

Northern Highland - American Legion State Forest

C263H Stands 1, 10

South Turtle Lake Road - 62 Acres

Town of Mercer and Winchester

T43N R4E Section 13

T43N R5E Section 18

NHAL Master Plan: Area 1 - Winegar Moraines Forest Production Area

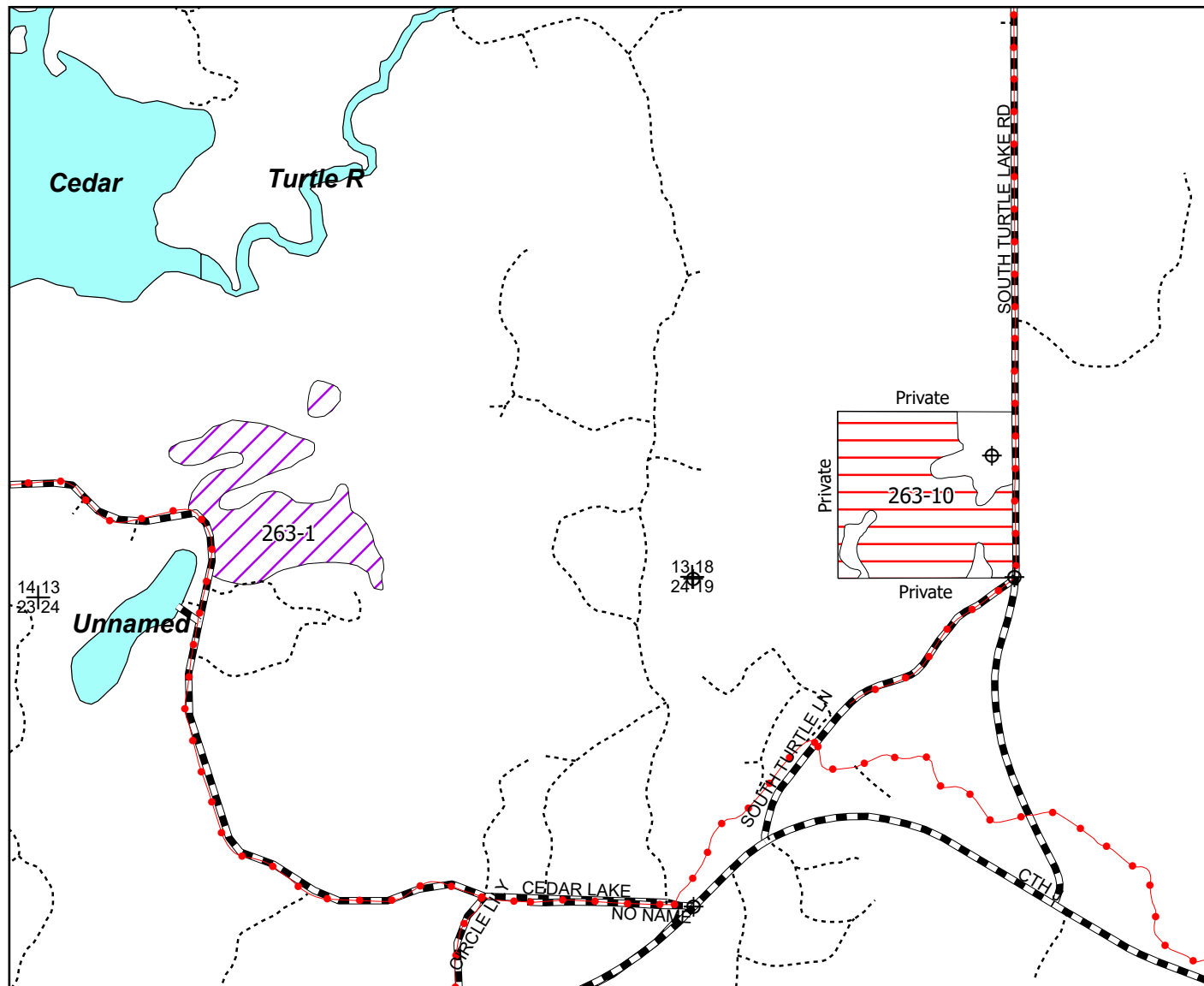

Legend

- ⊕ Survey Marker
- + Section Corner
- Snowmobile Trails
- Woods Roads
- == Highways and Town Roads
- Lakes
- Aspen 1967
- Aspen 1972

Stand 1 (28 acres): Aspen stand 1967 origin that will be regenerated through a coppice with standards harvest.

Stand 10 (34 acres): Aspen stand 1972 origin that will be regenerated through a coppice with standards harvest.

Biomass harvest is approved.



Scale: 4" = 1 Mile
1:15,840



Map produced by
Christopherson 04/25

This map is for informational purposes only and may not have been prepared for or be suitable for legal, engineering or surveying purposes. The user is solely responsible for verifying the accuracy of information before using for any purpose. By using this product for any purpose user agrees to be bound by all disclaimers found here: <https://dnr.wisconsin.gov/legal>.