

Northern Highland - American Legion State Forest
C257H Stands 5, 19, 20
Powell Road- 123 Acres
Town of Sherman
T42N R4E Section 25
NHAL Master Plan: Area 2 - Manitowish Peatlands Forest Production Area

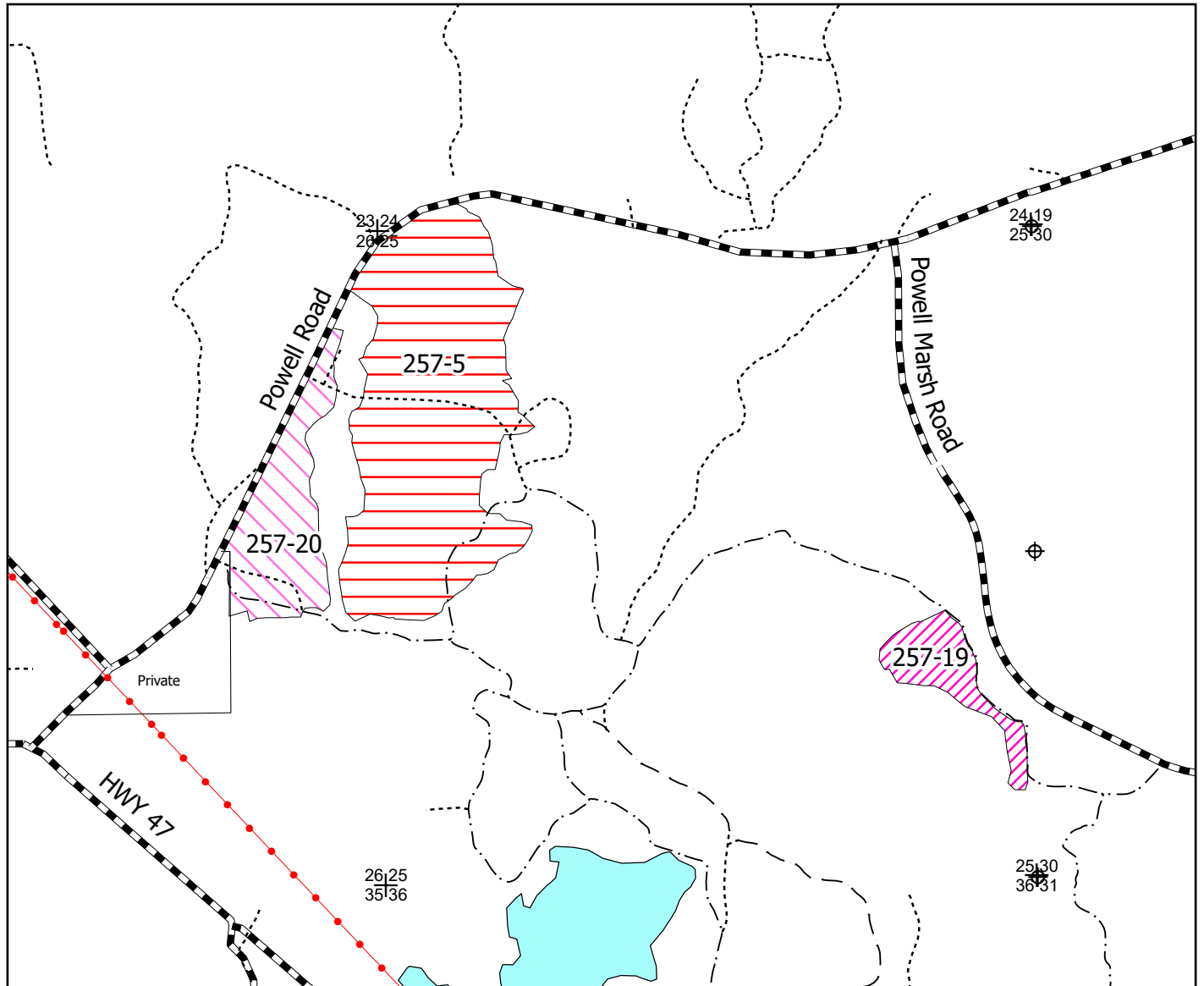

Legend

-  Survey Marker
-  Section Corner
-  Recreational Trails
-  Snowmobile Trails
-  Woods Roads
-  Highways and Town Roads
-  Lakes
-  Northern Hardwoods 5
-  Northern Hardwoods 19
-  Aspen

Stand 5 (86 acres): This is a small sawlog size northern hardwood and hemlock stand with a diversity of forest regen. The stand will receive a selection harvest with gaps to promote growth and vigor.

Stand 19 (12 acres): This is a well stocked pole-sized northern hardwood stand that will be harvested following the even-age to uneven-age conversion steps.

Stand 20 (25 acres): Aspen stand of 1974 origin. The stand will receive a coppice with standards harvest to regenerate the aspen.



Scale: 4" = 1 Mile
 1:15,840



Map produced by
 Christopherson 04/25

This map is for informational purposes only and may not have been prepared for or be suitable for legal, engineering or surveying purposes. The user is solely responsible for verifying the accuracy of information before using for any purpose. By using this product for any purpose user agrees to be bound by all disclaimers found here: <https://dnr.wisconsin.gov/legal>.