

Northern Highland - American Legion State Forest
C147H Stand 20
Mist Pine- 15 Acres
Town of Boulder Junction
T41N R7E Section 30
NHAL Master Plan: Area 12 - Mixed Forest Native Community Management

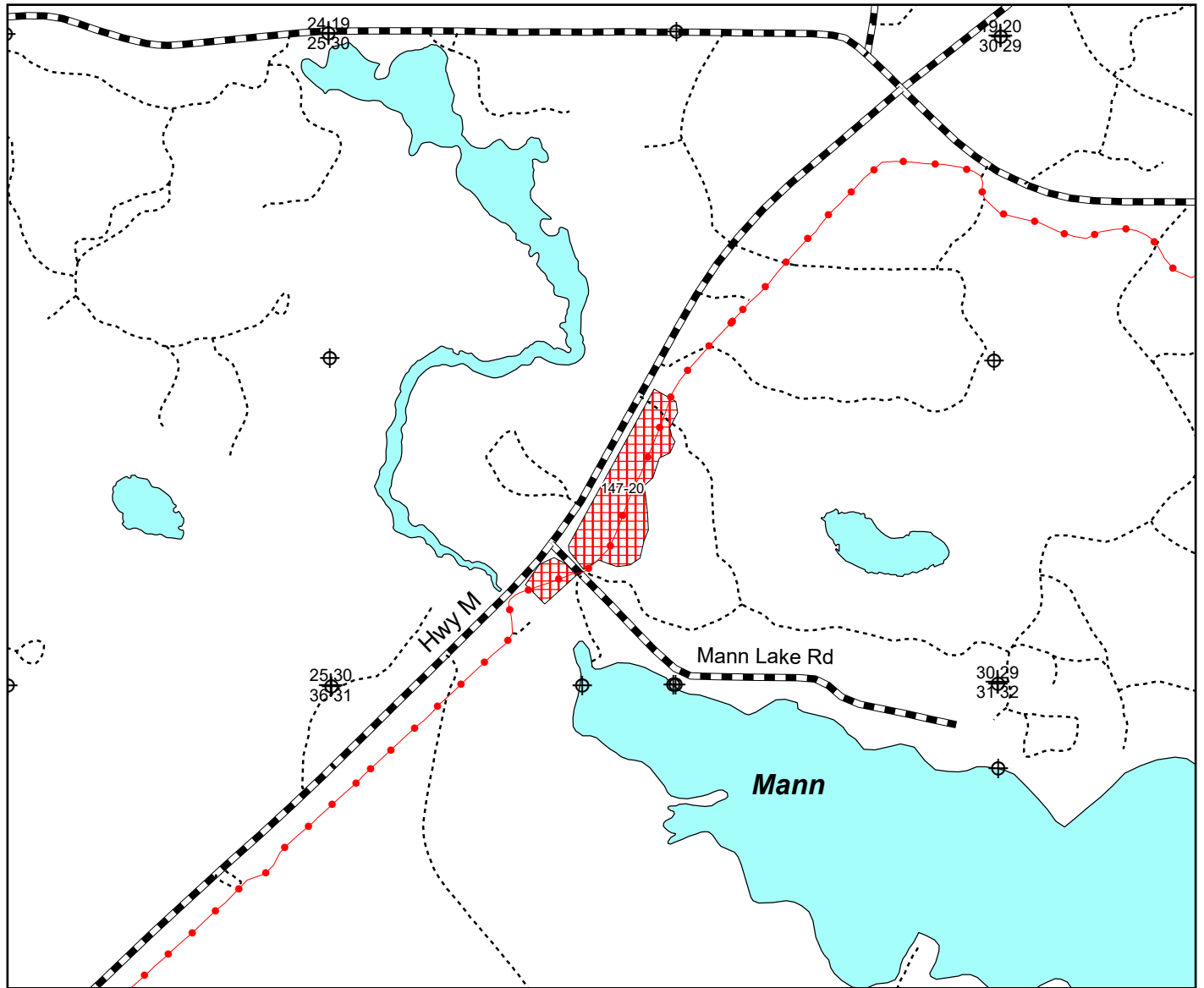

Legend

- Survey Marker
- Section Corner
- Snowmobile Trails
- Woods Roads
- Highways and Town Roads
- Lakes
- Red Pine

Stand 20 (15 acres): This is a well stocked red pine stand of 1977 origin that will receive a second thinning to promote growth and vigor.

N

 Scale: 4" = 1 Mile
 1:15,840



Map produced by
 Christopherson 04/25

This map is for informational purposes only and may not have been prepared for or be suitable for legal, engineering or surveying purposes. The user is solely responsible for verifying the accuracy of information before using for any purpose. By using this product for any purpose user agrees to be bound by all disclaimers found here: <https://dnr.wisconsin.gov/legal>.