

**Northern Highland - American Legion State Forest**  
**C107H Stands 1 & 18 and C108H Stand 1**  
**Hwy 70 Sunset Cruise - 140 Acres**  
**Town of Arbor Vitae, Vilas County, T40N-R7E Secs. 26, 27, 34 & 35**  
**NHAL - SF Master Plan: Mgmt. Area 5 - Big Arbor Vitae Loamy Hills - Forest Production**

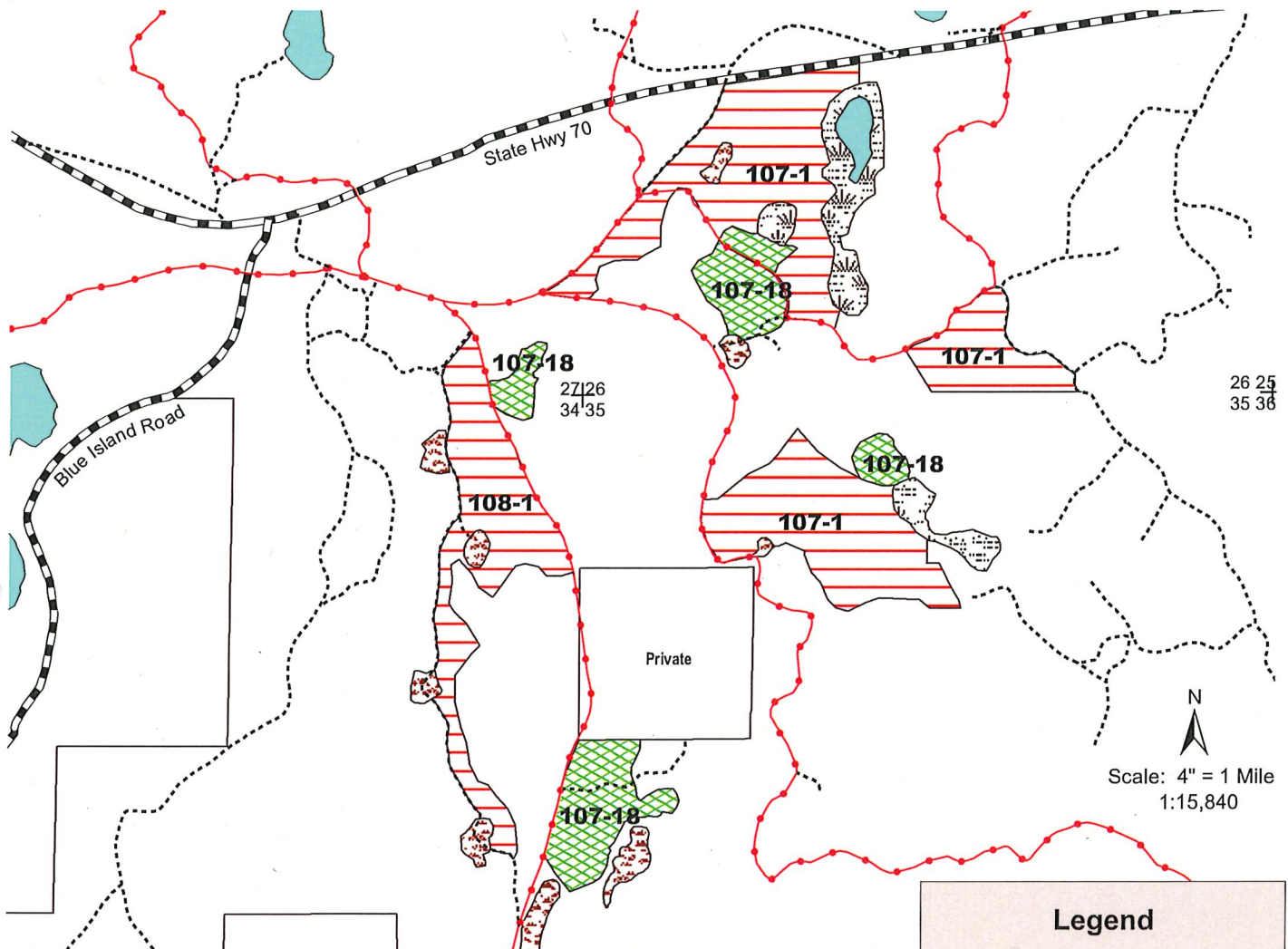

C107H - Stand 1 (80 Acres) is comprised of 53 year old well stocked aspen poletimber with other associated species. The goal is to maintain aspen as a strong component across the landscape. A coppice with standards harvest will be prescribed to regenerate this stand. This stand is adjacent to similar aged aspen which has been split into three separate stands in order to diversify age class distribution.

C107H - Stand 18 (30 Acres) is comprised of 111 year old well stocked red and white pine sawtimber. This stand was thinned in the past. This stand would benefit from an improvement thinning at this time. A free thinning technique will be applied to remove the highest risk and poorest quality trees.

C108H - Stand 1 (30 Acres) is comprised of 47 year old well stocked aspen poletimber with other associated species. The goal is to maintain aspen as a strong component across the landscape. A coppice with standards harvest will be prescribed to regenerate this stand. This stand is adjacent to similar aged aspen which has been split into three separate stands in order to diversify age class distribution.

There is a good network of woods roads and snowmobile trails throughout the area. There is direct access to State Hwy 70.

**Legend**

- Section Corner
- Woods Roads
- Snowmobile Trails
- Highways and Town Roads
- Lowland Area
- Wildlife Openings
- Aspen Regeneration Area
- Pine Area
- Lakes

This map is for informational purposes only and may not have been prepared for or be suitable for legal, engineering or surveying purposes. The user is solely responsible for verifying the accuracy of information before using for any purpose. By using this product for any purpose user agrees to be bound by all disclaimers found here: <https://dnr.wisconsin.gov/legal>.



Map produced by  
 Jim Wetterau, 2/25