

Northern Highland - American Legion State Forest
C21A Stands 16 & 17
Highpoint Aspen 136 Acres
Town of Woodruff, Oneida County T39N-R7E Sec. 25
NHAL-SF Master Plan: Mgmt. Area 6 - Oneida Sandy Plains - Forest Production

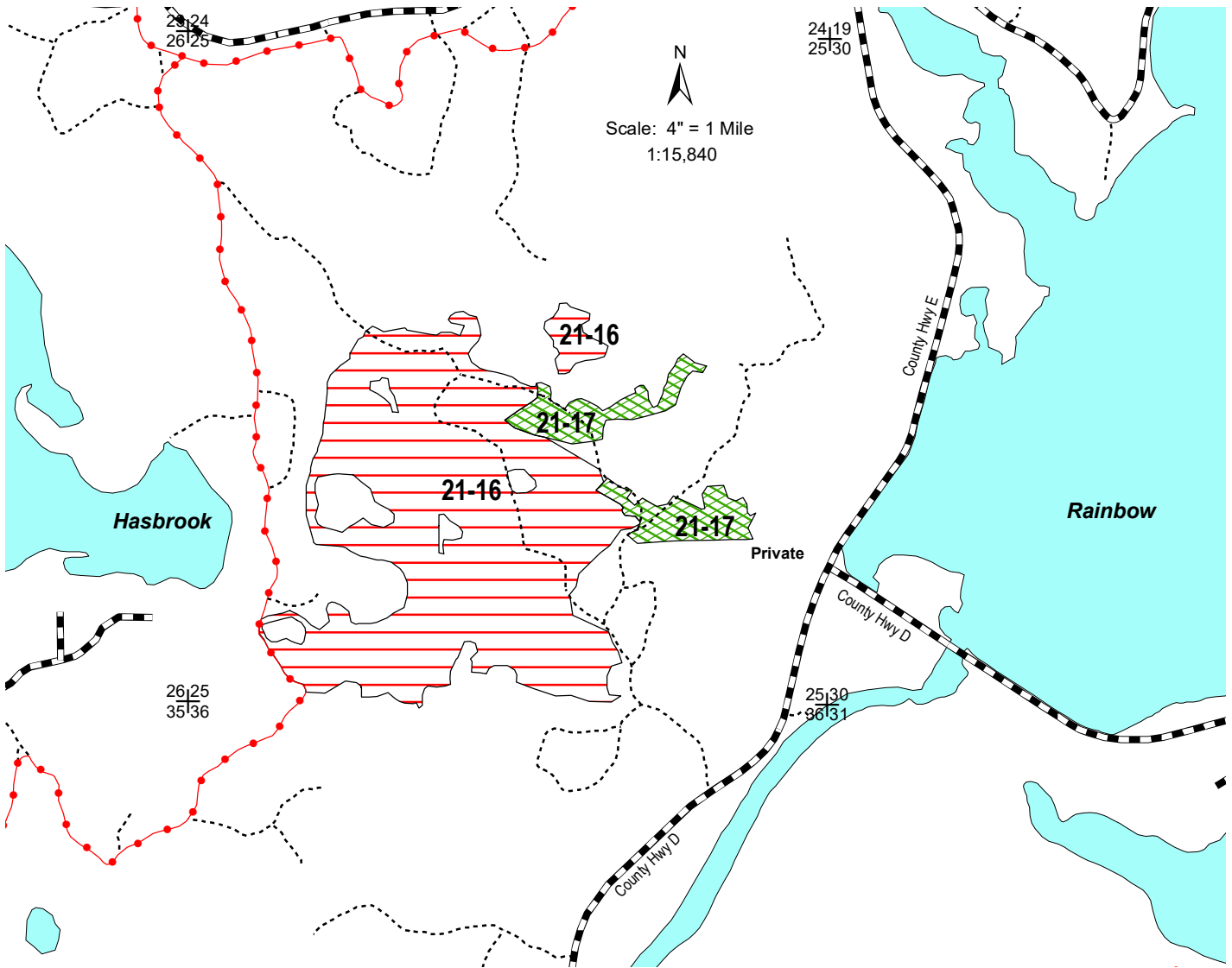

Legend

- Section Corner
- Highways and Town Roads
- Snowmobile Trails
- Woods Roads
- Aspen Regeneration Area
- Pine Thinning Area
- Lakes

C21A Stand 16 (122 acres) is comprised of well stocked aspen poletimber with associated maple, birch and pine. This stand originated in 1970. The goal is to maintain aspen on the landscape by regenerating it through a simple coppice with standards harvest prescription.

C21A Stand 17 (14 acres) is a 106 year old natural large sawlog sized red and white pine stand. This stand is somewhat clumpy with variable stocking densities. It will receive an improvement thinning to maintain growth and vigor.

There is a snowmobile trail located in the southwest corner of the proposed timber sale. The trail will be signed and kept snow covered if harvested during the winter. Biomass harvesting is restricted due to the soils. There is good access to County Hwy D.

