

Northern Highland - American Legion State Forest
C79H Stands 1 & 2

West Plum Aspen 205 Acres

Town of St. Germain T40N, R7E, Sections 12 & 13

NHAL - SF Master Plan Mgmt Area 4 - Vilas Sandy Plains Central - Forest Production

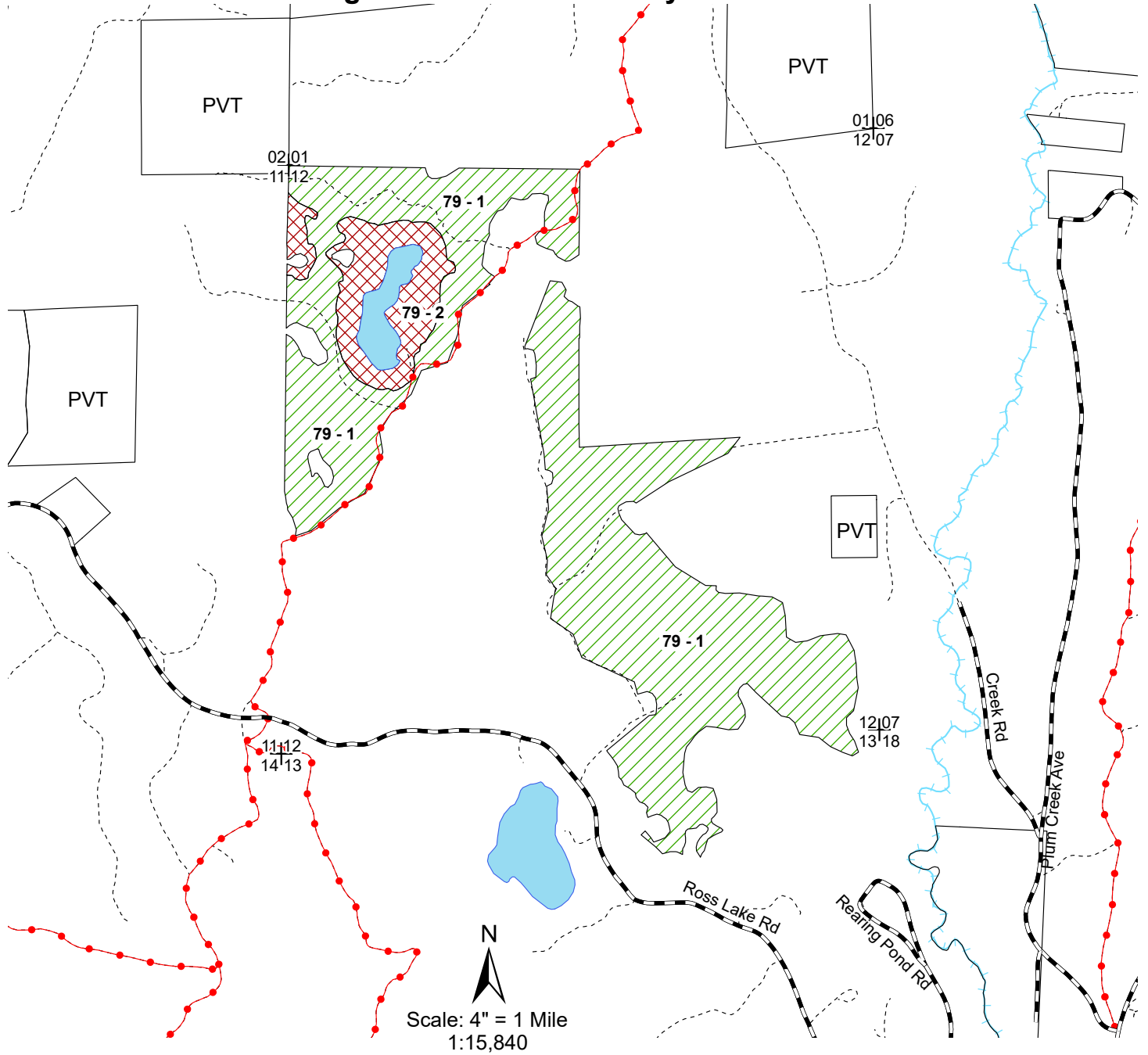

Scale: 4" = 1 Mile
1:15,840

Legend

- ⊕ Section Corner
- Town and County Roads
- Snowmobile Trails
- - - Woods Roads
- ~ Rivers and Streams
- Lakes
- ▨ Aspen Area
- ▩ Pine Area

Area 4: Vilas Sandy Plains Central

C79H Stand 1 (182 Acres) is an aspen stand with a year of origin of 1974. This stand was split from a larger block of aspen and will be regenerated using a coppice with standards. The other stand will be regenerated at a later time to create age class diversity on the landscape.

C79H Stand 2 (23 Acres) is comprised mainly of large sawlog size red pine along with other species. This stand will receive a thinning to promote the growth and vigor of the remaining stems.