

# Northern Highland - American Legion State Forest

C172H Stands 1, 2, 3, 8

Wooly Woods - 99 Acres

Town of Boulder Junction

T42N R6E Sec 13, 14, 24

## NHAL Master Plan: Area 3 - Vilas Sandy Plains North - Forest Production

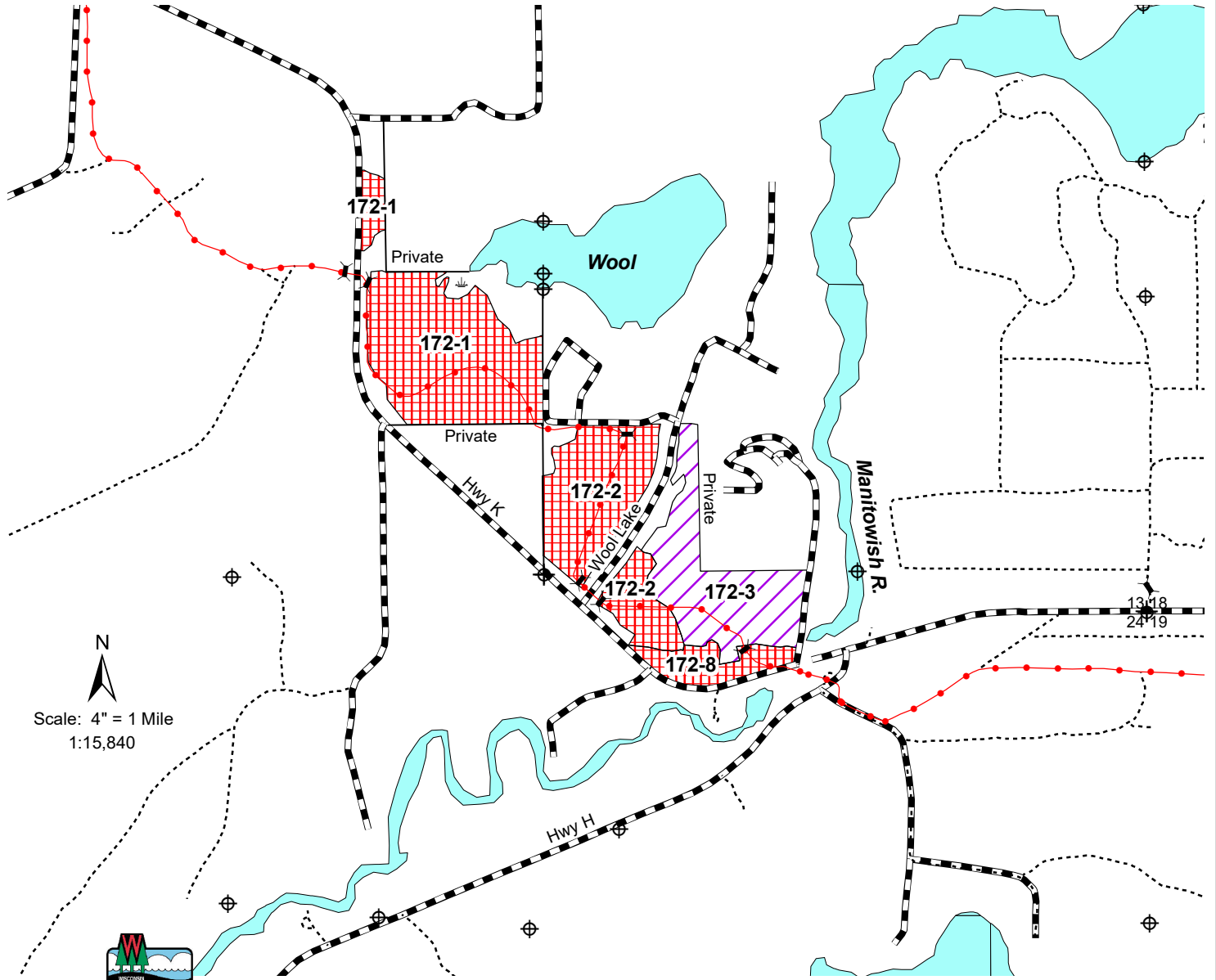

Scale: 4" = 1 Mile  
1:15,840



Map produced by  
Zweifel&Christopherson 02/19

This map is not a survey of the actual boundary of any property this map depicts.

### Legend

- Keg/Swamp
- Gates
- Section Corner
- Survey Marker
- Woods Roads
- Snowmobile Trails
- Highways and Town Roads
- Oak
- Red Pine
- Lakes

**Stand 1 (38 acres)** is a 54-year-old red pine plantation that is ready for a thinning. The stand was last thinned in 2010. The prescription will be a free thinning, with the intent to reduce the stocking level to promote the growth and vigor of the remaining crop trees.

**Stand 2 (28)** is a 70-year-old red pine plantation that is ready for a thinning. The stand was last thinned in 2000. The prescription will be the same as stand 1.

**Stand 3 (25 acres)** is a 99-year-old oak stand that received a shelterwood harvest in 2000. The stand will have an overstory removal harvest completed to release advanced regeneration. Larger diameter oak and pine will be retained with 5-10 trees per acre for wildlife and aesthetic purposes.

**Stand 8 (8 acres)** is a 101-year-old stand of red pine with a mix of other species, including oak and birch. This stand will be thinned, and most short-lived species will be cut.

The snowmobile trail will be posted if cutting occurs near the trail in winter. Aesthetics along the roads and trails should be minimized with an ample amount of pine residual throughout most areas.