

Northern Highland - American Legion State Forest

C182H Stands 2, 4, 6, 9, 18, 19

Max Lake - 150 Acres

Town of Arbor Vitae

T41N R6E Sec 23

NHAL Master Plan: Area 3 - Vilas Sandy Plains North - Forest Production

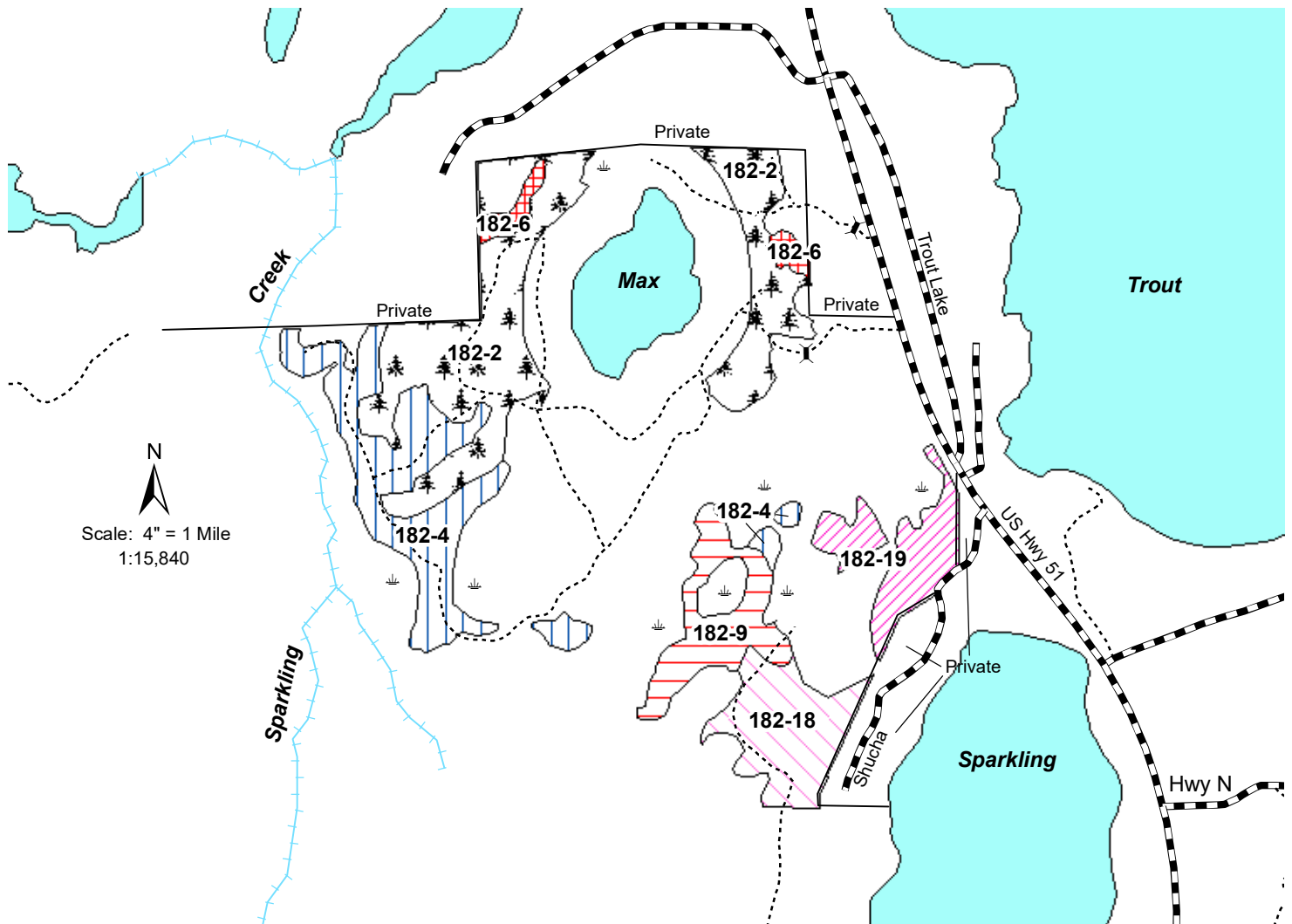

Legend

- Keg/Swamp
- Gates
- Survey Marker
- Woods Roads
- Highways and Town Roads
- Rivers and Streams
- Oak
- Pine
- White Pine
- Aspen
- Oak mix
- Oak
- Lakes

Stand 2 (57 acres) is an oak stand of 1920 origin. The stand had a shelterwood harvest in 2010 and is now ready for an overstory removal to release the oak and pine regeneration. The northeast corner has a heavy aspen and maple understory.

Stand 4 (37 acres) is a pine stand of 1890 origin. Parts of the stand will be thinned and other areas will be regenerated with a shelterwood harvest.

Stand 6 (5 acres) is a white pine stand of 1990 origin. This stand will receive a marked thinning and the early successional species will be harvested.

Stand 9 (16 acres) is an aspen stand of 1964 origin. The proposed harvest will be coppice with standards to regenerate the aspen.

Stand 18 (20 acres) is an oak stand of 1917 origin. The stand was last harvested in 1995. It will now receive a shelterwood harvest to regenerate oak and pine.

Stand 19 (15 acres) is an oak stand of 1917 origin. The stand has no known history of forest management and will now be thinned. Access to the north end of the stand will be difficult.



Map produced by
Chase Christopherson, 02/19

This map is not a survey of the actual boundary of any property this map depicts.