

Northern Highland – American Legion State Forest

C32H Stand 26

Camp Two Road Red Pine Failure 67 acres

Town of Plum Lake, Vilas County

T42N R8E Sec. 22 & 27

NHAL – SF Master Plan: Mgmt. Area 3 – Vilas Sandy Plains North – Forest Production

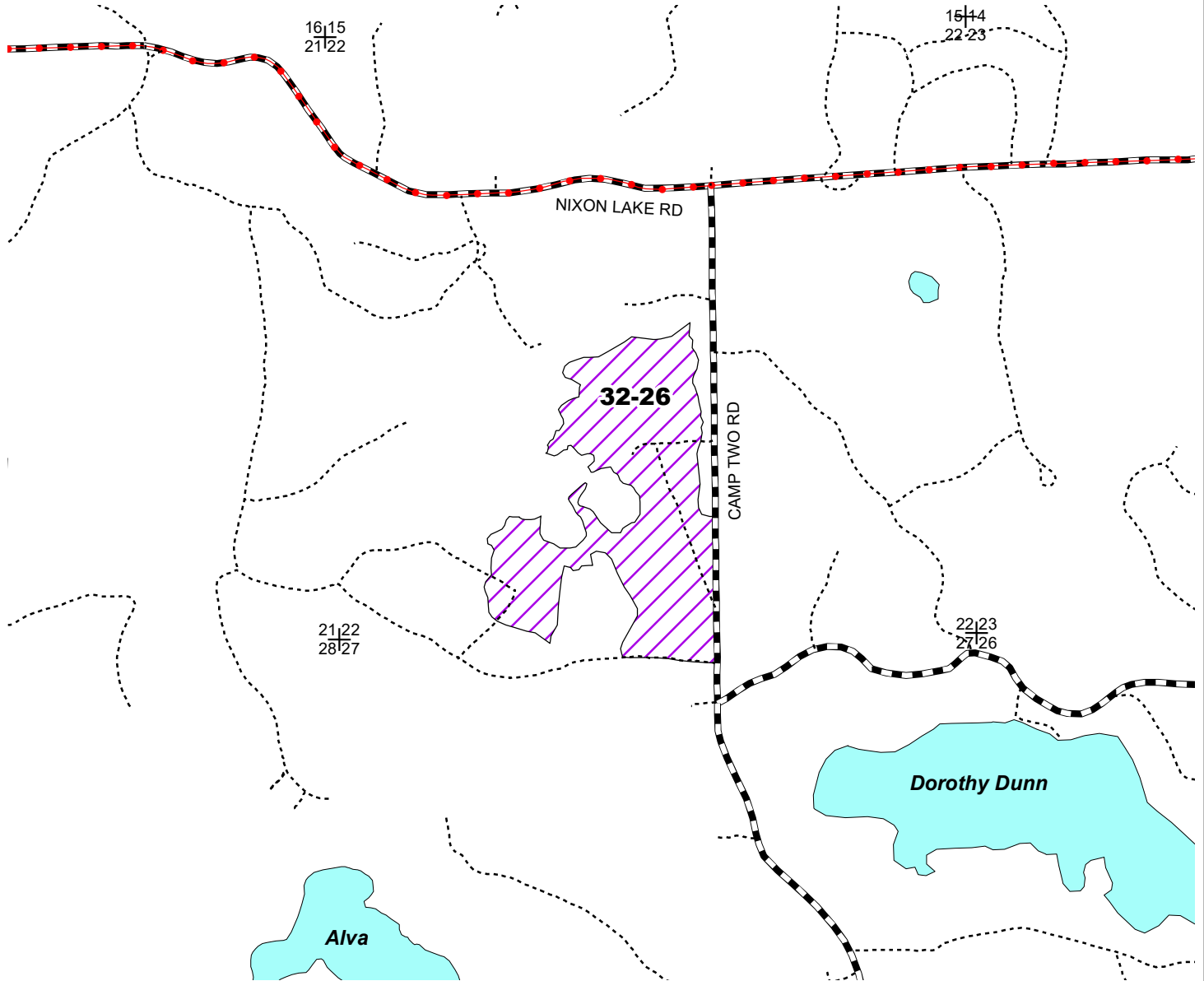





Scale: 4" = 1 Mile
1:15,840



Map produced by
Todd Anderson &
Paul Schultz, 2/19

C32H Stand 26 (67 acres): This is a red pine plantation planted in 1995. A significant portion of the stand has failed. The overall stocking is low with open grown and limby red pine. Bracken fern and blackberry dominate vast portions of the stand. Areas that did not fail will be thinned if suitable. The remaining portion of the stand will be clearcut and prepared to be replanted (preferably to jack pine) to maintain a fully stocked productive stand of timber.

Legend

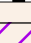
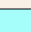
-  Section Corner
-  Woods Roads
-  Snowmobile Trails
-  Highways and Town Roads
-  Red Pine Plantation
-  Lakes