

**WISCONSIN
DEPARTMENT OF NATURAL RESOURCES
TIMBER SALE
TRACT 038-25W OELHAFEN CREEK
T37N R5E SECTIONS 11 & 14
HARVEST ACRES - 119**

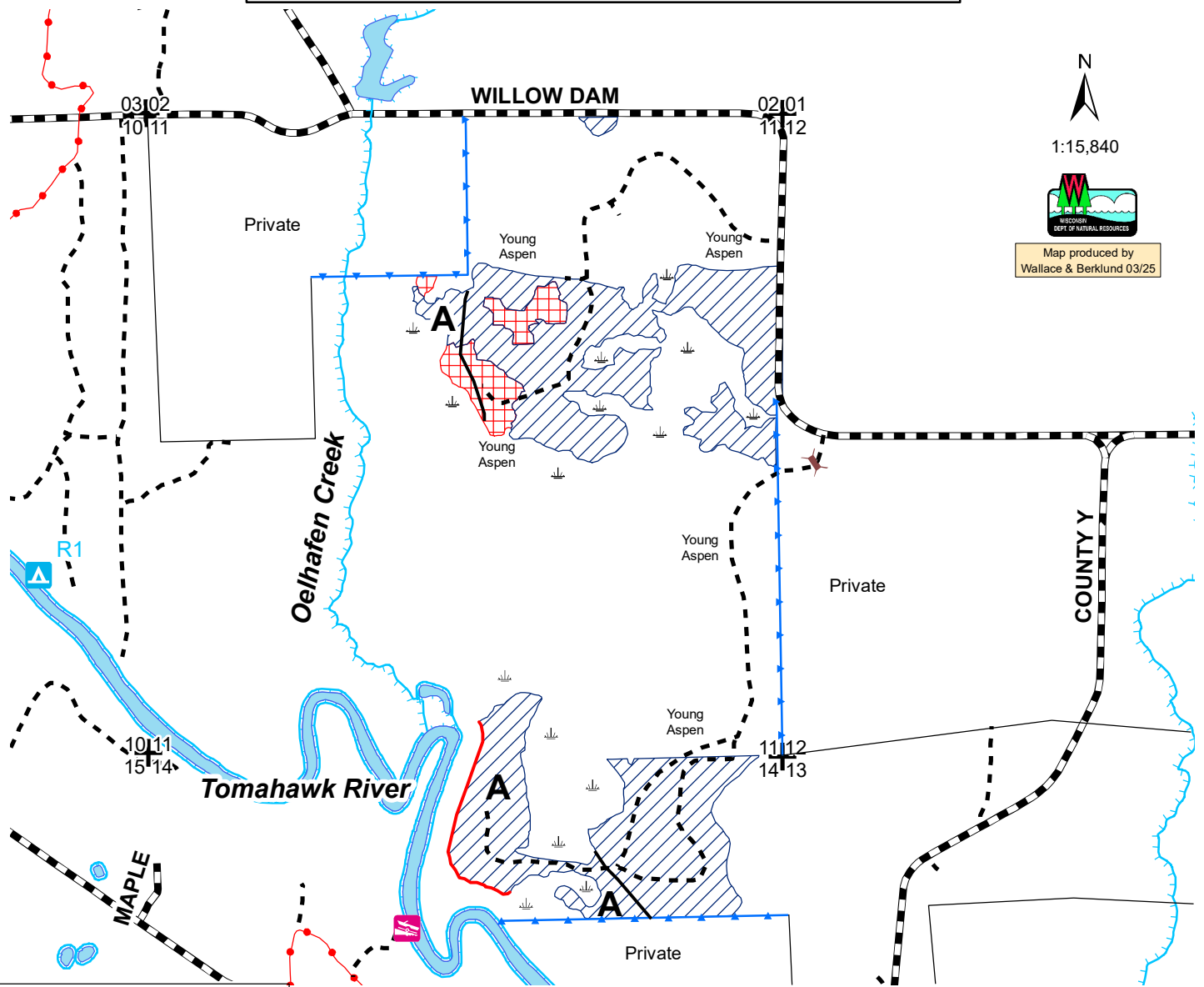

N
1:15,840



Map produced by
Wallace & Berkland 03/25

Legend

- Blue Line
- Red Line
- Section Corners
- Woods Roads
- Snowmobile and ATV Trail
- Town/County Roads
- Creeks
- Campsite
- Canoe Landing
- Lakes/Rivers
- Wetland
- Private Gate

- Aspen Harvest Area (109 acres): Cut all aspen, balsam fir, maple, and white birch. Cut all 1-5" aspen & maple concurrently.
- Red Pine Thinning (10 acres): Cut all orange marked trees and all merchantable aspen, balsam fir, maple and white birch.

Zone A (27 acres): Logging operations are only allowed from Sept. 15 to May 15 within 300 meters of the river and creek.

Note: Do NOT damage advanced pine or oak regeneration/saplings when found throughout the sale area.

This map is for informational purposes only and may not have been prepared for or be suitable for legal, engineering or surveying purposes. The user is solely responsible for verifying the accuracy of information before using for any purpose. By using this product for any purpose user agrees to be bound by all disclaimers found here: <https://dnr.wisconsin.gov/legal>.

WILLOW FLOWAGE SCENIC WATERS AREA

TRACT NO. 38-25W

Oelhafen Creek

Oneida County

The cutting area is approximately 119 acres.

All trees designated for harvest that yield one or more 100-inch sticks to the minimum 4" top diameter will be cut and utilized.

ESTIMATED VOLUME (TONS)
MINIMUM TOP DIAMETER

<u>SPECIES</u>	<u>4"</u>
Red Pine ¹	110
Balsam Fir	670
Aspen ²	5630

Total Minimum Bid Value: \$ 75,278.00

¹ Pine Logs are approximately 75% Red Pine and 25% White Pine and a total of 10 MBF of sawlogs.

² Aspen is approximately 98% Aspen, 1% Maple, 1% White Birch

Total sale volume equates approximately to 50 tons/acre or 24 cords/acre.

Special Conditions:

1. Do not cut, knock down or utilize any dead trees, except they may be cut down along roadways where they pose a safety hazard.
2. Slash within 50 feet of all roads, trails, and waterbodies must be lopped and/or scattered to lie within two feet of the ground and be pulled back 10 feet behind the tree line concurrently with cutting. No slash allowed across any wetland or waterbody.
3. Do not cut any trees within 15 feet of the ephemeral ponds. All wetland areas are to be avoided as much as possible or only operated within during dry or frozen ground conditions to prevent rutting.
4. Cutting must be concurrent for all species to be harvested. Do not damage residual trees, especially pine regeneration.
5. All landings and any new woods roads must be approved by the Willow Property Manager.
6. Access through the private property and gate to the southern sale area has been verbally granted to WI DNR. The logging contractor must keep this private access road in good drivable condition by passenger vehicles at all times. No decking of wood products or any other use of the private property or access road is allowed. Contact the Willow Flowage Property Manager in advance for access through the private gate.
7. If the contract is to be worked on during multiple time periods a mid-contract "pull-off" inspection meeting will be required. One-week notice shall be given by the contractor prior to moving equipment off site. During the "pull-off" inspection, provisions needing attention will be documented. The contractor at that time can decide to remedy them before pulling equipment off or rectify them when moving back onto the site. If the latter is chosen, documented items shall be addressed before harvesting can continue.
8. In Zone A (27 acres), logging operations are only allowed from Sept. 15 to May 15 within 300 meters of the river and creek.
9. All pine products cut between April 1 and September 1 must be removed from the sale area within three weeks from time of cutting. Pine products cut during the remainder of the year must be removed prior to April 1 of each year.
10. Biomass (whole-tree) utilization is not allowed.

State of Wisconsin
Department of Natural Resources
dnr.wi.gov

Timber Sale Bid

Form 2400-049 (R 07/22)

Notice: Completion of this form is mandatory. The Department will not recognize your bid unless you complete and submit this form. Personal information collected will be used for program administration and may be provided to requesters as required by Wisconsin's Public Records law [ss. 19.31-19.39, Wis. Stats.].

Date

Bidder Name

Street Address

City

State

ZIP Code

Property Name (if any)

Willow Flowage Scenic Waters

Timber Sale Name

Oelhafen Creek

Tract Number

38W-35

Date and Hour of Bid Opening

May 7, 2025 1:30pm Boulder Junction Community Center

Minimum Acceptable Bid (optional)

\$75,278.00

Species-All bids including Lump Sum bids must be by species	Utilization Specifications (4 inch/Whole Tree/Logs)	Estimated Volume	Volume Units (tons/cords/mbf)	Price Bid Per Unit	Total Bid Value on Estimated Volume
red pine	4 inch	110	tons		
balsam fir	4 inch	670	tons		
aspen	4 inch	5,630	tons		

The award shall be based on this TOTAL BID AMOUNT:

Performance Bond

Will be in the form of: (select one)

☐ Personal Check

☐ Assurance Bond

☐ Certified Check/Money Order

☐ Certificate of Deposit

☐ Irrevocable Letter of Credit

☐ Assignment of Savings Account

I understand that any or all bids may be rejected and that consideration and awarding of a contract will be based upon my past performance and ability to complete contracts. **I also understand that if I am the winning bidder, I have 6 weeks from the date of the bid opening to submit an acceptable performance bond. I also understand that if I am awarded the contract and fail to execute it or work under it, I will be required to forfeit to the Department an amount equal to 10% of my total bid amount.** Failure to forfeit the 10% penalty will result in being considered ineligible to bid on any state timber sales for a two-year duration. In the event the highest bidder can not or will not sign the contract, the award may be made to the next highest qualified bid.

☐ By checking this box, I certify that I hold a Wisconsin Master Logger Certification.

Notice: I understand:

Utilization specifications and estimated volumes are listed in the prospectus which is available upon request from the Department.

A copy of the standard timber sales contract which must be entered into is available upon request from the Department.

Signature of Bidder

Bidder's Name (Please Print or Type)

Phone Number (include area code)

Email Address