

**WISCONSIN
DEPARTMENT OF NATURAL RESOURCES
TIMBER SALE
TRACT 29-24 BALLOON FACTORY
T42N R5E SECTION 14, 15
HARVEST ACRES - 96**

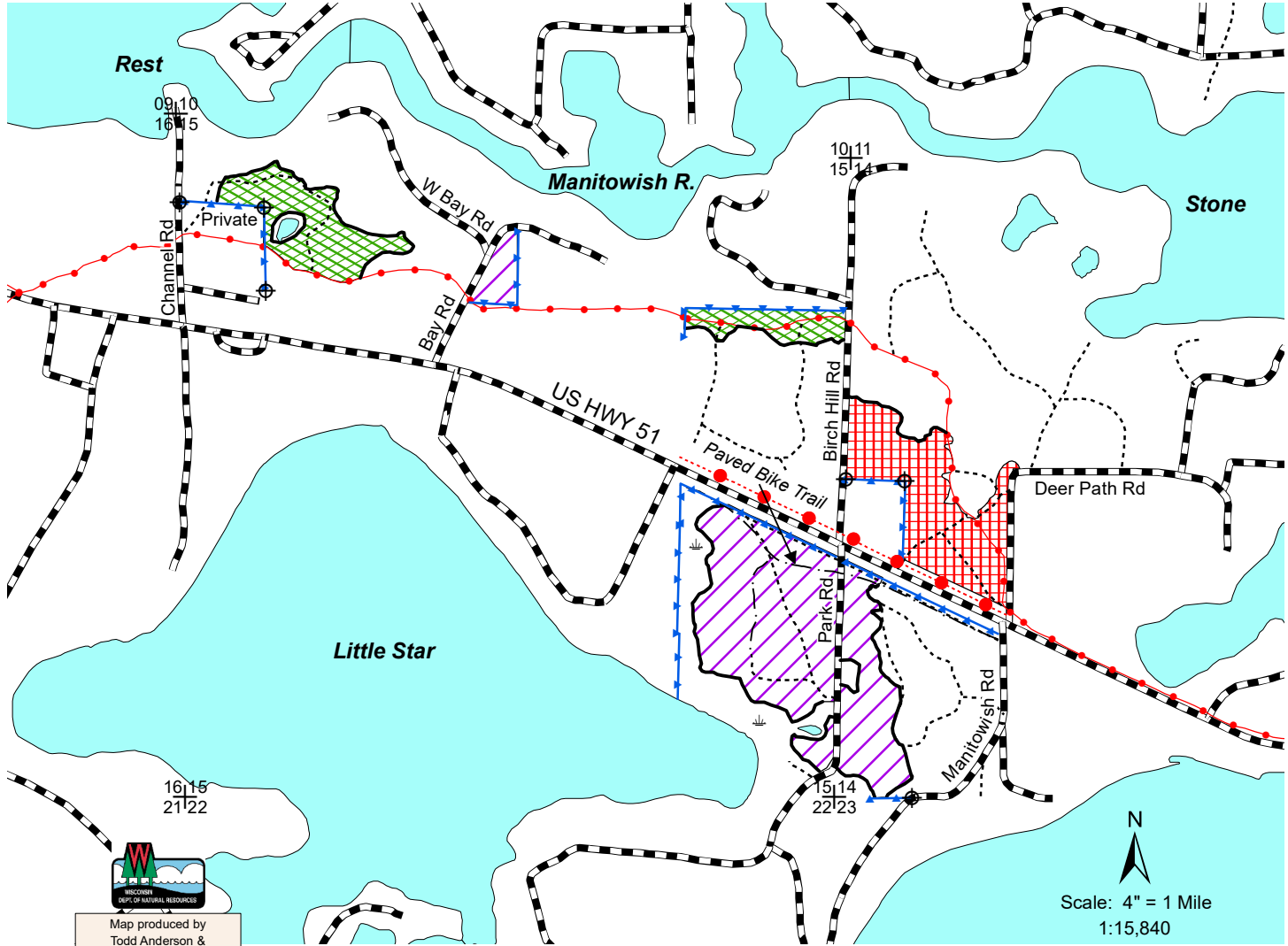

Map produced by
Todd Anderson &
Christopherson 09/24

Scale: 4" = 1 Mile
1:15,840

- Legend**
- Keg/Swamp
 - Survey Marker
 - Section Corner
 - Power Line
 - Blue Line
 - Red Line
 - Recreational Trail
 - Snowmobile Trails
 - Woods Roads
 - Highways and Town Roads
 - Lakes

- Aspen Coppice (20 Acres): Cut all merchantable aspen, red maple, oak, red pine and orange marked trees. Cut 1-5 inch maple.
- Pine Thinning (23 Acres): Cut all pine marked with orange paint.
- Aspen and Pine Stands (53 Acres): Cut all merchantable aspen, maple, and orange marked trees. Cut 1-5 inch maple.

Note: All logging operations, including road building, are only allowed between July 16 – April 14. Do not cut trees marked with green paint. Do not cut any maple within 25 feet of any Town Road.

This map is for informational purposes only and may not have been prepared for or be suitable for legal, engineering or surveying purposes. The user is solely responsible for verifying the accuracy of information before using for any purpose. By using this product for any purpose user agrees to be bound by all disclaimers found here: <https://dnr.wisconsin.gov/legal>.

NH-ALSF TRACT NO. 29-24
Balloon Factory

The cutting area is approximately 96 acres.

All trees that will yield one or more 100-inch sticks to a minimum 4" top diameter will be cut and utilized.

ESTIMATED VOLUME (TONS)

MINIMUM TOP DIAMETER

<u>SPECIES</u>	<u>4"</u>
Red Pine ¹	1100
Aspen	2850
Oak ²	435
Red Maple	285

Total Minimum Bid Value \$70,052.50

1\ Contains approximately 143 tons and 170 MBF red pine; 49 tons and 34 MBF white pine.

2\ Contains approximately 25 MBF oak.

Sale contains approximately 50 tons/acre or 22 cords/acre.

Administering Forester – Todd Anderson / 715.892.0529 - toddm.anderson@wisconsin.gov

Special Conditions

1. SEASONAL RESTRICTION: Harvest activity (cutting and forwarding) is allowed only between July 16 and April 14. Hauling of cut products allowed year round.
2. At the time this sale was established the construction of the paved bike trail was scheduled to begin, it should be completed by the time of the bid opening. There will be enhancements made to the trail to allow machinery crossing to access the wood between the trail and USH 51 ROW.
3. Snowmobile trail must be kept free of debris, snow covered in winter, and always left in good condition for vehicle traffic. All landings and any new roads must be approved prior to sale start up. All roads must be cleared of debris and leveled upon sale completion.
4. Do not harvest any trees or operate machinery within 15 feet of any wetland. Cutting must be concurrent for all species to be harvested. Within 25 feet of any Town Road or woods road, treat all slash to lie within 2 feet of the ground.
5. All pine products cut between April 1 and September 1 must be removed from the sale area within three weeks from time of cutting. Pine products cut during the remainder of the year must be removed prior to April 1 of each year.
6. Biomass harvesting is not allowed. Do not cut, knock down or utilize any dead trees unless they pose an operational safety risk.
7. If the contract is to be worked on during multiple time periods a mid-contract "pull-off" inspection meeting will be required. One week notice shall be given by the contractor prior to moving equipment off-site. During the "pull-off" inspection, provisions needing attention will be documented. The contractor at that time can decide to remedy them before pulling equipment off or rectify them when moving back onto the site. If the latter is chosen, documented items shall be addressed before harvesting can continue.

Notice: Completion of this form is mandatory. The Department will not recognize your bid unless you complete and submit this form. Personal information collected will be used for program administration and may be provided to requesters as required by Wisconsin's Public Records law [ss. 19.31-19.39, Wis. Stats.].

Date

Bidder Name

Street Address	City	State	ZIP Code
----------------	------	-------	----------

Property Name (if any) Northern Highland-American Legion	Timber Sale Name Balloon Factory	Tract Number 29-24
---	-------------------------------------	-----------------------

Date and Hour of Bid Opening November 6, 2024 1:30 pm Boulder Junction Community Center	Minimum Acceptable Bid (optional) \$70,052.50
--	--

Species-All bids including Lump Sum bids must be by species	Utilization Specifications (4 inch/Whole Tree/Logs)	Estimated Volume	Volume Units (tons/cords/mbf)	Price Bid Per Unit	Total Bid Value on Estimated Volume
red pine	4 inch	1,100	tons		
aspen	4 inch	2,850	tons		
oak	4 inch	435	tons		
red maple	4 inch	285	tons		

The award shall be based on this TOTAL BID AMOUNT:

Performance Bond

Will be in the form of: (select one)

- | | |
|--|---|
| <input type="radio"/> Personal Check | <input type="radio"/> Assurance Bond |
| <input type="radio"/> Certified Check/Money Order | <input type="radio"/> Certificate of Deposit |
| <input type="radio"/> Irrevocable Letter of Credit | <input type="radio"/> Assignment of Savings Account |

I understand that any or all bids may be rejected and that consideration and awarding of a contract will be based upon my past performance and ability to complete contracts. **I also understand that if I am the winning bidder, I have 6 weeks from the date of the bid opening to submit an acceptable performance bond. I also understand that if I am awarded the contract and fail to execute it or work under it, I will be required to forfeit to the Department an amount equal to 10% of my total bid amount.** Failure to forfeit the 10% penalty will result in being considered ineligible to bid on any state timber sales for a two-year duration. In the event the highest bidder can not or will not sign the contract, the award may be made to the next highest qualified bid.

By checking this box, I certify that I hold a Wisconsin Master Logger Certification.

Notice: I understand:

Utilization specifications and estimated volumes are listed in the prospectus which is available upon request from the Department.

A copy of the standard timber sales contract which must be entered into is available upon request from the Department.

Signature of Bidder
Bidder's Name (Please Print or Type)
Phone Number (include area code)
Email Address