

**WISCONSIN
DEPARTMENT OF NATURAL RESOURCES
TIMBER SALE
TRACT 13-22 BIG RESINOSA
T42N R7E SECTIONS 21, 22, 27
HARVEST ACRES - 35**

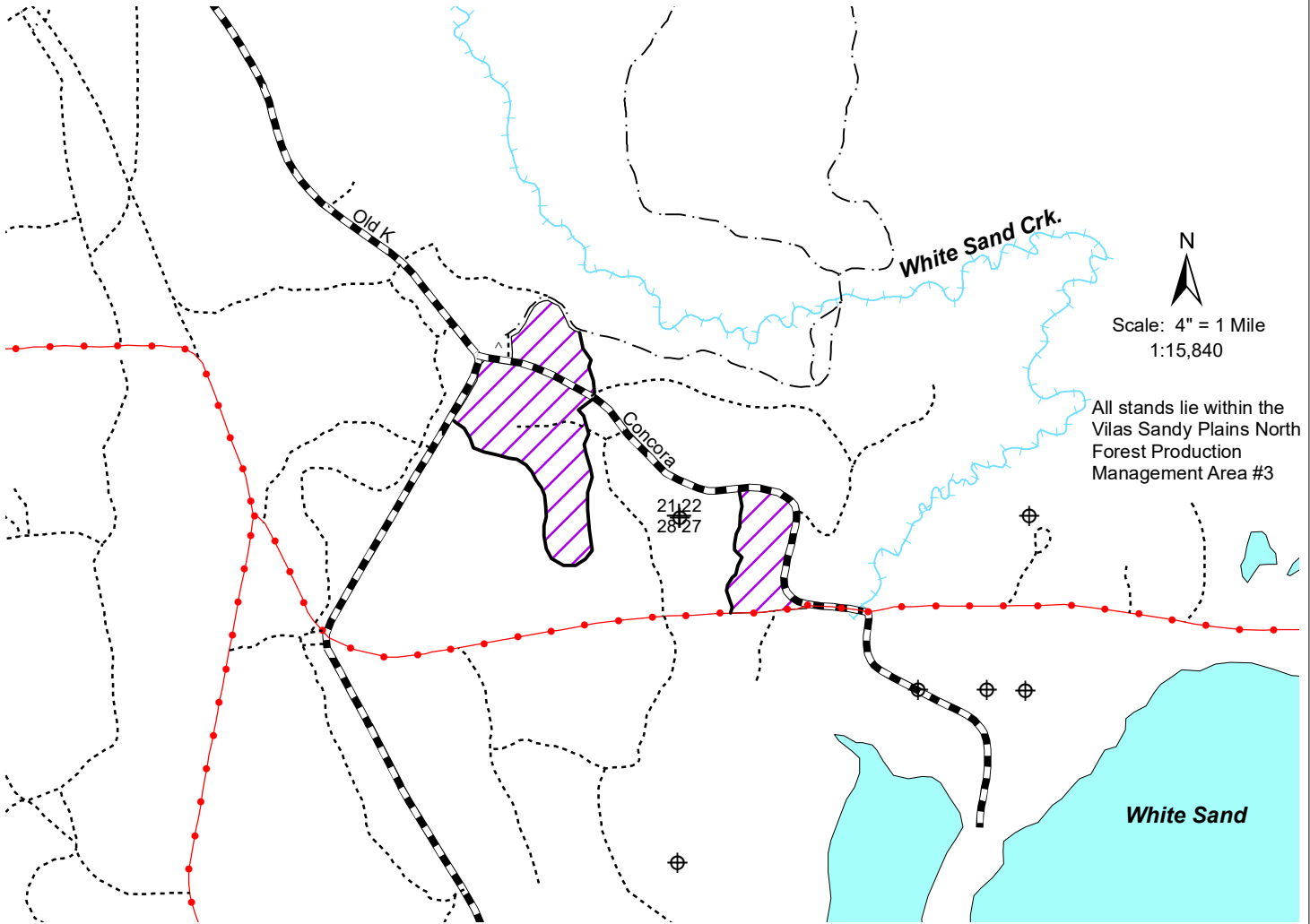

N
Scale: 4" = 1 Mile
1:15,840

All stands lie within the
Vilas Sandy Plains North
Forest Production
Management Area #3

Legend

- ⊕ Survey Marker
- ⊕ Section Corner
- Woods Roads
- Red Line
- - - Lumberjack Trail
- Snowmobile Trails
- ▬▬▬ Highways and Town Roads
- ~~~ Rivers and Streams
- ▨ Aspen / Pine
- Lakes

▨ Aspen / Pine Area (35 Acres): Cut all merchantable aspen, red maple, and jack pine. Cut all oak and pine marked with orange paint. Only cut white birch greater than 8-inches in diameter.

**Note: Do NOT cut trees marked with green paint.
No harvesting or skidding April 15 - July 15 due to
the risk of Oak Wilt.**



Map produced by
Christopherson &
Anderson 07/22

This map is not a survey of the actual boundary of any property this map depicts.

NH-ALSF TRACT NO. 13-22

Big Resinosa

Vilas County

Township 42 North, Range 7 East (Town of Boulder Junction)

Section 21 – NESE, SWSE, SESE

Section 22 – SWSW

Section 27 – NWNW

No bid bond will be required.

The cutting area is approximately 35 acres.

All trees that will yield one or more 100-inch sticks to the minimum top diameter chosen by the bidder will be cut and utilized.

Whole tree utilization is NOT allowed.

ESTIMATED VOLUME (TONS)

<u>SPECIES</u>	<u>MIN. TOP DIAMETER</u>
	<u>4"</u>
White Pine ¹	150
Red Pine ²	315
Aspen	700
Mixed Hardwood ³	380

Total Minimum Bid Value \$ 17,423.00

1\ Volume includes approximately 28 MBF white pine.

2\ Volume includes approximately 57 MBF red pine.

3\ Approximately 50% soft maple, 37% white birch 13% red oak. Volume includes approximately 7 MBF white birch and 6 MBF oak. (Wt. conv. 2.372 tons/cord).

Sale contains approximately 44 tons/acre or 18 cords/acre.

Special Conditions

1. **SEASONAL RESTRICTIONS:** Harvesting operations permitted from July 15 thru April 15.
2. Only cut white birch greater than 8-inches in diameter.
3. Slash will be treated to lie within two feet of the ground along the Town Roads and along the Lumberjack Trail.
4. All landings and any new roads must be approved prior to sale start up. All roads must be cleared of debris and leveled upon sale completion.
5. Cutting must be concurrent for all species.
6. Do not cut, knock down or utilize any dead trees unless they pose an operational safety risk.
7. If the contract is to be worked on during multiple time periods a mid-contract "pull-off" inspection meeting will be required. One week notice shall be given by the contractor prior to moving equipment off-site. During the "pull-off" inspection, provisions needing attention will be documented. The contractor at that time can decide to remedy them before pulling equipment off or rectify them when moving back onto the site. If the latter is chosen, documented items shall be addressed before harvesting can continue.