

**WISCONSIN
DEPARTMENT OF NATURAL RESOURCES
TIMBER SALE
TRACT 07-21 WOOLY WOODS
T42N R6 SECTIONS 13 & 24
HARVEST ACRES - 36**

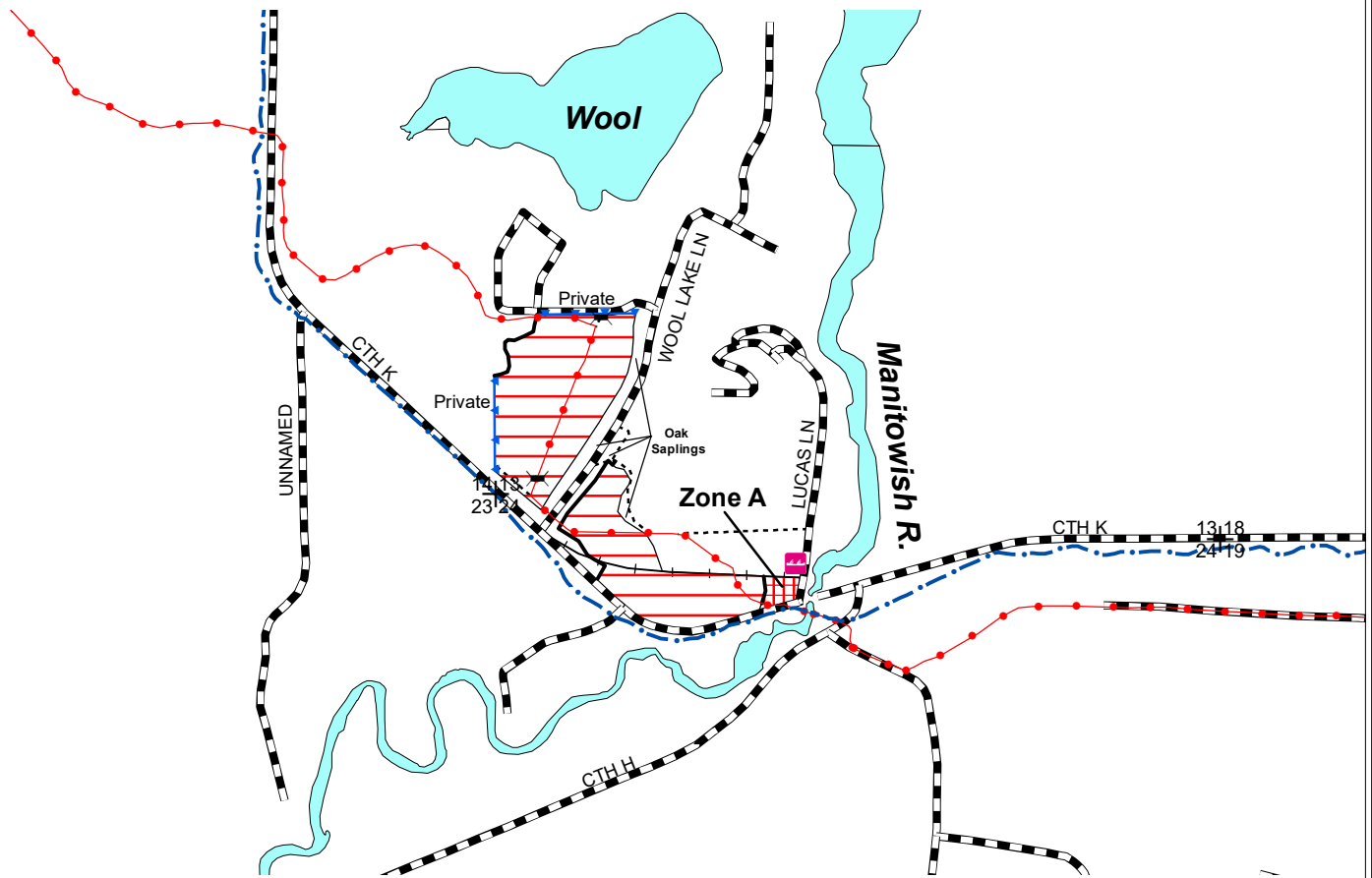

Legend

- Gate
- Canoe Campsite
- Section Corner
- Blacktop Bicycle Trail
- Snowmobile Trail
- Red Line
- Blue Line
- Highways and Town Roads
- Old Railroad Grade
- Woods Road
- Lakes and Rivers

Pine Thinning Area (36 Acres): Cut all merchantable jack pine, maple, and birch. Cut all orange-marked trees and scotch pine greater than 1-inch diameter.

Zone A (3/4 Acre): Harvesting is optional. Same cutting prescription as Pine Thinning Area, and if done must occur under frozen-ground conditions with no stump pulling or other soil disturbances.

Note: Do not cut trees marked with green paint.

No harvesting operations from April 15 - July 15 due to the risk of Oak Wilt.

Harvest operations limited to daytime hours during summer months to reduce impact to nearby campsites.

All stands lie within Mgmt. Area 3:
Vilas Sandy Plains North -
Forest Production Mgmt Area



Scale: 4" = 1 Mile
1:15,840



Map produced by
Brian Zweifel 02/21

This map is not a survey of the actual boundary of any property this map depicts.

NH-ALSF TRACT NO. 07-21

Wooly Woods

Vilas County

Town 42 North, Range 6 East (Boulder Junction Township)

Section 13 - SWSW

Section 24 – NENW, NWNW

No bid bond is required.

15% of the total sale bid value will be required for performance bond.

The cutting area is approximately 36 acres.

The contract period is 3 years.

All trees that will yield one or more 100-inch sticks to a 4" top diameter will be cut and utilized.

Whole tree utilization or biomass harvesting is NOT allowed.

ESTIMATED VOLUME (TONS)
MINIMUM TOP DIAMETER

<u>SPECIES</u>	<u>4"</u>
Red Pine ¹	925
Red Oak	45
Mixed Hardwood ²	40

Total Minimum Bid Value: \$15,571.50

¹ Includes potential for 70 MBF of red pine sawlogs.

² Approximately 68% hard maple and 32% white birch. (Wt. conv. 2.501 tons/cord)

Note: Total sale volume equates to 28.0 tons/acre or 12.3 cords/acre.

Special Conditions:

1. Oak Wilt Restriction: No harvest activities or road construction allowed April 15 – July 15.
2. All pine products cut between May 1 and September 1 must be removed from the sale area within three weeks from time of cutting. Pine products cut during the remainder of the year must be removed prior to May 1 of each year.
3. Zone A: Harvesting in this area is optional, and if done must occur under frozen-ground conditions with no stump pulling or other soil disturbances.
4. Harvest operations limited to daytime hours during summer months to reduce impact to nearby campsites.
5. Cutting must be concurrent for all species.
6. Do not cut, knock down or utilize any dead trees unless they pose an operational safety risk.
7. Slash within 50 feet of all roads and trails must be lopped and/or scattered to lie within two feet of the ground and be pulled back 10' behind the tree line concurrently with cutting.
8. The snowmobile trail must be kept free of debris, snow covered in winter, and left in good condition for vehicle traffic at all times.
9. Roads and landings must be approved by the forester in advance of use.