

**WISCONSIN
DEPARTMENT OF NATURAL RESOURCES
TIMBER SALE
TRACT 03-21 MAX LAKE
T41N R6E SECTION 23
HARVEST ACRES - 95**

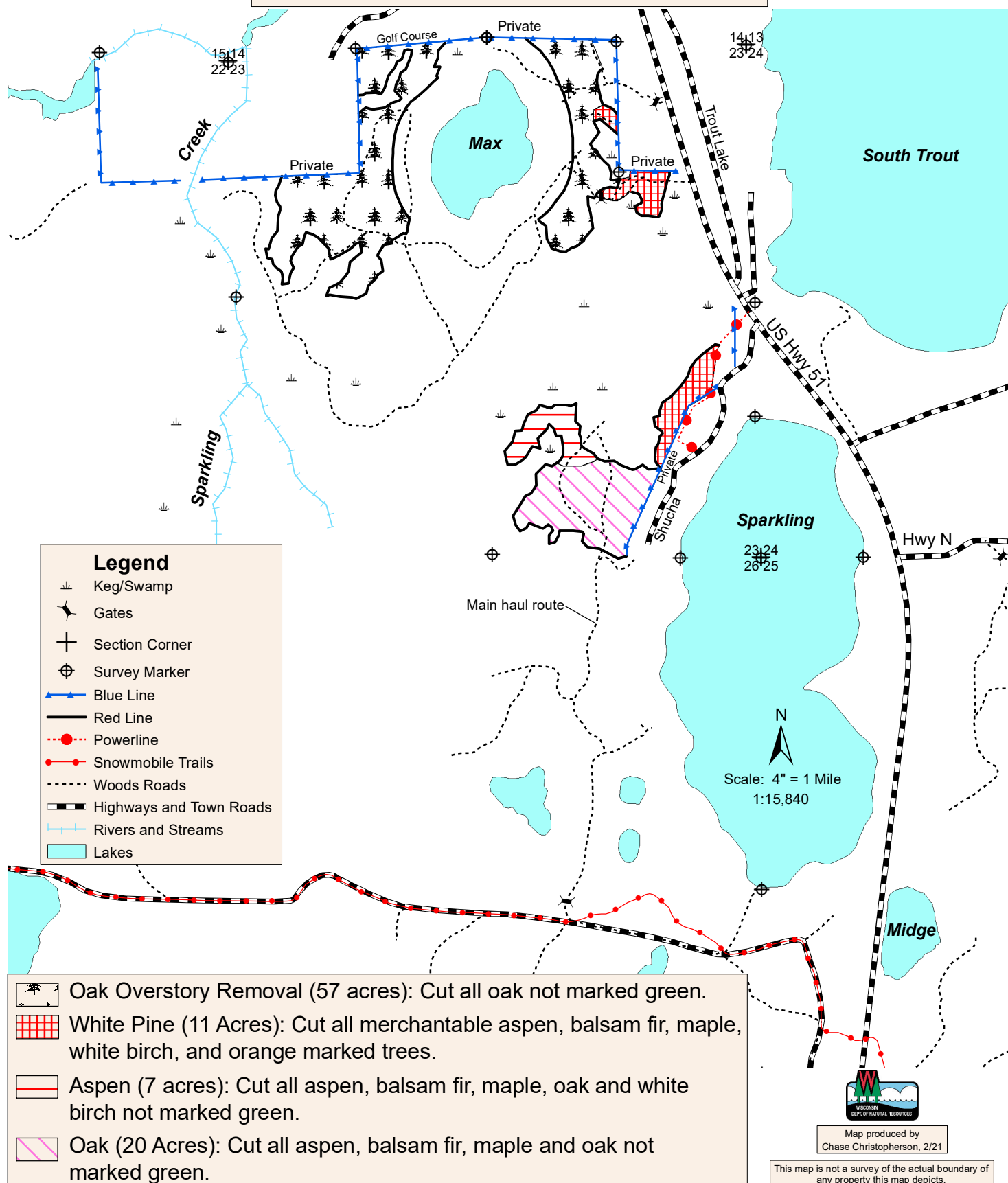

NH-ALSF TRACT NO. 3-21

Max Lake

Vilas County

Town 41 North, Range 6 East

Section 23 – NWNE, SWNE, SENE, NENW, SWNW, SENW, GL 1, NWSE, SWSE, GL 2

15% of the total sale bid value will be required for performance bond.

The cutting area is approximately 95 acres.

The contract period is 3 years.

All trees that will yield one or more 100-inch sticks to the minimum top diameter will be cut and utilized.

Whole Tree harvest is not allowed.

ESTIMATED VOLUME (TONS)

MINIMUM TOP DIAMETER

<u>SPECIES</u>	<u>4"</u>
Balsam Fir ¹	170
Aspen	420
Red Oak	1800
Mixed Hardwoods ²	490

ESTIMATED VOLUME (MBF)

Red Oak 245

TOTAL MINIMUM BID VALUE: \$ 83,482.00

1 Balsam Fir consists of 73% balsam fir, 22% white pine and 5% red pine. Wt. Avg. is 2.126 tons/cord.

2 Mixed Hardwood consists of 60% red maple, 32% hard maple and 8% white birch. Wt. Avg. is 2.372 tons/cord.

Note: Total sale volume equates to 45.8 tons/acre or 17.5 cords/acre.

Special Conditions:

1. Cutting must be concurrent for all species to be harvested. Do not cut, knock down or utilize any dead trees.
2. Trees may not be felled into wetland/swamp areas.
3. No harvesting, skidding or road construction from April 15th to July 15th due to the risk of oak wilt.
4. Trucking on Shucha Road should be avoided.
5. Snowmobile trails must be kept free of debris and left in good condition for vehicle traffic at all times.
6. The snowmobile trail aka "Camp Lake Road" must be repaired to pre-harvest conditions.
7. Note: The main access road to the north end of the timber sale has issues with periodic flooding. A reroute is planned to be constructed by the State by the end of 2021. Logging operations before that time may be interrupted.