

**WISCONSIN  
DEPARTMENT OF NATURAL RESOURCES  
TIMBER SALE  
TRACT 9-21 SOUTH KATHAN ASPEN  
T-39-N R-9-E SECTION 22, 23, 26 & 27  
HARVEST ACRES - 141**

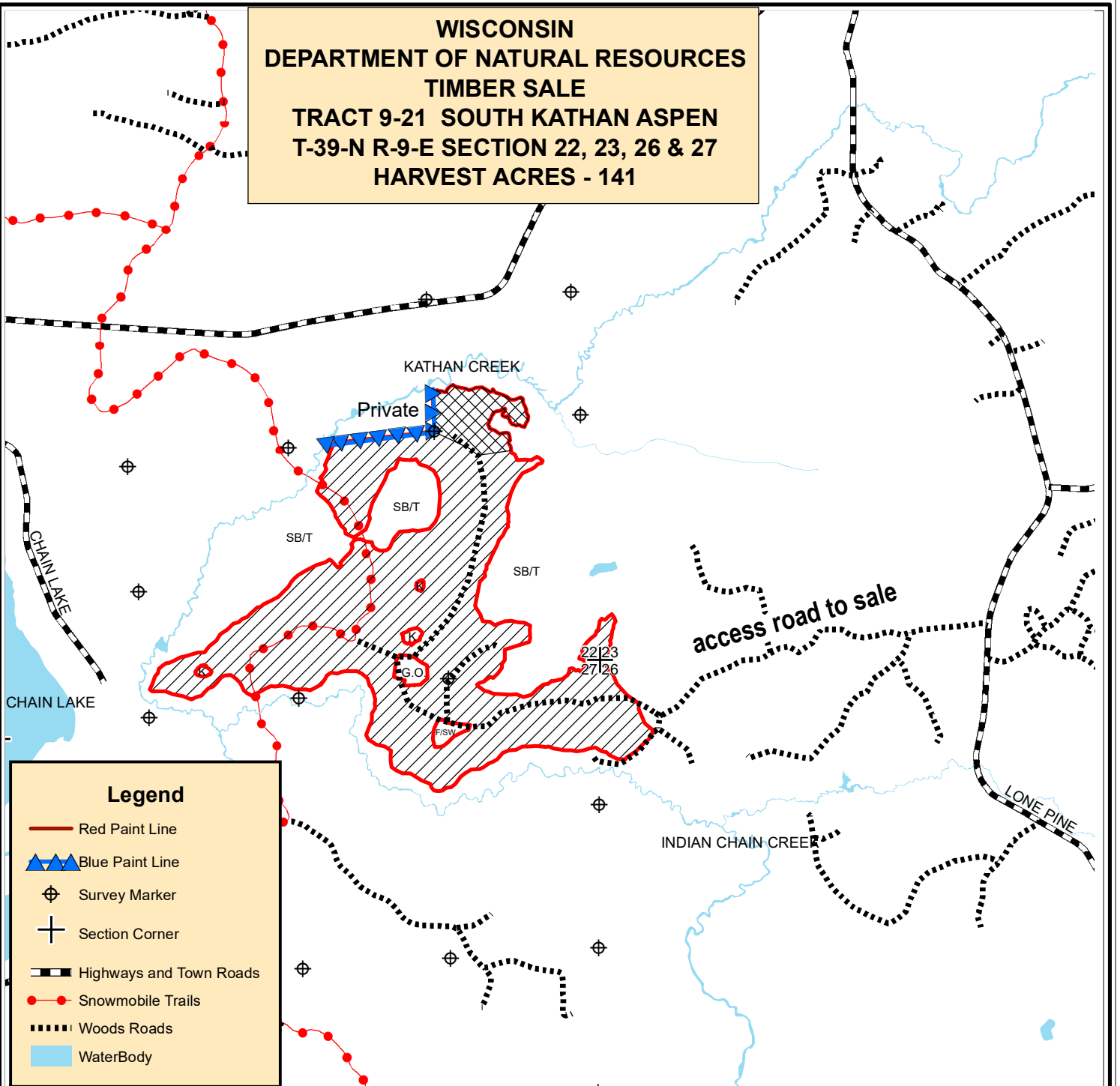

**Legend**

- Red Paint Line
- ▲ Blue Paint Line
- ⊕ Survey Marker
- ⊕ Section Corner
- Highways and Town Roads
- Snowmobile Trails
- Woods Roads
- WaterBody



Aspen Harvest Area (137 Acres): Cut all aspen and maple greater than 1 inch in diameter and all orange marked trees. Cut all balsam fir, birch, and spruce with two or more merchantable sticks.



Pine Plantation Area (4 Acres): Cut same as above

All stands are within  
Mgmt. Area 6: Oneida Sandy Plains-  
Forest Production

Scale: 4" = 1 Mile



Map produced by  
Jon Leith, 5/21

This map is not a survey  
of the actual boundary of  
any property this map depicts.

Do not cut oak, cherry, unmarked pine or trees painted with green paint.  
Leave 1-2 patches of non-merchantable balsam fir per acre where possible  
not to exceed 60 foot diameter.

NH-ALSF TRACT 9-21

South Kathan Aspen

Oneida County

Town 39N, Range 9E (Town of Sugar Camp)

Section 22 – SE1/4, SENE

Section 23 – SWSW

Section 26 – NWNW

Section 27 – NENE, NWNE

No bid bond required.

Performance bond needs to be 15% or \$1000.00 whichever is greater.

The cutting area is approximately 141 acres.

The contract period is 3 years.

All trees that will yield one or more 100-inch sticks to a 4-inch top diameter will be cut and utilized.

---

ESTIMATED VOLUME (TONS)

<u>SPECIES</u>	Minimum Top Diameter <u>4"</u>
Red Pine <sup>1</sup>	280
Balsam Fir	660
Aspen	2200
Mixed Hardwood <sup>2</sup>	660

**Total Minimum Bid Value    \$ 37,926.00**

---

Red pine<sup>1</sup> - Volume consists of 44% spruce, 36% red pine, 20% white pine with approximately 2 MBF of spruce potential sawlogs, – 6 MBF of red pine potential sawlogs, and 1 MBF of white pine potential sawlogs. WCF = 2.11t/cd

MX<sup>2</sup> - Volume consists of 87% red maple, 13% white birch with approximately 1 MBF as potential sawlogs WCF = 2.291t/cd

Note: Sale volume equates to 27 tons/acre or approximately 13 cords/acre.

Special Conditions:

1. Cutting must be concurrent for all species to be harvested.
2. No tops or slash allowed across any blue line, red line or within any wetland/keg areas. Slash must be lopped and scattered to lie within 2 feet of the ground and pulled back into the sale a minimum of 10 feet from wetlands, blue lines, and snowmobile trails.
3. Do not knock down or utilize any dead standing snags unless they pose an operational safety risk.
4. Soil rutting and damage to residual trees will NOT be tolerated.
5. If the contract is to be worked on during multiple time periods a mid-contract "pull-off" inspection meeting will be required. One week notice shall be given by the contractor prior to moving equipment off-site. during the "pull-off" inspection, provisions needing attention will be documented. The contractor at that time can decide to remedy them before pulling equipment off or rectify them when moving back onto the site. If the latter is chosen, documented items shall be addressed before harvesting can continue.
6. No new roads or landings without prior approval from sale administrator.
7. All pine products cut between May 1 and September 1 must be removed from the sale area within three weeks from time of cutting. Pine products cut during the remainder of the year must be removed prior to May 1 of each year to mitigate Pine Bark Beetle issues.
8. All existing roads will be left in as good or better condition at completion and remain passable at all times.
9. Landings will be cleaned free of debris upon completion of hauling.