

**WISCONSIN
DEPARTMENT OF NATURAL RESOURCES
TIMBER SALE
TRACT 29-19 CALL ME MAMIE
T39N R8E SECTION 4
T40N R8E SECTION 33
HARVEST ACRES - 70**

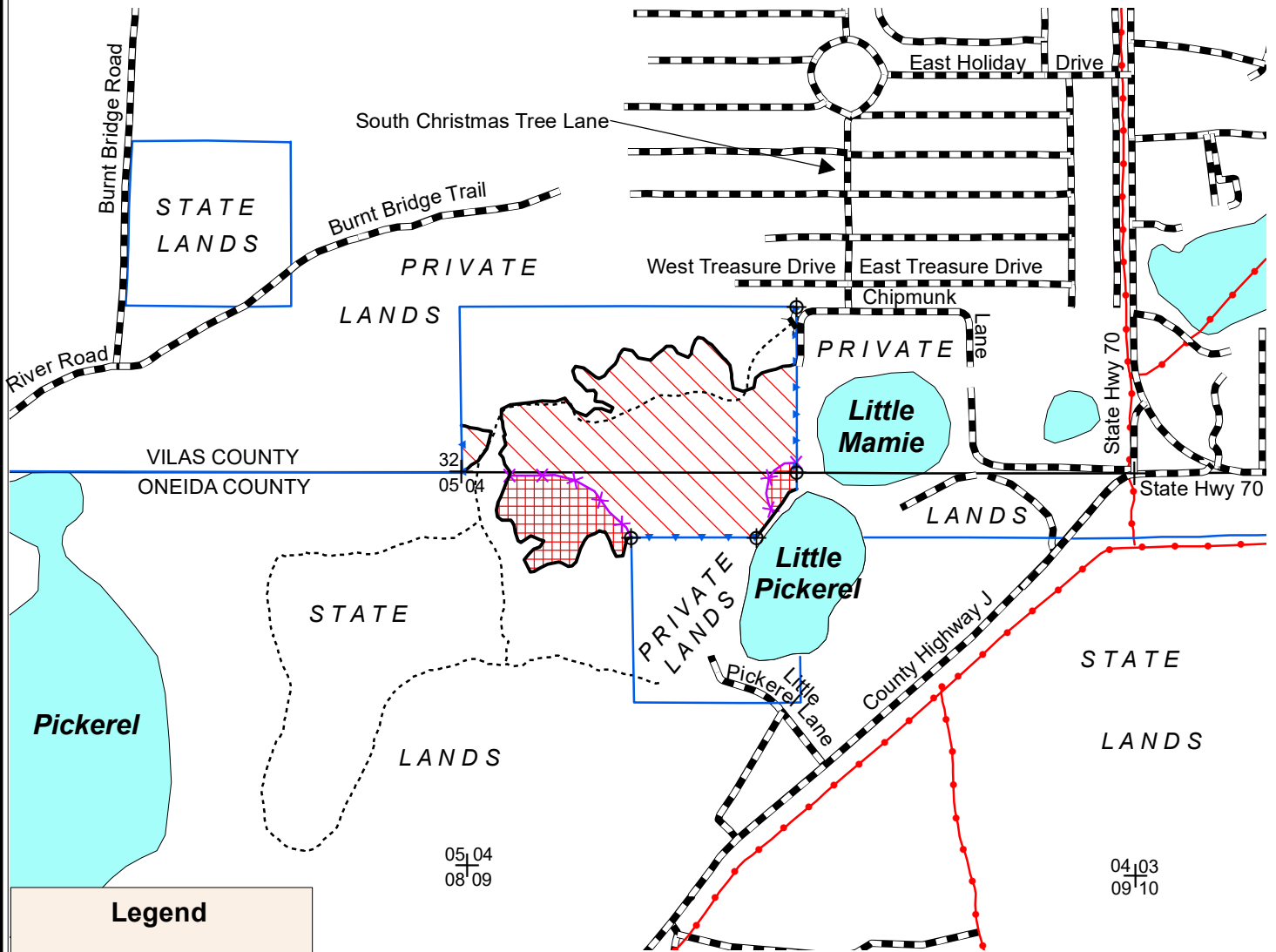

Legend

- Red Line
- Purple Line
- Property Boundary (Blue-Marked)
- Property Boundary (Unmarked)
- Section Corner
- Survey Marker
- Gates
- Woods Roads
- Snowmobile Trails
- Highways and Town Roads
- Lakes

- Pine Thinning Area (58 acres): Cut all trees marked with orange paint, as well as all aspen, birch, maple, jack pine, balsam fir, and oak with one or merchantable sticks of timber.
- ZONE A (12 Acres): Same harvest prescription as above. Purple Paint Line separates Zone A from Pine Thinning Area.

Oak Wilt Restriction: All harvest activities prohibited between April 15th and July 15th in ZONE A.

DO NOT CUT trees marked with green paint.

N
Scale: 4" = 1 Mile
1:15,840



Map produced by
Ryan Brown &
Jill Nemeec, 06/19

This map is not a survey of the actual boundary of any property this map depicts.

NH-ALSF TRACT NO. 29-19

Call-me-Mamie

Vilas County & Oneida County

Township 40 N Range 8 East

Section 33 – SESW, SWSW

Township 39 N Range 8 East

Section 04 – FR NW1/4, NWSW

No bid bond required.

Required performance bond is 15% of the total sale bid value or \$1,000.00, whichever is greater.

The cutting area is approximately 70 acres.

The contract period is 3 years.

All trees that will yield one or more 100-inch sticks to the minimum 4” top diameter will be cut and utilized.

Biomass/whole tree harvest is not allowed.

<u>SPECIES</u>	<u>ESTIMATED VOLUME (TONS)</u>	
	<u>4”</u>	<u>Advertised Price</u>
		<u>Per Unit</u>
White Pine ¹	760	\$ 13.90
Red Pine ²	470	\$21.70
Mixed Hardwood ³	530	\$ 11.30
<u>Total Minimum Bid Value</u>		<u>\$ 26, 752.00</u>

Utilized NHAL Base Stumpage Rates.

1: Included within this volume is approximately 35 MBF of white pine sawlog sized material and 90 tons of Fir. (weight conversion 2.1 tons/cord).

2: Included within this volume is approximately 40 MBF of red pine sawlog sized material and 10 tons of jack pine. (weight conversion 2.25 tons/cord).

3: Approximately 27% aspen, 7% white birch, 51% red oak, 15% red maple. Included within this volume is approximately 8 MBF of MX sawlog sized material. (weight conversion 2.52 tons/cord).

Total sale volume equates to approximately 25 tons/acre or 11 cords/acre.

Special Conditions

1. Dry or Frozen ground restriction throughout sale area. DNR sale administrator will determine soil conditions at request of start up and if harvest activity can commence.
2. **Zone A - SEASONAL OAK WILT RESTRICTION:** No cutting or skidding allowed between April 15 – July 15.
3. Cutting must be concurrent for all species to be harvested including designated non-merchantable trees.
4. No tops or slash allowed across any blue line or red line. Slash must be lopped and scattered to within 2 feet of the ground and pulled back into the sale area a minimum of 10 feet from blue property lines and public roads.
5. Do not cut, knock down or utilize any dead standing snags unless they pose an operational safety risk.
6. Soil rutting and damage to residual trees will NOT be tolerated.
7. From May 1 to September 1, removal of cut pine products from all sale areas is required within three weeks. Pine products cut during the remainder of the year must be removed prior to June 1 each year.
8. Contractor will be responsible for securing access over private driveway to the sale area.
9. Established aspen, birch, pine and oak regeneration may not be run over except where operational pass is required to harvest designated trees.