

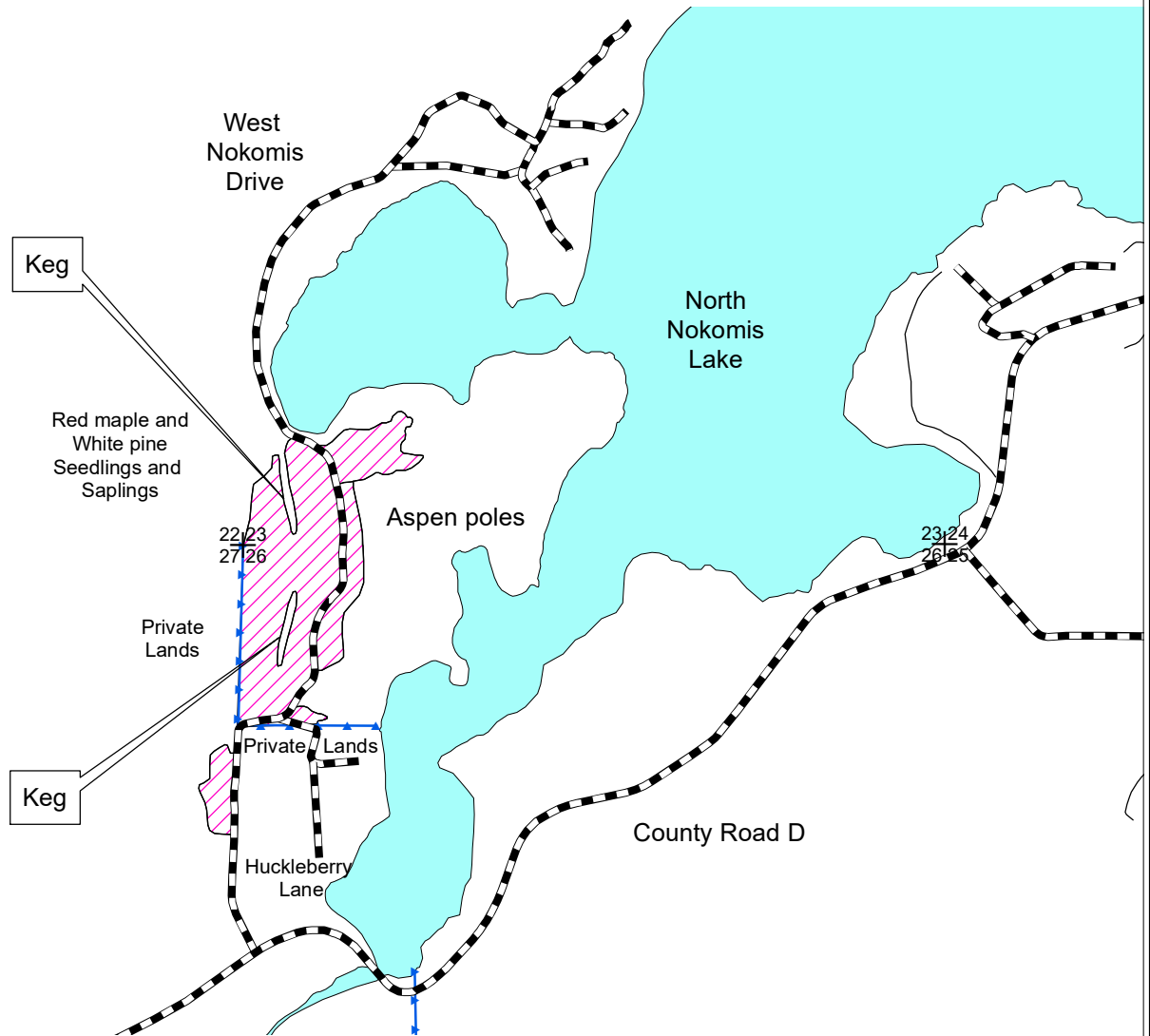

**WISCONSIN
DEPARTMENT OF NATURAL RESOURCES
TIMBER SALE
TRACT 19-20 Huckleberry Pine
T39N R8E SECTION 23, 26, 27
HARVEST ACRES - 39**



Legend

- + Section Corner
- Highways and Town Roads
- Blue Line
- Lakes

 Red Pine Plantation (39 Acres): Cut all trees marked with orange paint.

***Oak Wilt Restriction:
All harvest activities prohibited
between April 15th and July 15th.***



Scale: 4" = 1 Mile
1:15,840



Map produced by
Sean Davison, 03/20

This map is not a survey of the actual
boundary of any property this map depicts.

NH-ALSF TRACT NO. 19-20

Huckleberry Pine

Oneida County

Township 39N Range 8 East:

Section 23 – Gov Lot 5

Section 26 – Gov Lot 5

Section 27 – SENE

No bid bond required.

15% of the total sale bid value will be required for performance bond.

The cutting area is approximately 39 acres.

The contract period is 3 years.

Cut all trees marked in orange paint.

Whole tree biomass harvest is NOT allowed.

ESTIMATED VOLUME (TONS)

<u>SPECIES</u>	<u>MINIMUM TOP DIAMETER</u> <u>4"</u>	<u>Advertised Price</u>
		<u>Per Unit</u>
Red Pine ¹	875	\$ 25.80
Mixed Hardwood ²	50	\$ 13.00

Total Minimum Bid Value: \$ 23,225.00

PR¹: Approximately 85% Red Pine, 15% White Pine. Volume includes approximately 64 MBF Red Pine and 8 MBF White Pine of potential saw logs (PR Wt. Ave. conversion 2.22 tons/cord)

MX²: Approximately 84% Red Maple, 16% Aspen. Volume includes approximately 2 MBF Red Maple, (MX Wt. Ave. conversion 2.27 tons/cord).

Utilized NHAL Base Stumpage Rates.

Total sale volume equates to 23.8 tons/acre or 11 cords/acre to a 4-inch top.

Special Conditions:

1. Restrictions: Oak Wilt restriction (no harvesting or skidding from April 15 to July 15 due to oak wilt concerns). Harvest under sufficiently dry or frozen-ground conditions. Contractor must adhere to Timber Sale Contract rutting standards.
2. Cutting must be concurrent for all species to be harvested.
3. No tops or slash allowed across any blue line, red line or within any wetland/keg areas. Slash must be lopped and scattered to within 2 feet of the ground and pulled back into the sale area a minimum of 10 feet from wetlands, blue property lines and public roads.
4. Do not cut, knock down or utilize any dead standing snags unless they pose an operational safety risk.
5. Soil rutting and damage to residual trees will NOT be tolerated.
6. If the contract is to be worked on during multiple time periods a mid-contract "pull-off" inspection meeting will be required. One-week notice shall be given by the contractor prior to moving equipment off-site. During the "pull-off" inspection provisions needing attention will be documented. The contractor can decide to remedy issues before pulling off or rectify them when moving back onto the site. If the latter is chosen documented items shall be addressed before harvesting can continue.
7. No new roads or landings without prior approval from sale administrator.
8. From May 15 to September 1, removal of cut pine product from all sale areas is required within three weeks. Pine products cut during the remainder of the year must be removed by June 1 each year.
9. Existing roads will be left in as good or better conditions and remain passable at all times.