

**WISCONSIN
DEPARTMENT OF NATURAL RESOURCES
TIMBER SALE
TRACT 14-20 RIVER ROAD REVISITED
T38N R7E SECTIONS 1 & 2
HARVEST ACRES - 125**

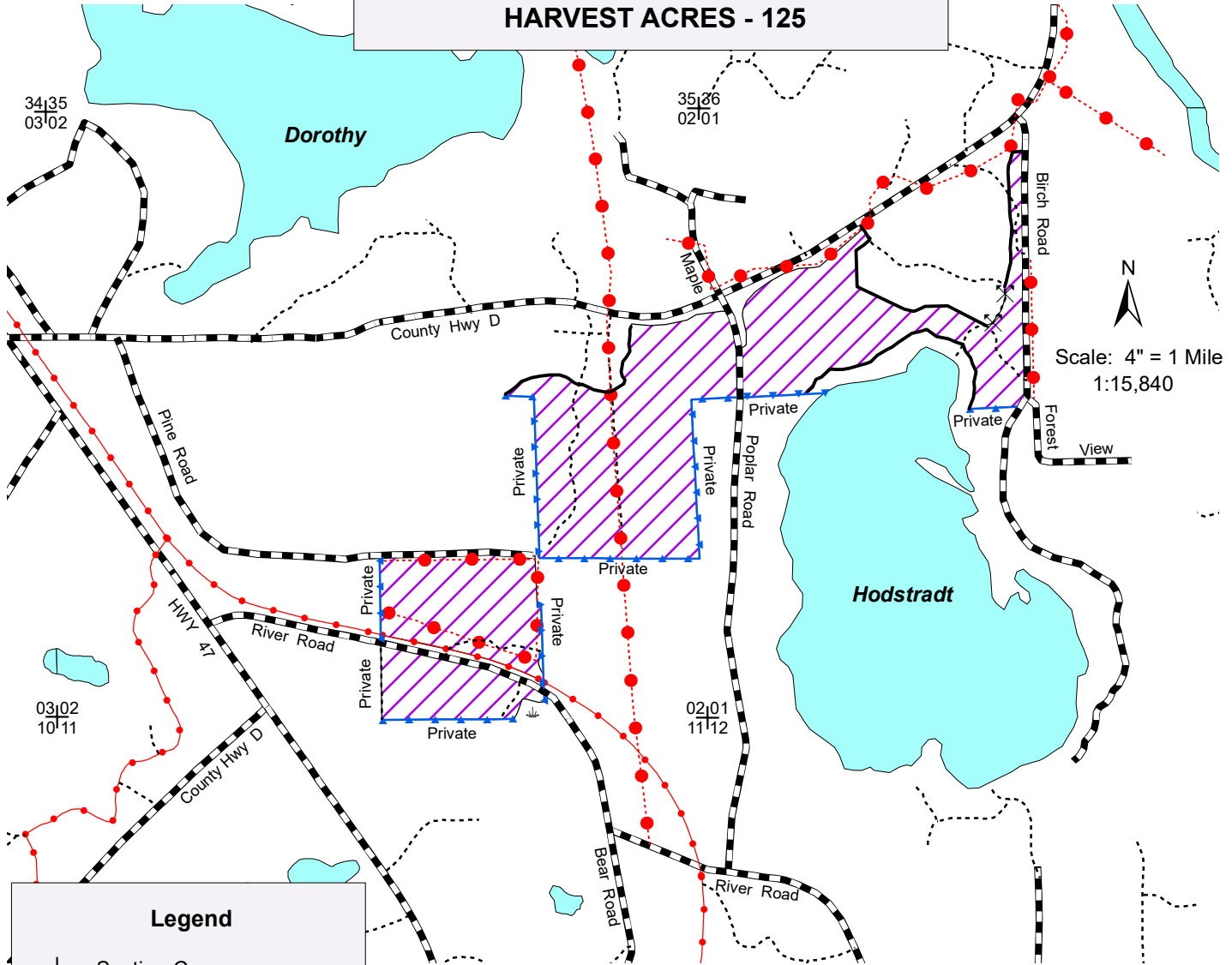

N
Scale: 4" = 1 Mile
1:15,840
Forest View

Legend

- ⊕ Section Corner
- ⊗ Berms
- ⊕ Keg
- Red Paint Line
- Blue Paint Line
- ⋯ Powerline
- ⋯ Woods Roads
- ⋯ Snowmobile Trails
- ▬ Highways and Town Roads
- ▭ Lakes

Main Sale Area (125 Acres): Cut all aspen, white birch, maple, jack pine and oak. Cut all orange marked red and white pine. Cut all 1-5 inch maple and aspen.

Note: Do NOT cut trees marked with green paint.
SEASONAL RESTRICTION: Harvesting, skidding and road building only allowed from July 15 - April 15, due to oak wilt considerations.

OPERATIONAL RESTRICTION: Harvesting and skidding only allowed from 6 a.m. - 10 p.m to minimize noise concerns with residents and recreationalists.

All stands are within Mgmt Area 6
 Oneida Sandy Plains - Forest Production

Map produced by
 Jim Wetterau, 2/20
 This map is not a survey of the actual boundary of any property this map depicts.

NH-ALSF TRACT 14-20
River Road Revisited

Oneida County

Town 38 North, Range 7 East

Section 1 – GL 3 & 7; NENW; SWNW

Town 38 North, Range 7 East

Section 2 – SENE; NESE; PT SWSE

No bid bond required.

15% of the total sale bid value will be required as performance bond.

The cutting area is approximately 125 acres.

The contract period is 3 years.

All trees that will yield one or more 100-inch sticks to the minimum top diameter chosen by the bidder will be cut and utilized.

ESTIMATED VOLUME (TONS)

MINIMUM TOP DIAMETER

<u>SPECIES</u>	<u>4"</u>	<u>Advertised Price</u> <u>Per Unit</u>
White Pine ¹	215	\$ 12.60
Red Pine ²	185	\$ 21.70
Aspen	4500	\$ 14.70
Red Oak ³	2090	\$ 23.80
Mx. Hardwood ⁴	1020	\$ 12.60

Total Minimum Bid Value \$ 135,467.50

¹Volume includes 50% white pine and 50% jack pine. It also includes 11 MBF of white pine potential logs. (Wt. Ave 2.113 tons/cord)

²Volume includes 21 MBF of potential logs.

³Volume includes 62 MBF of potential logs.

⁴Volume includes 74% red maple, 18% sugar maple and 8% white birch. (Wt. Ave. 2.335 tons/cord)
The total sale volume equates to approximately 63.6 tons/acre or 26.9 cords/acre.

Special Conditions:

1. Do not harvest or operate machinery within 15 feet of any ephemeral pond. No machinery allowed within 100 feet of Hodstradt Lake. All other low ground areas to be operated in during dry or frozen ground conditions to prevent rutting. Cutting must be concurrent for all species to be harvested.
2. Biomass harvesting is not allowed. Do not cut, knock down, or utilize any dead standing snags. All harvesting, skidding and road building activity will only be allowed between July 15 and April 15. All harvesting and skidding activity will only be allowed from 6 a.m. - 10 p.m.
3. No tops or slash allowed across any blue line, red line, powerline, highway right-of-way or within any wetland. Slash within 50 feet of the town roads, highways, snowmobile trail and private lands must be lopped and scattered within 2 feet of the ground and pulled back into the sale area at least 10 feet from the edge of the road right-of-way, the snowmobile trail and adjacent private lands.
4. Snowmobile trail must be kept free of debris, snow covered in winter, and left in good condition for vehicle traffic always. All trails must be repaired to pre-harvest conditions before the start of each snow season. All landings and any new woods roads must be approved prior to sale start up. All existing woods roads and the snowmobile trail must be restored to pre-harvest condition upon sale completion.
5. All pine products cut between May 1 and September 1 must be removed from the sale area within three weeks from time of cutting. Pine products cut during the remainder of the year must be removed prior to May 1 of each year.
6. If the contract is to be worked on during multiple time periods a mid-contract "pull-off" inspection meeting will be required. One-week notice shall be given by the contractor prior to moving equipment off-site. During the "pull-off" inspection, provisions needing attention will be documented. The contractor at that time can decide to remedy them before pulling equipment off or rectify them when moving back onto the site. If the latter is chosen, documented items shall be addressed before harvesting can continue.

