

**WISCONSIN
DEPARTMENT OF NATURAL RESOURCES
TIMBER SALE
WOODBORO WILDLIFE AREA
SALE # 986 East Roe
T36N R7E SECTION 34
HARVEST ACRES - 38**

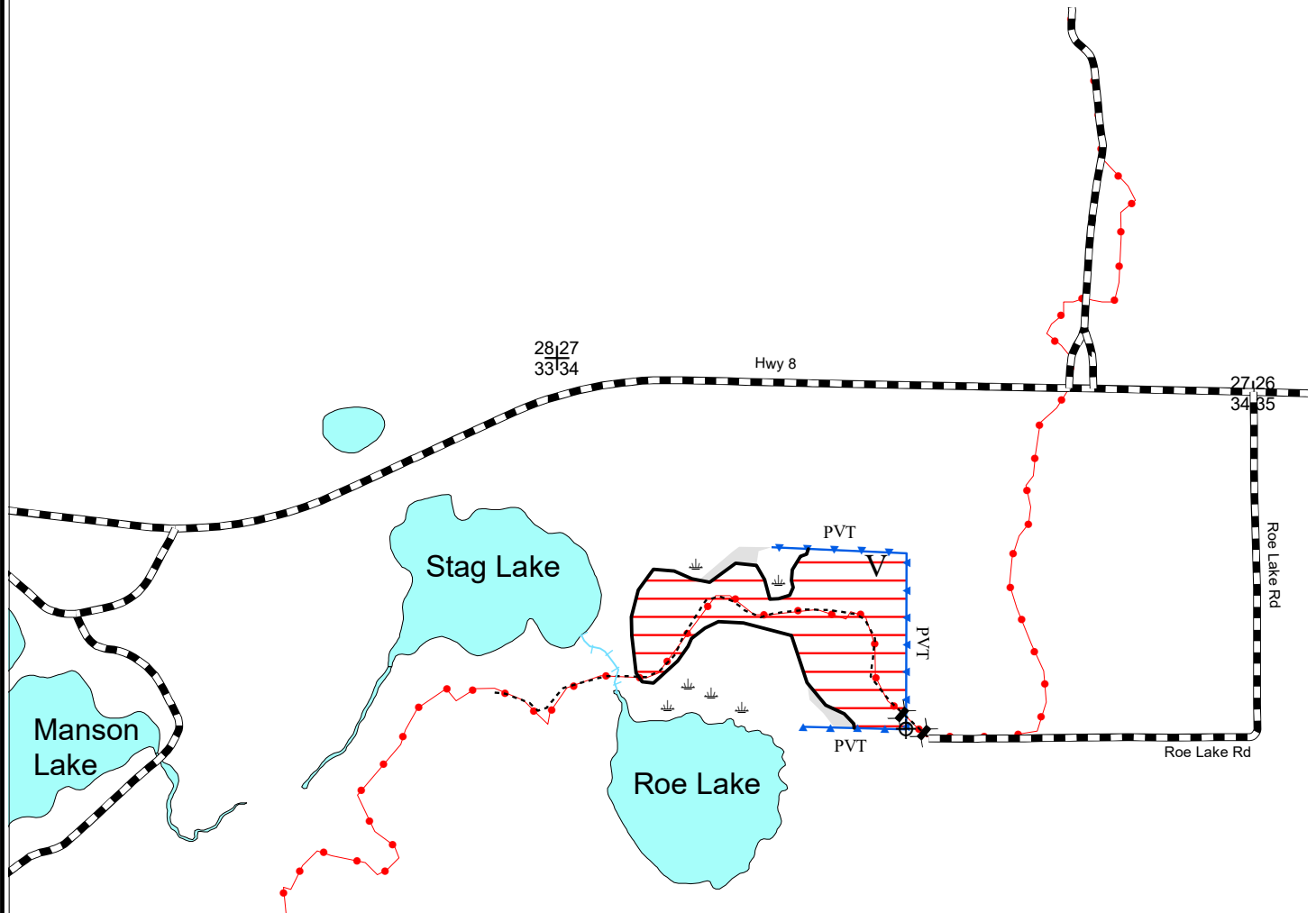

Legend

- Red Paint Line
- Blue Paint Line
- Highways and Town Roads
- Snowmobile Trails
- Woods Roads
- Gate
- PVT Private Ownership
- Section Corner
- Survey Marker
- Green Tree Retention
- Lakes
- Stream
- V Vernal Pond
- Wetland or Forested Wetland



Harvest Area (38 acres): Cut all aspen, red maple, balsam fir, and orange marked oak greater than 1 inch. If harvesting whole tree, 1 in 10 tops above the standard 4 inch top must be left on site and evenly distributed throughout the harvest area.

Note: Seasonal Restriction - No Harvest activity allowed between April 15 and July 15 in order to prevent establishment of oak wilt.



Scale: 4" = 1 Mile
1:15,840



Map produced by
Ricky Keller, 3/20

This map is not a survey of the actual boundary of any property this map depicts.

Woodboro Lakes Wildlife Area TRACT 986-20
East Roe

Oneida County: Town 36 North, Range 7 East:
Section 34 – SWNW and SENW

No bid bond required.

15% of the total sale bid value or \$1,000.00, whichever is greater, will be required for performance bond.

The sale area is approximately 41 acres.

The cutting area is approximately 38 acres.

The contract period is 3 years.

All trees that will yield one or more 100-inch sticks to a minimum top diameter of 4" will be cut and utilized.

Whole tree harvest is allowed.

ESTIMATED VOLUME (TONS)
MINIMUM TOP DIAMETER

<u>SPECIES</u>	<u>Whole Tree*</u>	<u>4" (TONS)</u>
Balsam Fir	100	80
Aspen	2,850	2,250
Mx. Hardwood ¹	300	240
Total Minimum Bid Value		\$ 20,286.00

¹ Volume includes approximately 92% red maple and 8% red oak (2.313 tons/cord)

Special Conditions

1. Access to this sale crosses private property between Roe Lake Rd. and State land. This segment of road must be in equal to or better condition after the sale than its pre-existing condition. This may require gravel application.
2. If harvesting occurs while the snowmobile trail is open, signs must be placed on both ends of the harvest area to notify users of the active timber harvest. Snowmobile trail must be kept snow covered if harvesting while trail is open.
3. Do not cut any trees within 15 feet of any ephemeral pond. All other areas are to be operated in during dry or frozen ground conditions to prevent rutting. Cutting must be concurrent for all species to be harvested.
4. Do not cut any snags unless they pose a safety hazard.
5. No slash allowed across any blue line, red line, powerline, or within any wetland. Slash must be lopped and scattered to lay within 2 feet of the ground and pulled back into the sale area at least 10 feet away from the adjacent private lands and public roads.
6. All landings and any new woods roads must be approved prior to sale start up.
7. If the contract is to be worked on during multiple time periods, a mid-contract "pull-off" inspection meeting will be required. One-week notice shall be given by the contractor prior to moving equipment off site. During the "pull-off" inspection, provisions needing attention will be documented. The contractor at that time can decide to remedy them before pulling equipment off or rectify them when moving back onto the site. If the latter is chosen, documented items shall be addressed before harvesting can continue.
8. No overnight camping will be allowed on the property except in designated camping locations between September 1st and December 31st.