

**Wisconsin
Department of Natural Resources
Timber Sale
Tract 24-20 Grouse Road
T38N R7E Sec. 5 & 6 and T39N R7E Sec. 31
Harvest Acres - 136**

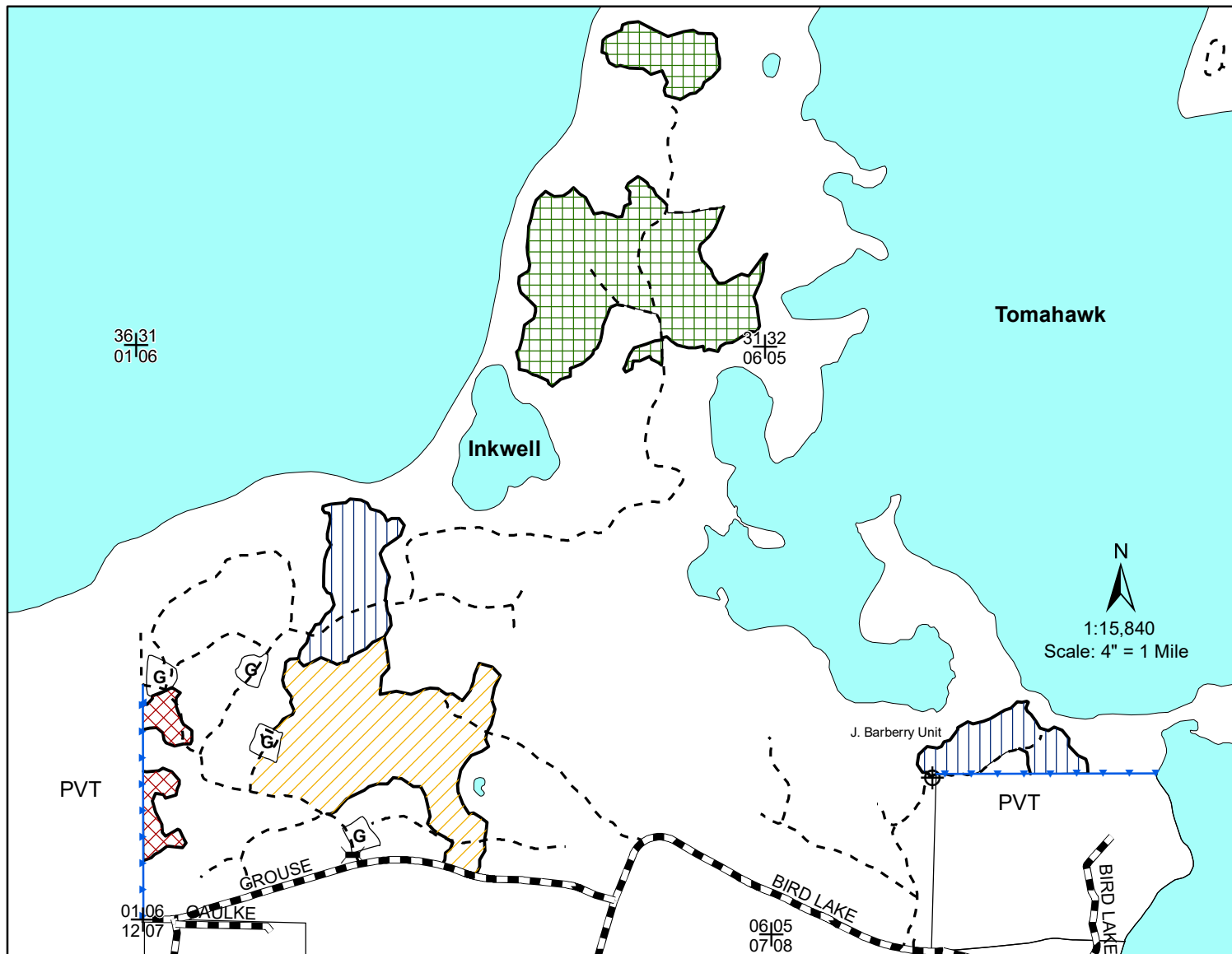

Legend

- Section Corner
- Gates
- Survey Marker
- Highways and Town Roads
- Woods Roads
- Blue Line
- Red Line
- Lakes
- Wildlife Opening

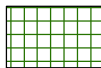

Oak Shelterwood Area (57 acres): Cut all merchantable trees except pine, hemlock, spruce, aspen, and those marked with green paint.

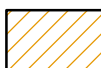

Aspen Area (46 Acres) cut all trees > 1" DBH except those marked with green paint.



Pine Thinning (6 Acres) cut all merchantable aspen and orange marked trees.



Oak Overstory Removal Area (27 Acres) cut all oak not marked with purple paint. Ignore green paint from previous sale.

**No harvesting will be allowed between April 15th
and July 15th due to oak wilt restrictions**

The entire sale lies within Management Area 6: Oneida Sandy Plains

****This map is not a survey of the actual boundary of any property this map depicts****



Map Produced by
Jordan Hunter 6/20

NHAL STATE FOREST TRACT NO. 24-20

Grouse Road

Oneida County

Town 38 North, Range 7 East (Town of Lake Tomahawk)

Section 5 – Govt. Lots 1 & 2

Section 6 – Govt. Lots 3, 4 & 5; SW1/4; W1/2SE1/4

Town 39 North, Range 7 East (Town of Woodruff)

Section 31 – Govt. Lots 1 & 2; SESE

No bid bond is required.

15% of the total sale bid value or \$1000.00, whichever is greater, will be required for performance bond.

The cutting area is approximately 136 acres.

The contract period is 3 years.

All trees that will yield one or more 100-inch sticks to the minimum 4" top diameter will be cut and utilized.

ESTIMATED VOLUME (TONS)
MINIMUM TOP DIAMETER

| <u>SPECIES</u> | <u>4"</u> |
|------------------------------|-----------|
| White Pine ¹ | 535 |
| Aspen | 2050 |
| Oak ² | 3380 |
| Mixed Hardwoods ³ | 1020 |

Total Minimum Bid Value: \$100,353.00

¹ Approximately 92% white pine, 4% red pine, and 4% balsam fir. Includes potential for 62 MBF white pine and 3 MBF red pine sawlogs. (Wt. conv. 2.106 tons/cord)

² Includes potential for 265 MBF of red oak sawlogs.

³ Approximately 61% red maple, 22% basswood, 10% hard maple, 6% white birch and <1% each of cherry and white ash. Includes potential for 14 MBF red maple sawlogs, 17 MBF basswood sawlogs, and 2 MBF hard maple sawlogs. (Wt. conv. 2.218 tons/cd)

Note: Total sale volume equates to 50.8 tons/acre or 20.8 cords/acre.

Special Conditions:

1. **Seasonal Restriction:** No cutting, skidding, or road building from April 15th to July 15th due to the risk of oak wilt.
2. All pine products cut between May 1 and September 1 must be removed from the sale area within three weeks from time of cutting. Pine products cut during the remainder of the year must be removed prior to May 1 of each year.
3. If equipment is cutting in the unit with J. Barberry and will be moved to another area of the sale, it must be washed prior to moving. This requirement can be mitigated by cutting this unit last and removing equipment from the sale.
4. Cutting must be concurrent for all species, including all 1-5" DBH trees where designated.
5. Do not cut, knock down or utilize any dead trees.
6. Slash within 50 feet of all roads and trails must be lopped and/or scattered to lie within two feet of the ground and be pulled back 10 feet behind the tree line concurrently with cutting.