

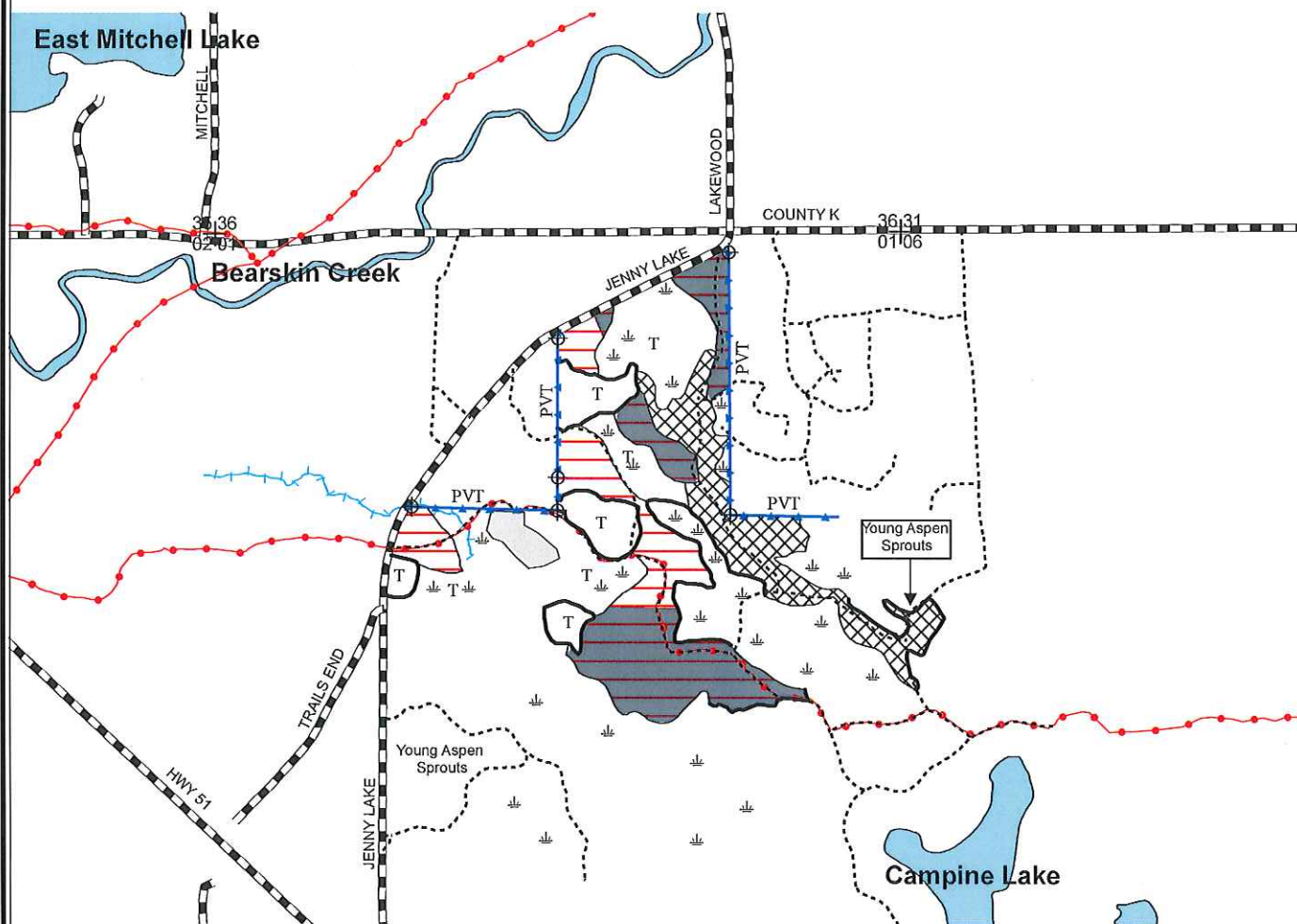



**WISCONSIN
DEPARTMENT OF NATURAL RESOURCES
TIMBER SALE
TRACT 983-19 TRAILS END III
T36N R6E SECTION 1
T36N R7E SECTION 6
HARVEST ACRES - 37**



Legend

- T Tamarack
- PVT Private Lands
- + Section Corner
- ⊕ Survey Marker
- ⌵ Keg/Swamp
- Blue Line
- Red Line
- Woods Trails
- Snowmobile Trails
- Highways and Town Roads
- Rivers and Streams
- Open Water
- GTR (3 acres)

-  Aspen Area (18 acres): Cut all aspen, balsam fir, tamarack and black spruce greater than 1 inch. If harvesting whole tree, 1 in 10 tops above the standard 4 inch top must be left on site and evenly distributed throughout the harvest area. Approximately 25% of the aspen trees in this area are wind-tipped.
-  Pine Plantation Area (19 acres): Cut out every row which has 3 diagonal orange slashes painted on trees within the row. Cut all other orange marked red pine, as well as all tamarack and black spruce greater than 1 inch. No pole or whole tree skidding allowed.
-  Harvested Area (30 acres) Aspen Sprouts: These areas were previously harvested and do not need to be entered.

N
Scale: 4" = 1 Mile
1:15,840



Map produced by
Ricky Keller, 3/19

This map is not a survey
of the actual boundary of
any property this map depicts.

WOODBORO LAKES TRACT NO. 983-19

Compartment 1 Stand #5 and 43

Trails End III Sale

Oneida County

Town 36 North Range 6 East

Section 1 – NWNE, S½NE, N½SE, SENW

Town 36 North Range 7 East

Section 6 – SWNW

The cutting area is approximately 37 acres.

The contract period is 2 years.

ESTIMATED VOLUME (TONS)

MINIMUM TOP DIAMETER

SPECIES	4"	ADVERTIZED	WHOLE	ADVERTIZED
		PRICE PER		PRICE PER
		UNIT 4"	TREE (WT)	UNIT (WT)
Red Pine	600	\$15.80/T		
Balsam Fir	160	\$8.60/T		
Aspen	570	\$11.50/T	OR 720T	\$9.10/T

Total Minimum Bid Value \$17,411.00

Special Conditions

1. Cutting must be concurrent for all species to be harvested.
2. If harvesting whole tree (aspen area only), 1 in 10 tops above the standard 4" top must be left on site and evenly distributed throughout the sale area.
3. No equipment may be operated within 15 feet of any wetland unless the ground is firm or frozen. All slash to be lopped and scattered to lie within two feet of the ground. No tops or slash allowed across any blue line, red line, or in any wetland.
4. Landings and any new road locations must be approved prior to construction.
5. If logging is done during the winter and the snowmobile trail is used, it must be kept open, level, free of debris, and snow covered. In addition, signs will need to be placed along the snowmobile trail. If logging is done during the remainder of the year the trail must be left in pre-sale condition prior to the snowmobile season.
6. All dead standing trees must be left standing unless they pose a safety hazard to the harvesting operation.
7. Decking of wood will not be permitted along the snowmobile trail during the winter.
8. All pine products cut between May 1 and September 1 must be removed from the sale area within three weeks from time of cutting. Pine products cut during the remainder of the year must be removed prior to May 1.