

**WISCONSIN
DEPARTMENT OF NATURAL RESOURCES
TIMBER SALE
TRACT 22-19 OVER YONDER ASPEN
T38N R7E SECTIONS 31, 32
HARVEST ACRES - 18**

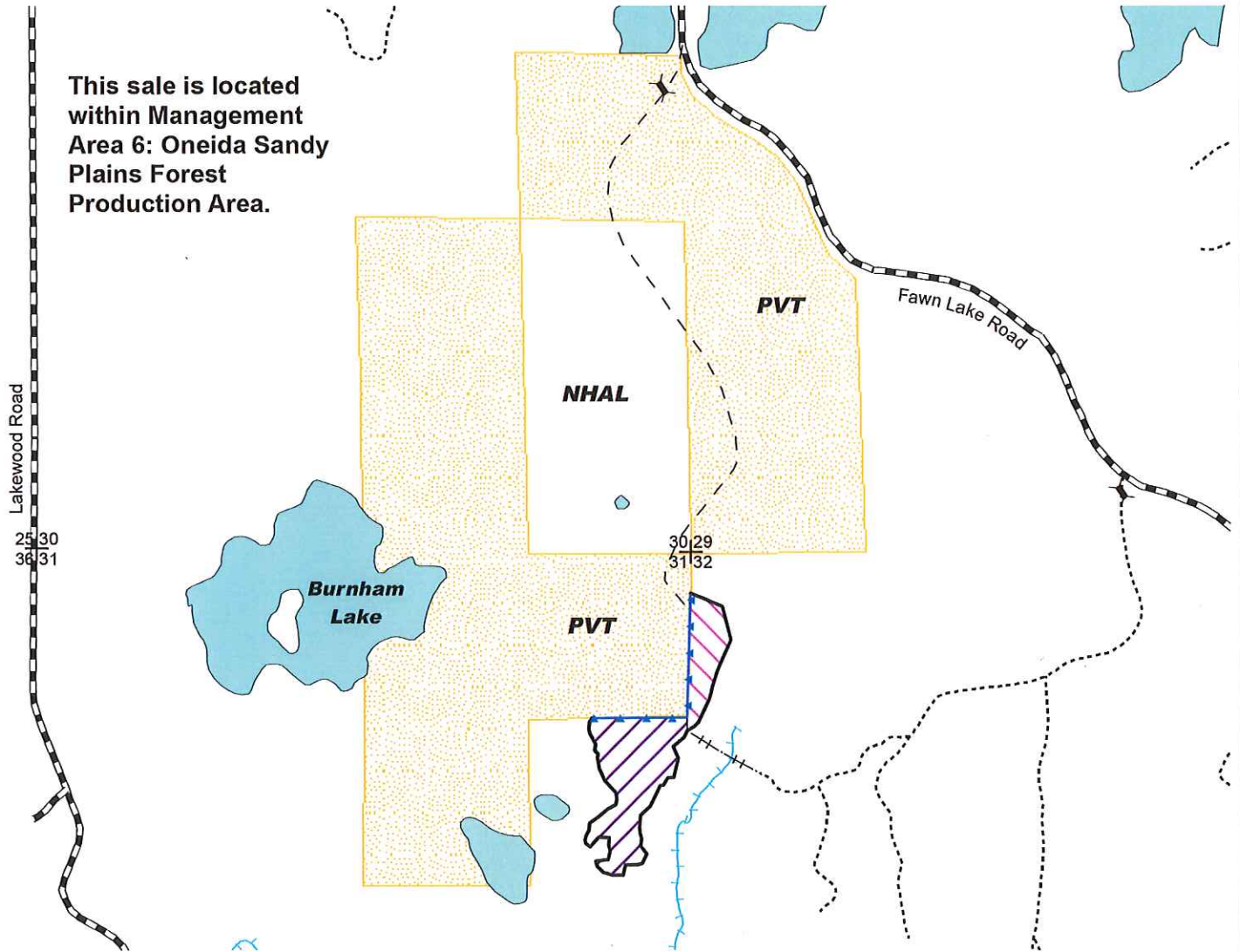

**This sale is located
within Management
Area 6: Oneida Sandy
Plains Forest
Production Area.**



**Scale: 4" = 1 Mile
1:15,840**

- Aspen-Pine Regeneration Area (13 Acres): Cut all aspen, white birch, maple and balsam fir 1 inch or greater in size.
- Maple Regeneration Area (5 Acres): Cut merchantable aspen, white birch, maple and balsam fir.

**Note: Do NOT cut trees marked with green paint.
Stream crossing ONLY under frozen ground conditions. Access
through private lands is contractor's responsibility.**

Legend

- Private Woods Road
- Gates
- Section Corner
- Proposed Wetland/Cedar Crossing
- Woods Roads
- Highways and Townroads
- Blue Line
- Red Line
- Stream
- Lakes & Open Water
- Private Land

Map produced by
Paul Steams & Jake Bonack, 03/21/19

This map is not a survey
of the actual boundary
of any property this maps depicts

NH-ALSF TRACT NO. 22-19
Over Yonder Aspen

Oneida County

Town 38 North, Range 7 East

Section 31- SENE

Section 32- NWNW

15% of the total sale bid value will be required for performance bond.

The cutting area is approximately 18 acres.

The contract period is 3 years.

All trees that will yield one or more 100-inch sticks to the minimum top diameter chosen by the bidder will be cut and utilized.

Biomass harvesting is approved.

ESTIMATED Weight (Tons)

MINIMUM TOP DIAMETER

<u>SPECIES</u>	<u>4"</u>	<u>Whole Tree</u>	<u>Advertised Price Per Unit</u>
Aspen	410	550	\$ 7.40
Fir	120	180	3.80
Mixed Hardwoods ¹	420	575	6.50

Total Minimum Sale Value \$ 8491.50

¹Approximately 34% White Birch, 66% Red Maple Conversion Factor: 2.32 tons/ cord
Total volume equates to 73 tons/ acre for whole tree volume or 53 tons/ acre to a 4" top

Special Conditions:

1. **The sale can be accessed through state lands (from the east) under frozen conditions using timber mats to cross a cedar swamp/ stream or the buyer may work with the private landowners to access the sale (from the north).**
2. The crossing will occur at a point that has been predetermined and using the stream crossing plan that was developed by a Best Managements Practices Forester (a copy of the stream crossing plan may be obtained from the timber sale administrator), or other approvable method (which would need to be approved by Department staff). All applicable permits will be filed by Department Staff and will need to be validated prior to the use of the crossing.
3. Slash must be lopped and/or scattered to lie within two feet of the ground and pulled back at least ten feet behind the tree line concurrent with cutting. No tops or slash allowed across any red line, blue line, or in any open swamp.
4. Landings and new road construction must be approved by forester prior to construction.
5. No harvest of dead trees (standing or downed) will be allowed.