

**WISCONSIN
DEPARTMENT OF NATURAL RESOURCES
TIMBER SALE
TRACT 14-19 McGINNIS
T42N R8E SECTIONS 21, 28
HARVEST ACRES - 169**

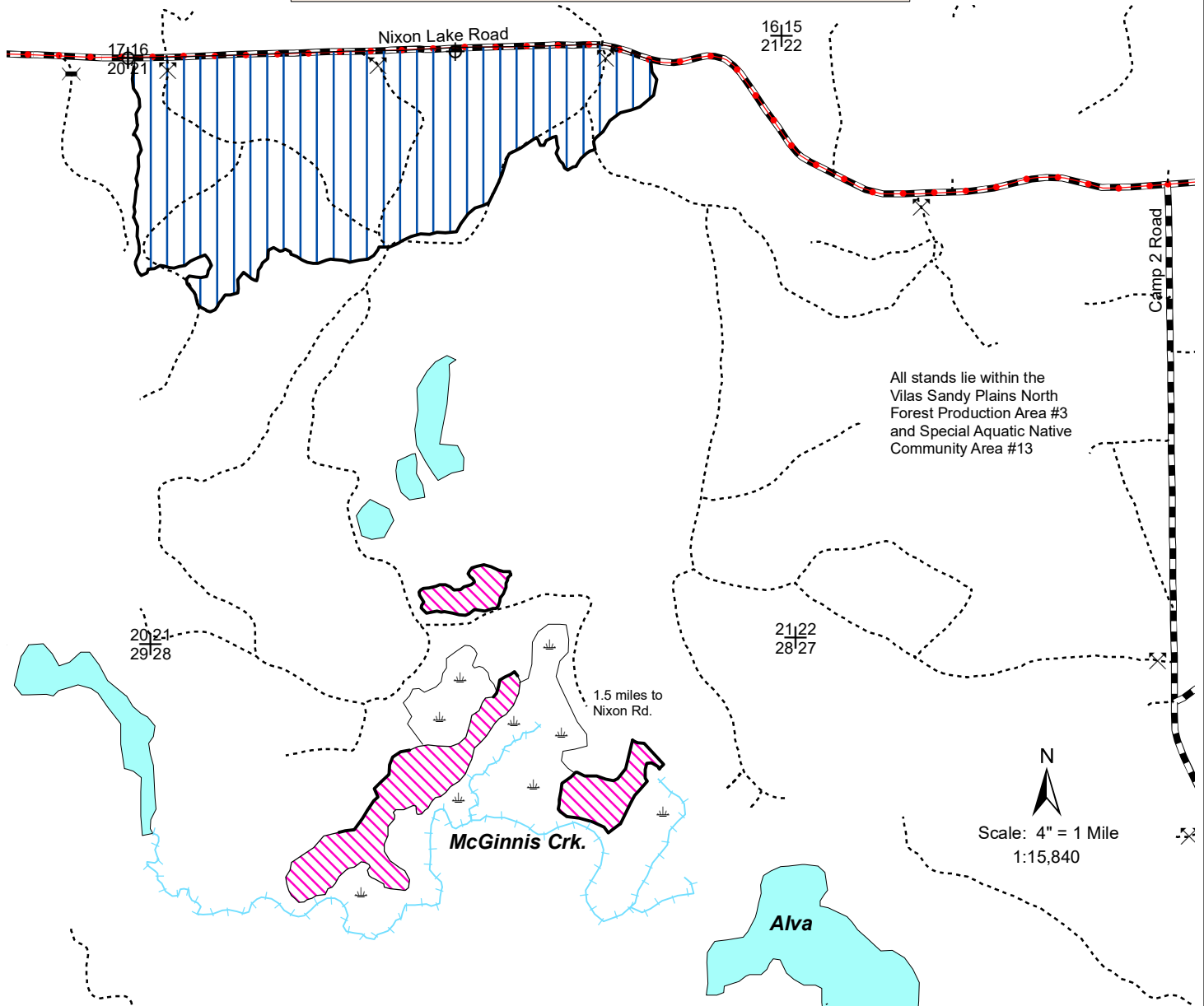

Legend

- Keg/Swamp
- Gates
- Berms
- Survey Marker
- Section Corner
- Stream
- Red Line
- Woods Roads
- Snowmobile Trails
- Highways and Town Roads
- Lakes



Main Sale Area (140 Acres): Cut all merchantable aspen, balsam fir, maple, white birch, and orange marked trees. Use caution to not damage forest regeneration.

No harvesting or skidding in Main Sale Area April 15 - July 15 due to the risk of Oak Wilt.



Aspen Mix (29 Acres): Cut all trees not marked green. Do not cut pine.

Note: Do NOT cut trees marked with green paint.



Map produced by
Chase Christopherson, 03/19

This map is not a survey of the actual boundary of any property this map depicts.

NH-ALSF TRACT NO. 14-19

McGinnis

Vilas County

Town 42 North, Range 8 East

Section 21 – NENE, NWNE, SWNE, NENW, NWNW,
SWNW, SENW, SESW, SWSE

Section 28 – NENE, NWNE, SWNE, NENW, SWNW, SENW

No bid bond is required.

15% of the total sale bid value will be required for performance bond.

The cutting area is approximately 169 acres.

The contract period is 3 years.

All trees that will yield one or more 100-inch sticks to the minimum top diameter will be cut and utilized.

Whole Tree harvest is not allowed.

ESTIMATED VOLUME (TONS)

| <u>SPECIES</u> | <u>MINIMUM TOP DIAMETER</u> | | <u>Advertised Price Per Unit</u> |
|------------------------------|-----------------------------|-------------------|--------------------------------------|
| | <u>4"</u> | <u>Whole Tree</u> | |
| White Pine ¹ | 440 | | \$ 15.40 |
| Red Pine ² | 480 | | \$ 21.70 |
| Balsam Fir ³ | 600 | | \$ 7.00 |
| Aspen | 320 | | \$ 15.40 |
| Red Oak | 1050 | | \$ 11.20 |
| Mixed Hardwoods ⁴ | 2300 | | \$ 13.30 |

ESTIMATED VOLUME (MBF)

| | | |
|---------|----|-----------|
| Red Oak | 96 | \$ 333.00 |
|---------|----|-----------|

TOTAL MINIMUM BID VALUE: \$ 100,638.00

1 Potential for 53 MBF of sawlogs.

2 Potential for 61 MBF of sawlogs.

3 Balsam fir is 69% balsam fir, 31% spruce and trace amounts of jack pine (wt. conv. 2.086 tons/cord).

4 Mixed Hardwood is approximately 69% red maple, 20% white birch, and 11% hard maple (wt. conv 2.340 tons/cord).

Note: Total sale volume equates to 34.1 tons/acre or 14.4 cords/acre.

Special Conditions:

1. Cutting must be concurrent for all species to be harvested.
2. Do not cut, knock down or utilize any dead trees.
3. No harvesting or skidding in Main Sale Area from April 15th to July 15th due to the risk of oak wilt.
4. All slash along Nixon Lake Road must be lopped and scattered to lie within two feet of the ground and pulled back behind the tree line concurrently with cutting.
5. All pine products cut between May 1 and September 1 must be removed from the sale area within three weeks from time of cutting. Pine products cut during remainder of the year must be removed prior to May 1 of each year.
6. If the contract is to be worked on during multiple time periods a mid-contract "pull-off" inspection meeting will be required. One-week notice shall be given by the contractor prior to moving equipment off-site. During the "pull-off" inspection provisions needing attention will be documented. The contractor at this time can decide to remedy them before pulling off or rectify them when moving back onto the site. If the latter is chosen documented items shall be addressed before harvesting can continue.

