

**WISCONSIN  
DEPARTMENT OF NATURAL RESOURCES  
TIMBER SALE  
TRACT 10-19 OVERDRIVE ASPEN  
T41N R7E SECTIONS 26,27  
HARVEST ACRES - 60**

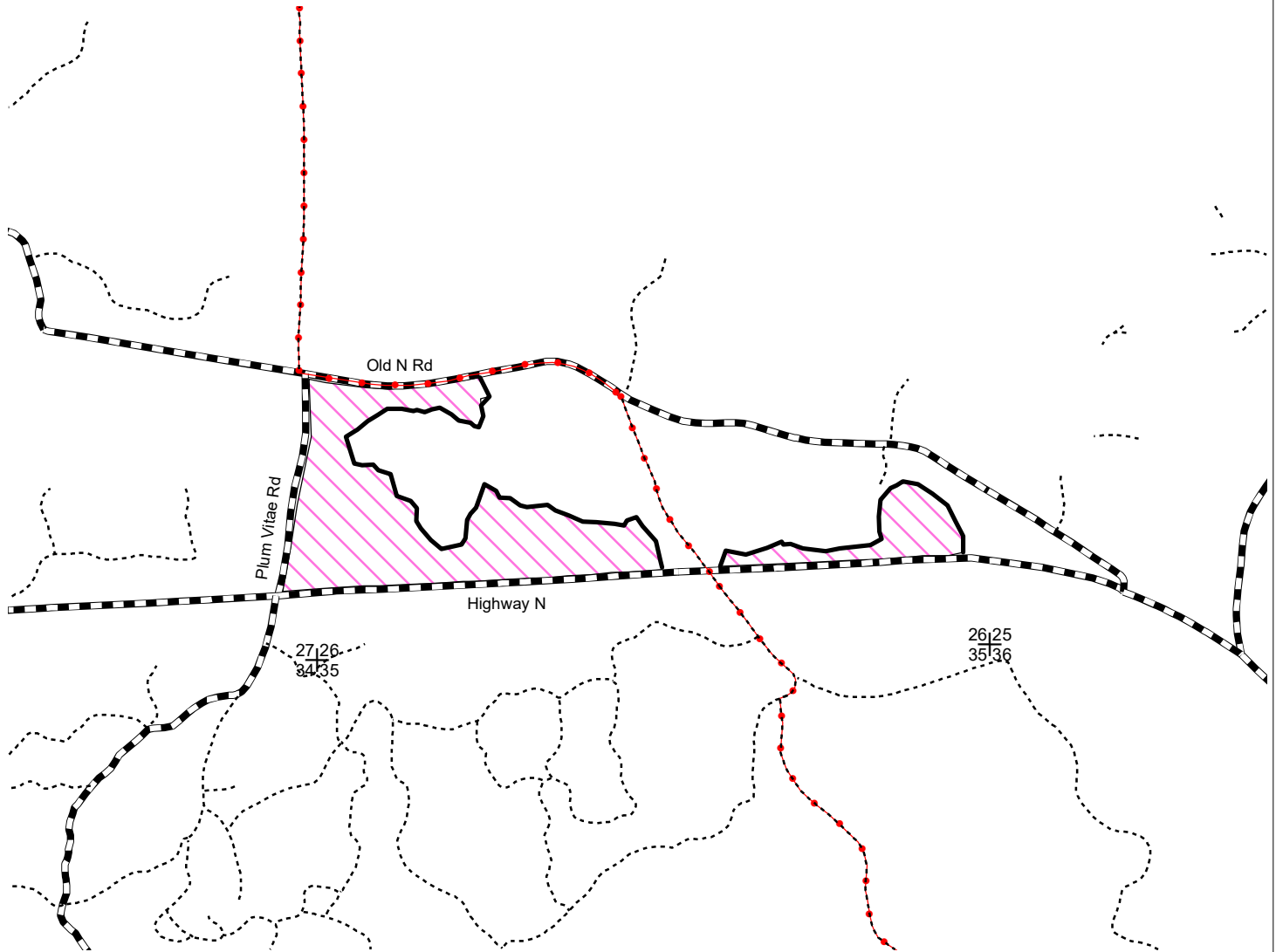

**Legend**

- Red Paint Line
- Section Corner
- Woods Roads
- Snowmobile Trails
- Highways and Town Roads

Harvest Areas (60 Acres): Cut all aspen, white birch, maple, balsam fir and orange marked trees.

***Note: Harvesting will be limited to July 15 - April 15  
due to Oak Wilt restrictions***

All stands are within  
Mgmt. Area 4: Vilas Sandy Plains Central  
Forest Production Area

This map is not a survey of the actual boundary of  
any property this map depicts.

N  
Scale: 4" = 1 Mile  
1:15,840



Map produced by  
Jake Truitt, 3/19

NHAL TRACT NO. 10-19  
Overdrive Aspen

Vilas County

Town 41 North, Range 7 East

Section 26 – SESE, SWSE, SW1/4

Section 27 – SESE, NESE

15 % of the total sale bid value will be required for performance bond.

The cutting area is approximately 60 acres.

The contract period is **2 years**.

All trees that will yield one or more 100-inch sticks to the minimum 4” top diameter will be cut and utilized.

Whole tree utilization is not allowed.

---

ESTIMATED VOLUME (TONS)

Minimum Top Diameter:		ADVERTISED PRICE
<u>SPECIES</u>	<u>4”</u>	<u>PER UNIT</u>
Red Pine <sup>1</sup>	230	\$ 21.70
Aspen	1370	\$ 15.40
Red Oak <sup>2</sup>	85	\$ 11.20
Mixed Hardwood <sup>3</sup>	890	\$ 13.30

**Total Minimum Bid Value: \$38,878.00**

---

1 - Volume includes: 43% Red Pine, 36% White Pine, 12% Scotch Pine, 9% Balsam Fir. Included in estimate is 9.4MBF Red Pine and 5.6MBF White Pine potential saw logs.

Conversion: 2.16 tons/cord.

2 – Volume includes: Potential of 5.6MBF Red Oak saw logs.

3 - Volume includes: 54% Red Maple, 32% Hard Maple, 14% White Birch. Included in estimate is 3.2MBF Hard Maple and 800BF Red Maple potential saw logs. MX conversion factor of 2.36 tons/cord.

Total Sale Volume equates to 43 tons/acre.

Special Conditions

1. **Seasonal Restrictions: Harvesting will be limited to a period from July 15 to April 15 due to Oak Wilt considerations.**
2. Felling and skidding damage to residual trees must be avoided, this includes understory seedlings and saplings.
3. Cutting must be concurrent for all species to be harvested.
4. All pine products cut between May 1 and September 1 must be removed from the sale area within three (3) weeks from time of cutting. Pine products cut during the remainder of the year must be removed prior to May 1 of each year.
5. All trails/woods roads must be repaired to preharvest conditions. Snowmobile trails must remain snow-covered during winter season.
6. Slash along town roads/snowmobile trail must be lopped and scattered to lie within two feet of the ground and pulled back behind the tree line concurrently with cutting.
7. If the contract is to be worked on during multiple time periods a mid-contract “pull-off” inspection meeting will be required. One-week notice shall be given by the contractor prior to moving equipment off-site. During the “pull-off” inspection provisions needing attention will be documented. The contractor at this time can decide to remedy them before pulling off or rectify them when moving back onto the site. If the latter is chosen documented items shall be addressed before harvesting can continue.