

**WISCONSIN
DEPARTMENT OF NATURAL RESOURCES
TIMBER SALE
TRACT 15-19 ALVA
T42N R8E SECTIONS 21, 22, 27, 28, 33, 34
HARVEST ACRES - 254**

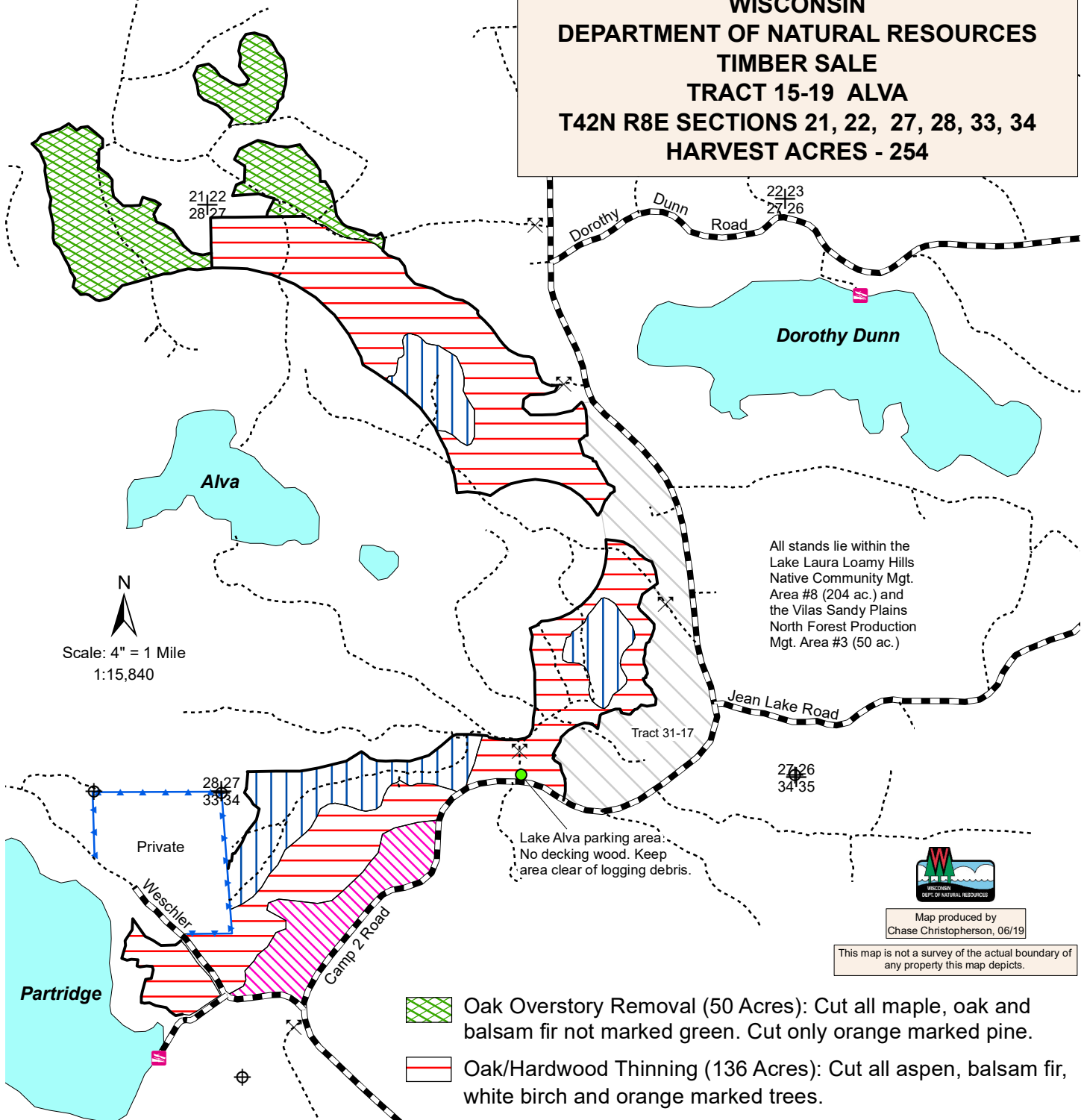

Map produced by
Chase Christopherson, 06/19

This map is not a survey of the actual boundary of any property this map depicts.

Legend

- Boat Landing
- Berms
- Survey Marker
- Section Corner
- Woods Roads
- Red Line
- Blue Line
- Highways and Town Roads
- Lakes

- Oak Overstory Removal (50 Acres): Cut all maple, oak and balsam fir not marked green. Cut only orange marked pine.
- Oak/Hardwood Thinning (136 Acres): Cut all aspen, balsam fir, white birch and orange marked trees.
- Hemlock (45 Acres): Cut all aspen, balsam fir, white birch and orange marked trees.
- Mixed Forest (23 Acres): Cut all aspen, balsam fir, white birch and orange marked trees.

Trees marked with a blue 'D' are to be dropped and left as Coarse Woody Debris concurrently with timber harvest.

**Note: No harvesting, skidding or road construction April 15 to July 15 due to the risk of Oak Wilt.
Do NOT cut trees marked with green paint.**

NH-ALSF TRACT NO. 15-19

Alva

Vilas County

Town 42 North, Range 8 East

Section 21 – SESE, SWSE

Section 22 – NWSW, SWSW

Section 27 – SWNE, NENW, NWNW, SENW, SWSW, SESW, NWSE, SWSE

Section 28 – NENE

Section 33 – GL 3

Section 34 – NENW, NWNW, SWNW

15% of the total sale bid value will be required for performance bond.

The cutting area is approximately 254 acres.

The contract period is 3 years.

All trees that will yield one or more 100-inch sticks to the minimum top diameter will be cut and utilized.

Whole Tree harvest is not allowed.

<u>ESTIMATED VOLUME (TONS)</u>		
<u>SPECIES</u>	<u>MINIMUM TOP DIAMETER</u>	<u>Advertised Price</u>
	<u>4"</u>	<u>Per Unit</u>
Red Pine ¹	100	\$ 21.70
Balsam Fir ²	800	\$ 7.00
Aspen	525	\$ 15.40
Red Oak	1850	\$ 11.20
Mixed Hardwood ³	3400	\$ 13.30

<u>ESTIMATED VOLUME (MBF)</u>		
Red Oak	219	\$ 333.00
Hard Maple	68	\$ 315.00

TOTAL MINIMUM BID VALUE: \$ 176,142.00

1 Red Pine is 65% red pine and 35% white pine. Included is an estimated 13 MBF. (wt. conv. 2.198)

2 Balsam Fir is approximately 66% balsam fir and 34% hemlock. Included is an estimated 11 MBF of hemlock. (wt. conv. 2.219)

3 Mixed Hardwood is approximately 46% hard maple, 33% white birch, 21% red maple, and <1% basswood and yellow birch. (wt. conv 2.443 tons/cord)

Note: Total sale volume equates to 32.9 tons/acre or 13.1 cords/acre.

Special Conditions:

1. Cutting must be concurrent for all species to be harvested.
2. Do not cut, knock down or utilize any dead trees.
3. No harvesting, skidding or road construction from April 15th to July 15th due to the risk of oak wilt.
4. Do not deck wood at parking area/road entrance to Lake Alva. The road may be used for trucking but must be kept clear of logging debris and repaired after use.
5. Trees marked with a blue "D" must be dropped and left lay concurrently with timber harvest. The intent is to create coarse woody debris which benefits tree regeneration, nutrient cycling and wildlife habitat.
6. If the contract is to be worked on during multiple time periods a mid-contract "pull-off" inspection meeting will be required. One-week notice shall be given by the contractor prior to moving equipment off-site. During the "pull-off" inspection provisions needing attention will be documented. The contractor at this time can decide to remedy them before pulling off or rectify them when moving back onto the site. If the latter is chosen documented items shall be addressed before harvesting can continue.