

NH-ALSF TRACT NO. 14-18  
THREE LITTLE LAKES ASPEN

Oneida County

Town 39 North, Range 7 East

Section 21 – SESW

Section 28 – NWNE, SWNE, NW¼

No bid bond required.

15% of the total sale bid value will be required for performance bond.

The cutting area is approximately 106 acres.

The contract period is 3 years.

All trees that will yield one or more 100-inch sticks to the minimum 4” top diameter will be cut and utilized.

---

ESTIMATED VOLUME (TONS)

<u>SPECIES</u>	Minimum Top Diameter:  4”	Whole <u>Tree</u>	ADVERTISED PRICE  <u>PER UNIT</u>
Balsam Fir <sup>1</sup>	120		\$ 6.00
Aspen	3350		\$ 17.00
Red Oak <sup>2</sup>	1000		\$ 22.10
Mixed Hardwood <sup>3</sup>	2020		\$ 16.20

**Total Minimum Bid Value: \$112,494.00**

---

<sup>1</sup>Approximately 75% Balsam Fir, 25% White Pine and less than 1% Red Pine and Jack Pine. Included within this volume is 4 MBF of White Pine. Weight Conversion: 2.119 tons/cord.

<sup>2</sup>Included within this volume is approximately 38 MBF of Red Oak. Weight Conversion: 2.750 tons/cord.

<sup>3</sup>Approximately 50% Red Maple, 30% White Birch and 20% Hard Maple. (2.368 tons/cd)

Total Sale Volume equates to 61.22 tons/acre or 25.98 cords/acre.

1. No cutting or skidding allowed between April 15 and July 15.
2. Cutting must be concurrent for all species to be harvested.
3. Snowmobile trails must be repaired to pre-harvest conditions before the start of each snow season.
4. All pine products cut between May 1 and September 1 must be removed from the sale area within three weeks from time of cutting. Pine products cut during the remainder of the year must be removed prior to May 1 of each year.
5. If the contract is to be worked on during multiple time periods a mid-contract “pull-off” inspection meeting will be required. One-week notice shall be given by the contractor prior to moving equipment off-site. During the “pull-off” inspection provisions needing attention will be documented. The contractor at this time can decide to remedy them before pulling off or rectify them when moving back onto the site. If the latter is chosen documented items shall be addressed before harvesting can continue.

WISCONSIN  
DEPARTMENT OF NATURAL RESOURCES  
TIMBER SALE  
TRACT 14-18 THREE LITTLE LAKES ASPEN  
T39N-R7E SECTIONS 21 & 28  
HARVEST ACRES: 106

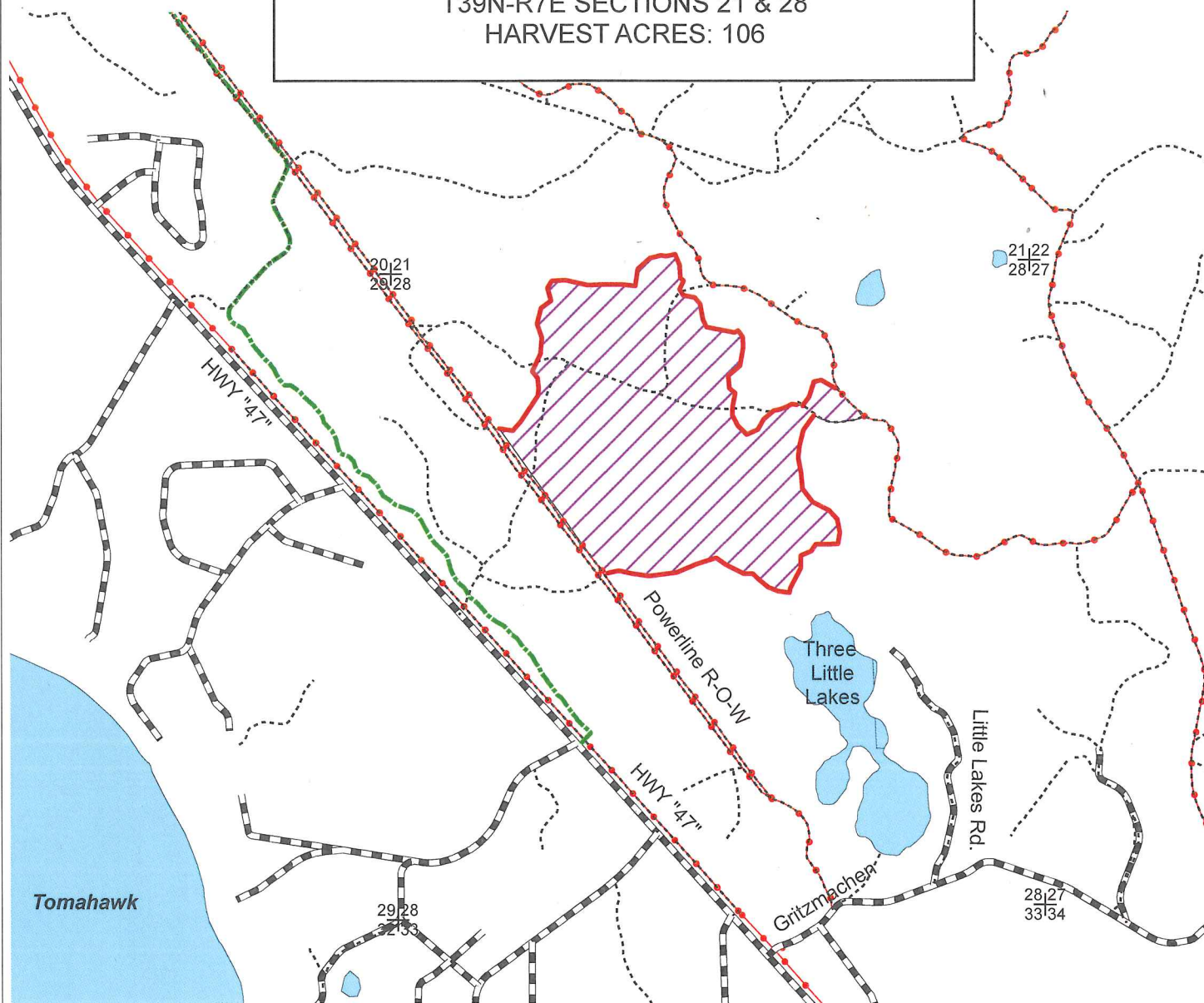

Cut all aspen, white birch, maple, oak, balsam fir and jack pine not marked with green paint. Cut only those red pine and white pine marked with orange paint. All 1-5" diameter aspen and maple must be cut concurrently with harvest.

**\*\*NO CUTTING OR SKIDDING BETWEEN APRIL 15 AND JULY 15\*\***

**Legend**

- + Section Corner
- Red Paint Line
- Woods Roads
- Blacktop Bike Trail
- Snowmobile Trails
- Highways and Town Roads
- Blue Lakes

Map Produced by  
C. Dalton 1/18



Master Plan Management Area 5 -- Big Arbor Vitae Loamy Hills -- Forest Production