

NHAL TRACT NO. 10-18  
Mann Creek Pines

Vilas County

Town 41 North, Range 7 East

Section 30 – NENE, NW1/4, SW1/4

No bid bond is required.

15 % of the total sale bid value will be required for performance bond.

The cutting area is approximately 50 acres.

The contract period is 3 years.

All trees that will yield one or more 100-inch sticks to the minimum 4” top diameter will be cut and utilized.

Whole tree utilization is not allowed.

---

ESTIMATED VOLUME (TONS)

<u>SPECIES</u>	Minimum Top Diameter: <u>4”</u>	<u>ADVERTISED PRICE</u> <u>PER UNIT</u>
Red Pine <sup>1</sup>	640	\$ 18.90
Balsam Fir <sup>2</sup>	185	\$ 4.90
Aspen	525	\$ 14.00
Mixed Hardwood <sup>3</sup>	800	\$ 13.30

**Total Minimum Bid Value: \$30,992.50**

---

1 - Volume includes: 94% Red Pine, 6% White Pine. Also includes 51MBF Red Pine, 2MBF White Pine. Conversion: 2.24 tons/cord.

2 - Contains 35 tons Black Spruce. Conversion: 2.10 tons/cord.

3 - Volume includes: 40% Red Oak, 39% Red Maple, 19% White Birch, 2% Hard Maple. It also includes 18MBF Red Oak, 500BF Red Maple, 2MBF White Birch. MX conversion factor of 2.48 tons/cord.

Total Sale Volume equates to 43 tons/acre.

Special Conditions

- Seasonal Restrictions: Harvesting will be limited to a period from July 15 to April 15 due to Oak Wilt considerations. Also, Area “A” will be limited to dry or frozen ground conditions only.**
- Felling and skidding damage to residual trees must be avoided, this includes understory seedlings and saplings.**
- Equipment Restrictions: Skidding of forest product materials will be restricted to shortwood skidders only.**
- Cutting must be concurrent for all species to be harvested including non-merchantable trees where applicable.
- All pine products cut between May 1 and September 1 must be removed from the sale area within three (3) weeks from time of cutting. Pine products cut during the remainder of the year must be removed prior to May 1 of each year.
- No felling of trees across red paint lines, and slash/tops must be pulled back out of wetlands/swamps and seasonal pond areas.
- Slash along roads must be lopped and/or scattered to lie within two feet of the ground and pulled back behind the tree line concurrently with cutting.
- If the contract is to be worked on during multiple time periods a mid-contract “pull-off” inspection meeting will be required. One-week notice shall be given by the contractor prior to moving equipment off-site. During the “pull-off” inspection provisions needing attention will be documented. The contractor at this time can decide to remedy them before pulling off or rectify them when moving back onto the site. If the latter is chosen documented items shall be addressed before harvesting can continue.



**WISCONSIN  
DEPARTMENT OF NATURAL RESOURCES  
TIMBER SALE  
TRACT 10-18 MANN CREEK PINES  
T41N R7E SECTION 30  
HARVEST ACRES - 50**

This sale is located within Management Area 3: Vilas Sandy Plains North Forest Production Area.

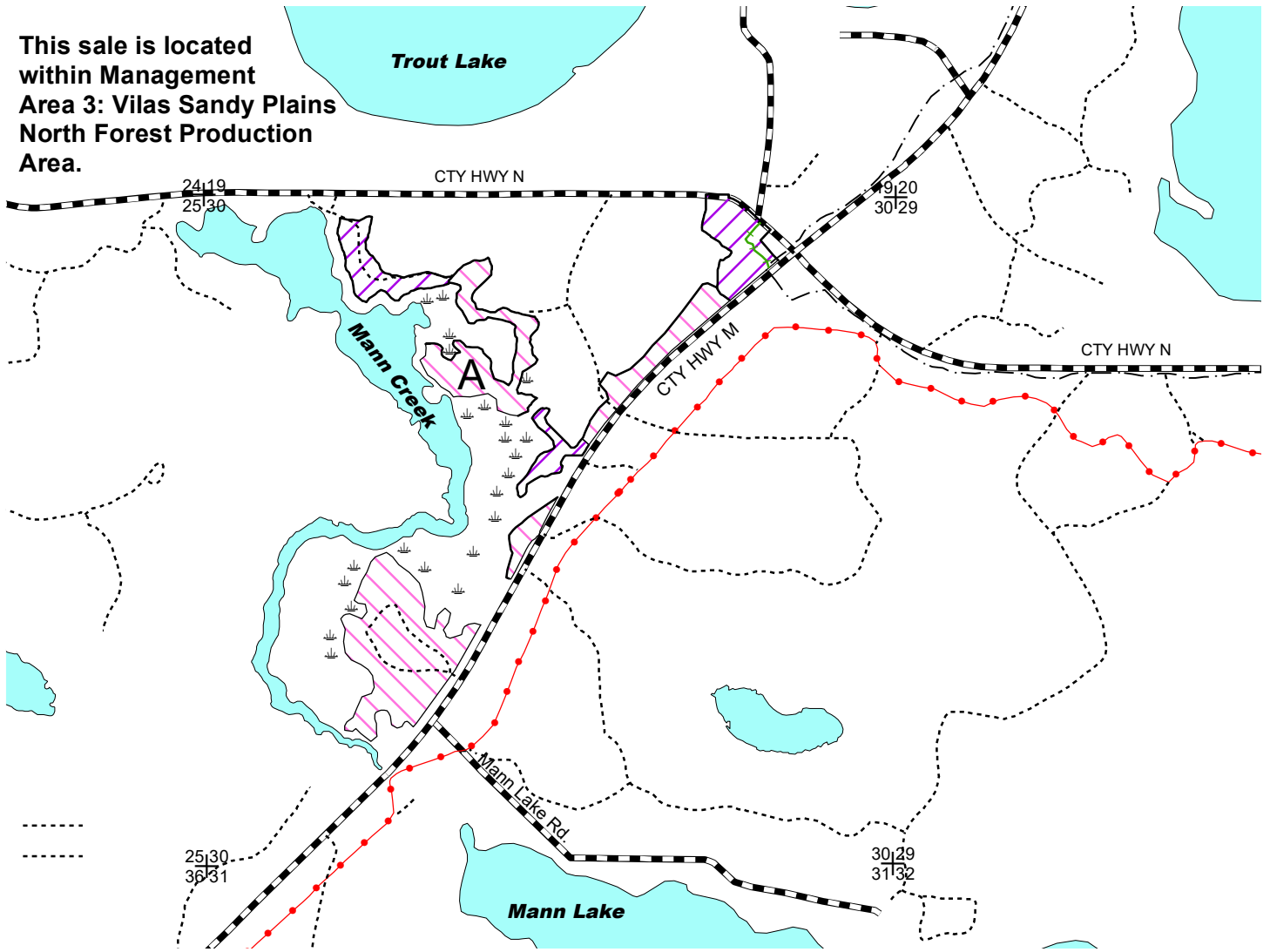



Scale: 4" = 1 Mile  
1:15,840

**Legend**

-  Section Corner
-  Survey Marker
-  Keg/Swamp
-  Red Line
-  Green Line
-  Bike Trail
-  Snowmobile Trails
-  Woods Roads
-  Highways and Townroads
-  Lakes & Open Water

**Oak Wilt Restrictions: No harvesting or skidding in all areas from April 15 to July 15 due to the risk of oak wilt.**

 Aspen Regeneration Area (14 Acres): Cut all aspen, birch, maple, jack pine, oak, black spruce, balsam fir and trees marked with orange paint. Within the Green Lined Area cut merchantable balsam fir and ONLY trees marked with orange paint. Excessive damage to aspen saplings will not be tolerated.

 Pine Thinning Area (36 Acres): Cut all aspen birch, maple, jack pine, black spruce, merchantable balsam fir and trees marked with orange paint.

**Area A: Harvesting Operations will be limited to frozen ground conditions only.**

**Note: Do NOT cut trees marked with green paint**



Map produced by Paul Stearns, 01/02/18

This map is not a survey of the actual boundary of any property this maps depicts