



**WISCONSIN
DEPARTMENT OF NATURAL RESOURCES
TIMBER SALE
TRACT 979-18 MANSON ASPEN
T36N R7E SECTION 33
SALE ACRES- 44
HARVEST ACRES - 41**



Scale: 4" = 1 Mile

1:15,840



Map produced by
Ricky Keller, 06/18

This map is not a survey
of the actual boundary of
any property this map depicts.

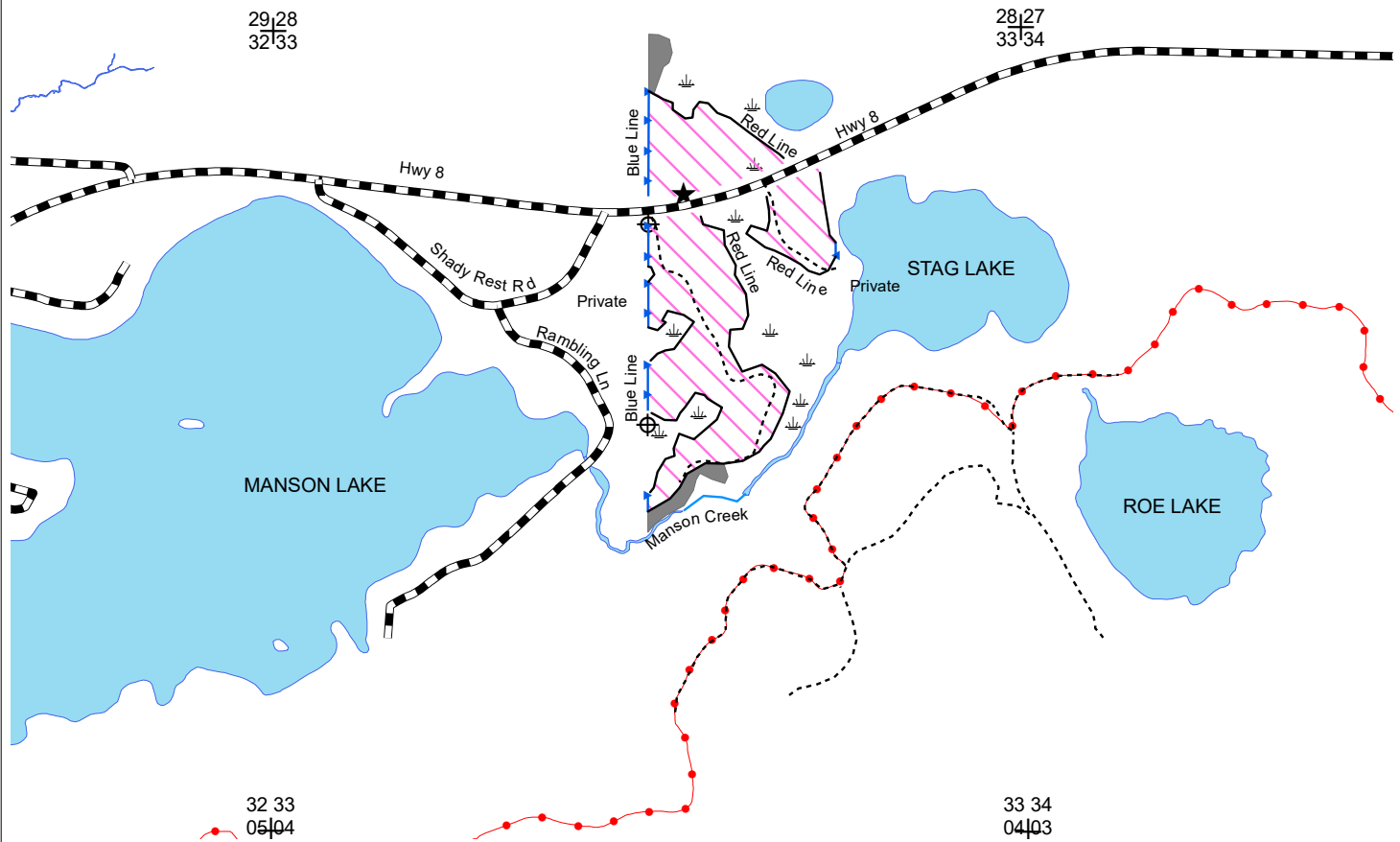

Legend

- Highways and Town Roads
- Creek
- Woods Roads
- Red Paint Line
- Blue Paint Line
- GTR
- Lake
- Section Corner
- Survey Marker
- Forested Wetland
- Snowmobile Trails
- Location for Driveway



Aspen Areas (41 Acres): Cut all aspen, red maple, balsam fir, white spruce, and sugar maple greater than 1 inch. Do not cut any other species. If harvesting whole tree, 1 in 10 tops above the standard 4 inch top must be left on site and evenly distributed throughout the harvest area.

Woodboro Lakes Wildlife Area TRACT 979-18

Manson Aspen

Oneida County: Town 36 North, Range 7 East:

Section 33 – NWNE, SWNE, and NWSE

No bid bond required.

15% of the total sale bid value or \$1,000.00, whichever is greater, will be required for performance bond.

The sale area is approximately 44 acres.

The cutting area is approximately 41 acres.

The contract period is 2 years.

All trees that will yield one or more 100-inch sticks to a minimum top diameter of 4" will be cut and utilized.

Whole tree harvest is allowed.

ESTIMATED VOLUME (TONS)
MINIMUM TOP DIAMETER

<u>SPECIES</u>	<u>Whole Tree[*]</u>	<u>Advertised Price</u> <u>Per Ton</u>	<u>4"</u>	<u>Advertised Price</u> <u>Per Ton</u>
Balsam Fir ¹	105	\$10.30		
Aspen ²	2,330	\$10.00	1,850	\$12.59
Mx. Hardwood ³	225	\$10.00	175	\$12.85
		Total Minimum Bid Value	\$ 26,631.50	

¹ Volume includes nearly 100% balsam fir (2.125 tons/cord). There is a small amount of white spruce that will be cut and included in this category.

² Volume includes 100% aspen (2.250 tons/cord).

³ Volume includes nearly 100% red maple (2.275 tons/cord) There may be a minimal amount of white ash and sugar maple within the sale that would be included in the Mx. Hardwood category.

Special Conditions

1. Do not cut any trees within 15 feet of any ephemeral pond. All other low areas are to be operated in during dry or frozen ground conditions to prevent rutting. Cutting must be concurrent for all species to be harvested.
2. No Damage to residual trees will be allowed.
3. Do not cut any snags unless they pose a safety hazard.
4. Signs indicating "Trucks entering roadway" or something similar must be placed on Hwy 8 on both the east and west sides of the sale.
5. No slash allowed across any blue line, red line, powerline, or within any wetland. Slash must be lopped and scattered to lay within 2 feet of the ground and pulled back into the sale area at least 10 feet away from the adjacent private lands and public roads.
6. All landings and any new woods roads must be approved prior to sale start up.
7. If the contract is to be worked on during multiple time periods a mid-contract "pull-off" inspection meeting will be required. One week notice shall be given by the contractor prior to moving equipment off site. During the "pull-off" inspection, provisions needing attention will be documented. The contractor at that time can decide to remedy them before pulling equipment off or rectify them when moving back onto the site. If the latter is chosen, documented items shall be addressed before harvesting can continue.
8. This sale will include harvesting some trees within the Department of Transportation (DOT) right-of-way for Highway 8. A cost-free permit will need to be obtained from the DOT.
9. A new driveway must be constructed to access the portion of the sale that is north of Highway 8. The driveway will need to be constructed, used, and deconstructed within a 30 day period. In addition, only right turns (turning west) will be allowed when leaving this driveway due to limited visibility to the west. This driveway will require a cost-free permit from the DOT prior to starting this sale.