



## Crex Meadows Wildlife Area

Mapped By:			Timber Sale Name		Contract #
<b>Nessler</b>			<b>Grumbling Grouse</b>		<b>780-222</b>
Date Drawn			Comp	Stands	Contractor
<b>6/14/2022</b>			<b>109</b>	<b>4 &amp; 7</b>	
Town			DNR Tract #		Expiration Date
<b>West Marshland</b>			<b>2-22</b>		<b>6/30/2027</b>
Twp	Range	Sections	Acres		Sale Type
<b>39N</b>	<b>18W</b>	<b>27, 28, 33 &amp; 34</b>	<b>45</b>		<b>Scaled</b>

### Cutting Requirements/ Information:

 **Coppice w/ reserves (40 ac)** – Sever all stems down to a 2” diameter except bur oak, white pine and red pine. Leave all bur oak, white pine, and red pine as reserve trees.

 **Clearcut- (5 ac)**  
Sever all stems down to a 2” diameter. Cutting block will be scarified by the Department prior to harvest. All jack pine slash shall be placed at a height not to exceed 2’ within scalps created by scarification.

	<u>4” tons</u>	<u>4” Cords</u>
Oak*	1300	470
Mixed Hdwd**	625	260
Jack Pine***	160	75
Aspen****	90	40

**Minimum Sale Value: \$8978.00**

\* Red oak conversion factor of **(2.75 Tons/Cord)** will be used.

\*\* Mixed hardwood volume is 68% red maple, 22% white birch, 9% ash, and 1% cherry. DNR soft maple conversion factor **(2.275 Tons/Cord)** will be used.

\*\*\* Jack pine average diameter is 11”. DNR jack pine conversion factor **(2.125 Tons/Cord)** will be used.

\*\*\*\* Aspen average diameter is 10”. DNR aspen conversion factor **(2.25 Tons/Cord)** will be used.

1. Entire sale shall be cut during frozen ground conditions.
2. No equipment shall operate in swamps or wetlands unless completely frozen.
3. Utilization to 4” top DIB.
4. Maximum stump height shall be 10”.
5. Sale boundaries consist of red paint line, blue paint line, town road, and natural boundaries (wetland/open field), all slash must remain within these boundaries and on the sale area
6. Slash shall be lopped and scattered to a maximum height of 2’ and kept within sale boundaries.
7. Do not harvest paint marked boundary trees.
8. No slash or equipment allowed across blue paint line or onto private land at any time, trees shall be felled onto state property and away from private lands.
9. Operations will be stopped, if in the opinion of the forester unnecessary damage of any kind occurs.
10. A temporary stream crossing will be necessary where delineated on the map. Contact sale administrator prior to installation. No other stream crossings shall be created or utilized.
11. Must follow all BMPs found in “Wisconsin’s Forestry Best Management Practices for Water Quality Field Manual”.
12. Leave all snags where they are not a safety risk to the operator.
13. Road approaches to town roads are the responsibility of the contractor. Damage to these roads are the responsibility of the contractor. Approaches may require improvements prior to hauling to prevent damage. Contractor is responsible for contacting the Town of West Marshland prior to installation of any improvements.
14. No dozer, road, or excavation work shall be completed without approval from sale administrator.
15. All piles of pine shall be removed within 30 days between April 15<sup>th</sup>- August 1<sup>st</sup>.
16. Landings shall be located only where indicated on the sale map. Any additional landings or alterations to landing locations shall only be done with the approval of the Sale Administrator.

\*These lands are 3<sup>rd</sup> party certified

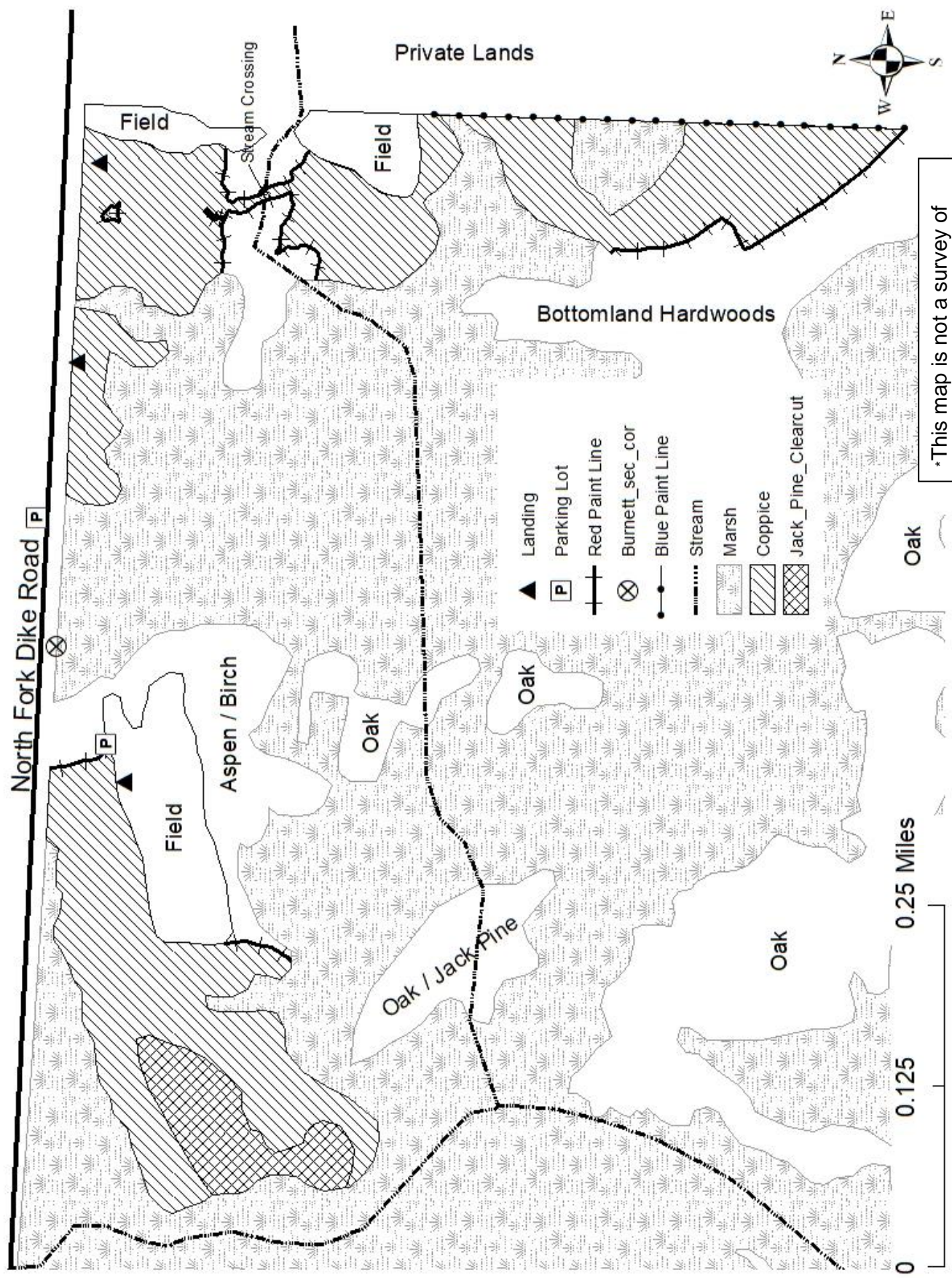

\*This map is not a survey of the actual boundary of any property this map depicts