



September 19, 2025

**Timber Sale Information for DNR and Frederic School Owned Land in Burnett and Polk**

Sealed bids will be received by mail or in person at the Grantsburg Ranger Station, 325 W State Rd 70, Grantsburg WI 54840 up to October 28, 2025 at 11:00 AM and will be opened immediately thereafter for timber stumpage described in this prospectus. The public may attend in person or call Jake Lindberg at 715-225-0359 one day in advance if you prefer to attend virtually.

For question about this bid opening- contact: Jake Lindberg – 715-225-0359; jake.lindberg@wisconsin.gov

This bid opening will be held for 9 tracts on the Governor Knowles State Forest, Straight Lake State Park, Omer Springs Fishery Area, Crex Meadows Wildlife Area, Amsterdam Sloughs Wildlife Area, and Frederic School properties.

**Governor Knowles State Forest**

<i>Sale Name</i>	<i>Tract</i>	<i>Acres</i>	<i>Timber Types</i>	<i>Tons 4"</i>	<i>Tons 6"</i>	<i>Min Bid</i>
<i>Curly Road</i>	<i>20-24</i>	<i>29</i>	<i>Oak//Jack Pine/Red Pine/Aspen/Mx Hardwood</i>	<i>625</i>	<i>405</i>	<i>\$4,826.00</i>
<i>Randall's Ash</i>	<i>40-22</i>	<i>47</i>	<i>Oak/Mx Hardwood/Ash</i>	<i>1,715</i>		<i>\$2,824.50</i>
<i>Freezer Meat</i>	<i>10-25</i>	<i>130</i>	<i>White Pine/Red Pine/Ash/Oak/ Mx Hardwood</i>	<i>3,935</i>		<i>\$45,170.50</i>
<i>Black Wolf</i>	<i>20-25</i>	<i>23</i>	<i>Red Pine/Oak/Aspen</i>	<i>715</i>		<i>\$5,065.00</i>

**Sales on DNR Owned Lands in Polk County**

<i>Sale Name</i>	<i>Tract</i>	<i>Acres</i>	<i>Timber Types</i>	<i>Cords 4"</i>	<i>MBF</i>	<i>Min Bid</i>
<i>BSA Sharpshooter</i>	<i>1-25</i>	<i>80</i>	<i>Red Oak/Ash Mx Hardwood/Basswood/Aspen</i>	<i>335</i>	<i>147</i>	<i>\$32,850.00</i>
<i>Omer Springs</i>	<i>2-25</i>	<i>8.5</i>	<i>Mx Hardwood/Basswood</i>	<i>100</i>	<i>24</i>	<i>\$3,275.00</i>

**Sales on DNR Owned Lands in Burnett County**

<i>Sale Name</i>	<i>Tract</i>	<i>Acres</i>	<i>Timber Types</i>	<i>Tons 4"</i>	<i>Whole Tree</i>	<i>Min Bid</i>
<i>Popple Fuzz</i>	<i>711-125</i>	<i>85</i>	<i>Aspen/Mx Hardwood/Oak</i>	<i>5,000</i>	<i>6,500</i>	<i>\$34,500.00</i>
<i>Kohler Peat Conversion</i>	<i>780-125</i>	<i>262</i>	<i>Red Pine/Oak/Jack Pine/Aspen</i>	<i>13,950</i>	<i>17,650</i>	<i>\$121,935.00</i>

**Sale on Frederic School Land in Polk County**

<i>Sale Name</i>	<i>Tract</i>	<i>Acres</i>	<i>Timber Types</i>	<i>Tons 4"</i>		<i>Min Bid</i>
<i>Frederic School Forest</i>		<i>33</i>	<i>Aspen/Red Pine/Mx Hardwood</i>	<i>2,270</i>		<i>\$27,840.00</i>

For tracts not sold on October 28, 2025, sealed bids will be accepted by mail or in person until November 4, 2025. Contact Jake Lindberg at 715-225-0359 or [jake.lindberg@wisconsin.gov](mailto:jake.lindberg@wisconsin.gov) for details on bid results following October 28<sup>th</sup> bid opening.

### **BIDDING REQUIREMENTS**

1. Bidding Procedure for Timber Sales
  - a. Bids will be made by species for each tract.
  - b. Estimated volumes and utilization specifications are listed on individual sale prospectus maps. Bid according to volumes listed on individual sale prospectus and/or maps.
  - c. The **high bidder** will be determined by the **greatest total bid** for each tract.
  - d. Bids will be opened in random order.
  - e. **Bidders in attendance (virtual)** can remove their bid from consideration before each individual tract is opened. Bidders must identify themselves by clearly stating their name, address, and telephone number PRIOR to a bid being opened to withdraw their bid from consideration.
2. Bids may be made on one or more tracts.
3. Submit each bid in an individual sealed envelope marked "Bid for Timber Stumpage" with the timber sale name, and tract number on the outside. Wisconsin DNR Timber Sale Bid Forms must be used to make bids on DNR timber sales and is included with the individual sale prospectus
4. A per unit bid must be made on every item on a tract. No "zero" bids for any species or products will be accepted.
5. Winning bidders will be notified within 24 hours of bid opening and must sign the timber sale contract and submit an acceptable performance bond within 6 weeks of the bid opening. If the winning bidder fails to execute the contract and submit an acceptable performance bond, the bidder shall be required to forfeit to the department an amount equal to 10% of the total bid amount. Failure to forfeit the 10% penalty will result in the bidder being considered ineligible to bid on any state or GNA timber sales for a two-year period.
6. A Performance Bond or Letter of Credit is required before awarding of contract. The bond shall be fifteen percent (15%) of the total bid value or a minimum of \$1000.00, whichever is greater. The bond will be held intact by the Department of Natural Resources until the satisfactory completion of the timber sale contract. Performance bonds in a form of other than cash for these sales must expire no earlier than **1-year past contract expiration date.**
7. The Department of Natural Resources reserves the right to reject any and all bids.

### **SALES TAX CERTIFICATION**

1. A Sales and Use Tax Exemption Certificate must be provided at the signing of the contract. This certificate is required to cover a contractor or individual reselling stumpage harvested for firewood/fuelwood and mills and manufacturing facilities. More information about the certificate can be found at <https://www.revenue.wi.gov/DORForms/s-211-inst.pdf>

### **UTILIZATION**

1. All trees designated for cutting will be utilized to standard on each sale map/prospectus.

### **SCALING AND PAYMENT**

1. If eligible for deferred payment option, payment for timber removed from site must be made within 30 days after invoice.

2. If not eligible for deferred payment option, no wood will be hauled from the sale area until advanced payment is made.
3. If sold as a lump sum sale, payment in full must be made on entire sale, or by the cutting block, or by some other means as mutually agreed upon by Department of Natural Resources and contractor.
4. The mill scale ticket system will be used as the preferred method of sale administration. Other scaling systems may be used at the discretion of the Department of Natural Resources.
5. If a woods scale system is used, all cordwood or logs will be piled for scaling. Piles will be level and square with at least 5 cords per pile or 3 MBF. At least 10 cords or 5 MBF will be piled before a scale is requested. Scaling requests must be made at least one day in advance.
6. No refunds of stumpage payments will be made for un-removed wood, and wood left on the sale area at contract expiration shall revert to the seller.
7. Scribner Decimal C Log Rule shall be used for scaling logs. Conversion from MBF to cords or cords to MBF shall be 2.44 cords per MBF for softwoods and 2.2 cords per MBF for hardwoods.
8. Weight scale conversions will be at rates as specified in the Department of Natural Resources timber sale handbook listed below, unless the individual timber sale has specific mixed species pro-rates/conversions.

#### CORDWOOD WEIGHT CONVERSION FACTORS POUNDS PER CORD

<u>Species</u>	<u>Weight (lbs.)</u>	<u>Weight (tons)</u>	<u>Species</u>	<u>Weight (lbs.)</u>	<u>Weight (tons)</u>
Ash	4600	2.3	Jack pine	4250	2.125
Aspen	4500	2.25	Locust	5300	2.65
Balsam	4250	2.125	Mixed hardwood	4800	2.4
Balsam poplar	4900	2.45	Red oak	5500	2.75
Basswood	3850	1.925	Red pine	4500	2.25
Beech	5050	2.525	Soft maple	4550	2.275
Black Cherry	4300	2.15	Spruce	4000	2.0
Cedar	3150	1.575	Tamarack	4650	2.325
Cottonwood	4650	2.325	White birch	4800	2.4
Elm	5000	2.5	White oak	5850	2.925
Hard maple	5100	2.55	White pine	4200	2.1
Hemlock	4800	2.4	Yellow birch	5350	2.675
Hickory	5400	2.7			

#### **CONTRACT PERIOD**

1. All contracts offered during this bid opening will expire as indicated on individual timber sale maps.

#### **CONTRACT EXTENSIONS**

Contract extensions will not be granted without justifiable reason. Justification will be determined by the Department of Natural Resources. Contract expiration dates are given on the individual timber sale. Contract extensions are not guaranteed. All extensions, if granted, will be for 1 year. Extension requests will be considered with the following conditions:

##### **One and Two-year contracts**

- 1st extension – 5% increase in stumpage rate
- 2<sup>nd</sup> extension – an additional 10% increase in stumpage rate

### Three and Four-year Contracts

- 1st extension – 15% increase in stumpage rate (only 1 extension granted)

### OTHER CONDITIONS

1. Wisconsin's Best Management Practices for Water Quality, Woody Biomass Harvesting Guidelines, and Best Management Practices for Invasive Species must be followed on all DNR timber sales. More information on these management guidelines can be found at the links found below.

Water Quality BMPs: <https://dnr.wi.gov/topic/ForestManagement/bmp.html>

Biomass: <https://councilonforestry.wi.gov/Pages/WoodyBiomass/Default.aspx>

Invasive BMPs: <https://councilonforestry.wi.gov/Pages/InvasiveSpecies/Forestry.aspx>

2. The "Contractor" (purchaser) must follow HRD/Oak Wilt requirements specified on each sale prospectus.

### Insurance

The "Contractor" (purchaser) shall provide the Department of Natural Resources with a Certificate of Insurance counter-signed by a Wisconsin Resident Agent, indicating that Worker's Compensation Insurance coverage is provided for the duration of the contract prior to any performance under it. Contractor claiming exemption, independent status, the contractor/purchaser will be required to submit a signed, notarized affidavit that affirms their exempt status pursuant to the criteria listed in section 102.07(7)(b), of the Wisconsin Statutes.

Contract may contain other provisions. Contracts may not be assigned. A sample copy of the contract is available upon request.

NOTE: Prospectus maps for each of the timber sales are available online at <https://dnr.wisconsin.gov/topic/TimberSales>

### **\*\*\*TRAINING STANDARD\*\*\***

The Purchaser shall ensure that at least one in-woods person actively engaged in performance of this contract and responsible for the logging site complies with the Wisconsin Sustainable Forestry Initiative® (SFI®) Training Standard as adopted by the Wisconsin SFI Implementation Committee (SIC). Criteria for the standard can be found at the website [https://www.fistausa.org/fista/SFI\\_Workshops.asp](https://www.fistausa.org/fista/SFI_Workshops.asp) or by contacting the Forest Industry Safety & Training Alliance (FISTA). Purchaser agrees to provide documentation to Seller that the training has been attained prior to initiating sale.

**FOREST CERTIFICATION:** All Wisconsin DNR owned lands are 3<sup>rd</sup> party certified.

### FORESTER CONTACT INFORMATION:

Governor Knowles State Forest	Mike Wallis	715-410-8315	<a href="mailto:michael.wallis@wisconsin.gov">michael.wallis@wisconsin.gov</a>
Straight Lake State Park	Paul Heimstead	715-410-8316	<a href="mailto:paul.heimstead@wisconsin.gov">paul.heimstead@wisconsin.gov</a>
Omer Springs Fishery Area	Paul Heimstead	715-410-8316	<a href="mailto:paul.heimstead@wisconsin.gov">paul.heimstead@wisconsin.gov</a>
Amerstdam Sloughs	Garrett Riewestahl	715-410-8318	<a href="mailto:garrett.riewestahl@wisconsin.gov">garrett.riewestahl@wisconsin.gov</a>
Crex Meadows & Fish Lake	Jake Lindberg	715-225-0359	<a href="mailto:jake.lindberg@wisconsin.gov">jake.lindberg@wisconsin.gov</a>
Frederic School Forest	Luke Krueger	715-701-3586	<a href="mailto:luke.krueger@wisconsin.gov">luke.krueger@wisconsin.gov</a>



# 2025 State Lands Bid Opening Sale Location Map

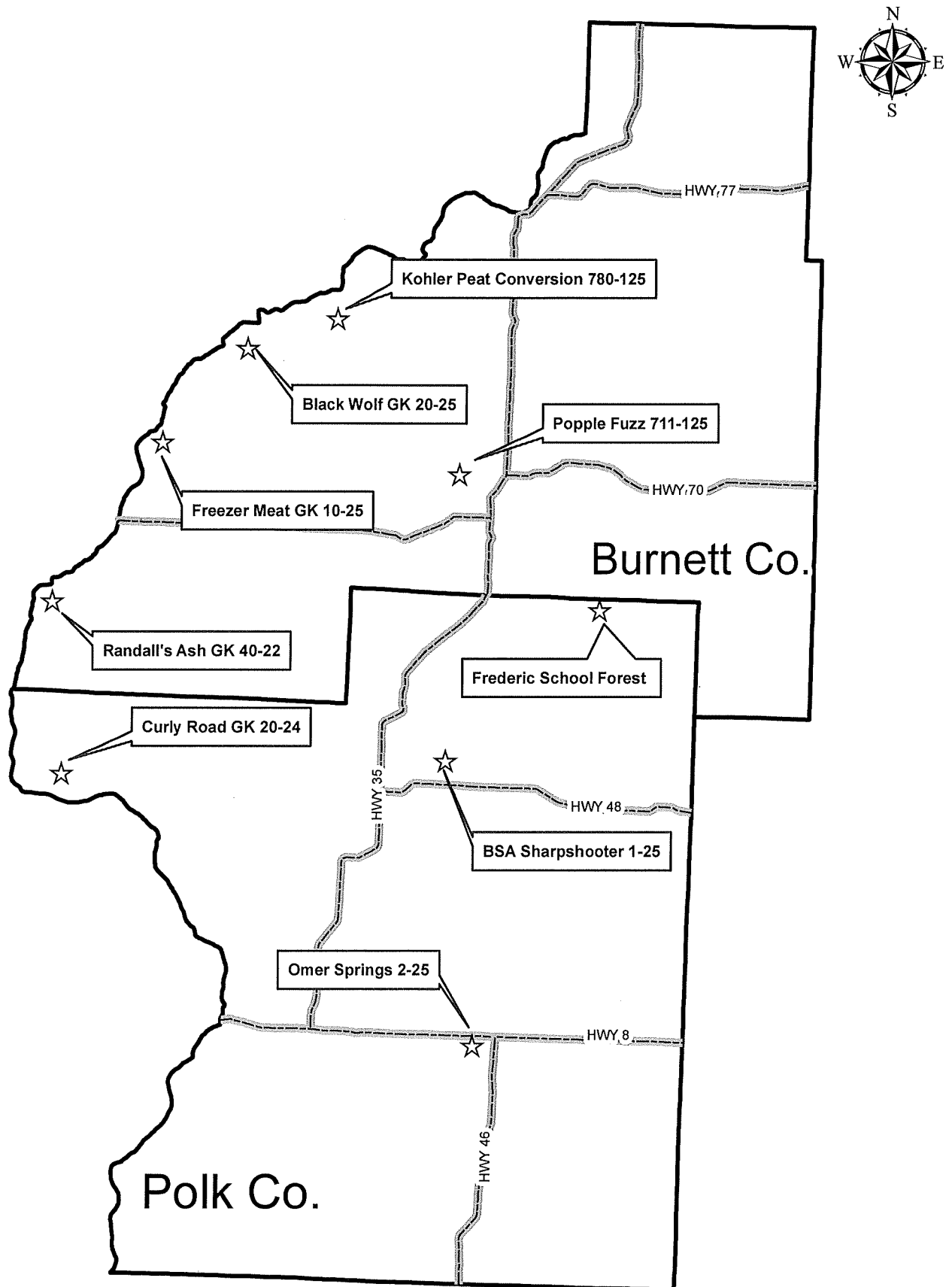



## GOVERNOR KNOWLES STATE FOREST



<b>Timber Sale #/Name:</b> / Curly Road Sale	<b>Town:</b> Sterling (W)	<b>Legal Description:</b> Sec. 27, 33, & 34-T36N-R20W
<b>DNR Tract #:</b> 20-24	<b>Comp:</b> 6 <b>Stand:</b> 5, 10, 15, 18, 19	<b>Acres: 29</b> Block A-3, Block B-3, Block C-1, Block D-8, Block E-9, Block F-4, Block G-1
<b>Sale Expiration Date:</b> December 31, 2027	<b>Mapped By/Date:</b> Mike Wallis 5/18/23	<b>Contractor:</b>

**LUMP SUM SALE - MINIMUM BID: \$4,826.00**

Species/Product	4" Vol. (tons)	6" Vol. (tons)	Price/Ton	Total
Oak	550			
Jack Pine*		310		
Red Pine		95		
Aspen	45			
Mixed Hardwoods**	30			

\*Approx. 45 tons Scotch pine, \*\*88% ash, 12% maple

### Cutting Requirements/Information

-  **Thinning** (Blocks C and F) – Block C harvest all red pine that is marked with orange paint. Block F is an unmarked 1<sup>st</sup> thinning, harvest 1 row leave 2 rows.
-  **Clearcut with Site Maintenance** (Blocks A, B, and D) - Harvest all species with one or more merchantable sticks. Eight acres in Block D were pre-sale scarified by the Department. Site maintenance required. Cut all trees greater than 2-inch DBH.
-  **Clearcut with Reserves** (Block E and G) - Clearcut, harvest all trees with one or more sticks except orange marked trees in E and bur oak in Block G

- Hardwood Utilization: 4" top DIB. **Pine Utilization: 6" top DIB.** All pine meeting the definition of a pulp stick (4" DIB at 100") shall be, at minimum, lopped at 100" and scattered as slash if not being removed from the harvest area.
- Do not harvest paint marked boundary trees.
- Maximum stump height shall be 10 inches.
- Slash shall be kept within the sale boundaries and scattered with a maximum height not to exceed 3 feet. Reduce the slash in block E to 2 feet and do not pile slash near the marked leave trees.
- Landings shall be approved by the Department prior to their construction. Progressive short wood landings are permitted along existing woods roads.
- All existing roads and trails shall be kept open to allow for normal use throughout the harvest.
- Harvesting shall be completed in a systematic and progressive manner. Harvest blocks shall be completely harvested prior to harvesting in another block, unless otherwise approved by the Department.
- Leave all snags where they are not a safety risk to the operators.
- All pine in piles between May 15 and August 15 shall be removed from the landings within 21 days.
- Do not damage advanced regeneration or trees not designated for harvest.
- Seasonal Restrictions - No harvesting allowed April 15-July 15 in all blocks due to oak wilt.

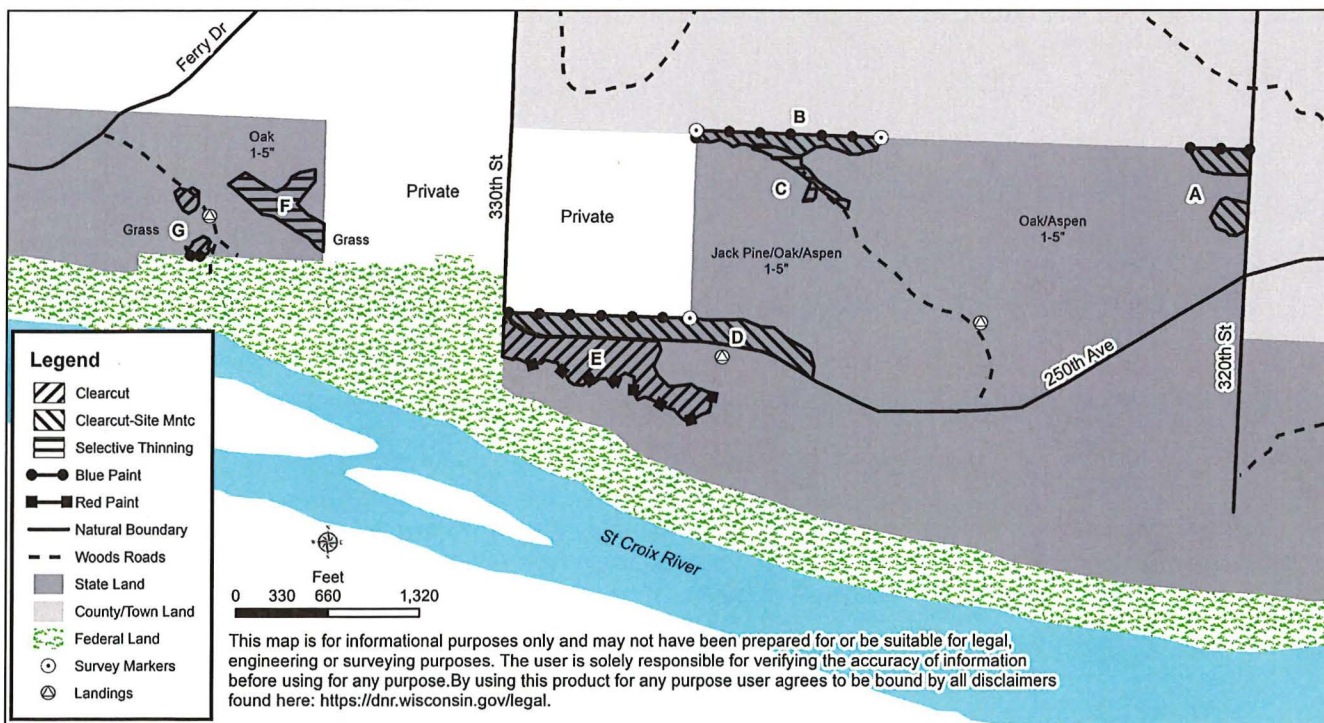

**Note:** In order to fill and save this form electronically, it must be opened using Adobe Reader or Acrobat software. Save a copy of the file, open Adobe Reader, select File > Open and browse for the file you saved.

State of Wisconsin  
Department of Natural Resources  
[dnr.wi.gov](http://dnr.wi.gov)

**Timber Sale Bid**  
Form 2400-049 (R 07/22)

**Notice:** Completion of this form is mandatory. The Department will not recognize your bid unless you complete and submit this form. Personal information collected will be used for program administration and may be provided to requesters as required by Wisconsin's Public Records law [ss. 19.31-19.39, Wis. Stats.].

Date

Bidder Name

Street Address	City	State	ZIP Code
Property Name (if any) Governor Knowles State Forest	Timber Sale Name Curly Road	Tract Number 20-24	

Date and Hour of Bid Opening October 28, 2025 @ 11:00 AM	Minimum Acceptable Bid (optional) \$4,826.00
---	---

Species-All bids including Lump Sum bids must be by species	Utilization Specifications (4 inch/Whole Tree/Logs)	Estimated Volume	Volume Units (tons/cords/mbf)	Price Bid Per Unit	Total Bid Value on Estimated Volume
Oak	4"	550	tons		
Jack Pine	6"	310	tons		
Red Pine	6"	95	tons		
Aspen	4"	45	tons		
Mixed Hardwoods	4"	30	tons		

The award shall be based on this TOTAL BID AMOUNT:

**Performance Bond**

Will be in the form of: (select one)

- |  |   |
|--|---|
| <input type="radio"/> Personal Check               | <input type="radio"/> Assurance Bond                |
| <input type="radio"/> Certified Check/Money Order  | <input type="radio"/> Certificate of Deposit        |
| <input type="radio"/> Irrevocable Letter of Credit | <input type="radio"/> Assignment of Savings Account |

I understand that any or all bids may be rejected and that consideration and awarding of a contract will be based upon my past performance and ability to complete contracts. I also understand that if I am the winning bidder, I have 6 weeks from the date of the bid opening to submit an acceptable performance bond. I also understand that if I am awarded the contract and fail to execute it or work under it, I will be required to forfeit to the Department an amount equal to 10% of my total bid amount. Failure to forfeit the 10% penalty will result in being considered ineligible to bid on any state timber sales for a two-year duration. In the event the highest bidder can not or will not sign the contract, the award may be made to the next highest qualified bid.

☐ By checking this box, I certify that I hold a Wisconsin Master Logger Certification.

**Notice:** I understand:

Utilization specifications and estimated volumes are listed in the prospectus which is available upon request from the Department.

A copy of the standard timber sales contract which must be entered into is available upon request from the Department.

Signature of Bidder
Bidder's Name (Please Print or Type)
Phone Number (include area code)
Email Address



## GOVERNOR KNOWLES STATE FOREST

<b>Timber Sale #/Name:</b> GK / Randall's Ash Sale	<b>Town:</b> Anderson	<b>Legal Description:</b> Sections 4, 5, & 8-T37N- R20W
<b>DNR Tract #:</b> GK 40-22	<b>Comp:</b> 15 <b>Stand:</b> 10, 13	<b>Acres:</b> 47 A-11 B-2 C-34
<b>Sale Expiration Date:</b> June 30, 2029	<b>Mapped By/Date:</b> Mike Wallis 4/7/22	<b>Contractor:</b>

**Minimum Purchase Price = \$2,824.50**

Species/Product	4" Vol. (tons)	Price/ton	Total
Oak Cordwood*	700		
Mixed Hardwoods**	525		
Ash	490		

\*77% Pin Oak, 23% Bur Oak.

\*\*80% Red Maple, 7% Aspen, 8% Birch, 5% Basswood, 1%. 4,520 pound per cord will be used to convert cords to tons.

### Cutting Requirements/Information

**Overstory Removal** - Harvest all pin oak, maple, aspen, basswood, and birch with one or more merchantable sticks. In addition, harvest all bur oak east of the trail with one or more merchantable sticks.

**Clearcut with Reserves** - Harvest all species with one or more merchantable sticks except pine and yellow birch.

### FROZEN GROUND REQUIRED

- Utilization: 4" top DIB. This is a mill scale sale.
- Maximum stump height shall be 10 inches.
- Do not harvest paint marked boundary trees.
- Natural boundaries consist of grass or previously harvested areas with scattered white pine and/or young hardwoods.
- Slash shall be lopped and scattered to a maximum height not to exceed three feet and kept within the sale boundaries.
- Landings shall be approved by the Department prior to their construction.
- An overgrown skid trail between blocks A and C is present from a prior harvest near the north end of block A.
- All existing roads and trails shall be kept open to allow for normal use throughout the harvest. The snowmobile trail shall be kept passable and snow covered while the trail is being groomed for snowmobiling.
- The bridge between blocks A and B is not rated for heavy equipment.
- Harvesting shall be completed in a systematic and progressive manner.
- Leave all snags where they are not a safety risk to the operators. Fell all snags within 50 feet of any existing trails.
- Avoid damage to advanced regeneration or trees not designated for harvest.
- Contractor is required to deliver all pin oak directly to a wood processing facility, minimizing the spread of oak wilt. Only pin oak that is peeled or has loose bark may be sorted and sold as firewood.
- Seasonal Restrictions – Block C requires frozen ground. No harvesting allowed in any blocks April 1-July 31 due to oak wilt and a threatened bird.**

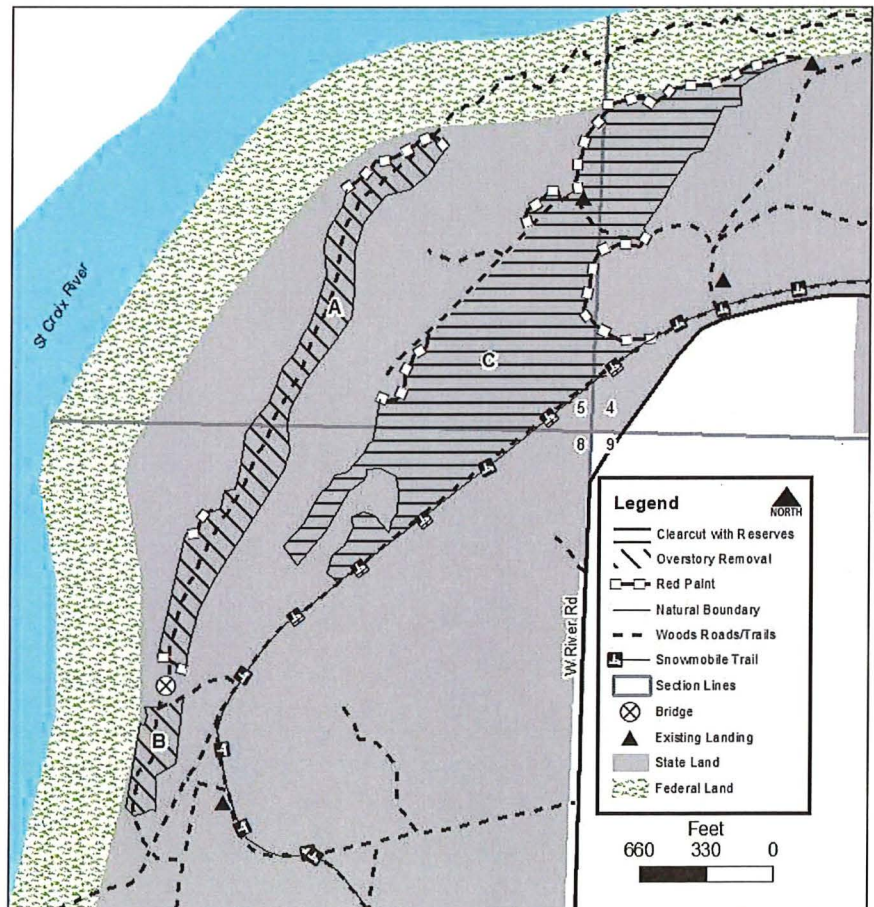

This map is for informational purposes only and may not have been prepared for or be suitable for legal, engineering, or surveying purposes. The user is solely responsible for verifying the accuracy of information before using for any purpose. By using this product for any purpose user agrees to be bound by all disclaimers found here: <https://dnr.wisconsin.gov/legal>.



**Note:** In order to fill and save this form electronically, it must be opened using Adobe Reader or Acrobat software. Save a copy of the file, open Adobe Reader, select File > Open and browse for the file you saved.

State of Wisconsin  
Department of Natural Resources  
[dnr.wi.gov](http://dnr.wi.gov)

## Timber Sale Bid

Form 2400-049 (R 07/22)

**Notice:** Completion of this form is mandatory. The Department will not recognize your bid unless you complete and submit this form. Personal information collected will be used for program administration and may be provided to requesters as required by Wisconsin's Public Records law [ss. 19.31-19.39, Wis. Stats.].

Date

Bidder Name

Street Address

City

State

ZIP Code

Property Name (if any)

Governor Knowles State Forest

Timber Sale Name

Randall's Ash

Tract Number

40-22

Date and Hour of Bid Opening

October 28, 2025 @ 11:00 AM

Minimum Acceptable Bid (optional)

\$2,824.50

Species-All bids including Lump Sum bids must be by species	Utilization Specifications (4 inch/Whole Tree/Logs)	Estimated Volume	Volume Units (tons/cords/mbf)	Price Bid Per Unit	Total Bid Value on Estimated Volume
Oak	4"	700	tons		
Mixed Hardwoods	4"	525	tons		
Ash	4"	490	tons		

The award shall be based on this TOTAL BID AMOUNT:

### Performance Bond

Will be in the form of: (select one)

☐ Personal Check

☐ Assurance Bond

☐ Certified Check/Money Order

☐ Certificate of Deposit

☐ Irrevocable Letter of Credit

☐ Assignment of Savings Account

I understand that any or all bids may be rejected and that consideration and awarding of a contract will be based upon my past performance and ability to complete contracts. I also understand that if I am the winning bidder, I have 6 weeks from the date of the bid opening to submit an acceptable performance bond. I also understand that if I am awarded the contract and fail to execute it or work under it, I will be required to forfeit to the Department an amount equal to 10% of my total bid amount. Failure to forfeit the 10% penalty will result in being considered ineligible to bid on any state timber sales for a two-year duration. In the event the highest bidder can not or will not sign the contract, the award may be made to the next highest qualified bid.

☐ By checking this box, I certify that I hold a Wisconsin Master Logger Certification.

**Notice:** I understand:

Utilization specifications and estimated volumes are listed in the prospectus which is available upon request from the Department.

A copy of the standard timber sales contract which must be entered into is available upon request from the Department.

Signature of Bidder

Bidder's Name (Please Print or Type)

Phone Number (include area code)

Email Address



## GOVERNOR KNOWLES STATE FOREST

<b>Timber Sale #/Name:</b> GK /Freezer Meat Sale	<b>Town:</b> West Marshland (W)	<b>Legal Description:</b> Sec. 21, 28, 29, 30, & 31-T39N-R19W
<b>DNR Tract #:</b> GK 10-25	<b>Comp:</b> 22/23 <b>Stand:</b> 1, 2, 20/9, 12, 28, 30	<b>Acres: 130</b> A-29, B-5, C-39, D-10, E-13, F-22, G-9, RMZ-3
<b>Sale Expiration Date:</b> <b>June 30, 2029</b>	<b>Mapped By/Date:</b> Mike Wallis 5/21/25	<b>Contractor:</b>

MINIMUM BID: \$45,170.50

Species/Product	4" Vol. (tons)	Price/Ton	Total
White Pine*	1900	\$	\$
Red Pine**	750	\$	\$
Ash	575	\$	\$
Oak	430		\$
Mixed Hardwoods***	280	\$	\$





\*less than 1% balsam fir, \*\*13% Jack pine,

\*\*\* 49% aspen, 24% red maple, 16% birch, 11% basswood

Total

- 4,500 POUNDS PER CORD WILL BE USED TO CONVERT MIXED HARDWOOD CORD SCALES TO TONS. ALL OTHER SPECIES WILL BE CONVERTED ACCORDING TO DNR HANDBOOK
- BLOCKS A, B, AND THE RMZ REQUIRE WELL FROZEN GROUND
- Mill Scale Sale with deferred payment for eligible contractors.

### Cutting Requirements/Information

-  **Clearcut** (Block D) - Harvest all species with one or more merchantable sticks except Jack pine and white pine less than 12" DBH.
-  **Overstory Removal** (Block B, C, F) – Harvest all pine 12" DBH and greater and harvest all other species with one or more merchantable sticks. (Block E, G) – Harvest all white pine 12" DBH and greater, harvest all red pine marked with orange paint, and harvest all other species with one or more merchantable sticks.
-  **Select Harvest** (Block A) - Harvest all pine 12" DBH and greater and harvest all other species with one or more merchantable sticks except maple, fir, yellow birch, and tamarack.
-  **RMZ Select Harvest** – Harvest all ash with one or more merchantable sticks.

1. Utilization: 4" top DIB. This is a mill scale sale.
2. Do not harvest paint marked boundary trees.
3. Maximum stump height shall be 10 inches.
4. Slash shall be kept within the sale boundaries and scattered to a maximum height not to exceed 3 feet throughout the harvest area.
5. Landings shall be approved by the Department prior to their construction. Progressive short wood landings may be permitted along existing woods roads. A forest opening is located near the center of block C and can be accessed using woods roads. If reduced skid distance is needed for blocks A and B, a landing in the ROW on Ferry Road or a landing constructed north of Ferry Road in block A is recommended. The Contractor is responsible for constructing landings and getting Town approval to pile wood in Town ROW's.
6. All existing roads and trails shall be kept open to allow for normal use throughout the harvest. The woods road from Paint Mine Rd to block F will need to be brushed back by the Contractor.
7. Do not operate equipment within 15 feet of the stream.
8. Harvesting shall be completed in a systematic and progressive manner. Harvest blocks shall be completely harvested prior to harvesting in another block, unless otherwise approved by the Department.
9. Leave all snags where they are not a safety risk to the operators.
10. All pine in piles between May 15 and August 15 shall be removed from the sale within 21 days.
11. Do not damage advanced regeneration or trees not designated for harvest.
12. Seasonal Restrictions - No harvesting allowed from April 15 to July 15 in all blocks due to oak wilt. Harvest operations in blocks A, B, and the RMZ require well frozen ground conditions. Block B doesn't require frozen ground to harvest, but access to this block requires frozen ground.

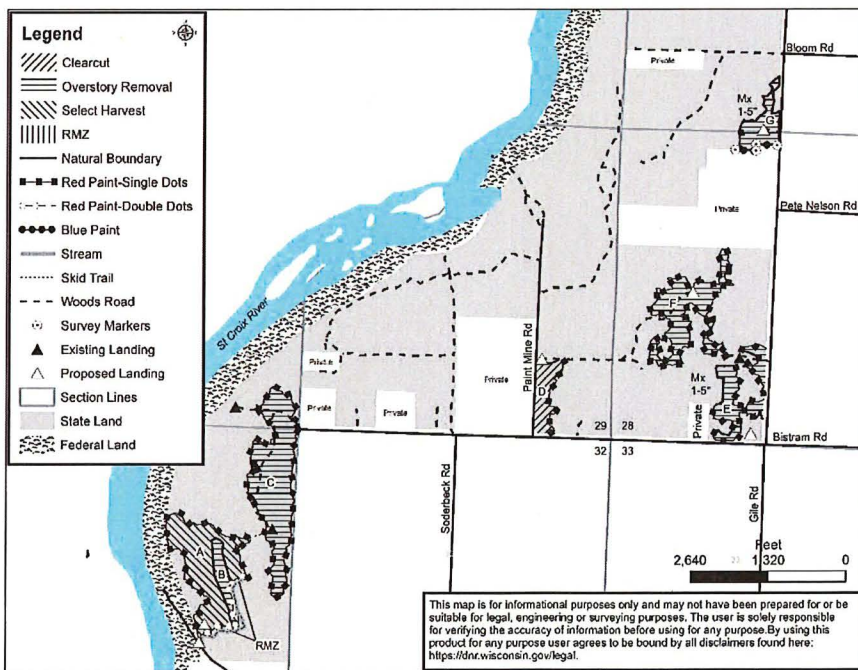





## GOVERNOR KNOWLES STATE FOREST TRACT 10-25

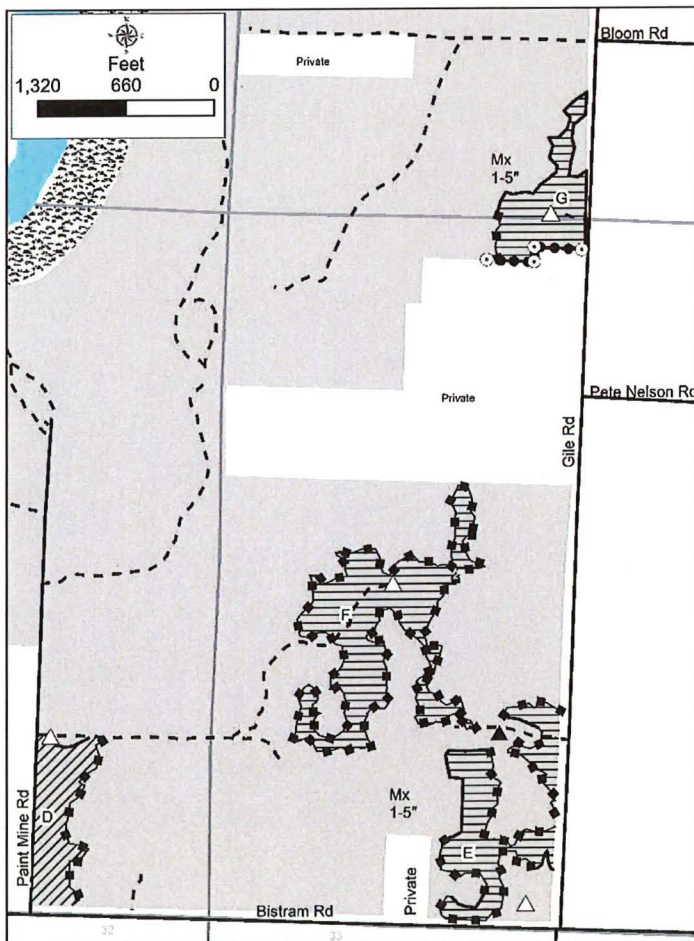
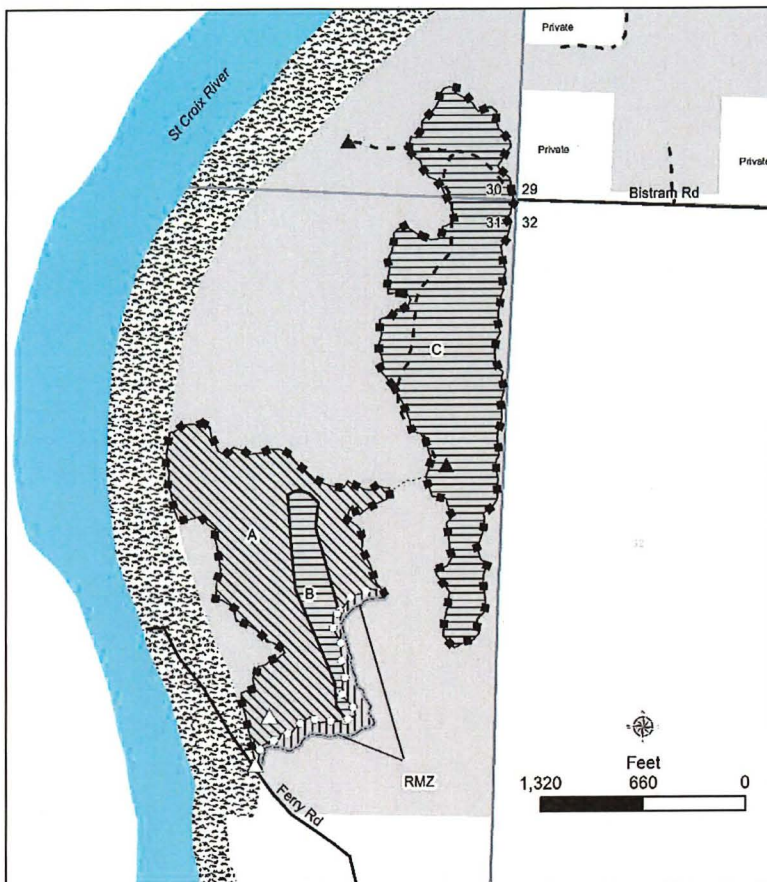

### Legend

- Clearcut
- Overstory Removal
- Select Harvest
- RMZ
- Natural Boundary
- Red Paint-Single Dots
- Red Paint-Double Dots
- Blue Paint
- Stream
- Skid Trail
- Woods Road
- Survey Markers
- Existing Landing
- Proposed Landing
- Section Lines
- State Land
- Federal Land

These maps are for informational purposes only and may not have been prepared for or be suitable for legal, engineering, or surveying purposes. The user is solely responsible for verifying the accuracy of information before using for any purpose. By using this product for any purpose user agrees to be bound by all disclaimers found here: <https://dnr.wisconsin.gov/legal>.

**Note:** In order to fill and save this form electronically, it must be opened using Adobe Reader or Acrobat software. Save a copy of the file, open Adobe Reader, select File > Open and browse for the file you saved.

State of Wisconsin  
Department of Natural Resources  
[dnr.wi.gov](http://dnr.wi.gov)

## Timber Sale Bid

Form 2400-049 (R 07/22)

**Notice:** Completion of this form is mandatory. The Department will not recognize your bid unless you complete and submit this form. Personal information collected will be used for program administration and may be provided to requesters as required by Wisconsin's Public Records law [ss. 19.31-19.39, Wis. Stats.].

Date

Bidder Name

Street Address		City	State	ZIP Code
Property Name (if any) Governor Knowles State Forest		Timber Sale Name Freezer Meat		Tract Number 10-25

Date and Hour of Bid Opening

October 28, 2025 @ 11:00 AM

Minimum Acceptable Bid (optional)

\$45,170.50

Species-All bids including Lump Sum bids must be by species	Utilization Specifications (4 inch/Whole Tree/Logs)	Estimated Volume	Volume Units (tons/cords/mbf)	Price Bid Per Unit	Total Bid Value on Estimated Volume
White Pine	4"	1,900	tons		
Red Pine	4"	750	tons		
Ash	4"	575	tons		
Oak	4"	430	tons		
Mixed Hardwoods	4"	280	tons		

The award shall be based on this TOTAL BID AMOUNT:

### Performance Bond

Will be in the form of: (select one)

- |  |   |
|--|---|
| <input type="radio"/> Personal Check               | <input type="radio"/> Assurance Bond                |
| <input type="radio"/> Certified Check/Money Order  | <input type="radio"/> Certificate of Deposit        |
| <input type="radio"/> Irrevocable Letter of Credit | <input type="radio"/> Assignment of Savings Account |

I understand that any or all bids may be rejected and that consideration and awarding of a contract will be based upon my past performance and ability to complete contracts. **I also understand that if I am the winning bidder, I have 6 weeks from the date of the bid opening to submit an acceptable performance bond. I also understand that if I am awarded the contract and fail to execute it or work under it, I will be required to forfeit to the Department an amount equal to 10% of my total bid amount.** Failure to forfeit the 10% penalty will result in being considered ineligible to bid on any state timber sales for a two-year duration. In the event the highest bidder can not or will not sign the contract, the award may be made to the next highest qualified bid.

☐ By checking this box, I certify that I hold a Wisconsin Master Logger Certification.

**Notice:** I understand:

Utilization specifications and estimated volumes are listed in the prospectus which is available upon request from the Department.

A copy of the standard timber sales contract which must be entered into is available upon request from the Department.

Signature of Bidder

Bidder's Name (Please Print or Type)

Phone Number (include area code)

Email Address





## GOVERNOR KNOWLES STATE FOREST

<b>Timber Sale #/Name:</b> GK /Black Wolf Sale	<b>Town:</b> West Marshland (W) & Union	<b>Legal Description:</b> Sec. 30-T40N-R18W Sec. 25 & 36-T40N-R19W
<b>DNR Tract #:</b> GK 20-25	<b>Comp:</b> 28 <b>Stand:</b> 4, 7, 24	<b>Acres: 23</b> A-7, B-12, C-4
<b>Sale Expiration Date:</b> December 31, 2027	<b>Mapped By/Date:</b> Mike Wallis 5/21/25	<b>Contractor:</b>

MINIMUM BID: \$5,065.00

Species/Product	4" Vol. (tons)	Price/Ton	Total
Red Pine*	525	\$	\$
Oak	100	\$	\$
Aspen	90	\$	\$

\*approximately 7% Jack pine, block B 50% bolts, block A 14" average DBH

Total \$

Mill Scale Sale with deferred payment for eligible contractors.

### Cutting Requirements/Information

 **Clearcut** (Block C) - Harvest all species with one or more merchantable sticks.

 **Overstory Removal** (Block A) – Harvest all red pine and oak with one or more merchantable sticks.

 **Select Harvest** (Block B) - Harvest all trees marked with orange paint.

- Utilization: 4" top DIB. This is a mill scale sale.
- Do not harvest paint marked boundary trees.
- Maximum stump height shall be 10 inches.
- Slash shall be kept within the sale boundaries and scattered to a maximum height not to exceed 3 feet throughout the harvest area. Remove slash from existing roads and trails.
- Landings shall be approved by the Department prior to their construction. Progressive short wood landings may be permitted along existing woods roads.
- All existing roads and trails shall be kept open to allow for normal use throughout the harvest. The woods road from Bang Road through block C is a hiking trail and may be used for hauling from block A to Bang Road. Do not drive on the remainder of the hiking trail except to forward wood in block C. The Contractor is responsible for restoring the hiking trail to its original condition. The woods road from Riegel Lane to block B will need to be brushed back by the Contractor if needed for hauling.
- Do not operate equipment within 15 feet of the stream.
- Harvesting shall be completed in a systematic and progressive manner. Harvest blocks shall be completely harvested prior to harvesting in another block, unless otherwise approved by the Department.
- Leave all snags where they are not a safety risk to the operators.
- All pine in piles between May 15 and August 15 shall be removed from the sale within 21 days of being cut.
- Do not damage advanced regeneration or trees not designated for harvest.
- Seasonal Restrictions - No harvesting allowed from April 15 to July 15 in all blocks due to oak wilt.

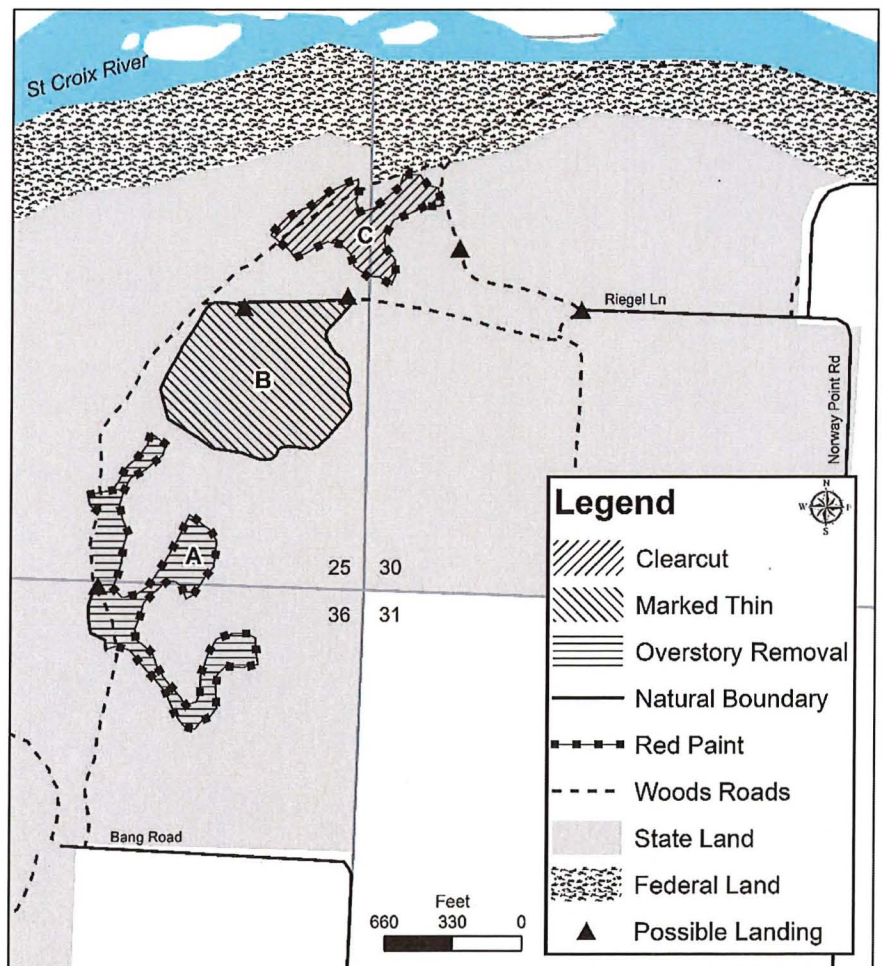

This map is for informational purposes only and may not have been prepared for or be suitable for legal, engineering or surveying purposes. The user is solely responsible for verifying the accuracy of information before using for any purpose. By using this product for any purpose user agrees to be bound by all disclaimers found here: <https://dnr.wisconsin.gov/legal>.

**Note:** In order to fill and save this form electronically, it must be opened using Adobe Reader or Acrobat software. Save a copy of the file, open Adobe Reader, select File > Open and browse for the file you saved.

State of Wisconsin  
Department of Natural Resources  
[dnr.wi.gov](http://dnr.wi.gov)

## Timber Sale Bid

Form 2400-049 (R 07/22)

**Notice:** Completion of this form is mandatory. The Department will not recognize your bid unless you complete and submit this form. Personal information collected will be used for program administration and may be provided to requesters as required by Wisconsin's Public Records law [ss. 19.31-19.39, Wis. Stats.].

Date

Bidder Name

Street Address		City	State	ZIP Code
Property Name (if any) Governor Knowles State Forest		Timber Sale Name Black Wolf		Tract Number 20-25

Date and Hour of Bid Opening October 28, 2025 @ 11:00 AM	Minimum Acceptable Bid (optional) \$5,065.00
---	---

Species-All bids including Lump Sum bids must be by species	Utilization Specifications (4 inch/Whole Tree/Logs)	Estimated Volume	Volume Units (tons/cords/mbf)	Price Bid Per Unit	Total Bid Value on Estimated Volume
Red Pine	4"	525	tons		
Oak	4"	100	tons		
Aspen	4"	90	tons		

The award shall be based on this TOTAL BID AMOUNT:

### Performance Bond

Will be in the form of: (select one)

- |  |   |
|--|---|
| <input type="radio"/> Personal Check               | <input type="radio"/> Assurance Bond                |
| <input type="radio"/> Certified Check/Money Order  | <input type="radio"/> Certificate of Deposit        |
| <input type="radio"/> Irrevocable Letter of Credit | <input type="radio"/> Assignment of Savings Account |

I understand that any or all bids may be rejected and that consideration and awarding of a contract will be based upon my past performance and ability to complete contracts. I also understand that if I am the winning bidder, I have 6 weeks from the date of the bid opening to submit an acceptable performance bond. I also understand that if I am awarded the contract and fail to execute it or work under it, I will be required to forfeit to the Department an amount equal to 10% of my total bid amount. Failure to forfeit the 10% penalty will result in being considered ineligible to bid on any state timber sales for a two-year duration. In the event the highest bidder can not or will not sign the contract, the award may be made to the next highest qualified bid.

☐ By checking this box, I certify that I hold a Wisconsin Master Logger Certification.

### Notice: I understand:

Utilization specifications and estimated volumes are listed in the prospectus which is available upon request from the Department.

A copy of the standard timber sales contract which must be entered into is available upon request from the Department.

Signature of Bidder
Bidder's Name (Please Print or Type)
Phone Number (include area code)
Email Address



# STRAIGHT LAKE STATE PARK

MAPPED BY: PAUL HEIMSTEAD 715-410-8316	PROJECT TYPE: TIMBER SALE	TIMBER SALE NUMBER (ASSIGNED ONCE SOLD) 4902-XXX
DATE DRAWN: 4-2-25	PROPERTY : 4902      COMPARTMENT: 210      STAND: 5, 16	CONTRACTOR:
TOWN: LUCK	DNR TRACT #: STRAIGHT LAKE 1-25	EXPIRATION DATE: JULY 1, 2028
TOWNSHIP/ RANGE/ SECTION T36 R17W SECTION 13	ACRES: <b>80 ACRES -</b>	<b>BSA SHARPSHOOTER</b>

Estimated Volume	Logs	Pulp
Red Oak	92 MBF	100 cds
Ash	25 MBF	
MX (Hic, Maple, White Oak, Birch)	11 MBF	100 cds
Basswood	19 MBF	25 cds
Aspen		130 cds
Minimum Advertised Value	<b>\$ 32,850.00</b>	

## Lump Sum Sale

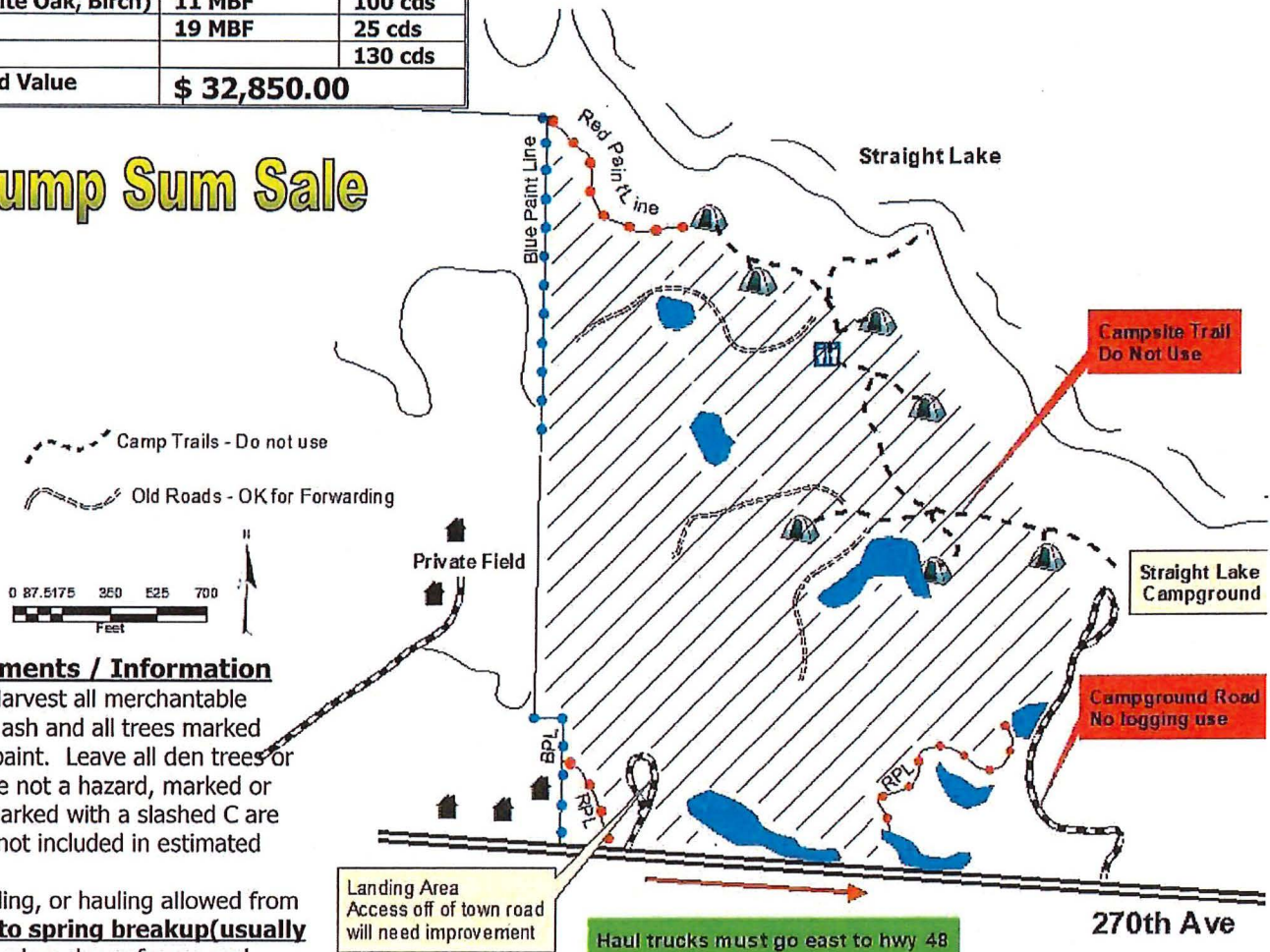

### Cutting Requirements / Information

1. Sale Area – Harvest all merchantable aspen, birch, ash and all trees marked with orange paint. Leave all den trees or snags that are not a hazard, marked or not. Trees marked with a slashed C are optional and not included in estimated volume.
2. Cutting, skidding, or hauling allowed from **October 1<sup>st</sup> to spring breakup (usually mid march)** when dry or frozen and rutting will not occur. Operations must cease if rutting occurs. No operations during regular gun deer season.
3. Wisconsin BMP's for water quality must be followed around any wetlands and/or vernal pools.
4. Care must be taken to avoid damage to residual trees. No tops or trees are to be left hanging in standing trees and slash must be lopped to below 3 feet and kept within sale area.
5. Wood Utilization Minimum; merchantable 100 inch stick to a 4" top.
6. Access is off of 270<sup>th</sup> Ave. Landing will need clearing. No new roads will be built in the sale area. Existing access (ditch) will have to be improved.
7. Access must be closed and blocked at sale completion.
8. This is a lump sum sale for all products. No guarantee that volume will cut out as estimated. Payment may be split into two blocks if requested.

**Description of Stumpage:** This is a 80 acre timber sale of mainly mature oak and northern hardwood sawlogs and pulpwood. Aspen and birch is mostly along the road. Down trees from old wind damage is present. Volume estimation is based on 100% tally. Topwood of sawtimber was estimated. Campground road and trail will not be used with minimal crossings. Campsites are in the sale area and care must be taken. Bid price should reflect long skid and extra effort.

This map is for informational purposes only and may not have been prepared for or be suitable for legal, engineering or surveying purposes. The user is solely responsible for verifying the accuracy of information before using for any purpose.

By using this product for any purpose user agrees to be bound by all disclaimers found here: <https://dnr.wisconsin.gov/legal>.

State of Wisconsin  
Department of Natural Resources  
[dnr.wi.gov](http://dnr.wi.gov)

**Timber Sale Bid**  
Form 2400-049 (R 07/22)

**Notice:** Completion of this form is mandatory. The Department will not recognize your bid unless you complete and submit this form. Personal information collected will be used for program administration and may be provided to requesters as required by Wisconsin's Public Records law [ss. 19.31-19.39, Wis. Stats.].

Date

Bidder Name

Street Address

City

State

ZIP Code

Property Name (if any)  
Stright Lake State Park

Timber Sale Name  
BSA Sharpshooter

Tract Number  
1-25

Date and Hour of Bid Opening

11:00am on 10-28-2025

Minimum Acceptable Bid (optional)

\$32,850.00

Species-All bids including Lump Sum bids must be by species	Utilization Specifications (4 inch/Whole Tree/Logs)	Estimated Volume	Volume Units (tons/cords/mbf)	Price Bid Per Unit	Total Bid Value on Estimated Volume
Red Oak	Logs	92	MBF		
Ash	Logs	25	MBF		
Mx Hdwd	Logs	11	MBF		
Basswood	Logs	19	MBF		
Oak	Pulp	100	Cords		
Mx Hdwd	Pulp	100	Cords		
Basswood	Pulp	25	Cords		
Aspen	Bolts/Pulp	130	Cords		

**Lump Sum**

The award shall be based on this TOTAL BID AMOUNT:

Performance Bond

Will be in the form of: (select one)

☐ Personal Check

☐ Assurance Bond

☐ Certified Check/Money Order

☐ Certificate of Deposit

☐ Irrevocable Letter of Credit

☐ Assignment of Savings Account

I understand that any or all bids may be rejected and that consideration and awarding of a contract will be based upon my past performance and ability to complete contracts. I also understand that if I am the winning bidder, I have 6 weeks from the date of the bid opening to submit an acceptable performance bond. I also understand that if I am awarded the contract and fail to execute it or work under it, I will be required to forfeit to the Department an amount equal to 10% of my total bid amount. Failure to forfeit the 10% penalty will result in being considered ineligible to bid on any state timber sales for a two-year duration. In the event the highest bidder can not or will not sign the contract, the award may be made to the next highest qualified bid.

☐ By checking this box, I certify that I hold a Wisconsin Master Logger Certification.

**Notice:** I understand:

Utilization specifications and estimated volumes are listed in the prospectus which is available upon request from the Department.

A copy of the standard timber sales contract which must be entered into is available upon request from the Department.

Signature of Bidder

Bidder's Name (Please Print or Type)

Phone Number (include area code)

Email Address



# STATE MANAGED LANDS – POLK CO.

<b>MAPPED BY:</b> PAUL HEIMSTEAD 715-410-8316	<b>PROJECT TYPE:</b> TIMBER SALE	<b>TIMBER SALE NUMBER (ASSIGNED ONCE SOLD)</b> 4948- XXX
<b>DATE DRAWN:</b> 4-7-25	<b>PROPERTY:</b> 4948	<b>COMPARTMENT:</b> 18
<b>TOWN:</b> APPLE RIVER	<b>STAND:</b> 2	<b>CONTRACTOR:</b>
<b>TOWNSHIP/ RANGE/ SECTION</b> T34 R16W SECTION 32	<b>DNR TRACT #:</b> OMER SPRINGS 2-25	<b>EXPIRATION DATE:</b> JULY 1, 2028
	<b>ACRES:</b> 8.5 ACRE OVERSTORY REMOVAL/CLEARCUT	<b>OMER SPRINGS</b>

<b>Estimated Volume</b>	<b>Logs</b>	<b>Pulp</b>
<b>Mx Hdwd</b>	19 MBF	80 cords
<b>Basswood</b>	5 MBF	20 cords
<b>Minimum Advertised Value</b>	<b>\$3,275.00</b>	

Mx Hdwd = Red Maple, Black and White  
Ash, Red Oak, Hickory.

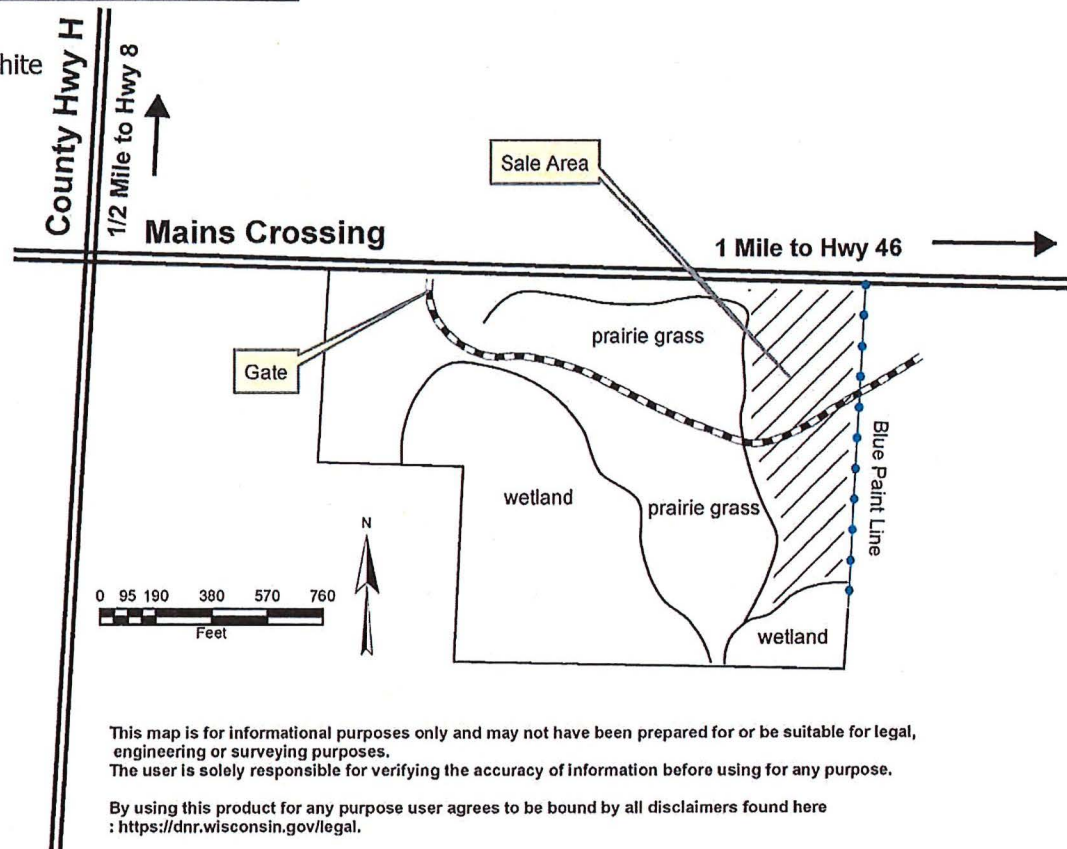

## Cutting Requirements / Information

1. Harvest all merchantable trees that will make 2 sticks or greater except leave all bur and white oak and any pine.
2. No cutting, skidding, or hauling during spring breakup or during wet periods when rutting may occur. Operations must cease if rutting occurs at any time.
3. No sale activity during regular gun deer season.
4. No equipment within 15 feet of any wetlands unless frozen. No slash or decking in wetlands. Wisconsin BMP's for water quality will be followed.
5. Care must be taken to avoid damage to residual trees. No tops or trees are to be left hanging in standing trees and slash must be lopped to below 3 feet and kept within sale area.
6. Wood Utilization minimum – merchantable 100 inch stick, 4 inch on small end.
7. Access road is also snowmobile trail. Trail must remain passable and snow-covered when trails are open.
8. Landing will be in field to the west of sale. All roads used will be cleared and smoothed as needed and at completion of sale.
9. This is a mill scale sale for all products. State reserves right to scale all wood on landing.
10. Access to the sale is off Mains Crossing 1/2 mile south of Hwy 8 and 1 mile west of HWY 46.

**Description of Stumpage:** Overstory removal/clear cut with reserves. Large diameter scattered sawtimber. Quality variable. 2+ year Contract.

State of Wisconsin  
Department of Natural Resources  
[dnr.wi.gov](http://dnr.wi.gov)

**Timber Sale Bid**  
Form 2400-049 (R 07/22)

**Notice:** Completion of this form is mandatory. The Department will not recognize your bid unless you complete and submit this form. Personal information collected will be used for program administration and may be provided to requesters as required by Wisconsin's Public Records law [ss. 19.31-19.39, Wis. Stats.].

Date

Bidder Name

Street Address

City

State

ZIP Code

Property Name (if any)  
Omer Springs - Polk County

Timber Sale Name  
Omer Springs

Tract Number  
2-25

Date and Hour of Bid Opening

11:00 AM on 10-28-2025

Minimum Acceptable Bid (optional)

\$3,275.00

Species-All bids including Lump Sum bids must be by species	Utilization Specifications (4 inch/Whole Tree/Logs)	Estimated Volume	Volume Units (tons/cords/mbf)	Price Bid Per Unit	Total Bid Value on Estimated Volume
Mx Hardwood	Logs	19	MBF		
Basswood	Logs	5	MBF		
Mx Hardwood	Pulp 4 inch	80	Cords		
Basswood	Pulp 4 inch	20	Cords		

The award shall be based on this TOTAL BID AMOUNT:

**Performance Bond**

Will be in the form of: (select one)

☐ Personal Check

☐ Assurance Bond

☐ Certified Check/Money Order

☐ Certificate of Deposit

☐ Irrevocable Letter of Credit

☐ Assignment of Savings Account

I understand that any or all bids may be rejected and that consideration and awarding of a contract will be based upon my past performance and ability to complete contracts. I also understand that if I am the winning bidder, I have 6 weeks from the date of the bid opening to submit an acceptable performance bond. I also understand that if I am awarded the contract and fail to execute it or work under it, I will be required to forfeit to the Department an amount equal to 10% of my total bid amount. Failure to forfeit the 10% penalty will result in being considered ineligible to bid on any state timber sales for a two-year duration. In the event the highest bidder can not or will not sign the contract, the award may be made to the next highest qualified bid.

☐ By checking this box, I certify that I hold a Wisconsin Master Logger Certification.

**Notice:** I understand:

Utilization specifications and estimated volumes are listed in the prospectus which is available upon request from the Department.

A copy of the standard timber sales contract which must be entered into is available upon request from the Department.

Signature of Bidder

Bidder's Name (Please Print or Type)

Phone Number (include area code)

Email Address



## Amsterdam Sloughs Wildlife Area

Mapped By: <b>Garrett Riewestahl</b>			Sale Name <b>Popple Fuzz</b>		Tract # <b>711-125</b>
Date Drawn <b>06/16/2025</b>			Acres <b>85</b>		Contract Term <b>6/30/2028</b>
County <b>Burnett</b>			Town <b>Daniels, Lincoln</b>		Sale Method <b>Scaled</b>
Twp	Range	Section	Comp	Stand	Utilization Standards
<b>39N</b>	<b>17W</b>	<b>36</b>	<b>147</b>	<b>14</b>	<b>4" top OR</b>
<b>38N</b>	<b>17W</b>	<b>1, 2</b>	<b>145</b>	<b>1, 4</b>	<b>Whole Tree</b>

**Aspen 4" top**

**2150 Tons – 2.25 Tons/Cord**

**Mixed Hardwood 4" top**

**1600 Tons – 2.40 Tons/Cord**

**Oak 4" top**

**1250 Tons – 2.75 Tons/Cord**

**Whole Tree All Sp. Mix**

**6500 Tons – 2.40 Tons/Cord**

**TOTAL MINIMUM SALE VALUE \$34,500**

*See map on reverse side*

### **Special Contract Restrictions:**

- 1. Harvesting operations limited to frozen ground conditions.**
2. Harvest all designated trees with at least one stick to a 4" top diameter. Whole tree harvesting allowed.
3. All landings and roadwork shall be approved by the Department prior to construction.
4. Woods trails and roads must remain open and free of debris during logging operation.
5. Existing trails shall be restored by the contractor to the satisfaction of the Department.
6. Gates to sale will remain closed and locked during non-work hours.
7. All wood cut or in piles shall be removed within 30 days.
8. All slash shall be lopped, scattered, or crushed to within 2' of the ground. No slash is to be left in any wetland. If whole tree harvesting 10% of tops shall be left scattered on site.
9. Protect survey monument shown on timber sale map. Damage will result in restoration costs paid by the contractor.
10. Leave as many snags as possible if they do not compromise safety.

DNR Contact: Garrett Riewestahl (715) 410-8318    garrett.riewestahl@wisconsin.gov

\* This map is for informational purposes only and may not have been prepared for or be suitable for legal, engineering or surveying purposes. The user is solely responsible for verifying the accuracy of information before using for any purpose. By using this product for any purpose user agrees to be bound by all disclaimers found here: <https://dnr.wisconsin.gov/legal>.

\*\*These Lands are 3<sup>rd</sup> party certified.

# Amsterdam Sloughs Wildlife Area

## Tract 711-125 "Popple Fuzz"

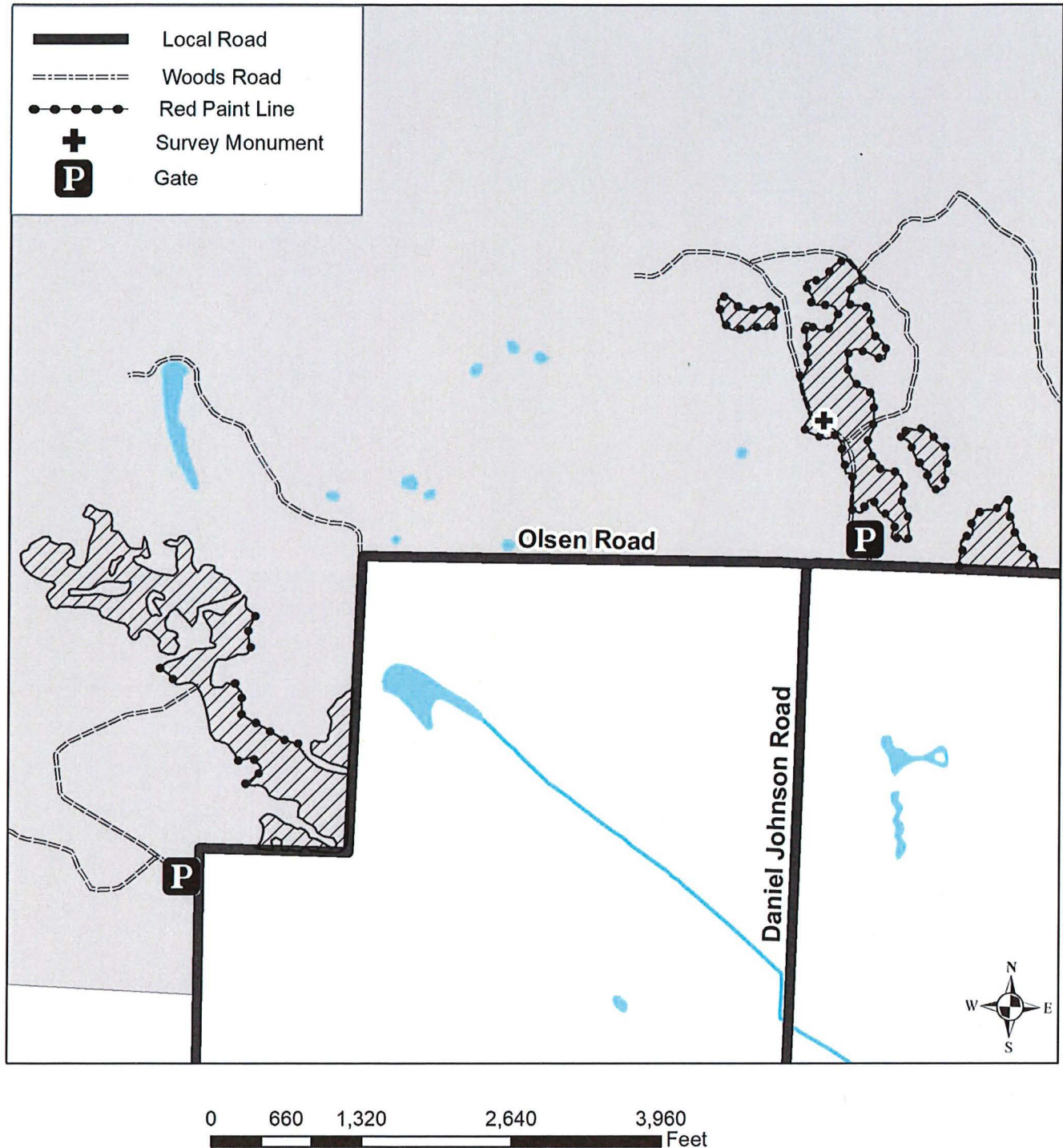

Aspen/Oak Coppice: (85 acres) Harvest all hardwood stems with at least one merchantable stick. Leave all conifer, white oak, and green marked stems un-cut and un-damaged. Site maintenance required on all stems 2" DBH and greater.



\* This map is for informational purposes only and may not have been prepared for or be suitable for legal, engineering or surveying purposes. The user is solely responsible for verifying the accuracy of information before using for any purpose. By using this product for any purpose user agrees to be bound by all disclaimers found here: <https://dnr.wisconsin.gov/legal>.

\*\*These Lands are 3<sup>rd</sup> party certified.



State of Wisconsin  
Department of Natural Resources  
[dnr.wi.gov](http://dnr.wi.gov)

**Timber Sale Bid**  
Form 2400-049 (R 07/22)

**Notice:** Completion of this form is mandatory. The Department will not recognize your bid unless you complete and submit this form. Personal information collected will be used for program administration and may be provided to requesters as required by Wisconsin's Public Records law [ss. 19.31-19.39, Wis. Stats.].

Date

Bidder Name

Street Address

City

State

ZIP Code

Property Name (if any)

Amsterdam Sloughs Wildlife Area

Timber Sale Name

Popple Fuzz

Tract Number

711-125

Date and Hour of Bid Opening

11:00AM on 10/28/2025

Minimum Acceptable Bid (optional)

\$34,500.00

Species-All bids including Lump Sum bids must be by species	Utilization Specifications (4 inch/Whole Tree/Logs)	Estimated Volume	Volume Units (tons/cords/mbf)	Price Bid Per Unit	Total Bid Value on Estimated Volume
Aspen	4"	2,150	Tons		
Mixed Hardwood	4"	1,600	Tons		
Oak	4"	1,250	Tons		

The award shall be based on this TOTAL BID AMOUNT:

**Performance Bond**

Will be in the form of: (select one)

☐ Personal Check

☐ Assurance Bond

☐ Certified Check/Money Order

☐ Certificate of Deposit

☐ Irrevocable Letter of Credit

☐ Assignment of Savings Account

I understand that any or all bids may be rejected and that consideration and awarding of a contract will be based upon my past performance and ability to complete contracts. I also understand that if I am the winning bidder, I have 6 weeks from the date of the bid opening to submit an acceptable performance bond. I also understand that if I am awarded the contract and fail to execute it or work under it, I will be required to forfeit to the Department an amount equal to 10% of my total bid amount. Failure to forfeit the 10% penalty will result in being considered ineligible to bid on any state timber sales for a two-year duration. In the event the highest bidder can not or will not sign the contract, the award may be made to the next highest qualified bid.

☐ By checking this box, I certify that I hold a Wisconsin Master Logger Certification.

**Notice:** I understand:

Utilization specifications and estimated volumes are listed in the prospectus which is available upon request from the Department.

A copy of the standard timber sales contract which must be entered into is available upon request from the Department.

Signature of Bidder

Bidder's Name (Please Print or Type)

Phone Number (include area code)

Email Address

State of Wisconsin  
Department of Natural Resources  
[dnr.wi.gov](http://dnr.wi.gov)

**Timber Sale Bid**  
Form 2400-049 (R 07/22)

**Notice:** Completion of this form is mandatory. The Department will not recognize your bid unless you complete and submit this form. Personal information collected will be used for program administration and may be provided to requesters as required by Wisconsin's Public Records law [ss. 19.31-19.39, Wis. Stats.].

Date

Bidder Name

Street Address

City

State

ZIP Code

Property Name (if any)

Amsterdam Sloughs Wildlife Area

Timber Sale Name

Popple Fuzz

Tract Number

711-125

Date and Hour of Bid Opening

11:00AM on 10/28/2025

Minimum Acceptable Bid (optional)

\$34,500.00

Species-All bids including Lump Sum bids must be by species	Utilization Specifications (4 inch/Whole Tree/Logs)	Estimated Volume	Volume Units (tons/cords/mbf)	Price Bid Per Unit	Total Bid Value on Estimated Volume
MIXED SPECIES - ALL	Whole Tree	6,500	Tons		

The award shall be based on this TOTAL BID AMOUNT:

**Performance Bond**

Will be in the form of: (select one)

☐ Personal Check

☐ Assurance Bond

☐ Certified Check/Money Order

☐ Certificate of Deposit

☐ Irrevocable Letter of Credit

☐ Assignment of Savings Account

I understand that any or all bids may be rejected and that consideration and awarding of a contract will be based upon my past performance and ability to complete contracts. I also understand that if I am the winning bidder, I have 6 weeks from the date of the bid opening to submit an acceptable performance bond. I also understand that if I am awarded the contract and fail to execute it or work under it, I will be required to forfeit to the Department an amount equal to 10% of my total bid amount. Failure to forfeit the 10% penalty will result in being considered ineligible to bid on any state timber sales for a two-year duration. In the event the highest bidder can not or will not sign the contract, the award may be made to the next highest qualified bid.

☐ By checking this box, I certify that I hold a Wisconsin Master Logger Certification.

**Notice:** I understand:

Utilization specifications and estimated volumes are listed in the prospectus which is available upon request from the Department.

A copy of the standard timber sales contract which must be entered into is available upon request from the Department.

Signature of Bidder

Bidder's Name (Please Print or Type)

Phone Number (include area code)

Email Address



# Crex Meadows Wildlife Area

Mapped By:			Timber Sale Name		Contract #
<b>Jake Lindberg</b>			<b>Kohler Peat Conversion</b>		<b>780-125</b>
Date Created			Comp	Stand	Contractor
<b>8/29/2025</b>			<b>32</b>	<b>2,17,20,25,26</b>	
Town			DNR Tract #		Expiration Date
<b>Union</b>			<b>780-125</b>		<b>12/31/2027</b>
Twp	Range	Section	Acres		Sale Method
<b>40N</b>	<b>18W</b>	<b>23,24,26</b>	<b>262</b>		<b>Scaled</b>

## Contract Restrictions

1. All pine in piles between April 15 to August 1 shall be removed within 30 days.
2. Slash shall be lopped and scattered not to exceed 4 feet in height and kept 100' away from the timber sale boundaries.
3. No equipment operation within 15' of any wetland unless the ground is firm or frozen.
4. Operation will be stopped, if in the opinion of the forester unnecessary damage occurs.
5. Maximum stump height shall be 10 inches.
6. Woods roads must remain open and free of debris during logging operations. Construction of new roads not allowed without prior approval of sale administrator.
7. Site maintenance required. Sever all stems 2" and larger.



**Clearcut (259 acres):** Harvest all trees with one or more merchantable sticks. Site maintenance required, sever all stems 2" and larger.



**Overstory Removal (3 acres):** Harvest all trees with one or more merchantable sticks.

Species	4" Vol. (tons)	Whole Tree (tons)
*Red Pine	6,300	6,900
**Oak	5,200	7,600
***Jack Pine	1,750	2,350
****Aspen	700	800
* Avg. DBH is 12-13"		
** 96% pin oak, 3% bur oak, >1% red maple		
*** 96% jack pine, 4% white pine, Avg. DBH is 8"		
**** Avg. DBH is 9-10"		
<b>Total sale minimum value:</b>		
<b>\$121,935</b>		

\* This map is for informational purposes only and may not have been prepared for or be suitable for legal, engineering or surveying purposes. The user is solely responsible for verifying the accuracy of information before using for any purpose.

By using this product for any purpose user agrees to be bound by all disclaimers found here:

<https://dnr.wisconsin.gov/legal>.

\*\*These Lands are 3<sup>rd</sup> party certified.

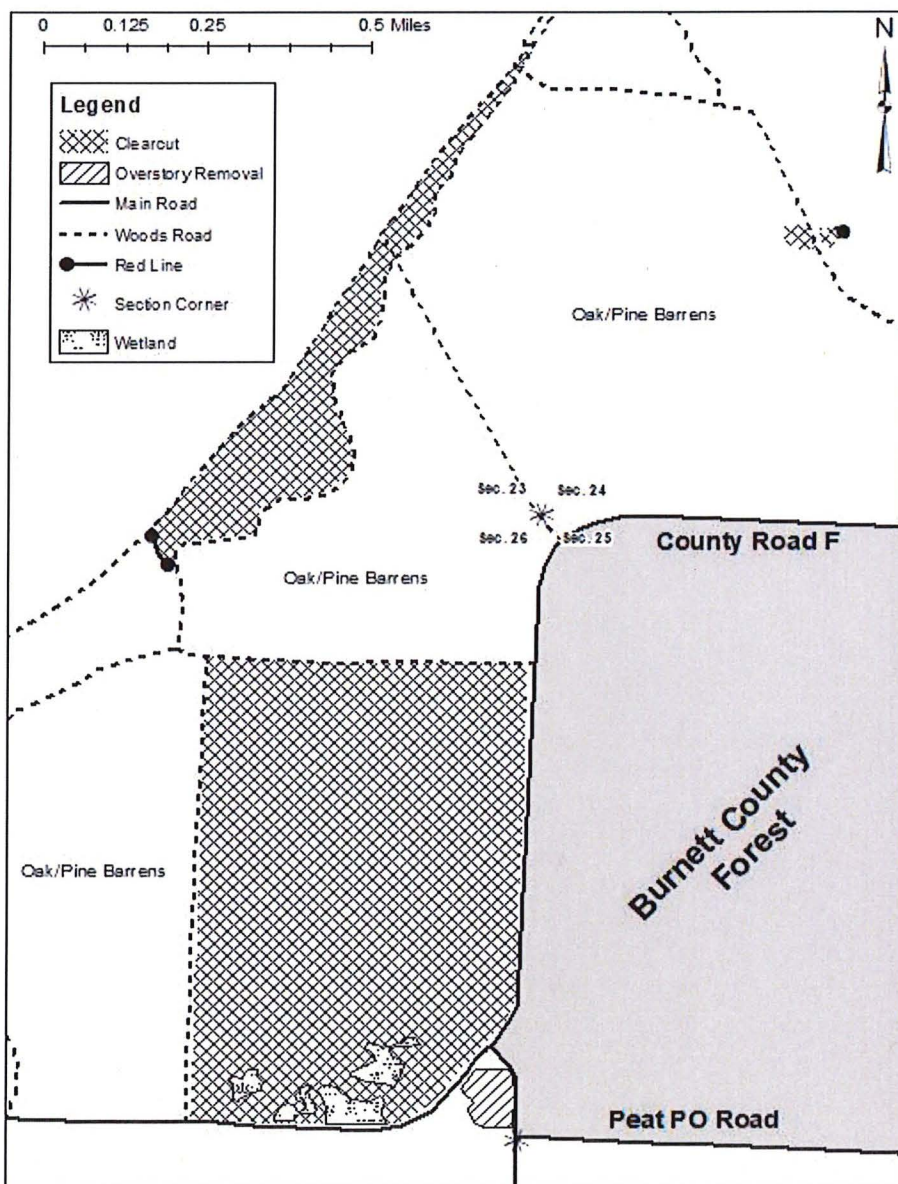

State of Wisconsin  
Department of Natural Resources  
[dnr.wi.gov](http://dnr.wi.gov)

**Timber Sale Bid**  
Form 2400-049 (R 07/22)

**Notice:** Completion of this form is mandatory. The Department will not recognize your bid unless you complete and submit this form. Personal information collected will be used for program administration and may be provided to requesters as required by Wisconsin's Public Records law [ss. 19.31-19.39, Wis. Stats.].

Date

Bidder Name

Street Address		City	State	ZIP Code
Property Name (if any) Crex Meadows Wildlife Area		Timber Sale Name Kohler Peat Conversion		Tract Number 780-125

Date and Hour of Bid Opening 11:00AM on 10-28-2025	Minimum Acceptable Bid (optional) \$121,935.00
---	---

Species-All bids including Lump Sum bids must be by species	Utilization Specifications (4 inch/Whole Tree/Logs)	Estimated Volume	Volume Units (tons/cords/mbf)	Price Bid Per Unit	Total Bid Value on Estimated Volume
Red Pine	Whole Tree	6,900	Tons		
Oak	Whole Tree	7,600	Tons		
Jack Pine	Whole Tree	2,350	Tons		
Aspen	Whole Tree	800	Tons		

The award shall be based on this TOTAL BID AMOUNT:

**Performance Bond**

Will be in the form of: (select one)

- |  |   |
|--|---|
| <input type="radio"/> Personal Check               | <input type="radio"/> Assurance Bond                |
| <input type="radio"/> Certified Check/Money Order  | <input type="radio"/> Certificate of Deposit        |
| <input type="radio"/> Irrevocable Letter of Credit | <input type="radio"/> Assignment of Savings Account |

I understand that any or all bids may be rejected and that consideration and awarding of a contract will be based upon my past performance and ability to complete contracts. I also understand that if I am the winning bidder, I have 6 weeks from the date of the bid opening to submit an acceptable performance bond. I also understand that if I am awarded the contract and fail to execute it or work under it, I will be required to forfeit to the Department an amount equal to 10% of my total bid amount. Failure to forfeit the 10% penalty will result in being considered ineligible to bid on any state timber sales for a two-year duration. In the event the highest bidder can not or will not sign the contract, the award may be made to the next highest qualified bid.

☐ By checking this box, I certify that I hold a Wisconsin Master Logger Certification.

**Notice:** I understand:

Utilization specifications and estimated volumes are listed in the prospectus which is available upon request from the Department.

A copy of the standard timber sales contract which must be entered into is available upon request from the Department.

Signature of Bidder
Bidder's Name (Please Print or Type)
Phone Number (include area code)
Email Address



State of Wisconsin  
Department of Natural Resources  
[dnr.wi.gov](http://dnr.wi.gov)

**Timber Sale Bid**  
Form 2400-049 (R 07/22)

**Notice:** Completion of this form is mandatory. The Department will not recognize your bid unless you complete and submit this form. Personal information collected will be used for program administration and may be provided to requesters as required by Wisconsin's Public Records law [ss. 19.31-19.39, Wis. Stats.].

Date

Bidder Name

Street Address	City	State	ZIP Code
----------------	------	-------	----------

Property Name (if any) Crex Meadows Wildlife Area	Timber Sale Name Kohler Peat Conversion	Tract Number 780-125
--	--	-------------------------

Date and Hour of Bid Opening 11:00AM on 10-28-2025	Minimum Acceptable Bid (optional) \$121,935.00
---	---

Species-All bids including Lump Sum bids must be by species	Utilization Specifications (4 inch/Whole Tree/Logs)	Estimated Volume	Volume Units (tons/cords/mbf)	Price Bid Per Unit	Total Bid Value on Estimated Volume
Red Pine	4"	6,300	Tons		
Oak	4"	5,200	Tons		
Jack Pine	4"	1,750	Tons		
Aspen	4"	700	Tons		

The award shall be based on this TOTAL BID AMOUNT:

**Performance Bond**

Will be in the form of: (select one)

- |  |   |
|--|---|
| <input type="radio"/> Personal Check               | <input type="radio"/> Assurance Bond                |
| <input type="radio"/> Certified Check/Money Order  | <input type="radio"/> Certificate of Deposit        |
| <input type="radio"/> Irrevocable Letter of Credit | <input type="radio"/> Assignment of Savings Account |

I understand that any or all bids may be rejected and that consideration and awarding of a contract will be based upon my past performance and ability to complete contracts. I also understand that if I am the winning bidder, I have 6 weeks from the date of the bid opening to submit an acceptable performance bond. I also understand that if I am awarded the contract and fail to execute it or work under it, I will be required to forfeit to the Department an amount equal to 10% of my total bid amount. Failure to forfeit the 10% penalty will result in being considered ineligible to bid on any state timber sales for a two-year duration. In the event the highest bidder can not or will not sign the contract, the award may be made to the next highest qualified bid.

☐ By checking this box, I certify that I hold a Wisconsin Master Logger Certification.

**Notice:** I understand:

Utilization specifications and estimated volumes are listed in the prospectus which is available upon request from the Department.

A copy of the standard timber sales contract which must be entered into is available upon request from the Department.

Signature of Bidder

Bidder's Name (Please Print or Type)

Phone Number (include area code)

Email Address



# Frederic School Forest

NON-CERTIFIED WOOD

## Restrictions

1. No cutting, skidding, or hauling during spring breakup or during wet periods when rutting may occur. Operations must cease if rutting occurs at any time.
2. Site maintenance required in the aspen area; sever all hardwood stems 2" and bigger.
3. Existing trails shall be kept free of debris and restored to satisfaction of the forester.
4. All pine shall be removed from site within 30 days during the summer.
5. No decking on town roads unless approval is obtained from the township.

## Legend

- Parcel Lines
- Red Pine 4th Thinning 13 acres: Harvest all orange marked trees
- Aspen Clearcut 20 acres: Harvest all hardwood stems except Oak. Site Maintenance Required.
- Trail
- Landings
- Roads

## Volume

\*Red Pine: 380 Tons  
Aspen: 1650 Tons  
\*\*MX: 240 Tons

**Minimum Sale Bid**  
**\$27,840**

**Contact:**  
**Luke Krueger**  
**DNR Forester**  
**715-701-3586**

360th Avenue

13 acres

20 acres

50th Street

\*Red pine contains 2% white pine  
\*\*MX is 93% red maple, 3% ash, 4% other  
Conversion factor of 2.25 for red pine and aspen, 2.4 for MX

Map projection: NAD 1983 HARN Wisconsin TM



1:6,000

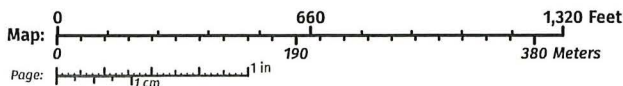

This map is a product generated by a DNR web mapping application.

This map is for informational purposes only and may not have been prepared for or be suitable for legal, engineering or surveying purposes. The user is solely responsible for verifying the accuracy of information before using for any purpose. By using this product for any purpose user agrees to be bound by all disclaimers found here: <https://dnr.wisconsin.gov/legal>

No print-by attribution  
Date Printed: 9/23/2025 3:16 PM





State of Wisconsin  
Department of Natural Resources  
[dnr.wi.gov](http://dnr.wi.gov)

**Timber Sale Bid**  
Form 2400-049 (R 07/22)

**Notice:** Completion of this form is mandatory. The Department will not recognize your bid unless you complete and submit this form. Personal information collected will be used for program administration and may be provided to requesters as required by Wisconsin's Public Records law [ss. 19.31-19.39, Wis. Stats.].

Date

Bidder Name

Street Address

City

State

ZIP Code

Property Name (if any)  
Frederic School Forest

Timber Sale Name  
Frederic School Forest

Tract Number

Date and Hour of Bid Opening  
10/28/2025 11:00AM

Minimum Acceptable Bid (optional)  
\$27,840.00

Species-All bids including Lump Sum bids must be by species	Utilization Specifications (4 inch/Whole Tree/Logs)	Estimated Volume	Volume Units (tons/cords/mbf)	Price Bid Per Unit	Total Bid Value on Estimated Volume
Red Pine	4 inch	380	tons		
Aspen	4 inch	1,650	tons		
MX	4 inch	240	tons		

The award shall be based on this TOTAL BID AMOUNT:

**Performance Bond**

Will be in the form of: (select one)

☐ Personal Check

☐ Assurance Bond

☐ Certified Check/Money Order

☐ Certificate of Deposit

☐ Irrevocable Letter of Credit

☐ Assignment of Savings Account

I understand that any or all bids may be rejected and that consideration and awarding of a contract will be based upon my past performance and ability to complete contracts. I also understand that if I am the winning bidder, I have 6 weeks from the date of the bid opening to submit an acceptable performance bond. I also understand that if I am awarded the contract and fail to execute it or work under it, I will be required to forfeit to the Department an amount equal to 10% of my total bid amount. Failure to forfeit the 10% penalty will result in being considered ineligible to bid on any state timber sales for a two-year duration. In the event the highest bidder can not or will not sign the contract, the award may be made to the next highest qualified bid.

☐ By checking this box, I certify that I hold a Wisconsin Master Logger Certification.

**Notice:** I understand:

Utilization specifications and estimated volumes are listed in the prospectus which is available upon request from the Department.

A copy of the standard timber sales contract which must be entered into is available upon request from the Department.

Signature of Bidder

Bidder's Name (Please Print or Type)

Phone Number (include area code)

Email Address