

Department of Natural Resources

INVITATION FOR BIDS

May 15, 2018

Sealed bids will be received by the Department of Natural Resources for timber stumpage on the following properties: Governor Knowles State Forest, Ice Age Trail, Totogatic Wild River Area, Sawyer Creek and Sand Creek Fisheries Areas, and Crex Meadows, Fish Lake, and Namekagon Barrens Wildlife Areas. Bids may be hand delivered or mailed to the following:

TIMBER SALE BID
(tract #, sale name)
Wisconsin DNR
325 W State Rd 70
Grantsburg, WI 54840

Bids will be opened on **Tuesday, May 15, 2018 at 11:00 a.m.** at 325 W. State Road 70 in Grantsburg, Wisconsin. No bid will be accepted after the date and time of bid opening. The Department of Natural Resources reserves the right to reject any or all bids.

Bidding process

1. Bids will be made by species and product for each tract. A minimum bid for each species is not published, however, there is a minimum aggregate bid value for each sale, which may or may not be advertised. The bid value must exceed the minimum aggregate sale bid value. Contracts will be awarded for the highest aggregate bid value for each tract.
2. To bid on a particular sale, the contractor must submit bids on DNR Form 2400-49A, TIMBER SALE BID. Bid sheets for each tract are included in this packet.
3. Bids for variable top diameter utilization may be accepted on some sales as indicated. Contractors submitting a bid for variable top diameter utilization, including whole tree harvesting, must clearly indicate on the Timber Sale Bid (Form 2400-49A) the species, utilization specifications, estimated volume and price per unit. The volumes are listed on the Timber Sale Map sheets and on the bid sheets. The Department of Natural Resources weight conversion rates will be used unless indicated otherwise on the map sheet. For those sales that list only one top end diameter, that diameter will be the required utilization specification and no whole tree conversions will be made unless otherwise indicated. The timber sale contract (Form 2400-5) will indicate the utilization specification and bid value you are bidding at. You will be required to harvest and utilize the wood at the utilization specification that you bid.
4. Some tracts may have optional species or areas where bidders may elect to bid on only those species not marked as optional. Bids will be awarded on highest total sale value regardless of whether or not the optional wood was bid.
5. Persons who bid on more than one tract must submit separate envelopes containing the bid for each tract. The envelope should be labeled with the tract number and sale name.
6. Contracts are to be signed within six weeks of letting bids and are considered binding for that period. Sample contracts are available upon request. Contracts may not be sub-contracted or assigned.
7. Winning bidders will have six weeks from the date of the bid opening to submit an acceptable performance bond. A performance bond of a minimum of \$1000.00 or 15% of the

total sale value, whichever is greater, is required on each sale. The type of performance bond must be determined and submitted at the time of contract signing. The performance bond may be retained for damages or if noncompliance of the sale contract occurs. Upon successful completion of the contract, the performance bond will be returned.

If the winning bidder fails to execute the contract and submit an acceptable performance bond, the bidder shall be required to forfeit to the Department an amount equal to 10% of the total bid amount. Failure to forfeit the 10% penalty will result in the bidder being considered ineligible to bid on any state timber sales for a two year period.

8. Bidders in attendance can remove a bid for a tract from consideration as long as it is done prior the reading of the first bid for that tract.

Scaling

Scaling arrangements on all sales will be made at the time of contract signing and Department conversion rates for weight, peeled, or processed fuelwood will be utilized. Unless a sale is sold by weight, the Department will convert any mill weight scales to cordwood or board feet volume using the Department conversion rates found in the Department's Timber Sale Handbook. Copies of the Department conversion rates are available upon request.

Payment Options

Mill Scale Sales

Two payment options exist. The Deferred payment option is, generally, the preferred system. The advanced payment option will be required if the contractor fails to pay a deferred payment by the payment due date.

Advanced Stumpage Payment Option

An advance stumpage will be required before any cutting begins, and as needed throughout the sale period. No wood will be removed from the sale area at any time until it has been paid for.

Deferred Stumpage Payment Option (not an option for lump sum sales)

The successful bidder may choose the Deferred Payment option. In this case, stumpage payments must be received by the State within 30 days of being billed by the forester. Advance stumpage payment is not required. A 1.5% per 30 days interest penalty will be applied to any stumpage not paid for within 30 days. For example, payment on day 40 for a \$5000.00 bill would be 10 days late. The late interest penalty would be calculated as follows: $\$5000.00 \times .015 \times 10/30 \text{ days} = \25.00 and would be added to the balance due. Late payment penalty funds will be paid to the sale but will not reduce the principal owed to the State. In addition to the late interest penalty, failure to pay within the 30 day framework on a sale will result in the contractor having to make advanced stumpage payments for the remainder of the sale. Two such payment breaches, even on separate State sales, will result in the purchaser being required to make advanced stumpage payments on all state timber sales for a two year period.

Lump Sum Sales

All lump sum timber sales require a stumpage payment prior to cutting. Failure to fully complete performance will result in forfeiture of the performance bond. **No refunds of stumpage payments will be made for any reason.** Wood left on the sale once the sale is closed out shall revert to the

seller.

Other Conditions

The successful bidder must comply with Wisconsin Worker's Compensation Act, Chapter 102 of Wisconsin Statutes. The successful bidder **MUST HAVE WORKERS COMPENSATION**, and must provide a **Certificate of Insurance** indicating the Department of Natural Resources as a "certificate holder" **at the time of contract signing**.

Successful purchasers of DNR stumpage will need to ensure that the logging contractor actually engaged in performance of the contract complies with the 3rd party certification training standard. Criteria for the standard can be found by contacting the Forest Industry Safety & Training Alliance (FISTA). Documentation confirming completion of the training standard will be required prior to contract signing.

All timber sales are on state owned land. These lands are 3rd party certified. The purchaser is responsible for maintaining chain of custody for stumpage after leaving the sale area.

Wisconsin's Best Management Practices for Water Quality (BMPs) and Wisconsin's Forestland Woody Biomass Harvesting Guidelines shall be followed on all DNR timber sales.

The contractor must contact the appropriate Department of Natural Resources office a minimum of three working days prior to initiating cutting on a sale contract. Failure to do so will be considered a contract violation.

If mixed loads of different valued species are hauled, the stumpage charges will be calculated based on the proportion of the different species as determined by the mill. If the mill fails to assign a percentage to the different valued species the entire load will be charged to the species with the higher stumpage rate. All mixed round wood loads hauled under the Haul Permit system should have separate haul tickets for the different valued species and estimated volumes of each. The Department reserves the right to assign weighted average prices and weight conversions.

Contract periods for each sale vary. Extensions will not be granted without a justifiable reason. Justification will be evaluated by the Department of Natural Resources to determine if an extension is warranted. If extended, stumpage increases will be factored according to the timber sale contract.

Timber sale contracts may contain other provisions. Sample contracts are available upon request.

The Department does not guarantee access to sales across any non-state-owned lands.

All successful bidders will agree to comply with the Department's fire protection requirements. These requirements are listed in the contract. In brief, the contractor will install fire extinguishers on all off-road logging equipment as well as equip all non-turbocharged engines with Department approved spark arrestors. The Department reserves the right to suspend all harvest operations when the risk for wildfires is elevated.

Existing State timber sale contracts that have run longer than the original expiration date must be completed before sale operations are started on any tracts offered in this bid opening unless otherwise approved by the Department.

Additional information may be obtained from the DNR Office at:

325 W. State Road 70
Grantsburg, WI 54840
(715) 463-2897

With questions on specific tracts call:

Gov. Knowles S.F.	Mike Wallis	715-463-2898
Tract 4934-1-16	Paul Heimstead	715-485-3518
Namekagon Barrens	Kyle Young	715-635-4081
Sawyer Creek Fishery	Kyle Young	715-635-4081
Totogatic Wild River	Kyle Young	715-635-4081
Crex Meadows Wildlife Area	Mark Gossman	715-866-8127
Fish Lake Wildlife Area	Mark Gossman	715-866-8127
Sand Creek Fisheries Area	Mark Gossman	715-866-8127

**GOVERNOR KNOWLES STATE FOREST
TIMBER SALE PROSPECTUS
Tract # 30-17**

A timber sale is being offered in portions of the NENW & SWSW of Section 25, the SESE of Section 26, and the NENE, SENE, and NWSE of Section 35, Township 41 North, Range 17 West, Burnett County, Wisconsin. This is a cordwood sale, however approximately 5% of the volume includes sawlog quality timber. The harvest area will encompass approximately 56 acres. Refer to the attached Sale Area Map.

CUTTING SPECIFICATIONS:

Clearcut (56 acres) – Within the harvest area, all merchantable timber is to be harvested EXCEPT red and white pine. All hardwood stems 2” in diameter and greater must be severed to promote vigorous sprouting. The harvest boundaries are delineated by red paint dots facing into the harvest area, the blue painted property line and obvious natural timber type edges as indicated on the Sale Area Map.

MINIMUM AGGREGATE BID VALUE \$6,716

<u>SPECIES/PRODUCT</u>	<u>ESTIMATED VOLUME</u>
Oak Cordwood*	350 Cords
Ash Cordwood	160 Cords
Mixed Hardwoods Cordwood**	100 Cords
Balsam Fir Cordwood	50 Cords

*Approx. 51% white oak, 49% pin oak

** Approx. 48% red maple, 20% birch, 16% basswood, 10% aspen, 5% hard maple

UTILIZATION SPECIFICATIONS:

All cordwood must be utilized to a 4” top diameter.

OTHER CONSIDERATIONS:

SLASH TREATMENT: Logging slash may not be left hanging in or against residual timber or across any property lines. Slash must be lopped or crushed to within 36” of the ground throughout the harvest areas. Stump heights are not to exceed 10 inches.

ACCESS/ROADS: Access to the sale area is via woods roads off St. Croix Trail. The woods roads may need to be widened and improved to facilitate truck traffic.

TIMELINE: Due to the saturated soils, frozen ground harvesting may be necessary for a portion of the sale. To prevent the spread of oak wilt, no harvest activity will be permitted between April 15th and July 15th.

The timber sale contract will run until July 1, 2021.

Established by: Groeschl Forestry Consulting, Inc. in conjunction with WI DNR.
13920W State Rd. 77
Hayward, WI 54832
715-634-6712
groeschl@centurytel.net

Township 41 North, Range 17 West
Sections 25, 26 & 35
Burnett County, Wisconsin

SALE AREA MAP

Tract # 30-17

0 660 1,320 Feet

Governor Knowles State Forest

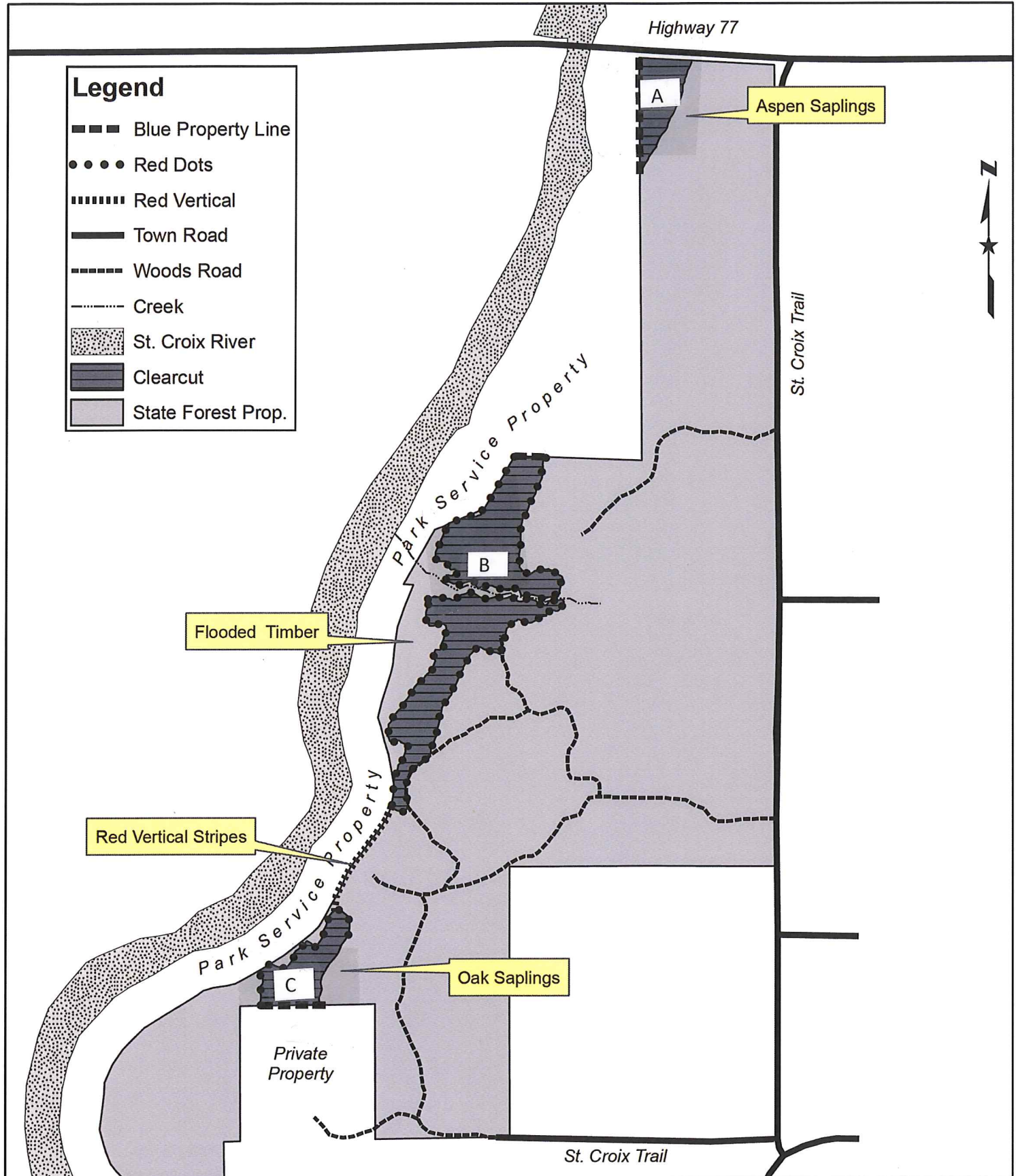

Notice: Completion of this form is mandatory. The Department will not recognize your bid unless you complete and submit this form. Personal information collected will be used for program administration and may be provided to requesters as required by Wisconsin's Open Records law [ss. 19.31-19.39, Wis. Stats.].

Date

Bidder Name

Street Address

City

State

ZIP Code

Property Name (if any)

Governor Knowles State Forest

Tract Number

30-17

Date and Hour of Bid Opening

Minimum Acceptable Bid (optional)

\$ \$6,716.00

Species-All bids including Lump Sum bids must be by species	Utilization Specifications	Advertised Value Per Unit (optional)	Estimated Volume	Volume Units	Price Bid Per Unit	Total Bid Value on Estimated Volume
Oak Cordwood	4"		350	Cords		
Ash Cordwood	4"		160	Cords		
Mixed Hardwoods Cordwood	4"		100	Cords		
Balsam Fir Cordwood	4"		50	Cords		

The award shall be based on this TOTAL BID AMOUNT:

Performance Bond

Will be in the form of: (select one)

☐ Cash

☐ Assurance Bond

☐ Personal Check

☐ Certificate of Deposit

☐ Certified Check/Money Order

☐ Assignment of Savings Account

☐ Irrevocable Letter of Credit

I understand that any or all bids may be rejected and that consideration and awarding of a contract will be based upon my past performance and ability to complete contracts. **I also understand that if I am the winning bidder, I have 6 weeks from the date of the bid opening to submit an acceptable performance bond. I also understand that if I am awarded the contract and fail to execute it or work under it, I will be required to forfeit to the Department an amount equal to 10% of my total bid amount.** Failure to forfeit the 10% penalty will result in being considered ineligible to bid on any state timber sales for a two-year duration. In the event the highest bidder can not or will not sign the contract, the award will be made to the next highest qualified bid.

Notice: I understand:

Utilization specifications and estimated volumes are listed in the prospectus which is available upon request from the Department.

A copy of the standard timber sales contract which must be entered into is available upon request from the Department.

Signature of Bidder

Bidder's Name (Please Print or Type)

Phone Number (include area code)

Email Address (optional)

GOVERNOR KNOWLES STATE FOREST

Timber Sale #/Name: / Lost Creek Sale	Town: Union (W) Union (E)	Legal Description: E1/2SE Sec. 1, NE ¼ Sec. 19, NE ¼ & SESE Sec. 12 T40N-R18W SW1/4 Sec. 6 T40N-R17W
DNR Tract #: GK 10-18	Comp: 34	Stand: 2, 19, 20, 22
Sale Expiration Date: July 15, 2021	Mapped By/Date: Mike Wallis 2/19/18	Acres: 90 Total A-44 ac. B-19 ac. C-21 ac. D-6 ac.
		Contractor:

Total Minimum Sale Value = \$11,600.00

Whole Tree weight conversions will be at 5,160 pounds/cord

Species/Product	4" Vol. (cords)	Whole Tree Vol. (cords)	Price/Cd	Total
Oak Cordwood*	550	N/A		
Mixed Hardwood Cordwood**	170	N/A		
Ash Cordwood	95	N/A		
Aspen Cordwood	35	N/A		
White Pine Cordwood	20	N/A		
Mixed Species All Cordwood***	N/A	1000		





*Approx. 56% pin oak, 44% bur oak

**Approx. 72% red maple, 21% white birch, 5% yellow birch, 2% basswood

***Approx. 64% oak, 14% maple, 11% ash, 4% white birch, 3% aspen, 2% white pine, 1% basswood, 1% yellow birch

Total \$

Cutting Requirements/Information

-  Block A (clearcut with reserves) - Harvest all trees with one or more merchantable stick except jack pine and balsam fir. Leave one bur oak larger than 14" DBH every 200 feet where possible.
-  Block B (light thinning) - Harvest all trees marked with orange paint. Do not damage aspen regeneration. Part of block B will be pre-sale scarified by the Department.
-  Block C (Overstory Removal) Cut all ash and Yellow Birch 8 inches in diameter and larger. In addition, cut all red maple, white birch, basswood, oak, aspen, elm. Leave all spruce, fir, and white pine. **Frozen ground conditions only.**
-  Block D (Clearcut) – Harvest all species with one or more merchantable sticks.

- Utilization: 4" top DIB or Wholetree.
- Do not harvest paint marked boundary trees.
- Maximum stump height shall be 10 inches.
- Slash shall be lopped and scattered to a maximum height not to exceed 3 feet and kept within the sale boundaries.
- Landings shall be approved by the Department prior to their construction.
- All existing roads and trails shall be kept open to allow for normal use throughout the harvest. Existing trails shall be restored by the contractor to the satisfaction of the Department.
- Recreational trails shall be kept free of debris and passable. Use caution when operating near the trails.
- All pine in piles between April 15 and August 1 shall be removed from the landing within 30 days.
- Leave all snags where they are not a safety risk to the operators.
- Do not damage advanced regeneration or trees not designated for harvest.
- Contractor is required to deliver all pin oak directly to a wood processing facility, minimizing the spread of oak wilt. Only pin oak that is peeled or has loose bark may be sorted and sold as firewood. There are no hauling restrictions on the bur/white oak.
- Seasonal Restrictions - No harvesting allowed in A, B, or D from April 15-July 15 due to oak wilt restrictions. Block C is restricted to frozen ground.

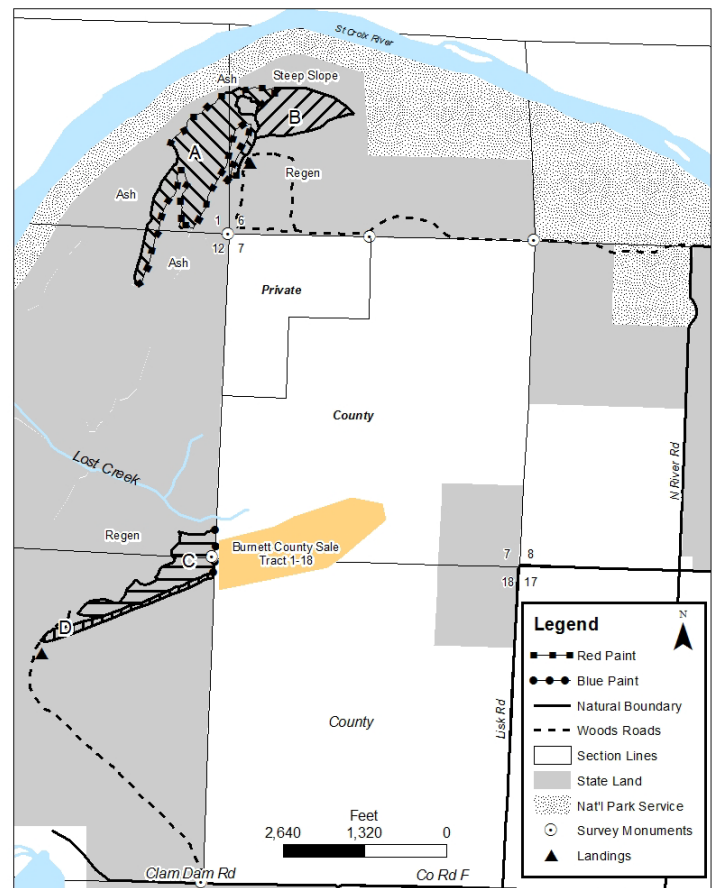

This map is not a survey of the actual boundary of any property this map depicts.

Notice: Completion of this form is mandatory. The Department will not recognize your bid unless you complete and submit this form. Personal information collected will be used for program administration and may be provided to requesters as required by Wisconsin's Open Records law [ss. 19.31-19.39, Wis. Stats.].

Date

Bidder Name

Street Address

City

State

ZIP Code

Property Name (if any)

Governor Knowles State Forest

Tract Number

10-18

Date and Hour of Bid Opening

Minimum Acceptable Bid (optional)

\$ 11,600.00

Species-All bids including Lump Sum bids must be by species	Utilization Specifications	Advertised Value Per Unit (optional)	Estimated Volume	Volume Units	Price Bid Per Unit	Total Bid Value on Estimated Volume
Oak Cordwood	4"		550	Cords		
Mixed Hardwoods Cordwood	4"		170	Cords		
Ash Cordwood	4"		95	Cords		
Aspen Cordwood	4"		35	Cords		
White Pine Cordwood	4"		20	Cords		

The award shall be based on this TOTAL BID AMOUNT:

Performance Bond

Will be in the form of: (select one)

☐ Cash

☐ Assurance Bond

☐ Personal Check

☐ Certificate of Deposit

☐ Certified Check/Money Order

☐ Assignment of Savings Account

☐ Irrevocable Letter of Credit

I understand that any or all bids may be rejected and that consideration and awarding of a contract will be based upon my past performance and ability to complete contracts. **I also understand that if I am the winning bidder, I have 6 weeks from the date of the bid opening to submit an acceptable performance bond. I also understand that if I am awarded the contract and fail to execute it or work under it, I will be required to forfeit to the Department an amount equal to 10% of my total bid amount.** Failure to forfeit the 10% penalty will result in being considered ineligible to bid on any state timber sales for a two-year duration. In the event the highest bidder can not or will not sign the contract, the award will be made to the next highest qualified bid.

Notice: I understand:

Utilization specifications and estimated volumes are listed in the prospectus which is available upon request from the Department.

A copy of the standard timber sales contract which must be entered into is available upon request from the Department.

Signature of Bidder

Bidder's Name (Please Print or Type)

Phone Number (include area code)

Email Address (optional)

Notice: Completion of this form is mandatory. The Department will not recognize your bid unless you complete and submit this form. Personal information collected will be used for program administration and may be provided to requesters as required by Wisconsin's Open Records law [ss. 19.31-19.39, Wis. Stats.].

Date

Bidder Name

Street Address

City

State

ZIP Code

Property Name (if any)

Governor Knowles State Forest

Tract Number

10-18

Date and Hour of Bid Opening

Minimum Acceptable Bid (optional)

\$ 11,600.00

Species-All bids including Lump Sum bids must be by species	Utilization Specifications	Advertised Value Per Unit (optional)	Estimated Volume	Volume Units	Price Bid Per Unit	Total Bid Value on Estimated Volume
Mixed Species All	Whole Tree		1,000	Cords		

The award shall be based on this TOTAL BID AMOUNT:

Performance Bond

Will be in the form of: (select one)

☐ Cash

☐ Assurance Bond

☐ Personal Check

☐ Certificate of Deposit

☐ Certified Check/Money Order

☐ Assignment of Savings Account

☐ Irrevocable Letter of Credit

I understand that any or all bids may be rejected and that consideration and awarding of a contract will be based upon my past performance and ability to complete contracts. **I also understand that if I am the winning bidder, I have 6 weeks from the date of the bid opening to submit an acceptable performance bond. I also understand that if I am awarded the contract and fail to execute it or work under it, I will be required to forfeit to the Department an amount equal to 10% of my total bid amount.** Failure to forfeit the 10% penalty will result in being considered ineligible to bid on any state timber sales for a two-year duration. In the event the highest bidder can not or will not sign the contract, the award will be made to the next highest qualified bid.

Notice: I understand:

Utilization specifications and estimated volumes are listed in the prospectus which is available upon request from the Department.

A copy of the standard timber sales contract which must be entered into is available upon request from the Department.

Signature of Bidder

Bidder's Name (Please Print or Type)

Phone Number (include area code)

Email Address (optional)

GOVERNOR KNOWLES STATE FOREST

Timber Sale #/Name: / Sunrise Sale	Town: Sterling (W)	Legal Description: N1/2NE1/4 & NENW Sec. 32, N1/2NW1/4 Sec. 33, S1/2SE1/4Sec. 29 T36N-R20W
DNR Tract #: GK 20-18	Comp: 6/7	Stand: 14, 16/6, 7, 11
Sale Expiration Date: July 1, 2020	Mapped By/Date: Mike Wallis 2/22/18	Acres: 81 Total A-10 ac. B-4 ac. C-3 ac. D-11 ac. E-14 ac. F-2 ac. G-22 ac. H-2 ac. I-13 ac.
		Contractor:

Total Minimum Sale Value = \$19,403.50





Species/Product	4" Vol. (cords)	Price/Cd	Total
Oak Cordwood*	625		
Ash Cordwood	220		
Aspen Cordwood	200		
Mixed Hardwood Cordwood**	120		
Basswood Cordwood	45		
Jack Pine Cordwood	10		

*Approx. 63% bur oak, 34% pin oak, 3% white oak

**Approx. 90% maple, 10% birch

Total \$

Cutting Requirements/Information

-  Block F (Selection) - Harvest all hardwood species with one or more merchantable sticks.
-  Block A, C, E, H (Clearcut) - Harvest all trees with one or more merchantable sticks. Site maintenance is required on all stems greater than 2" DBH. In blocks C, E, and H, leave two bur oaks per acre greater than 12" DBH.
-  Block B (Clearcut with Reserves) Harvest all trees with one or more merchantable sticks. Leave all bur oaks greater than 12" DBH.
-  Blocks D, G, I (Shelterwood) – Harvest all trees marked with orange paint. Harvest all aspen, birch, maple. Jack pine, and ash with one or more merchantable sticks. Site maintenance is required on all stems greater than 2" DBH. Part of block D will be blade scarified by the Department prior to harvest.

- Utilization: 4" top DIB.
- Do not harvest paint marked boundary trees.
- Maximum stump height shall be 10 inches.
- Slash shall be lopped and scattered to a maximum height not to exceed 2 feet and kept within the sale boundaries. Keep slash out of the swamps.
- Additional landings, if needed, shall be approved by the Department prior to their construction. The two western landings are accessible by abandoned woods roads. Use of the road ROW as a landing requires Town of Sterling approval, and if approved shall be stocked from the harvest side of the piles. Do not use the Town road as a forwarder/skid trail.
- All existing roads and trails shall be kept open to allow for normal use throughout the harvest. Ferry Drive is a snowmobile trail. The snowmobile trail shall be kept passable, free of debris, and snow covered while it is being groomed.
- Harvesting shall be completed in a systematic and progressive manner. Cutting blocks shall be completely harvested prior to harvesting in another block, unless otherwise approved by the Department.
- Leave all snags where they are not a safety risk to the operators.
- Do not damage advanced regeneration or trees not designated for harvest.
- Contractor is required to deliver all pin oak directly to a wood processing facility, minimizing the spread of oak wilt. Only pin oak that is peeled or has loose bark may be sorted and sold as firewood. There are no hauling restrictions on the bur/white oak.
- Seasonal Restrictions - No harvesting allowed April 15-July 15 due to oak wilt restrictions.

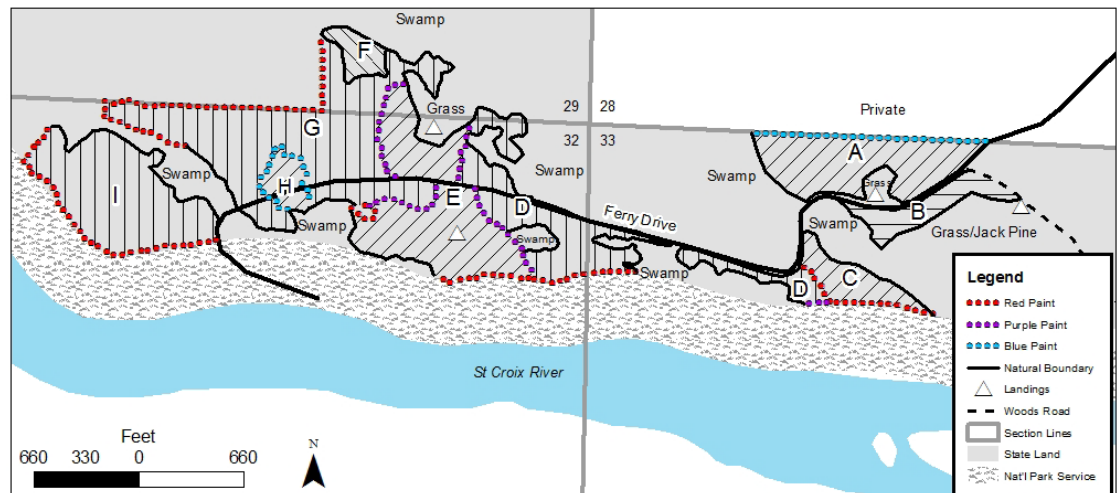

Notice: Completion of this form is mandatory. The Department will not recognize your bid unless you complete and submit this form. Personal information collected will be used for program administration and may be provided to requesters as required by Wisconsin's Open Records law [ss. 19.31-19.39, Wis. Stats.].

Date

Bidder Name

Street Address

City

State

ZIP Code

Property Name (if any)

Governor Knowles State Forest

Tract Number

20-18

Date and Hour of Bid Opening

Minimum Acceptable Bid (optional)

\$ 19,403.50

Species-All bids including Lump Sum bids must be by species	Utilization Specifications	Advertised Value Per Unit (optional)	Estimated Volume	Volume Units	Price Bid Per Unit	Total Bid Value on Estimated Volume
Oak Cordwood	4"		625	Cords		
Ash Cordwood	4"		220	Cords		
Aspen Cordwood	4"		200	Cords		
Mixed Hardwoods Cordwood	4"		120	Cords		
Basswood Cordwood	4"		45	Cords		
Jack Pine Cordwood	4"		10	Cords		

The award shall be based on this TOTAL BID AMOUNT:

Performance Bond

Will be in the form of: (select one)

☐ Cash

☐ Assurance Bond

☐ Personal Check

☐ Certificate of Deposit

☐ Certified Check/Money Order

☐ Assignment of Savings Account

☐ Irrevocable Letter of Credit

I understand that any or all bids may be rejected and that consideration and awarding of a contract will be based upon my past performance and ability to complete contracts. **I also understand that if I am the winning bidder, I have 6 weeks from the date of the bid opening to submit an acceptable performance bond. I also understand that if I am awarded the contract and fail to execute it or work under it, I will be required to forfeit to the Department an amount equal to 10% of my total bid amount.** Failure to forfeit the 10% penalty will result in being considered ineligible to bid on any state timber sales for a two-year duration. In the event the highest bidder can not or will not sign the contract, the award will be made to the next highest qualified bid.

Notice: I understand:

Utilization specifications and estimated volumes are listed in the prospectus which is available upon request from the Department.

A copy of the standard timber sales contract which must be entered into is available upon request from the Department.

Signature of Bidder

Bidder's Name (Please Print or Type)

Phone Number (include area code)

Email Address (optional)

GOVERNOR KNOWLES STATE FOREST

Timber Sale #/Name: / Painted Llama Sale	Town: West Marshland (W)	Legal Description: Sec. 29, SE1/4 Sec. 30, & E1/2 Sec. 31 T39N R19W
DNR Tract #: GK 30-18	Comp: 22/23	Stand: 8/13
Sale Expiration Date: July 1, 2021	Mapped By/Date: Mike Wallis 3/8/18	Acres: 111 Total A-71 ac. B-33 ac. C-7 ac
		Contractor:

Total Minimum Sale Value = \$35,113.50

Species/Product	4" Vol. (cords)	Price/Cd	Total
Oak Cordwood*	1,250		
Mixed Hardwood Cordwood**	360		
Red Pine Cordwood	200		
Jack Pine Cordwood	100		
Aspen Cordwood	60		
White Pine Cordwood	55		

*Approx. 88% pin oak, 12% bur/white oak

**Approx. 67% maple, 16% birch, 14% basswood, 3% other hardwoods

Total \$

Cutting Requirements/Information

 Clearcut - Harvest all white pine marked with orange paint and all other species with one or more merchantable sticks except bur/white oak and unmarked white pine.

1. All existing roads and trails shall be kept open to allow for normal use throughout the harvest.
2. Harvesting shall be completed in a systematic and progressive manner. Cutting blocks shall be completely harvested prior to harvesting in another block, unless otherwise approved by the Department.
3. Slash shall be lopped and scattered to a maximum height not to exceed 2 feet and kept within the sale boundaries.
4. Landings shall be approved by the Department prior to their construction.
5. Utilization: 4" top DIB.
6. All pine in piles between April 15 and August 1 shall be removed from the landing within 30 days.
7. Do not harvest paint marked boundary trees.
8. Maximum stump height shall be 10 inches.
9. Leave all snags where they are not a safety risk to the operators.
10. Do not damage advanced regeneration or trees not designated for harvest.
11. Contractor is required to deliver all pin oak directly to a wood processing facility, minimizing the spread of oak wilt. Only pin oak that is peeled or has loose bark may be sorted and sold as firewood.
12. Seasonal Restrictions - No harvesting allowed April 15-July 15 due to oak wilt restrictions.

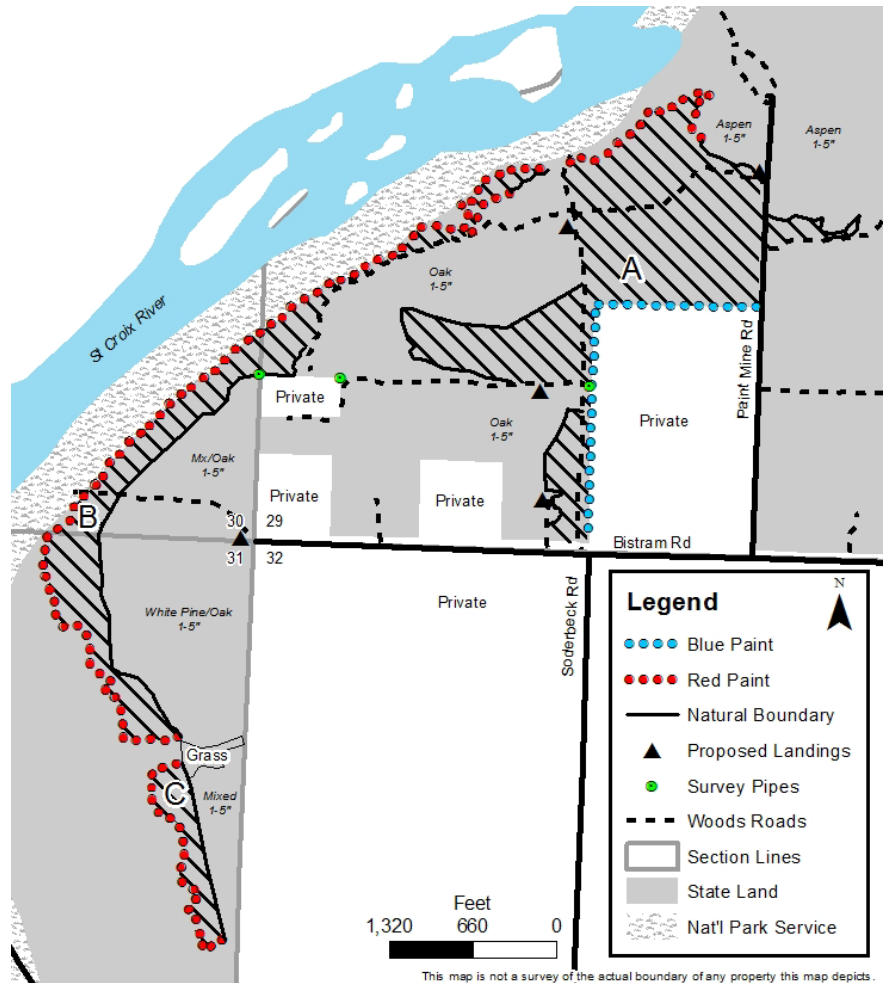

Notice: Completion of this form is mandatory. The Department will not recognize your bid unless you complete and submit this form. Personal information collected will be used for program administration and may be provided to requesters as required by Wisconsin's Open Records law [ss. 19.31-19.39, Wis. Stats.].

Date

Bidder Name

Street Address

City

State

ZIP Code

Property Name (if any)

Governor Knowles State Forest

Tract Number

30-18

Date and Hour of Bid Opening

Minimum Acceptable Bid (optional)

\$ 35,113.50

Species-All bids including Lump Sum bids must be by species	Utilization Specifications	Advertised Value Per Unit (optional)	Estimated Volume	Volume Units	Price Bid Per Unit	Total Bid Value on Estimated Volume
Oak Cordwood	4"		1,250	Cords		
Mixed Hardwoods Cordwood	4"		360	Cords		
Red Pine Cordwood	4"		200	Cords		
Jack Pine Cordwood	4"		100	Cords		
Aspen Cordwood	4"		60	Cords		
White Pine Cordwood	4"		55	Cords		

The award shall be based on this TOTAL BID AMOUNT:

Performance Bond

Will be in the form of: (select one)

☐ Cash

☐ Assurance Bond

☐ Personal Check

☐ Certificate of Deposit

☐ Certified Check/Money Order

☐ Assignment of Savings Account

☐ Irrevocable Letter of Credit

I understand that any or all bids may be rejected and that consideration and awarding of a contract will be based upon my past performance and ability to complete contracts. **I also understand that if I am the winning bidder, I have 6 weeks from the date of the bid opening to submit an acceptable performance bond. I also understand that if I am awarded the contract and fail to execute it or work under it, I will be required to forfeit to the Department an amount equal to 10% of my total bid amount.** Failure to forfeit the 10% penalty will result in being considered ineligible to bid on any state timber sales for a two-year duration. In the event the highest bidder can not or will not sign the contract, the award will be made to the next highest qualified bid.

Notice: I understand:

Utilization specifications and estimated volumes are listed in the prospectus which is available upon request from the Department.

A copy of the standard timber sales contract which must be entered into is available upon request from the Department.

Signature of Bidder

Bidder's Name (Please Print or Type)

Phone Number (include area code)

Email Address (optional)

GOVERNOR KNOWLES STATE FOREST

Timber Sale #/Name: / Moscow Sale	Town: Sterling (W)	Legal Description: E1/4 Sec. 18 & 19, SW1/4 Sec. 20, N1/2NW1/4 Sec. 29 T36N-R20W
DNR Tract #: GK 40-18	Comp: 7/8/9	Stand: 8/34, 38/21
Sale Expiration Date: July 1, 2021	Mapped By/Date: Mike Wallis 3/16/18	Acres: 75 Total
		Contractor:

Total Minimum Sale Value = \$25,172.00

Species/Product	4" Vol. (cords)	Price/Cd	Total
Oak Cordwood*	775		
Mixed Hardwood Cordwood**	380		
Ash Cordwood	260		
Aspen Cordwood	60		
Red Pine Cordwood	30		

*Approx. 65% pin oak, 33% bur oak, 2% white oak

**Approx. 79% maple, 9% basswood, 8% yellow birch, 4% white birch,

Total \$

Cutting Requirements/Information



Clearcut - Harvest all species with one or more merchantable sticks except white pine.



Clearcut **FROZEN GROUND ONLY** - Harvest all species with one or more merchantable sticks except white pine.



Selection **FROZEN GROUND ONLY** - Harvest all oak marked with orange paint. Harvest all Basswood, Ash, and Maple with one or more merchantable sticks.

1. Utilization: 4" top DIB.
2. Do not harvest paint marked boundary trees.
3. Maximum stump height shall be 10 inches.
4. Slash shall be lopped and scattered to a maximum height not to exceed 3 feet and kept within the sale boundaries. Keep slash out of the swamps and RMZs.
5. Additional landings, if needed, shall be approved by the Department prior to their construction. Progressive shortwood landings are permitted along existing woods roads.
6. All existing roads and trails shall be kept open to allow for normal use throughout the harvest. The snowmobile trail may be plowed, but shall be kept snow covered while it is being groomed.
7. Harvesting shall be completed in a systematic and progressive manner. Harvest areas shall be completely harvested prior to harvesting in another area, unless otherwise approved by the Department.
8. Leave all snags where they are not a safety risk to the operators.
9. Do not damage advanced regeneration or trees not designated for harvest.
10. Contractor is required to deliver all pin oak directly to a wood processing facility, minimizing the spread of oak wilt. Only pin oak that is peeled or has loose bark may be sorted and sold as firewood. There are no hauling restrictions on the bur/white oak.
11. Seasonal Restrictions - No harvesting allowed April 15-July 15 due to oak wilt restrictions.

**Moscow Sale
Tract GK40-18**

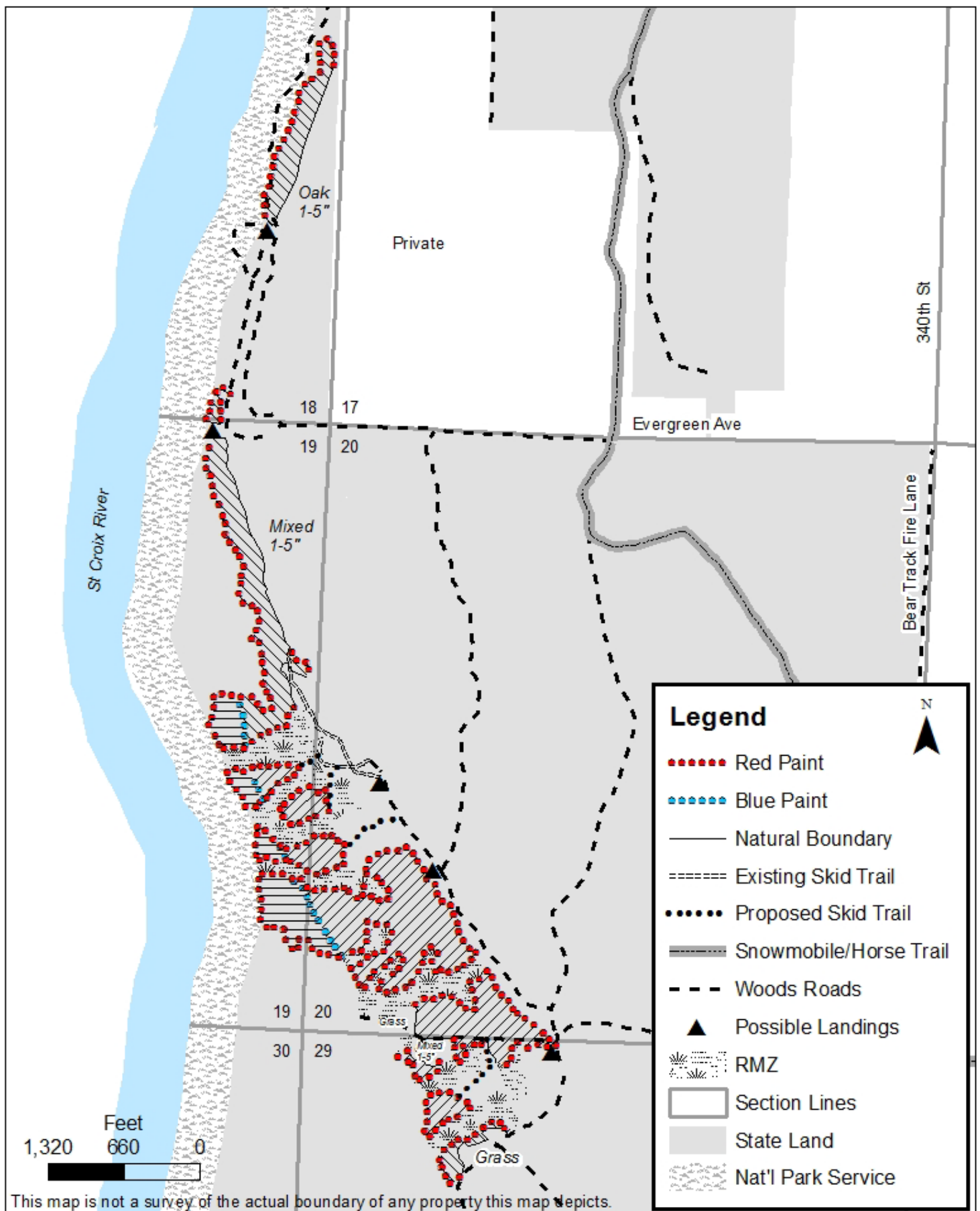

Notice: Completion of this form is mandatory. The Department will not recognize your bid unless you complete and submit this form. Personal information collected will be used for program administration and may be provided to requesters as required by Wisconsin's Open Records law [ss. 19.31-19.39, Wis. Stats.].

Date

Bidder Name

Street Address

City

State

ZIP Code

Property Name (if any)

Governor Knowles State Forest

Tract Number

40-18

Date and Hour of Bid Opening

Minimum Acceptable Bid (optional)

\$ 25,172.00

Species-All bids including Lump Sum bids must be by species	Utilization Specifications	Advertised Value Per Unit (optional)	Estimated Volume	Volume Units	Price Bid Per Unit	Total Bid Value on Estimated Volume
Oak Cordwood	4"		775	Cords		
Mixed Hardwoods Cordwood	4"		380	Cords		
Ash Cordwood	4"		260	Cords		
Aspen Cordwood	4"		60	Cords		
Red Pine Cordwood	4"		30	Cords		

The award shall be based on this TOTAL BID AMOUNT:

Performance Bond

Will be in the form of: (select one)

☐ Cash

☐ Assurance Bond

☐ Personal Check

☐ Certificate of Deposit

☐ Certified Check/Money Order

☐ Assignment of Savings Account

☐ Irrevocable Letter of Credit

I understand that any or all bids may be rejected and that consideration and awarding of a contract will be based upon my past performance and ability to complete contracts. **I also understand that if I am the winning bidder, I have 6 weeks from the date of the bid opening to submit an acceptable performance bond. I also understand that if I am awarded the contract and fail to execute it or work under it, I will be required to forfeit to the Department an amount equal to 10% of my total bid amount.** Failure to forfeit the 10% penalty will result in being considered ineligible to bid on any state timber sales for a two-year duration. In the event the highest bidder can not or will not sign the contract, the award will be made to the next highest qualified bid.

Notice: I understand:

Utilization specifications and estimated volumes are listed in the prospectus which is available upon request from the Department.

A copy of the standard timber sales contract which must be entered into is available upon request from the Department.

Signature of Bidder

Bidder's Name (Please Print or Type)

Phone Number (include area code)

Email Address (optional)

GOVERNOR KNOWLES STATE FOREST

Timber Sale #/Name: / Playground Sale	Town: Grantsburg (E)	Legal Description: E1/2SW1/4 Sec. 2 and E1/2NW Sec. 11 T38N R19W
DNR Tract #: GK 50-18	Comp: 21	Stand: 3, 25
Sale Expiration Date: July 15, 2021	Mapped By/Date: Mike Wallis 3/7/18	Acres: 71 Total A-42 ac. B-10 ac. C-5 ac. D-14 ac. Contractor:

Total Minimum Sale Value = \$23,390.00

Whole Tree weight conversions will be at 5,305 pounds/cord

Species/Product	4" Vol. (cords)	Whole Tree Vol. (cords)	Price/Cd	Total
Oak Cordwood	925	N/A		
Jack Pine Cordwood*	270	270*		
Mixed Hardwoods Cordwood**	160	N/A		
Aspen Cordwood	150	N/A		
Mixed Species All Cordwood***	N/A	1400		



*Harvest to a 4" top only, lop and scatter tops throughout sale

**Approx. 96% red maple, 4% other hardwoods

***Approx. 76% oak, 12% maple, 11% aspen, 1% other hardwoods

Total \$

Cutting Requirements/Information

-  Clearcut with Reserves (Blocks A and B) - Harvest all trees with one or more merchantable stick except white pine. Part of block A will be pre-sale scarified by the Department prior to harvest.
-  Clearcut with Reserves (Block C)- Harvest all trees with one or more merchantable stick except white pine. **due to a swamp access from block a, this block is restricted to FROZEN GROUND.**
-  Harvest all trees with one or more merchantable stick except white pine. **Shortwood logging only. No harvesting or hauling in block D from 6:00PM to 7:00AM or all day on Sundays.**

- Utilization: **Jack pine 4" top DIB all blocks. Block D 4" top DIB. Wholetree permitted in blocks A, B, and C only.**
- Block B will be accessed by crossing a narrow stream in the RMZ. The stream crossing may be permitted for all-season use. Installation of the stream crossing will be a coordinated effort between the Department and the Contractor. The Department will obtain a stream crossing permit and provide timber mats for the crossing.**
- Landings shall be approved by the Department prior to their construction.
- Do not harvest paint marked boundary trees.
- Maximum stump height shall be 10 inches.
- Slash shall be lopped and scattered to a maximum height not to exceed 3 feet and kept within the sale boundaries.
- All existing roads shall be kept open to allow for normal use throughout the harvest.
- Harvest all snags within 100 feet of the playground near block D. Leave all other snags standing where they are not a safety risk to the operators.
- All pine in piles between April 15 and August 1 shall be removed from the landing within 30 days.
- Do not damage advanced regeneration or trees not designated for harvest.
- Contractor is required to deliver all pin oak directly to a wood processing facility, minimizing the spread of oak wilt. Only pin oak that is peeled or has loose bark may be sorted and sold as firewood. There are no hauling restrictions on bur/white oak.
- Harvesting shall be done in a systematic and progressive manner. A harvest block shall be completed prior to beginning in another block unless prior approval is given by the Department.
- Seasonal Restrictions - No harvesting in any blocks from April 15-July 15 due to oak wilt restrictions. Block C is restricted to frozen ground due to access across a short stretch of marsh from block A.

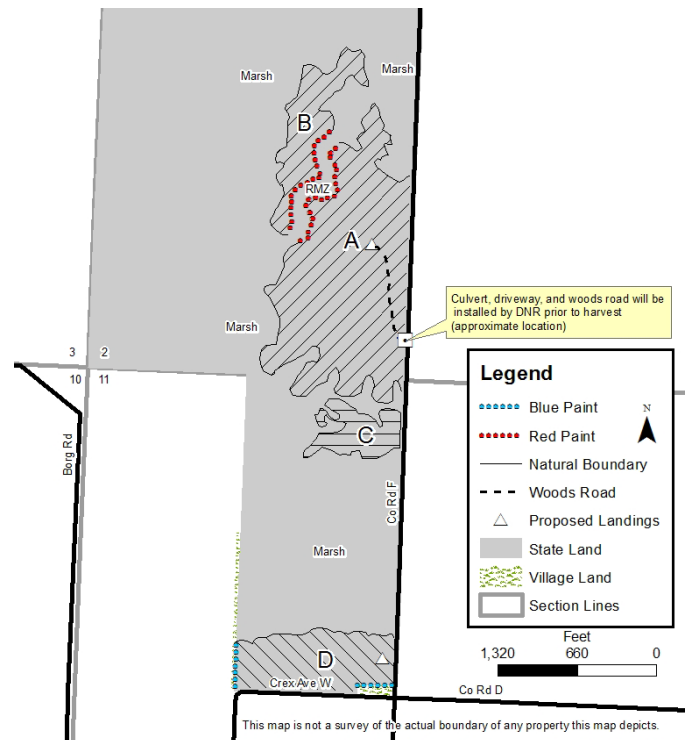

Notice: Completion of this form is mandatory. The Department will not recognize your bid unless you complete and submit this form. Personal information collected will be used for program administration and may be provided to requesters as required by Wisconsin's Open Records law [ss. 19.31-19.39, Wis. Stats.].

Date

Bidder Name

Street Address

City

State

ZIP Code

Property Name (if any)

Governor Knowles State Forest

Tract Number

50-18

Date and Hour of Bid Opening

Minimum Acceptable Bid (optional)

\$ 23,390.00

Species-All bids including Lump Sum bids must be by species	Utilization Specifications	Advertised Value Per Unit (optional)	Estimated Volume	Volume Units	Price Bid Per Unit	Total Bid Value on Estimated Volume
Oak Cordwood	4"		925	Cords		
Jack Pine	4"		270	Cords		
Mixed Hardwoods Cordwood	4"		160	Cords		
Aspen Cordwood	4"		150	Cords		

The award shall be based on this TOTAL BID AMOUNT:

Performance Bond

Will be in the form of: (select one)

☐ Cash

☐ Assurance Bond

☐ Personal Check

☐ Certificate of Deposit

☐ Certified Check/Money Order

☐ Assignment of Savings Account

☐ Irrevocable Letter of Credit

I understand that any or all bids may be rejected and that consideration and awarding of a contract will be based upon my past performance and ability to complete contracts. **I also understand that if I am the winning bidder, I have 6 weeks from the date of the bid opening to submit an acceptable performance bond. I also understand that if I am awarded the contract and fail to execute it or work under it, I will be required to forfeit to the Department an amount equal to 10% of my total bid amount.** Failure to forfeit the 10% penalty will result in being considered ineligible to bid on any state timber sales for a two-year duration. In the event the highest bidder can not or will not sign the contract, the award will be made to the next highest qualified bid.

Notice: I understand:

Utilization specifications and estimated volumes are listed in the prospectus which is available upon request from the Department.

A copy of the standard timber sales contract which must be entered into is available upon request from the Department.

Signature of Bidder

Bidder's Name (Please Print or Type)

Phone Number (include area code)

Email Address (optional)

Notice: Completion of this form is mandatory. The Department will not recognize your bid unless you complete and submit this form. Personal information collected will be used for program administration and may be provided to requesters as required by Wisconsin's Open Records law [ss. 19.31-19.39, Wis. Stats.].

Date

Bidder Name

Street Address

City

State

ZIP Code

Property Name (if any)

Governor Knowles State Forest

Tract Number

50-18

Date and Hour of Bid Opening

Minimum Acceptable Bid (optional)

\$ 23,390.00

Species-All bids including Lump Sum bids must be by species	Utilization Specifications	Advertised Value Per Unit (optional)	Estimated Volume	Volume Units	Price Bid Per Unit	Total Bid Value on Estimated Volume
Mixed Species All	Whole Tree		1,400	Cords		
Jack Pine	4"		270	Cords		

The award shall be based on this TOTAL BID AMOUNT:

Performance Bond

Will be in the form of: (select one)

☐ Cash

☐ Assurance Bond

☐ Personal Check

☐ Certificate of Deposit

☐ Certified Check/Money Order

☐ Assignment of Savings Account

☐ Irrevocable Letter of Credit

I understand that any or all bids may be rejected and that consideration and awarding of a contract will be based upon my past performance and ability to complete contracts. **I also understand that if I am the winning bidder, I have 6 weeks from the date of the bid opening to submit an acceptable performance bond. I also understand that if I am awarded the contract and fail to execute it or work under it, I will be required to forfeit to the Department an amount equal to 10% of my total bid amount.** Failure to forfeit the 10% penalty will result in being considered ineligible to bid on any state timber sales for a two-year duration. In the event the highest bidder can not or will not sign the contract, the award will be made to the next highest qualified bid.

Notice: I understand:

Utilization specifications and estimated volumes are listed in the prospectus which is available upon request from the Department.

A copy of the standard timber sales contract which must be entered into is available upon request from the Department.

Signature of Bidder

Bidder's Name (Please Print or Type)

Phone Number (include area code)

Email Address (optional)

TOTOGATIC WILD RIVER

Mapped By: Kyle Young			Project Type Timber Sale		Contract #
Date Drawn 5/11/17			Comp 3	Stand 44, 45	Contractor
Town MINONG (W)			DNR Tract # 2-17		Expiration Date
Twp 42N	Range 13W	Section 32, 33	Acres 45		Scale 3" = ¼ mile



Aspen - Harvest all merchantable timber except Red Pine, White Pine, White Oak, and X marked trees. Site maintenance required on all hardwood stems.



Jack Pine - Harvest all merchantable timber except White Pine, White Oak, and X marked trees. Site maintenance required on all hardwood stems.

Aspen – 1,050 Tons

Approx. 475 cds

Jack Pine – 700 Tons

Approx. 325 cds

Red Pine – 450 Tons

Approx. 200 cds

Oak – 275 Tons

Approx. 100 cds

Mixed Hdwd – 35 Tons

Approx. 15 cds

(2.3 Tons / cd)

Total Minimum

Sale Value

\$ 26,881.50

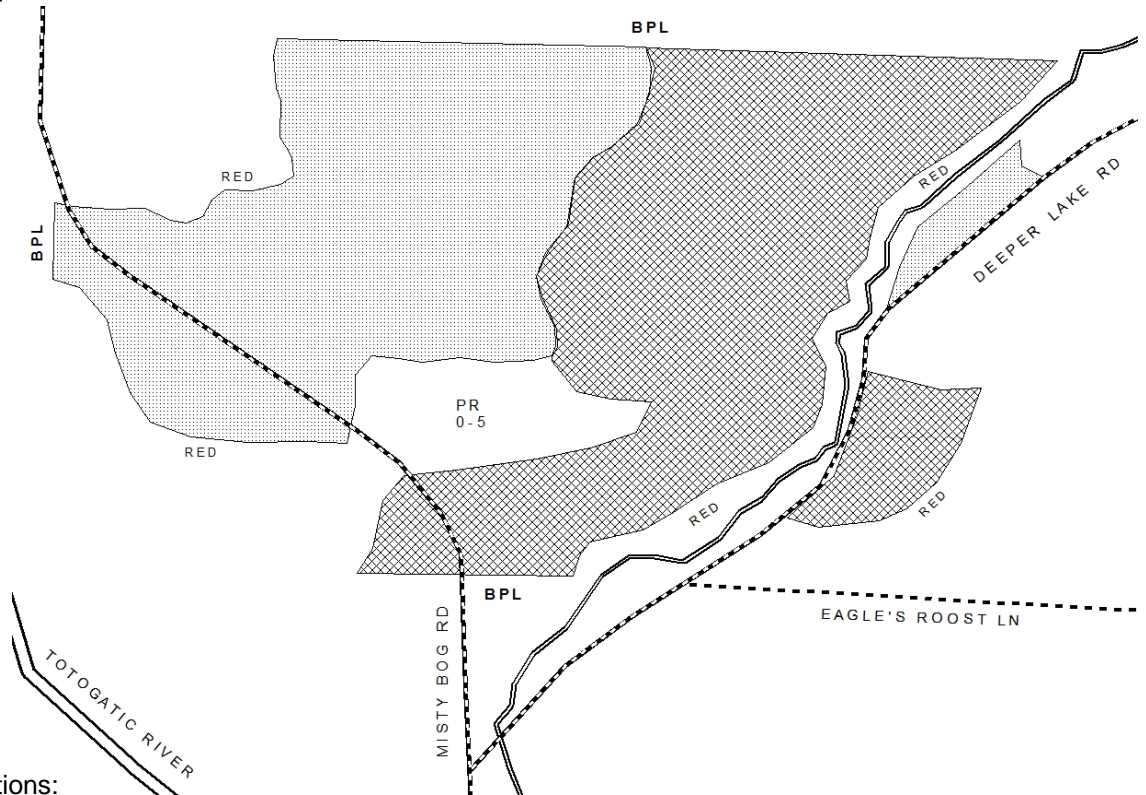

Special Contract Restrictions:

1. Whole tree harvesting is not allowed.
2. **Scarification site. No cutting in jack pine area East of Misty Bog Road allowed until scarification is completed by DNR during non-frozen conditions.** Site will be scheduled for scarification after contractor provides timeline for harvest. Harvest required within 1 year of scarification. Jack pine tops must be scattered directly on scarified areas.
3. Damage to residual trees will result in additional skidding restrictions. Operations will be stopped, if in the opinion of the forester, unnecessary damage occurs.
4. Although summer logging is permitted, during wet periods the soils may become soft, and susceptible to road damage. Operations will be suspended during these periods.
5. All wood cut or in piles shall be removed within 30 days. All wood should be utilized to at least a 4" top.
6. No new roads allowed.
7. Eagle's Roost Lane is a private road and cannot be used at this time. All landings shall be approved by the forester, prior to their construction.
8. Harvest activity during peak summer river use should be conducted to minimize noise disturbance to river users.
9. Leave as many snags standing as possible as long as they do not compromise safety.
10. Wisconsin BMP's for water quality must be followed. No equipment allowed past Red Paint Lines.
11. No equipment is allowed across the blue paint line onto private land at any time.
12. Landings must be free of slash & debris and leveled upon sale completion to the satisfaction of the Department.

Notice: Completion of this form is mandatory. The Department will not recognize your bid unless you complete and submit this form. Personal information collected will be used for program administration and may be provided to requesters as required by Wisconsin's Open Records law [ss. 19.31-19.39, Wis. Stats.].

Date

Bidder Name

Street Address

City

State

ZIP Code

Property Name (if any)

Totogatic Wild River

Tract Number

2-17

Date and Hour of Bid Opening

Minimum Acceptable Bid (optional)

\$ 26,881.50

Species-All bids including Lump Sum bids must be by species	Utilization Specifications	Advertised Value Per Unit (optional)	Estimated Volume	Volume Units	Price Bid Per Unit	Total Bid Value on Estimated Volume
Aspen	4"		1,050	Tons		
Jack Pine	4"		700	Tons		
Red Pine	4"		450	Tons		
Oak	4"		275	Tons		
Mixed Hardwoods	4"		35	Tons		

The award shall be based on this TOTAL BID AMOUNT:

Performance Bond

Will be in the form of: (select one)

☐ Cash

☐ Assurance Bond

☐ Personal Check

☐ Certificate of Deposit

☐ Certified Check/Money Order

☐ Assignment of Savings Account

☐ Irrevocable Letter of Credit

I understand that any or all bids may be rejected and that consideration and awarding of a contract will be based upon my past performance and ability to complete contracts. **I also understand that if I am the winning bidder, I have 6 weeks from the date of the bid opening to submit an acceptable performance bond. I also understand that if I am awarded the contract and fail to execute it or work under it, I will be required to forfeit to the Department an amount equal to 10% of my total bid amount.** Failure to forfeit the 10% penalty will result in being considered ineligible to bid on any state timber sales for a two-year duration. In the event the highest bidder can not or will not sign the contract, the award will be made to the next highest qualified bid.

Notice: I understand:

Utilization specifications and estimated volumes are listed in the prospectus which is available upon request from the Department.

A copy of the standard timber sales contract which must be entered into is available upon request from the Department.

Signature of Bidder

Bidder's Name (Please Print or Type)

Phone Number (include area code)

Email Address (optional)

NAMEKAGON BARRENS WILDLIFE AREA (CONVERSION SALE)

Mapped By: Kyle Young			Project Type Timber Sale		Contract #
Date Drawn 2/12/18			Comp 1	Stand 6	Contractor
Town Blaine (E) Minong (W)			DNR Tract # 1-18		Expiration Date
Twp 42N	Range 14;13W	Section 1;6	Acres 230		Scale 1" = 1/3 Mile

IMPORTANT – PLEASE READ ALL SALE REQUIREMENTS BEFORE BIDDING.
MINIMUM BID VALUES HAVE BEEN LOWERED TO REFLECT EXTRA WORK REQUIRED.

Red Pine 6,750 Tons (approx. 3,000 cords)

Jack Pine 2,125 Tons (approx. 1,000 cords)

Oak 70 Tons (approx. 25 cords)

Total Minimum Sale Bid - \$ 29,806.00

Whole tree bidders add 20%.

Cutting Instructions – **ALL UNITS** – Harvest all merchantable timber except leave 1-3 scattered leave trees / acre (leave a mix of different species, individual trees & clumps). This can be discussed with the forester and adjusted as cutting is taking place. Do not leave any trees within 50' / 100' of fuelbreaks, whichever distance is shown on the map.

 Red Pine – Origin 1980/1984 – 113 Ac

 Jack Pine – Origin 1984 - 2 Ac

 Jack / Red Pine – Origin 1998 – 30 Ac

 Red Pine – Origin 1990 – 58 Ac

 Jack / Red Pine / Oak – 27 Ac
 Fuel Break Clearing
 (Distance shown on map in box)

 Reserve Area – **No Harvest** – 7 Ac
 (Bound by Red Paint Line)

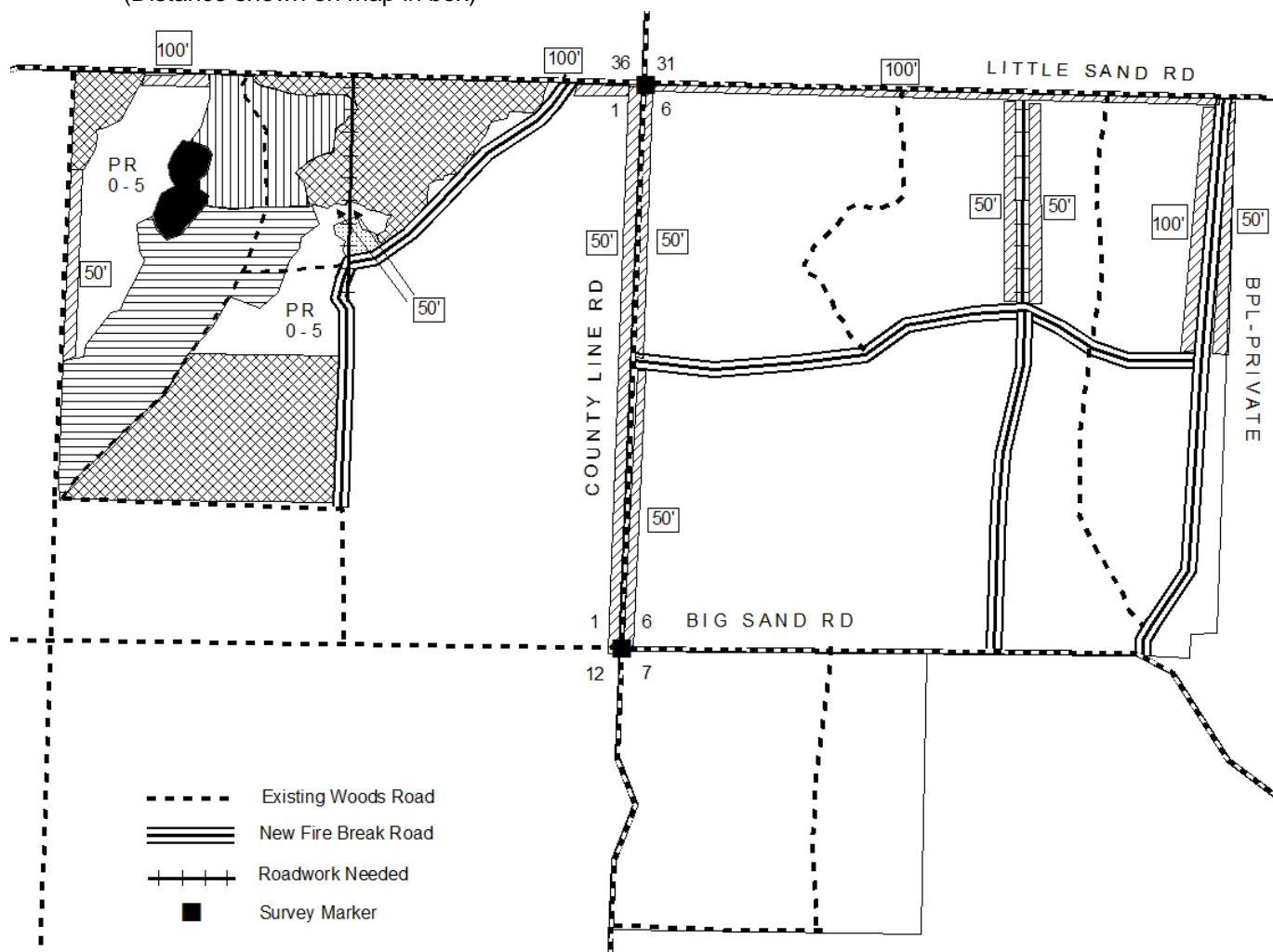

Special Contract Restrictions:

1. **If not whole tree harvested, all tops and slash from logging operations within 100' of town roads & fuelbreak (or distance shown in box) must be picked up, taken back and spread evenly in the sale area / adjoining area, without creating large berms or piles as these areas will be burned and converted to Barrens after harvest is completed.**
2. Damage to residual trees will result in additional skidding restrictions. Operations will be stopped, if in the opinion of the forester, unnecessary damage occurs.
3. All wood cut & in piles shall be removed within 30 days.
4. All non-frozen season harvesting will be allowed (frozen ground harvesting not allowed). Contractor may need to work with townships to determine best haul routes to avoid damage to roads during spring.
5. Do not leave reserve trees within 50' or 100' of fuel break roads, whichever distance is shown in box (including snag trees).
6. All roadwork & landings shall be approved by the forester prior to their construction. Whole tree landings must be located a minimum of 100' from Fire Break Roads to minimize wood chip buildup near fuel breaks. Roads must be free of slash & debris and leveled upon sale completion to the satisfaction of the Department.
7. Wisconsin BMP's must be followed at all times.
8. Leave as many dead standing snags as possible as long as they do not compromise safety.
9. No equipment allowed beyond Blue Paint Lines onto private land at any time.
10. Reserve area surrounded by Red Paint Lines – do not harvest these areas.
11. **There are 2 sections shown on the map (just over $\frac{3}{4}$ mile) where roadwork is needed for future fuelbreak roads. Needed roadwork will be approximately 25' wide. All stumps must be removed and spread evenly throughout the sale area, a minimum of 50' from new roads. Roads must be level upon completion and berms from roadwork should be kept to a minimum. These roads have been flagged & painted in GREEN PAINT by DNR Staff & can be discussed with the forester if there are any questions.**

Notice: Completion of this form is mandatory. The Department will not recognize your bid unless you complete and submit this form. Personal information collected will be used for program administration and may be provided to requesters as required by Wisconsin's Open Records law [ss. 19.31-19.39, Wis. Stats.].

Date

Bidder Name

Street Address

City

State

ZIP Code

Property Name (if any)

Namekagon Barrens Wildlife Area

Tract Number

1-18

Date and Hour of Bid Opening

Minimum Acceptable Bid (optional)

\$ 29,806.00

Species-All bids including Lump Sum bids must be by species	Utilization Specifications	Advertised Value Per Unit (optional)	Estimated Volume	Volume Units	Price Bid Per Unit	Total Bid Value on Estimated Volume
Red Pine	4"		6,750	Tons		
Jack Pine	4"		2,125	Tons		
Oak	4"		70	Tons		

The award shall be based on this TOTAL BID AMOUNT:

Performance Bond

Will be in the form of: (select one)

☐ Cash

☐ Assurance Bond

☐ Personal Check

☐ Certificate of Deposit

☐ Certified Check/Money Order

☐ Assignment of Savings Account

☐ Irrevocable Letter of Credit

I understand that any or all bids may be rejected and that consideration and awarding of a contract will be based upon my past performance and ability to complete contracts. **I also understand that if I am the winning bidder, I have 6 weeks from the date of the bid opening to submit an acceptable performance bond. I also understand that if I am awarded the contract and fail to execute it or work under it, I will be required to forfeit to the Department an amount equal to 10% of my total bid amount.** Failure to forfeit the 10% penalty will result in being considered ineligible to bid on any state timber sales for a two-year duration. In the event the highest bidder can not or will not sign the contract, the award will be made to the next highest qualified bid.

Notice: I understand:

Utilization specifications and estimated volumes are listed in the prospectus which is available upon request from the Department.

A copy of the standard timber sales contract which must be entered into is available upon request from the Department.

Signature of Bidder

Bidder's Name (Please Print or Type)

Phone Number (include area code)

Email Address (optional)

Notice: Completion of this form is mandatory. The Department will not recognize your bid unless you complete and submit this form. Personal information collected will be used for program administration and may be provided to requesters as required by Wisconsin's Open Records law [ss. 19.31-19.39, Wis. Stats.].

Date

Bidder Name

Street Address

City

State

ZIP Code

Property Name (if any)

Namekagon Barrens Wildlife Area

Tract Number

1-18

Date and Hour of Bid Opening

Minimum Acceptable Bid (optional)

\$ 29,806.00

Species-All bids including Lump Sum bids must be by species	Utilization Specifications	Advertised Value Per Unit (optional)	Estimated Volume	Volume Units	Price Bid Per Unit	Total Bid Value on Estimated Volume
Red Pine	Whole Tree		8,100	Tons		
Jack Pine	Whole Tree		2,550	Tons		
Oak	Whole Tree		84	Tons		

The award shall be based on this TOTAL BID AMOUNT:

Performance Bond

Will be in the form of: (select one)

☐ Cash

☐ Assurance Bond

☐ Personal Check

☐ Certificate of Deposit

☐ Certified Check/Money Order

☐ Assignment of Savings Account

☐ Irrevocable Letter of Credit

I understand that any or all bids may be rejected and that consideration and awarding of a contract will be based upon my past performance and ability to complete contracts. **I also understand that if I am the winning bidder, I have 6 weeks from the date of the bid opening to submit an acceptable performance bond. I also understand that if I am awarded the contract and fail to execute it or work under it, I will be required to forfeit to the Department an amount equal to 10% of my total bid amount.** Failure to forfeit the 10% penalty will result in being considered ineligible to bid on any state timber sales for a two-year duration. In the event the highest bidder can not or will not sign the contract, the award will be made to the next highest qualified bid.

Notice: I understand:

Utilization specifications and estimated volumes are listed in the prospectus which is available upon request from the Department.

A copy of the standard timber sales contract which must be entered into is available upon request from the Department.

Signature of Bidder

Bidder's Name (Please Print or Type)

Phone Number (include area code)

Email Address (optional)

SAWYER CREEK FISHERIES AREA

Mapped By: Kyle Young			Project Type Timber Sale		Contract #
Date Drawn 3/12/18			Comp 220	Stand 8, 32, 37	Contractor
Town BASHAW			DNR Tract # 2-18		Expiration Date
Twp 38N	Range 13W	Section 23	Acres 31		Scale 1" = 1/8 mile



Aspen: Harvest all merchantable timber except Conifers, Oak, & Green marked trees. Site maintenance required to 2" on all hardwood stems.



White Pine: Harvest all trees marked in Orange Paint.



Oak / NH: Harvest all tree marked in Orange Paint.

Aspen - 340 Tons (approx. 150 cords)

Mixed Hdwd - 300 Tons (approx. 125 cords)
44% red maple, 24% sugar maple, 8% ash,
8% birch, 16% basswood – **2.29 Tons / cord**

Oak – 135 Tons (approx. 50 cords)

White Pine – 170 Tons (approx. 80 cords)

Mixed Hdwd Sawlogs – 10 MBF

60% red oak, 10% sugar maple,
10% red maple, 10% white oak,
10% basswood

Total Minimum Sale Value
\$ 10,876.20

Special Contract Restrictions:

1. Whole tree harvesting is not allowed.
2. Damage to residual trees will result in additional skidding restrictions. Operations will be stopped, if in the opinion of the forester, unnecessary damage occurs.
3. **Southern Oak Units (East of drainage): Harvest limited to winter only.**
Remainder of Sale area: No harvest activity allowed April 15 – July 15.
Although summer logging is permitted, during wet periods the soils may become soft, and susceptible to road damage. Operations will be suspended during these periods.
4. All wood cut or in piles shall be removed within 30 days.
5. All wood should be utilized to a 4" top
6. All landings shall be approved by the forester, prior to their construction.
7. No new roads will be allowed. Roads must be kept free of debris, passable, and be leveled upon sale completion to the satisfaction of the Department.
8. Leave as many snags standing as possible as long as they do not compromise safety.
9. Wisconsin BMP's for water quality must be followed. No equipment allowed within 15' of wetland or stream edges.
10. No equipment is allowed across the blue paint line onto private land at any time.
11. Gates shall remain closed during non-work hours.
12. Snowmobile trail shall remain free of debris, passable, & snow-covered during winter.
13. **Invasive species present – WI BMP's for Invasive Species shall be followed.**
14. All sawtimber must be scaled by DNR staff prior to leaving the site.

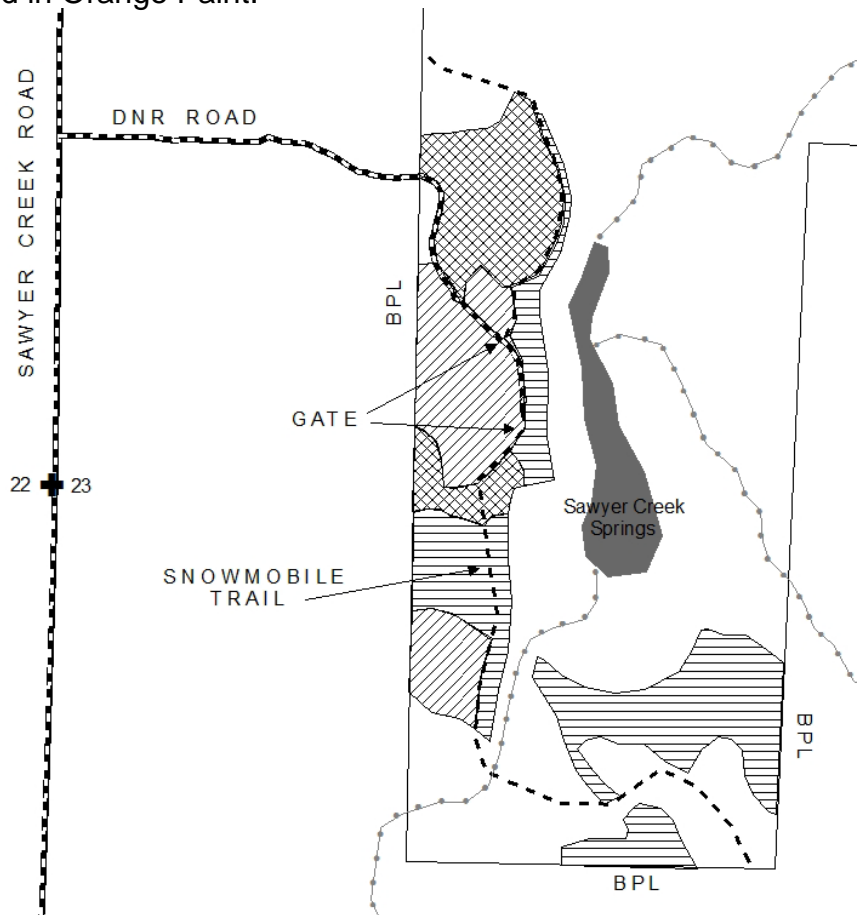

Notice: Completion of this form is mandatory. The Department will not recognize your bid unless you complete and submit this form. Personal information collected will be used for program administration and may be provided to requesters as required by Wisconsin's Open Records law [ss. 19.31-19.39, Wis. Stats.].

Date

Bidder Name

Street Address

City

State

ZIP Code

Property Name (if any)

Sawyer Creek Fisheries Area

Tract Number

2-18

Date and Hour of Bid Opening

Minimum Acceptable Bid (optional)

\$ 10,876.20

Species-All bids including Lump Sum bids must be by species	Utilization Specifications	Advertised Value Per Unit (optional)	Estimated Volume	Volume Units	Price Bid Per Unit	Total Bid Value on Estimated Volume
Aspen	4"		340	Tons		
Mixed Hardwoods	4"		300	Tons		
Oak	4"		135	Tons		
White Pine	4"		170	Tons		
Mixed Hardwoods	4"		10	MBF		

The award shall be based on this TOTAL BID AMOUNT:

Performance Bond

Will be in the form of: (select one)

☐ Cash

☐ Assurance Bond

☐ Personal Check

☐ Certificate of Deposit

☐ Certified Check/Money Order

☐ Assignment of Savings Account

☐ Irrevocable Letter of Credit

I understand that any or all bids may be rejected and that consideration and awarding of a contract will be based upon my past performance and ability to complete contracts. **I also understand that if I am the winning bidder, I have 6 weeks from the date of the bid opening to submit an acceptable performance bond. I also understand that if I am awarded the contract and fail to execute it or work under it, I will be required to forfeit to the Department an amount equal to 10% of my total bid amount.** Failure to forfeit the 10% penalty will result in being considered ineligible to bid on any state timber sales for a two-year duration. In the event the highest bidder can not or will not sign the contract, the award will be made to the next highest qualified bid.

Notice: I understand:

Utilization specifications and estimated volumes are listed in the prospectus which is available upon request from the Department.

A copy of the standard timber sales contract which must be entered into is available upon request from the Department.

Signature of Bidder

Bidder's Name (Please Print or Type)

Phone Number (include area code)

Email Address (optional)

MAPPED BY: JEREMY KOSLOWSKI	PROJECT TYPE: TIMBER SALE	TIMBER SALE NUMBER (ASSIGNED ONCE SOLD)
DATE DRAWN: 05-03-2016	COMP: 300 STAND: 8,10,11,2	CONTRACTOR:
TOWNSHIP: LORAIN	DNR TRACT #: 4934-1-16	EXPIRATION DATE:
TOWN/ RANGE/ SECTION T37N R15W SEC. 20	ACRES: 61 ACRE HARDWOOD SELECTION 8 ACRE RED PINE THINNING 5 ACRE WHITE SPRUCE THINNING 3 ACRE WHITE PINE THINNING	EASY CHAIR SALE

Estimated Volume	
Red Oak	35 MBF
White Oak	10 MBF
MX	17 MBF
Basswood	6 MBF
Mx pulp	205 cds
Oak pulp	165 cds
Basswood pulp	50 cds
Aspen	60 cds
Red Pine/spruce/white pine	130 cds
Minimum Advertised Value	\$27,530.00
Lump Sum Sale	

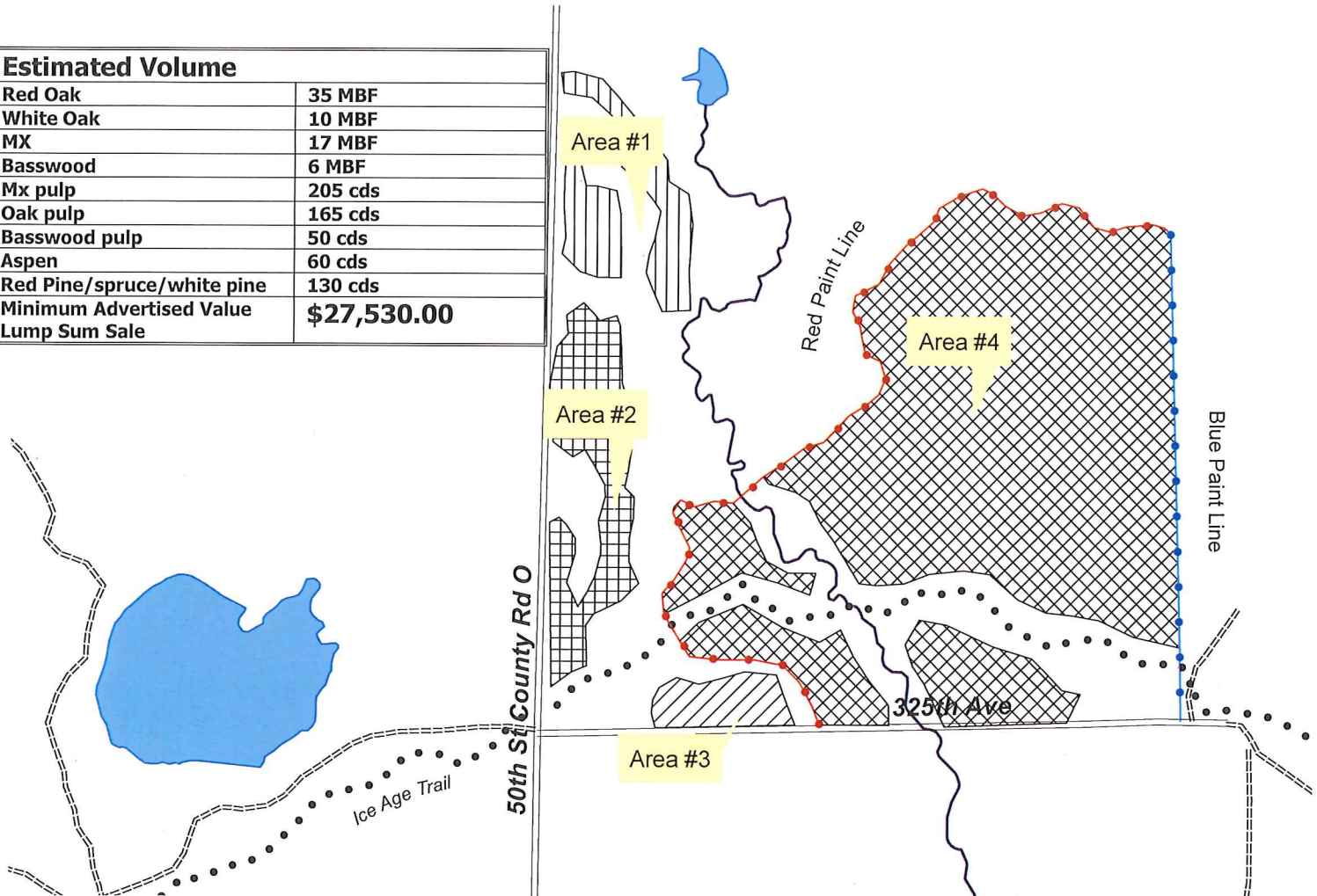

Cutting Requirements / Information

1. Areas #1, 2 and 3 - Harvest all trees marked with orange paint.
2. Area #4 - Harvest all trees marked with orange paint and all aspen and white birch 2 inches and greater.
3. No cutting or slash within 50' of the Ice Age Trail. Crossing the trail with equipment should be kept to a minimum. Any slash or other debris must be removed by the end of each day.
4. **No cutting, skidding or hauling from breakup to August 24** due to two threatened birds, or any wet periods when rutting occurs.
5. Wisconsin BMP's for water quality must be followed around any streams, ponds, wetlands, and vernal pools.
6. Utilization: Utilize all harvested trees that will make at least 1 pulp stick 4 inches on small end.
7. No whole tree harvesting. Care must be taken to avoid damage to residual trees. No tops or trees are to be left hanging in standing trees and slash must be lopped to below 3 feet and kept within sale area. If excessive damage occurs to residual trees, fines will be imposed and equipment and/or operators will be restricted.
8. All improvements to existing road, if made, are the responsibility of the buyer. Roads and landings required to be cleared and smoothed out to allow seeding by DNR after sale completion. Any new roads to or within sale must have prior approval. Where access road and ice age trail overlap, IAT must be kept open and passable.
9. This is a lump sum sale for all products. Payments may be broken down into payment blocks at the discretion of the administering forester.

Notice: Completion of this form is mandatory. The Department will not recognize your bid unless you complete and submit this form. Personal information collected will be used for program administration and may be provided to requesters as required by Wisconsin's Open Records law [ss. 19.31-19.39, Wis. Stats.].

Date

Bidder Name

Street Address

City

State

ZIP Code

Property Name (if any)

Ice Age Trail (LUMP SUM)

Tract Number

4934-1-16

Date and Hour of Bid Opening

Minimum Acceptable Bid (optional)

\$ 27,530.00

Species-All bids including Lump Sum bids must be by species	Utilization Specifications	Advertised Value Per Unit (optional)	Estimated Volume	Volume Units	Price Bid Per Unit	Total Bid Value on Estimated Volume
Red Oak	4"		35	MBF		
White Oak	4"		10	MBF		
Mixed Hardwoods	4"		17	MBF		
Basswood	4"		6	MBF		
Mixed Hardwoods	4"		205	Cords		
Oak	4"		165	Cords		
Basswood	4"		50	Cords		
Aspen	4"		60	Cords		
Red Pine/Spruce/White Pine	4"		130	Cords		

The award shall be based on this TOTAL BID AMOUNT:

Performance Bond

Will be in the form of: (select one)

☐ Cash

☐ Personal Check

☐ Certified Check/Money Order

☐ Irrevocable Letter of Credit

☐ Assurance Bond

☐ Certificate of Deposit

☐ Assignment of Savings Account

I understand that any or all bids may be rejected and that consideration and awarding of a contract will be based upon my past performance and ability to complete contracts. **I also understand that if I am the winning bidder, I have 6 weeks from the date of the bid opening to submit an acceptable performance bond. I also understand that if I am awarded the contract and fail to execute it or work under it, I will be required to forfeit to the Department an amount equal to 10% of my total bid amount.** Failure to forfeit the 10% penalty will result in being considered ineligible to bid on any state timber sales for a two-year duration. In the event the highest bidder can not or will not sign the contract, the award will be made to the next highest qualified bid.

Notice: I understand:

Utilization specifications and estimated volumes are listed in the prospectus which is available upon request from the Department.

A copy of the standard timber sales contract which must be entered into is available upon request from the Department.

Signature of Bidder

Bidder's Name (Please Print or Type)

Phone Number (include area code)

Email Address (optional)

Fish Lake Wildlife Area

Mapped By: Mark Gossman			Project Type Timber Sale		Contract #
Date Drawn 3/6/18			Comp 147	Stand 2	Contractor
Town Anderson (E)			DNR Tract # FL 11-18		Expiration Date
Twp 37N	Range 19W	Section 7,17,18	Acres 198		Scale 1"=1/4 Mile



Scrub Oak Clearcut Area. 191 Ac. Cut all Northern pin oak, aspen, jack pine, and maple. Leave all red and white pine as well as White oak. Within 100 feet of the sale perimeter no leave trees will be left. No slash within 50 feet of the perimeter. All stems 2 inches and larger will be cut. No harvesting from April 15th to August 1st. Roughly 40% of the sale can be cut during dry conditions. No operations allowed within the Natural Area to the North. A map will be provided at the time of cutting. **This sale is being offered to either a 4-inch top or whole tree.**



Same Prescription old cut over area with mature oak and Jack pine. **7 Ac.**

Species	4" Tons	WT tons	Approx. Cords 4"
*Scrub Oak	9000	11,500	3500
Aspen	790	950	350
Jack Pine	440	530	200

*Scrub oak volume contains Northern pin oak. In addition, a small amount of maple is included.

Minimum Advertised Value: \$42,296.00

Special Contract Restriction

- All wood cut or in piles shall be removed within 30 days.
- Operation will be stopped, if in the opinion of the forester unnecessary damage occurs.
- Damage to residual trees will result in additional skidding restrictions.
- No slash is to be left in any wetland or within 50 feet of the sale edges.
- No equipment within 15' of wetland edges during non-frozen time of year.
- All slash shall be lopped to within 3' of the ground.
- Landings shall be located only where indicated by ▲ on the sale map, unless approval is obtained from the forester.
- No slash or equipment allowed across blue paint line onto private land at any time, trees shall be felled onto State property and away from private lands
- Protect survey monuments shown on timber sale map. Damage will result in restoration costs paid by the contractor.
- Whole tree harvesting allowed, contractor must retain one in every ten tree tops scattered throughout the sale area.
- Woods trails and roads must remain open and free of debris during logging operation.
- Road approaches to town, roads are the responsibility of the contractor. Damage to these roads are the responsibility of the contractor. The approach to town roads may need improvements prior to hauling to prevent damage.

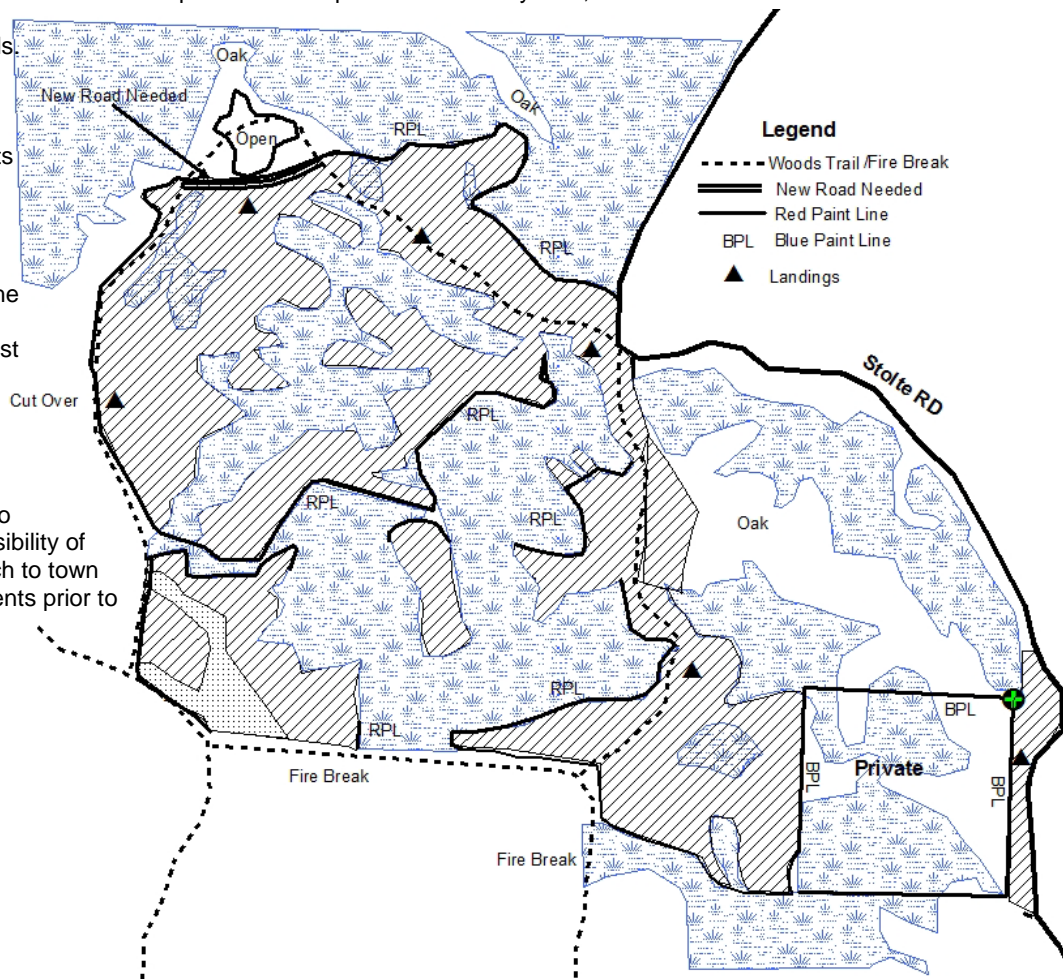

Notice: Completion of this form is mandatory. The Department will not recognize your bid unless you complete and submit this form. Personal information collected will be used for program administration and may be provided to requesters as required by Wisconsin's Open Records law [ss. 19.31-19.39, Wis. Stats.].

Date

Bidder Name

Street Address

City

State

ZIP Code

Property Name (if any)

Fish Lake Wildlife Area

Tract Number

FL 11-18

Date and Hour of Bid Opening

Minimum Acceptable Bid (optional)

\$ 42,296.00

Species-All bids including Lump Sum bids must be by species	Utilization Specifications	Advertised Value Per Unit (optional)	Estimated Volume	Volume Units	Price Bid Per Unit	Total Bid Value on Estimated Volume
Scrub Oak	4"		9,000	tons		
Aspen	4"		790	tons		
Jack Pine	4'		440	tons		

The award shall be based on this TOTAL BID AMOUNT:

Performance Bond

Will be in the form of: (select one)

☐ Cash

☐ Personal Check

☐ Certified Check/Money Order

☐ Irrevocable Letter of Credit

☐ Assurance Bond

☐ Certificate of Deposit

☐ Assignment of Savings Account

I understand that any or all bids may be rejected and that consideration and awarding of a contract will be based upon my past performance and ability to complete contracts. **I also understand that if I am the winning bidder, I have 6 weeks from the date of the bid opening to submit an acceptable performance bond. I also understand that if I am awarded the contract and fail to execute it or work under it, I will be required to forfeit to the Department an amount equal to 10% of my total bid amount.** Failure to forfeit the 10% penalty will result in being considered ineligible to bid on any state timber sales for a two-year duration. In the event the highest bidder can not or will not sign the contract, the award will be made to the next highest qualified bid.

Notice: I understand:

Utilization specifications and estimated volumes are listed in the prospectus which is available upon request from the Department.

A copy of the standard timber sales contract which must be entered into is available upon request from the Department.

Signature of Bidder

Bidder's Name (Please Print or Type)

Phone Number (include area code)

Email Address (optional)

Notice: Completion of this form is mandatory. The Department will not recognize your bid unless you complete and submit this form. Personal information collected will be used for program administration and may be provided to requesters as required by Wisconsin's Open Records law [ss. 19.31-19.39, Wis. Stats.].

Date

Bidder Name

Street Address

City

State

ZIP Code

Property Name (if any)

Fish Lake Wildlife Area

Tract Number

FL 11-18

Date and Hour of Bid Opening

Minimum Acceptable Bid (optional)

\$ 42,296.00

Species-All bids including Lump Sum bids must be by species	Utilization Specifications	Advertised Value Per Unit (optional)	Estimated Volume	Volume Units	Price Bid Per Unit	Total Bid Value on Estimated Volume
Scrub Oak	Whole Tree		11,500	tons		
Aspen	Whole Tree		950	tons		
Jack Pine	Whole Tree		530	tons		

The award shall be based on this TOTAL BID AMOUNT:

Performance Bond

Will be in the form of: (select one)

☐ Cash

☐ Personal Check

☐ Certified Check/Money Order

☐ Irrevocable Letter of Credit

☐ Assurance Bond

☐ Certificate of Deposit

☐ Assignment of Savings Account

I understand that any or all bids may be rejected and that consideration and awarding of a contract will be based upon my past performance and ability to complete contracts. **I also understand that if I am the winning bidder, I have 6 weeks from the date of the bid opening to submit an acceptable performance bond. I also understand that if I am awarded the contract and fail to execute it or work under it, I will be required to forfeit to the Department an amount equal to 10% of my total bid amount.** Failure to forfeit the 10% penalty will result in being considered ineligible to bid on any state timber sales for a two-year duration. In the event the highest bidder can not or will not sign the contract, the award will be made to the next highest qualified bid.

Notice: I understand:

Utilization specifications and estimated volumes are listed in the prospectus which is available upon request from the Department.

A copy of the standard timber sales contract which must be entered into is available upon request from the Department.

Signature of Bidder

Bidder's Name (Please Print or Type)

Phone Number (include area code)

Email Address (optional)

Crex Meadows Wildlife Area

Mapped By: Mark Gossman			Project Type Timber Sale		Contract #
Date Drawn 1/5/2018			Comp 102:103	Stand 1: 6,20	Contractor
Town West Marshland			DNR Tract # CM12-18		Expiration Date
Twp 39N	Range 18W	Section 5	Acres 92		Scale 1" = 1/4 Mile



Scrub Oak Clearcut Area. 64 Ac. Cut all oak, jack pine aspen and maple. All stems must be severed. Trees may be cut up to wetlands but no slash or equipment operations within 15 feet of wetlands. Shrubs and grasses must remain undisturbed. Site Maintenance required. All hardwood stems 2" and larger within designated areas must be severed.

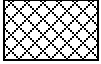

Jack pine/White Pine Scrub Oak clearcut with Reserves. 28 Ac. Cut all oak, jack pine, aspen maple and white pine over 8 inches diameter breast height. Leave all white pine under 8 inches and red pine undamaged. Protect seedling sapling white pine regeneration as best as possible.

Species	Tons	Whole Tree Tons	Approx. cords
*Scrub Oak	3200	3860	1170
**White Pine	435	500	210
Jack Pine	215	245	130
Aspen	210	245	95

Minimum Advertised Value: \$23,550.30

*Contains a small amount of maple

** Contains 40% sawlog material

Special Contract Restriction

- Roughly 80 percent of this sale can be cut during dry ground conditions the remaining must be cut during frozen ground conditions.
- All wood cut or in piles shall be removed within 30 days.
- Operation will be stopped, if in the opinion of the forester, unnecessary damage occurs.
- Damage to residual trees will result in additional skidding restrictions.
- No slash is to be left in any wetland within 50 feet of Currey RD, County Road F, or the Southern Fire break. (Road on the South end of the tract.)
- No equipment within 15' of wetland edges during non-frozen time of year.
- All slash shall be lopped to within 2' of the ground. No slash allowed within 50 feet of the fuel break located along the southern fuel break on the very southern part of the sale. In addition, no slash left within 50 feet of County Rd F.
- Landings shall be located only where indicated by a ▲ on the sale map, unless approval is obtained from the forester.
- No slash or equipment allowed across blue paint line onto private land at any time, trees shall be felled onto state property and away from private lands.
- Whole tree harvesting allowed.
- Due to the occurrence of oak wilt, harvesting is not permitted from April 15th to July 15th.
- Road approaches to County Road F are the responsibility of the contractor.

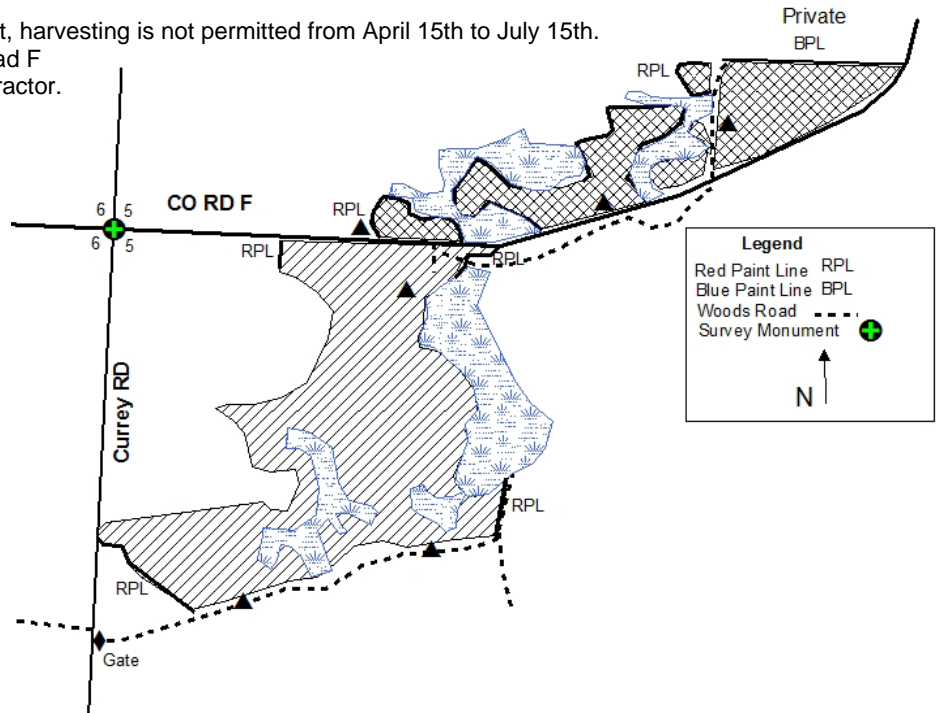

Notice: Completion of this form is mandatory. The Department will not recognize your bid unless you complete and submit this form. Personal information collected will be used for program administration and may be provided to requesters as required by Wisconsin's Open Records law [ss. 19.31-19.39, Wis. Stats.].

Date

Bidder Name

Street Address

City

State

ZIP Code

Property Name (if any)

Crex Meadows Wildlife Area

Tract Number

CM 12-18

Date and Hour of Bid Opening

Minimum Acceptable Bid (optional)

\$ 23,550.30

Species-All bids including Lump Sum bids must be by species	Utilization Specifications	Advertised Value Per Unit (optional)	Estimated Volume	Volume Units	Price Bid Per Unit	Total Bid Value on Estimated Volume
Scrub Oak	4"		3,200	tons		
White Pine	4"		435	tons		
Jack Pine	4"		215	tons		
Aspen	4"		210	tons		

The award shall be based on this TOTAL BID AMOUNT:

Performance Bond

Will be in the form of: (select one)

☐ Cash

☐ Personal Check

☐ Certified Check/Money Order

☐ Irrevocable Letter of Credit

☐ Assurance Bond

☐ Certificate of Deposit

☐ Assignment of Savings Account

I understand that any or all bids may be rejected and that consideration and awarding of a contract will be based upon my past performance and ability to complete contracts. **I also understand that if I am the winning bidder, I have 6 weeks from the date of the bid opening to submit an acceptable performance bond. I also understand that if I am awarded the contract and fail to execute it or work under it, I will be required to forfeit to the Department an amount equal to 10% of my total bid amount.** Failure to forfeit the 10% penalty will result in being considered ineligible to bid on any state timber sales for a two-year duration. In the event the highest bidder can not or will not sign the contract, the award will be made to the next highest qualified bid.

Notice: I understand:

Utilization specifications and estimated volumes are listed in the prospectus which is available upon request from the Department.

A copy of the standard timber sales contract which must be entered into is available upon request from the Department.

Signature of Bidder

Bidder's Name (Please Print or Type)

Phone Number (include area code)

Email Address (optional)

Notice: Completion of this form is mandatory. The Department will not recognize your bid unless you complete and submit this form. Personal information collected will be used for program administration and may be provided to requesters as required by Wisconsin's Open Records law [ss. 19.31-19.39, Wis. Stats.].

Date

Bidder Name

Street Address

City

State

ZIP Code

Property Name (if any)

Crex Meadows Wildlife Area

Tract Number

CM 12-18

Date and Hour of Bid Opening

Minimum Acceptable Bid (optional)

\$ 23,550.30

Species-All bids including Lump Sum bids must be by species	Utilization Specifications	Advertised Value Per Unit (optional)	Estimated Volume	Volume Units	Price Bid Per Unit	Total Bid Value on Estimated Volume
Scrub Oak	Whole Tree		3,860	Tons		
White Pine	Whole Tree		500	Tons		
Jack Pine	Whole Tree		245	Tons		
Aspen	Whole Tree		245	Tons		

The award shall be based on this TOTAL BID AMOUNT:

Performance Bond

Will be in the form of: (select one)

☐ Cash

☐ Assurance Bond

☐ Personal Check

☐ Certificate of Deposit

☐ Certified Check/Money Order

☐ Assignment of Savings Account

☐ Irrevocable Letter of Credit

I understand that any or all bids may be rejected and that consideration and awarding of a contract will be based upon my past performance and ability to complete contracts. **I also understand that if I am the winning bidder, I have 6 weeks from the date of the bid opening to submit an acceptable performance bond. I also understand that if I am awarded the contract and fail to execute it or work under it, I will be required to forfeit to the Department an amount equal to 10% of my total bid amount.** Failure to forfeit the 10% penalty will result in being considered ineligible to bid on any state timber sales for a two-year duration. In the event the highest bidder can not or will not sign the contract, the award will be made to the next highest qualified bid.

Notice: I understand:

Utilization specifications and estimated volumes are listed in the prospectus which is available upon request from the Department.

A copy of the standard timber sales contract which must be entered into is available upon request from the Department.

Signature of Bidder

Bidder's Name (Please Print or Type)

Phone Number (include area code)

Email Address (optional)

Sand Creek Fisheries Area

Mapped By: Mark Gossman			Project Type Timber Sale		Contract #
Date Drawn 4/8/18			Comp 240	Stand 4,9	Contractor
Town Roosevelt			DNR Tract # SC 13-18		Expiration Date
Twp 37N	Range 14W	Section 19	Acres 20		Scale 1 inch = 1/4 mile

Oak Thinning and Regeneration Area (15 ac)



Harvest all aspen except trees marked with green paint. Also harvest all orange marked trees.

Aspen Regeneration and Oak Reserve Area (5 ac)



Harvest all aspen except for trees marked with green paint. Leave all oak and white pine

	Tons	Approx. cds
Aspen	360	160
Mixed Hardwood	410	180

Minimum Sale Value

\$7518.00

Sale sold in tons

Special Contract Restrictions

- Shortwood operations only. Harvest to a 4-inch top.
- Permission to cross private land (Wally Cudd) is the responsibility of the contractor. Preliminary permission has been granted to use the access as drawn on the map.
- Landing must be approved by the administering forester.
- Operations will be stopped, if in the opinion of the forester, unnecessary damage occurs.
- No operation within designated RMZ's.
- All slash to be scattered within 2' of ground.
- No slash or equipment allowed across blue paint line at any time. Trees shall be felled onto State property and away from private land.
- Leave all snags unless leaving them is a safety concern. Leave all blown over, broken and tipped trees
- Operations during frozen grounds conditions only.

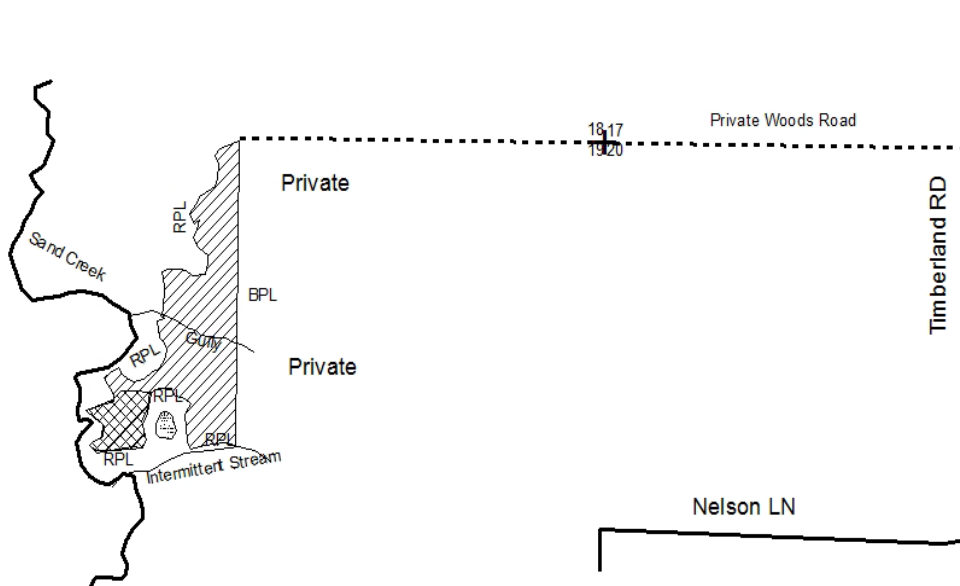

Notice: Completion of this form is mandatory. The Department will not recognize your bid unless you complete and submit this form. Personal information collected will be used for program administration and may be provided to requesters as required by Wisconsin's Open Records law [ss. 19.31-19.39, Wis. Stats.].

Date

Bidder Name

Street Address

City

State

ZIP Code

Property Name (if any)

Sand Creek Fisheries Area

Tract Number

SC 13-18

Date and Hour of Bid Opening

Minimum Acceptable Bid (optional)

\$ 7,518.00

Species-All bids including Lump Sum bids must be by species	Utilization Specifications	Advertised Value Per Unit (optional)	Estimated Volume	Volume Units	Price Bid Per Unit	Total Bid Value on Estimated Volume
Aspen	4"		360	tons		
Mixed Hardwood	4"		410	tons		

The award shall be based on this TOTAL BID AMOUNT:

Performance Bond

Will be in the form of: (select one)

☐ Cash

☐ Personal Check

☐ Certified Check/Money Order

☐ Irrevocable Letter of Credit

☐ Assurance Bond

☐ Certificate of Deposit

☐ Assignment of Savings Account

I understand that any or all bids may be rejected and that consideration and awarding of a contract will be based upon my past performance and ability to complete contracts. **I also understand that if I am the winning bidder, I have 6 weeks from the date of the bid opening to submit an acceptable performance bond. I also understand that if I am awarded the contract and fail to execute it or work under it, I will be required to forfeit to the Department an amount equal to 10% of my total bid amount.** Failure to forfeit the 10% penalty will result in being considered ineligible to bid on any state timber sales for a two-year duration. In the event the highest bidder can not or will not sign the contract, the award will be made to the next highest qualified bid.

Notice: I understand:

Utilization specifications and estimated volumes are listed in the prospectus which is available upon request from the Department.

A copy of the standard timber sales contract which must be entered into is available upon request from the Department.

Signature of Bidder

Bidder's Name (Please Print or Type)

Phone Number (include area code)

Email Address (optional)