

Tract 18-25 (Bugle Boy) - Flambeau River State Forest

Parts of: E1/2, Section 19, T38N-R3W, Winter Township, Sawyer County



Selection Area (83 acres) - Bounded by red paint, harvest all orange marked trees within the designated boundaries. Sever all orange marked unmerchantable stems and all ironwood. Do not cut snags, cull trees, or trees marked with an orange X.



Coppice Area (30 acres) - Bounded by yellow paint, harvest all trees greater than 1" except for green marked trees, hemlock, white pine, oak, cedar, and cherry.

Total Acres: 113

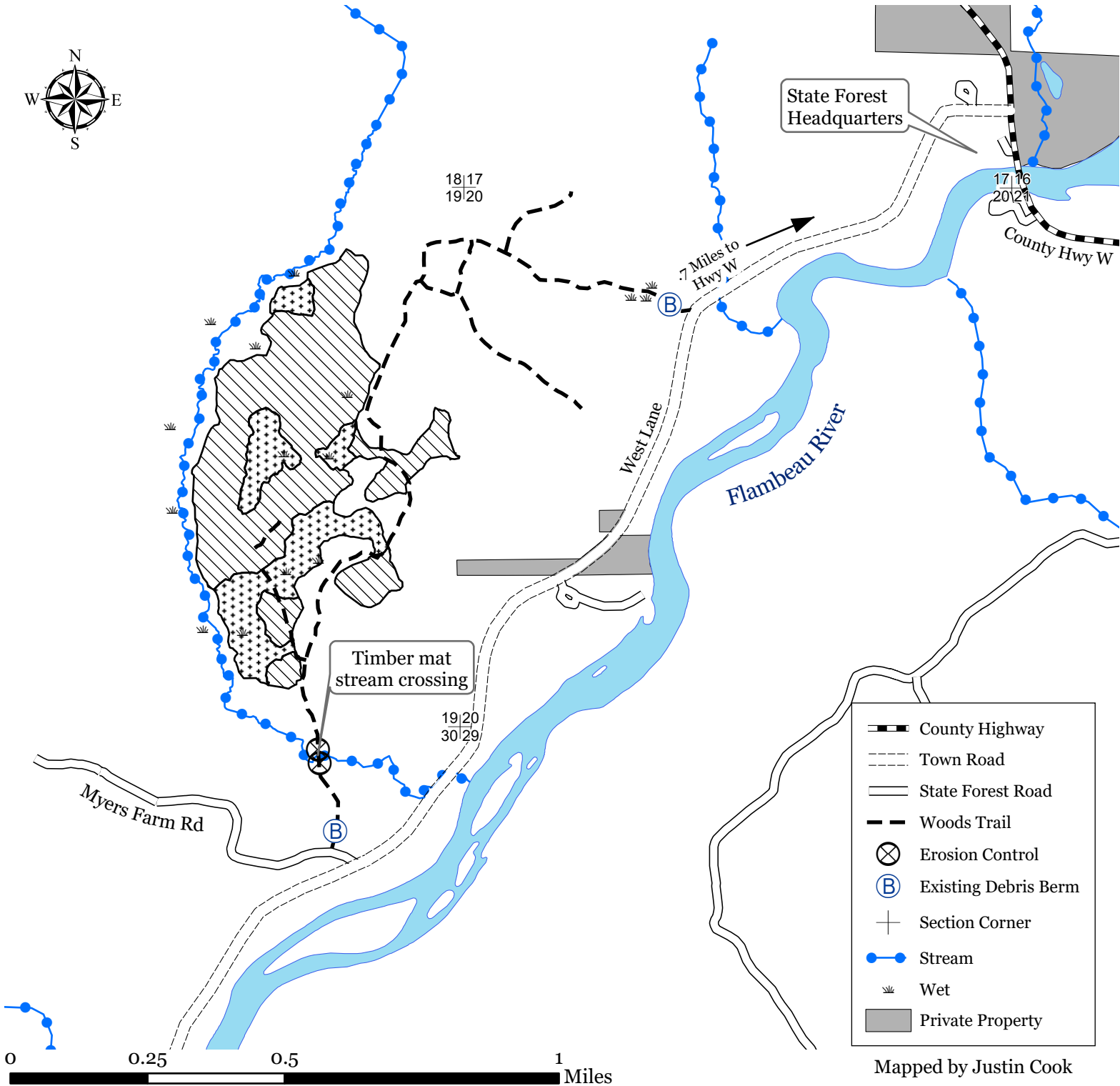

Mapped by Justin Cook

1:15,840

This map is for informational purposes only and may not have been prepared for or be suitable for legal, engineering or surveying purposes.

The user is solely responsible for verifying the accuracy of information before using for any purpose.

By using this product for any purpose user agrees to be bound by all disclaimers found here: <https://dnr.wisconsin.gov/legal>.