

Tract 7-24 (Scooby) - Flambeau River State Forest

Parts of: W1/2NE, NWSE, NENW, SENW, NESW Sec. 14, T 38N-R3W, Town of Winter, Sawyer County

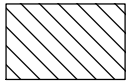

Selection Area (44 acres) – Bounded by red paint. Harvest all orange marked trees. Sever all orange marked unmerchantable stems. Leave all snags.

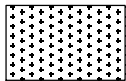

Aspen Coppice Area (19 acres) – Bounded by yellow paint. Cut all trees greater than 2” except for: 1) hemlock, 2) pine, 3) oak, 4) cherry, 5) spruce, 6) balsam, 7) green marked trees. Leave all snags.

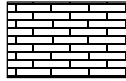

Canopy Openings (7 acres) – Bounded by purple paint. Harvest all trees greater than 2” except for: 1) conifers, 2) oak, 3) aspen, 4) purple marked trees. *Within openings, processor/skidder trails will be at least 50’ apart. Trees should be directionally felled out of the gaps or onto this equipment access lane to prevent damage to established regeneration.*

Total Acres: 70

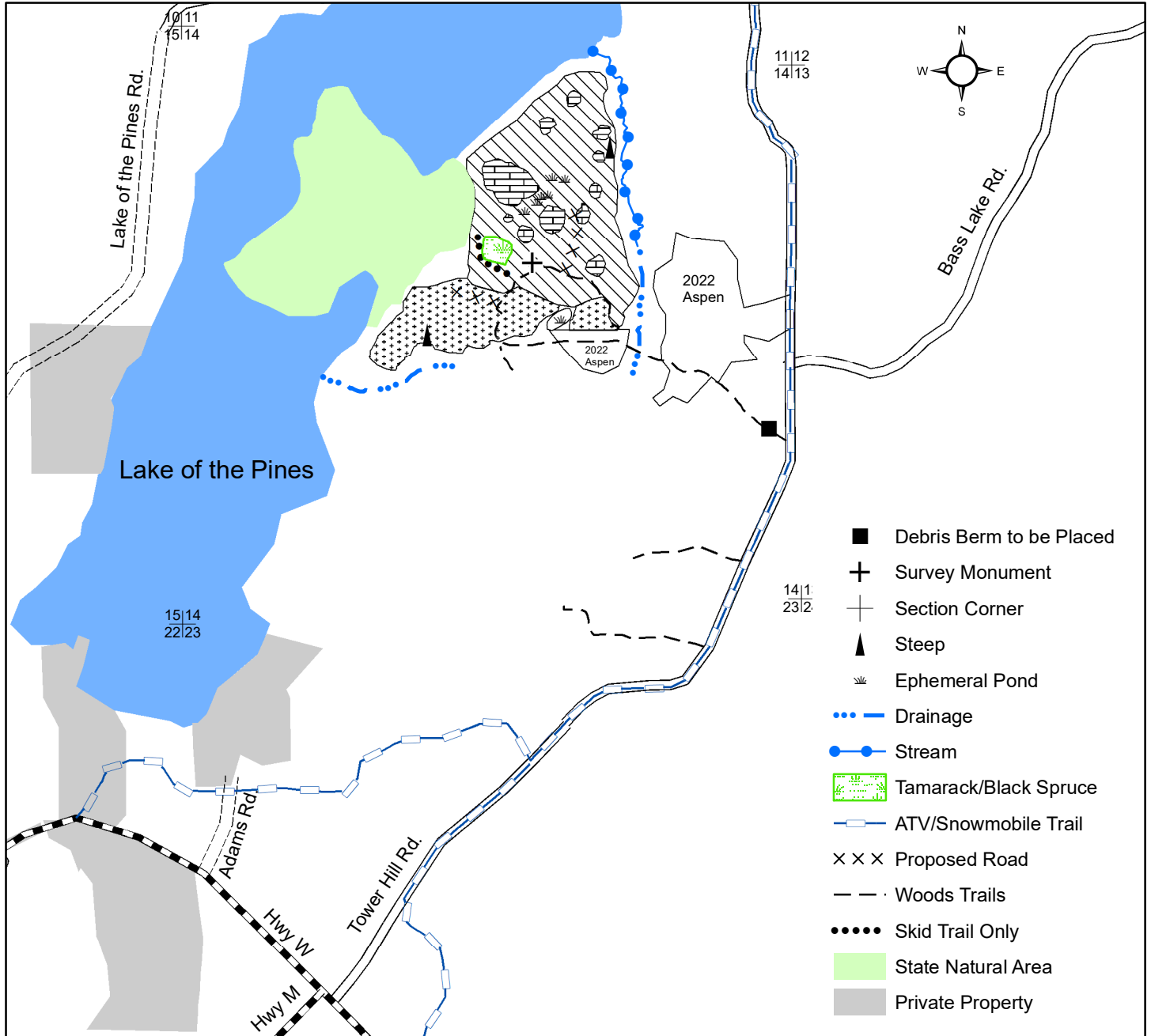

1:15,840

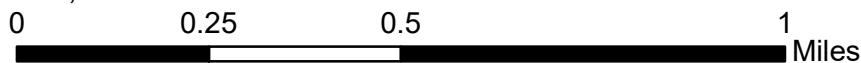

Mapped by Heidi Brunkow

This map is for informational purposes only and may have not been prepared for or be suitable for legal, engineering or surveying purposes. The user is solely responsible for verifying the accuracy of information before using for any purpose. By using this product for any purpose user agrees to be bound by all disclaimers found here: <https://dnr.wisconsin.gov/legal>.