

Tract 2-25 (Wears Your Paddle) - Flambeau River State Forest

Parts of: SE, SESW, Sec. 34, T37N - R4W, Town of Winter, Sawyer County.
 NWNE Sec. 3, T36N - R4W, Town of Cedar Rapids, Rusk County.

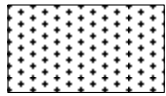

Coppice area (60 acres) - Bounded by red paint, blue paint, green paint, roads, and trails. Harvest all trees greater than 1". Leave all 1) hemlock, 2) cedar, 3) white pine, 4) oak, 5) butternut, 6) green marked trees, 7) all snags.

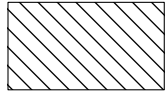

Selection area (3 acres) - Bounded by red paint, blue paint, roads, and trails. Harvest all orange marked trees within the designated boundaries. Sever all orange marked unmerchantable stems. Leave all snags.

Total acres: 63

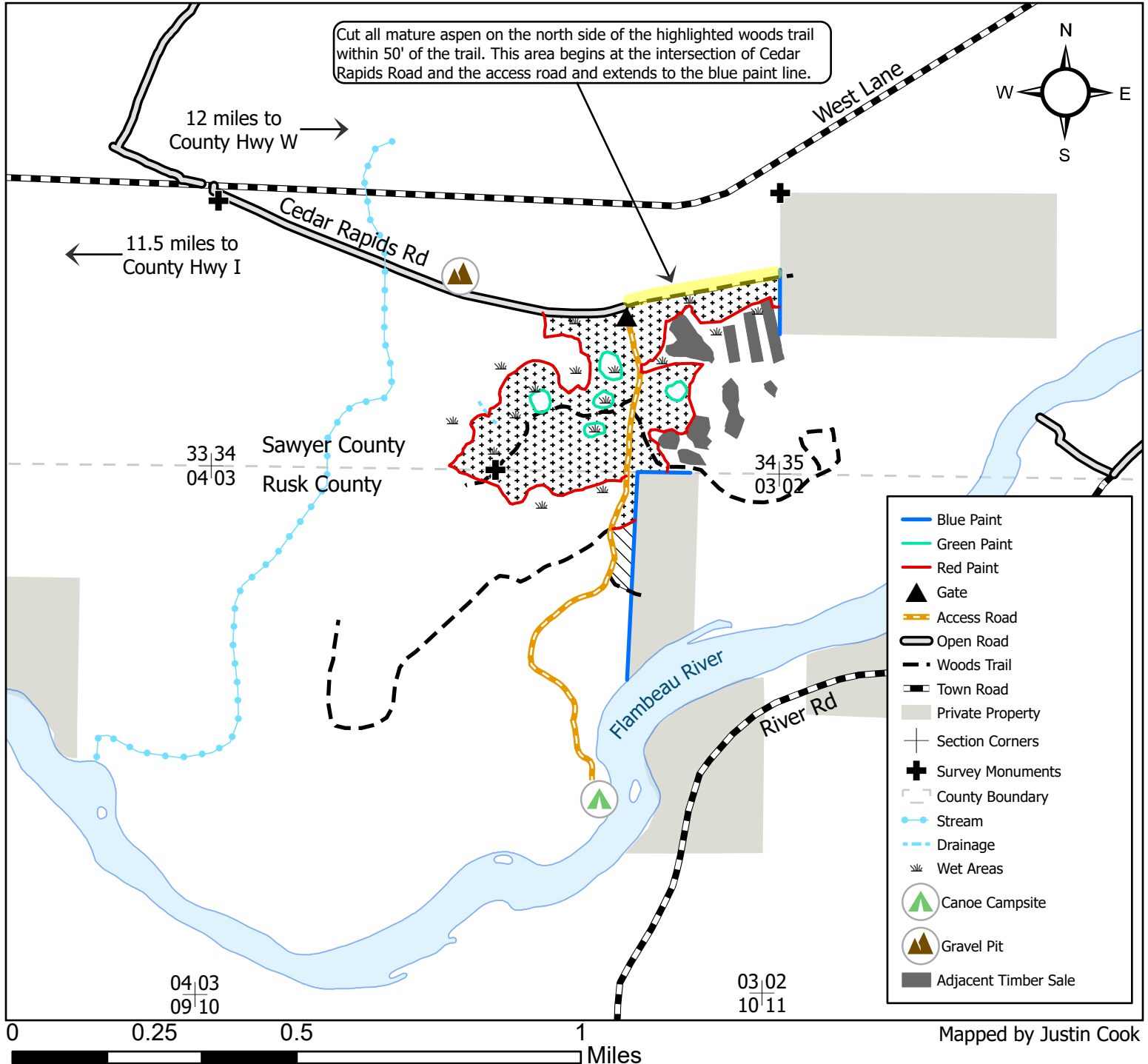

This map is for informational purposes only and may not have been prepared for or be suitable for legal, engineering or surveying purposes. The user is solely responsible for verifying the accuracy of information before using for any purpose. By using this product for any purpose user agrees to be bound by all disclaimers found here: <https://dnr.wisconsin.gov/legal>.