



CHIPPEWA FLOWAGE TIMBER SALE MAP
Wisconsin Department of Natural Resources
Sawyer County, WI

Forester Contact: Brody Fischer (715) 210-0150

Timber Sale: Moss Chief

Legal Description:
T40N - R7W - Sec1
T40N - R7W - Sec 2

Tract Number: H01-25

Sale Number: TBD

Species

Aspen

Mxd Hwd

Tons

1950

480

MBF

Cut Acres: 42

Harvest Requirements

Clear Cut -

Cut all stems 2" in diameter and larger except for Oak, Pine and Birch

Reserve Areas -

No harvest operations.

General Sale Conditions

- Access via Pines rd and woods road adjacent to HWY B
- Seasonal restrictions: No harvest activities April 15th – July 15th
- No machine operations allowed within 15' of any interior or exterior wetland
- Utilization: 4" top
- Leave uncut all standing dead snag trees that will not impact woods roads
- All slash must be pulled back 6' from woods roads and out of wetlands and lopped and scattered
- Decking may only occur within clear cut sale boundaries or on other state lands with the approval of DNR Forester
- Use of any private lands woods roads will require permission of the landowner

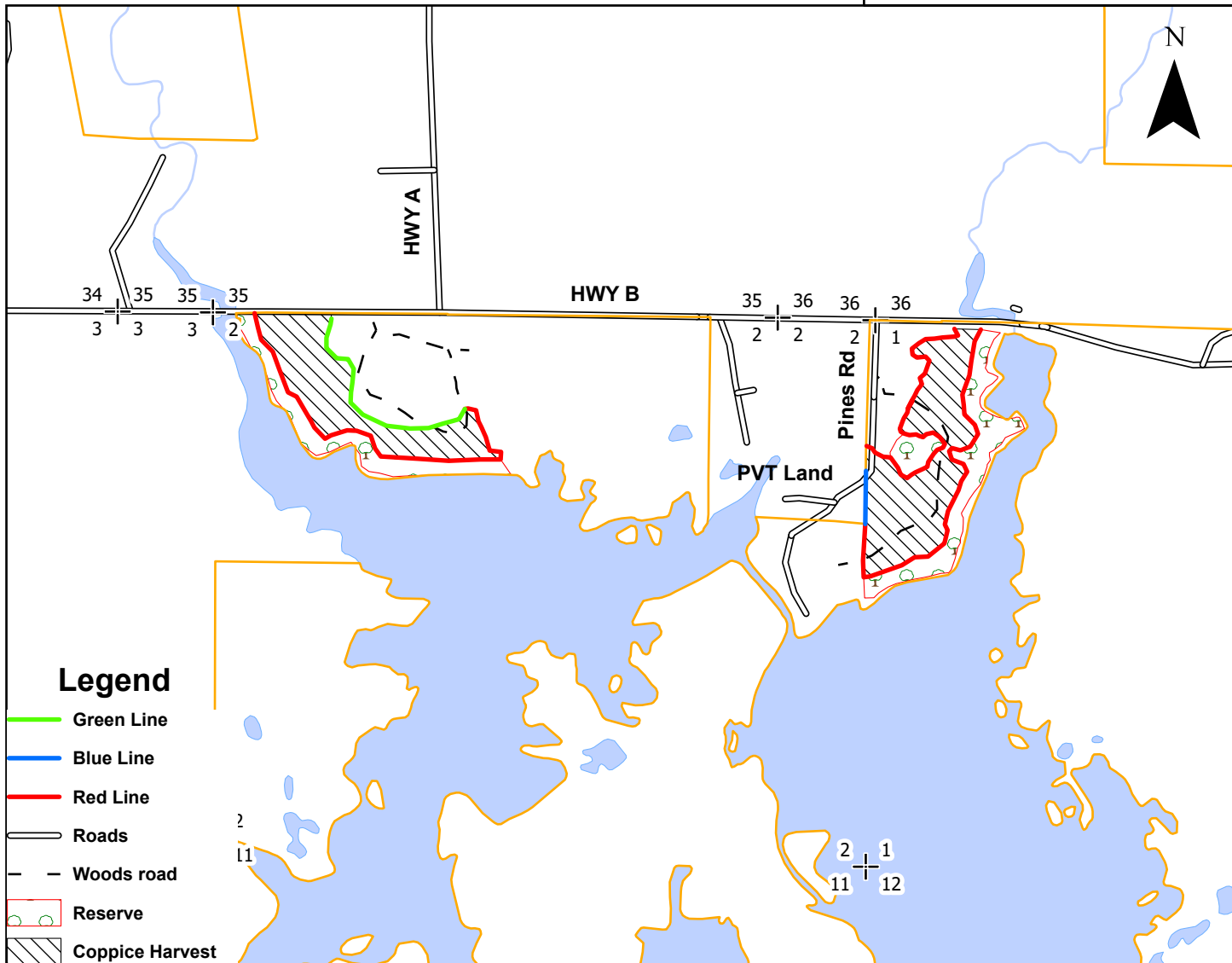

1 inch = 0.25 miles

This map is for informational purposes only and may not have been prepared for or be suitable for legal, engineering or surveying purposes. The user is solely responsible for verifying the accuracy of information before using for any purpose. By using this product for any purpose user agrees to be bound by all disclaimers found here: <https://dnr.wisconsin.gov/legal>.

Sale Prepared by Brody Fischer