

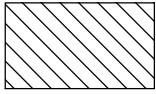

8-25 (Narrow Arrow) – Flambeau River State Forest

Parts of: NE SE Section 22, SW, SW NW Section 23 - T38N R3W Town of Winter, Sawyer County



Selection Area (33 acres) – Bounded by red paint, blue paint, County Road M, Old Lodge Lane, and utility ROW. Harvest all orange marked trees. Sever all orange marked unmerchantable stems. Cut all ironwood. Leave all snags.

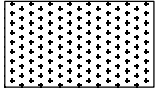

Aspen Coppice (28 acres) – Bounded by yellow paint. Harvest all trees greater than 1" except for: 1) conifers, 2) oak, 3) cherry, 4) green marked trees, and 5) snags.

Total acres: 61

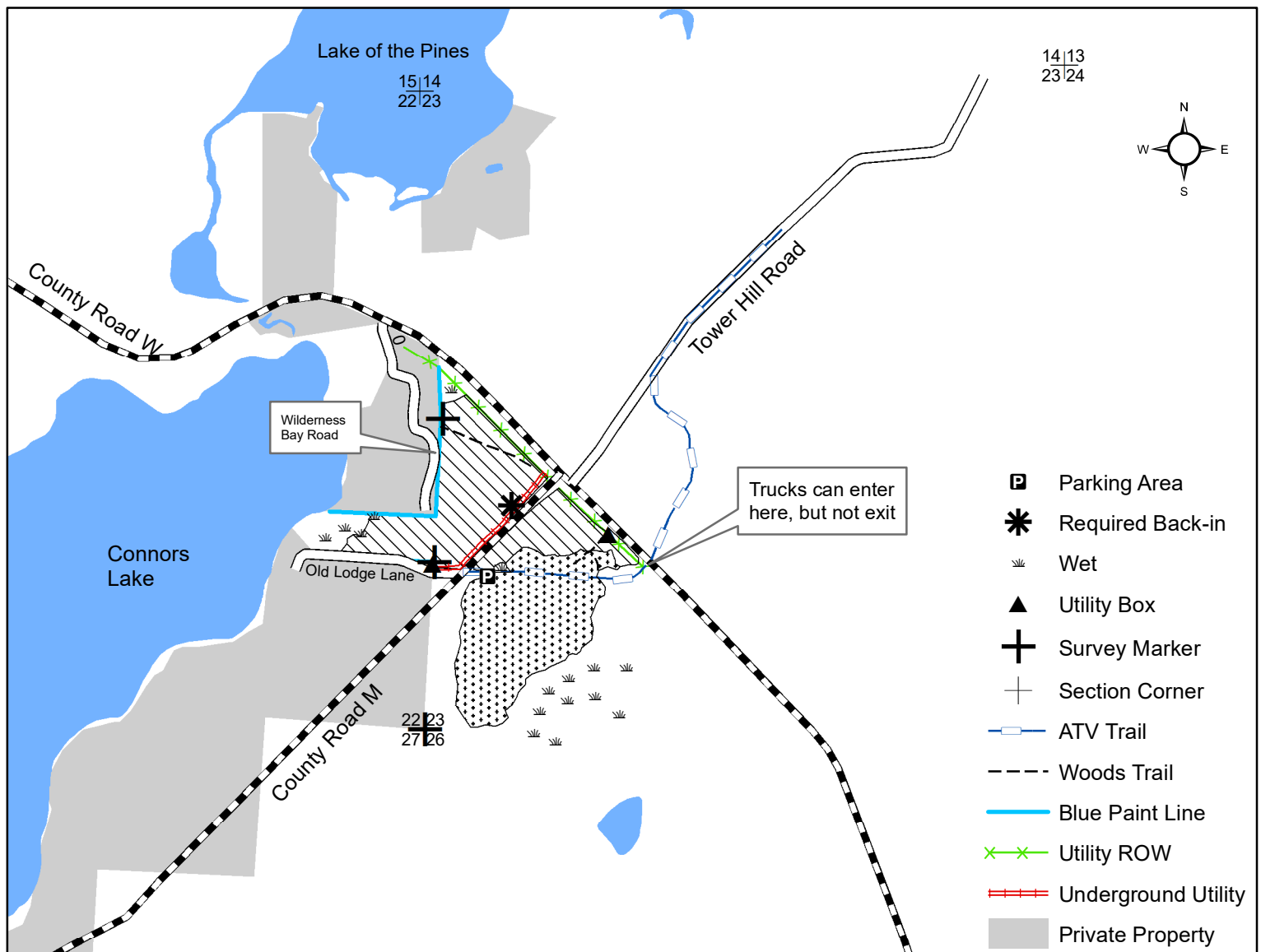

1:15,840

0 0.25 0.5 1 Miles

Mapped by Heidi Brunkow

This map is for informational purposes only and may have not been prepared for or be suitable for legal, engineering or surveying purposes. The user is solely responsible for verifying the accuracy of information before using for any purpose. By using this product for any purpose user agrees to be bound by all disclaimers found here: <https://dnr.wisconsin.gov/legal>.