

# Tract 13-24 (Electric Alley) - Flambeau River State Forest

Parts of: NE, SENW, N1/2SE, E1/2SW of Section 25; SE, SENE of Section 24, T37N-R3W,  
Town of Winter, Sawyer County

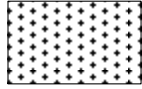

**Aspen/Red Maple Area (237 acres)** - Bounded by yellow or blue paint, snowmobile trail, power line, and young aspen. Harvest all trees greater than 2". Leave all 1) hemlock, 2) cedar, 3) white pine, 4) oak, 5) spruce, 6) green painted trees.

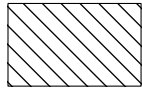

**Selection Area (13 acres)** - Bounded by red paint. Harvest all orange marked trees. Sever all orange marked unmerchantable stems. Leave all snags.

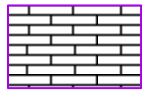

**Purple Area (2 acres)** - Bounded by purple paint. Harvest all trees greater than 2". Leave all 1) hemlock, 2) white pine, 3) trees marked with purple paint.

**Total acres: 252**

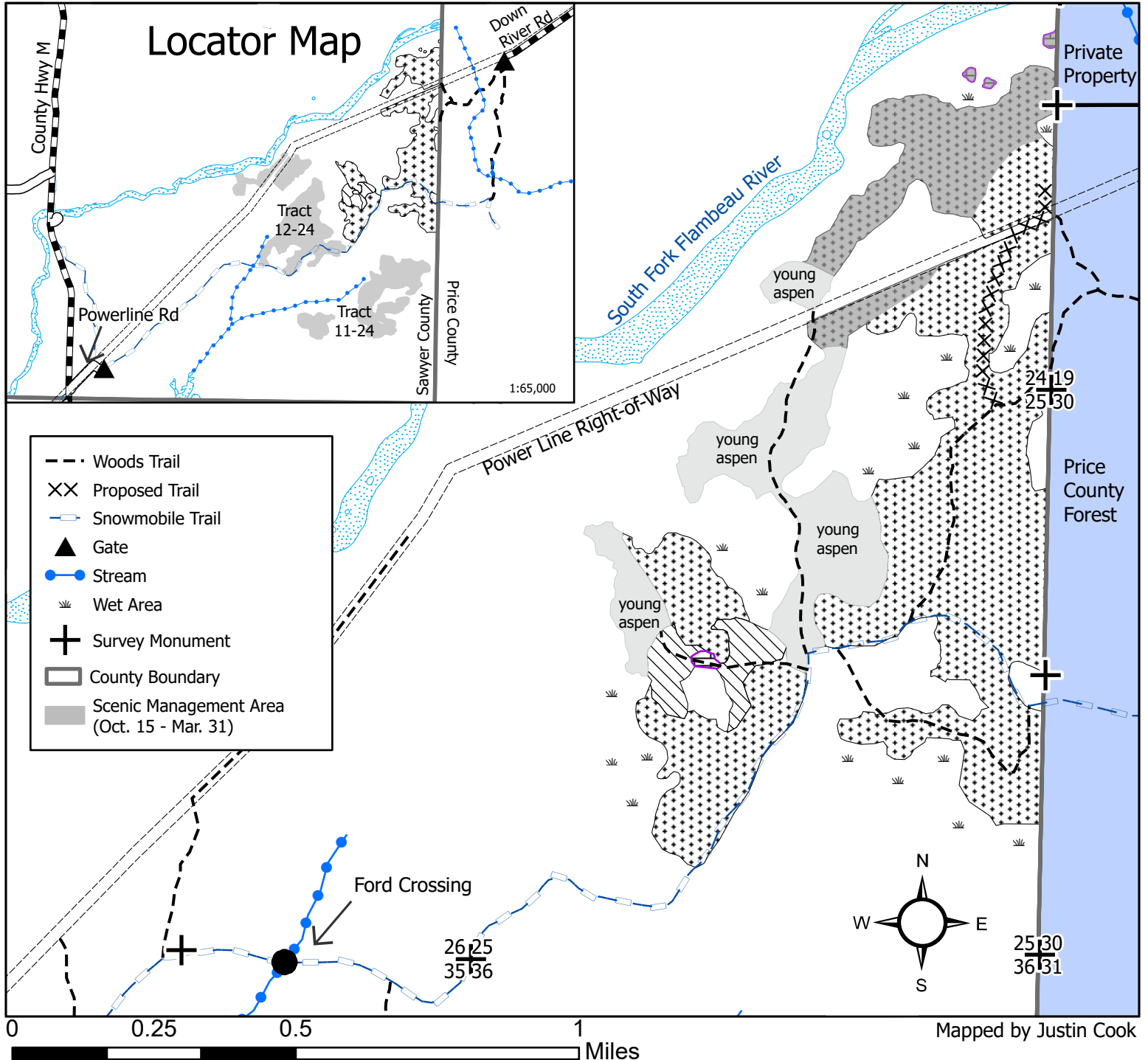

Scale: 1:15,840

This map is for informational purposes only and may not have been prepared for or be suitable for legal, engineering or surveying purposes. The user is solely responsible for verifying the accuracy of information before using for any purpose. By using this product for any purpose user agrees to be bound by all disclaimers found here: <https://dnr.wisconsin.gov/legal>.