

# Tract 12-24 (Riverside) - Flambeau River State Forest

Parts of: SWNW, W½ SW, Section 25, S½ NE, E½ SE Section 26  
T37N R3W, Town of Winter, Sawyer County.

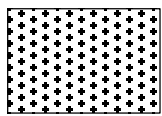

1:15,840



**Aspen/Red Maple Area (125 acres)** – Bounded by yellow paint and snowmobile trail. Harvest all trees greater than 2" except: 1) oak, 2) hemlock, 3) cedar, 4) white pine, and 5) trees marked with a green X. Leave all snags.

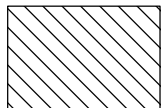

**Select Cut Area (20 acres)** – Bounded by red paint and snowmobile trail. Harvest all orange marked trees within the designated boundaries. Sever all orange marked unmerchantable stems. Leave all snags and trees marked with an orange X.

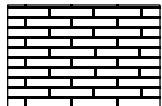

**Purple Area (3 acres)** – Bounded by purple paint. Cut all trees greater than 1" except: 1) hemlock, 2) white pine, 3) cedar, and 4) trees marked with a purple X.

Total: 148 acres

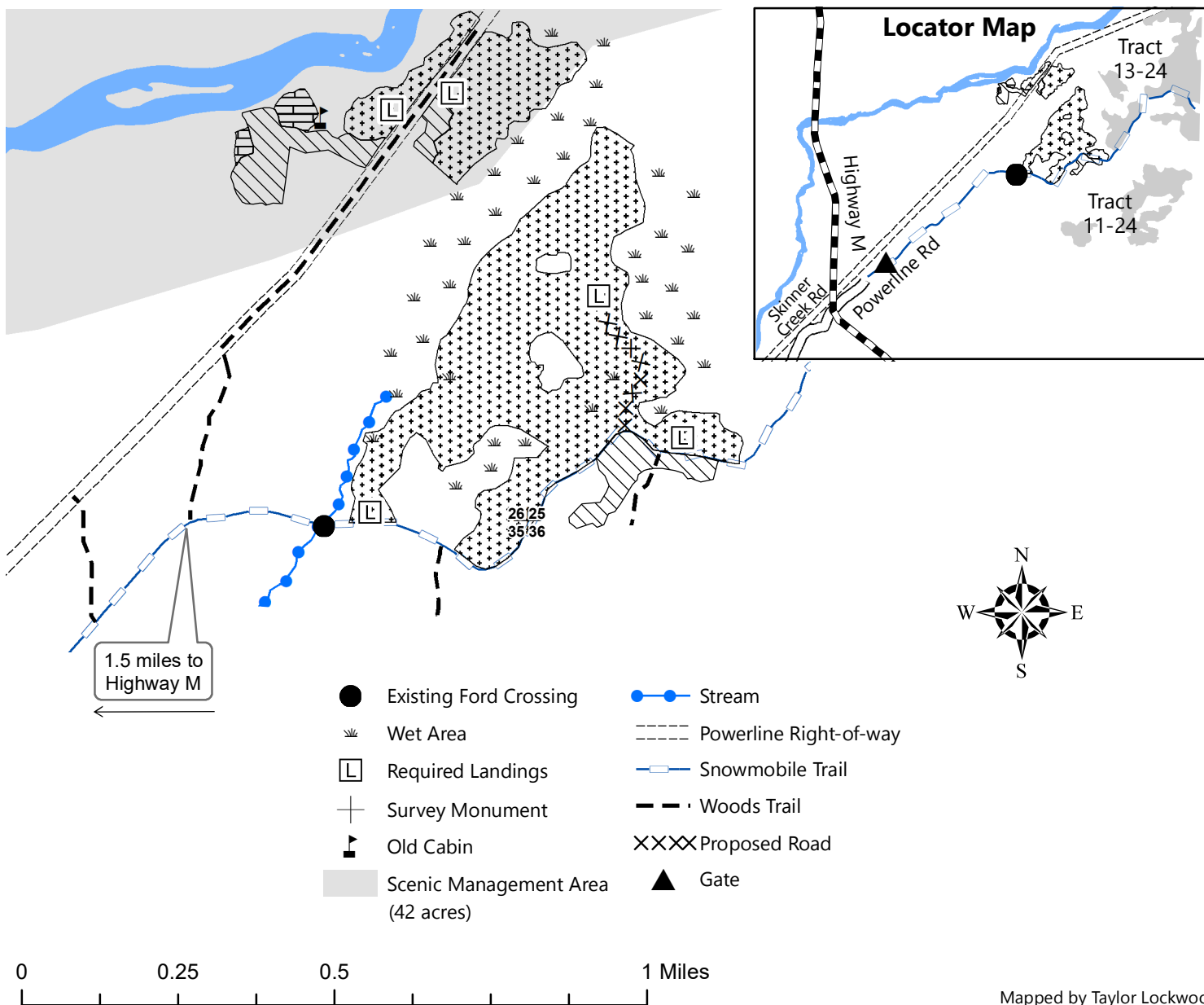

Mapped by Taylor Lockwood