

Tract 4-22 (Moonwalk Sale) - Flambeau River State Forest

Parts of: SW, SWNW, SENW, SWNE, Section 4, T39N-R3W, Sawyer County.

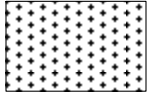

Coppice area (70 acres) - Bounded by red paint and Tuscobia State Trail. Harvest all trees greater than 1" except for 1) hemlock, 2) pine, 3) cedar, 4) oak, 5) elm, 6) cherry, 7) yellow birch.

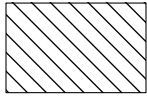

Selection area: (7 acres) - Bounded by red paint. Harvest all orange marked trees.

Total Acres: 77

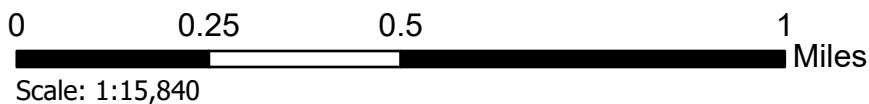
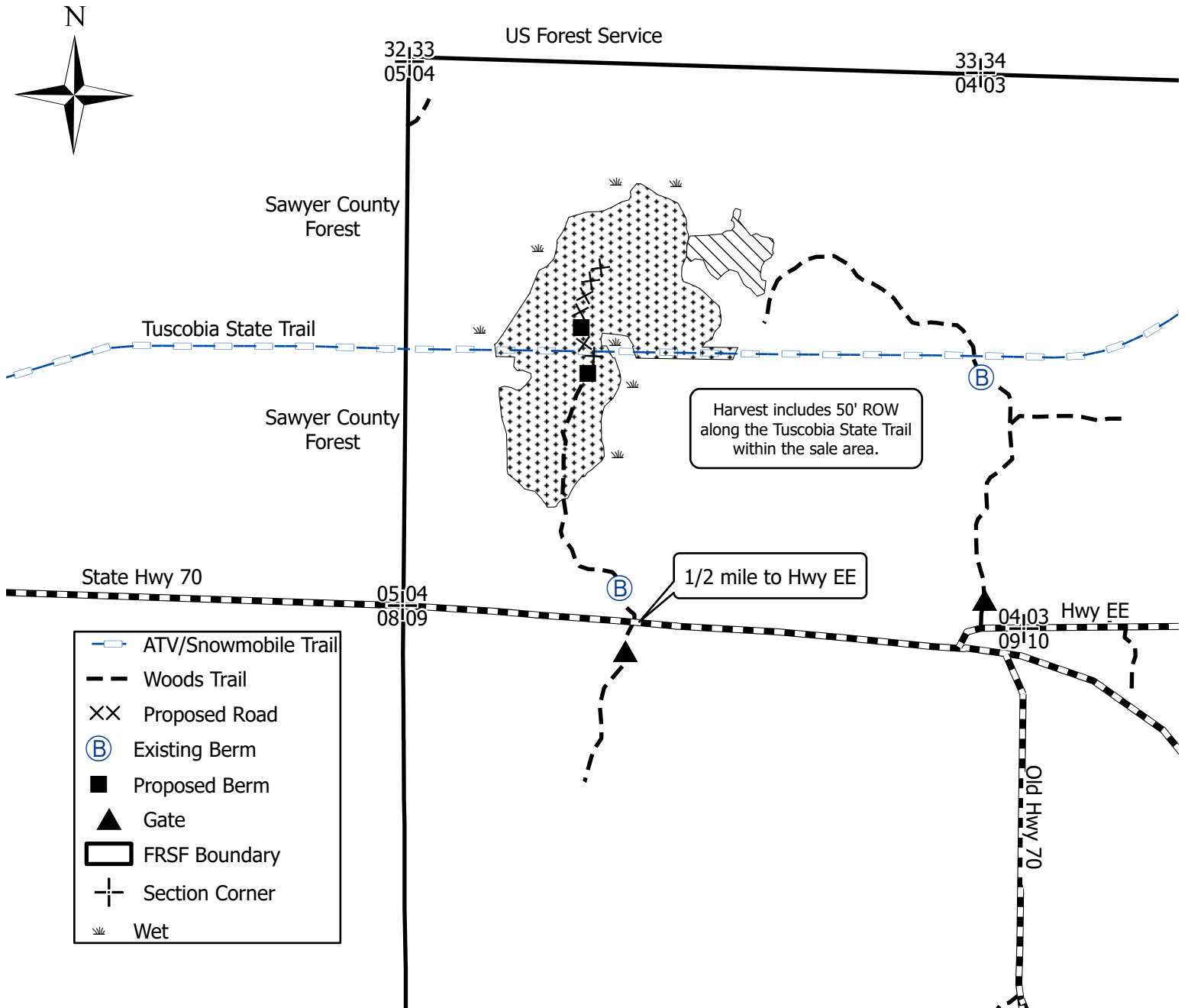

Mapped by Mike Bulgrin/Justin Cook
"This map is not a survey of the actual boundary of any property this map depicts"