

**Selection Area (66 acres)** – Bounded by red paint and young aspen. Harvest all orange marked trees within the designated boundaries. Do not cut snags or cull trees.

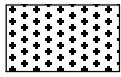

**Aspen Coppice Area (94 acres)** – Bounded by yellow paint and young aspen. Harvest all trees greater than 1" except 1) hemlock, 2) white pine, 3) oak, 4) cherry and 5) spruce. LEAVE all trees within 30 feet of all hemlock.

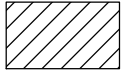

**Red Maple/ Ash Coppice Area (28 acres)** – Bounded by yellow paint and tamarack area. Harvest all trees greater than 1" except 1) hemlock, 2) white pine, 3) oak, 4) cherry and 5) spruce. LEAVE all trees within 30 feet of all hemlock.

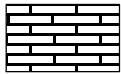

**Tamarack Clear Cut (26 acres)** – Bounded by yellow paint, red maple/ash area, and aspen. Harvest all trees greater than 1" except 1) hemlock, 2) white pine, 3) oak, 4) cherry and 5) spruce. LEAVE all trees within 30 feet of all hemlock.

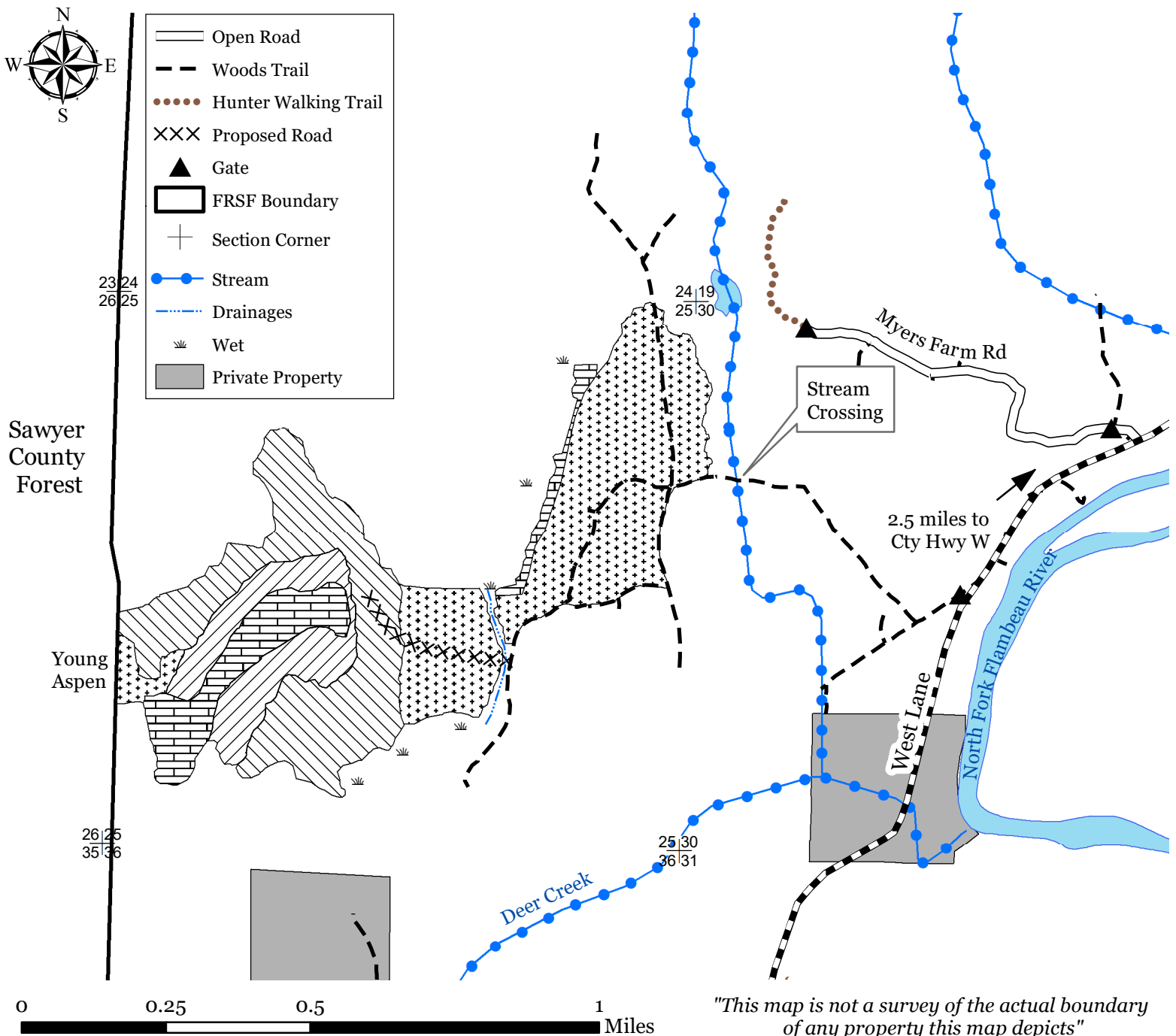

"This map is not a survey of the actual boundary of any property this map depicts"