

Tract 1-21 (End Of The Line Sale)

1:15,840

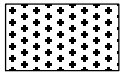

**Coppice Area (89 acres)** – Bounded by yellow and blue paint. Harvest all trees greater than 1” **except for:** 1) hemlock, 2) white pine, 3) oak, 4) cedar, 5) spruce and 6) cherry. Leave **all trees** within 30’ of all hemlock and cedar.

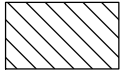

**Selection Area (44 acres)** – Bounded by red and blue paint. Harvest all orange marked trees within the designated boundaries. Do not cut snags or cull trees.



**Shelterwood Area (11 acres)** – Bounded by green paint. Harvest all trees greater than 1” **except for:** 1) all purple marked trees, 2) hemlock, 3) white pine, 4) oak and 5) cedar.

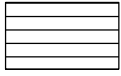

**Tamarack Seed Tree Area (26 acres)** – Bounded by green paint. Harvest all trees greater than 1” **except for:** 1) all green X marked trees, 2) hemlock, 3) white pine and 4) cedar.

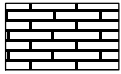

**Tamarack Clear Cut (16 acres)** – Bounded by yellow paint. Harvest all trees greater than 1” **except for:** 1) hemlock, 2) white pine and 3) cedar.

	Open Road
	Woods Trail
	Proposed Road
	Section Corner
	Survey Monuments
	Fence Posts
	Steep
	Proposed Berm
	Gate
	Canoe Campsite
	Stream
	Drainage
	Wet
	Private Property
	Scenic Area - Leaf Off Only (Oct 15 - Apr 1)

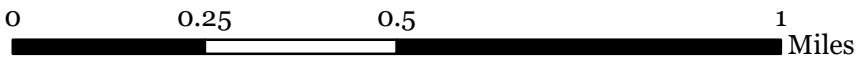
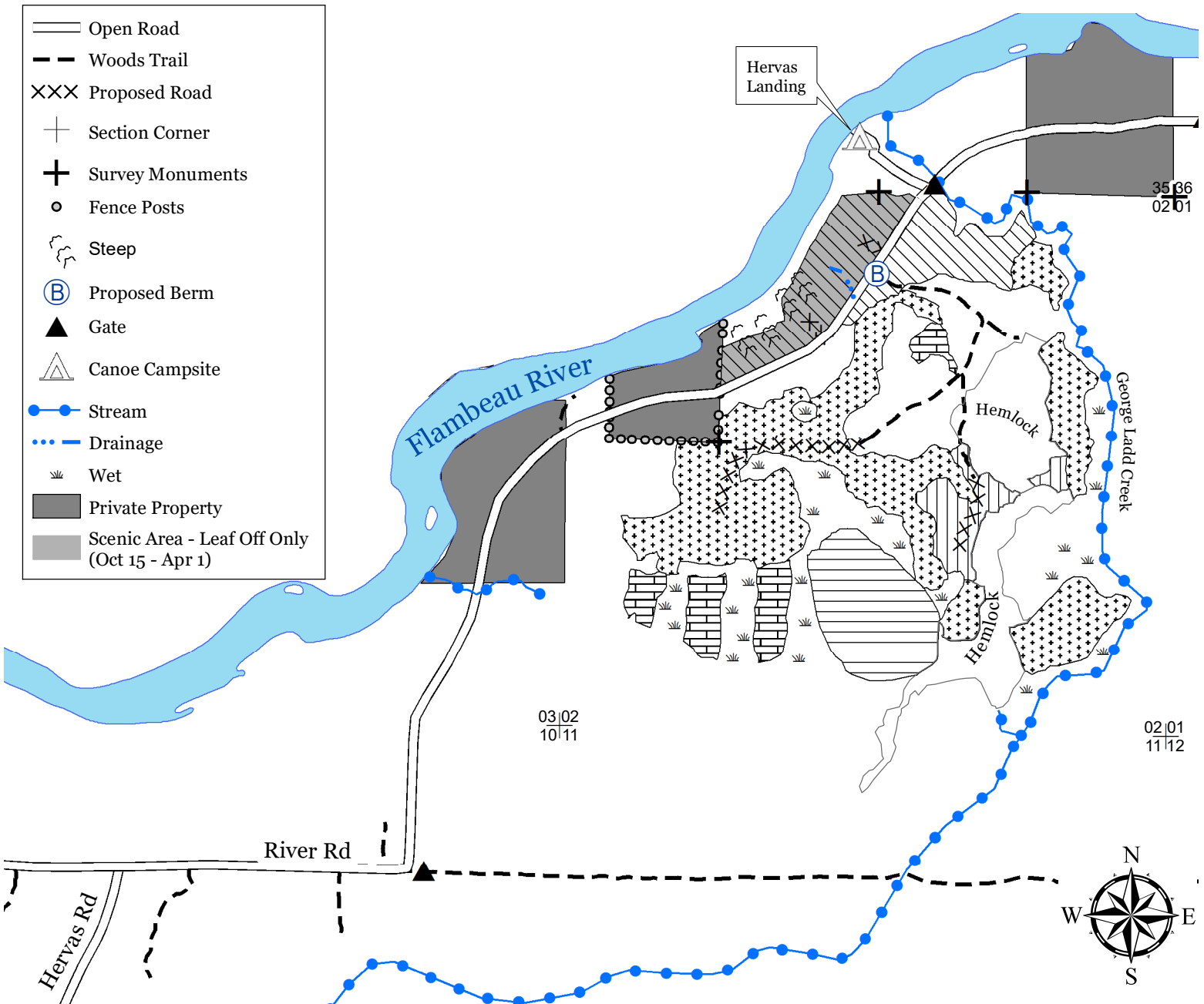

"This map is not a survey of the actual boundary of any property this map depicts"