

Tract 3-22 PKF (Una Macrocarpa Sale)

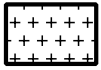

Aspen Coppice Area (40 acres) -- Area bounded by red paint, blue paint, and aspen saplings.
Harvest all trees 2" dbh and larger except for: 1) cedar, 2) hemlock, 3) white pine, 4) oak, 5) yellow birch, and 6) green marked trees.

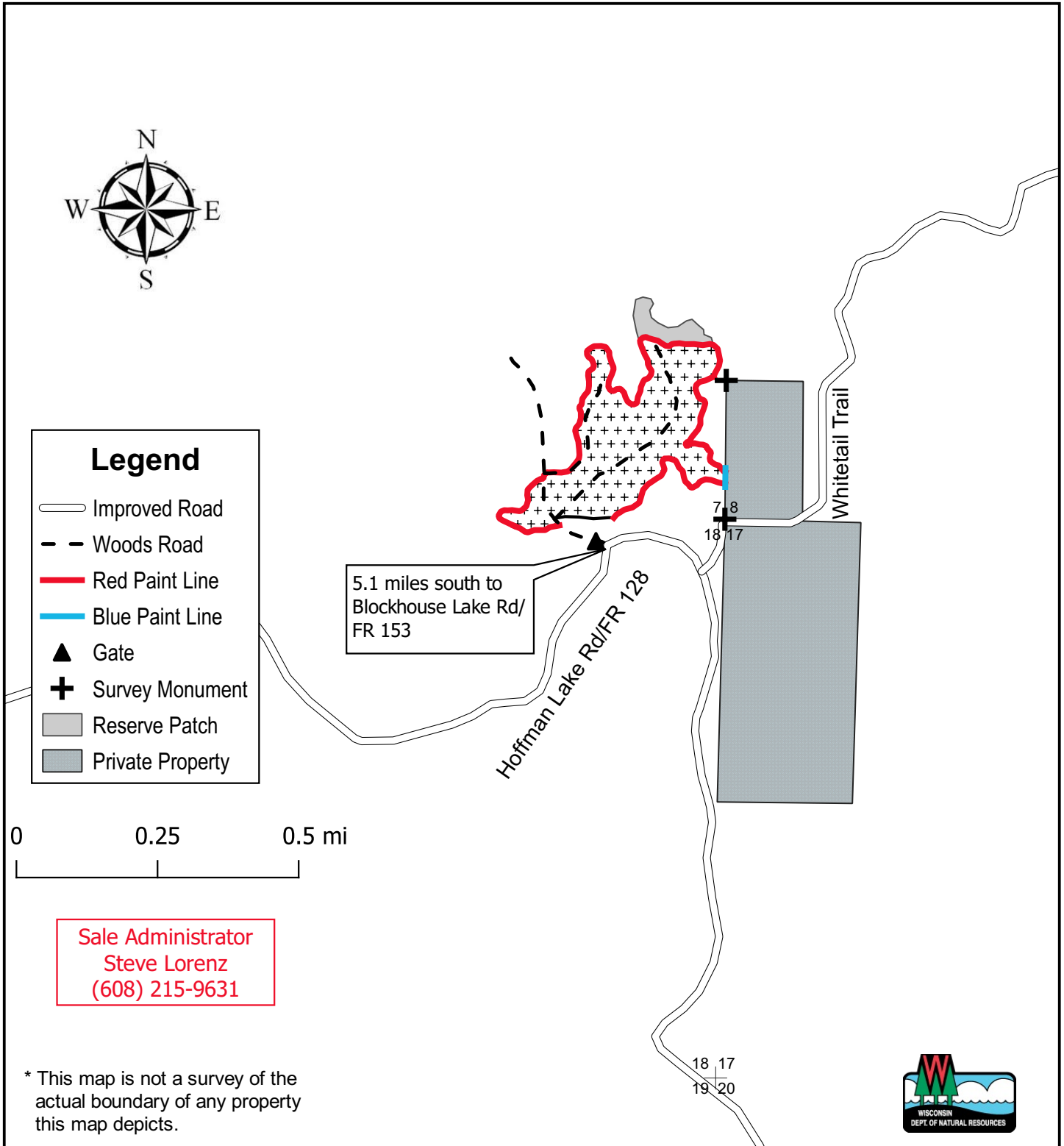

Sale Administrator
Steve Lorenz
(608) 215-9631

* This map is not a survey of the actual boundary of any property this map depicts.

