

Flambeau River State Forest and other State Lands Sustainable Forestry Timber Sales

Includes sales from
Flambeau River State Forest – 4 sales
Hay Creek–Hoffman Lake Wildlife Area – 1 sale

May 28, 2020



Flambeau River State Forest Sale Locator Map

Legend

- Spring 2020 Timber Sales

Note: Sale Locator map does not include other state land sales

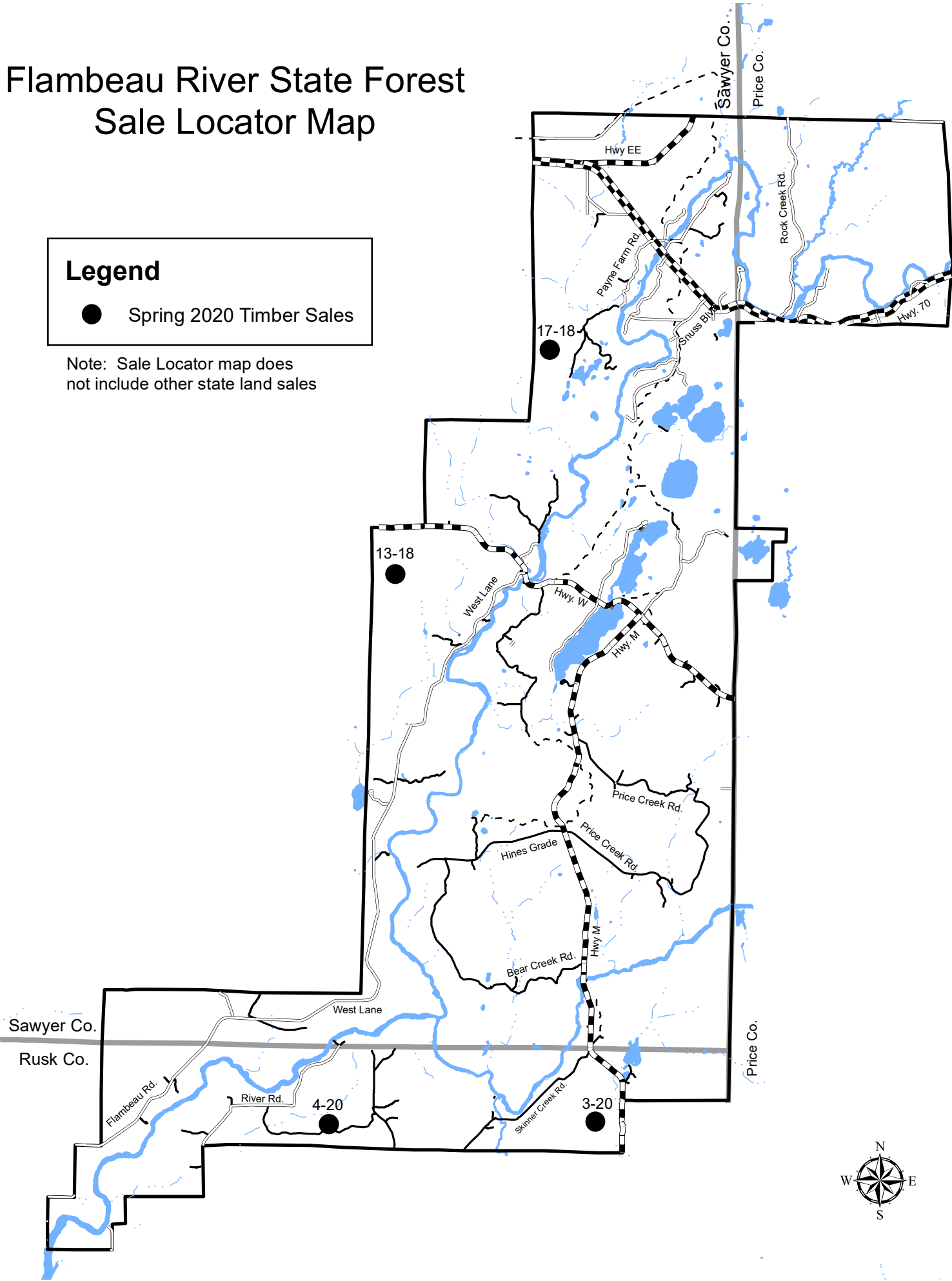

2020 MAY TIMBER SALES
FLAMBEAU RIVER STATE FOREST & OTHER STATE LANDS
W1613 COUNTY ROAD W
WINTER, WI 54896
(715) 332-5271

Sealed bids for sales in this packet will be received by the Wisconsin Department of Natural Resources, Flambeau River State Forest (FRSF), at the Flambeau Forest Headquarters, Winter, Wisconsin until **1:30 p.m. on May 28th, 2020** and opened immediately thereafter for timber stumpage on the Flambeau River State Forest and other state lands. Sealed bids for the other state lands should also be received at the Flambeau Forest Headquarters. Sealed bids for sales not sold on May 28th will be received at the Flambeau Forest Headquarters until **1:30 p.m. on June 29th, 2020.**

Please note: Due to the current situation with the COVID-19 pandemic, access to the FRSF headquarters is limited, bids will be accepted by mail or appointment only. In order to protect the health and safety of our employees and the public, the bid opening will be closed to the public. The bid opening will be conducted by a telecommunication system. For the call-in number and instructions on how to listen/participate, please call 715-332-5271 ext. 106 by 4:00 p.m. May 27th.

“These lands are 3rd party certified.”

It is the responsibility of the bidder to inspect, evaluate the stumpage, examine the locations, investigate field conditions, and check Contract requirements for each tract prior to bidding. Submission of bid reflects that the bidder has inspected the tract and clearly understands and agrees to all Contract conditions and requirements. For inspection of Flambeau River State Forest timber sales for bidding, ATVs will be permitted. For sale inspection, call 715-332-5271 ext. 106 for the combination lock on gates. Please do not go around gates.

Please review **Attachment A** for berming requirements and **Attachment B** for protection of road signs.

The sales on the Flambeau River State Forest will use the mill scale ticket system for pulpwood. Sales with saw logs included in the pulp price will also use the mill scale ticket system.

The contractor shall notify a DNR Forester or Forest Technician 3 days prior to beginning work on sale. Before work begins on sale, contractors will be required to have a pre-sale meeting with either a Forest Technician or a Forester.

NO DECKING OR SKIDDING ALLOWED ON Price Creek Road, Bear Creek Road, Hines Grade, Tower Hill Road, Skinner Creek Road, Hervas Road, Cedar Rapids Access Road, Wannigan Rapids Access Road, or Oxbo Access Roads without special permission.

The State may not plow snow on state forest roads. If a sale is located on a state forest road, the contractor may be responsible for plowing the snow. The following are state forest roads: Tower Hill, Bass Lake, Price Creek, Hines Grade, Bear Creek, Skinner Creek, and Hervas.

TRAINING REQUIREMENT

The purchaser shall ensure that the actual logging contractor engaged in performance of this contract complies with the Wisconsin SFI (Sustainable Forestry Initiative) Training Standard as adopted by the

Wisconsin SFI Implementation Committee (SCI). Criteria for the standard can be found at the website www.fistausa.org/sfi_standards or by contacting the Forest Industry Safety & Training Alliance (FISTA). Purchaser agrees to provide documentation to Seller that the training has been attained prior to initiating sale.

SOIL DISTURBANCE AND RUTTING

- a. The Purchaser agrees to take all steps and precautions to avoid and minimize soil disturbances, such as soil compaction and rutting. If soil disturbances occur, the Purchaser agrees to work cooperatively to mitigate and repair any and all instances of soil disturbance.
- b. Excessive soil disturbance (as defined in Table 1) shall not be permitted. Purchaser agrees to contact Seller in the event of an excessive soil disturbance.

Table 1. Thresholds for soil disturbances.

<u>Timber Sale Infrastructure</u>	<u>Soil disturbances are excessive if:</u>
<i>Roads, Landings, Skid Trails, and General Harvest Area</i>	<ul style="list-style-type: none"> ▪ A gully or rut is 6 inches deep or more and is resulting in channelized flow to a wetland, stream, or lake.
<i>Roads, Landings, and Primary Skid Trails</i>	<ul style="list-style-type: none"> ▪ In a riparian management zone (RMZ) or wetland, a gully or rut is 6 inches deep or more and 100 feet long or more. ▪ In an upland area (outside of RMZ), a gully or rut is 10 inches deep or more and 66 feet long or more.
<i>Secondary Skid Trails and General Harvest Area</i>	<ul style="list-style-type: none"> ▪ A gully or rut is 6 inches deep or more and 100 feet long or more.

Note: The depth is to be measured from the original soil surface to the bottom of the depression. If individual lug depressions are visible, the depth would be measured to the lesser of the two depths (the "top" of the lug). The length is measured from the start of the "too deep" section to the end of the "too deep" section. Measurements are not cumulative.

- c. Prior to sale completion the Purchaser shall mitigate and repair soil disturbances to the Seller's satisfaction.

For questions on the following properties please contact the person listed:

Flambeau River State Forest – Heidi Brunkow (715) 332-5271 ext. 106
Hay Creek – Hoffman Lake Wildlife Area – Kristina Wells (608) 403-2257

FLAMBEAU RIVER STATE FOREST

General Sale Conditions

Bidding and Financing

1. To bid on a tract, each species must be bid on (per cord or MBF) and the **minimum total sale value must be met.** The advertised value (per cord or MBF) is provided as a reference value only - a bid on each species at its advertised value will automatically meet the minimum total sale value when all species are added together. **A bid will be rejected if any individual species/product bid is \$0.**
2. A bid must be made on all species and products listed by tract including lump sum sales.
3. All bids must be by tract number and **sealed in individual envelopes** marked on the outside, Bid on Tract ____.
4. Whole tree (chipping) bids will be adjusted by adding overrun factors to cruised volumes. Notification prior to bidding will be required. Approved areas allowing whole tree logging will be identified along with specific overrun factors to be used. If for any reason the contract is not whole tree harvested, the contractor will pay 25% more than the bid value per species that anticipated whole tree harvest. Whole tree harvest (chipping) includes all wood and bark.
5. All bids will include the following:
 - A. Tract Number
 - B. List of species to be harvested and estimated volume
 - C. Bid price, per unit for each species and product
 - D. Signature and address of each bidder
6. Persons desiring to bid on more than one tract must submit a separate bid for each tract.
7. Bids will be opened in a random order from a draw of the hat. **Prior to the reading of a bid, a contractor may elect to withdraw the bid.** The contractor or representative of the contractor must declare this at the bid opening before any bids for the specified tract are read.
8. **BID BOND NOT REQUIRED.** Winning bidders will have 6 weeks from the date of the bid opening to submit an acceptable performance bond to the department. If the winning bidder fails to execute the contract and submit an acceptable performance bond, the bidder shall be required to forfeit to the department an amount equal to 10% of the total bid amount. Failure to forfeit the 10% penalty will result in the bidder being considered ineligible to bid on any state timber sales for a two-year period.
9. An Irrevocable Letter of Credit may be used as a Performance Bond. ***The expiration date of all letters of credit must be maintained for four full years.*** Contact the Forest Headquarters for details regarding the clauses required in the letter.

Contracts & Extensions

1. Contracts must be signed and returned to the Flambeau River State Forest or appropriate property within 30 days of the bid letting. Contracts may contain additional provisions. Contracts may not be assigned.
2. All contract lengths will be noted on timber sale document. It is understood that all contracts are expected to be completed during the initial contract. Extensions are not automatic.
3. Requests for extensions must be submitted prior to the expiration date of the contract. The performance bond may be retained if requests are not submitted by the expiration date.

Payments

1. Purchaser agrees to make stumpage payments within 30 days of billing, unless otherwise specified in the payment schedule.
2. Late interest penalty – Purchaser agrees to pay a late interest penalty of 1.5% for every 30 days on past due stumpage in excess of the 30 day period. In addition, failure to pay within the 30 day period will result in the Purchaser having to prepay for the remainder of the sale. Two such payment breaches, even on separate State sales, will also result in the purchaser being required to prepay on all state timber sales for a two-year duration.

Cutting and Skidding Specifications

1. All timber marked or designated for cutting will be utilized whether or not the quantity is more or less than the

- estimated volume.
2. No pole length skidding will be allowed in select cut areas, pine thinnings, or spruce thinnings.
 3. **No cutting can be done during the months of April, May, and June in selection harvests or pine thinnings** due to bark being more easily damaged at these times, unless special permission is granted.
 4. All decking must be done on the sale if it is not specifically designated.
 5. Any young growth bent or held down by felled trees must be promptly released.
 6. The Department of Natural Resources reserves the right to stop operations if unreasonable, excessive, or avoidable damage occurs or will occur. The contractor may be held responsible to repair any or all damage.
 7. Although logging during very dry conditions may be permitted, during wet periods the soils may become soft and susceptible to rutting. Soils may become too wet after storms and extended wet spells. Operations will be suspended during these periods.
 8. The Department of Natural Resources may change, suspend or terminate any timber sale contract or portion of contract with no penalties to the State if errors in timber sale planning or designing cause or may cause serious environmental damage, or may cause aesthetic concerns, or are not sound silvicultural practices, or violate any county, state, or federal law or regulation.
 9. Any bole damage to residual trees will be considered unnecessary.
 10. Trees that are marked with an "X" are not to be cut. They are leave trees. All snags will be reserved unless a safety concern, then the snags will be cut and left for coarse woody debris.
 11. **Extra caution is needed to avoid damaging existing pockets of regeneration throughout select cut sale areas.** These pockets of regeneration should not have trees felled into them or skid trails run through them.
 12. If collecting firewood for home, a firewood permit is required. **A permit is also required for collection of burls.**

Slash Requirements

1. All slash requirements will be done concurrent with sale operations. For town roads, state forest roads, hunter/walker trails, and ATV/snowmobile trails, **all slash and ends will be removed from the roads and ditches concurrently with each truckload.**
2. Slash that is within 100 feet of state highways, county highways, forest roads, open access roads, ATV/Snowmobile trails, canoe campsites and landings will be lopped and scattered to within 2 feet of the ground by the contractor.
3. No slash or logging debris will be left across the blue line onto private land.
4. No slash piles from landing operations may be left over 24" above the ground level. Piles shall be spread over the site before leaving.
5. Slash disposal will comply with the State Slash Law, Section 26.12(b), Wisconsin Statutes, and with requests regarding forest fires prevention and suppression made by the seller.

Road and Camps

1. The locations of all roads, landings, and camps must be approved by the Forester prior to construction. A DNR Forester must be contacted at least 48 hours in advance for an appointment.
2. The sale area, including all roads and camps, will be kept neat, clean and free of garbage, oil cans, plastic bottles, and miscellaneous trash throughout the contract period. All residues, including oils and fluids, generated may not be buried or burned, but must be removed from the sale area and disposed of properly.
3. Those merchantable trees removed or damaged as a result of approved road building operations will be utilized.
4. All road entrances must be cleaned up of all roots, stumps, and down trees at the time of construction.
5. **It will be the responsibility of the contractor to repair any road damage due to logging.**
6. **Contractor is required to close roads at designated map locations by placing rocks, stumps and/or cull log barriers. (See Attachment A).** Any road, landing, or primary skid trail used for a timber sale will need to be closed according to Attachment A.
7. **Do not damage or remove trail/roadway signage. (See Attachment B).**
8. Road approaches to surfaced roads or other government public roads are the responsibility of the Contractor. Damage to these roads is the responsibility of the Contractor.
9. **The State may not plow snow on state forest roads.** If a sale is located on a state forest road, the contractor may be responsible for plowing the snow. The following are state forest roads: Tower Hill, Bass Lake, Price Creek, Hines Grade, Bear Creek, Skinner Creek, and Hervas.

Seasonal Restrictions

1. **No cutting can be done during the months of April, May, and June in selection harvests or pine thinnings** due to bark being more easily damaged at these times, unless special permission is granted.
2. Any wood located within 400' of the Flambeau River shall be removed prior to April 1st of each contract year.
3. The State reserves the right to place additional seasonal restrictions on sales as necessary.

Hauling Restrictions

1. It is the responsibility of the Contractor, to obtain permission from the appropriate Township to deck wood along a town road.
2. All road bans and weight restrictions are the responsibility of the Contractor. State forest roads may be posted for longer periods of time than county and township roads.
3. The purchaser will be required to restrict or suspend hauling during periods when the compacted road surface would be damaged. Hauling will be suspended if it is causing rutting into the subgrade, or surfacing material would be displaced, such as during heavy rainfall or spring break-up freezing and thawing cycles.

General Conditions

1. All provisions in the contract shall be met before the contract expires. Performance under the contract must proceed in an efficient, workman-like manner, conducive to the orderly completion of the sale. Extensions will only be considered under unusual hardship of circumstances. Details of extension conditions, damage assessments, and other provisions are addressed in the contract which is on file at the Forest Headquarters.
2. Permanent survey monuments shall be left undisturbed. Forest personnel shall be notified if one is encountered during timber sale operations.
3. Extreme caution must be used in sale operations to prevent wildfire. There are requirements outlined in the contract for fire extinguishers and spark arrestors.
4. No skidding, landing, or piling of wood products will take place on the ATV/Snowmobile trail or the State Forest roads without special permission. The following are State Forest roads: Tower Hill, Bass Lake, Price Creek, Hines Grade, Bear Creek, Skinner Creek, and Hervas.
5. If a snowmobile trail is used for a timber sale operation, 3" of packed snow will be maintained on the snowmobile trail, weather permitting.

Utilization Specifications

Those sales without an increased utilization option will have the following standards:

Standard Utilization - Unless otherwise specified, standard specifications will be as follows:

Aspen pulpwood	4" top diameter
Hardwood pulpwood	4" top diameter
Softwood pulpwood	4" top diameter
Hardwood sawlogs	10" top diameter inside bark
Softwood sawlogs	8" top diameter, inside bark

Merchantable trees are those that have one or more 100 inch pulpwood sticks with a minimum top diameter of four inches.

Scaling Specification

1. All bid species of sawlogs will be scaled as such. Pulpwood products cut longer than 8' may be scaled by the board feet and converted to cords as follows: Softwood - 2.44 cds./MBF and Hardwood - 2.20 cds./MBF.
2. All logs will be scaled with the Scribner Decimal C log rule. All logs will be scaled as sawlogs if 50% sound and meet the requirements of a Grade No. 3 log or better in accordance with the National Forest Scaling Handbook. The minimum diameter for a Grade No. 3 log is 10". The maximum trim allowance is 5" unless contractor can demonstrate that market specifications dictate more trim (ties, veneer, etc.). Logs with excessive trim will be scaled at the next highest foot length.
3. Logs will be decked for scaling on pulpwood stringers with the small ends all one way (towards the road) and separated by log length. Decks will not exceed six feet in height and will be accessible for inspection from both sides of the deck. If separating for bolts, the bolts will be decked with the small ends all one way (towards the road).

4. When sap-peeled pulpwood is scaled, 12.5% will be added to hand peeled and stroke delimber/processor peeled volume, and 16% will be added to ring debarked volume. **Scale ticket must state if the load is a peeled product.**
5. The mill scale ticket system will be required for pulp. Contractor is required to deposit a scale ticket in the lock box placed on the sale. These tickets are provided by the State Forest and will be filled out in their entirety. The Contractor is also required to deliver a mill ticket to the mill purchasing the forest product. This mill ticket will be returned to the Flambeau River State Forest along with a copy of the mill's scale. The Contractor is responsible for having these mill tickets and scale slips returned to the Flambeau River State Forest in a timely manner. The mill scale slip that corresponds to the lock box ticket must be received at the Flambeau River State Forest Office within 14 days of hauling.
6. If wood is to be yarded at another location other than the sale area, permission must be granted by Forester.
7. Contractors that are required to prepay must at a minimum purchase 5 or more scale tickets at a time, but it is encouraged that a full booklet of 25 scale tickets be purchased.
8. A mill scale ticket must also be placed in the ticket box for loads of scaled logs.

Cordwood Weight Conversion Factors

If a cordwood weight conversion is not provided by the mill purchasing the forest product, the following weight conversion factors will be used in the conversion of weight scale to standard 4' x 4' x 100" cords. Seasoned wood is normally understood to be that which was cut and dried two or more months between April 1 and October 31 before weighing. All other wood should be considered green.

**CORDWOOD WEIGHT CONVERSION FACTORS
POUNDS PER CORD**

Species	Weight	Species	Weight
Hemlock	4800	Yellow Birch	5350
Tamarack	4650	Hard Maple	5100
Red Pine	4500	Elm	5000
Jack Pine	4250	Balsam Poplar	4900
Balsam	4250	White Birch	4800
White Pine	4200	Ash	4600
Spruce	4000	Soft Maple	4550
White Oak	5850	Aspen	4500
Red Oak	5500	Basswood	3850
Hickory	5400	Mixed Hardwood	4800

Worker's Compensation Law

The contractor (purchaser) shall provide the Department with a Certificate of Insurance indicating that Worker's Compensation Insurance coverage is provided for all of the contractor's (purchaser's) employees working under the contract during its duration. This shall be in the Department's file prior to any performance under the contract. Such certificates of insurance shall further include the condition that the insurer shall notify the Department at the Flambeau River State Forest Headquarters within five (5) days of any change in its terms or twenty (20) days prior to termination.

The Special Sale Conditions listed for each individual tract and the General Sale Conditions are additions to, or condensations, of a standard timber sale contract that the successful bidder must sign. A sample contract, additional information, maps for each sale, and bid forms may be obtained from the Forest Superintendent, Flambeau River State Forest, W1613, Co. Rd. W, Winter, Wisconsin 54896.

The Department of Natural Resources reserves the right to reject any or all bids.

Attachment A

Contractor Sale Closure Requirements

Gated Roads

For sales that occurred behind a locked gate, and harvesting occurred around the gate area, contractors are required to do one of the following:

1. Block the sides of the gates with rocks or stumps with root-balls.
 - a. Rocks must be between 3-4' in diameter
 - b. Stumps must be a minimum of 3' high.
 - c. No greater than 24" spacing between rocks or root-balls.
 - d. A 30" clearance should be left immediately adjacent to one gate post for foot traffic.
 - e. Barrier will extend from each side of the gate until vehicle traffic is not possible around the gate.

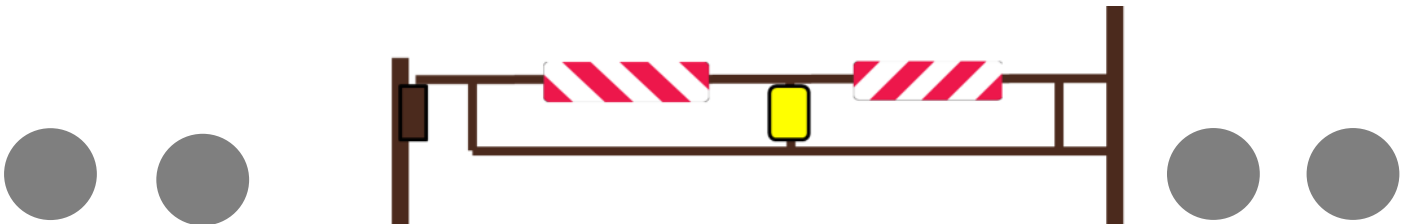

2. Block the sides of gates with a debris berm.
 - a. Berm should be a minimum of 4' high.
 - b. Shall consist of dirt, rocks, logs, and other dense/non-compressible materials.
 - c. A 30" clearance should be left immediately adjacent to one gate post for foot traffic.
 - d. Barrier will extend from each side of the gate until vehicle traffic is not possible around the gate.

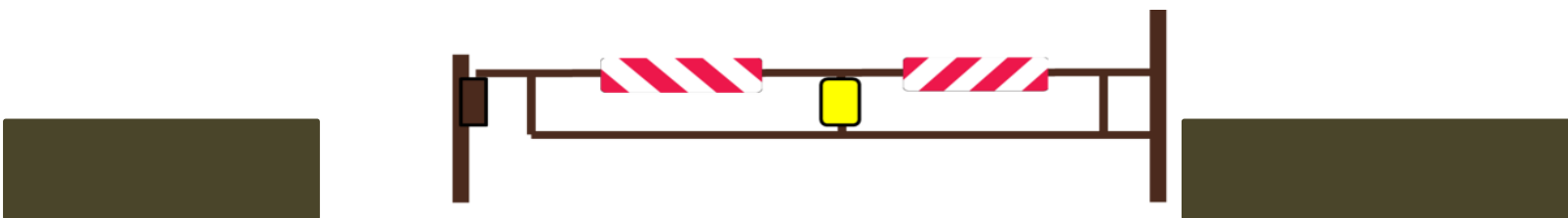

Pushed in Roads

For sales that have roads pushed in **NOT** behind a gate, the contractor shall close the road in the following manner.

All roads, landings, & Primary Skid trails will need to be closed off that come out to an open road or motorized trail. The number of roads needed for a sale should be as minimal as possible & all skid trails should go to the sale road, not open public roads or motorized trails.

Options & Requirements:

Rock or Stump with Root-ball barrier

1. Utilize Rocks 3-4' in diameter or a minimum of 3' high root-balls placed not more than 24" apart from each other.
2. Rocks or Root-balls will be placed in two alternating rows that extend across the width of the Road/landing/skid trail until a point in which vehicle traffic is not possible around the berm due to vegetation, terrain, stumps, etc. (**NOTE: A dual row design is only needed for primary sale roads. Landings & Skid trails only need one row**).
3. For main sale roads, the berm will be placed 15' from the roadway edge, allowing enough room for a vehicle to park. On landings and skid trails, the berm shall be immediately adjacent to the ditch line.

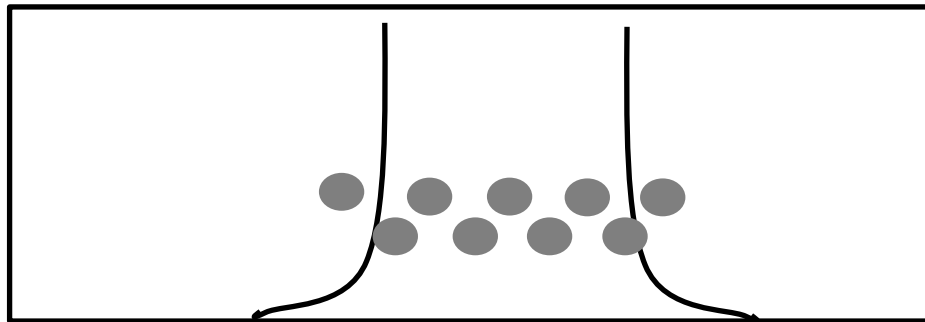

Debris Berms: alternatively, a debris berm may be used. The debris berm should be made of non-compressible materials such as logs, root balls, rocks, and dirt. The same requirements above apply, except that only one row needs to be placed and at a 4' height, extending the entire width of the roadway and beyond the edge to prevent traffic.

***Earthen Berms shall not be used**

****When pulling out from a sale for an extended period of time, the contractor shall lay a tree or other object across the sale road to prevent vehicle entry.**

Attachment B

LOGGING OPERATIONS AND TRAIL/ROADWAY SIGNAGE

Contractors must take care when working on trails and roadways in order to prevent damage to regulatory signage, and to provide for the safety of other users. There are legal implications of removing regulatory signage, especially if it results in injury as a result of it missing. Guidance:

1. Contractors should avoid piling logs against signs. This damages the signs and makes them unreadable to users. Contractors should also avoid pulling signs without first notifying the department.
2. Contractors **shall not** pile logs within 25' of roadway or trail stop signs, or stop ahead signs. Stop signs and stop ahead signs **must never be removed. If it is necessary to remove one of these signs, the contractor must notify the department first before doing so, so that it can be properly re-positioned.** This poses a significant safety hazard to trail/road users- and can leave the contractor with legal responsibility.
3. Contractors **shall not**, under any circumstances, remove, or stack wood against or within 25' of a department open road street sign. These signs designate open roads within the forest and also have stop signs and regulatory signage attached.

23.33(8)(f)1.

1. No person may intentionally remove, damage, deface, move, obstruct, or interfere with the effective operation of any uniform all-terrain vehicle route or trail sign or standard or any uniform sign or standard for the operation of a utility terrain vehicle on an all-terrain vehicle route or trail if the sign or standard is legally placed by the state, any municipality or any authorized individual.

Tract (13-18) Popple Pita Sale

Parts of: S1/2NW, NESW of Section 13; E1/2, NENW of Section 24 T38N-R4W, Sawyer County.

114 Acres

<u>Species</u>	<u>Estimated Volume</u>	<u>Advertised Value/Unit</u>
¹ Mixed Pulp	1300 cords	19.40
Basswood	300 cords	3.40
Aspen	1630 cords	18.70

Minimum Acceptable

Bid for Entire Sale

\$56,721.00

¹Mixed pulp includes 29% hard maple, 32% red maple, 30% ash, and 9% cherry, elm, ironwood, yellow birch and white birch combined. Mixed pulp also includes 6 MBF hard maple, 6 MBF red maple, and 16 MBF ash.

Other species not mentioned will be charged at the mixed pulp price.

The performance bond will be 15% of the total sale value. Contract length is approximately three years.

SPECIAL SALE CONDITIONS:

Equipment use will be restricted to frozen ground conditions only due to wet soil conditions for access.

No decking allowed on West Lane.

Access could be from either Hwy. W or West Lane. If accessing sale from West Lane, a temporary instream crossing using poles or timber mats will be needed at location indicated on map. All conditions of the temporary instream crossing permit, which will be obtained by the Flambeau River State Forest, will be followed by the contractor. Placement and removal shall be the responsibility of the contractor.

Use of a continuous rotating saw head will not be allowed in the selection area or aspen removal area due to density and distribution of regeneration.

New road construction is limited to the proposed road layout indicated on map. Other new construction must be approved by forester.

No landings will be built within 200 feet of the stream indicated on the map.

All additional restrictions listed in prospectus and standard contract apply unless specified.

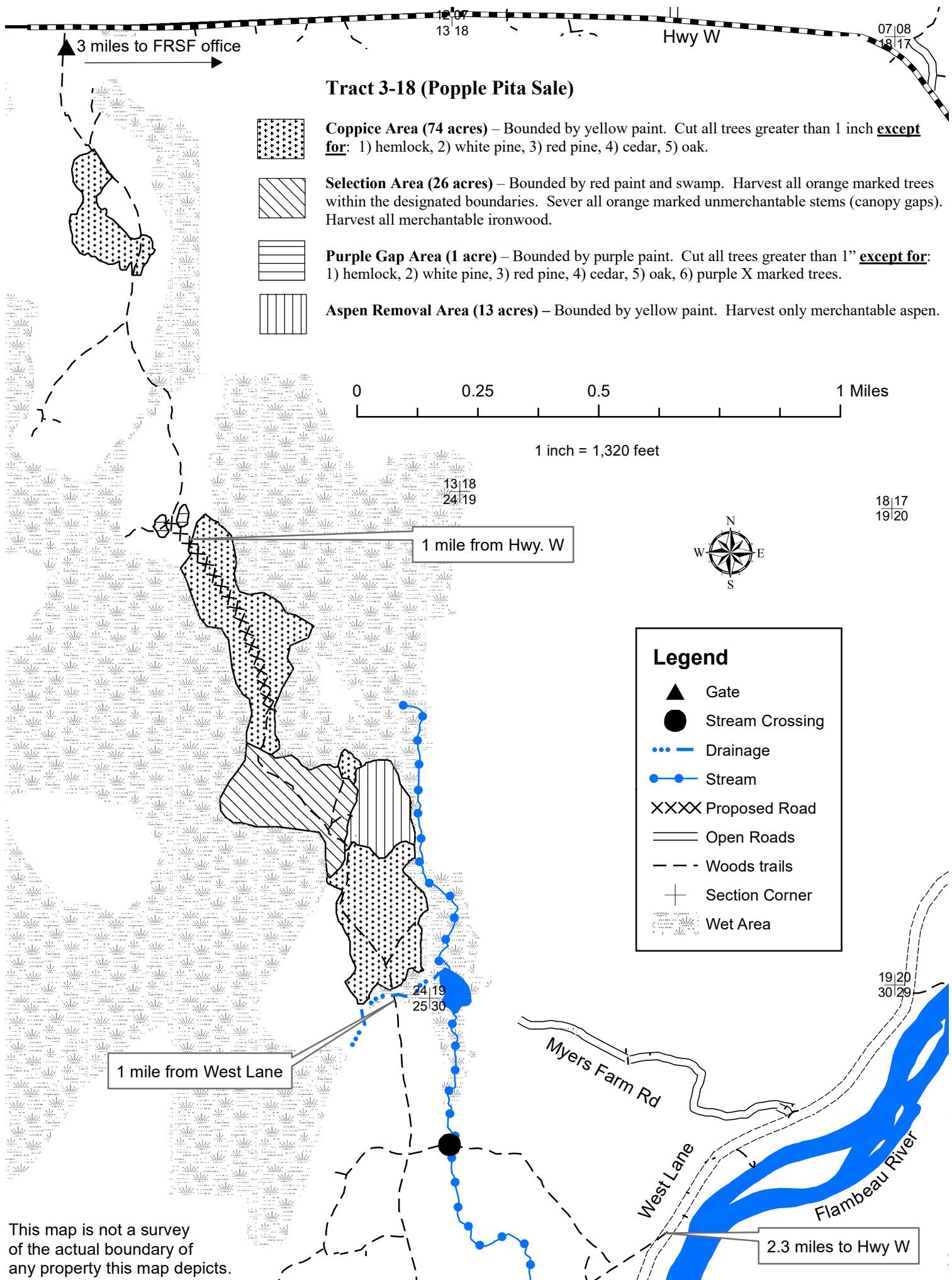

Tract (17-18) Groundhog Sale

Parts of: SW, S1/2NW, SE Sec. 28 and N1/2, NW, SWNW Sec. 33, T39N-R3W, Sawyer County

243 Acres

<u>Species</u>	<u>Estimated Volume</u>	<u>Advertised Value/Unit</u>
¹ Mixed Pulp	3000 cords	22.10
Basswood	400 cords	4.30
Ash	800 cords	12.80
Aspen	400 cords	21.30
Fir	75 cords	10.20
Hard Maple	25 MBF	208.00
Ash	75 MBF	98.00
Basswood	45 MBF	98.00
² Mixed Saw	43 MBF	102.00

Minimum Acceptable
Bid for Entire Sale
\$108,891.00

¹Mixed pulp includes 53% red maple, 42% hard maple, 4% yellow birch, 1% white birch, elm, and ironwood combined.

²Mixed saw includes 35 MBF red maple and 8 MBF yellow birch.

Other species not mentioned will be charged at the mixed pulp/saw price.

The performance bond will be 15% of the total sale value. Contract length is three years.

SPECIAL SALE CONDITIONS:

No harvesting allowed in selection area and the red maple/ash overstory removal area from **April 1st through August 10th**.

No harvesting in the red maple/aspen coppice area from **May 20th through August 10th**.

Equipment use will be restricted to dry or frozen ground conditions. Areas recommended for frozen ground harvesting are indicated on map.

Use of a continuous rotating saw will not be allowed in the selection area or the red maple/ash overstory removal area due to the density and distribution of regeneration. The objective is to release existing regeneration in these areas and extra caution will be taken to prevent unnecessary damage.

No landings, decking or skidding on or along Hanson Lake West Road without prior approval from the timber sale administrator.

If decking on hunter/walking trails all slash and ends shall be removed from the trail and ditches concurrently with each truckload.

Upon sale completion, all woods roads and hunter/walking trails and access points along Hansen Lake West Road shall be leveled, re-ditched if necessary, and returned to pre-sale condition.

Access across private property (if desired) is the responsibility of the contractor.

The existing berm on the hunter walking trail adjacent to private property will be removed by the contractor.

Care must be taken to insure protection of the existing survey monument as shown on the map.

All additional restrictions listed in prospectus and standard contract apply unless specified.



GroundHog Sale (Tract 17-18)

This map is not a survey of the actual boundary of any property this map depicts.

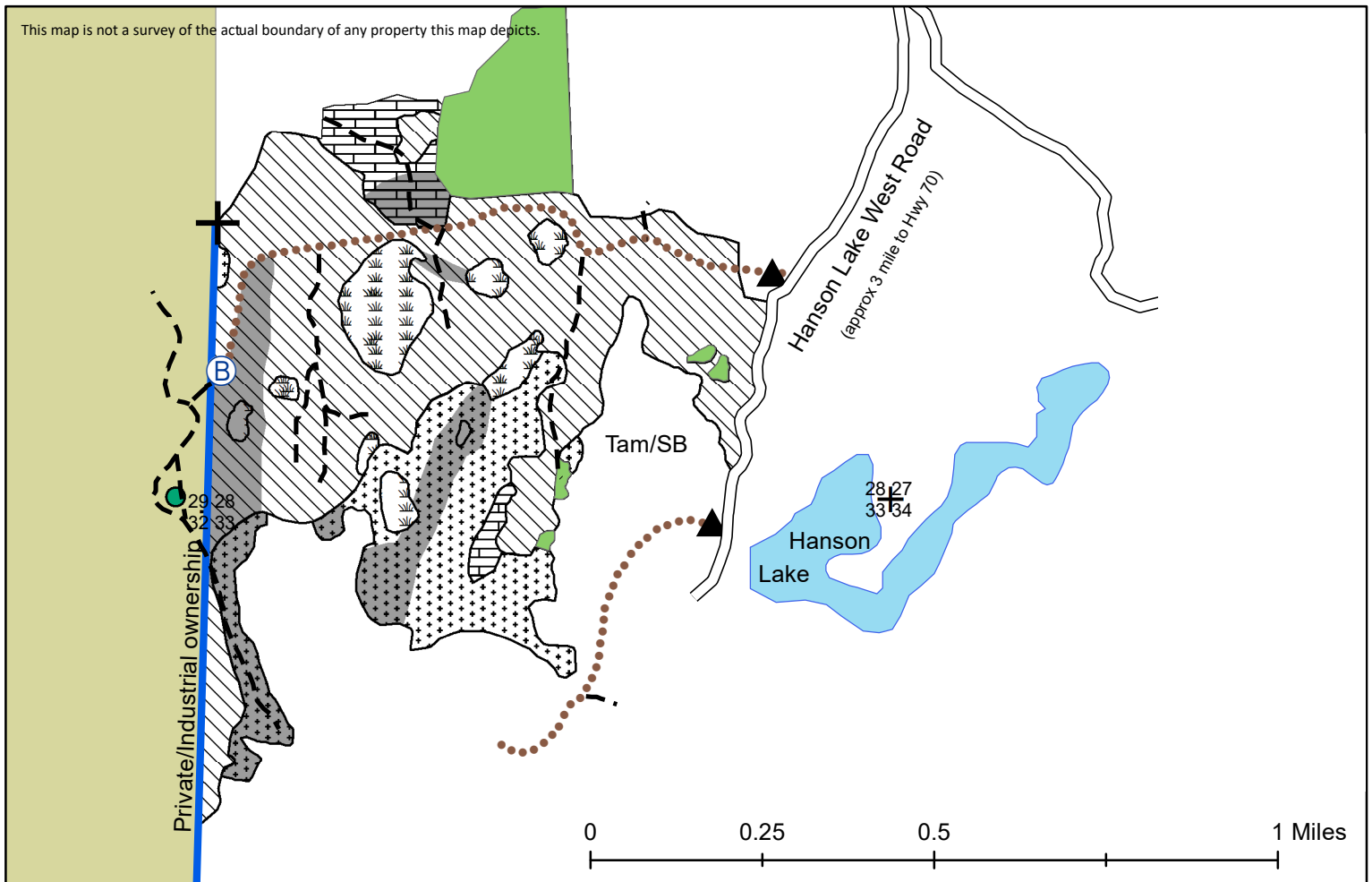

For sale inspection, please call 715-332-5271 ext. 106 or ext. 112 for the combination of the lock for the gate. Please do not go around gate.

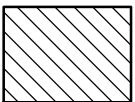

Selection Area (168 acres)- Bounded by red paint, blue paint, Hanson Lk. West Rd., and black spruce/tamarack wetland areas. Harvest all orange marked trees and merchantable ironwood within designated boundaries. Sever all orange marked unmerchantable stems (canopy gaps).

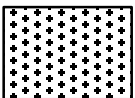

Red Maple/Aspen Coppice Area (58 acres)- Bounded by yellow paint. Cut all trees greater than 2" except for: 1). Cedar, 2). Hemlock, 3). White Pine, 4). Spruce, 5). Oak, and 6) Cherry.

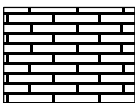

Red Maple/Ash Overstory Removal (17 acres)- Bounded by purple paint. Cut all trees 5" and larger except for: 1). Cedar, 2). Hemlock, 3). White Pine, 4). Spruce, 5). Oak, 6). Cherry, 7). Yellow Birch, and 8). Any trees marked with a purple "ring".

Legend

- open roads
- wet area
- gate
- present berm
- survey monument
- woods roads
- Hunter Walking
- openings
- Blue paint line
- recommended frozen ground
- cabin
- private land

Tract 3-20 (Crazy 8 Sale)

Parts of: W1/2, SWNE Sec. 3; W1/2SW, NW, W1/2NE, SENE, N1/2SE Sec. 10; SESE Sec. 9 T36N –3W Rusk County

193 Acres

<u>Species</u>	<u>Estimated Volume</u>	<u>Advertised Value/Unit</u>	
Mixed Pulp ¹	2000 cds.	\$ 18.80/cd	
Basswood	60 cds.	\$ 3.60/cd	
Aspen	410 cds.	\$ 18.10/cd	
Balsam Fir ²	230 cds.	\$ 8.70/cd	
Tamarack	525 cds.	\$ 8.70/cd	
Hard Maple	13 MBF	\$177.00/MBF	
Red Maple	85 MBF	\$ 87.00/MBF	Minimum Acceptable
Ash	59 MBF	\$ 83.00/MBF	<u>Bid for Entire sale</u>
Mixed ³	16 MBF	\$ 87.00/MBF	\$67,790.50

¹Mixed Hardwood Pulp includes: 52% Red Maple, 26% Ash, 12% Sugar Maple, 9% Yellow Birch, and 1% white birch, ironwood. ²Balsam Fir pulp includes 44% Fir and 56% Black Spruce. ³Mixed Hardwood Sawtimber includes: 10 MBF Basswood, 5 MBF Yellow Birch, 1 MBF White Birch/other. Species not listed will be charged the mixed pulp/saw price.

The performance bond will be 15% of the total sale value. Contract length is approximately 3 years.

Special Sale Conditions:

Equipment use will be restricted to very dry or frozen ground conditions. No harvest in select cut area from April 1 - June 30 due to bark being easily damaged during this time period.

No pole length skidding will be allowed in the selection area.

Decking will be done along woods trails within the sale area. Decking will be allowed along snowmobile trail. Decking of wood along snowmobile trail shall not impede traffic on the trail. No decking will be permitted off Highway M or Skinner Creek Road.

Slash that is within 100 feet of Highway M will be lopped and scattered to within 2 feet of the ground by the contractor.

3" of packed snow will be maintained on snowmobile trail, weather permitting. The trail will be kept free of debris. Any new access roads or landings need the approval of DNR forester.

Avoid government survey monuments illustrated on prospectus map.

There are small areas within the selection area (indicated on map) that were damaged by a wind storm in 2019. Utilize merchantable wood from the wind damaged trees if possible. Wind damaged is defined as uprooted or trees with 50% or more crown damage.

All additional restrictions listed in prospectus and standard contract apply unless specified.

Tract 3-20 Crazy 8 Sale

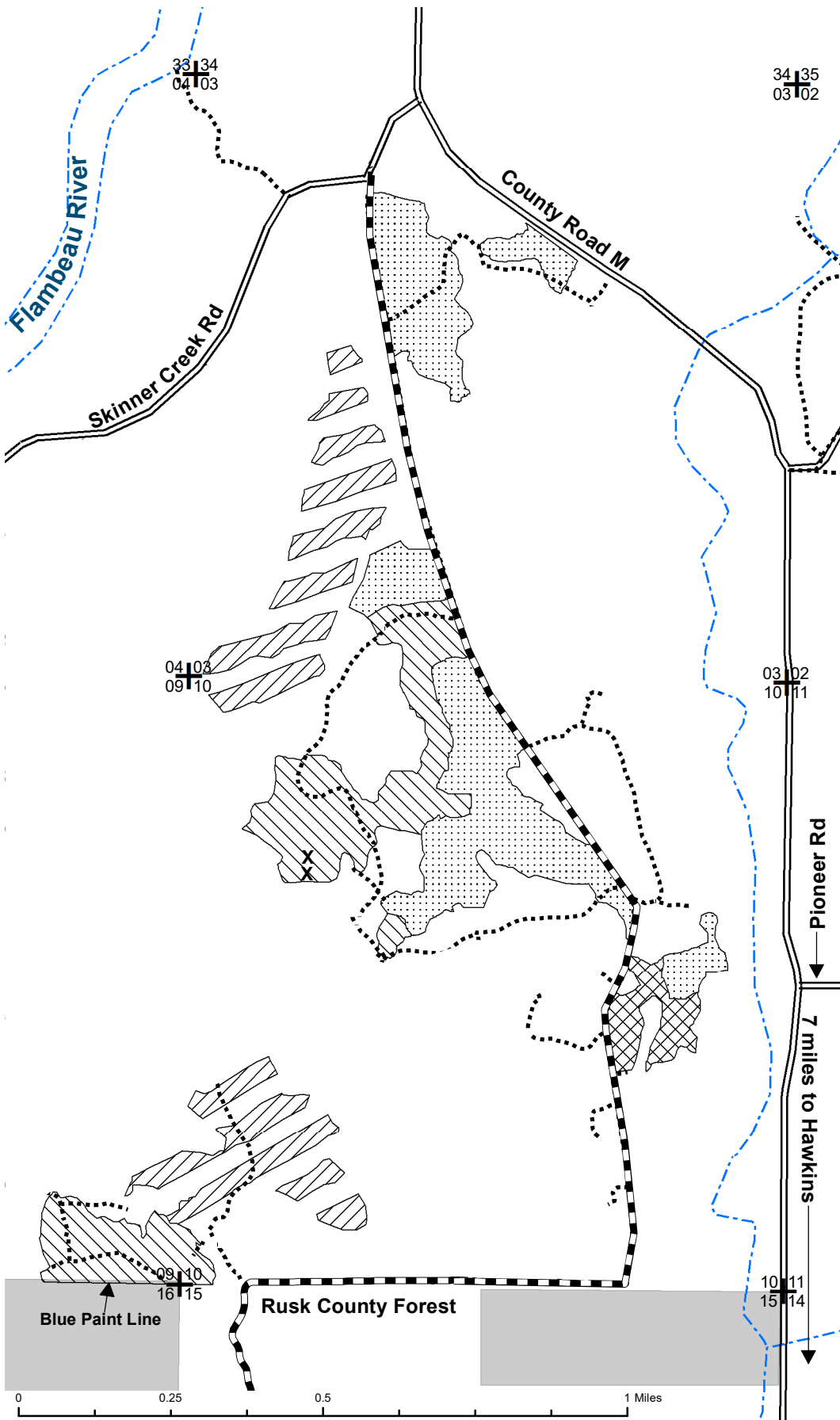
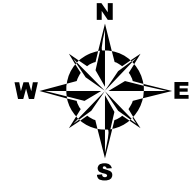

X Wind Damaged Area

--- Snowmobile Trail

... Woods road

+ Section Corners

--- Rivers & Streams

■ Private Land

Selection Harvest Areas(59 Acres) – Bounded by Red paint and by Blue paint. Harvest all orange marked trees within boundary area.

Tamarack/Black Spruce Strip Clearcuts(43 Acres) - Bounded by Yellow paint. Harvest all trees 1" or larger within boundary areas with exception of: White Pine, Hemlock, White Cedar.

Aspen/Red Maple Coppice Areas(81 Acres) – Bounded by Yellow paint and snowmobile trail. No paint along trail. Harvest all stems 1" or larger within boundary areas with exception of: Hemlock, White Cedar, White Pine, White Spruce, Oak and Cherry.

Black Ash Coppice Area(10 Acres) - Bounded by Yellow paint and snowmobile trail.

No paint along trail. Harvest all merchantable stems 4" or larger with exception of: Spruce, Hemlock, Cedar and Pine.

* This map is not a survey of the actual boundary of any property this map depicts.

Tract (04-20) Dog Dayz

Parts of: SW¼ Sec. 10, N½ S½, SW¼ NE¼ Sec. 11, N½SW¼, SE½ NW¼, SW¼ SE¼ Sec. 12, T36N R4W
Rusk County

135 acres

<u>Species</u>	<u>Estimated Volume</u>	<u>Advertised Value/Unit</u>
¹ Mixed Pulp	2120 cords	22.10
Basswood	250 cords	4.30
Aspen	600 cords	21.30
Oak	160 cords	10.20
Hard Maple	15 MBF	208.00
Red Maple	40 MBF	102.00
Basswood	60 MBF	98.00
Ash	120 MBF	98.00
Oak	30 MBF	221.00
² Mixed Saw	1 MBF	102.00

Minimum Acceptable
Bid for Entire Sale
\$93,911.00

¹Mixed pulp includes 23% hard maple, 32% red maple, 43% ash, 2% yellow birch, white birch, cherry, and ironwood combined.

²Mixed saw includes 1 MBF yellow birch, white birch, and cherry combined.

Other species not mentioned will be charged at the mixed pulp/mixed saw price.

The performance bond will be 15% of the total sale value. Contract length is approximately three years.

SPECIAL SALE CONDITIONS:

Equipment use is restricted to very dry or frozen conditions.

Use of a continuous rotating saw head will not be allowed in the selection or oak areas due to density and distribution of regeneration.

In the selection area, no cutting allowed during the months of April, May, or June in selection harvests due to bark being easily damaged at these times.

To prevent oak wilt and to protect the regeneration, no operations will be allowed in the overstory removal between April 1— July 15.

Any woods road used for access must have a debris berm placed by contractor at completion of sale.

All slash within 100 feet of Hervas or Acorn roads shall be lopped and scattered to within two feet of the ground by the contractor.

When decking on Hervas or Acorn roads, all slash and ends will be removed from the roads and ditches concurrently with each truck load.

All additional restrictions listed in prospectus and standard contract apply unless specified.

Tract 04-20 (Dog Dayz)

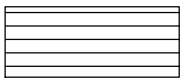

Oak Overstory Removal: (8 acres) Bounded by red paint and Hervas Road. Harvest all merchantable trees **except** for: 1) cherry and 2) yellow birch. Leave all snags. Avoid damaging regeneration.

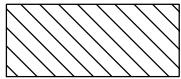

Selection Area: (98 acres) Bounded by red paint, young aspen, and Hervas Road. Harvest all orange marked trees within the boundary. Sever all orange marked unmerchantable stems. Leave all snags. Cut only **marked** aspen.

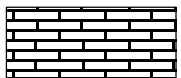

Purple Patch Area: (6 acres) Bounded by purple paint. Harvest all trees greater than 2 inches **except** for: 1) hemlock, 2) white pine, 3) oak.

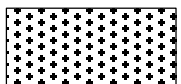

Aspen Area: (23 acres) Bounded by yellow paint, Hervas Road, and woods road. Harvest all trees greater than 1 inch **except** for: 1) hemlock, 2) white pine, 3) oak.



- Woods Trail
- + Section Corner
- ... Drainage

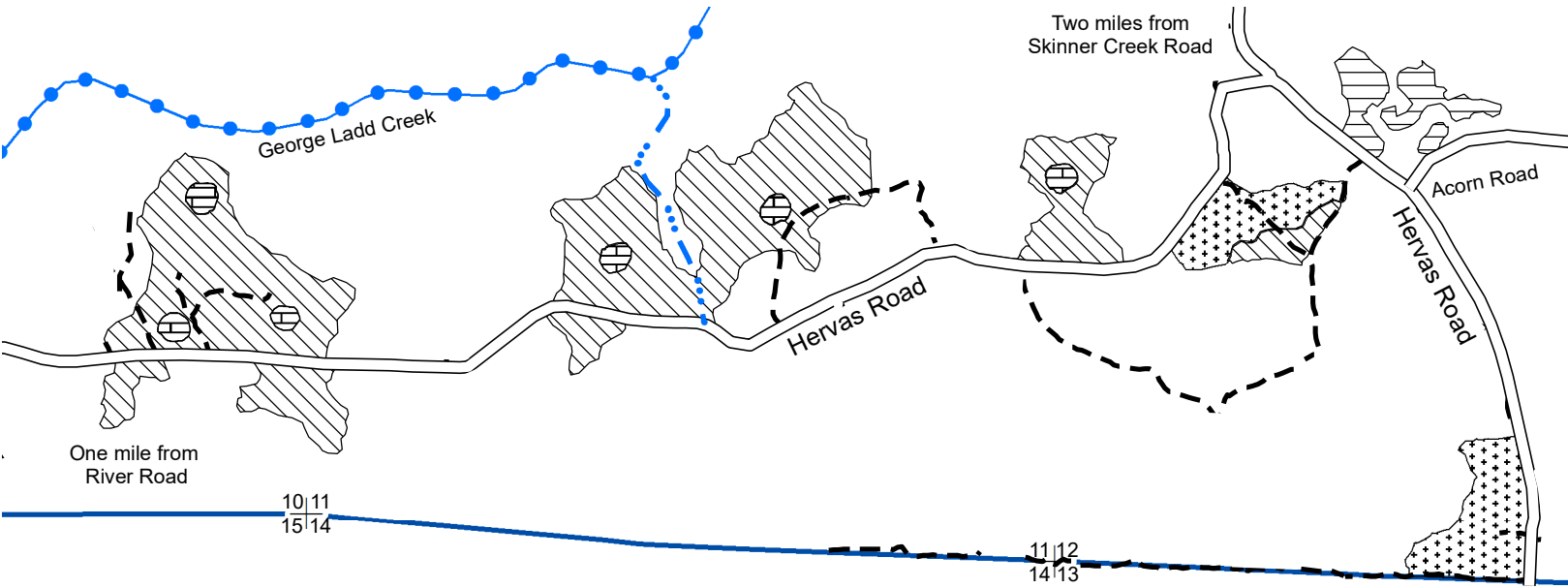

"This map is not a survey of the actual boundary of any property this map depicts"

Tract (PF 1-20) Take-Out Sale

Parts of: Section 18, Township 41 N, Range 2 E, Iron County.

104 Acres

<u>Species</u>	<u>Estimated Volume</u>	<u>Advertised Value/Unit</u>
Aspen Pulp	2954 tons	\$9.00/ton
¹ Mixed Hardwood Pulp	1044 tons	\$8.00/ton
² Balsam Pulp	1065 tons	\$6.00/ton

**Minimum Acceptable
Bid for Entire Sale
\$41,328.00**

¹Mixed hardwood pulp includes 61% hard maple, 28% red maple, 11% ash and black cherry combined.

²Balsam pulp includes 92% balsam fir and 8% spruce.

Other species not mentioned will be charged at the mixed pulp price.

The performance bond will be **15%** of the total sale value. Contract length is approximately three years.

SPECIAL SALE CONDITIONS:

Seasonal and Equipment Conditions

Equipment use will be restricted to very dry or frozen ground conditions due to wet soil conditions.

Roads/Access/Decking

NO DECKING OR SKIDDING ALLOWED on Hoffman Lake Road without special permission from the Property Manager and Forester.

If decking on Hoffman Lake Road or the access woods road south of Hoffman Lake Road to private land, all slash and ends will be removed from the roads and ditches **concurrently with each truckload**.

It is possible that Hoffman Lake Road (main haul road) will be used for multiple sales; it is the responsibility of the contractors of sales to determine the logistics for hauling and/or road repair.

Culvert(s) may be needed on existing and/or newly constructed roads. Roads are not to exceed 15 feet in width without permission from the Forester.

To make areas of sale operable during dry conditions, the existing main woods road will need rock material. The state will provide the rock material up to \$4,999 in value. The contractor will be responsible for additional rock costs after this amount and additional roadwork costs to the main woods road. It will be the responsibility of the contractor for loading/hauling/leveling any rock needed for decking on existing roads and new stubs. Type of fill material supplied by contractor must be approved by Property Manager.

Upon sale completion, all landings and access points along Hoffman Lake Road shall be re-ditched and returned to the condition prior to the sale.

Proposed logging debris berms shall be built at woods roads intersections not accessing private property (see sale map for berm locations). Large boulders or logging debris berms shall be used.

Contact: Kristina Wells – DNR Forester
(608) 403-2257

All additional restrictions listed in prospectus and standard contract apply unless specified.

Tract PF 1-20 Take-Out Sale

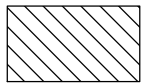

Selection Area (7 acres) - Bounded by blue paint to the south, red paint to the north. Harvest all orange-marked trees and all aspen within the designated boundaries.

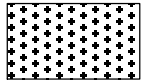

Aspen Regeneration Areas (97 acres) - Bounded by yellow paint, Hoffman Lake Road, and two-track road. Cut all trees greater than 2" except for 1) pine, 2) hemlock, 3) cedar, and 4) oak. Do not cut green-marked trees.

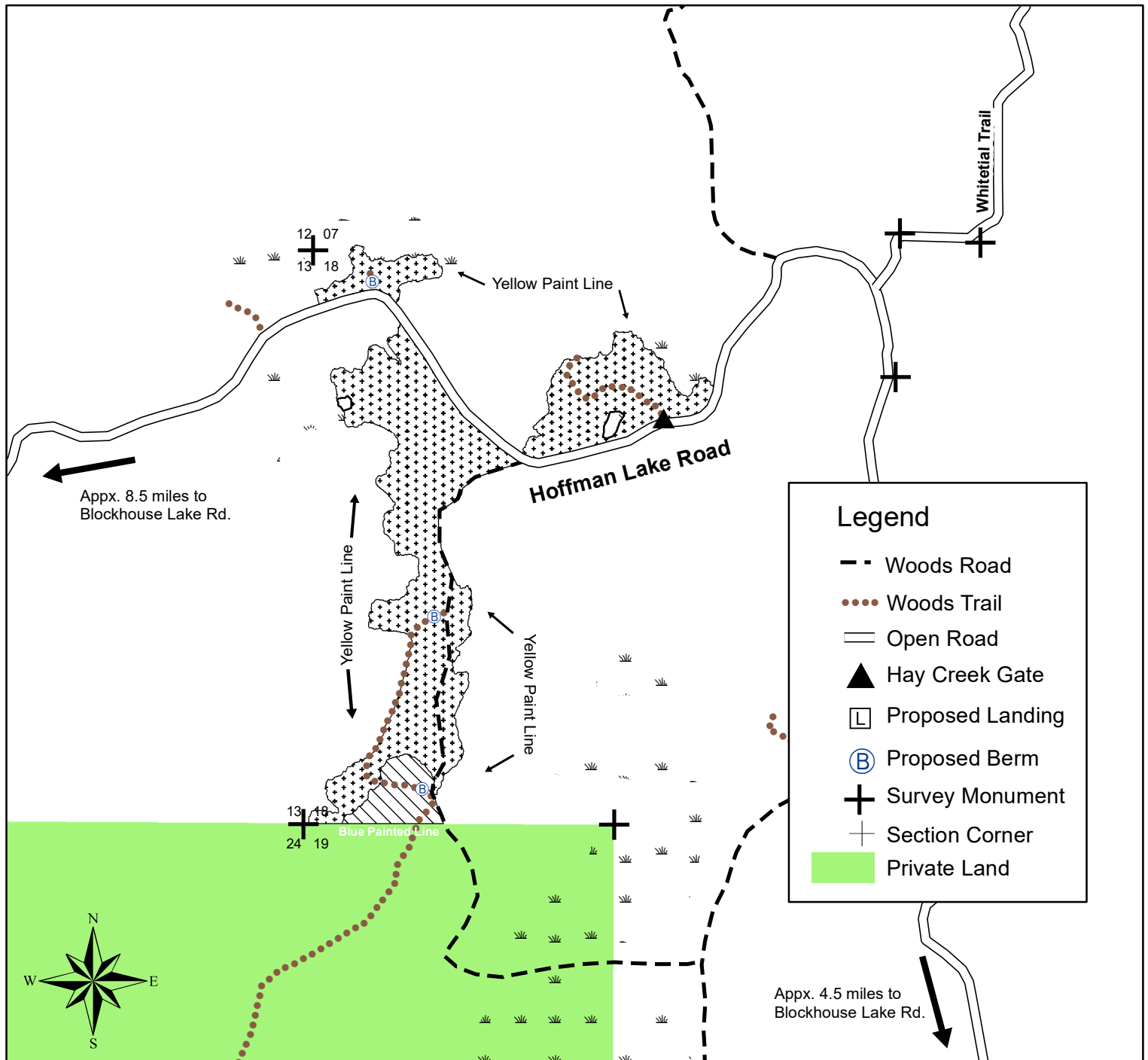

0 0.2 0.4 0.8 Miles

1 inch = 0.25 miles

1:15,840

*This map is not a survey of the actual boundary of any property this map depicts.