

Flambeau River State Forest and other State Lands Sustainable Forestry Timber Sales

Includes sales from
Flambeau River State Forest – 10 sales
Hay Creek–Hoffman Lake Wildlife Area – 2 sales
Rib River Fishery Area – 1 sale

November 12, 2020



Flambeau River State Forest Sale Locator Map

Legend

- Fall 2020 Timber Sales

Note: Sale Locator map does not include other state land sales

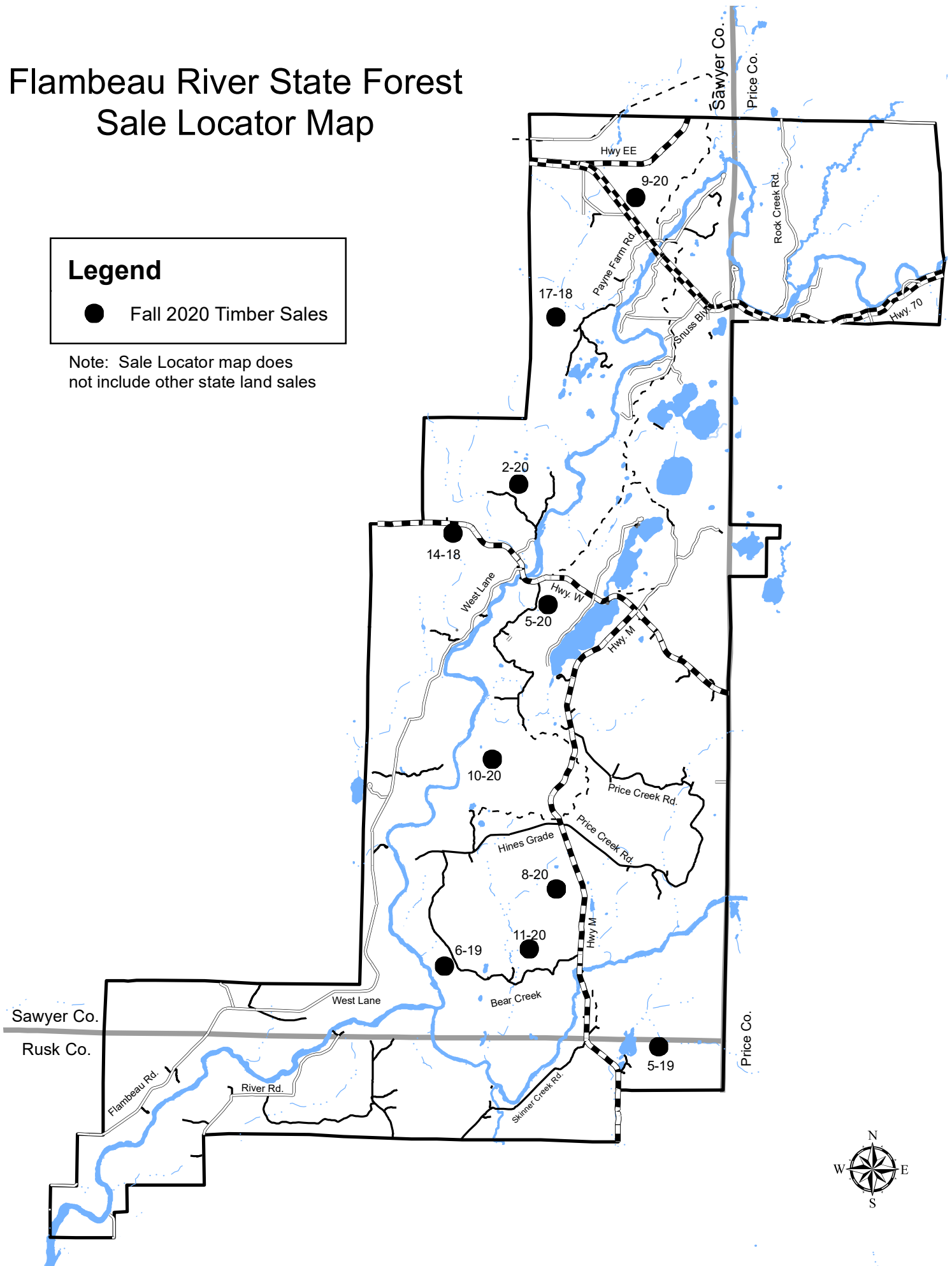

Hay Creek/Hoffman Lake Wildlife Area Timber Sale Locator Map for :

Blazed Aspen (PKF 1-21)

White Birch Oasis (PKF 2-21)

● Spring 2020 Timber Sales

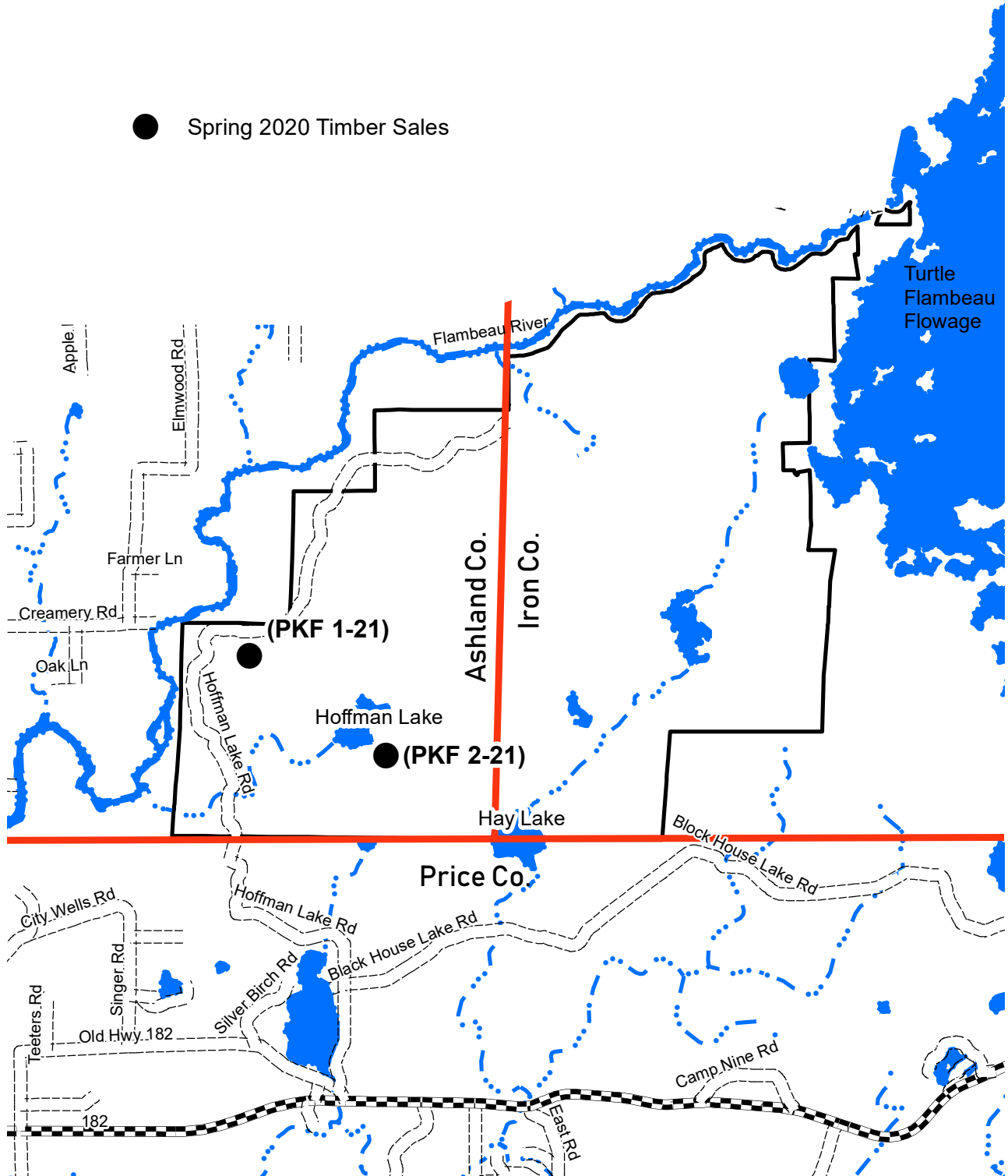

2020 NOVEMBER TIMBER SALES
FLAMBEAU RIVER STATE FOREST & OTHER STATE LANDS
W1613 COUNTY ROAD W
WINTER, WI 54896
(715) 332-5271

Sealed bids for sales in this packet will be received by the Wisconsin Department of Natural Resources, Flambeau River State Forest (FRSF), at the Flambeau Forest Headquarters, Winter, Wisconsin until **1:30 p.m. on November 12th, 2020** and opened immediately thereafter for timber stumpage on the Flambeau River State Forest and other state lands. Sealed bids for the other state lands should also be received at the Flambeau Forest Headquarters. Sealed bids for sales not sold on November 12th will be received at the Flambeau Forest Headquarters until **1:30 p.m. on December 14th, 2020**.

Please note: Due to the current situation with the COVID-19 pandemic, access to the FRSF headquarters is limited, bids will be accepted by mail or appointment only. In order to protect the health and safety of our employees and the public, the bid opening will be closed to the public. The bid opening will be conducted by a telecommunication system. For the call-in number and instructions on how to listen/participate, please call 715-332-5271 ext. 106 by 4:00 p.m. November 11th.

“These lands are 3rd party certified.”

Please note: Cordwood weight conversion provided by the mill purchasing the forest product will no longer be used. The weight conversion factors in the table on page 6 will be used in the conversion of weight scale to a standard 128 cubic foot cord.

It is the responsibility of the bidder to inspect, evaluate the stumpage, examine the locations, investigate field conditions, and check Contract requirements for each tract prior to bidding. Submission of bid reflects that the bidder has inspected the tract and clearly understands and agrees to all Contract conditions and requirements. For inspection of Flambeau River State Forest timber sales for bidding, ATVs will be permitted. For sale inspection, call 715-332-5271 ext. 106 for the combination lock on gates. Please do not go around gates.

Please review **Attachment A** for berming requirements and **Attachment B** for protection of road signs.

The sales on the Flambeau River State Forest will use the mill scale ticket system for pulpwood. Sales with saw logs included in the pulp price will also use the mill scale ticket system.

The contractor shall notify a DNR Forester or Forest Technician 3 days prior to beginning work on sale. Before work begins on sale, contractors will be required to have a pre-sale meeting with either a Forest Technician or a Forester.

NO DECKING OR SKIDDING ALLOWED ON Price Creek Road, Bear Creek Road, Hines Grade, Tower Hill Road, Skinner Creek Road, Hervas Road, Cedar Rapids Access Road, Wannigan Rapids Access Road, or Oxbo Access Roads without special permission.

The State may not plow snow on state forest roads. If a sale is located on a state forest road, the contractor may be responsible for plowing the snow. The following are state forest roads: Tower Hill,

Bass Lake, Price Creek, Hines Grade, Bear Creek, Skinner Creek, and Hervas.

TRAINING REQUIREMENT

The purchaser shall ensure that the actual logging contractor engaged in performance of this contract complies with the Wisconsin SFI (Sustainable Forestry Initiative) Training Standard as adopted by the Wisconsin SFI Implementation Committee (SCI). Criteria for the standard can be found at the website www.fistausa.org/sfi_standards or by contacting the Forest Industry Safety & Training Alliance (FISTA).

Purchaser agrees to provide documentation to Seller that the training has been attained prior to initiating sale.

SOIL DISTURBANCE AND RUTTING

a. The Purchaser agrees to take all steps and precautions to avoid and minimize soil disturbances, such as soil compaction and rutting. If soil disturbances occur, the Purchaser agrees to work cooperatively to mitigate and repair any and all instances of soil disturbance.

b. Excessive soil disturbance (as defined in Table 1) shall not be permitted. Purchaser agrees to contact Seller in the event of an excessive soil disturbance.

Table 1. Thresholds for soil disturbances.

<u>Timber Sale Infrastructure</u>	<u>Soil disturbances are excessive if:</u>
<i>Roads, Landings, Skid Trails, and General Harvest Area</i>	<ul style="list-style-type: none">▪ A gully or rut is 6 inches deep or more and is resulting in channelized flow to a wetland, stream, or lake.
<i>Roads, Landings, and Primary Skid Trails</i>	<ul style="list-style-type: none">▪ In a riparian management zone (RMZ) or wetland, a gully or rut is 6 inches deep or more and 100 feet long or more.▪ In an upland area (outside of RMZ), a gully or rut is 10 inches deep or more and 66 feet long or more.
<i>Secondary Skid Trails and General Harvest Area</i>	<ul style="list-style-type: none">▪ A gully or rut is 6 inches deep or more and 100 feet long or more.

Note: The depth is to be measured from the original soil surface to the bottom of the depression. If individual lug depressions are visible, the depth would be measured to the lesser of the two depths (the "top" of the lug). The length is measured from the start of the "too deep" section to the end of the "too deep" section. Measurements are not cumulative.

c. Prior to sale completion the Purchaser shall mitigate and repair soil disturbances to the Seller's satisfaction.

For questions on the following properties please contact the person listed:

Flambeau River State Forest – Heidi Brunkow (715) 332-5271 ext. 106
Hay Creek – Hoffman Lake Wildlife Area – Maggie Lorenz (715) 492-1970
Rib River Fishery Area – Jeff Sorenson (715) 965-9228

FLAMBEAU RIVER STATE FOREST

General Sale Conditions

Bidding and Financing

1. To bid on a tract, each species must be bid on (per cord, ton, or MBF) and the **minimum total sale value must be met. A bid will be rejected if any individual species/product bid is \$0.**
2. A bid must be made on all species and products listed by tract including lump sum sales.
3. All bids must be by tract number and sealed in individual envelopes marked on the outside, Bid on Tract ____.
4. Whole tree (chipping) bids will be adjusted by adding overrun factors to cruised volumes. Notification prior to bidding will be required. Approved areas allowing whole tree logging will be identified along with specific overrun factors to be used. If for any reason the contract is not whole tree harvested, the contractor will pay 25% more than the bid value per species that anticipated whole tree harvest. Whole tree harvest (chipping) includes all wood and bark.
5. All bids will include the following:
 - A. Tract Number
 - B. List of species to be harvested and estimated volume
 - C. Bid price, per unit for each species and product
 - D. Signature and address of each bidder
6. Persons desiring to bid on more than one tract must submit a separate bid for each tract.
7. Bids will be opened in a random order from a draw of the hat. **Prior to the reading of a bid, a contractor may elect to withdraw the bid.** The contractor or representative of the contractor must declare this at the bid opening before any bids for the specified tract are read.
8. **BID BOND NOT REQUIRED.** Winning bidders will have 6 weeks from the date of the bid opening to submit an acceptable performance bond to the department. If the winning bidder fails to execute the contract and submit an acceptable performance bond, the bidder shall be required to forfeit to the department an amount equal to 10% of the total bid amount. Failure to forfeit the 10% penalty will result in the bidder being considered ineligible to bid on any state timber sales for a two-year period.
9. An Irrevocable Letter of Credit may be used as a Performance Bond. ***The expiration date of all letters of credit must be maintained for four full years.*** Contact the Forest Headquarters for details regarding the clauses required in the letter.

Contracts & Extensions

1. Contracts must be signed and returned to the Flambeau River State Forest or appropriate property within 30 days of the bid letting. Contracts may contain additional provisions. Contracts may not be assigned.
2. All contract lengths will be noted on timber sale document. It is understood that all contracts are expected to be completed during the initial contract. Extensions are not automatic.
3. Requests for extensions must be submitted prior to the expiration date of the contract. The performance bond may be retained if requests are not submitted by the expiration date.

Payments

1. Purchaser agrees to make stumpage payments within 30 days of billing, unless otherwise specified in the payment schedule.
2. Late interest penalty – Purchaser agrees to pay a late interest penalty of 1.5% for every 30 days on past due stumpage in excess of the 30 day period. In addition, failure to pay within the 30 day period will result in the Purchaser having to prepay for the remainder of the sale. Two such payment breaches, even on separate State sales, will also result in the purchaser being required to prepay on all state timber sales for a two-year duration.

Cutting and Skidding Specifications

1. All timber marked or designated for cutting will be utilized whether or not the quantity is more or less than the estimated volume.
2. No pole length skidding will be allowed in select cut areas, pine thinnings, or spruce thinnings.
3. **No cutting can be done during the months of April, May, and June in selection harvests** due to bark being

- more easily damaged at these times, unless special permission is granted.
4. All decking must be done on the sale if it is not specifically designated.
 5. Any young growth bent or held down by felled trees must be promptly released.
 6. The Department of Natural Resources reserves the right to stop operations if unreasonable, excessive, or avoidable damage occurs or will occur. The contractor may be held responsible to repair any or all damage.
 7. Although logging during very dry conditions may be permitted, during wet periods the soils may become soft and susceptible to rutting. Soils may become too wet after storms and extended wet spells. Operations will be suspended during these periods.
 8. The Department of Natural Resources may change, suspend or terminate any timber sale contract or portion of contract with no penalties to the State if errors in timber sale planning or designing cause or may cause serious environmental damage, or may cause aesthetic concerns, or are not sound silvicultural practices, or violate any county, state, or federal law or regulation.
 9. Any bole damage to residual trees will be considered unnecessary.
 10. Trees that are marked with an "X" are not to be cut. They are leave trees. All snags will be reserved unless a safety concern, then the snags will be cut and left for coarse woody debris.
 11. **Extra caution is needed to avoid damaging existing pockets of regeneration throughout selection sale areas.** These pockets of regeneration should not have trees felled into them or skid trails run through them.
 12. If collecting firewood for home, a firewood permit is required. **A permit is also required for collection of burls.**

Slash Requirements

1. All slash requirements will be done concurrent with sale operations. For town roads, state forest roads, hunter/walker trails, and ATV/snowmobile trails, **all slash and ends will be removed from the roads and ditches concurrently with each truckload.**
2. Slash that is within 100 feet of state highways, county highways, forest roads, open access roads, ATV/Snowmobile trails, canoe campsites and landings will be lopped and scattered to within 2 feet of the ground by the contractor.
3. No slash or logging debris will be left across the blue line onto private land.
4. No slash piles from landing operations may be left over 24" above the ground level. Piles shall be spread over the site before leaving.
5. Slash disposal will comply with the State Slash Law, Section 26.12(b), Wisconsin Statutes, and with requests regarding forest fires prevention and suppression made by the seller.

Road and Camps

1. The locations of all roads, landings, and camps must be approved by the Forester prior to construction. A DNR Forester must be contacted at least 48 hours in advance for an appointment.
2. The sale area, including all roads and camps, will be kept neat, clean and free of garbage, oil cans, plastic bottles, and miscellaneous trash throughout the contract period. All residues, including oils and fluids, generated may not be buried or burned, but must be removed from the sale area and disposed of properly.
3. Those merchantable trees removed or damaged as a result of approved road building operations will be utilized.
4. All road entrances must be cleaned up of all roots, stumps, and down trees at the time of construction.
5. **It will be the responsibility of the contractor to repair any road damage due to logging.**
6. **Contractor is required to close roads at designated map locations by placing rocks, stumps and/or cull log barriers. (See Attachment A).** Any road, landing, or primary skid trail used for a timber sale will need to be closed according to Attachment A.
7. **Do not damage or remove trail/roadway signage. (See Attachment B).**
8. Road approaches to surfaced roads or other government public roads are the responsibility of the Contractor. Damage to these roads is the responsibility of the Contractor.
9. **The State may not plow snow on state forest roads.** If a sale is located on a state forest road, the contractor may be responsible for plowing the snow. The following are state forest roads: Tower Hill, Bass Lake, Price Creek, Hines Grade, Bear Creek, Skinner Creek, and Hervas.

Seasonal Restrictions

1. **No cutting can be done during the months of April, May, and June in selection harvests** due to bark being more easily damaged at these times, unless special permission is granted.
2. Any wood located within 400' of the Flambeau River shall be removed prior to April 1st of each contract year.
3. The State reserves the right to place additional seasonal restrictions on sales as necessary.

Hauling Restrictions

1. It is the responsibility of the Contractor, to obtain permission from the appropriate Township to deck wood along a town road.
2. All road bans and weight restrictions are the responsibility of the Contractor. State forest roads may be posted for longer periods of time than county and township roads.
3. The purchaser will be required to restrict or suspend hauling during periods when the compacted road surface would be damaged. Hauling will be suspended if it is causing rutting into the subgrade, or surfacing material would be displaced, such as during heavy rainfall or spring break-up freezing and thawing cycles.

General Conditions

1. All provisions in the contract shall be met before the contract expires. Performance under the contract must proceed in an efficient, workman-like manner, conducive to the orderly completion of the sale. Extensions will only be considered under unusual hardship of circumstances. Details of extension conditions, damage assessments, and other provisions are addressed in the contract which is on file at the Forest Headquarters.
2. Permanent survey monuments shall be left undisturbed. Forest personnel shall be notified if one is encountered during timber sale operations.
3. Extreme caution must be used in sale operations to prevent wildfire. There are requirements outlined in the contract for fire extinguishers and spark arrestors.
4. No skidding, landing, or piling of wood products will take place on the ATV/Snowmobile trail or the State Forest roads without special permission. The following are State Forest roads: Tower Hill, Bass Lake, Price Creek, Hines Grade, Bear Creek, Skinner Creek, and Hervas.
5. If a snowmobile trail is used for a timber sale operation, 3" of packed snow will be maintained on the snowmobile trail, weather permitting.

Utilization Specifications

Those sales without an increased utilization option will have the following standards:

Standard Utilization - Unless otherwise specified, standard specifications will be as follows:

Aspen pulpwood	4" top diameter
Hardwood pulpwood	4" top diameter
Softwood pulpwood	4" top diameter
Hardwood sawlogs	10" top diameter inside bark
Softwood sawlogs	8" top diameter, inside bark

Merchantable trees are those that have one or more 100 inch pulpwood sticks with a minimum top diameter of four inches.

Scaling Specification

1. All bid species of sawlogs will be scaled as such. Pulpwood products cut longer than 8' may be scaled by the board feet and converted to cords as follows: Softwood - 2.44 cds./MBF and Hardwood - 2.20 cds./MBF.
2. All logs will be scaled with the Scribner Decimal C log rule. All logs will be scaled as sawlogs if 50% sound and meet the requirements of a Grade No. 3 log or better in accordance with the National Forest Scaling Handbook. The minimum diameter for a Grade No. 3 log is 10". The maximum trim allowance is 5" unless contractor can demonstrate that market specifications dictate more trim (ties, veneer, etc.). Logs with excessive trim will be scaled at the next highest foot length.
3. Logs will be decked for scaling on pulpwood stringers with the small ends all one way (towards the road) and separated by log length. Decks will not exceed six feet in height and will be accessible for inspection from both sides of the deck. If separating for bolts, the bolts will be decked with the small ends all one way (towards the road).
4. When sap-peeled pulpwood is scaled, 12.5% will be added to hand peeled and stroke delimeter/processor peeled volume, and 16% will be added to ring debarked volume. **Scale ticket must state if the load is a peeled product.**
5. The mill scale ticket system will be required for pulp. Contractor is required to deposit a scale ticket in the

lock box placed on the sale. These tickets are provided by the State Forest and will be filled out in their entirety. The Contractor is also required to deliver a mill ticket to the mill purchasing the forest product. This mill ticket will be returned to the Flambeau River State Forest along with a copy of the mill's scale. The Contractor is responsible for having these mill tickets and scale slips returned to the Flambeau River State Forest in a timely manner. The mill scale slip that corresponds to the lock box ticket must be received at the Flambeau River State Forest Office within 14 days of hauling.

6. If wood is to be yarded at another location other than the sale area, permission must be granted by Forester.
7. Contractors that are required to prepay must at a minimum purchase 5 or more scale tickets at a time, but it is encouraged that a full booklet of 25 scale tickets be purchased.
8. A mill scale ticket must also be placed in the ticket box for loads of scaled logs.

Cordwood Weight Conversion Factors

Cordwood weight conversion provided by the mill purchasing the forest product will no longer be used, the following weight conversion factors will be used in the conversion of weight scale to a standard 128 cubic foot cord. The weight conversion in the following table will be used for billing purposes.

CORDWOOD WEIGHT CONVERSION FACTORS
POUNDS PER CORD

Species	Weight	Species	Weight
Ash	4600	Jack pine	4250
Aspen	4500	Locust	5300
Balsam	4250	Mixed hardwood	4800
Balsam poplar	4900	Red oak	5500
Basswood	3850	Red pine	4500
Beech	5050	Soft maple	4550
Black Cherry	4300	Spruce	4000
Cedar	3150	Tamarack	4650
Cottonwood	4650	White birch	4800
Elm	5000	White oak	5850
Hard maple	5100	White pine	4200
Hemlock	4800	Yellow birch	5350
Hickory	5400		

Worker's Compensation Law

The contractor (purchaser) shall provide the Department with a Certificate of Insurance indicating that Worker's Compensation Insurance coverage is provided for all of the contractor's (purchaser's) employees working under the contract during its duration. This shall be in the Department's file prior to any performance under the contract. Such certificates of insurance shall further include the condition that the insurer shall notify the Department at the Flambeau River State Forest Headquarters within five (5) days of any change in its terms or twenty (20) days prior to termination.

The Special Sale Conditions listed for each individual tract and the General Sale Conditions are additions to, or condensations, of a standard timber sale contract that the successful bidder must sign. A sample contract, additional information, maps for each sale, and bid forms may be obtained from the Forest Superintendent, Flambeau River State Forest, W1613, Co. Rd. W, Winter, Wisconsin 54896.

The Department of Natural Resources reserves the right to reject any or all bids.

Attachment A

Contractor Sale Closure Requirements

Gated Roads

For sales that occurred behind a locked gate, and harvesting occurred around the gate area, contractors are required to do one of the following:

1. Block the sides of the gates with rocks or stumps with root-balls.
 - a. Rocks must be between 3-4' in diameter
 - b. Stumps must be a minimum of 3' high.
 - c. No greater than 24" spacing between rocks or root-balls.
 - d. A 30" clearance should be left immediately adjacent to one gate post for foot traffic.
 - e. Barrier will extend from each side of the gate until vehicle traffic is not possible around the gate.

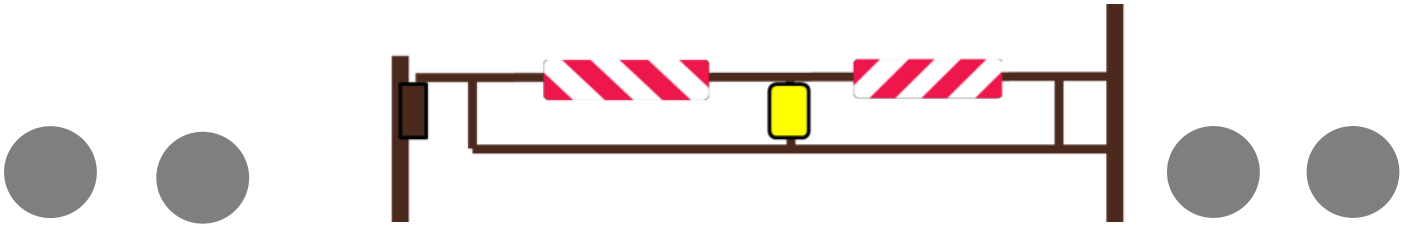

2. Block the sides of gates with a debris berm.
 - a. Berm should be a minimum of 4' high.
 - b. Shall consist of dirt, rocks, logs, and other dense/non-compressible materials.
 - c. A 30" clearance should be left immediately adjacent to one gate post for foot traffic.
 - d. Barrier will extend from each side of the gate until vehicle traffic is not possible around the gate.

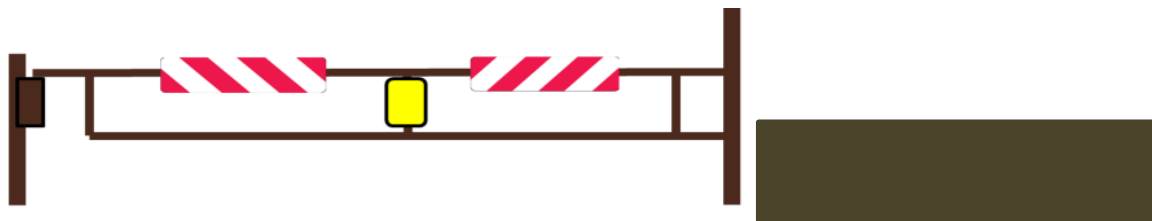

Pushed in Roads

For sales that have roads pushed in **NOT** behind a gate, the contractor shall close the road in the following manner.

All roads, landings, & Primary Skid trails will need to be closed off that come out to an open road or motorized trail. The number of roads needed for a sale should be as minimal as possible & all skid trails should go to the sale road, not open public roads or motorized trails.

Options & Requirements:

Rock or Stump with Root-ball barrier

1. Utilize Rocks 3-4' in diameter or a minimum of 3' high root-balls placed not more than 24" apart from each other.
2. Rocks or Root-balls will be placed in two alternating rows that extend across the width of the Road/landing/skid trail until a point in which vehicle traffic is not possible around the berm due to vegetation, terrain, stumps, etc. (**NOTE: A dual row design is only needed for primary sale roads. Landings & Skid trails only need one row**).
3. For main sale roads, the berm will be placed 15' from the roadway edge, allowing enough room for a vehicle to park. On landings and skid trails, the berm shall be immediately adjacent to the ditch line.

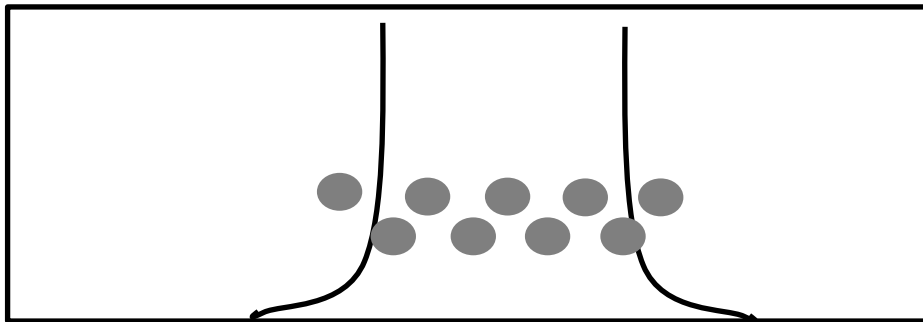

Debris Berms: alternatively, a debris berm may be used. The debris berm should be made of non-compressible materials such as logs, root balls, rocks, and dirt. The same requirements above apply, except that only one row needs to be placed and at a 4' height, extending the entire width of the roadway and beyond the edge to prevent traffic.

***Earthen Berms shall not be used**

****When pulling out from a sale for an extended period of time, the contractor shall lay a tree or other object across the sale road to prevent vehicle entry.**

Attachment B

LOGGING OPERATIONS AND TRAIL/ROADWAY SIGNAGE

Contractors must take care when working on trails and roadways in order to prevent damage to regulatory signage, and to provide for the safety of other users. There are legal implications of removing regulatory signage, especially if it results in injury as a result of it missing. Guidance:

1. Contractors should avoid piling logs against signs. This damages the signs and makes them unreadable to users. Contractors should also avoid pulling signs without first notifying the department.
2. Contractors **shall not** pile logs within 25' of roadway or trail stop signs, or stop ahead signs. Stop signs and stop ahead signs **must never be removed. If it is necessary to remove one of these signs, the contractor must notify the department first before doing so, so that it can be properly re-positioned.** This poses a significant safety hazard to trail/road users- and can leave the contractor with legal responsibility.
3. Contractors **shall not**, under any circumstances, remove, or stack wood against or within 25' of a department open road street sign. These signs designate open roads within the forest and also have stop signs and regulatory signage attached.

23.33(8)(f)1.

1. No person may intentionally remove, damage, deface, move, obstruct, or interfere with the effective operation of any uniform all-terrain vehicle route or trail sign or standard or any uniform sign or standard for the operation of a utility terrain vehicle on an all-terrain vehicle route or trail if the sign or standard is legally placed by the state, any municipality or any authorized individual.

Tract 14-18 Popple Pita North Sale

Parts of: SW, SWSE, E1/2SE of Sec. 7, NE Sec. 18, W1/2NW Sec. 17 T 38N-R3W; E1/2SE, NENE Sec. 13 T38N-R4W, Sawyer County.

174 Acres

<u>Species</u>	<u>Estimated Volume</u>	
¹ Mixed Pulp	1900 cords	
Basswood	25 cords	Minimum Acceptable
Aspen	2500 cords	<u>Bid for Entire Sale</u>
² Spruce	150 cords	\$42,861.50
Balsam	80 cords	
Tamarack	150 cords	
Red Maple	35 MBF	
Ash	30 MBF	
Yellow Birch	13 MBF	
³ Mixed Saw	5 MBF	

¹Mixed pulp includes 6% hard maple, 61% red maple, 27% ash, and 6% yellow birch and small amounts of white birch, ironwood, and cherry.

²Spruce includes 70% white spruce and 30% black spruce.

³Mixed Saw includes 4 MBF of hard maple, 1 MBF of basswood, and a small amount of white birch.

Other species not mentioned will be charged at the mixed pulp price or mixed saw price.

The performance bond will be 15% of the total sale value. Contract length is approximately three years.

SPECIAL SALE CONDITIONS:

Equipment use will be restricted to very dry or frozen ground conditions due to wet soil conditions. Some areas will likely require frozen conditions.

New road construction is limited to the proposed road layout indicated on map. Modifications may be made with approval of forester. Other new construction must be approved by forester.

If decking on Aspen Lane or White Pine Road, all slash and ends will be removed from the roads and ditches concurrently with each truckload.

All slash located within 100 feet of Cty. Rd. W shall be lopped and scattered to within two feet of the ground. No slash will be left in ditch line of Cty. Rd. W.

All additional restrictions listed in prospectus and standard contract apply unless specified.

Tract 14-18 (Popple Pita North Sale)

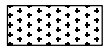

Aspen Coppice Area (83 acres) – Bounded by yellow paint. Cut all trees greater than 1” **except for:** 1) hemlock, 2) white pine, 3) red pine, 4) oak, 5) cedar, and 6) spruce with 1 stick or less. Leave all trees within 30’ of all hemlock and cedar.

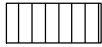

Red Maple Coppice Area (77 acres) – Bounded by yellow paint and/or swamp. Cut all trees greater than 1 inch **except for:** 1) hemlock, 2) white pine, 3) red pine, 4) oak, and 5) cedar. Leave all trees within 30’ of all hemlock and cedar.



Selection Area (2 acres) – Bounded by red paint and yellow paint. Harvest all orange marked trees. Sever all orange marked unmerchantable stems (canopy gaps). Harvest all merchantable ironwood.

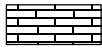

Purple Gap Area (3 acres) – Bounded by purple paint. Cut all trees greater than 1” **except for:** 1) hemlock, 2) white pine, 3) red pine, 4) oak, 5) cedar, 6) purple “X” marked trees.

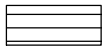

Tamarack/Black Spruce Area (9 acres) – West area bounded by red paint. East area bounded by tag alder and young aspen. Cut all trees greater than 1” **except for:** 1) hemlock, 2) white pine, 3) oak, 4) cedar, 5) green “X” marked trees.

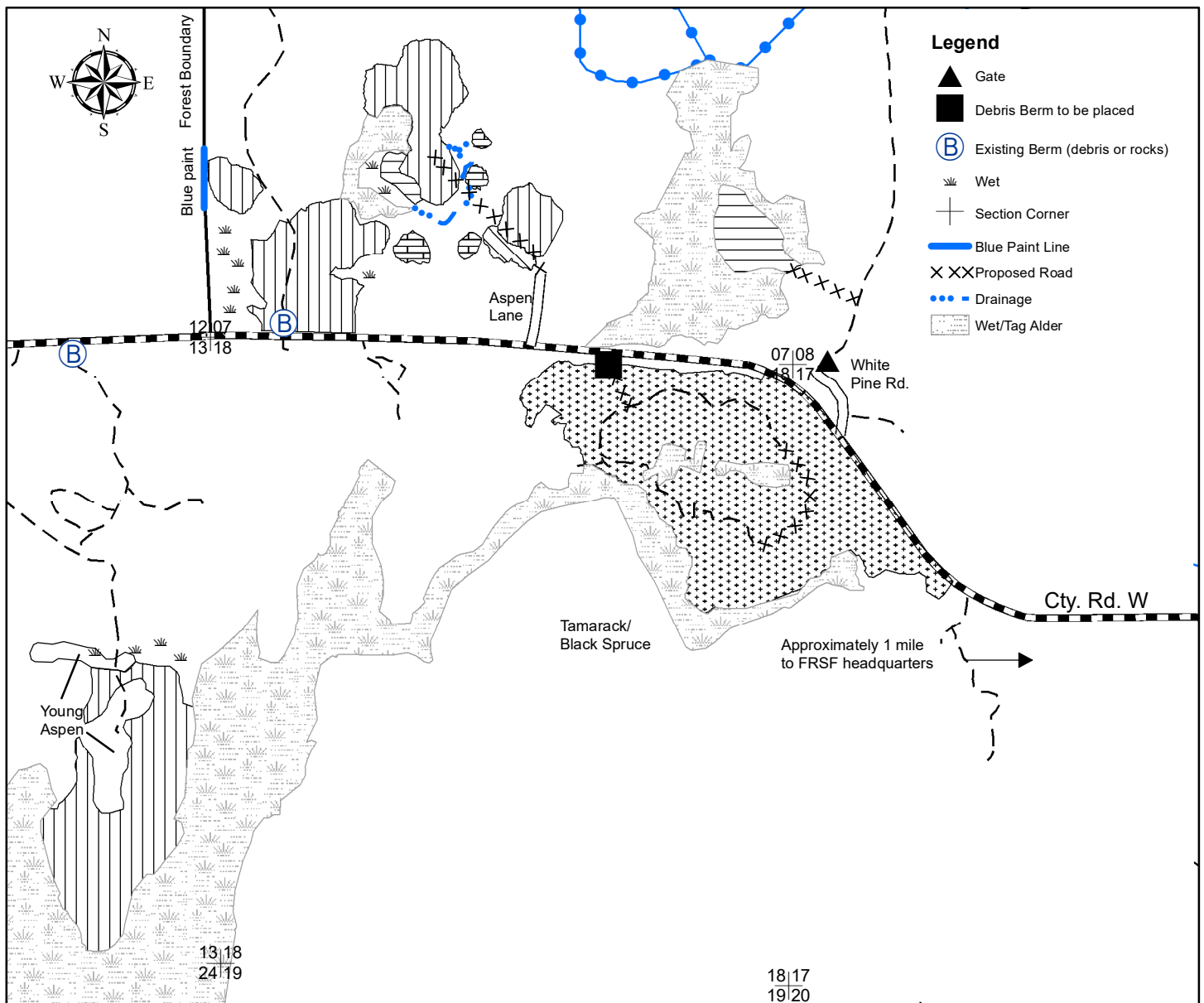

1:15,840

0 0.25 0.5 1 Miles

"This map is not a survey of the actual boundary of any property this map depicts"

Tract (17-18) Groundhog Sale

Parts of: SW, S1/2NW, SE Sec. 28 and N1/2, NW, SWNW Sec. 33, T39N-R3W, Sawyer County

243 Acres

<u>Species</u>	<u>Estimated Volume</u>	<u>Advertised Value/Unit</u>
¹ Mixed Pulp	3800 cords	5.00
Basswood	400 cords	1.00
Aspen	400 cords	12.60
Fir	75 cords	1.00
Hard Maple	25 MBF	105.00
Ash	75 MBF	70.00
Basswood	45 MBF	70.00
² Mixed Saw	43 MBF	70.00

Minimum Acceptable
Bid for Entire Sale
\$38,550.00

¹Mixed pulp includes 53% red maple, 42% hard maple, 4% yellow birch, 1% white birch, elm, and ironwood combined.

²Mixed saw includes 35 MBF red maple and 8 MBF yellow birch.

Other species not mentioned will be charged at the mixed pulp/saw price.

The performance bond will be 15% of the total sale value. Contract length is three years.

SPECIAL SALE CONDITIONS:

No harvesting allowed in selection area and the red maple/ash overstory removal area from **April 1st through August 10th**.

No harvesting in the red maple/aspen coppice area from **May 20th through August 10th**.

Equipment use will be restricted to dry or frozen ground conditions. Areas recommended for frozen ground harvesting are indicated on map.

Use of a continuous rotating saw will not be allowed in the selection area or the red maple/ash overstory removal area due to the density and distribution of regeneration. The objective is to release existing regeneration in these areas and extra caution will be taken to prevent unnecessary damage.

No landings, decking or skidding on or along Hanson Lake West Road without prior approval from the timber sale administrator.

If decking on hunter/walking trails all slash and ends shall be removed from the trail and ditches concurrently with each truckload.

Upon sale completion, all woods roads and hunter/walking trails and access points along Hansen Lake West Road shall be leveled, re-ditched if necessary, and returned to pre-sale condition.

Access across private property (if desired) is the responsibility of the contractor.

The existing berm on the hunter walking trail adjacent to private property will be removed by the contractor.

Care must be taken to insure protection of the existing survey monument as shown on the map.

All additional restrictions listed in prospectus and standard contract apply unless specified.



GroundHog Sale (Tract 17-18)

This map is not a survey of the actual boundary of any property this map depicts.

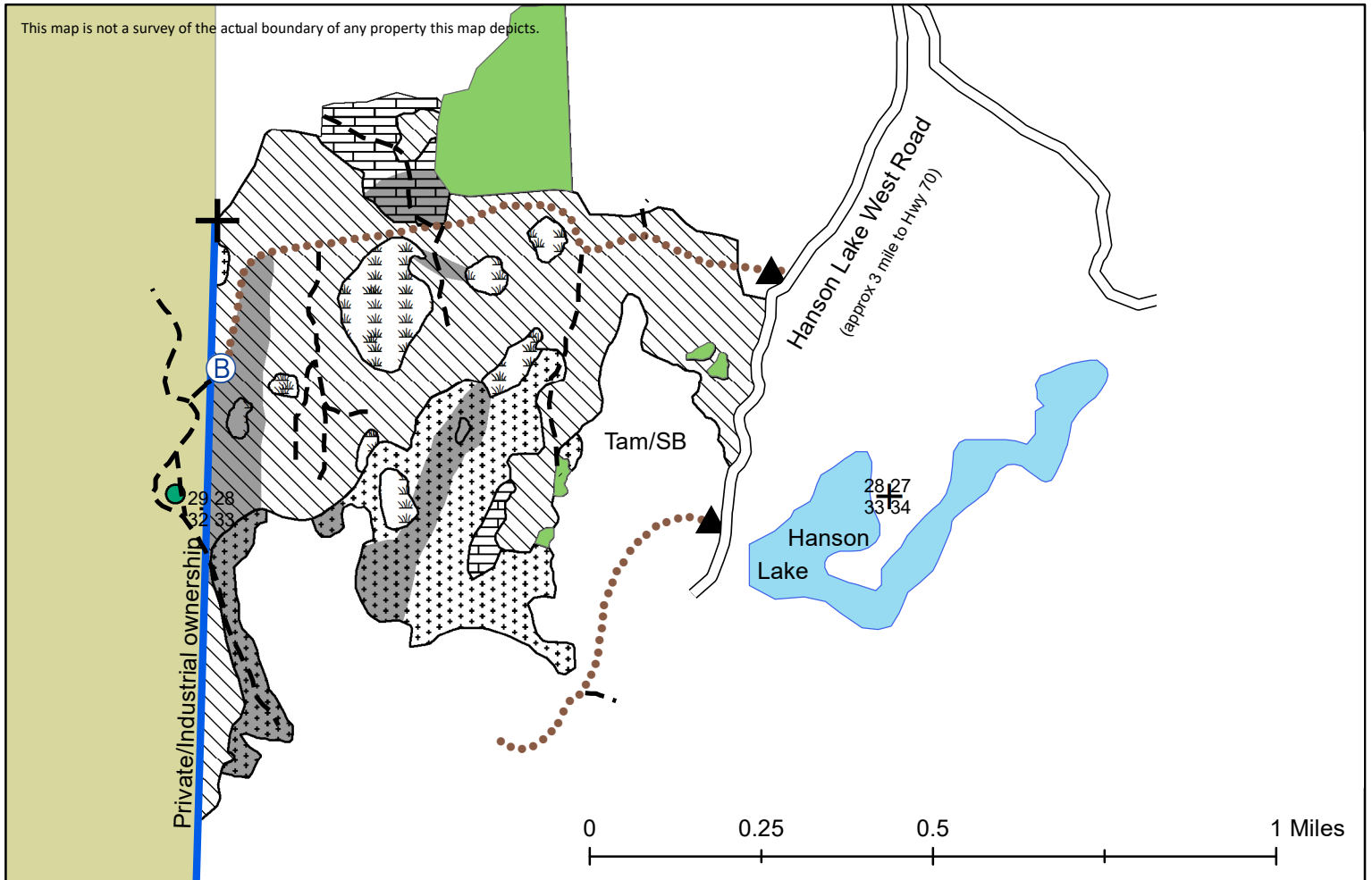

For sale inspection, please call 715-332-5271 ext. 106 or ext. 112 for the combination of the lock for the gate. Please do not go around gate.

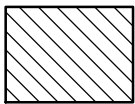

Selection Area (168 acres)- Bounded by red paint, blue paint, Hanson Lk. West Rd., and black spruce/tamarack wetland areas. Harvest all orange marked tees and merchantable ironwood within designated boundaries. Sever all orange marked unmerchantable stems (canopy gaps).

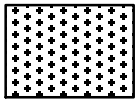

Red Maple/Aspen Coppice Area (58 acres)- Bounded by yellow paint. Cut all trees greater than 2" except for: 1). Cedar, 2). Hemlock, 3). White Pine, 4). Spruce, 5). Oak, and 6) Cherry.

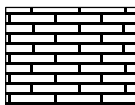

Red Maple/Ash Overstory Removal (17 acres)- Bounded by purple paint. Cut all trees 5" and larger except for: 1). Cedar, 2). Hemlock, 3). White Pine, 4). Spruce, 5). Oak, 6). Cherry, 7). Yellow Birch, and 8). Any trees marked with a purple "ring".

Legend

- open roads
- wet area
- gate
- present berm
- survey monument
- woods roads
- Hunter Walking
- openings
- Blue paint line
- recommended frozen ground
- cabin
- private land

Tract 5-19 (Swimming Swans)

Parts of: NESW, W1/2SE, SENW, and SWSW Section 2 in T36N-R3W, Rusk County.

Parts of :SESE Section 35 in T37N-R3W, Sawyer County.

108 acres

<u>Species</u>	<u>Estimated Volume</u>	
¹ Mixed Pulp	1100 cords	
Basswood	10 cords	Minimum Acceptable
Aspen	800 cords	<u>Bid for Entire Sale</u>
² Fir	25 cords	\$21,798.00
Sugar maple	6 MBF	
Red maple	32 MBF	
Ash	14 MBF	
Mixed Logs	1 MBF	

¹Mixed pulp includes 19% hard maple, 62% red maple, 14% Ash, and a combined 5% of Cherry, Elm, Birch and Ironwood.

²Fir includes a small amount of spruce and tamarack.

Other species not mentioned will be charged at the mixed pulp or mixed log price.

The performance bond will be 15% of the total sale value. Contract length is approximately three years.

SPECIAL SALE CONDITIONS:

This sale will be restricted to very dry or frozen ground.

Portions of the sale are restricted to frozen ground due to the quantity and distribution of exotic honeysuckle.

If decking is done on the hunter walking trail or open road, all slash and ends will be removed from the road and ditches concurrently with each truckload.

The portion of the sale indicated as aspen conversion/wildlife area will be mowed by department staff. This portion of the sale must be cut within one year of the mowing operation. Department staff will coordinate with the contractor to time the mowing operation to when the contractor has begun harvesting areas of the sale and soil conditions would allow for harvest/mowing in this area.

For sale inspection, call 715-332-5271 ext. 106 or ext. 109 for the combination of the lock for the gate. Please do not go around the gate.

All additional restrictions listed in prospectus and standard contract apply unless specified.

Tract 5-19 (Swimming Swans)

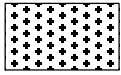

Aspen/Red Maple Area (86 acres) – Bounded by red paint and 2013 aspen. Cut all trees greater than 1” except: 1) hemlock, 2) white pine, 3) cedar, 4) oak. Leave all trees within 30’ of all hemlock and cedar.

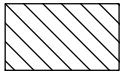

Selection Area (5 acres) – Bounded by a two-sided red paint line. Harvest all trees marked with orange paint. Harvest all merchantable ironwood.

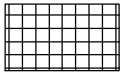

Aspen Conversion/Wildlife Area (17 acres) – Harvest all aspen within, and only in, the mowed tag alder area. This harvest area shall be cut within 1 year of department mowing operation. Leave all Tamarack.

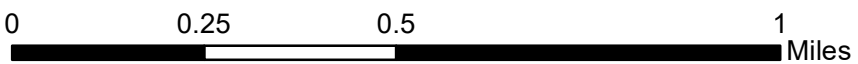
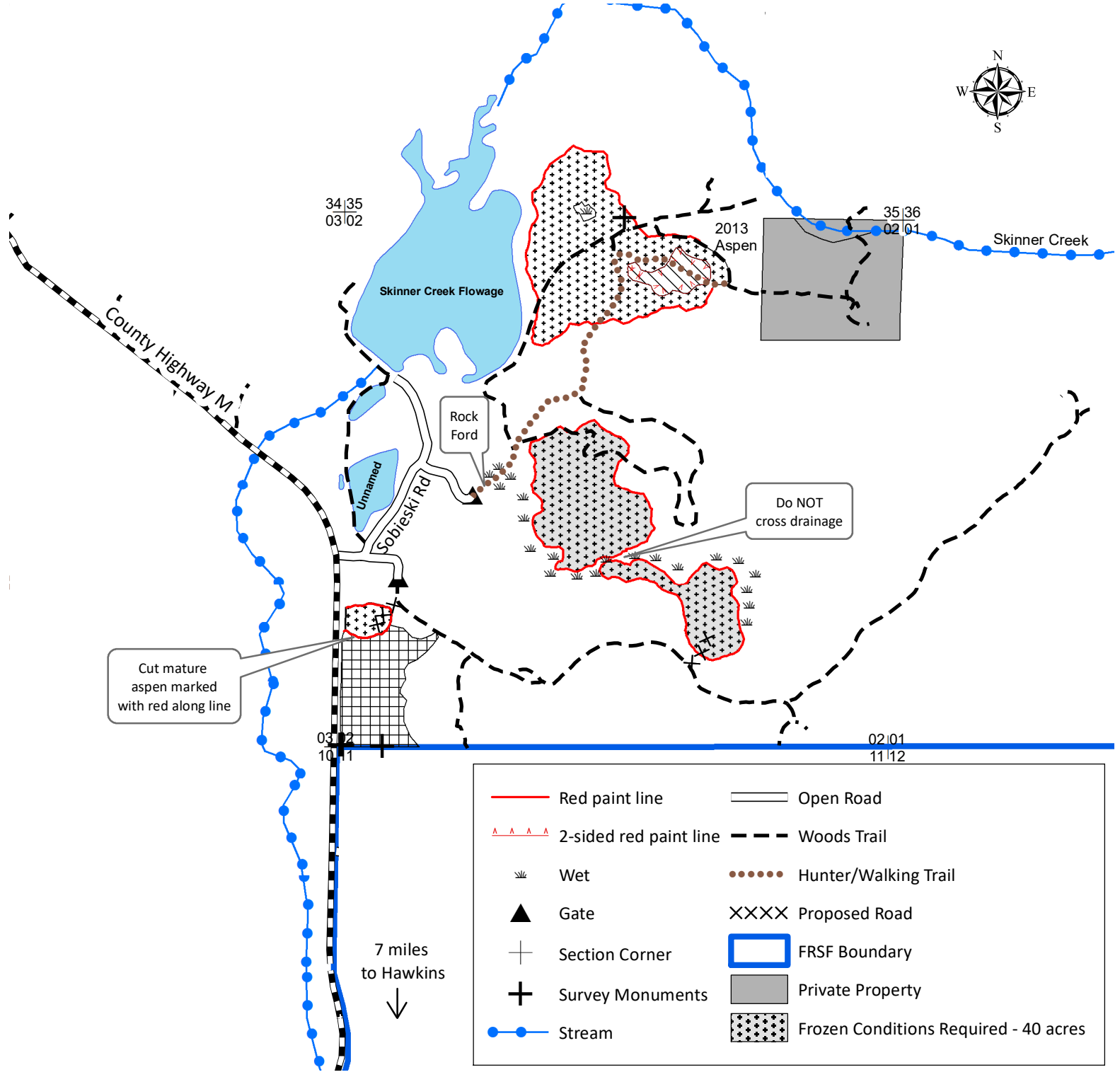

"This map is not a survey of the actual boundary of any property this map depicts"

Tract (6-19) Mostly Harmless

Parts of: SE ¼, SW ¼ NE ¼, SE ¼ of Section 30 T37N-R3W,
NE ¼ NE ¼ of Section 31 T37N-R3W

105 acres

<u>Species</u>	<u>Estimated Volume</u>
Mixed Pulp ¹	1940 cords
Aspen	840 cords
Fir ²	110 cords
Hard Maple	20 MBF
Red Maple	20 MBF
Ash	25 MBF
White Birch	15 MBF
Yellow Birch	10 MBF
Mixed Saw ³	1 MBF

Minimum Acceptable
Bid for Entire Sale
\$38,311

¹Mixed pulp includes 14% hard maple, 36% red maple, 21% ash, 7% yellow birch, 21% white birch, 1% ironwood, cherry, and basswood combined.

²Fir contains 90% fir and 10% spruce

³Mixed saw includes 1 MBF basswood and cherry combined.

Other species not mentioned will be charged at the mixed pulp or mixed saw price.

The performance bond will be 15% of the total sale value. Contract length is approximately three years.

SPECIAL SALE CONDITIONS:

Due to wet soils and access concerns, the majority of this sale will require very dry or frozen conditions only.

Use of a continuous rotating saw head will not be allowed in the single-tree selection or in the shelterwood areas due to density and distribution of regeneration.

If decking is done on Bear Creek Road, all slash and ends will be removed from the trail concurrently with each truckload.

Portions of this sale are in the Flambeau River Scenic Management Area, operations within this area shall be conducted during leaf off (October 15th – March 31st).

No cutting during the months of April, May, or June in selection and shelterwood harvests due to bark being easily damaged at these times.

Debris berms are required at locations designated on map.

No new access points will be permitted.

No harvesting or equipment will be allowed past red marked stream or wetland buffer lines. **No stream crossing is permitted.**

It's possible that the access road (hunter-walker trail) may be in use for another sale. It is the responsibility of the contractors to determine logistics for hauling and road maintenance/repairs

No cutting shall be done in the birch shelterwood until scarification is completed by forestry staff. Contractor needs to notify the DNR the August prior to harvesting. Cutting shall be completed within one year of scarification.

For sale inspection, call 715-332-5271 ext. 106 or ext. 107 for the combination of the lock for the gate. Please do not go around gate.

All additional restrictions listed in prospectus and standard contract apply unless specified.

Tract (06-19) Mostly Harmless

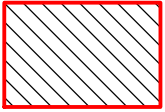

Selection Cut (35 acres): Bounded by red paint. Harvest all trees marked with orange slash mark, except for: 1) trees with an orange X, 2) snags, 3) cull trees. Harvest all merchantable ironwood.

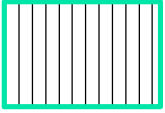

Birch Shelterwood (5 acres): Bounded by green paint. Harvest all merchantable trees except for: 1) trees ringed with green paint, 2) hemlock and white pine, 3) aspen. All unmerchantable stems, except for aspen, shall be severed.

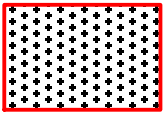

Aspen Coppice (67 acres): Bounded by red paint. Cut all trees greater than 1 inches, including trees with black paint, except for: 1) hemlock, 2) white pine, 3) spruce with 2 sticks or less, 4) oak.

19|20
30|29

20|21
29|28



Wet

Stream

Gate

Bear Creek Road

XXXXX Proposed Road

Woods Road

Hemlock Inclusion

Hunter Walker Trail

Scenic Area (60 ac)

Berm to be placed

+ Section Corner

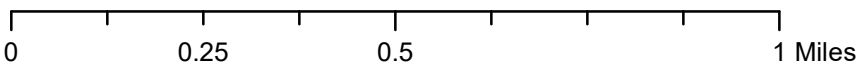
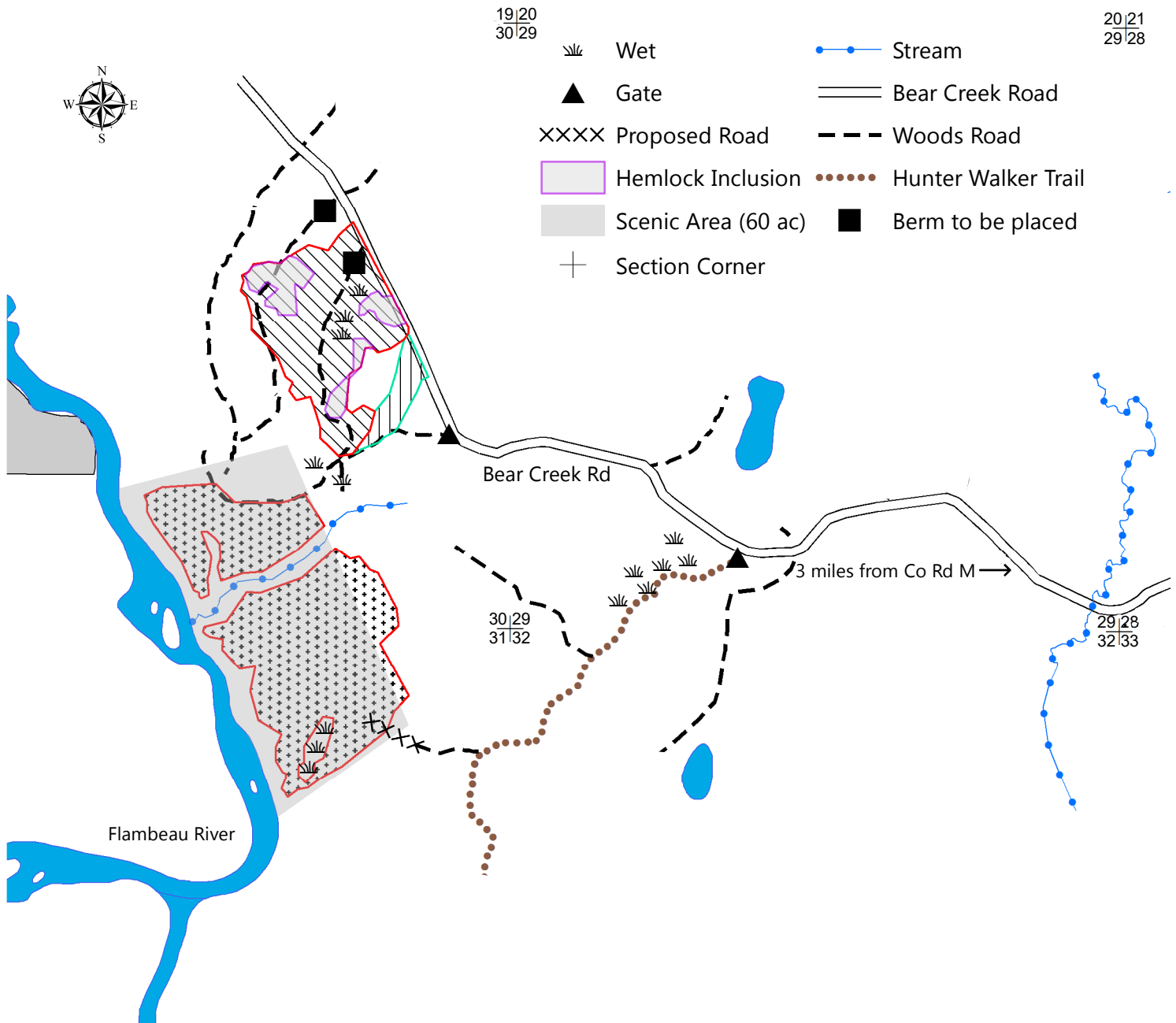

This map is not a survey of the actual boundary of any property this map depicts

Tract 02-20 (Fear the Deer)

Parts of: E1/2SE section 5; SWSW section 4; E1/2NE, NESE section 8; NWSW, SWNW section 9, in T38N-R3W, Sawyer County

137 Acres

<u>Species</u>	<u>Estimated Volume</u>	
¹ Mixed Pulp	1200 cords	
Basswood	110 cords	
Aspen	25 cords	Minimum Acceptable
² Fir	10 cords	<u>Bid for Entire Sale</u>
Hard Maple	21 MBF	\$14,966.00
Ash	27 MBF	
Basswood	22 MBF	
³ Mixed Saw	4 MBF	

¹Mixed pulp includes 61% hard maple, 19% ash, 11% red maple, 6% birch and 3% other hardwood species. Other hardwood species not mentioned will be charged at the mixed pulp price.

²All conifer species not listed will be charged under the fir price.

³Mixed saw includes 3 MBF red maple and 1 MBF white birch. All other hardwood species not listed will be charged the mixed saw price.

The performance bond will be 15% of the total sale value. Contract length is approximately three years.

SPECIAL SALE CONDITIONS:

Equipment use will be restricted to dry or frozen ground conditions.

Use of a continuous rotating saw head will not be allowed in the sale area due to density and distribution of regeneration.

No cutting during the months of April, May, or June in sale area due to bark being easily damaged at these times.

If decking on Long Creek Road/snowmobile trail or a hunter walking trail, all slash and ends will be removed from the roads and ditches concurrently with each truckload.

Upon sale completion, all landings and access points along Long Creek Road shall be re-ditched and returned to the condition prior to the sale.

Debris berms are required at new access locations.

3" of packed snow will be maintained on snowmobile trail, weather permitting.

Garlic mustard has been found on a trail leading to the sale area. This trail shall not be used prior to the garlic mustard on the road being treated by the DNR forestry staff. Contractor needs to notify the DNR prior to any operations. The affected section of road will be graveled by DNR forestry staff.

All additional restrictions listed in prospectus and standard contract apply unless specified.

For sale inspection, call 715-332-5271 ext. 106 or ext. 109 for the combination of the lock for the gate. Please do not go around gate.

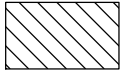

Selection Area (137 acres) – Bounded by red paint, Long Creek Road, and swamp. Harvest all orange marked trees within the designated boundaries. Sever all orange marked unmerchantable stems and all ironwood. Do not cut snags, cull trees or trees marked with an orange X.

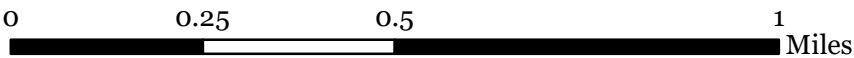
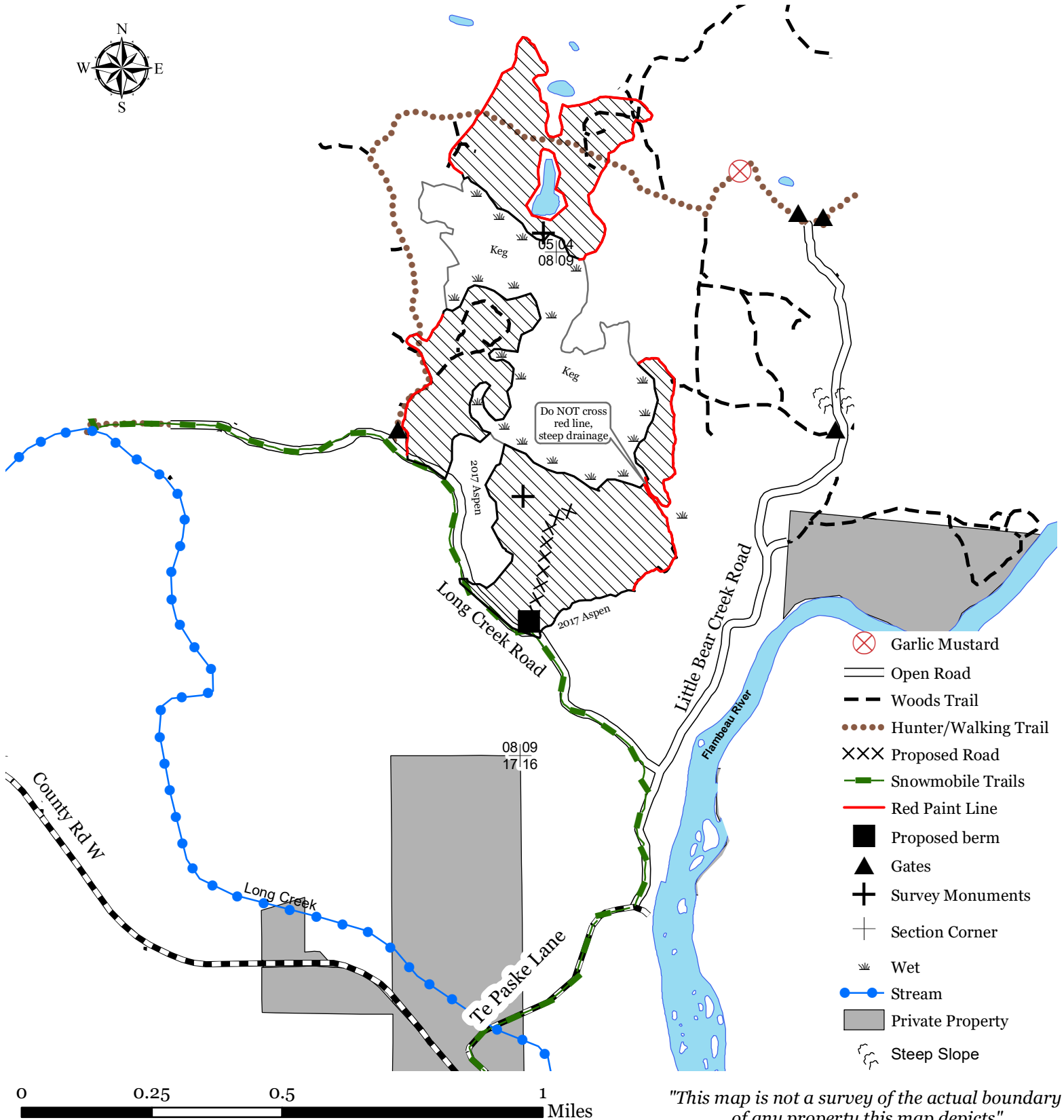

"This map is not a survey of the actual boundary of any property this map depicts"

Tract (05-20) Sour Skittles

Parts of: T38N R03W S21, T38N R03W E½ SE S20

147 acres

<u>Species</u>	<u>Estimated Volume</u>
² Mixed Pulp	900 cords
Basswood	50 cords
Aspen	300 cords
³ Fir	360 cords
Red Pine	800 cords
Ash	19 MBF
¹ Mixed Saw	13 MBF

Minimum Acceptable
Bid for Entire Sale
\$27,145.00

¹Mixed Saw contains 5 MBF hard maple, 2 MBF red maple, 3 MBF basswood, 1 MBF yellow birch, and 2 MBF white birch and ironwood combined.

²Mixed Pulp includes 30% hard maple, 30% red maple, 25% ash, 10% yellow birch, 5% white birch and ironwood combined.

³Fir contains 62% balsam fir, 19% black spruce, 14% tamarack, and 5% white spruce.

Other species not mentioned will be charged at the mixed pulp or mixed saw price.

The performance bond will be 15% of the total sale value. Contract length is approximately three years.

SPECIAL SALE CONDITIONS:

Equipment use will be restricted to dry or frozen ground conditions.

Use of a continuous rotating saw head will not be allowed in the selection area due to density and distribution of regeneration.

No cutting during the months of April, May, or June in selection harvests due to bark being easily damaged at these times.

If decking on Nedli Road or ATV/snowmobile trail, all slash and ends will be removed from the roads and ditches concurrently with each truckload.

Nedli Road is also an ATV/snowmobile trail. Public passage will be allowed. 3 inches of snow cover will be maintained on Nedli, weather permitting.

Ash salvage may require frozen ground.

All pine cut or piled between May 1st and August 1st shall be removed within 30 days due bark beetle concerns.

For sale inspection, call 715-332-5271 ext. 106 or ext. 107 for the combination of the lock for the gates. Please do not go around gates.

All additional restrictions listed in prospectus and standard contract apply unless specified.

Tract 05-20 (Sour Skittles)

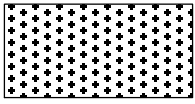

Coppice Area (18 acres)- Bounded by yellow paint, red paint, or wetland. Cut all trees greater than 2" **except for:** 1) hemlock, 2) white pine, 3) spruce, 4) oak, 5) tamarack. Leave all trees within 30' of all hemlock and cedar,

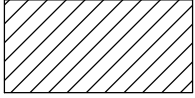

Plantation Thinning (57 acres)- Bounded by red paint. Harvest all trees marked with orange paint. Cut only **marked** aspen.

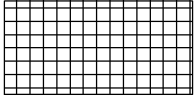

Ash Salvage (17 acres)- Bounded by yellow paint, young aspen, and wetland. Cut all trees greater than 2" **except for:** 1) oak, 2) all conifers.

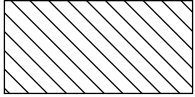

Selection Area (55 acres)- Bounded by red paint. Harvest all orange marked trees within the designated boundaries. Sever all orange marked unmerchantable stems. Harvest all merchantable ironwood.



- | | | |
|------------------|---------------|------------------|
| Wet Area | Blue Line | Stream |
| Drainage | Yellow Line | Private Property |
| Snowmobile Trail | Existing Berm | Nedli Road |
| Red Line | Gate | Woods Road |

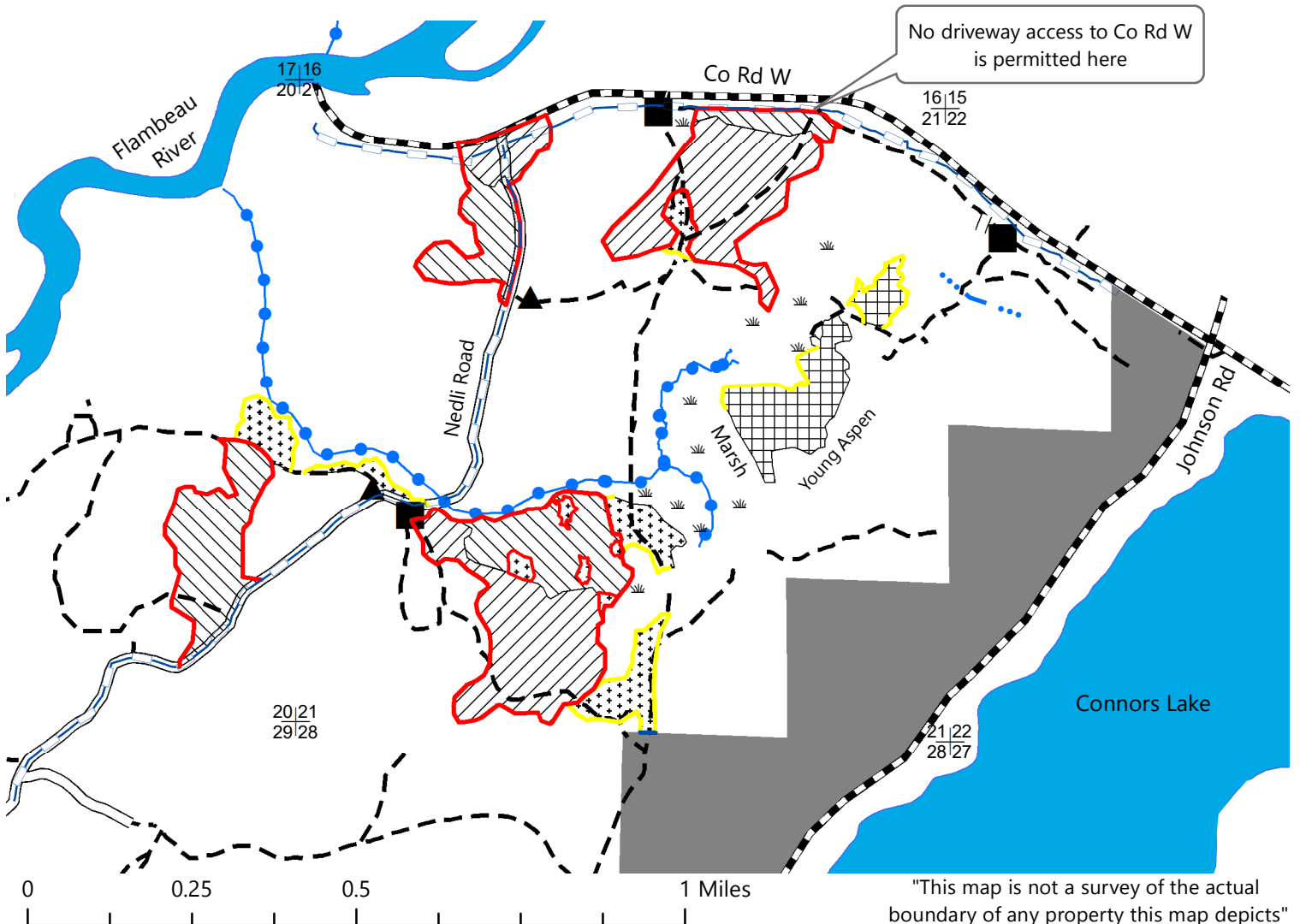

"This map is not a survey of the actual boundary of any property this map depicts"

Tract 8-20 (Tamarack Tract Redux)

Parts of: NESE, SENE, NENE Sec. 21; NWSW, SWNW, NWNW Sec. 22 T37N-R3W
Sawyer County

64 Acres

<u>Species</u>	<u>Estimated Volume</u>	
Mixed Pulp ¹	900 cds	Minimum Acceptable
Aspen	280 cds	<u>Bid for Entire Sale</u>
Spruce	150 cds	\$14,218.00
Tamarack ²	400 cds	

¹Mixed pulp includes approx. 54% red maple, 27% black ash, 7% yellow birch, 5% basswood, and 7% sugar maple/elm/white birch/ironwood. Mixed pulp volumes include 34 MBF red maple, 35 MBF black ash, 7 MBF yellow birch and 7 MBF basswood, white birch and sugar maple combined. ²Tamarack includes a small amount of balsam fir. Species not listed will be charged the mixed pulp price.

The performance bond will be 15% of the total sale value. Contract length is approximately three years.

SPECIAL SALE CONDITIONS:

Equipment use will be restricted to **frozen ground conditions only** due to wet soil conditions and wet road access.

Existing woods roads will be used. No new access points will be permitted.

New road construction is optional, and is limited to proposed road layout shown on prospectus map. Modifications can be made with approval of forester.

Decking will be done along woods roads within the sale area.

Contractor is required to close roads at the location designated on the map by placing logging debris, per sale prospectus.

All additional restrictions listed in prospectus and standard contract apply unless specified.

Tract 8-20 (Tamarack Tract Redux)

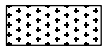

Red Maple/Aspen Coppice Area (44 acres) – Bounded by yellow paint. Cut all trees greater than 1” **except for:** 1) hemlock, 2) white pine, 3) oak, 4) cherry, 5) spruce with 2 sticks or less, and 6) balsam with 2 sticks or less. Leave all trees within 30’ of all hemlock.



Tamarack Strips (20 acres) – Bounded by red paint. Cut all trees (including orange marked trees) greater than 1” **except for:** 1) hemlock, 2) white pine, and 3) cedar. Leave all trees within 30’ of all hemlock and cedar.

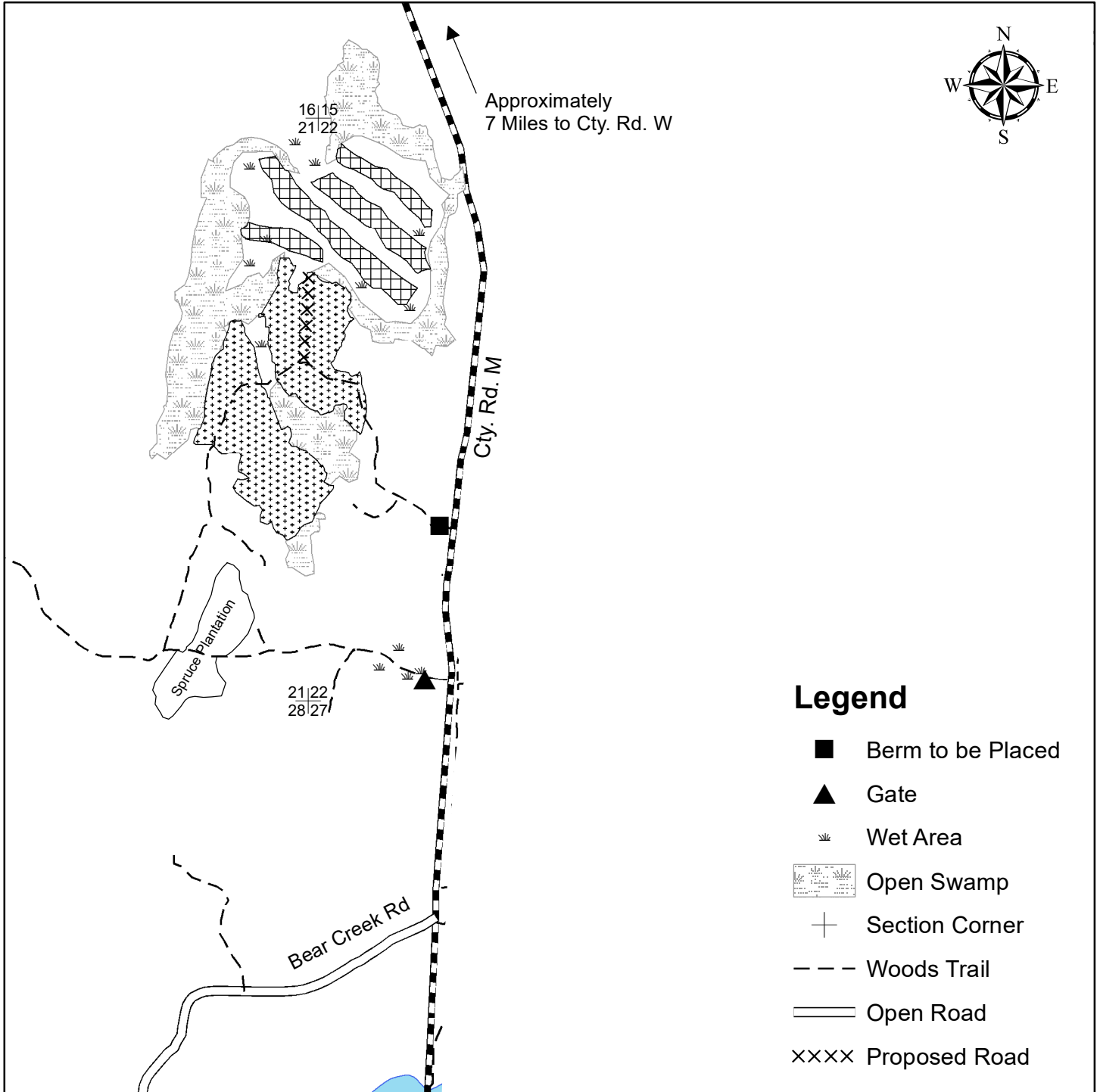

Legend

- Berm to be Placed
- ▲ Gate
- ☙ Wet Area
- Open Swamp
- ⊕ Section Corner
- Woods Trail
- Open Road
- ×××× Proposed Road

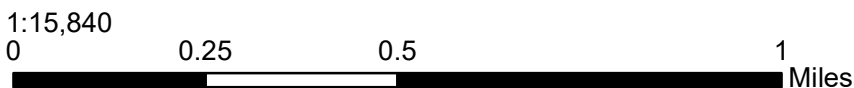

"This map is not a survey of the actual boundary of any property this map depicts"

Tract (9-20) Tall Tines

Parts of: NWSE, NESE, SENE, SESE, of section 10 T39N-R3W
NWSW, NESW, SWNW, SENW, of section 11 T39N-R3W.

75 Acres

<u>Species</u>	<u>Estimated Volume</u>	
¹ Mixed Hardwood	350 cords	Minimum Acceptable
Aspen	2100 cords	<u>Bid for Entire Sale</u>
Balsam Fir	190 cords	\$40,995.00

¹Mixed pulp includes 77% red maple, 11% hard maple, 8% yellow birch, 2% white birch, and 2% elm.
Other species not mentioned will be charged at the mixed pulp price.

The performance bond will be 15% of the total sale value. Contract length is approximately three years.

SPECIAL SALE CONDITIONS:

- Equipment use will be restricted to very dry or frozen ground conditions due to wet soil conditions
- Contractor will be required to close roads at the present berm location
- All slash must always be kept clear of travel ways, and out of wetlands and riparian areas
- All road maintenance and rehabilitation post-harvest is the purchaser's responsibility. Roads will be left in an equal or improved state post-harvest.
- Existing roads will be utilized for this harvest. New road construction is limited to proposed road layout shown on map. Modifications can be made with approval with forester
- No decking or parking of equipment will be allowed on Highway 70

All additional restrictions listed in prospectus and standard contract apply unless specified.

Tract (9-20) Tall Tines Sale

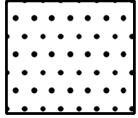

Coppice Area (75 acres) - Bounded by red paint. Harvest all trees greater than 2 inches except for: 1) hemlock 2) white pine 3) oak 4) spruce 5) cedar

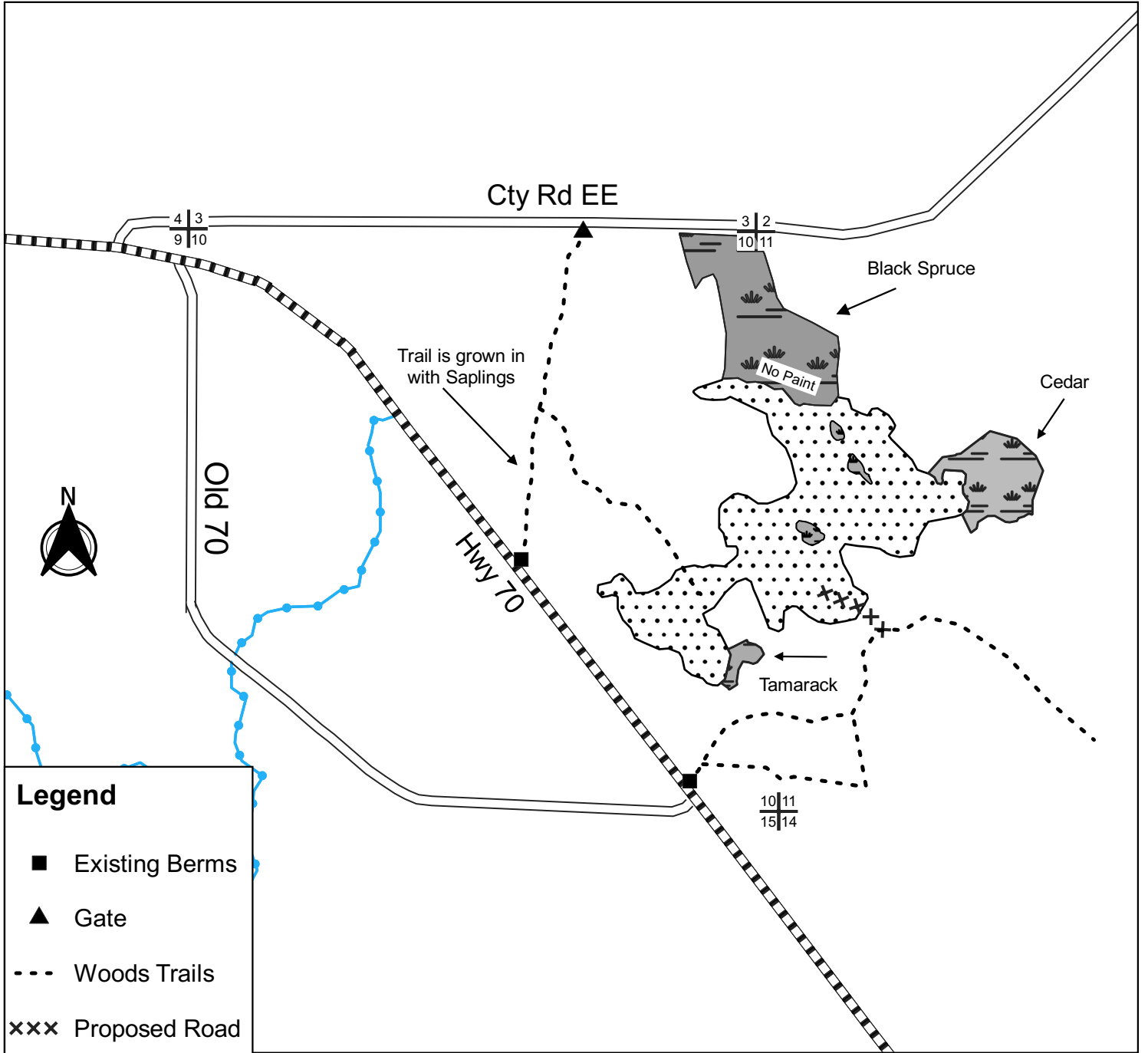

Legend

- Existing Berms
- ▲ Gate
- - - Woods Trails
- xxx Proposed Road
- + Section Corner
- Wet
- Stream

Scale = 1:15,840 Approx.
4" = 1 mile

This map is not a survey of the actual boundary of any property this map depicts.

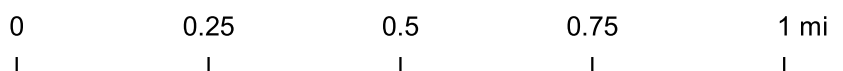

Tract 10-20 (Still Standing Woods)

Parts of: NE, SENW of Section 5, T37N – R3W, Sawyer County

117 Acres

<u>Species</u>	<u>Estimated Volume</u>	
¹ Mixed Pulp	1500 cords	
Basswood	80 cords	
Hard Maple	11 MBF	Minimum Acceptable
Red Maple	10 MBF	<u>Bid for Entire Sale</u>
Ash	30 MBF	\$14,599.00
² Mixed Saw	2 MBF	

¹Mixed pulp includes 43% hard maple, 27% red maple, 19% ash, 9% yellow birch, 1% white birch, 1% cherry aspen and elm combined.

²Mixed saw includes 1 MBF of basswood and less than 1 MBF yellow and white birch combined.

Other species not mentioned will be charged at the mixed saw or pulp price.

The performance bond will be 15% of the total sale value. Contract length is approximately three years.

SPECIAL SALE CONDITIONS:

Equipment use will be restricted to very dry or frozen ground conditions due to wet soil conditions.

Use of a continuous rotating saw head will not be allowed in the selection area due to density and distribution of regeneration.

No cutting during the months of April, May, or June in selection harvests due to bark being easily damaged at these times.

Damage done to the main gravel road is the responsibility of the contractor. Main gravel road needs to be left in the same condition as found or better.

Big Block Road could be used if accessing the west area of sale during very dry conditions if no garlic mustard is found.

Gate located near Cty Hwy M needs to remain closed during non-work hours.

All additional restrictions listed in prospectus and standard contract apply unless specified.

For sale inspection, call 715-332-5271 ext. 106 or ext. 109 for the combination of the lock for the gate. Please do not go around gate.

Tract 10-20 (Still Standing Woods)

1:15,840

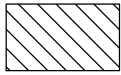

Selection Area (111 acres) – Bounded by red paint. Harvest all orange marked trees within the designated boundaries. Sever all orange marked unmerchantable stems and all ironwood. Do not cut snags, cull trees or trees marked with an orange X.

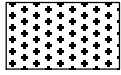

Red Maple Area (6 acres) – Bounded by yellow paint. Harvest all trees greater than 1” except 1) hemlock, 2) cedar, 3) white pine and 4) oak. LEAVE all trees within 30 feet of all hemlock or cedar.

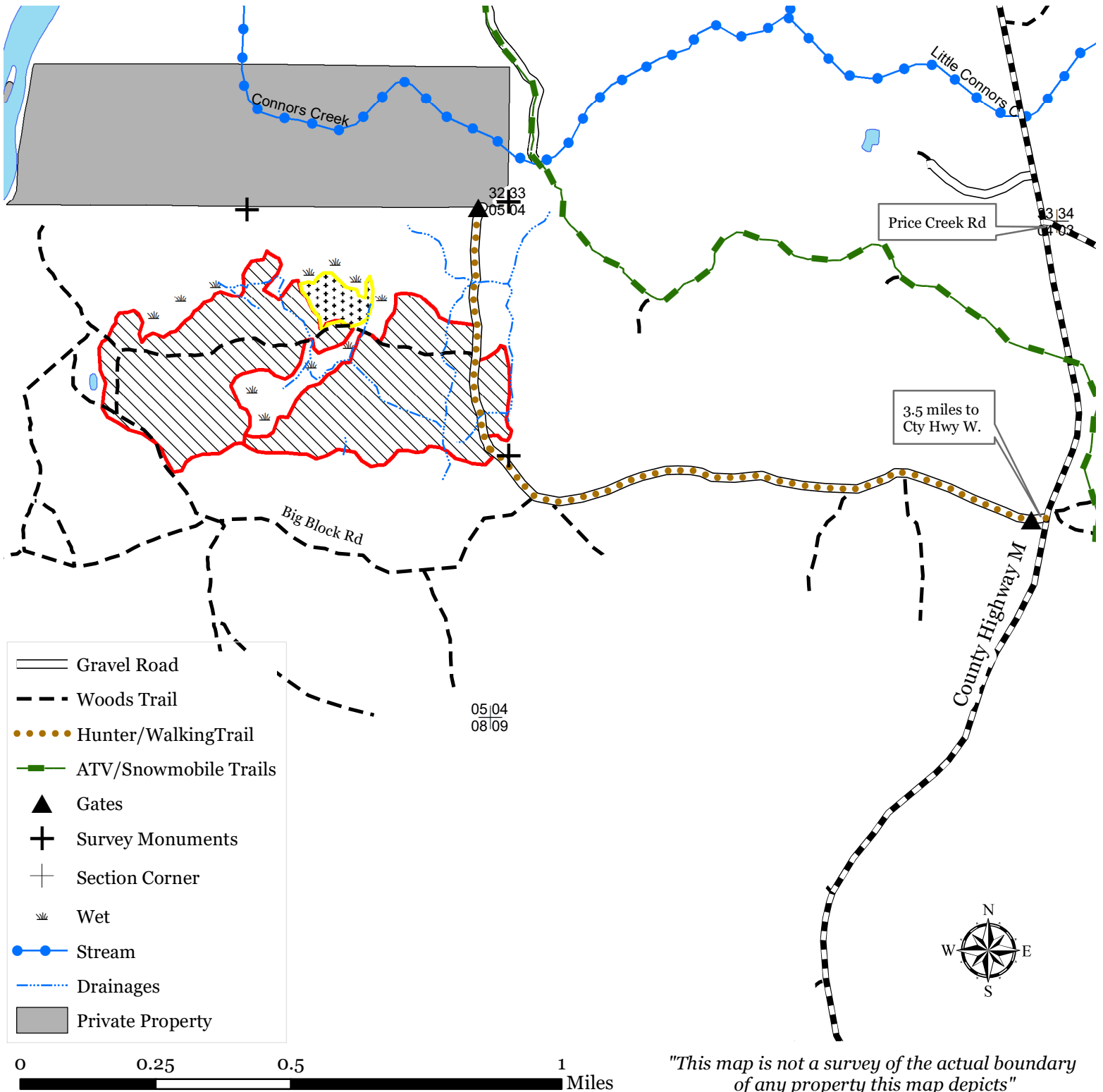

Tract 11-20 (Lone Oak 2)

Parts of: SWNW, N1/2SW, SWSW of Section 28, SENE of Section 29, T37N – R3W, Sawyer County

64 Acres

<u>Species</u>	<u>Estimated Volume</u>	
¹ Mixed Pulp	1000 cords	
Aspen	80 cords	
³ Spruce	20 cords	Minimum Acceptable
Hard Maple	9 MBF	<u>Bid for Entire Sale</u>
Red Maple	31 MBF	\$12,635.00
Ash	18 MBF	
² Mixed Saw	2 MBF	

¹Mixed pulp includes 27% hard maple, 46% red maple, 19% ash, 5% yellow birch, 2% white birch, 1% elm, cherry, and ironwood combined. A small amount of basswood is included in the mixed pulp. (about 1 cord)

²Mixed saw includes 1 MBF yellow birch and 1 MBF white birch.

³A small amount of fir is included in the spruce.

Other species not mentioned will be charged at the mixed pulp or saw price.

The performance bond will be 15% of the total sale value. Contract length is approximately three years.

SPECIAL SALE CONDITIONS:

Equipment use will be restricted to very dry or frozen ground conditions due to wet soil conditions.

Use of a continuous rotating saw head will not be allowed in the selection area due to density and distribution of regeneration.

No cutting during the months of April, May, or June in selection harvests due to bark being easily damaged at these times.

NO DECKING OR SKIDDING allowed on Bear Creek Road without permission from Forester.

Debris berms are required at locations designated on map.

No new roads will be permitted.

All slash within 100' of Bear Creek Road shall be lopped and scattered to within 2' of the ground.

Bear Creek Road is a snowmobile trail. 3" of packed snow will be maintained on snowmobile trail, weather permitting.

Contractor is required to close roads at the location designated on the map by placing logging debris, per sale prospectus.

All additional restrictions listed in prospectus and standard contract apply unless specified.

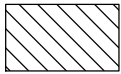

Selection Area (35 acres) – Bounded by red paint. Harvest all orange marked trees within the designated boundaries. Sever all orange marked unmerchantable stems and all ironwood. Do not cut snags, cull trees or trees marked with an orange X.

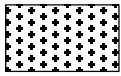

Coppice Area (26 acres) – Bounded by yellow paint or recent coppice areas. Harvest all trees greater than 1” except for 1) hemlock, 2) cedar, 3) white pine, 4) red pine and 5) oak. LEAVE all trees within 30 feet of any hemlock or cedar.

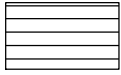

Strip Clear Cut (3 acres) – Bounded by yellow paint. Harvest all trees greater than 1” except for 1) hemlock, 2) cedar, 3) white pine, 4) oak and trees marked with GREEN paint. LEAVE all trees within 30 feet of any hemlock or cedar.

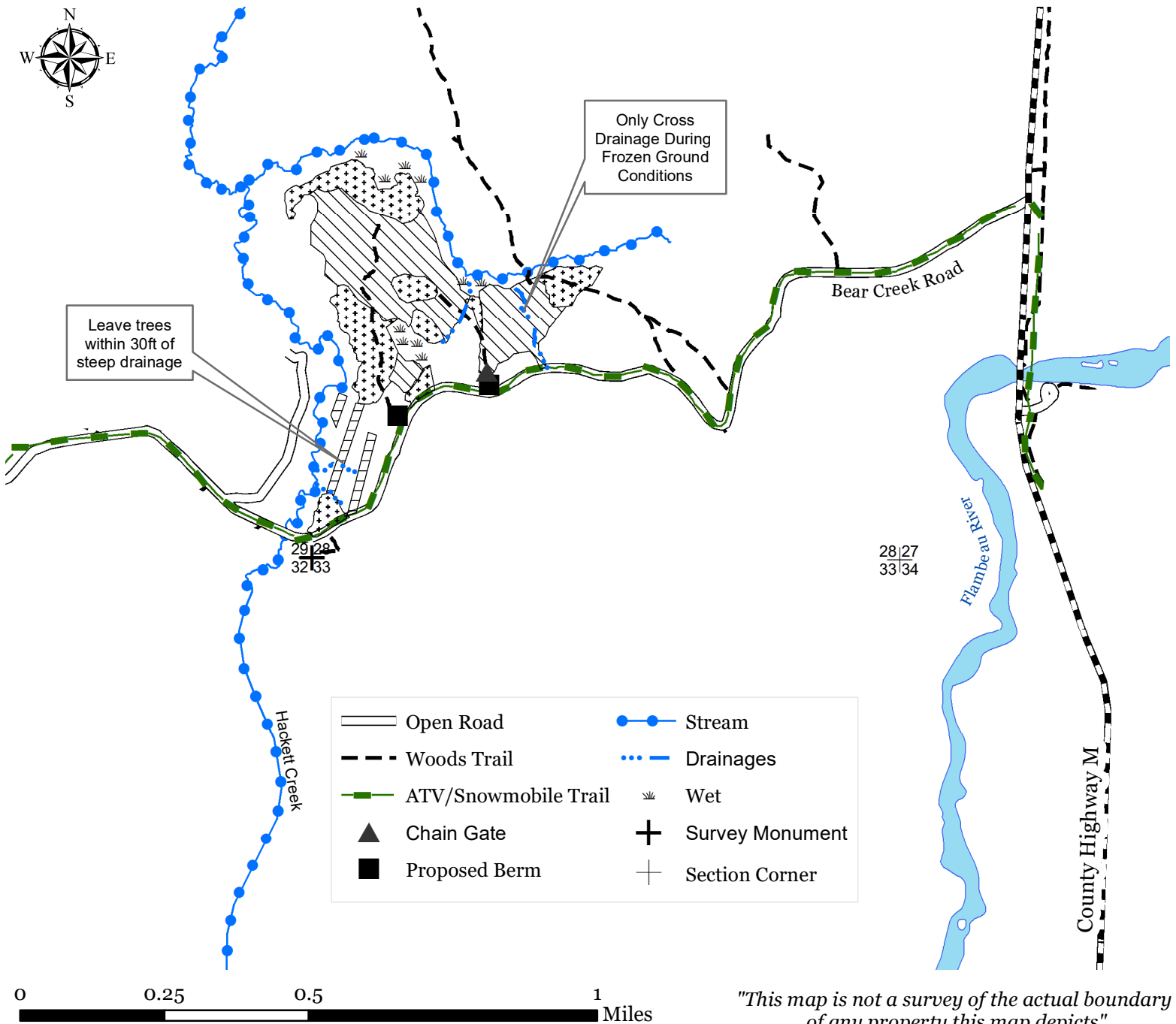

Leave trees within 30ft of steep drainage

Only Cross Drainage During Frozen Ground Conditions

- | | |
|----------------------|-----------------|
| Open Road | Stream |
| Woods Trail | Drainages |
| ATV/Snowmobile Trail | Wet |
| Chain Gate | Survey Monument |
| Proposed Berm | Section Corner |

0 0.25 0.5 1 Miles

"This map is not a survey of the actual boundary of any property this map depicts"

Hoofin' It
Tract # 1-20
State of Wisconsin
Rib River Fishery Area

Forester Contact Information:
 Jeff Sorenson
 200 Bauer Dr. Medford, WI 54451
jeff.sorenson@wisconsin.gov
 715-965-9228

Legal Description: NE ¼ Section 29 T32N R3E Taylor County, State of Wisconsin
 (see attached map for location and layout of harvest areas)

Estimated Volumes	44 acres		
To a 4 inch top	Product	Units	Volume
Mixed Hardwood ¹	Pulp	Tons	1000
Aspen	Pulp	Tons	110
Oak	Pulp	Tons	45
Fir	Pulp	Tons	25
Mixed Hardwood	Logs	MBF	55
Sugar Maple	Logs	MBF	9
Red Oak	Logs	MBF	4
¹ Mixed Hardwood pulp Volume is ~5% basswood			

Sale method: Scale (ticket system)
Contract length: Three years
Minimum advertised value: \$13,371.50

Cutting Specifications

Selection/Thinning/Shelterwood harvest - 40 acres, cut all orange marked trees plus all merchantable ash, aspen, ironwood, musclewood and balsam fir. Retain all other conifers.

Aspen Regeneration harvest - 4 acres, cut all stems >2" DBH except oak but harvest orange marked oak. Retain all conifers except balsam fir.

Operational Considerations-

- Timber operations must occur during dry, firm or frozen soil conditions. No harvesting between April 15th and July 15th of each calendar year per oak wilt guidelines. With various drainages and wet areas occurring in the northern hardwood area, summer chance logging would be unlikely but will still be offered. All other parts of sale are dry, firm and frozen ground only. DNR forester will determine operability.
- Road building – any road building has to have prior approval
- Access will be from Forest Drive for the southern unit will involve potential partial use of county snowmobile trail. The trail intersects a small portion in the far SW corner of the sale and is the main ingress/egress access from Forest Dr. Signage will be placed during active logging operations warning of active logging operations. Northern access will be at parking area just west of the river. Landing area will be needed to be expanded slightly to accommodate wood product piles.
- BMP requirements – no equipment allowed past red line.
- Slash shall be not be piled higher than 36" and evenly dispersed throughout sale area only.

State of Wisconsin
Rib River Fishery Area - Hoofin' It Timber Sale
Tract 1-20
Town of Rib Lake (South part) Taylor County
44 acres - NE 1/4 Section 29 T32N R3E



Legend

- ==== Trail
- Snowmobile Trail
- Blue Line
- Purple Line
- Red Line
- Roads
- Water
- Aspen Regeneration Harvest:
Cut all stems > 2" DBH except oak but harvest orange marked oak.
Retain all conifers except balsam fir. 4 acres
- Selection/thinning/shelterwood harvest: Cut all orange marked trees plus all merchantable ash, aspen, ironwood, musclewood and balsam fir. Retain all other conifers. 40 acres
- State Ownership

19,20
30 29

20 21
29 28

Forest Dr

River Rd

Tower Ave

Big Rib River

Estimated Volumes 44 acres			
To a 4 inch top	Product	Units	Volume
Mixed Hardwood ¹	Pulp	Tons	1000
Aspen	Pulp	Tons	110
Oak	Pulp	Tons	45
Fir	Pulp	Tons	25
Mixed Hardwood	Logs	MBF	55
Sugar Maple	Logs	MBF	9
Red Oak	Logs	MBF	4
¹ Mixed Hardwood pulp Volume is ~5% basswood			

This map is not an actual survey of any boundary this map depicts.

 Mapped by Jeff Sorenson



Tract (PKF 1-21) Blazed Aspen Sale

Parts of: N1/2NW, SENW, W1/2NE, NWSE, NESW of Section 27, T41N-R1E, Ashland County.

61 Acres

<u>Species</u>	<u>Estimated Volume</u>
¹ Mixed Pulp	2300 tons
Aspen	1125 tons
² Mixed Softwood	320 tons

Minimum Acceptable
Bid for Entire Sale
\$32,665.50

¹Mixed Pulp includes 20% hard maple, 63% red maple, 1% ash, 6% yellow birch, 7% white birch, and 3% cherry.

²Mixed Softwood includes 91% balsam fir and 9% spruce.

Other species not mentioned will be charged accordingly at the Mixed Pulp or Mixed Softwood price.

The performance bond will be 15% of the total sale value. Contract length is approximately three years.

SPECIAL SALE CONDITIONS:

Equipment use will be restricted to **very dry** conditions due to wet soil conditions. The intent is for this sale to be a summer harvest. Areas of low wet ground have been excluded from harvest area.

No harvesting activity in the shelterwood, selection, overstory removal area during the months of April, May, or June.

NO DECKING OR SKIDDING ALLOWED ON Hoffman Lake Road without written permission from the Town of Agenda.

If decking on town road or hunter/walking trail all slash and ends will be removed from the roads and ditches concurrently with each truckload.

The hunter/walking trail may be used for multiple sales, it is the responsibility of the contractors of sales to determine the logistics for hauling and/or road repair.

To make areas of sale operable during dry conditions, existing trails and new stub roads will most likely need pit run material. The state will provide the pit run material, but it will be the responsibility of the contractor for loading/hauling/leveling any pit run needed for decking on these existing roads and new stubs.

Upon sale completion, all landings and access points along Hoffman Lake Road shall be re-ditched and returned to the condition prior to the sale.

Logging debris berms or large boulders are required at locations designated on map.

No new access points will be permitted.

No wheeled or tracked harvesting equipment will be operated within low wet areas. Equipment must stay 15 to 50 feet from the edge of low wet areas.

Do not cut or **disturb aspen** in the Shelterwood area.

For sale inspection, call or email Maggie Lorenz (715) 492-1970 or margaret.lorenz@wisconsin.gov, for the combination of the lock for the gates. Please do not go around gate.

All additional restrictions listed in prospectus and standard contract apply unless specified.

Tract (PKF 1-21) Blazed Aspen Sale

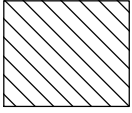

Selection Area (5 acres)- Bounded by red paint. Harvest all orange marked trees within the designated boundaries. Sever all orange marked unmerchantable stems (canopy gaps). Harvest all merchantable aspen, ironwood, and balsam fir.

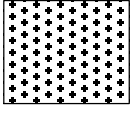

Aspen/Red Maple Area (47 acres)- Bounded by yellow paint, hunter walking trail, wet forested swamp, and grassy opening. Harvest all trees greater than 2" **except for:** 1) hemlock, 2) white pine, 3) cedar 4) oak, 5) tamarack, 6) white spruce.

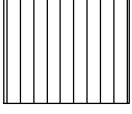

Shelterwood Area (4 acres)- Bounded by green paint, blue paint, and Hoffman Lake Road. Harvest all trees greater than 2" **except for:** 1) hemlock, 2) white pine, 3) all aspen, 4) green marked trees. All unmerchantable stems, except for aspen, shall be severed.

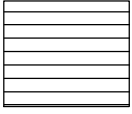

Overstory Removal Area (5 acres)- Bounded by red paint, blue paint, black ash drainage, and Hoffman Lake Road. Harvest all trees greater than 4" **except for:** 1) hemlock, 2) white pine, 3) cedar 4) oak, 5) tamarack, 6) spruce. Caution shall be taken to protect regeneration.

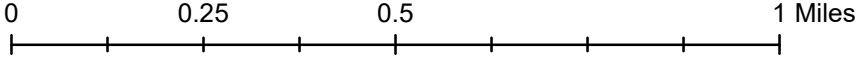

1 in = 0.25 miles

*This map is not a survey of the actual boundary of any property this map depicts.

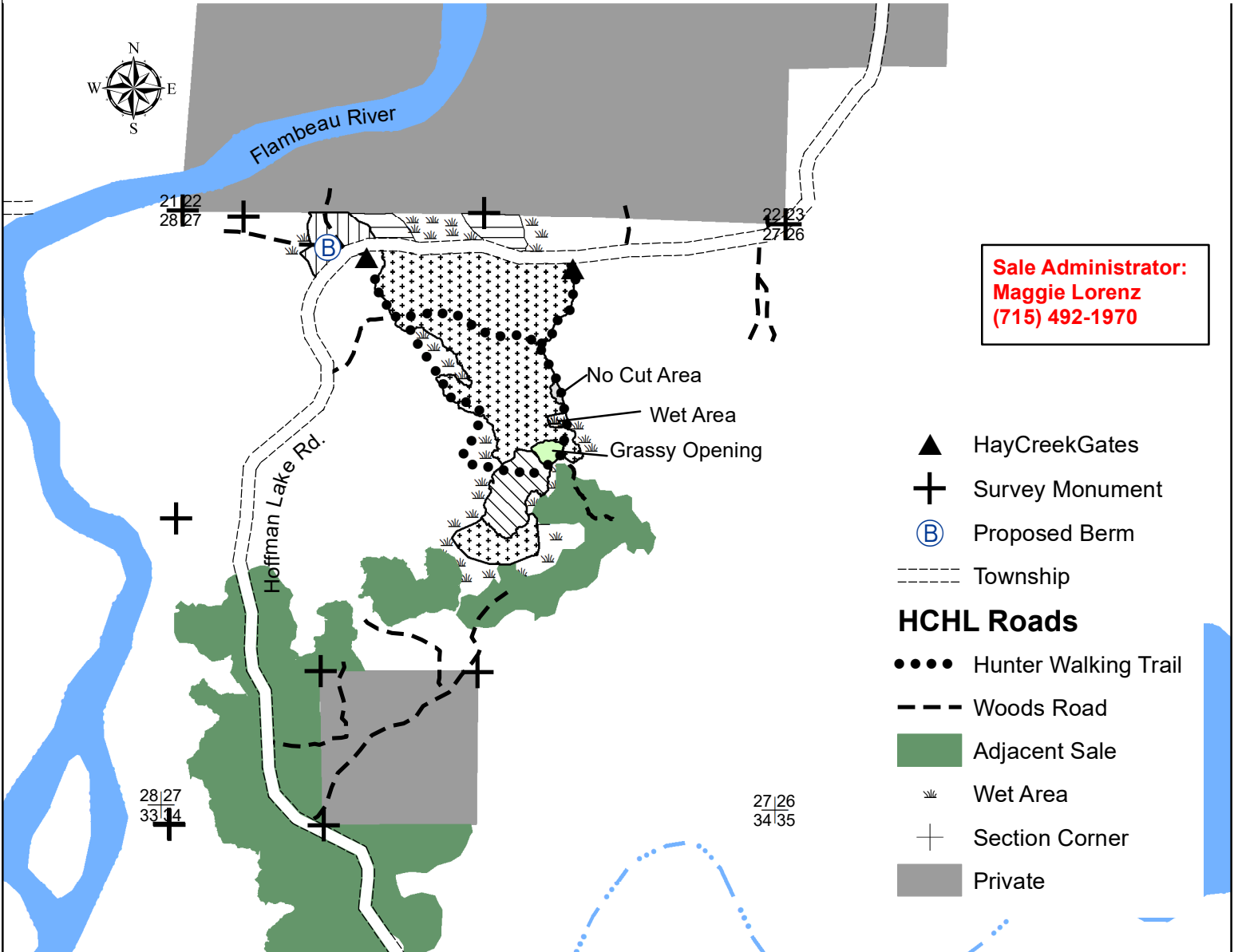

Sale Administrator:
Maggie Lorenz
(715) 492-1970

- ▲ HayCreekGates
- ⊕ Survey Monument
- Ⓟ Proposed Berm
- Township
- HCHL Roads**
- Hunter Walking Trail
- Woods Road
- Adjacent Sale
- ☼ Wet Area
- ⊕ Section Corner
- Private

Tract (PKF 2-21) White Birch Oasis Sale

Parts of: NW and NWSW of Section 36, E1/2NE, N1/2SE of Section 35, SESE of Section 26, SW of Section 25, T41N-R1E of Ashland County.

152 Acres

<u>Species</u>	<u>Estimated Volume</u>
¹ Mixed Pulp	2600 tons
² Birch	3600 tons
³ Mixed Softwoods	1000 tons
Aspen	2400 tons
⁴ Mixed Saw	93 MBF

Minimum Acceptable
Bid for Entire Sale
\$55,780.00

¹Mixed Pulp includes 22% hard maple, 76% red maple, and 2% ash.

²Birch volume includes 92% white birch and 8% yellow birch.

³Mixed Softwoods includes 71% balsam fir and 29% spruce.

⁴Mixed Saw is 85 MBF white birch, 1 MBF yellow birch, 3 MBF red maple, and 4 MBF hard maple

Other species not mentioned will be charged at the mixed pulp or mixed saw price accordingly.

The performance bond will be 15% of the total sale value. Contract length is approximately three years.

SPECIAL SALE CONDITIONS:

No harvesting during the months of April, May, or June due to special management considerations.

Access to the sale area will require temporary crossings using poles or timber mats to cross wetlands.

To make areas of sale operable during dry conditions, existing woods roads will most likely need pit run material. The state will provide a portion of pit run material, but it will be the responsibility of the contractor for loading/hauling/leveling any material needed for decking on the existing State-owned roads.

DNR will ensure access to timber sale, however, access across Forest Service property is the responsibility of the contractor.

Within the **White Birch Area**, 1 white or yellow birch tree shall be left approximately every 120 feet. These trees are being left as a seed source. These trees shall be greater than 8" DBH and shall have a healthy crown in the upper canopy. These trees are logger's choice.

For sale inspection, call 715-492-1970 for the combination of the lock for the gate. Please do not go around gate.

All additional restrictions listed in prospectus and standard contract apply unless specified.

Tract (PKF 2-21) White Birch Oasis Sale

 **Selection Area (15 acres)-** Bounded by red paint. Harvest all orange marked trees within the designated boundaries. Sever all orange marked unmerchantable stems (canopy gaps). Harvest all aspen, ironwood, and balsam fir.

 **White Birch Area (82 acres)-** Bounded by red paint, forested wetland, and swamp. Cut all trees greater than 2” except for: 1) hemlock, 2) white pine, 3) tamarack, 4) cedar , 5) green marked trees, 6) loggers choice of a leave, do not cut , 1 “Seed tree” white/yellow birch approximately every 120 feet.

 **Aspen Area (47 acres)-** Bounded by red paint, forested wetland, and swamp. Cut all trees greater than 2” except for: 1) hemlock, 2) white pine, 3) tamarack 4) cedar, 5) green marked trees.

 **Overstory Removal Area (8 acres)-** Bounded by young aspen. Harvest all trees greater than 4” except for: 1) basswood, 2) hemlock, 3) white pine. (Intent is to harvest overstory trees and save as much regeneration as possible.)

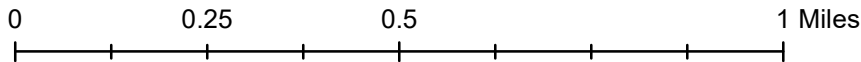

*This map is not a survey of the actual boundary of any property this map depicts.

 Leave Area/Tamarack

 Proposed Road

 Temporary Crossing

 Woods Road

 Red Paint Boundary

 Section Corner

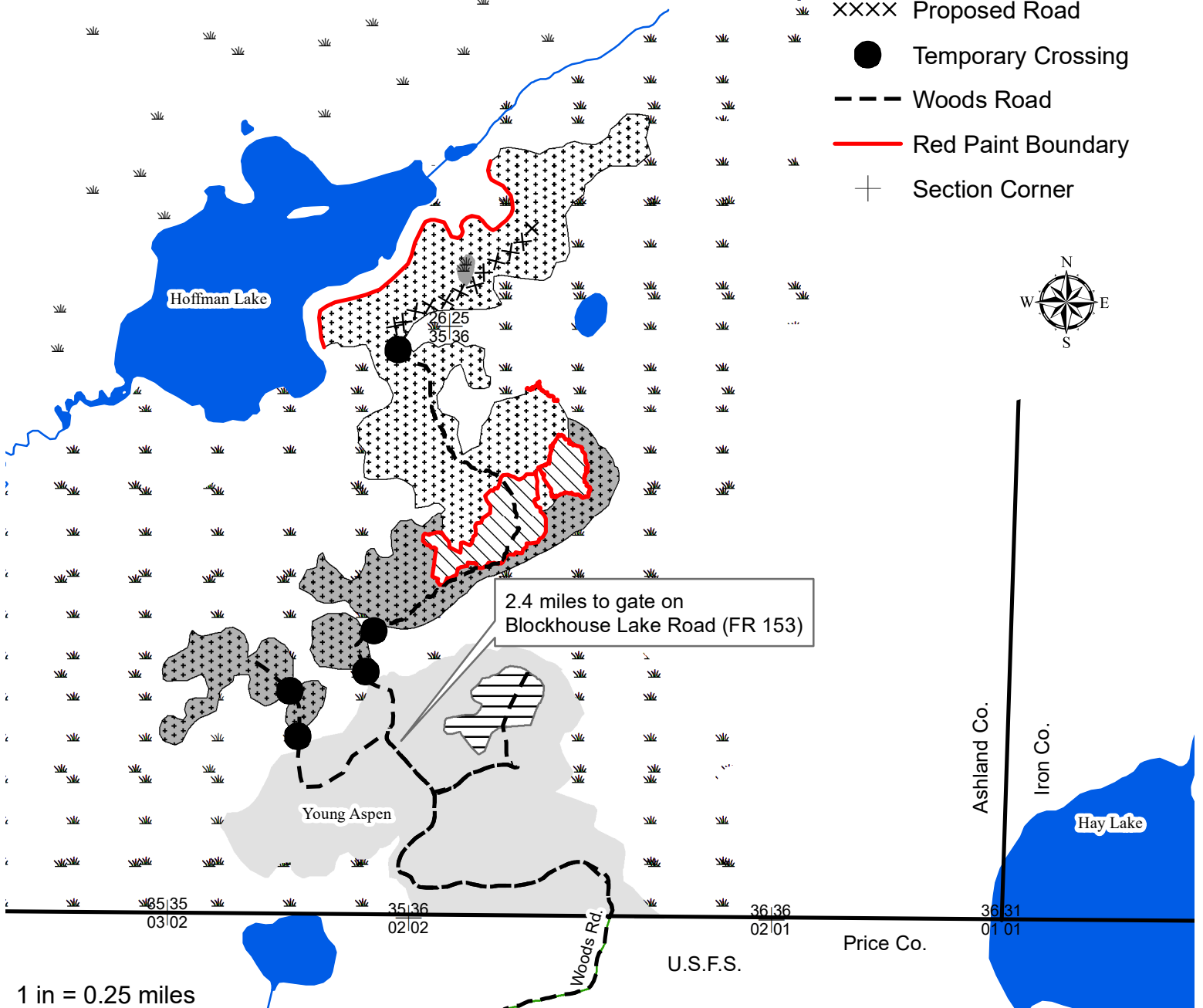

1 in = 0.25 miles