



American Dream Tract (12-18)

 **Selection Area (44 acres)**- Bounded by red paint. Harvest all orange marked trees within the designated boundaries. Sever all orange marked unmerchantable stems (canopy gaps). Harvest all merchantable ironwood.

 **Aspen/Red Maple Area (86 acres)**- Bounded by yellow paint and alder swamp. Cut all trees greater than 2" except for: 1) hemlock, 2) white pine, 3) cedar, 4) oak, 5) spruce.

 **Black Ash Area (5 acres)**- Bounded by yellow paint. Cut all merchantable ash. Leave all non-ash species.

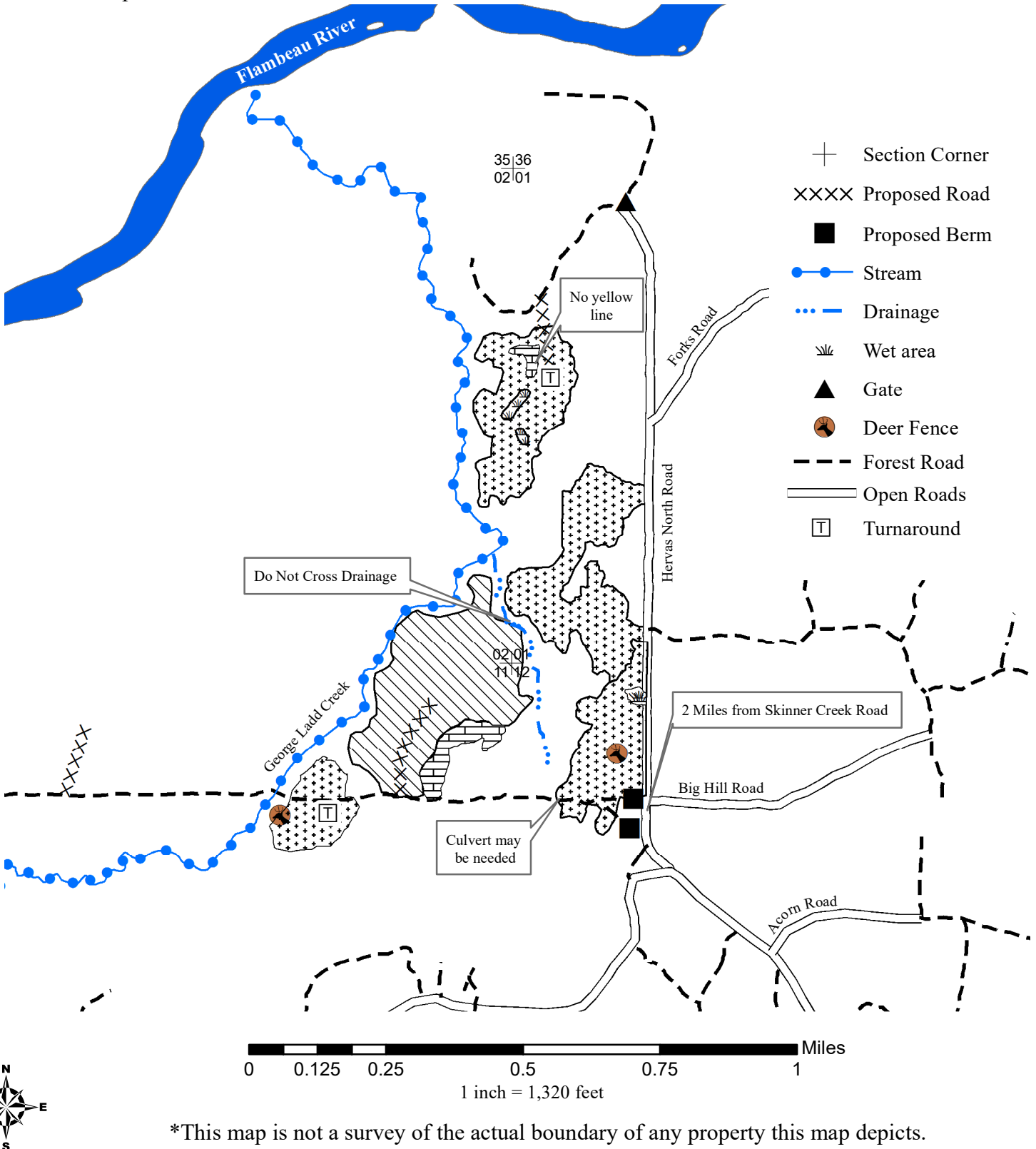

*This map is not a survey of the actual boundary of any property this map depicts.

Tract (12-18) American Dream Sale

Parts of: W1/2SW, and SWNW of Section 1; E1/2SE, and SENE of Section 2; N1/2NE of Section 11; W1/2NW of Section 12, in T36N-R4W, Rusk County.

135 Acres

<u>Species</u>	<u>Estimated Volume</u>	<u>Advertised Value/Unit</u>
¹ Mixed Pulp	1350 cords	15.50
² Ash	380 cords	9.80
Aspen	1090 cords	17.60
³ Fir	310 cords	6.50

Minimum Acceptable
Bid for Entire Sale
\$45,848.00

¹Mixed pulp includes 73% red maple, 17% yellow birch, 7% hard maple, 2% cherry, 1% elm and basswood combined. It also includes 8 MBF red maple, 3 MBF yellow birch, and 1 MBF of hard maple.

²Ash includes 7 MBF of saw.

³Fir includes 74% balsam fir, and 26% white spruce.

Other species not mentioned will be charged at the mixed pulp price.

The performance bond will be 15% of the total sale value. Contract length is approximately two years.

SPECIAL SALE CONDITIONS:

Equipment use will be restricted to very dry or frozen ground conditions only, and likely only frozen conditions due to wet soil conditions.

Use of a continuous rotating saw head will not be allowed in the single-tree selection area due to density and distribution of regeneration.

There are old deer fences located within the sale area. Use caution when working in these areas.

Any roads, landings, or primary skid trails used for the timber sale will be bermed at the close of the sale according to the guidelines in timber sale prospectus.

Decking will be allowed on Hervas North Road. All slash and ends will be removed from Hervas North Road and ditches concurrently with each truckload.

All additional restrictions listed in prospectus and standard contract apply unless specified.