

Flambeau River State Forest and other State Lands Sustainable Forestry Timber Sales

Includes sales from

Flambeau River State Forest – 8 sales

Hay Creek–Hoffman Lake Wildlife Area – 1 sale

Kimberly Clark Wildlife Area – 1 sale

Totagatic Wildlife Area – 1 sale

Lake Helene State Natural Area – 1 sale

Turtle Flambeau Flowage – 1 sale

October 17, 2019



Flambeau River State Forest Sale Locator Map

Legend
● Fall 2019 Timber Sales

Note: Sale Locator map does not include other state land sales

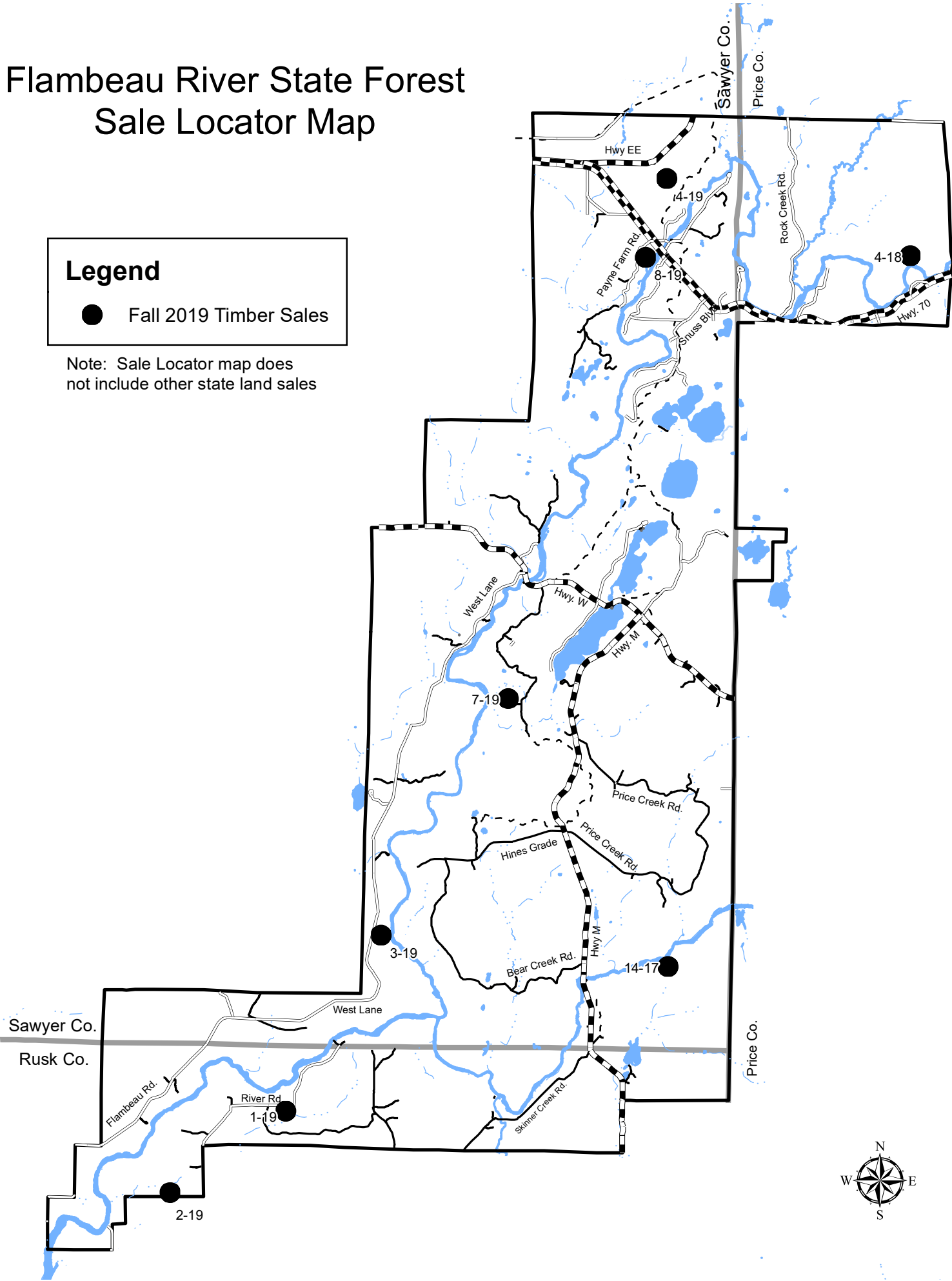

2019 OCTOBER TIMBER SALES
FLAMBEAU RIVER STATE FOREST & OTHER STATE LANDS
W1613 COUNTY ROAD W
WINTER, WI 54896
(715) 332-5271

Sealed bids for sales in this packet will be received by the Wisconsin Department of Natural Resources, Flambeau River State Forest, at the Flambeau Forest Headquarters, Winter, Wisconsin until **1:30 p.m. on October 17th, 2019** and publicly opened immediately thereafter for timber stumpage on the Flambeau River State Forest and other state lands. Sealed bids for the other state lands should also be received at the Flambeau Forest Headquarters. Sealed bids for sales not sold on October 17th will be received at the Flambeau Forest Headquarters until **1:30 p.m. on November 18th, 2019.**

“These lands are 3rd party certified.”

It is the responsibility of the bidder to inspect, evaluate the stumpage, examine the locations, investigate field conditions, and check Contract requirements for each tract prior to bidding. Submission of bid reflects that the bidder has inspected the tract and clearly understands and agrees to all Contract conditions and requirements. For inspection of Flambeau River State Forest timber sales for bidding, ATVs will be permitted. For sale inspection, call 715-332-5271 ext. 106 or ext. 112 for the combination lock on gates. Please do not go around gates.

Please review **Attachment A** for berming requirements and **Attachment B** for protection of road signs.

The sales on the Flambeau River State Forest will use the mill scale ticket system for pulpwood. Sales with saw logs included in the pulp price will also use the mill scale ticket system.

The contractor shall notify a DNR Forester or Forest Technician 3 days prior to beginning work on sale. Before work begins on sale, contractors will be required to have a pre-sale meeting with either a Forest Technician or a Forester.

NO DECKING OR SKIDDING ALLOWED ON Price Creek Road, Bear Creek Road, Hines Grade, Tower Hill Road, Skinner Creek Road, Hervas Road, Cedar Rapids Access Road, Wannigan Rapids Access Road, or Oxbo Access Roads without special permission.

The State may not plow snow on state forest roads. If a sale is located on a state forest road, the contractor may be responsible for plowing the snow. The following are state forest roads: Tower Hill, Bass Lake, Price Creek, Hines Grade, Bear Creek, Skinner Creek, and Hervas.

TRAINING REQUIREMENT

The purchaser shall ensure that the actual logging contractor engaged in performance of this contract complies with the Wisconsin SFI (Sustainable Forestry Initiative) Training Standard as adopted by the Wisconsin SFI Implementation Committee (SCI). Criteria for the standard can be found at the website www.fistausa.org/sfi_standards or by contacting the Forest Industry Safety & Training Alliance (FISTA). Purchaser agrees to provide documentation to Seller that the training has been attained prior to initiating sale.

SOIL DISTURBANCE AND RUTTING

- a. The Purchaser agrees to take all steps and precautions to avoid and minimize soil disturbances, such as soil compaction and rutting. If soil disturbances occur, the Purchaser agrees to work cooperatively to mitigate and repair any and all instances of soil disturbance.
- b. Excessive soil disturbance (as defined in Table 1) shall not be permitted. Purchaser agrees to contact Seller in the event of an excessive soil disturbance.

Table 1. Thresholds for soil disturbances.

| <u>Timber Sale Infrastructure</u> | <u>Soil disturbances are excessive if:</u> |
|---|---|
| <i>Roads, Landings, Skid Trails, and General Harvest Area</i> | <ul style="list-style-type: none">▪ A gully or rut is 6 inches deep or more and is resulting in channelized flow to a wetland, stream, or lake. |
| <i>Roads, Landings, and Primary Skid Trails</i> | <ul style="list-style-type: none">▪ In a riparian management zone (RMZ) or wetland, a gully or rut is 6 inches deep or more and 100 feet long or more.▪ In an upland area (outside of RMZ), a gully or rut is 10 inches deep or more and 66 feet long or more. |
| <i>Secondary Skid Trails and General Harvest Area</i> | <ul style="list-style-type: none">▪ A gully or rut is 6 inches deep or more and 100 feet long or more. |

Note: The depth is to be measured from the original soil surface to the bottom of the depression. If individual lug depressions are visible, the depth would be measured to the lesser of the two depths (the "top" of the lug). The length is measured from the start of the "too deep" section to the end of the "too deep" section. Measurements are not cumulative.

- c. Prior to sale completion the Purchaser shall mitigate and repair soil disturbances to the Seller's satisfaction.

For questions on the following properties please contact the person listed:

Flambeau River State Forest – Heidi Brunkow (715) 332-5271 ext. 106
Hay Creek – Hoffman Lake Wildlife Area – Maggie Lorenz (715) 492-1970
Kimberly Clark Wildlife Area – Tom Onchuck (715) 661-3728
Totagatic Wildlife Area – Jim Kujala (715) 558-9632
Lake Helane State Natural Area – Jim Kujala (715) 558-9632
Turtle Flambeau Flowage – Bryce Berklund (715) 416-4981

FLAMBEAU RIVER STATE FOREST

General Sale Conditions

Bidding and Financing

1. To bid on a tract, each species must be bid on (per cord or MBF) and the **minimum total sale value must be met.** The advertised value (per cord or MBF) is provided as a reference value only - a bid on each species at its advertised value will automatically meet the minimum total sale value when all species are added together. **A bid will be rejected if any individual species/product bid is \$0.**
2. A bid must be made on all species and products listed by tract including lump sum sales.
3. All bids must be by tract number and **sealed in individual envelopes** marked on the outside, Bid on Tract ____.
4. Whole tree (chipping) bids will be adjusted by adding overrun factors to cruised volumes. Notification prior to bidding will be required. Approved areas allowing whole tree logging will be identified along with specific overrun factors to be used. If for any reason the contract is not whole tree harvested, the contractor will pay 25% more than the bid value per species that anticipated whole tree harvest. Whole tree harvest (chipping) includes all wood and bark.
5. All bids will include the following:
 - A. Tract Number
 - B. List of species to be harvested and estimated volume
 - C. Bid price, per unit for each species and product
 - D. Signature and address of each bidder
6. Persons desiring to bid on more than one tract must submit a separate bid for each tract.
7. Bids will be opened in a random order from a draw of the hat. **Prior to the reading of a bid, a contractor may elect to withdraw the bid.** The contractor or representative of the contractor must declare this at the bid opening before any bids for the specified tract are read.
8. **BID BOND NOT REQUIRED.** Winning bidders will have 6 weeks from the date of the bid opening to submit an acceptable performance bond to the department. If the winning bidder fails to execute the contract and submit an acceptable performance bond, the bidder shall be required to forfeit to the department an amount equal to 10% of the total bid amount. Failure to forfeit the 10% penalty will result in the bidder being considered ineligible to bid on any state timber sales for a two-year period.
9. An Irrevocable Letter of Credit may be used as a Performance Bond. ***The expiration date of all letters of credit must be maintained for four full years.*** Contact the Forest Headquarters for details regarding the clauses required in the letter.

Contracts & Extensions

1. Contracts must be signed and returned to the Flambeau River State Forest or appropriate property within 30 days of the bid letting.
2. All contracts will be issued for a period of two years, unless otherwise noted. It is understood that all contracts are expected to be completed during the initial contract. Extensions are not automatic.
3. Requests for extensions must be submitted prior to the expiration date of the contract. The performance bond may be retained if requests are not submitted by the expiration date.

Payments

1. Purchaser agrees to make stumpage payments within 30 days of billing, unless otherwise specified in the payment schedule.
2. Late interest penalty – Purchaser agrees to pay a late interest penalty of 1.5% for every 30 days on past due stumpage in excess of the 30 day period. In addition, failure to pay within the 30 day period will result in the Purchaser having to prepay for the remainder of the sale. Two such payment breaches, even on separate State sales, will also result in the purchaser being required to prepay on all state timber sales for a two-year duration.

Cutting and Skidding Specifications

1. All timber marked or designated for cutting will be utilized whether or not the quantity is more or less than the estimated volume.
2. No pole length skidding will be allowed in select cut areas, pine thinnings, or spruce thinnings.
3. **No cutting can be done during the months of April, May, and June in selection harvests or pine thinnings**

due to bark being more easily damaged at these times, unless special permission is granted.

4. All decking must be done on the sale if it is not specifically designated.
5. Any young growth bent or held down by felled trees must be promptly released.
6. The Department of Natural Resources reserves the right to stop operations if unreasonable, excessive, or avoidable damage occurs or will occur. The contractor may be held responsible to repair any or all damage.
7. Although logging during very dry conditions may be permitted, during wet periods the soils may become soft and susceptible to rutting. Soils may become too wet after storms and extended wet spells. Operations will be suspended during these periods.
8. The Department of Natural Resources may change, suspend or terminate any timber sale contract or portion of contract with no penalties to the State if errors in timber sale planning or designing cause or may cause serious environmental damage, or may cause aesthetic concerns, or are not sound silvicultural practices, or violate any county, state, or federal law or regulation.
9. Any bole damage to residual trees will be considered unnecessary.
10. Trees that are marked with an "X" are not to be cut. They are leave trees. All snags will be reserved unless a safety concern, then the snags will be cut and left for coarse woody debris.
11. **Extra caution is needed to avoid damaging existing pockets of regeneration throughout select cut sale areas.** These pockets of regeneration should not have trees felled into them or skid trails run through them.
12. If collecting firewood for home, a firewood permit is required. **A permit is also required for collection of burls.**

Slash Requirements

1. All slash requirements will be done concurrent with sale operations. For town roads, state forest roads, hunter/walker trails, and ATV/snowmobile trails, **all slash and ends will be removed from the roads and ditches concurrently with each truckload.**
2. Slash that is within 100 feet of state highways, county highways, forest roads, open access roads, ATV/Snowmobile trails, canoe campsites and landings will be lopped and scattered to within 2 feet of the ground by the contractor.
3. No slash or logging debris will be left across the blue line onto private land.
4. No slash piles from landing operations may be left over 24" above the ground level. Piles shall be spread over the site before leaving.
5. Slash disposal will comply with the State Slash Law, Section 26.12(b), Wisconsin Statutes, and with requests regarding forest fires prevention and suppression made by the seller.

Road and Camps

1. The locations of all roads, landings, and camps must be approved by the Forester prior to construction. A DNR Forester must be contacted at least 48 hours in advance for an appointment.
2. The sale area, including all roads and camps, will be kept neat, clean and free of garbage, oil cans, plastic bottles, and miscellaneous trash throughout the contract period. All residues, including oils and fluids, generated may not be buried or burned, but must be removed from the sale area and disposed of properly.
3. Those merchantable trees removed or damaged as a result of approved road building operations will be utilized.
4. All road entrances must be cleaned up of all roots, stumps, and down trees at the time of construction.
5. **It will be the responsibility of the contractor to repair any road damage due to logging.**
6. **Contractor is required to close roads at designated map locations by placing rocks, stumps and/or cull log barriers. (See Attachment A).** Any road, landing, or primary skid trail used for a timber sale will need to be closed according to Attachment A.
7. **Do not damage or remove trail/roadway signage. (See Attachment B).**
8. Road approaches to surfaced roads or other government public roads are the responsibility of the Contractor. Damage to these roads is the responsibility of the Contractor.
9. **The State may not plow snow on state forest roads.** If a sale is located on a state forest road, the contractor may be responsible for plowing the snow. The following are state forest roads: Tower Hill, Bass Lake, Price Creek, Hines Grade, Bear Creek, Skinner Creek, and Hervas.

Seasonal Restrictions

1. **No cutting can be done during the months of April, May, and June in selection harvests or pine thinnings** due to bark being more easily damaged at these times, unless special permission is granted.
2. Any wood located within 400' of the Flambeau River shall be removed prior to April 1st of each contract year.
3. The State reserves the right to place additional seasonal restrictions on sales as necessary.

Hauling Restrictions

1. It is the responsibility of the Contractor, to obtain permission from the appropriate Township to deck wood along a town road.
2. All road bans and weight restrictions are the responsibility of the Contractor. State forest roads may be posted for longer periods of time than county and township roads.
3. The purchaser will be required to restrict or suspend hauling during periods when the compacted road surface would be damaged. Hauling will be suspended if it is causing rutting into the subgrade, or surfacing material would be displaced, such as during heavy rainfall or spring break-up freezing and thawing cycles.

General Conditions

1. All provisions in the contract shall be met before the contract expires. Performance under the contract must proceed in an efficient, workman-like manner, conducive to the orderly completion of the sale. Extensions will only be considered under unusual hardship of circumstances. Details of extension conditions, damage assessments, and other provisions are addressed in the contract which is on file at the Forest Headquarters.
2. Permanent survey monuments shall be left undisturbed. Forest personnel shall be notified if one is encountered during timber sale operations.
3. Extreme caution must be used in sale operations to prevent wildfire. There are requirements outlined in the contract for fire extinguishers and spark arrestors.
4. No skidding, landing, or piling of wood products will take place on the ATV/Snowmobile trail or the State Forest roads without special permission. The following are State Forest roads: Tower Hill, Bass Lake, Price Creek, Hines Grade, Bear Creek, Skinner Creek, and Hervas.
5. If a snowmobile trail is used for a timber sale operation, 3" of packed snow will be maintained on the snowmobile trail, weather permitting.

Utilization Specifications

Those sales without an increased utilization option will have the following standards:

Standard Utilization - Unless otherwise specified, standard specifications will be as follows:

| | |
|-------------------|------------------------------|
| Aspen pulpwood | 4" top diameter |
| Hardwood pulpwood | 4" top diameter |
| Softwood pulpwood | 4" top diameter |
| Hardwood sawlogs | 10" top diameter inside bark |
| Softwood sawlogs | 8" top diameter, inside bark |

Merchantable trees are those that have one or more 100 inch pulpwood sticks with a minimum top diameter of four inches.

Scaling Specification

1. All bid species of sawlogs will be scaled as such. Pulpwood products cut longer than 8' may be scaled by the board feet and converted to cords as follows: Softwood - 2.44 cds./MBF and Hardwood - 2.20 cds./MBF.
2. All logs will be scaled with the Scribner Decimal C log rule. All logs will be scaled as sawlogs if 50% sound and meet the requirements of a Grade No. 3 log or better in accordance with the National Forest Scaling Handbook. The minimum diameter for a Grade No. 3 log is 10". The maximum trim allowance is 5" unless contractor can demonstrate that market specifications dictate more trim (ties, veneer, etc.). Logs with excessive trim will be scaled at the next highest foot length.
3. Logs will be decked for scaling on pulpwood stringers with the small ends all one way (towards the road) and separated by log length. Decks will not exceed six feet in height and will be accessible for inspection from both sides of the deck. If separating for bolts, the bolts will be decked with the small ends all one way (towards the road).
4. When sap-peeled pulpwood is scaled, 12.5% will be added to hand peeled and stroke delimber/processor peeled volume, and 16% will be added to ring debarked volume. **Scale ticket must state if the load is a**

peeled product.

5. The mill scale ticket system will be required for pulp. Contractor is required to deposit a scale ticket in the lock box placed on the sale. These tickets are provided by the State Forest and will be filled out in their entirety. The Contractor is also required to deliver a mill ticket to the mill purchasing the forest product. This mill ticket will be returned to the Flambeau River State Forest along with a copy of the mill's scale. The Contractor is responsible for having these mill tickets and scale slips returned to the Flambeau River State Forest in a timely manner. The mill scale slip that corresponds to the lock box ticket must be received at the Flambeau River State Forest Office within 14 days of hauling.
6. If wood is to be yarded at another location other than the sale area, permission must be granted by Forester.
7. Contractors that are required to prepay must at a minimum purchase 5 or more scale tickets at a time, but it is encouraged that a full booklet of 25 scale tickets be purchased.
8. A mill scale ticket must also be placed in the ticket box for loads of scaled logs.

Cordwood Weight Conversion Factors

If a cordwood weight conversion is not provided by the mill purchasing the forest product, the following weight conversion factors will be used in the conversion of weight scale to standard 4' x 4' x 100" cords. Seasoned wood is normally understood to be that which was cut and dried two or more months between April 1 and October 31 before weighing. All other wood should be considered green.

CORDWOOD WEIGHT CONVERSION FACTORS
POUNDS PER CORD

| Species | Weight | Species | Weight |
|------------|--------|-----------------------|-------------|
| Hemlock | 4800 | Yellow Birch | 5350 |
| Tamarack | 4650 | Hard Maple | 5100 |
| Red Pine | 4500 | Elm | 5000 |
| Jack Pine | 4250 | Balsam Poplar | 4900 |
| Balsam | 4250 | White Birch | 4800 |
| White Pine | 4200 | Ash | 4600 |
| Spruce | 4000 | Soft Maple | 4550 |
| White Oak | 5850 | Aspen | 4500 |
| Red Oak | 5500 | Basswood | 3850 |
| Hickory | 5400 | Mixed Hardwood | 4800 |

Worker's Compensation Law

The contractor (purchaser) shall provide the Department with a Certificate of Insurance indicating that Worker's Compensation Insurance coverage is provided for all of the contractor's (purchaser's) employees working under the contract during its duration. This shall be in the Department's file prior to any performance under the contract. Such certificates of insurance shall further include the condition that the insurer shall notify the Department at the Flambeau River State Forest Headquarters within five (5) days of any change in its terms or twenty (20) days prior to termination.

The Special Sale Conditions listed for each individual tract and the General Sale Conditions are additions to, or condensations, of a standard timber sale contract that the successful bidder must sign. A sample contract, additional information, maps for each sale, and bid forms may be obtained from the Forest Superintendent, Flambeau River State Forest, W1613, Co. Rd. W, Winter, Wisconsin 54896.

The Department of Natural Resources reserves the right to reject any or all bids.

Attachment A

Contractor Sale Closure Requirements

Gated Roads

For sales that occurred behind a locked gate, and harvesting occurred around the gate area, contractors are required to do one of the following:

1. Block the sides of the gates with rocks or stumps with root-balls.
 - a. Rocks must be between 3-4' in diameter
 - b. Stumps must be a minimum of 3' high.
 - c. No greater than 24" spacing between rocks or root-balls.
 - d. A 30" clearance should be left immediately adjacent to one gate post for foot traffic.
 - e. Barrier will extend from each side of the gate until vehicle traffic is not possible around the gate.

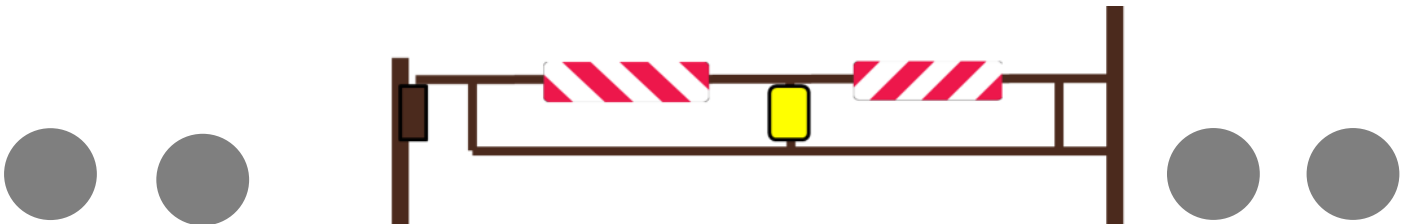

2. Block the sides of gates with a debris berm.
 - a. Berm should be a minimum of 4' high.
 - b. Shall consist of dirt, rocks, logs, and other dense/non-compressible materials.
 - c. A 30" clearance should be left immediately adjacent to one gate post for foot traffic.
 - d. Barrier will extend from each side of the gate until vehicle traffic is not possible around the gate.

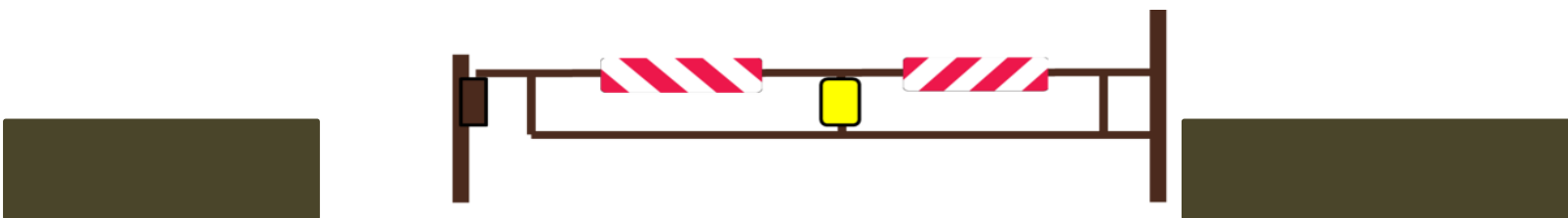

Pushed in Roads

For sales that have roads pushed in **NOT** behind a gate, the contractor shall close the road in the following manner.

All roads, landings, & Primary Skid trails will need to be closed off that come out to an open road or motorized trail. The number of roads needed for a sale should be as minimal as possible & all skid trails should go to the sale road, not open public roads or motorized trails.

Options & Requirements:

Rock or Stump with Root-ball barrier

1. Utilize Rocks 3-4' in diameter or a minimum of 3' high root-balls placed not more than 24" apart from each other.
2. Rocks or Root-balls will be placed in two alternating rows that extend across the width of the Road/landing/skid trail until a point in which vehicle traffic is not possible around the berm due to vegetation, terrain, stumps, etc. (**NOTE: A dual row design is only needed for primary sale roads. Landings & Skid trails only need one row**).
3. For main sale roads, the berm will be placed 15' from the roadway edge, allowing enough room for a vehicle to park. On landings and skid trails, the berm shall be immediately adjacent to the ditch line.

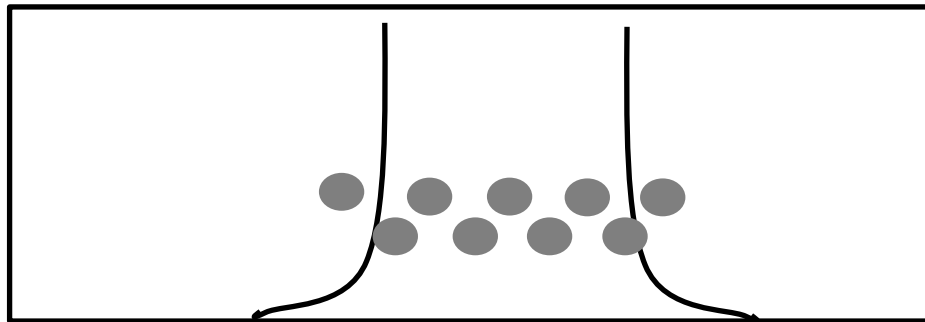

Debris Berms: alternatively, a debris berm may be used. The debris berm should be made of non-compressible materials such as logs, root balls, rocks, and dirt. The same requirements above apply, except that only one row needs to be placed and at a 4' height, extending the entire width of the roadway and beyond the edge to prevent traffic.

***Earthen Berms shall not be used**

****When pulling out from a sale for an extended period of time, the contractor shall lay a tree or other object across the sale road to prevent vehicle entry.**

Attachment B

LOGGING OPERATIONS AND TRAIL/ROADWAY SIGNAGE

Contractors must take care when working on trails and roadways in order to prevent damage to regulatory signage, and to provide for the safety of other users. There are legal implications of removing regulatory signage, especially if it results in injury as a result of it missing. Guidance:

1. Contractors should avoid piling logs against signs. This damages the signs and makes them unreadable to users. Contractors should also avoid pulling signs without first notifying the department.
2. Contractors **shall not** pile logs within 25' of roadway or trail stop signs, or stop ahead signs. Stop signs and stop ahead signs **must never be removed. If it is necessary to remove one of these signs, the contractor must notify the department first before doing so, so that it can be properly re-positioned.** This poses a significant safety hazard to trail/road users- and can leave the contractor with legal responsibility.
3. Contractors **shall not**, under any circumstances, remove, or stack wood against or within 25' of a department open road street sign. These signs designate open roads within the forest and also have stop signs and regulatory signage attached.

23.33(8)(f)1.

1. No person may intentionally remove, damage, deface, move, obstruct, or interfere with the effective operation of any uniform all-terrain vehicle route or trail sign or standard or any uniform sign or standard for the operation of a utility terrain vehicle on an all-terrain vehicle route or trail if the sign or standard is legally placed by the state, any municipality or any authorized individual.

Tract (14-17) Rivers Edge

Parts of: NENE, S1/2NE, SE of Section 26; W1/2NW, W1/2SW, SESW of Section 25;
N1/2NE of Section 35; NWNW of Section 36; in T37N-R3W, Sawyer County

Acres 166

| <u>Species</u> | <u>Estimated Volume</u> | <u>Advertised Value/Unit</u> |
|-------------------------|-----------------------------|----------------------------------|
| ¹ Mixed Pulp | 2600 cords | 18.30 |
| Basswood | 90 cords | 3.30 |
| Ash | 400 cords | 9.10 |
| Aspen | 1540 cords | 18.10 |
| Spruce | 70 cords | 12.10 |
| ² Tamarack | 90 cords | 5.00 |
| Hard Maple | 10 MBF | 204.00 |
| Red Maple | 10 MBF | 80.00 |
| Ash | 29 MBF | 91.00 |
| ³ Mixed Saw | 1 MBF | 74.00 |

Minimum Acceptable

Bid for Entire Sale

\$86,241.00

¹Mixed pulp includes 70% red maple, 20% hard maple, 6% yellow birch, 2% white birch, 2% ironwood and black cherry combined.

²Tamarack includes approx. 30% balsam fir.

³Mixed saw includes .5 MBF basswood.

Other species not mentioned will be charged at the mixed pulp price or mixed saw price accordingly.

The performance bond will be 15% of the total sale value. Contract length is approximately two years.

SPECIAL SALE CONDITIONS:

Equipment use will be restricted to very dry or frozen ground conditions due to wet soil conditions. No rutting allowed.

Portions of this sale are in the Flambeau River Scenic Management Area, operations within this area shall be conducted during leaf off (October 15th – March 31st).

Landings are required at approximate locations designated on map.

No decking or parking of equipment will be allowed in powerline Right-of-Way. The Right-of-Way is tree line to tree line.

All additional restrictions listed in prospectus and standard contract apply unless specified.

Tract 14-17 River's Edge

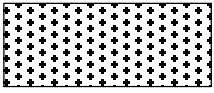

Aspen/Red Maple Area (138 acres) –Bounded by yellow paint. Harvest all trees greater than 2 inches except for: 1) hemlock, white pine, oak, cedar and 2) trees marked with a green X.

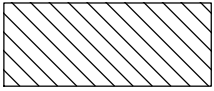

Select Cut Area (25 acres) -Bounded by red paint. Harvest all orange marked trees within the designated boundaries. Sever all orange marked unmerchantable stems (canopy gaps). Leave, do not cut 1)snags 2)cull trees 3)trees marked with an orange X.

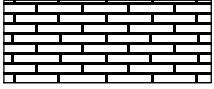

Purple Area (3 acres) –Bounded by purple paint. Cut all trees greater than 1 inch except for 1)purple X marked trees 2)Hemlock 3)White Pine.

****Decking on snowmobile trail will be kept to a minimum**

****No parking equipment or decking wood in the powerline ROW**

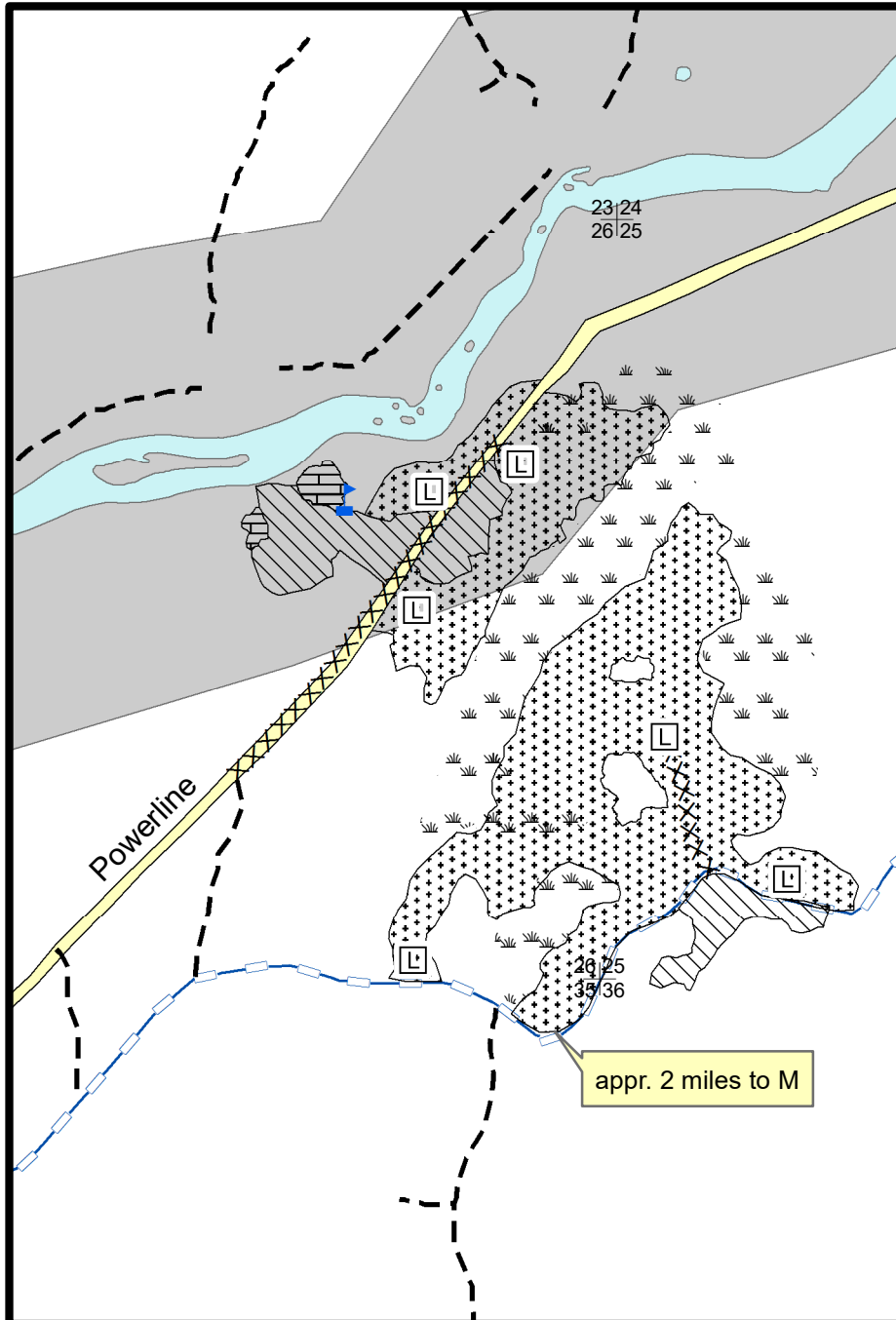

0 0.25 0.5 1 Miles

Locator Map

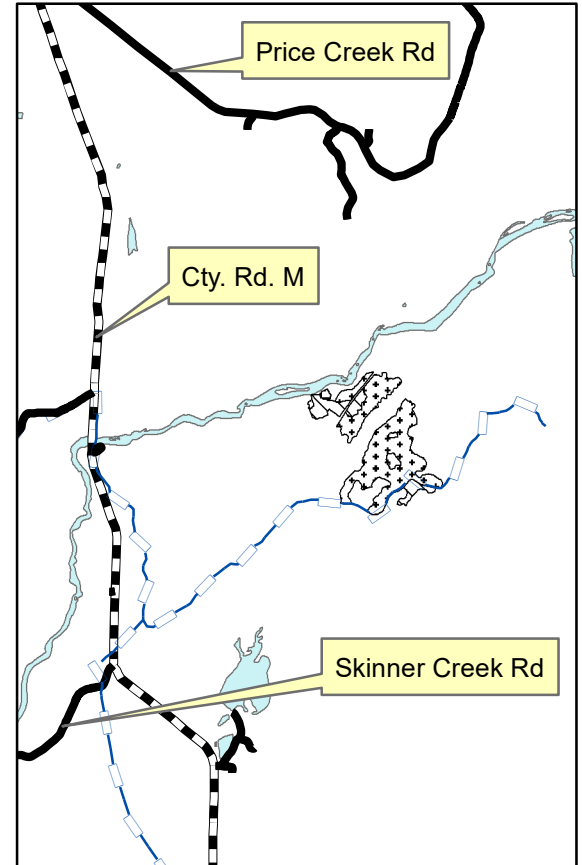

- Old Cabin
- Survey Monuments
- Landing
- Wet Area
- XXX Proposed Road
- Snowmobile
- Woods trails
- Powerline
- Flambeau River
- Scenic Area Leaf Off (Oct. 15-Apr. 1) 50 acres



This map is not a survey of the actual boundary of any property it depicts

Tract (4-18) Canoe Paddler Sale

Parts of: SE 1/4 and SW 1/4 Section 15 & SESE Section 16, T39N-R2W, Price County.

163 Acres

| <u>Species</u> | <u>Estimated Volume</u> | <u>Advertised Value/Unit</u> |
|-------------------------|-----------------------------|----------------------------------|
| ¹ Mixed Pulp | 2400 cords | 18.30 |
| Basswood | 125 cords | 3.50 |
| Ash | 500 cords | 10.60 |
| Aspen | 500 cords | 17.60 |
| Spruce | 50 cords | 17.60 |
| Balsam | 150 cords | 8.50 |
| Hard Maple | 14 MBF | 140.00 |
| Ash | 40 MBF | 65.00 |
| Basswood | 15 MBF | 65.00 |
| ² Mixed Saw | 8 MBF | 68.00 |

Minimum Acceptable
Bid for Entire Sale
\$66,691.50

¹Mixed pulp includes 60% hard maple, 33% red maple, 5% birch, 2% cherry/ironwood.

²Mixed saw includes 6 MBF of red maple and 2 MBF of yellow birch.

Other species not mentioned will be charged at the mixed pulp/saw price.

The performance bond will be 15% of the total sale value. Contract length is approximately three years.

SPECIAL SALE CONDITIONS:

This sale lies within the Flambeau River Scenic Management Area. Harvest operations within this sale area will be conducted during leaf-off (October 15th-March 31st). Equipment use will be restricted to dry or frozen ground conditions.

Access to sale will be via hunter walking trail from Ruby Rd. Distance to the sale area is approximately 3.5 miles. Alternate access may be available through Heartwood Forestland property to east of sale area. It would be the responsibility of the contractor to secure necessary road use agreements if this option is used.

Tree length skidding will not be allowed in select cut area, unless special permission is granted by Forester.

Use of continuous rotating saw head will not be allowed in the selection area due to density and distribution of regeneration.

Timber mats will likely be needed to cross several drainages as indicated on timber sale map.

It is possible that access roads may be in use for multiple sales at one time; it is the responsibility of the contractors of sales to determine the logistics for hauling and road maintenance/repairs.

New road and landing locations will need to be first discussed and approved by Forester.

Upon sale completion, all woods roads utilized shall be leveled, re-ditched if necessary, and returned to the condition prior to the sale.

All additional restrictions listed in prospectus and standard contract apply unless specified.

Tract (4-18) Canoe Paddler Sale

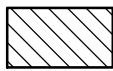

Selection Area (114 acres)- Bounded by red paint, young aspen, and black spruce/tamarack. Harvest all orange marked tees, and merchantable ironwood within designated boundaries. Sever all orange marked unmerchantable stems (canopy gaps).

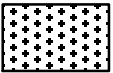

Aspen/Red Maple Area (40 acres)- Bounded by yellow paint. Cut all trees greater than 2" except for: 1). Cedar, 2). Hemlock, 3). White Pine, 4). Red Pine, 5). Oak

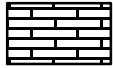

Purple Gap Area (9 acres)- Bounded by purple paint. Cut all trees greater than 2" except for: 1). Cedar, 2). Hemlock, 3). White Pine, 4). Red Pine, 5). Oak

For sale inspection, please call 715-332-5271 ext. 106 or ext. 112 for the combination of the lock for the gate. Please do not go around gate.

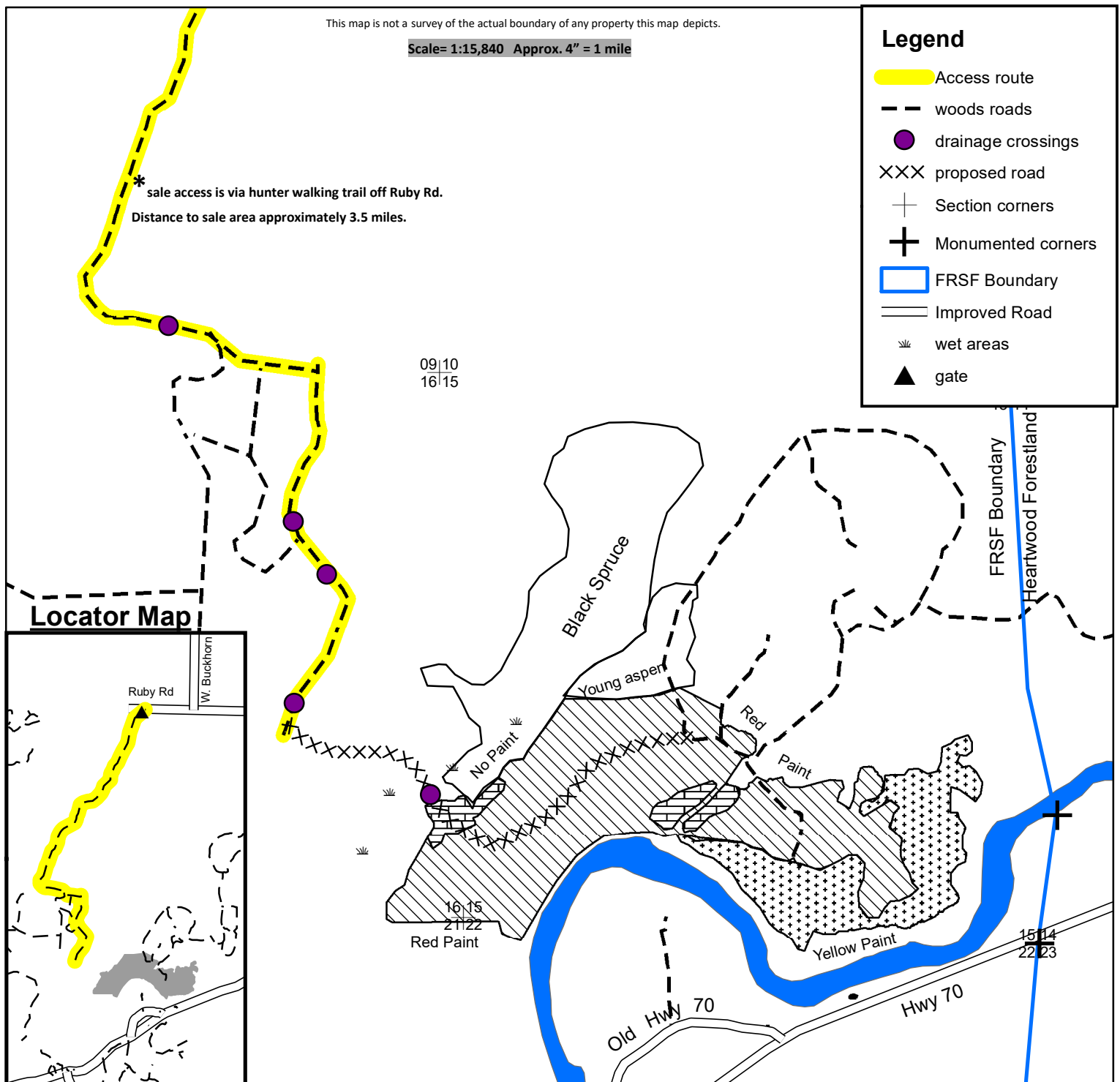

Tract 1-19 (Sea Horse Sale)

Parts of: NE1/4 Sec. 10; SESE Sec.3; NW1/4 Sec.11; SW1/4 Sec. 2 T36N R4W
Rusk County

117 Acres

| <u>Species</u> | <u>Estimated Volume</u> | <u>Advertised Value/Unit</u> | |
|-------------------------|-----------------------------|----------------------------------|----------------------------|
| Mixed Pulp ¹ | 400 cds | 23.90 | Minimum Acceptable |
| Aspen | 2,200 cds | 23.00 | <u>Bid for Entire Sale</u> |
| White Spruce | 190 cds | 16.50 | \$63,570.00 |
| Balsam Fir ² | 25 cds | 11.00 | |

¹Mixed pulp includes approximately 85% of red maple, 9% of ash, 4% of elm and 2% of sugar maple. Also includes 5 MBF of red maple and basswood. White spruce cordwood includes 9 MBF. ²Balsam Fir includes approximately 28% of black spruce. Species not listed will be charged the mixed pulp price.

The performance bond will be 15% of total sale value. Contract length is approximately two years.

SPECIAL SALE CONDITIONS:

Existing woods roads will be used. Proposed new access point will be permitted per location on prospectus map.

Location of turn arounds is limited to proposed layout shown on prospectus map. Modifications can be made with approval from Forester.

No decking will be allowed on River Road. Decking will be done along woods trails within the sale area.



Slash that is within 100 feet of River Road will be lopped and scattered to within 2 feet of the ground by the contractor.

No slash will be left in the ditch line of River Road. Any damage done to River Road or the ditch lines is the responsibility of the contractor.

Contractor is required to close roads at the locations designated on the map by placing logging debris, per sale prospectus.

All additional restrictions listed in prospectus and standard contract apply unless specified.

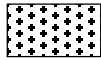
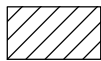
(Tract 1-19) Seahorse Sale

-  **Aspen Area (97 acres)**- Bounded by yellow paint. Cut all trees greater than 1 inch except for: hemlock, white pine, white spruce, and oak.
-  **Spruce/Aspen Coppice (6 acres)** – Bounded by yellow paint. Cut all trees greater than 1 inch except for: hemlock, white pine, and oak.
-  **Aspen Area (14 acres)** – Bounded by yellow paint, River Road, and young aspen. Cut all trees greater than 1 inch except for: hemlock, white pine, and oak. **Cut all spruce.**

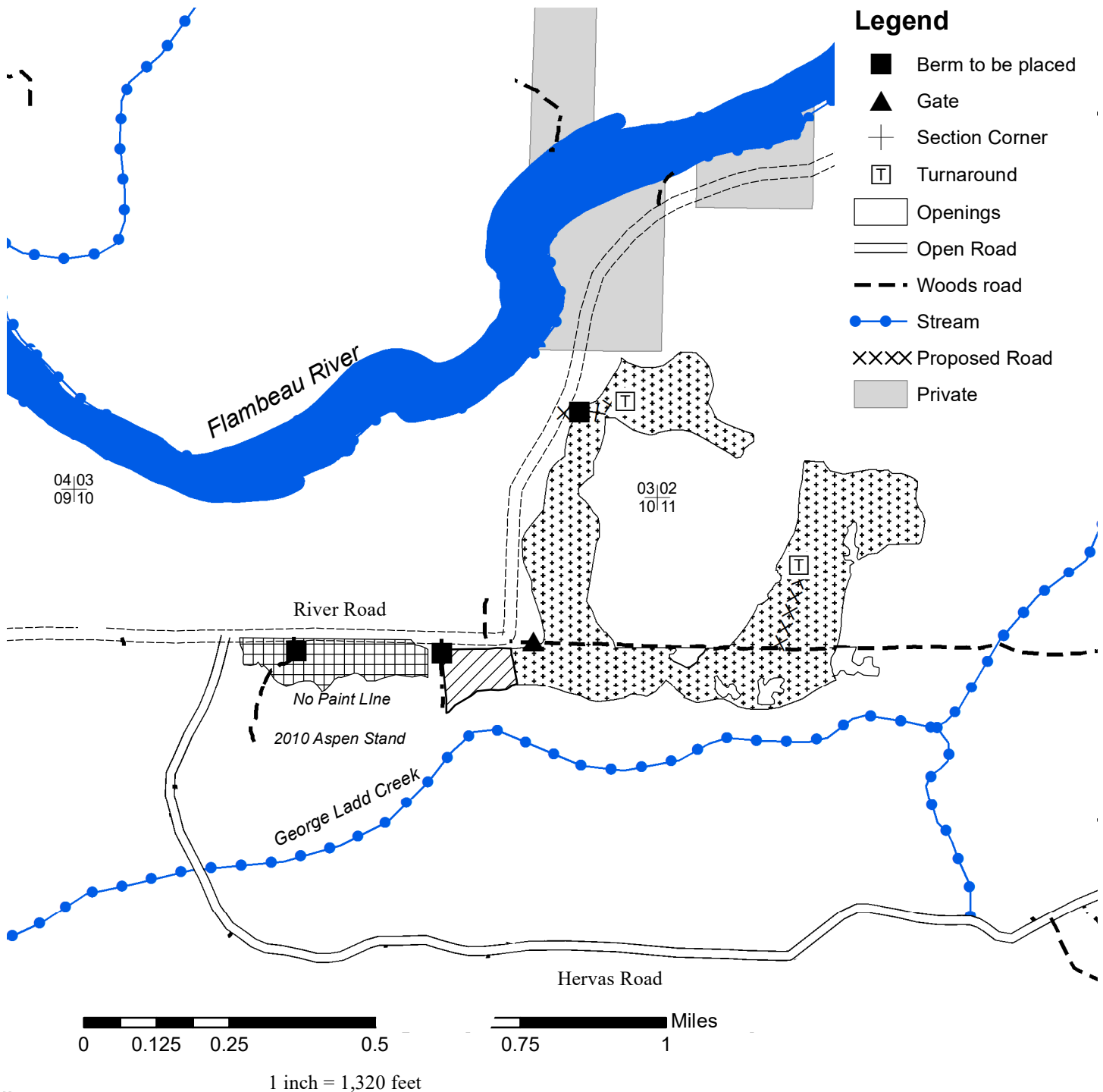

*This map is not a survey of the actual boundary of any property this map depicts.



Tract (2-19) North of the Border Sale
Parts of: SESW, SWSE of Sec. 17 T36N-R4W, Rusk County.

34 Acres

| <u>Species</u> | <u>Estimated Volume</u> | <u>Advertised Value/Unit</u> | <u>Minimum Acceptable Bid for Entire Sale</u> |
|-------------------------|-----------------------------|----------------------------------|---|
| | | | \$17,088.00 |
| ¹ Mixed Pulp | 60 cords | 22.10 | |
| Aspen | 740 cords | 21.30 | |

¹Mixed pulp includes approximately 75% red maple, 18% elm, and 7% ash and sugar maple combined. Also includes 2 MBF red maple.
Other species not mentioned will be charged at the mixed pulp price.

The performance bond will be 15% of the total sale value. Contract length is approximately two years.

SPECIAL SALE CONDITIONS:

- Existing woods roads will be used.
- Location of turn-around is limited to proposed layout shown on prospectus map. Modifications can be made with approval from Forester.
- No decking on River Road. Decking will be done along woods trails within the sale area.
- Contractor is required to close road at the location designated on the map by placing logging debris, per sale prospectus.
- Avoid government survey monuments illustrated on prospectus map.
- All additional restrictions listed in prospectus and standard contract apply unless specified.

Tract #2-19 North of the Border Sale

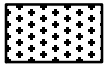

Aspen Area (34 acres)- Bounded by yellow paint. Road between state and county properties painted blue. Cut all trees greater than 1 inch except for: hemlock, cedar, white pine, white spruce, oak and cherry.

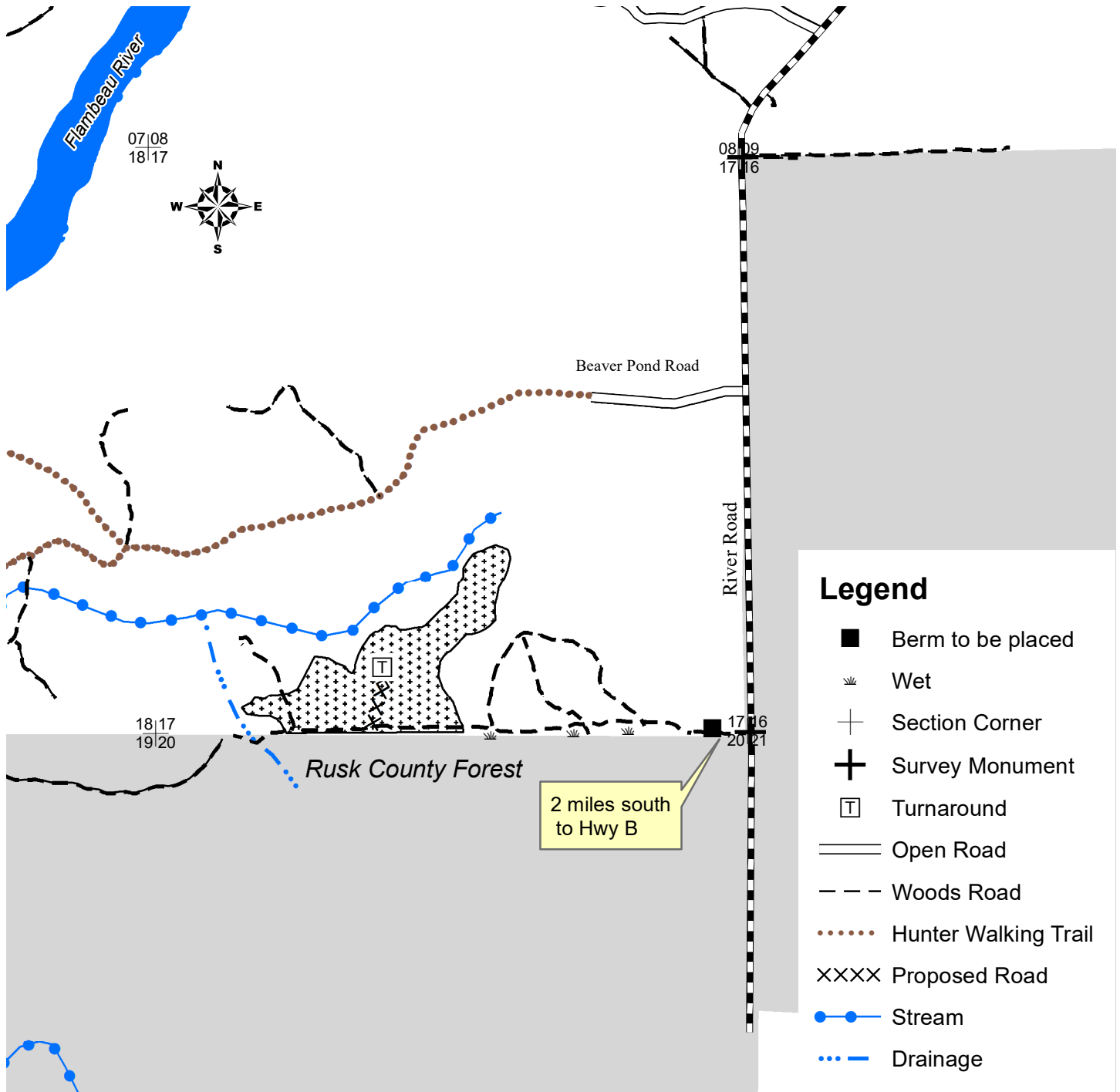

Legend

- Berm to be placed
- ☎ Wet
- ⊕ Section Corner
- ⊕ Survey Monument
- ⊕ Turnaround
- Open Road
- - Woods Road
- Hunter Walking Trail
- XXXX Proposed Road
- Stream
- Drainage

0 0.125 0.25 0.5 0.75 1 Miles
1 inch = 1,320 feet

*This map is not a survey of the actual boundary of any property this map depicts.

Tract (3-19) Fallin' Firs Sale

Parts of: W1/2NE, NW, NESW, S1/2SW, NWSE of Section 24 T39N-R4W, Sawyer County.

123 Acres

| <u>Species</u> | <u>Estimated Volume</u> | <u>Advertised Value/Unit</u> |
|-------------------------|-----------------------------|----------------------------------|
| ¹ Mixed Pulp | 785 cords | 20.60 |
| Basswood | 30 cords | 4.30 |
| Ash | 375 cords | 12.80 |
| Aspen | 570 cords | 21.30 |
| Balsam Fir | 175 cords | 8.80 |
| Spruce | 85 cords | 13.20 |
| Hard Maple | 5 MBF | 183.00 |
| Ash | 18 MBF | 98.00 |
| ² Mixed Saw | 4 MBF | 102.00 |

Minimum Acceptable

Bid for Entire Sale

\$38,990.00

¹Mixed pulp includes 40% hard maple, 45% red maple, 9% yellow birch and 6% elm, white birch, ironwood combined.

²Mixed saw includes 4 MBF of red maple and small amount of birch.

Other species not mentioned will be charged at the mixed pulp price.

The performance bond will be 15% of the total sale value. Contract length is approximately two years.

SPECIAL SALE CONDITIONS:

Portions of this sale are within the Flambeau River Scenic Management Area, operations within this area shall be conducted during leaf off conditions (October 15th – March 31st).

Equipment use will be restricted to dry or frozen ground conditions.

No logging April 1st – June 30th in the selection area.

No decking allowed on West Lane.

Contractor is required to close roads at locations designated on the map by placing logging debris per bid prospectus. Any new access points will also need to be bermed with logging debris. Upon sale completion, all woods roads and access points shall be leveled, re-ditched if necessary, and returned to the condition prior to the sale.

The road between the private and the FRSF can be used by the contractor. No decking on private property. No dozing on road between private and FRSF due to survey markers located in the center of the road. Material may be added.

Survey monuments and markers along private property shall be left undisturbed.

All additional restrictions listed in prospectus and standard contract apply unless specified.

Tract 3-19 (Fallin' Firs Sale)

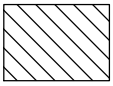

Selection Area (63 acres) – Bounded by red paint, West Lane, and blue paint. Harvest all orange marked trees within the designated boundaries. Sever all orange marked unmerchantable stems (canopy gaps). Leave, do not cut 1) snags, 2) trees marked with an orange X. Harvest only **marked** aspen.

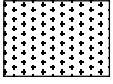

Coppice Area (49 acres) – Bounded by yellow paint, West Lane, and blue paint. Harvest all trees greater than 1 inch except for: 1) white pine, 2) hemlock, 3) oak.



Swamp Hardwood Strips (11 acres) – Cut all trees within 60 feet of both sides of orange marked center line (strips are 120' wide total). Do not cut: 1) white pine, 2) hemlock, 3) cedar. Do cut orange marked trees.

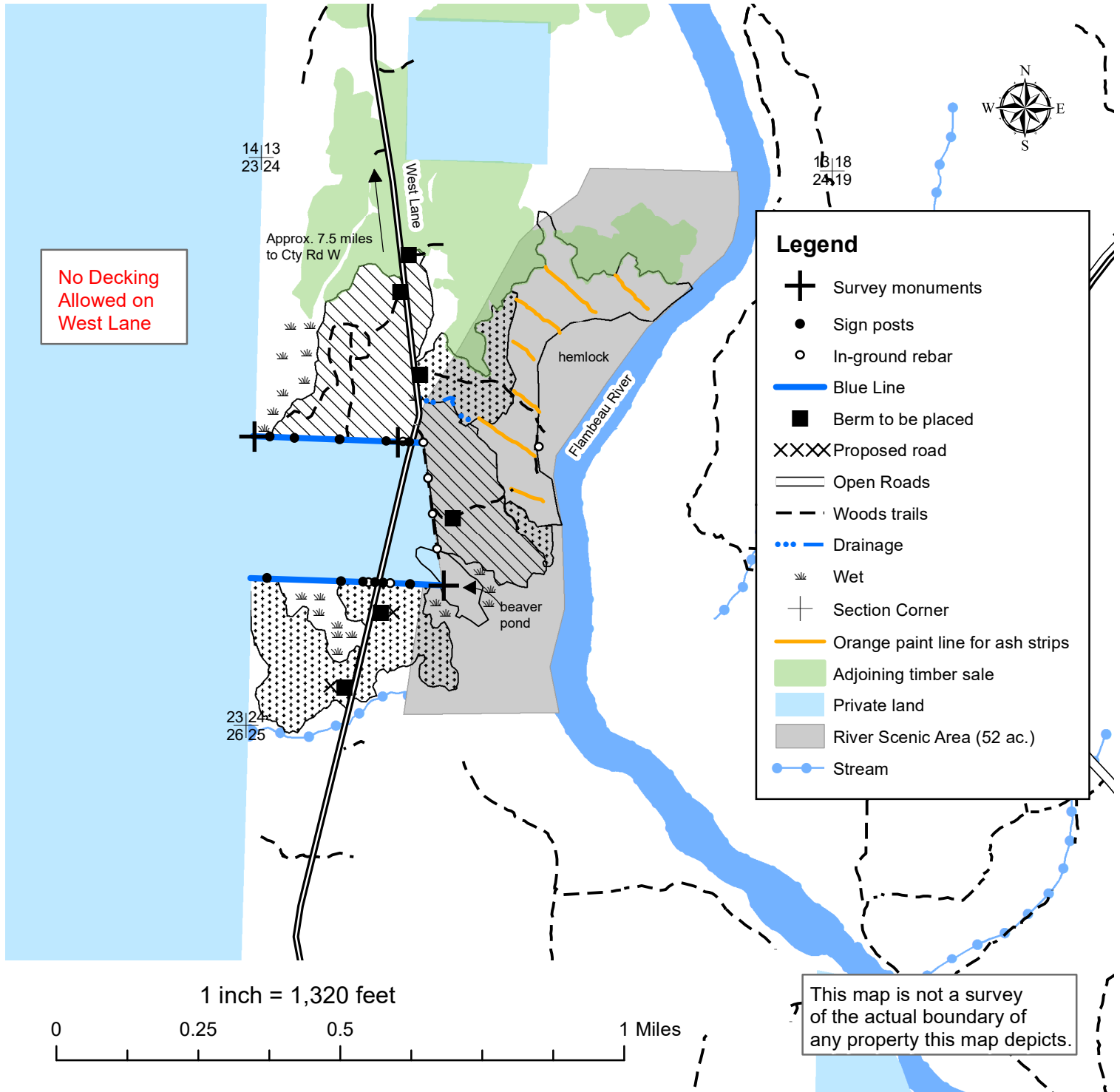

Tract (4-19) Broken Gun Sale

Parts of: SESW, SWSE Sec. 2; N1/2, N1/2SE, NESW, SWSE Sec. 11; E1/2NW Sec. 12 T39N-R3W, Sawyer County.

247 Acres

| <u>Species</u> | <u>Estimated Volume</u> | <u>Advertised Value/Unit</u> |
|-------------------------|-----------------------------|----------------------------------|
| ¹ Mixed Pulp | 3500 cords | 22.10 |
| Basswood | 45 cords | 4.30 |
| Balsam Fir | 15 cords | 10.20 |
| Hard Maple | 240 MBF | 208.00 |
| Red Maple | 36 MBF | 102.00 |
| Ash | 30 MBF | 98.00 |
| Basswood | 45 MBF | 98.00 |
| Yellow Birch | 33 MBF | 112.00 |
| ² Mixed Saw | 1 MBF | 102.00 |

Minimum Acceptable

Bid for Entire Sale

\$142,436.50

¹Mixed pulp includes 80% hard maple, 12% red maple, 6% yellow birch and 2% ash, elm, ironwood, cherry, and oak combined.

²Mixed saw includes a small amount of oak.

Other species not mentioned will be charged at the mixed pulp price.

The performance bond will be 15% of the total sale value. Contract length is approximately two years.

SPECIAL SALE CONDITIONS:

Equipment use will be restricted to dry or frozen ground conditions.

No logging April 1st – June 30th in the selection area or purple overstory removal area.

Bridges on ATV/Snowmobile Trail will not be crossed.

Contractor is required to close roads at locations designated on the map by placing logging debris per bid prospectus. Any new access points will also need to be bermed with logging debris. Upon sale completion, all woods roads and access points shall be leveled, re-ditched if necessary, and returned to the condition prior to the sale.

The ATV/Snowmobile trail will only be crossed at a maximum of 3 locations. If possible, keep decking to a minimum on the ATV/Snowmobile trail. Three inches of snow will be maintained on the Snowmobile trail, weather permitting. Ditches need to be returned to the condition prior to the sale.

If decking on open road, hunter walking trail, or ATV/Snowmobile trail, all slash and ends will be removed from the roads and ditches concurrently with each truckload.

Use of a continuous rotating saw head will not be allowed within the sale.

All additional restrictions listed in prospectus and standard contract apply unless specified.

Tract 4-19 (Broken Gun Sale)

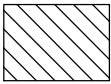

Selection Area (216 acres) – Bounded by red paint and Cty Rd EE. Harvest all orange marked trees within the designated boundaries. Sever all orange marked unmerchantable stems (canopy gaps). Leave, do not cut 1) snags, 2) trees marked with an orange X. Harvest only marked aspen. **Protect all oak seedlings/saplings.**

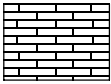

Purple Overstory Removal Areas (31 acres) – Bounded by purple paint. Harvest all trees greater than 2 inches except for: 1) white pine, 2) hemlock, 3) oak.
(Intent is to harvest overstory trees and save as much regeneration as possible.)

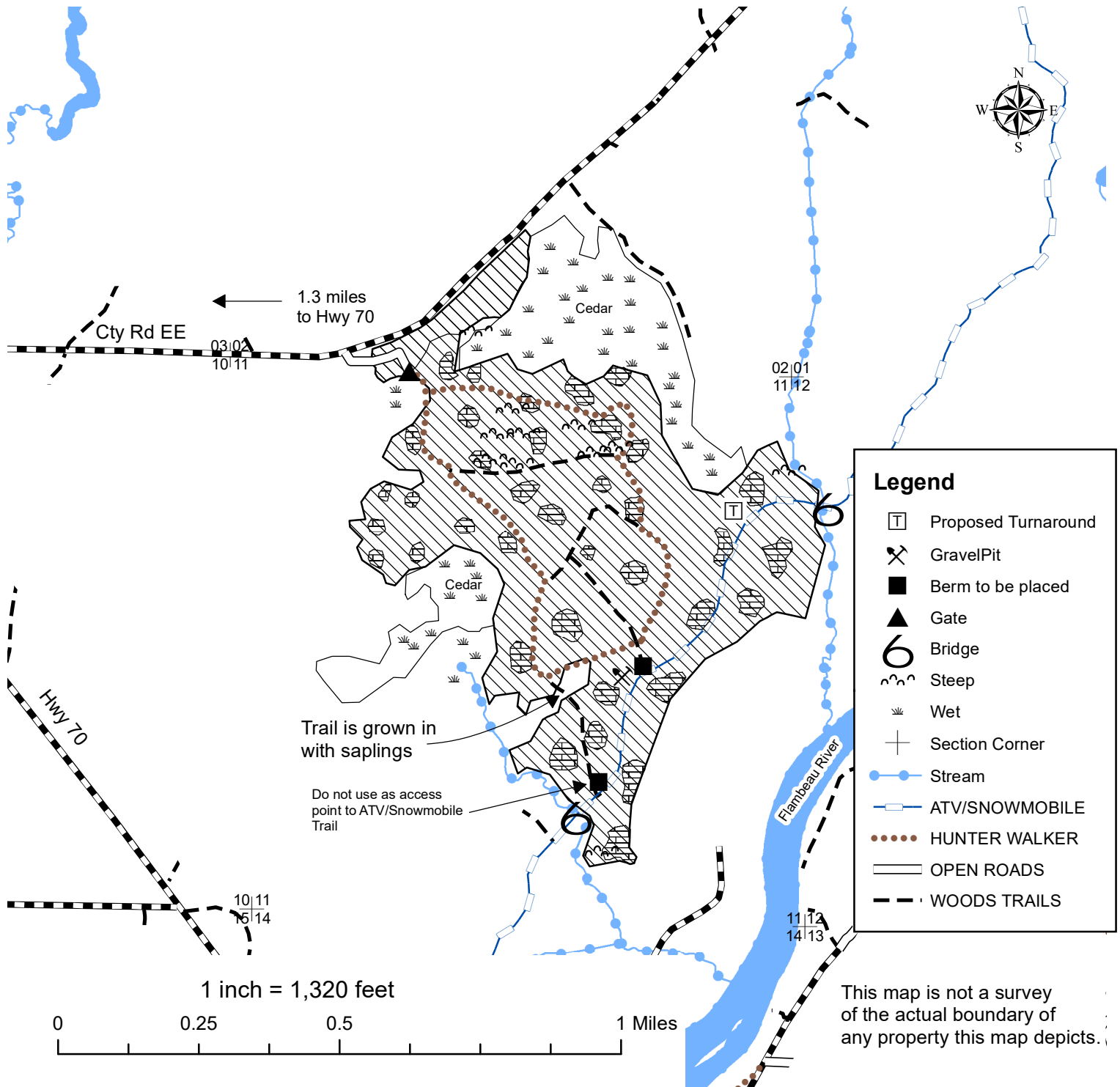

Tract (7-19) Elk Haven Sale

Parts of: SWSW Sec. 28; SENW, NESW, SWNE, SE Sec. 29; NE, N1/2SE Sec. 32; W1/2NW, NWSW Sec. 33, T38N-R3W, Sawyer County.

248 Acres

| <u>Species</u> | <u>Estimated Volume</u> | <u>Advertised Value/Unit</u> | |
|-------------------------|-----------------------------|----------------------------------|----------------------------|
| ¹ Mixed Pulp | 2600 cords | 22.10 | |
| Basswood | 75 cords | 4.30 | |
| Ash | 500 cords | 12.80 | |
| Aspen | 70 cords | 21.30 | |
| ² Tamarack | 60 cords | 10.20 | |
| Red Pine | 35 cords | 25.30 | |
| Hard Maple | 36 MBF | 208.00 | Minimum Acceptable |
| Red Maple | 12 MBF | 102.00 | <u>Bid for Entire Sale</u> |
| Ash | 34 MBF | 98.00 | \$80,133.00 |
| ³ Mixed Saw | 9 MBF | 102.00 | |

¹Mixed pulp includes 75% hard maple, 16% red maple, 6% yellow birch and 3% elm, ironwood, and cherry.

²Tamarack includes 55% tamarack, 30% balsam fir, and 15% white spruce.

³Mixed Saw includes 55% basswood and 45% yellow birch.

Other species not mentioned will be charged at the mixed pulp price.

The performance bond will be 15% of the total sale value. Contract length is approximately two years.

SPECIAL SALE CONDITIONS:

Portions of the sale are in the Flambeau River Scenic Management Area, operations within this area shall be conducted during leaf off (October 15th – March 31st).

Equipment use will be restricted to dry or frozen ground conditions.

No logging April 1st – June 30th in the selection area or purple overstory removal area.

Stream will not be crossed. Multiple access roads will be used to access the sale.

Wildlife openings will not be used for decking.

Contractor is required to close roads at locations designated on the map by placing logging debris per bid prospectus. Any new access points will also need to be bermed with logging debris. Upon sale completion, all woods roads and access points shall be leveled, re-ditched if necessary, and returned to the condition prior to the sale.

Nedli Road is an ATV/Snowmobile Trail. If possible, keep decking to a minimum on Nedli Road/ ATV/Snowmobile trail. Three inches of snow will be maintained on the Snowmobile trail, weather permitting. Ditches need to be returned to the condition prior to the sale. If decking on Nedli Road/ATV/Snowmobile trail, all slash and ends will be removed from the roads and ditches concurrently with each truckload.

Use of a continuous rotating saw head will not be allowed within the sale.

All pine cut or piled between May 1st and August 1st shall be removed in 30 days.

All additional restrictions listed in prospectus and standard contract apply unless specified.

For sale inspection, call 715-332-5271 ext. 106 or ext. 112 for the combination of the lock for the gate. Please do not go around the gate.

Tract 7-19 (Elk Haven Sale)

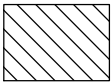

Selection Area (235 acres) – Bounded by red paint, blue paint and Nedli Road/ATV/Snowmobile Trail. Harvest all orange marked trees within the designated boundaries. Sever all orange marked unmerchantable stems (canopy gaps). Leave, do not cut 1) snags, 2) trees marked with an orange X.

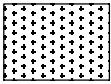

Coppice Areas (12 acres) – Bounded by yellow paint. Harvest all trees greater than 1 inch except for: 1) white pine, 2) hemlock, 3) oak.



Tamarack Strips (1 acre) – Harvest all trees within 60 feet on both sides of orange marked center line except for 1) white pine, 2) cedar, 3) hemlock. Strips are a total of 120 feet wide. Cut all orange marked trees.

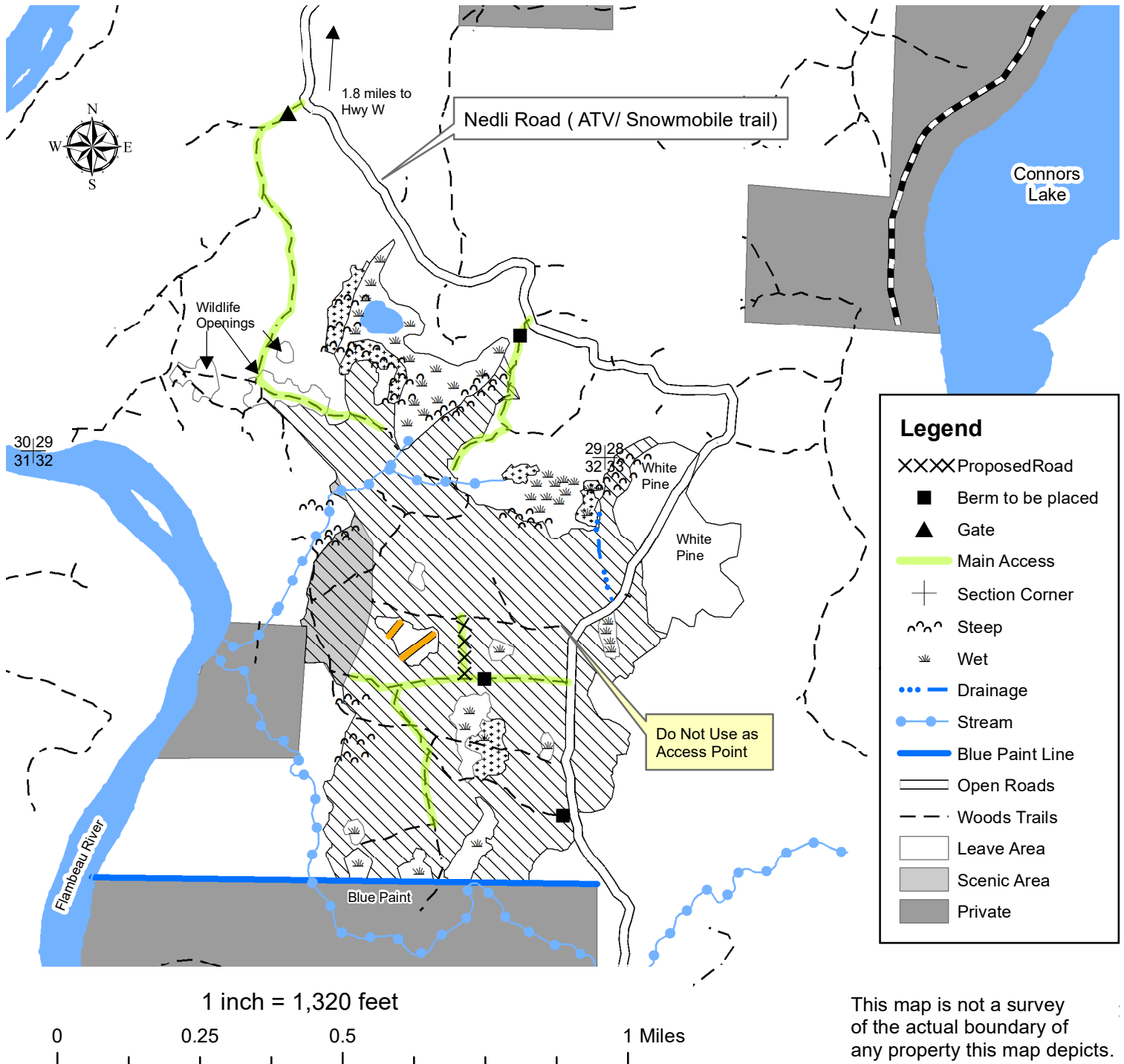

This map is not a survey of the actual boundary of any property this map depicts.

Tract (8-19) Different Payne Sale

Parts of: SW of Section 14; W1/2NW of Section 23; NE of Section 22; and SESE of Section 15 in T39N-R3W, Sawyer County.

121 Acres

| <u>Species</u> | <u>Estimated Volume</u> | <u>Advertised Value/Unit</u> |
|-------------------------|-----------------------------|----------------------------------|
| ¹ Mixed Pulp | 1000 cords | 25.50 |
| ² Ash | 360 cords | 15.30 |
| Aspen | 180 cords | 21.30 |
| ³ Spruce | 160 cords | 15.30 |
| ⁴ Red Pine | 200 cords | 29.80 |

Minimum Acceptable
Bid for Entire Sale
\$43,250.00

¹Mixed pulp includes 88% hard maple, 3% red maple, 7% yellow birch, 2% elm, white birch, cherry, and ironwood. Includes 12 MBF hard maple, 1 MBF red maple, and 1 MBF yellow birch.

²Ash volume includes 97% ash and 3% basswood. Includes 17 MBF ash and 1 MBF basswood.

³Spruce volume includes 52% white spruce, 47% balsam fir, and 1% black spruce.

⁴Red pine volume includes 49 MBF red pine. Average diameter is 13 inches.

Other species not mentioned will be charged at the mixed pulp price.

The performance bond will be 15% of the total sale value. Contract length is approximately two years.

SPECIAL SALE CONDITIONS:

Equipment use will be restricted to very dry or frozen ground conditions due to wet soil conditions.

Portions of this sale are in the Flambeau River Scenic Management Area, operations within this area shall be conducted during leaf off (October 15th – March 31st).

A special management area is identified in light green on the sale map. No harvesting shall occur within this area between May 1st and August 24th.

Use of a continuous rotating saw head will not be allowed in the select cut area due to density and distribution of regeneration.

NO DECKING OR SKIDDING ALLOWED on Payne Farm Road without special permission from the Town of Draper.

Gates shall be closed when not working on sale.

Payne Farm Road is used for multiple sales, it is the responsibility of the contractors of sales to determine the logistics for hauling.

Upon sale completion, all woods roads and access points along Payne Farm Road shall be re-ditched and returned to the condition prior to the sale.

Any access points used will need to be bermed with logging debris.

All additional restrictions listed in prospectus and standard contract apply unless specified.

(Tract 8-19) Different Payne Sale



Select Cut Area (65 acres)- Bounded by red paint and Payne Farm Road. Harvest all orange marked trees within the designated boundaries. Sever all orange marked unmerchantable stems (canopy gaps). Harvest all merchantable ironwood and balsam fir. Leave, do not cut 1)snags, 2)cull trees, 3)trees marked with an orange X. Cut only marked aspen.

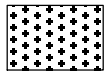

Aspen Areas/Swamp Hardwood Patches (17 acres)- Bounded by yellow paint, blue paint, and Payne Farm Road. Cut all trees greater than 2" except for: 1) hemlock, 2)white pine, 3) oak, 4) cedar, 5) red pine,6) balsam with less than 2 sticks.

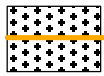

Swamp Hardwood Strips (7 acres)- No boundary paint. Strip cut is marked in the center by a strip of trees marked with orange paint. Strips are 120 feet wide. Cut all trees greater than 2 inches within 60ft of either side of orange marked trees except for: 1) hemlock, 2) cedar, 3) white pine.

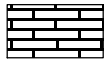

Purple Overstory Removal Area (10 acres)- Bounded by purple paint. Cut all trees greater than 2" except 1) purple "X" marked trees, 2) hemlock, 3) white pine, 4)oak. (Intent is to harvest overstory trees and save as much hard maple regeneration as possible.)

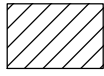

Red Pine Plantation (19 acres)- Bounded by red paint, northern hardwoods, and Payne Farm Road. Harvest all trees marked with orange paint. Cut only marked aspen.

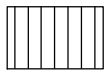

Spruce Plantation (3 acres)- Bounded by red paint and northern hardwoods. Harvest all orange marked trees within the designated boundaries. Cut only marked aspen.

Ⓟ Berm to be Placed

Ⓜ Turnarounds

▲ Gate

⊕ Survey Monument

⊕ Section Corner

XXX Proposed Road

● Stream

▬ State Highway

▬ Town Road

Scenic Area Leaf Off (Oct. 15-April 1st)(81ac.)

Special Management Area (Aug 25-April1st)(32 ac.)

Private

● Hunter Walker

▬ Open Roads

▬ Woods trails

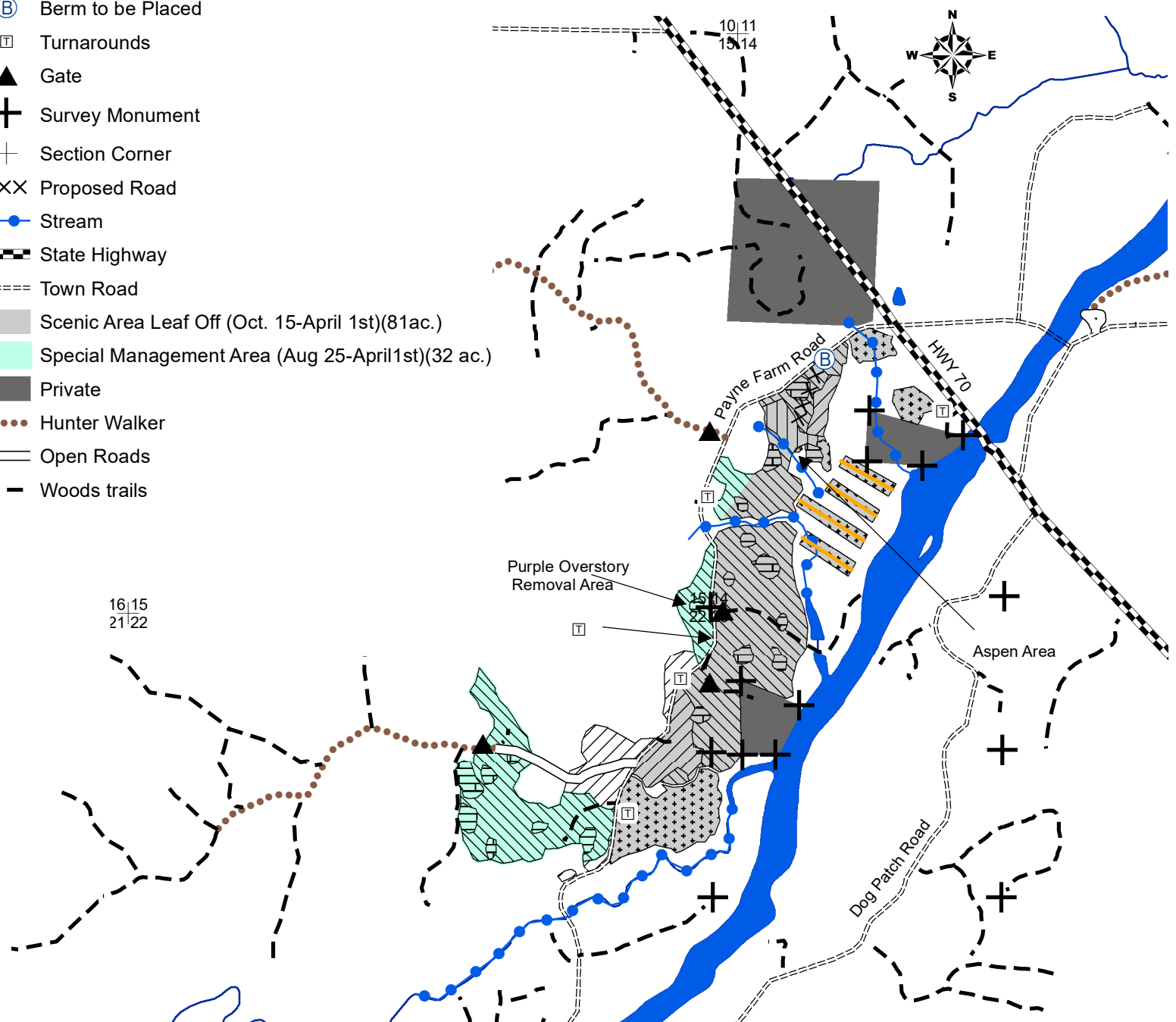

Tract (2-19 KC)
Section 29, T38N-R2W, Price County.

34 Acres

| <u>Species</u> | <u>Estimated Volume</u> | <u>Advertised Value/Unit</u> |
|-------------------------|-----------------------------|----------------------------------|
| Aspen | 700 cords | 20.00 |
| ¹ Mixed Pulp | 150 cords | 20.80 |
| ² Balsam | 50 cords | 10.20 |

Minimum Acceptable
Bid for Entire Sale
\$17,630.00

¹Mixed pulp includes almost entirely red maple with very minor amounts of cherry, birch, and ash.

²Balsam volume estimate includes minor amount of spruce.

Other species not mentioned will be charged at the mixed pulp price.

The performance bond will be 15% of the total sale value. Contract length is approximately three years.

SPECIAL SALE CONDITIONS:

Harvesting will be limited to frozen ground conditions.

Harvest area is bounded by yellow paint line and young aspen.

Equipment operations will be prohibited in wet inclusions as indicated on timber sale map.

Any new roads or access points will be discussed and approved by the administering forester and will require slash and/or debris berms to be placed following completion to prevent unauthorized vehicle usage.

Best access to sale area is via extension of woods road to north of sale as indicated on timber sale map.

Signage will be provided and placed by the Dept. if sale is harvested during the open snowmobiling season.

Upon sale completion, all roads shall be leveled and returned to as good or better condition.

Sale Info: Tom Onchuck, Park Fall DNR Service Center, 715-661-3728, thomas.onchuck@wisconsin.gov

All additional restrictions listed in prospectus and standard contract apply unless specified.



Tract 2-19 KC

Kimberly Clark Wildlife Area
Sec. 29, T38N-R2W

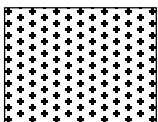
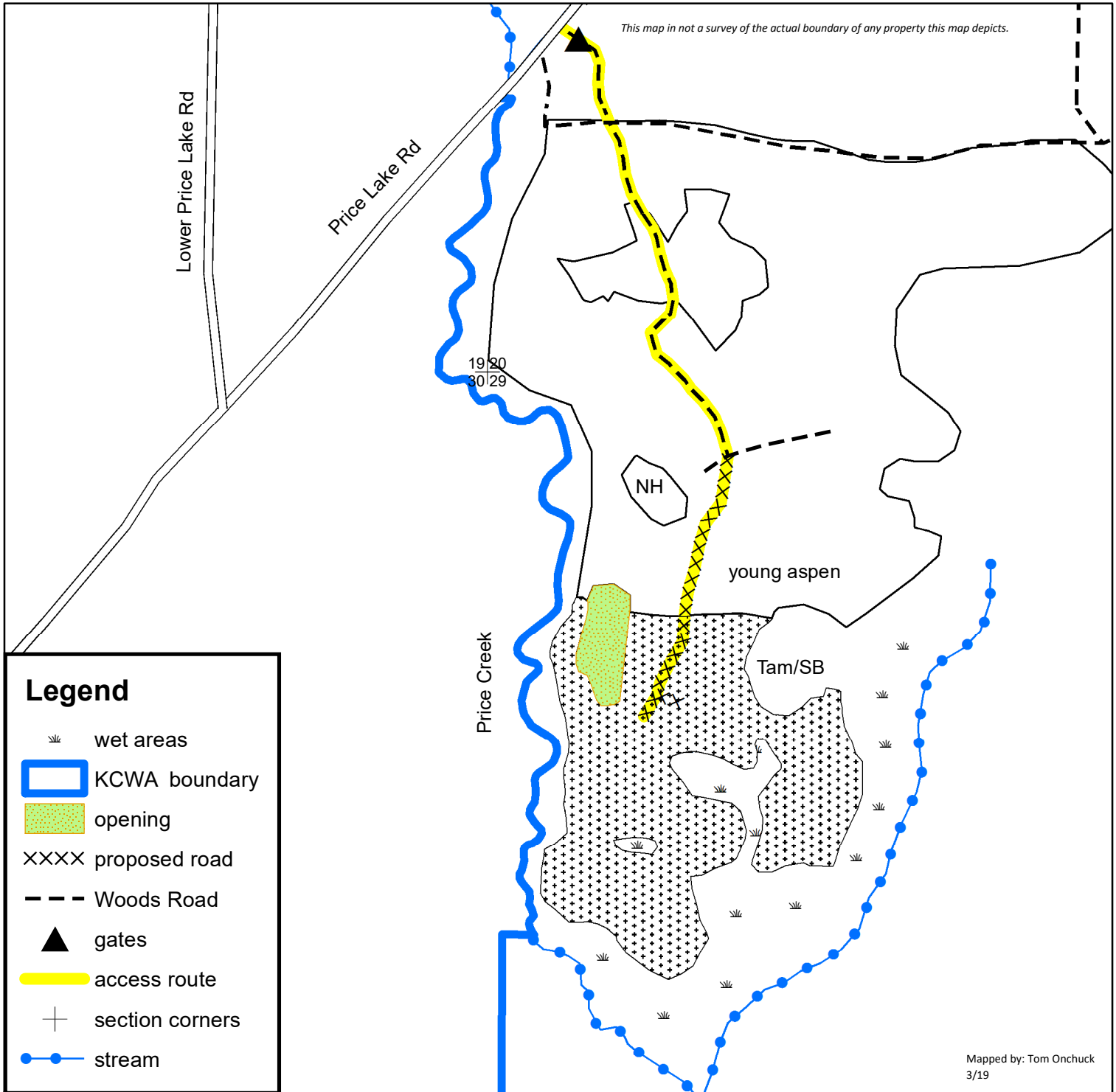

Regeneration harvest (34ac)- Harvest all stems greater than 2" DBH except for: 1). oak, 2). cedar 3). hemlock, 4). spruce containing 3 sticks or less.

0 330 660 1,320 Feet

Scale= 1:7,920



Sawyer County State Lands Timber Sale

Totagatic Wildlife Area
Timber Sale Prospectus

Tract #. H05-18

Location:

| Town | Range | Section | Description |
|------|-------|---------|-------------|
| 42N | 9W | 17 | W1/2 |
| 42N | 9W | 18 | E1/2 |
| 42N | 9W | 19 | NE1/4 |
| 42N | 9W | 20 | N1/2,SE1/4 |

Sale Area: 151 Acres

| SPECIES | VOLUME | MIN. PRICE | TOTAL | SPECIES | VOLUME | MIN. PRICE | TOTAL |
|----------|-----------|------------|------------|------------|--------|--------------|-------------|
| Aspen | 40 Tons | \$9.40/Ton | \$376.00 | Hard Maple | 95 MBF | \$141.00/MBF | \$13,395.00 |
| MX HDWD | 1400 Tons | \$8.33/Ton | \$9,940.00 | Basswood | 95 MBF | \$71.00/MBF | \$6,745.00 |
| Basswood | 575 Tons | \$2.20/Ton | \$1,265.00 | MX HDWD | 10 MBF | \$71.00/MBF | \$1,420.00 |

- Mixed Hardwood cordwood volume is comprised of 95% Hard Maple.
- **Bid Prices MUST be shown in TONS.**

Minimum Acceptable Bid: \$33,141.00

Harvest Requirements

Select Cut: Harvest all trees marked in orange paint.

Gaps: Within canopy gaps designated with purple paint, cut all stems 2" in diameter and larger and all musclewood and ironwood. Take care not to damage any existing hardwood regeneration under 2".

Site Conditions: Gaps have been established with the intent to establish new regeneration and release existing regeneration. Existing regeneration outside of canopy gaps should be protected if possible but is a secondary priority to regeneration existing within established canopy gaps.

Additional Requirements:

- **Harvesting operation may occur during dry or frozen ground conditions**
- **Within Eagle nest buffer ONLY: No harvest February 15th-August 15th.**
- All slash must always be kept clear of travel ways and out of wetlands and riparian areas
- All road maintenance and rehabilitation post-harvest is the purchaser's responsibility. Roads will be left in an equal or improved state post-harvest.
- Any disturbed roads or landing areas will be re-seeded post-harvest with loggers mix if necessary.
- Sale will be billed using mill ticket system for pulp; logs will be scaled on the landing.
- No bid bond required, a performance bond of 15% of the total sale bid value will be required. 2 year contract period
- Reserve all snags that do not pose a safety risk
- Equipment must be clean of dirt and debris before entering sale area
- Do not disturb survey corners, monuments, or surrounding witness trees
- Existing roads will utilized for this harvest within harvest area.

Contact Jim Kujala with questions: 715-558-9632 or james.kujala@wisconsin.gov

SAWYER COUNTY STATE LANDS TIMBER SALE MAP

Map Codes

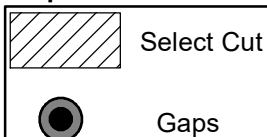

Cutting Specifications

Harvest all trees marked with orange paint.

Within canopy gaps designated with PURPLE paint, cut all stems 2" in diameter and larger AND all musclewood and ironwood. Take care not to damage existing hardwood regeneration under 2"

Estimated Volumes

| Species | Tons | MBF |
|---------|------|-----|
| A | 40 | |
| MX | 1400 | 20 |
| BA | 575 | 95 |
| MH | | 95 |

Contractor

| Tract # | H05-18 | Sale # | Sale Acreage |
|-------------------------------|--------|----------|-------------------|
| Legal Description: Section(s) | 17 | T42N R9W | Desc. W1/2 |
| Legal Description: Section(s) | 18 | T42N R9W | Desc. E1/2 |
| Legal Description: Section(s) | 19 | T42N R9W | Desc. NE1/4 |
| Legal Description: Section(s) | 20 | T42N R9W | Desc. N1/2, SE1/4 |

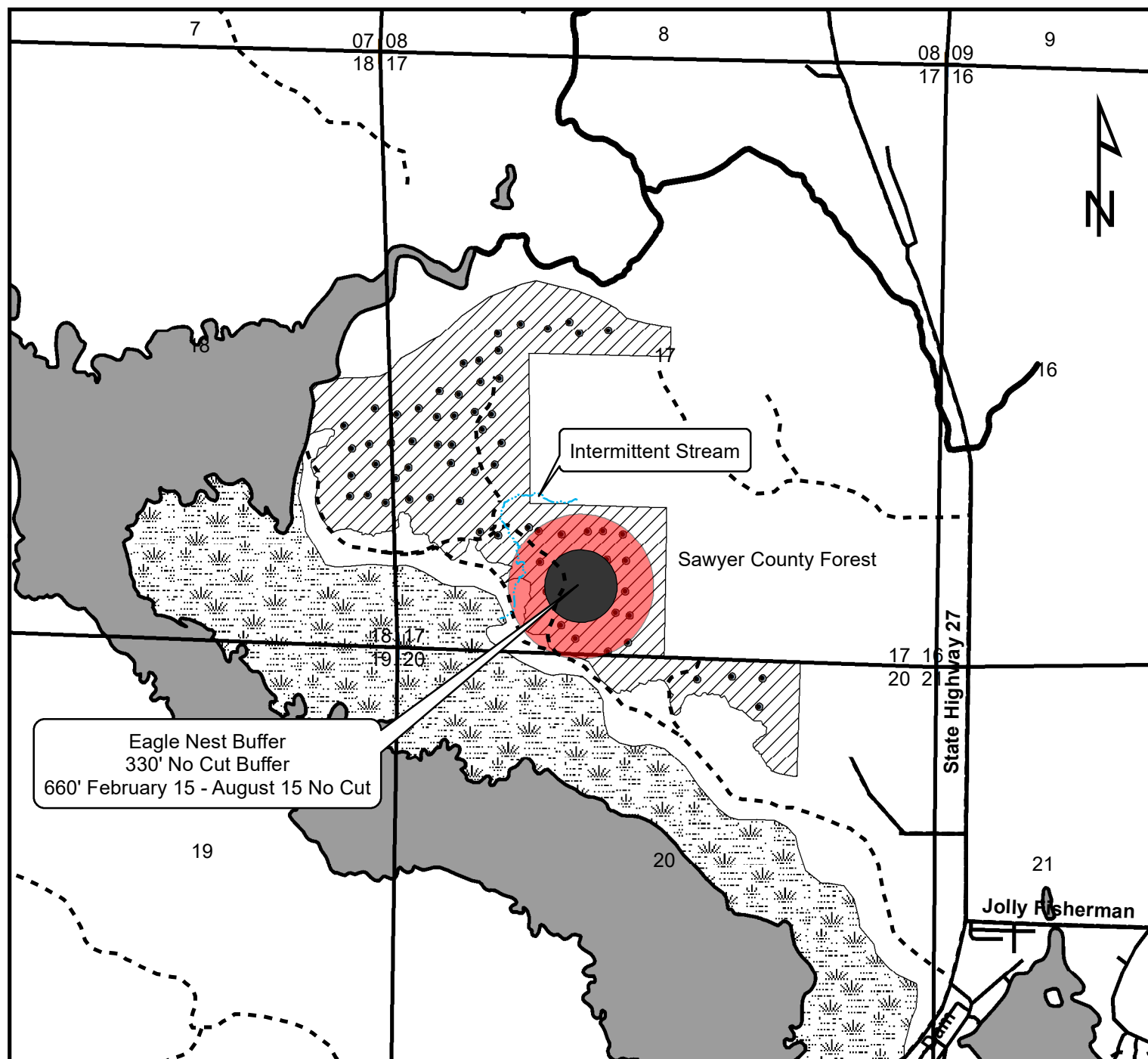

*All cutting boundaries lined in red
 *Sawyer County Forest lined in blue
 Property lines are not survey accurate

1 inch = 0.25 miles

Sale Prepared by: Jim Kujala



Sawyer County State Lands Timber Sale

Lake Helene State Natural Area

Timber Sale Prospectus

Tract #. H07-18

Location:

| Town | Range | Section | Description |
|------|-------|---------|-------------|
| 42N | 7W | 16 | SE1/4 |

Sale Area: 29 Acres

| SPECIES | VOLUME | MIN. PRICE | TOTAL |
|---------|----------|--------------|------------|
| MX HDWD | 460 Tons | \$5.40/Ton | \$2,484.00 |
| Aspen | 335 Tons | \$7.30/Ton | \$2,445.50 |
| Red Oak | 135 Tons | \$2.90/Ton | \$391.50 |
| MX HDWD | 4 MBF | \$70.00/MBF | \$280.00 |
| Red Oak | 10 MBF | \$139.00/MBF | \$1,390.00 |

- Bid Prices MUST be shown in TONS and MBF

Minimum Acceptable Bid: \$6,991.00

Harvest Requirements:

Shelterwood: Harvest all trees 2" in diameter and greater except Pine and trees marked in Purple paint

Select Cut: Harvest all trees marked in orange paint.

Clear Cut: Harvest all trees 2" in diameter and larger EXCEPT Oak and Pine

Site Conditions: The shelterwood harvest areas are intended to promote the regeneration of a new stand of Red Oak. Pre-sale scarification will be completed by DNR prior to harvest. All slash shall be lopped and scattered within 2' of ground level and deposited a minimum of 10' from any remaining trees in the shelterwood areas.

Additional Requirements:

- **Oak Wilt Restrictions- No cutting April 15th – July 15th**
- All slash must be kept clear of travel ways at all times, and out of wetlands and riparian areas. Do not harvest trees within 15' of any wetlands within the sale area.
- All slash must be pulled back at least 10' from any private land boundaries.
- All road maintenance and rehabilitation post-harvest is the purchaser's responsibility. Roads will be left in an equal or improved state post-harvest.
- Sale will be billed using mill ticket system.
- No bid bond required, a performance bond of 15% of the total sale bid value will be required. 2 year contract period
- Reserve all snags that do not pose a safety risk
- Equipment must be clean of dirt and debris before entering sale area
- Do not disturb survey corners, monuments, or surrounding witness trees
- Existing roads will utilized for this harvest within harvest area.



Contact Jim Kujala with questions: 715-558-9632 or james.kujala@wisconsin.gov

SAWYER COUNTY STATE LANDS TIMBER SALE MAP

Map Codes

Cutting Specifications

Estimated Volumes

| | | |
|--|-------------|---|
|  | Select Cut | Cut all trees marked with orange paint Take care not to damage existing regen |
|  | Clear Cut | Harvest all stems 2" in diameter and larger EXCEPT Pine and Oak |
|  | Shelterwood | Harvest all stems 2" in diameter and greater except those marked in purple paint and any Pine |

| Species | Tons | M B F |
|---------|------|-------|
| MX | 460 | 4 |
| A | 335 | |
| OR | 135 | 10 |

Contractor _____

Tract # H07-18 Sale # _____ Sale Acreage 29

Legal Description: Section(s) 16 T42N R7W Desc. SE1/4

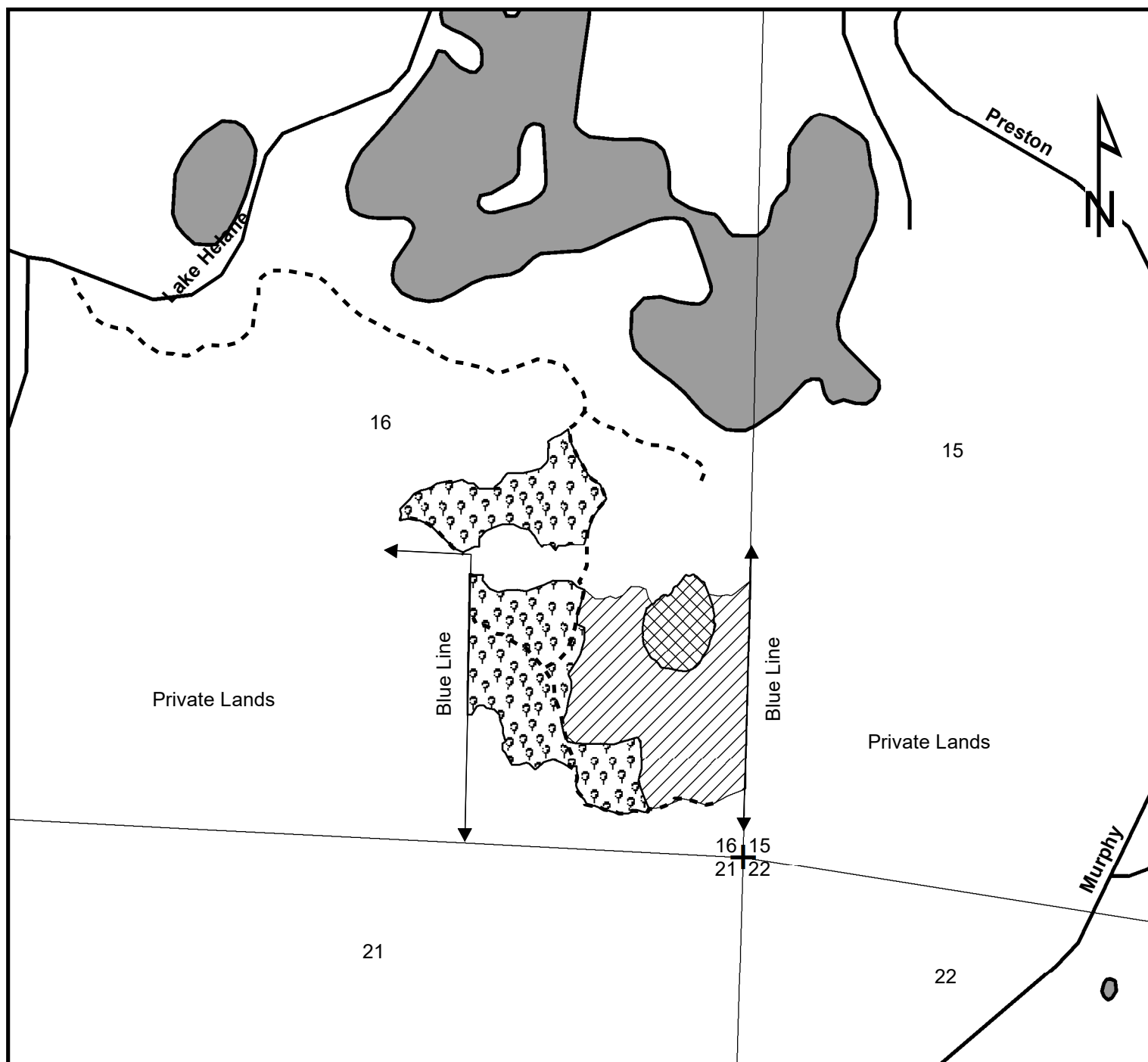

*All cutting boundaries lined in red

*Private Lands cutting boundaries lined with blue

Property lines are not survey accurate

1 inch = 0.13 miles

Sale Prepared by: Jim Kujala

Tract (PKF4-18) Hardwood Baby Sale

Parts of: S1/2 of Section 30, SWSW of Section 29, and the NE of Section 31 T41N-R2E, Iron County, WI.

80 Acres

| <u>Species</u> | <u>Estimated Volume</u> | <u>Advertised Value/Unit</u> | |
|-------------------------|------------------------------------|---|---|
| ¹ Mixed Pulp | 390 cords | 13.30 | |
| ² Basswood | 15 cords | 2.50 | |
| Aspen | 650 cords | 15.60 | |
| ³ Spruce | 270 cords | 13.10 | |
| ⁴ Red Pine | 430 cords | 21.70 | |
| | | | <u>Minimum Acceptable Bid For Entire Sale</u> \$28,232.50 |

¹Mixed pulp includes 37% hard maple, 50% red maple, and 13% ash. Mixed pulp volume includes 1 MBF hard maple, 500 BF of red maple, and 1 MBF ash.

²Basswood volume includes 900 BF of basswood.

³Spruce volume includes 75% white and black spruce and 25% balsam fir.

⁴Red Pine volume includes 89 MBF red pine saw. Average diameter is 8".

Other species not mentioned will be charged at the mixed pulp price.

The performance bond will be 15% of the total sale value. Contract length is approximately two years.

SPECIAL SALE CONDITIONS:

Equipment use will be restricted to very dry or frozen ground conditions due to wet soil conditions.

No cutting during the months of April, May, or June in selection harvest area due to bark being easily damaged at these times.

NO DECKING OR SKIDDING ALLOWED ON Hoffman Lake Road without special permission.

If decking on Hoffman Lake Road or hunter/walking trail all slash and ends will be removed from the roads and ditches concurrently with each truckload.

The main haul road may be used for multiple sales, it is the responsibility of the contractors of sales to determine the logistics for hauling and/or road repair.

To make areas of sale operable during dry conditions, existing trails and new stub roads will most likely need pit run/breaker run material. The state will provide the pit run/breaker run material, but it will be the responsibility of the contractor for loading/hauling/leveling any material needed for decking on these existing roads and new stubs.

Upon sale completion, all open roads and hunter walking trails shall be returned to as good or better condition than prior to the sale startup.

DNR will ensure access to timber sale, however, access across private property (if desired) is the responsibility of the contractor.

No wheeled or tracked harvesting equipment will be operated within 15 feet of the ordinary high-water mark except on roads or at stream crossing.

For sale inspection, call or email Maggie Lorenz (715) 492-1970 or margaret.lorenz@wisconsin.gov, for the combination of the lock for the gate. Please do not go around gate.

All additional restrictions listed in prospectus and standard contract apply unless specified.

Tract (PKF4-18) Hardwood Baby Sale

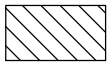
 **Selection Area (12 acres)**- Bounded by red paint and blue paint. Harvest all orange marked trees within the designated boundaries. Sever all orange marked unmerchantable stems (canopy gaps). Harvest all merchantable ironwood and balsam fir.

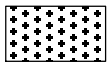
 **Aspen Area (21 acres)**- Bounded by yellow paint, open wet swamp, and woods road. Cut all trees greater than 2" **except for:** 1) cedar, 2) hemlock, 3) white pine, 4) oak, 5) yellow birch, 6) red pine.

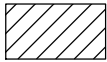
 **Plantation Thinning (47 acres)**- Bounded by open swamp, Hoffman Lake Road, woods road and open road. Harvest all trees marked with orange paint. Harvest all merchantable aspen, balsam fir, spruce, and hardwoods (except yellow birch and white birch).

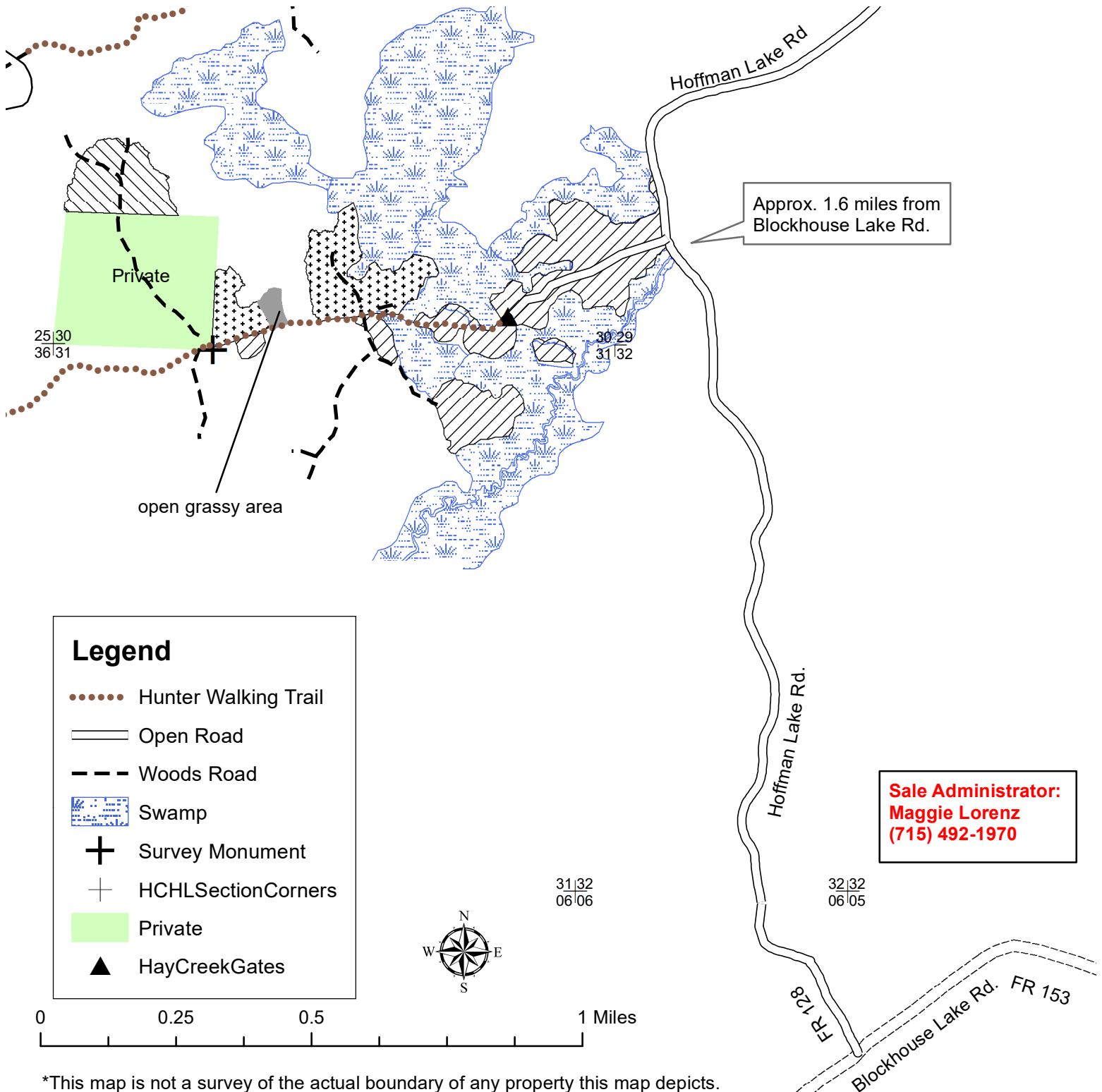

Turtle Flambeau Scenic Waters Area TF 1-19

Town of Mercer

Iron County

T42N / R2E / Section 23 / SESW

T42N / R2E / Section 26 / NWNW, NWNE, SENE, SWNE

T42N / R2E / Section 27 / NWSE

Contact Information: Bryce Berklund (Mercer DNR Forester)

Phone Number: (715)416-4981

State House Circle, Mercer, WI 54547

15% of the total sale bid value will be required for performance bond.

The cutting area is approximately 141 acres.

The contract period is 3 years.

All trees that will yield one or more 100-inch sticks to the minimum 4" top diameter will be cut and utilized.

Whole tree utilization is not allowed.

ESTIMATED VOLUME (Tons) MINIMUM TOP DIAMETER

| <u>SPECIES</u> | <u>4"</u> | Total Adv. Value | Advertised Price <u>Per Unit</u> |
|---------------------------------|-----------|------------------|-------------------------------------|
| Aspen | 200 Tons | \$4,220.00 | \$ 21.10 |
| Mixed Hardwood ¹ | 3480 Tons | \$62,640.00 | \$ 18.00 |
| Balsam Fir | 180 Tons | \$1,260.00 | \$ 7.00 |
| TOTAL MINIMUM BID VALUE: | | | \$ 68,120.00 |

1.Mix Hardwood Volumes are as follows: 54% Red Maple Pulp Tons / 32% Hard Maple Pulp Tons / 14% White Birch Pulp Tons

1.Ticket books shall be issued when the Contract is signed and periodically thereafter as needed. All tickets shall be accounted for by the Purchaser. Unused tickets shall be returned to the Seller immediately upon completion or termination of the Contract.

2.Lock boxes shall be placed on the premises by the Seller.

3.The Purchaser shall provide the Seller with a list of all destinations of timber to be removed from the premises prior to hauling to the destination. Changes in timber destination shall be reported before hauling to the new destination.

4.The Purchaser agrees to request from the mill that the second portion of the haul permit be returned to the Seller by the mill unless other arrangements are made with the Seller. Further, the Purchaser shall notify the Seller if the mill refuses to provide the second portion of the haul permit to the Seller.

5.Each time a load of cut timber leaves the sale area, the appropriate portion of the ticket shall be clearly and completely filled out and deposited in the lock box.

6.Failure to deposit tickets in the lock box each time a load of cut timber leaves the sale area shall be considered a breach of Contract. Purchaser agrees to pay double the mill rate, as liquidated damages, for such removed timber.

7.Tickets are issued for the Contract specified on the cover of the ticket book and shall not be used for any other Contract.

8.When transporting timber from the sale area, the truck driver shall have in his/her possession the appropriate portion of the ticket applicable to the load.

9.A list of all truckers that will be hauling timber from the premises shall be provided to the Seller by the Purchaser. It shall be the responsibility of the Purchaser to provide such truckers with appropriate ticket books.

10.The Seller may check scale and scale tickets at any time.

11.Truck Delivery: The appropriate portion of the ticket shall be detached at the point where the timber is scaled and attached to a duplicate copy of the scale slip and then immediately returned to the Seller.

12.Rail Car Shipment to a Mill: The appropriate portion of the ticket shall be attached to the bill of lading for the car. At the mill, the ticket shall be attached to a copy of the scale slip, then immediately returned to the Seller.

13.Other

a. Cutting must be concurrent for all species to be harvested.

b. Biomass Harvesting is not allowed.

c. Cutting must be concurrent for all species to be harvested.

d. Do not fall trees in or make skid trails over large areas of advanced regeneration.

e. Retain all trees marked red.

f. Utilize sawlogs to a 10" top diameter and pulpwood to a 4" top diameter.

g. Follow all Wisconsin BMPs.

h. Harvest only in frozen conditions to prevent damage to residual trees, rutting in the pockets of wetter soils and inclusions of wetlands that need to be harvested, and spreading of any future diseases.

i. Each block must be cut separately and completed before beginning on the next block.

j. Slash must be lopped and/or scattered to lie within two feet of the ground and pulled back at least ten feet behind the tree line concurrent with cutting. No tops or slash allowed across any red line, wetland, or within the power line row.

k. Landings will not be permitted within the Riparian Zone or on any of the parking lots or driveways.

l. Existing roads and trails shall be kept free of debris and restored to original condition prior to sale close out or when moving equipment off site.

m. Landings and new road construction must be approved by forester prior to construction.

n. Absolutely no damage or harm to any of the residual trees or seedling/saplings.

**WISCONSIN
DEPARTMENT OF NATURAL RESOURCES
TRACT TF 1-19 BIG EYE
T42N R2E SECTIONS 23, 26, 27
HARVEST ACRES - 139**



Scale: 4"=1 Mile
1:15,840

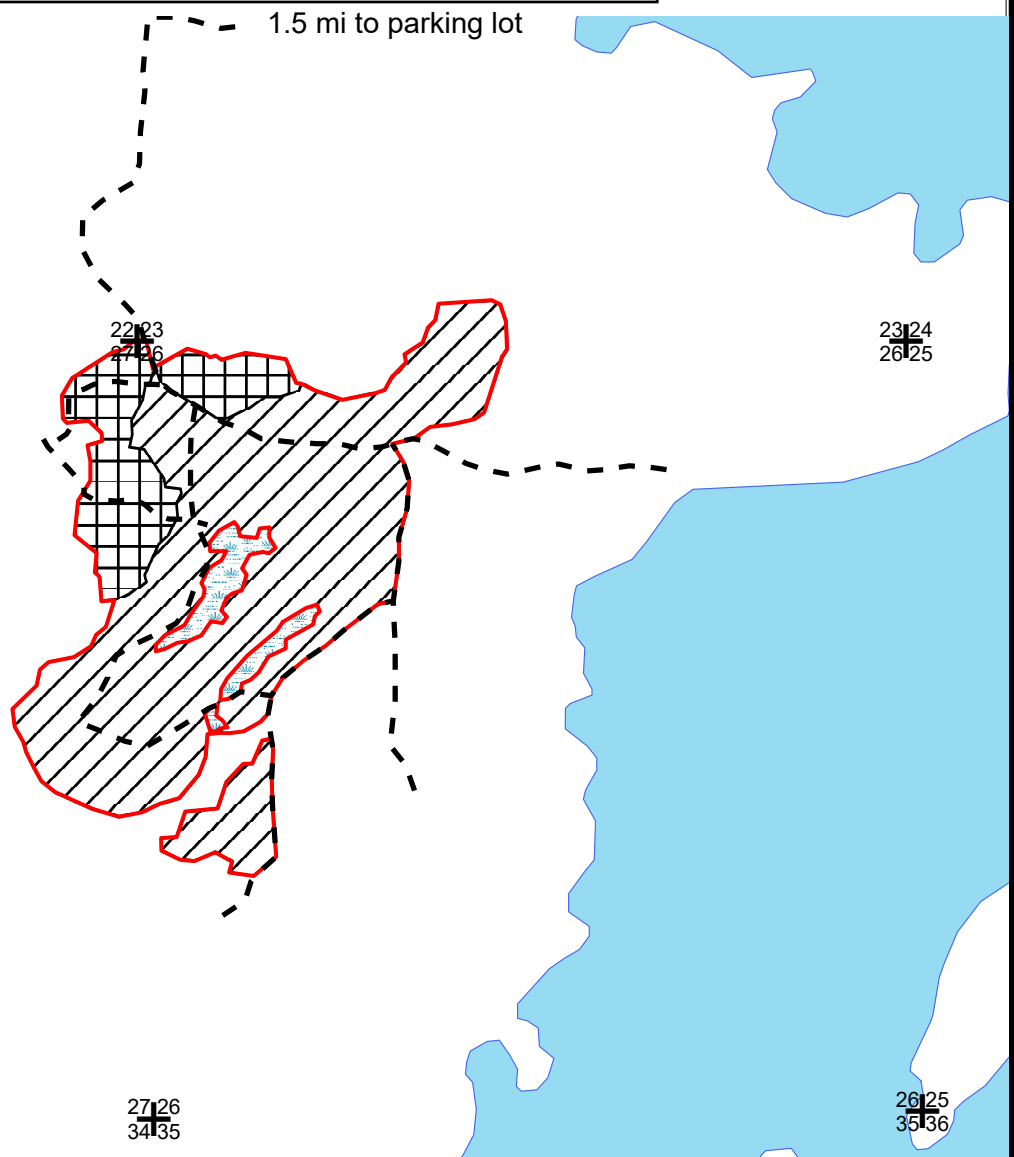

Legend

- Section Corner
- Trails/Roads
- Red Paint Line
- Wetland
- Turtle Flambeau Flowage

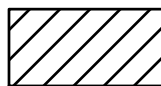

Selection Harvest (116 Ac): Harvest all orange painted trees, aspen, ironwood and balsam fir that are greater than 2" at DBH.



Coppice (23 ac): Harvest everything including ironwood and balsam fir that is greater than 2" at DBH.

Note: Do not harvest any pine, oak, yellow birch, cedar, or hemlock. Do not harvest any red marked trees. Harvest will only occur on frozen ground. This map is not a survey of the actual boundary of any property this map depicts.

These lands are third party certified.

Prepared by: Bryce Berklund DNR Forester (715) 416-4981