

Tract 9-18 (Snake Farm Sale)

Parts of: NE, N1/2NW, W1/2SW, SESW Sec. 3; E1/2SE, NWSE, E1/2SW, SWSW Sec. 4; E1/2NE, E1/2SE Sec. 8; NW, NWSW Sec. 9; T39N-R2W Price County

230 Acres

<u>Species</u>	<u>Estimated Volume</u>	<u>Advertised Value/Unit</u>	
Mixed Pulp ¹	2300 cds	\$ 22.10	
Basswood	200 cds	\$ 3.90	
Ash pulp	450 cds	\$ 12.00	Minimum Acceptable
Aspen	540 cds	\$ 17.60	<u>Bid for Entire Sale</u>
Tamarack	50 cds	\$ 9.20	\$84,429.00
Balsam Fir	165 cds	\$ 10.20	
Spruce	140 cds	\$ 15.30	
Hard Maple	10 MBF	\$208.00	
Red Maple	30 MBF	\$102.00	
Ash	43 MBF	\$ 93.00	
Basswood	27 MBF	\$ 93.00	
Yellow Birch	15 MBF	\$ 98.00	
Mixed Saw ²	5 MBF	\$102.00	

Mixed pulp¹ includes approx. 48% of hard maple, 38% of red maple, 7% yellow birch, 7% elm, cherry, white birch, and ironwood. Mixed Saw² includes 4 MBF white birch and 1 MBF cherry. Other species not mentioned will be charged the mixed pulp price or mixed saw price.

The performance bond will be 15% of the total sale value. Contract length is approximately three years.

SPECIAL SALE CONDITIONS:

Equipment use will be restricted to very dry or frozen ground conditions for entire sale between **December 1st – March 31st** due to management objectives of this area.

Any decking on Ruby Road must have prior approval from the Town of Lake.

If decking on Hunter/Walking Trail or Ruby Road (if allowed), all slash and ends will be removed from the road and ditches concurrently with each truckload. The Hunter/Walking Trail will be kept free of debris.

Use of a continuous rotating saw head will not be allowed in the selection areas or overstory removal area due to density and distribution of regeneration.

It is possible that access roads may be in use for multiple sales at one time. It is the responsibility of the contractors of these sales to determine the logistics for hauling and road maintenance/repairs.

All additional restrictions listed in prospectus and standard contract apply unless specified.

Tract 9-18 (Snake Farm Sale)

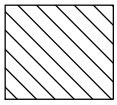

Selection Area (134 acres) – Bounded by red paint, blue paint, young aspen, Ruby Road, and hunter/walking trail. Harvest all orange marked trees within the designated boundaries. Sever all orange marked unmerchantable stems (canopy gaps). Leave, do not cut 1) snags, 2) trees marked with an orange X. Harvest only **marked** aspen.

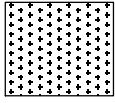

Aspen/Red Maple Area (89 acres) – Bounded by yellow paint, Ruby Road, and hunter/walking trail. Harvest all trees greater than 2 inches except for: 1) white pine, 2) hemlock, 3) oak, 4) cedar.

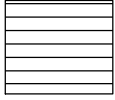

Overstory Removal Area (7 acres) – Bounded by green paint. Harvest all trees greater than 5 inches except for: 1) white pine, 2) hemlock, 3) cedar, 4) green “X” marked trees. **(Intent is to harvest overstory trees and save as much hard maple regeneration as possible.)**

For sale inspection, call 715-332-5271 ext. 106 or ext. 112 for the combination of the lock for the gate. Please do not go around gate.

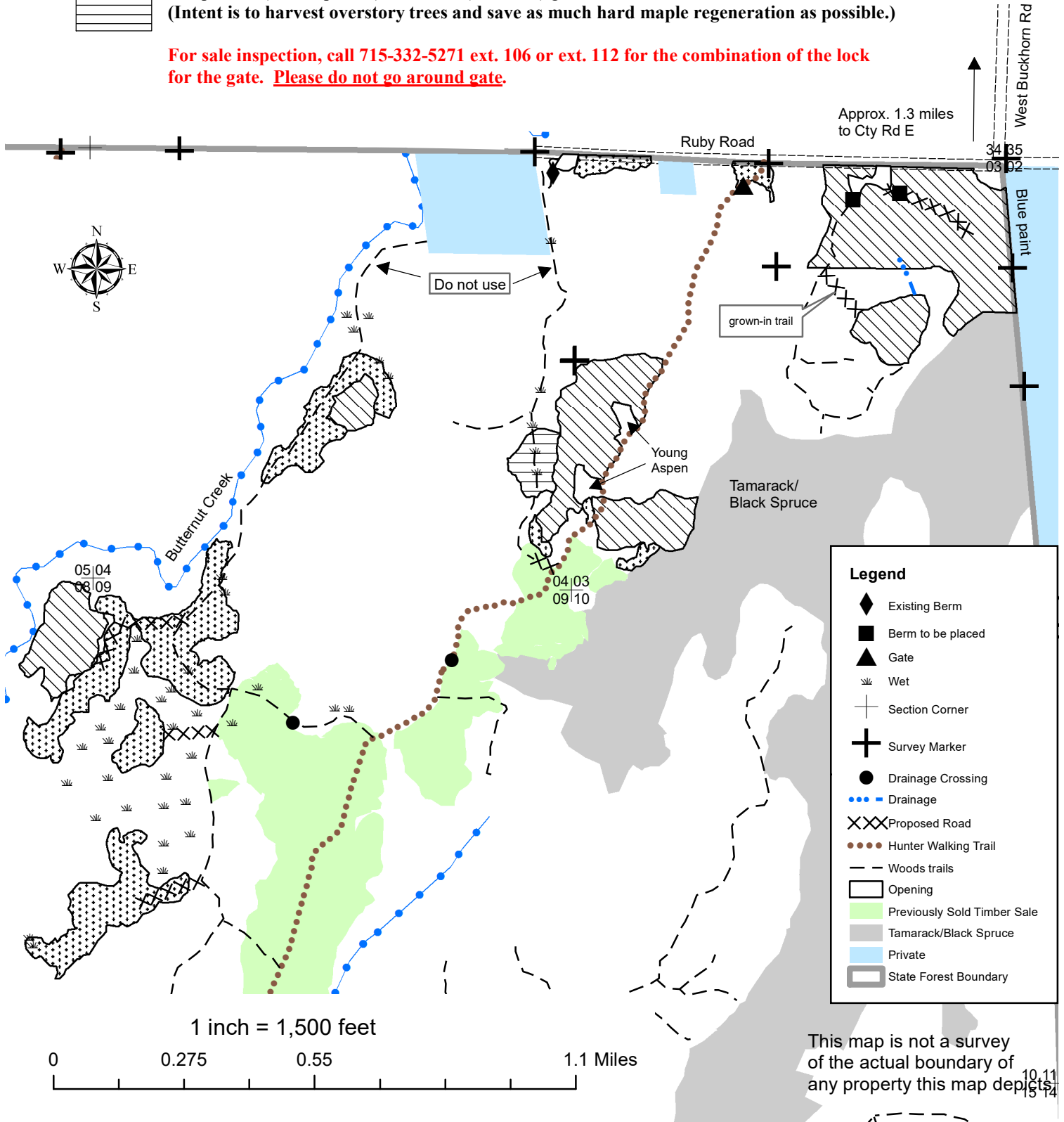

This map is not a survey of the actual boundary of any property this map depicts.