

Tract (PF 1-18) First Sale

Parts of: SE and NE of Section 25 in T41N-R1E in Iron County.

54 Acres

<u>Species</u>	<u>Estimated Volume</u>	<u>Advertised Value/Unit</u>
¹ Mixed Pulp	800 cords	13.60
Aspen	130 cords	12.80
Fir	40 cords	7.20
² White Birch	250 cords	13.40
Spruce	20 cords	10.20
Hard Maple	12 MBF	180.00
³ White Birch	25 MBF	112.00
⁴ Mixed Saw	11 MBF	73.00

Minimum Acceptable
Bid for Entire Sale
\$22,149.00

¹Mixed pulp includes 44% hard maple, 52% red maple, 4% ash, elm, and cherry combined.

⁴Mixed saw includes 9 MBF red maple and 2 MBF ash.

²White birch cordwood includes 2% yellow birch.

³White birch saw includes a small amount of yellow birch.

Other species not mentioned will be charged at the mixed pulp or mixed saw price accordingly.

The performance bond will be 15% of the total sale value. Contract length is approximately two years.

SPECIAL SALE CONDITIONS:

Equipment use will be restricted to very dry or frozen ground conditions due to wet soil conditions.

No cutting can be done during the months of April, May, or June in selection harvest, purple overstory removal area, or overstory removal area, due to bark being more easily damaged at these times.

No pole length skidding will be allowed within the selection area, overstory removal area, or purple overstory removal area.

Use of a continuous rotating saw head will not be allowed in the selection area, overstory removal area, or the purple overstory removal area due to density and distribution of regeneration.

NO DECKING OR SKIDDING ALLOWED ON Hoffman Lake Road without special permission from the property manager.

If decking on Hoffman Lake Road, open road, or the hunter/walking trail all slash and ends will be removed from the roads and ditches concurrently with each truckload.

The hunter/walking trail (main haul road) is used for multiple sales, it is the responsibility of the contractors of sales to determine the logistics for hauling and/or road repair.

All additional restrictions listed in prospectus and standard contract apply unless specified.

Contact for Sale Information: Maggie Lorenz, Park Fall DNR Service Center, 715-492-1970, Margaret.Lorenz@wisconsin.gov

Tract PF 1-18 First Sale



Selection Area(18 acres)- Bounded by red paint, young aspen, and cedar swamp. Harvest all orange marked trees within the designated boundaries. Sever all orange marked unmerchantable stems (canopy gaps). Harvest all merchantable ironwood.



Aspen Area (8 acres)- Bounded by yellow paint and cedar swamp. Cut all trees greater than 2" except for: 1) hemlock, 2) white pine, 3) cedar, 4) oak.



Shelterwood Area (19 acres)- Bounded by yellow paint. Cut all trees greater than 2" except for: 1) hemlock 2)white pine, 3) cedar 4) oak 5) green marked trees. All unmerchantable stems shall be severed.



Overstory Removal Area (3 acres)- Bounded by red paint, young aspen, and cedar swamp. Cut all trees greater than 5" except for: 1) hemlock, 2) cedar, 3) white pine.

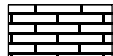

Purple Overstory Removal Area (6 acres)- Bounded by purple paint. Cut all trees greater than 4" except for: 1) hemlock, 2) white pine, 3) cedar, 4) trees marked with purple. **(Intent is to harvest overstory trees and save as much regeneration as possible.)**

- Wet Area
- Private Property
- Gate
- Section Corner
- Hunter Walking Trail
- Open Road
- Woods Road

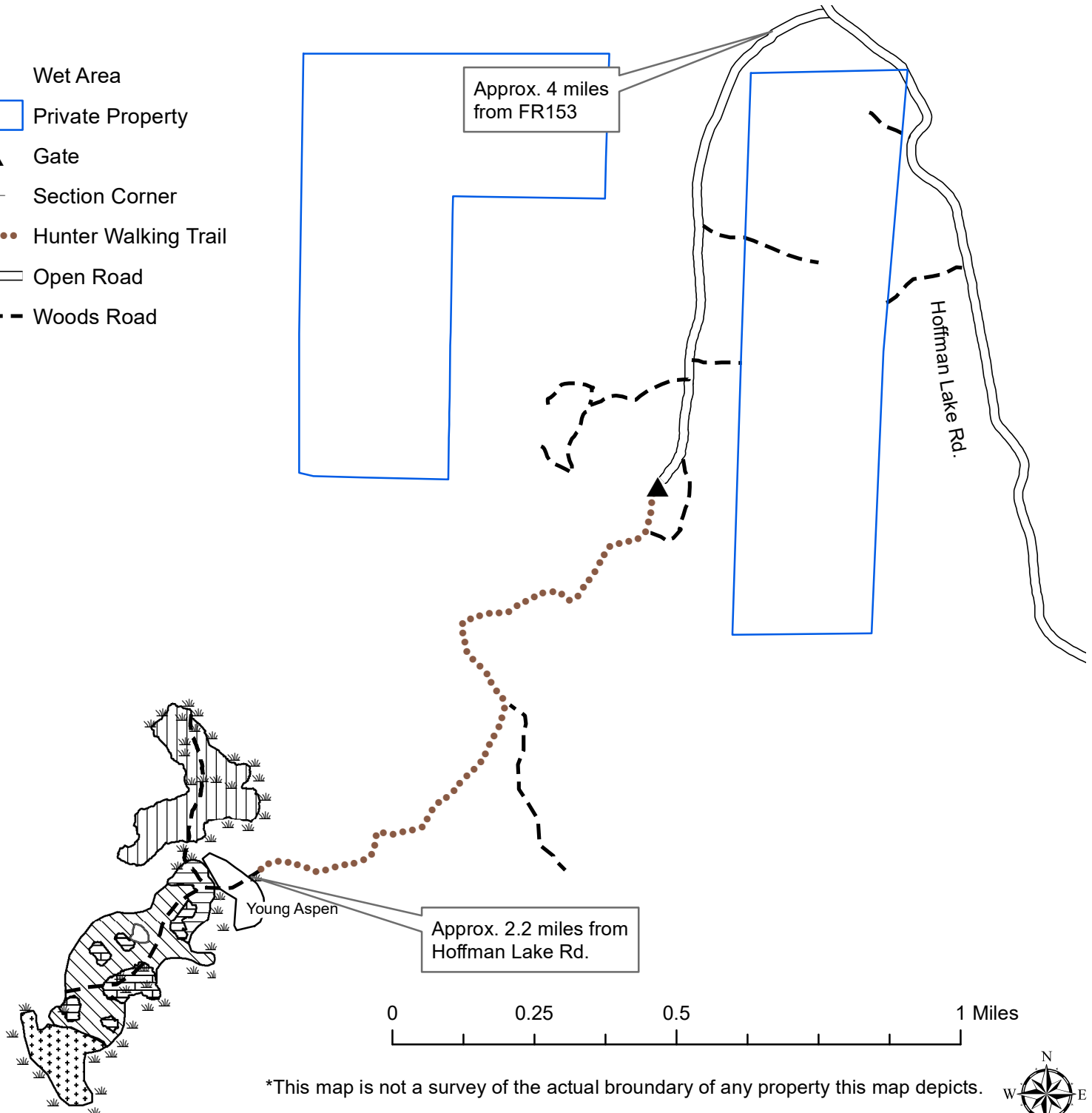

*This map is not a survey of the actual boundary of any property this map depicts.

