



July 9th, 2024

Lincoln and Marathon Counties Timber Sale Information

Sealed bids will be received by mail or in person at the **Wausau Service Center 225051 Rib Mountain Drive Wausau, WI 54401**, up to Wednesday, August 7th, 2024 at 1:00 pm and will be opened immediately thereafter for timber stumpage described in this prospectus. The public may attend in person or if wishing to attend virtually, please register prior to the meeting by calling:

Jeff Sorenson - 715-965-9228; jeff.sorenson@wisconsin.gov Any questions about this bid opening can also be directed to Jeff Sorenson, as well.

This bid opening will be held for 11 tracts on the Big Rib River Fishery Area, Chilsen Demonstration Forest, Prairie River Fishery Area in Lincoln County and on the Mead Wildlife Area and McMillan Wildlife Area in Portage and Marathon Counties.

Big Rib River Fishery Area				Volume			
				Tons	MBF	Tons	
Sale Name	Tract #	Acres	Timber Type	4"	Logs	Whole Tree	Minimum Bid
Silver Fox	3524-01-2024	32	Red pine, MX hardwood, Spruce	1,055	NA	1,350	\$10,174.00
Chilsen Demonstration Forest				Volume			
				Tons	MBF	Tons	
Sale Name	Tract #	Acres	Timber Type	4"	Logs	Whole Tree	Minimum Bid
Arbogast Anguish	3508-01-2024	27	MX hardwood, Ash	400	42	NA	\$6,471.00
Prairie River Fishery Area				Volume			
				Tons	MBF	Tons	
Sale Name	Tract #	Acres	Timber Type	4"	Logs	Whole Tree	Minimum Bid
Prairie Axe	3507-01-2023	36	Tamarack, MX hardwood, Mixed conifer, Aspen	1,455	NA	NA	\$2,327.00
Lawless	3507-01-2024	40	MX hardwood, red pine, aspen, balsam fir	1805	NA	2280	\$6,834.00
Mead Wildlife Area				Volume			
				Tons	MBF	Tons	
Sale Name	Tract #	Acres	Timber Type	4"	Logs	Whole Tree	Minimum Bid
County O	3719-03-2024	56	Aspen, MX hardwood, Oak	3,600	NA	NA	\$18,925.00
Dippin Dot	3719-04-2024	23	MX hardwood, Aspen	1,050	NA	NA	\$6,805.00
Pine Road	3719-06-2024	23	MX hardwood, Aspen	480	NA	NA	\$5,325.00
Quail Lane	3719-01-2024	32	Aspen, MX hardwood	1,300	NA	NA	\$6,110.00
Speedee Chickadee	3719-05-2024	26	MX hardwood, Aspen	1,560	NA	NA	\$12,631.00
Ulman Lane	3719-02-2024	29	Aspen, MX hardwood, Oak	1,290	NA	NA	\$8,292.00
McMillan Wildlife Area				Volume			
				Tons	MBF	Tons	
Sale Name	Tract #	Acres	Timber Type	4"	Logs	Whole Tree	Minimum Bid
Frazzled Pheasant	3718-01-2024	66	MX hardwood, Aspen	2,860	26	NA	\$18,130.00

Sales on the Mead W.A. and McMillan W.A. are mixed product sales for mixed hardwood and oak – ton volumes represent pulp, bolts and logs. See individual sales prospectus for more specific information.

Contact Jeff Sorenson at (715-965-9228) for details on bid results. For tracts not sold on August 7th, 2024, sealed bids may be accepted by mail or in person until September 4th, 2024 at 1 pm.

BIDDING REQUIREMENTS

1. Bidding Procedure for Timber Sales
 - a. Bids will be made by species for each tract.
 - b. Estimated volumes and utilization specifications are listed on individual sale prospectus maps. Bid according to volumes listed on individual sale prospectus and/or maps.
 - c. The **high bidder** will be determined by the **greatest total bid** for each tract.
 - d. Bids will be opened in random order.
 - e. **Bidders in attendance (virtual)** can remove their bid from consideration before each individual tract is opened. Bidders must identify themselves by clearly stating their name, address, and telephone number PRIOR to a bid being opened to withdraw their bid from consideration.
2. Bids may be made on one or more tracts.
3. Submit each bid in an individual sealed envelope marked “Bid for Timber Stumpage” with the timber sale name, and tract number on the outside. Wisconsin DNR Timber Sale Bid Forms must be used to make bids on DNR timber sales and is included with the individual sale prospectus
4. A per unit bid must be made on every item on a tract. No “zero” bids for any species or products will be accepted.
5. Winning bidders will be notified within 24 hours of bid opening and must sign the timber sale contract and submit an acceptable performance bond within 6 weeks of the bid opening. If the winning bidder fails to execute the contract and submit an acceptable performance bond, the bidder shall be required to forfeit to the department an amount equal to 10% of the total bid amount. Failure to forfeit the 10% penalty will result in the bidder being considered ineligible to bid on any state or GNA timber sales for a two-year period.
6. A **Performance Bond or Letter of Credit** is required before awarding of contract. The bond shall be fifteen percent (15%) of the total bid value or a minimum of \$1000.00, whichever is greater. The bond will be held intact by the Department of Natural Resources until the satisfactory completion of the timber sale contract. Performance bonds in a form of other than cash for these sales must expire no earlier than **1-year past contract expiration date**.
7. The Department of Natural Resources reserves the right to reject any and all bids.

SALES TAX CERTIFICATION

1. A [Sales and Use Tax Exemption Certificate](#) must be provided at the signing of the contract. This certificate is required to cover a contractor or individual reselling stumpage harvested for firewood/fuelwood and mills and manufacturing facilities. More information about the certificate can be found at <https://www.revenue.wi.gov/DORForms/s-211-inst.pdf>

UTILIZATION

1. See individual timber sales for utilization specifications.

SCALING AND PAYMENT

1. If eligible for deferred payment option, payment for timber removed from site must be made within 30 days after invoice.
2. If not eligible for deferred payment option, no wood will be hauled from the sale area until advanced payment is made.
3. If sold as a lump sum sale, payment in full must be made on entire sale, or by the cutting block, or by some other means as mutually agreed upon by Department of Natural Resources and contractor.
4. The mill scale ticket system will be used as the preferred method of sale administration. Other scaling systems may be used at the discretion of the Department of Natural Resources.
5. If a woods scale system is used, all cordwood or logs will be piled for scaling. Piles will be level and square with at least 10 cords per pile or 5 MBF. At least 20 cords or 10 MBF will be piled before a scale is requested. Scaling requests must be made at least one day in advance.
6. No refunds of stumpage payments will be made for un-removed wood, and wood left on the sale area at contract expiration shall revert to the seller.
7. Scribner Decimal C Log Rule shall be used for scaling logs. Conversion from MBF to cords or cords to MBF shall be 2.44 cords per MBF for softwoods and 2.2 cords per MBF for hardwoods.
8. Weight scale conversions will be at rates as specified in the Department of Natural Resources timber sale handbook listed below, unless the individual timber sale has specific mixed species pro-rates/conversions.

CORDWOOD WEIGHT CONVERSION FACTORS POUNDS PER CORD

<u>Species</u>	<u>Weight (lbs.)</u>	<u>Weight (tons)</u>	<u>Species</u>	<u>Weight (lbs.)</u>	<u>Weight (tons)</u>
Ash	4600	2.3	Jack pine	4250	2.125
Aspen	4500	2.25	Locust	5300	2.65
Balsam	4250	2.125	Mixed hardwood	4800	2.4
Balsam poplar	4900	2.45	Red oak	5500	2.75
Basswood	3850	1.925	Red pine	4500	2.25
Beech	5050	2.525	Soft maple	4550	2.275
Black Cherry	4300	2.15	Spruce	4000	2.0
Cedar	3150	1.575	Tamarack	4650	2.325
Cottonwood	4650	2.325	White birch	4800	2.4
Elm	5000	2.5	White oak	5850	2.925
Hard maple	5100	2.55	White pine	4200	2.1
Hemlock	4800	2.4	Yellow birch	5350	2.675
Hickory	5400	2.7			

CONTRACT PERIOD

1. All contracts offered during this bid opening will expire on **June 30, 2027.**

CONTRACT EXTENSIONS

Contract extensions will not be granted without justifiable reason. Justification will be determined by the Department of Natural Resources. Contract expiration dates are given on the individual timber sale. Contract extensions are not guaranteed. All extensions, if granted, will be for 1 year. Extension requests will be considered with the following conditions:

One and Two-year contracts

- 1st extension – 5% increase in stumpage rate

- 2nd extension – an additional 10% increase in stumpage rate

Three and Four-year Contracts

- 1st extension – 15% increase in stumpage rate (only 1 extension granted)

OTHER CONDITIONS

1. Wisconsin’s Best Management Practices for Water Quality, Woody Biomass Harvesting Guidelines, and Best Management Practices for Invasive Species must be followed on all DNR timber sales. More information on these management guidelines can be found at the links found below.

Water Quality BMPs: <https://dnr.wi.gov/topic/ForestManagement/bmp.html>

Biomass: <https://councilonforestry.wi.gov/Pages/WoodyBiomass/Default.aspx>

Invasive BMPs: <https://councilonforestry.wi.gov/Pages/InvasiveSpecies/Forestry.aspx>

2. HRD/Oak Wilt requirements: See each sale for specific requirements.
3. See each sale for specific other sale special conditions.

Insurance

The “Contractor” (purchaser) shall provide the Department of Natural Resources with a Certificate of Insurance counter-signed by a Wisconsin Resident Agent, indicating that Worker’s Compensation Insurance coverage is provided for the duration of the contract prior to any performance under it. Contractor claiming exemption, independent status, the contractor/purchaser will be required to submit a signed, notarized affidavit that affirms their exempt status pursuant to the criteria listed in section 102.07(7)(b), of the Wisconsin Statutes.

Contract may contain other provisions. Contracts may not be assigned. A sample copy of the contract is available upon request.

NOTE: Prospectus maps for each of the timber sales are available online at <https://dnr.wisconsin.gov/topic/TimberSales>

*****TRAINING STANDARD*****

The Purchaser shall ensure that at least one in-woods person actively engaged in performance of this contract and responsible for the logging site complies with the Wisconsin Sustainable Forestry Initiative® (SFI®) Training Standard as adopted by the Wisconsin SFI Implementation Committee (SIC). Criteria for the standard can be found at the website https://www.fistausa.org/fista/SFI_Workshops.asp or by contacting the Forest Industry Safety & Training Alliance (FISTA). Purchaser agrees to provide documentation to Seller that the training has been attained prior to initiating sale.

FOREST CERTIFICATION: These lands are 3rd party certified.

Silver Fox
Tract # 3524-01-2024
State of Wisconsin
Big Rib River Fishery Area

Forester Contact Information:
Zach Hylinski
101 Eagle Drive. Merrill, WI 54452
715-921-5611
zachary.hylinski@wisconsin.gov

Legal Description: NWSE & SWSE Sec. 30 & NWNE, NENE, SWNE Sec. 31, T31N R4E – Town of Corning, Lincoln County

(see attached map for location and layout of harvest areas)

Species	Units	Volume*	Whole Tree Volume*
Red Pine ¹	Tons	1,000	1,280
Mixed Hardwood ²	Tons	25	30
Spruce ³	Tons	30	40
Total		1,055	1,350

*All volumes use DNR standard weight conversions

¹ Includes approx. 59 MBF Red Pine

² Approx. 80% red maple, 20% ash

³ Approx. 80% spruce, 20% balsam fir

Sale method: Mill scale

Contract length and end date: Three years or June 30, 2027

Minimum advertised value: \$ 7,031.00

Acres: 32

Cutting Specifications

- Unit 1 – Pine thinning area – 32 acres: Cut all orange-marked trees. Only shortwood skidding allowed in sale. Red & Blue paint represent the end of some of the harvest unit. Along Silver Fox Road the harvest area ends with the orange marked trees.
- All harvested pieces with at least a 4-inch diameter on the small end must be utilized.
- Whole tree harvesting is permitted on this sale only with short wood skidding. 1 in 10 tops must remain on site if whole tree is utilized.

Operational Considerations-

- Verbal permission given from adjacent landowner to harvest area (see map & Landowner has access to Hwy. 64 directly as well). Agreement to use access is between the Contractor and the Landowner (Brandon Zinkowich – 920-851-7360) or through DNR land, however this would require a stream crossing permit. Prior notification to DNR is needed for the stream crossing.
- Harvesting operations must occur only during dry or frozen-ground conditions determined by the DNR Forester. Operations will be suspended during wet periods when soil is susceptible to rutting and excessive compaction.
- The Contractor is responsible for working with the Township when operating near Silver Fox Road. The road and snowmobile trails shall have signs posted (responsibility of the Contractor) when working near that location.
- Contractor must adhere to Timber Sale Contract rutting standards and Wisconsin Best Management Practices for Water Quality. This sale has a 100' no cut buffer along the Big Rib River, except along Silver Fox Road. Here the buffer varies to address a forest health concern.
- New roads and landings must be approved by a state forester prior to building.

- All roads and landings must be restored to pre-sale condition and seeded with a DNR approved seed mix
- Equipment operations outside of harvest boundaries are prohibited; trees felled over harvest boundary lines must be pulled back into the sale area before being limbed and topped.
- Do not cut standing dead trees, unless leaving them represents a hazard to operator safety.
- Do not cut any trees marked with red or blue paint.
- Contractor must properly disperse slash throughout the sale. Slash may not exceed 3 feet in height. Slash must be kept off landings, parking areas, town and woods roads, and private property. Stump heights must be no greater than the diameter of the stump or 12 inches, whichever is less.
- Harvesting equipment must be power washed and be free and clear of debris before entering sale. Inspection by DNR agent is needed prior to cutting can begin.
- Between May 1st and August 31st, all cut pine and spruce must be hauled within 2 weeks.
- **SPECIAL CONDITIONS:** All Pine and Spruce will require HRD (heterbasidion root disease) prevention treatment by the contractor if cut between April 1st and November 30th.
 1. The contractor shall purchase and apply an approved fungicide to all cut Pine and Spruce stumps and horizontal wound surfaces.
 2. Pesticide applicators must be certified/licensed by DATCP for this treatment.
 3. All stumps shall be treated by the end of each day.
 4. All stumps shall be left clear of logging slash to allow for the application and inspection of the approved fungicide.
 5. A marker dye shall be added to the solution to monitor application coverage.
- **Modifications to HRD treatment:**
 1. Prolonged, unusually warm weather during the winter period (December 1 - March 31), treatment may be recommended.
 2. Prolonged, unusually cold weather outside the winter period (outside of December 1 - March 31), treatment may not be necessary.
 3. Deep snow cover (at least 12 inches) outside of the winter period (outside of December 1 - March 31), treatment may not be necessary

Timber Sale Name: Silver Fox
Tract: 3524-01-24
Property Owner: State of Wisconsin
Name of Property: Big Rib River Fishery Area

Species	Volume	Whole Tree
Red Pine	1,000 Tons	1,280 Tons
Mixed Hardwood	25 Tons	30 Tons
Spruce	30 Tons	40 Tons
Total	1,055 Tons	1,350 Tons

Legal Description: NWSE & SWSE Sec. 30 & NWNE, NENE, SWNE Sec. 31,
 T31N R4E – Town of Corning, Lincoln County

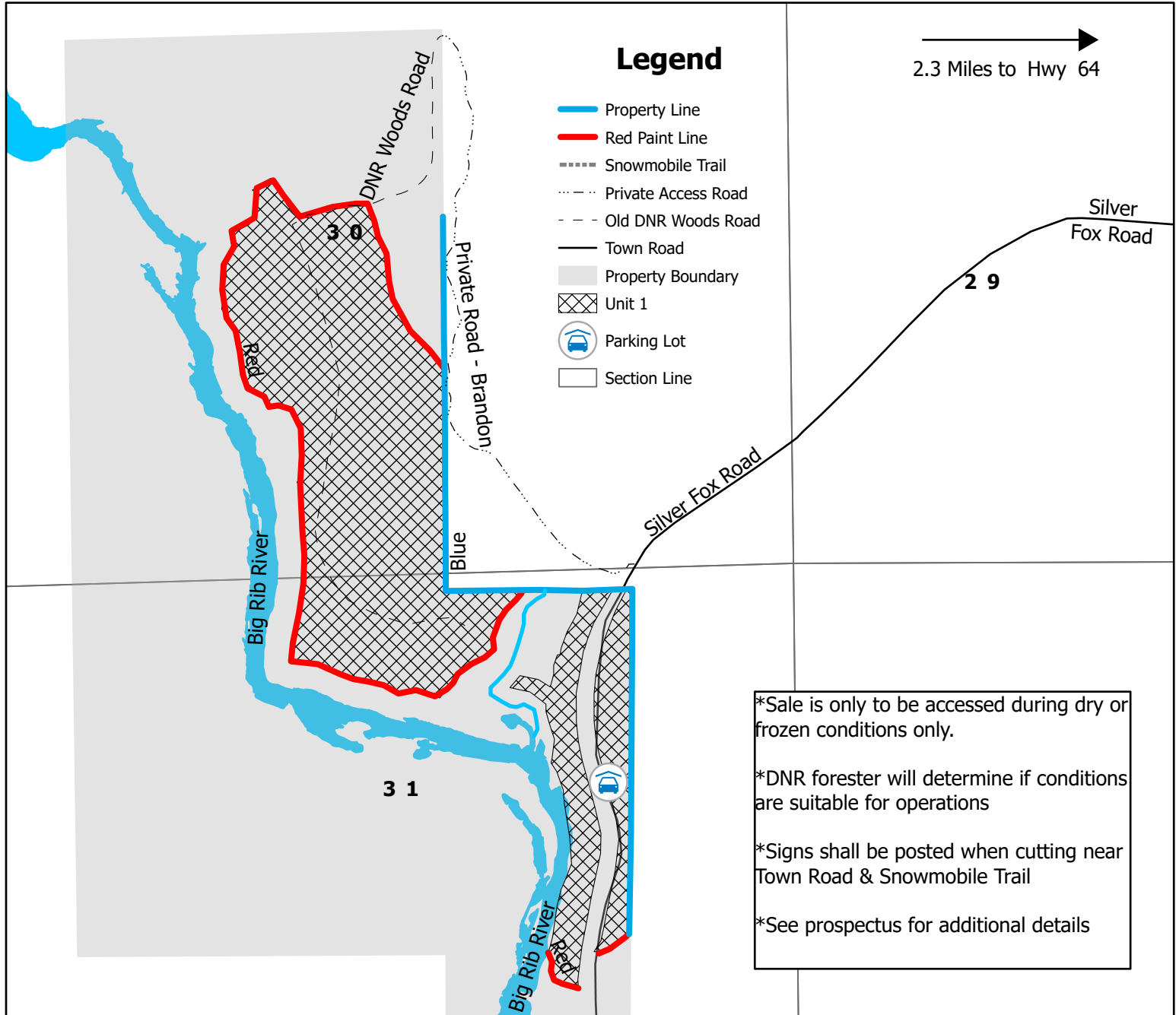

Unit 1: Red Pine Thinning (32 acres) - Harvest all orange marked trees

Contract End Date: June 30, 2027
Sale Method: Mill Scale



This map is for informational purposes only and may not have been prepared for or be suitable for legal, engineering or surveying purposes. The user is solely responsible for verifying the accuracy of information before using for any purpose.
 Mapped: Zach Hylinski

Notice: Completion of this form is mandatory. The Department will not recognize your bid unless you complete and submit this form. Personal information collected will be used for program administration and may be provided to requesters as required by Wisconsin's Public Records law [ss. 19.31-19.39, Wis. Stats.].

Date

Bidder Name

Street Address

City

State

ZIP Code

Property Name (if any)

Big Rib River Fishery Area

Timber Sale Name

Silver Fox

Tract Number

3524-01-2024

Date and Hour of Bid Opening

8/7/24 1PM

Minimum Acceptable Bid (optional)

\$7,031.00

Species-All bids including Lump Sum bids must be by species	Utilization Specifications (4 inch/Whole Tree/Logs)	Estimated Volume	Volume Units (tons/cords/mbf)	Price Bid Per Unit	Total Bid Value on Estimated Volume
Red Pine			tons		
Mixed Hardwood			tons		
Spruce			tons		

The award shall be based on this TOTAL BID AMOUNT:

Performance Bond

Will be in the form of: (select one)

Personal Check

Assurance Bond

Certified Check/Money Order

Certificate of Deposit

Irrevocable Letter of Credit

Assignment of Savings Account

I understand that any or all bids may be rejected and that consideration and awarding of a contract will be based upon my past performance and ability to complete contracts. **I also understand that if I am the winning bidder, I have 6 weeks from the date of the bid opening to submit an acceptable performance bond. I also understand that if I am awarded the contract and fail to execute it or work under it, I will be required to forfeit to the Department an amount equal to 10% of my total bid amount.** Failure to forfeit the 10% penalty will result in being considered ineligible to bid on any state timber sales for a two-year duration. In the event the highest bidder can not or will not sign the contract, the award may be made to the next highest qualified bid.

By checking this box, I certify that I hold a Wisconsin Master Logger Certification.

Notice: I understand:

Utilization specifications and estimated volumes are listed in the prospectus which is available upon request from the Department.

A copy of the standard timber sales contract which must be entered into is available upon request from the Department.

Signature of Bidder

Bidder's Name (Please Print or Type)

Phone Number (include area code)

Email Address

**Arbogast Anguish
Tract # 3508-01-2024
State of Wisconsin
Chilsen Demonstration Forest**

Forester Contact Information:
Zach Hylinski
101 Eagle Drive. Merrill, WI 54452
715-921-5611
zachary.hylinski@wisconsin.gov

Legal Description: SWNW Sec. 30 of T32N R8E - Town of Schley, Lincoln County
(see attached map for location and layout of harvest areas)

Species	Units	Volume*
Mixed Hardwood ¹	Tons	400
Ash	MBF	26
Sugar Maple	MBF	5
Basswood	MBF	7
Red Maple	MBF	3
Red Oak	MBF	1

*All volumes use DNR standard weight conversions

¹ Includes 1 ton of balsam fir which can be utilized or just felled unutilized.

Sale method: Mill scale
Contract length and end date: Three years or June 30, 2027
Minimum advertised value: \$6,471.00
Acres: 27

Cutting Specifications

- Unit 1 – Salvage – 4 acres: Harvest all trees at 45-degree angle or 50% of the crown removed (discuss at pre-sale), ash and ironwood. All red oak shall not be cut. Exterior of the harvest area marked with trees with a red band. A red dot faces into the salvage area. Red marked trees shall not be cut. Tip up mounds from root balls shall be retained at 2-6 per acre. Hemlock in this area will be left “as is” unless an issue to the Contractor to aid in tip up mound retention. Some blown over trees may require Contractor to position stump & root ball to achieve density of 2-6 per acre.
- Unit 2 – Marked Salvage/Sanitation - 23 acres: Harvest all orange marked trees and merchantable ironwood. Exterior of the area is marked with blue paint (property line) or red paint.
- All harvested pieces with at least a 4-inch diameter on the small end must be utilized.
- Only short wood skidding is allowed for this harvest.

Operational Considerations-

- Timber Harvesting is allowed from July 16th – February 28th (No harvesting from March 1st - July. 15th). Any deviations would depend on temperature the year of harvest and shouldn't be anticipated.
- Harvesting operations must occur only during dry or frozen-ground conditions determined by the DNR forester. Operations will be suspended during wet periods when soil is susceptible to rutting and excessive compaction.
- Snowmobile trail runs through part of the timber sale (see map). Slash must be removed from the snowmobile trail daily concurrently with cutting when operating in that area. Signs shall be posted (responsibility of the Contractor) when working near that location. Snow cover must be left on the trail.
- Wisconsin Best Management Practices for Water Quality and Invasive Species shall be followed.

- New roads and landings must be approved by a state forester prior to building.
- All roads, trails, gates, and landings must be restored to pre-sale condition and seeded with a DNR approved seed mix.
- Equipment operations outside of harvest boundaries are prohibited; trees felled over harvest boundary lines must be pulled back into the sale area before being limbed and topped.
- Do not cut standing dead trees (outside of unit 1 or marked with orange paint), unless leaving them represents a hazard to operator safety.
- Do not cut any trees marked with red or blue paint.
- Contractor must properly disperse slash throughout the sale. Slash may not exceed 3 feet in height. Slash must be kept off landings, parking areas, town and woods roads, and private property. Stump heights must be no greater than the diameter of the stump or 12 inches, whichever is less.
- Harvesting equipment must be power washed and be free and clear of debris before entering sale. Inspection by DNR agent is needed prior to cutting can begin.

Timber Sale Name: Arbogast Anguish

Tract: 3508-01-24

Property Owner: State of Wisconsin

Name of Property: Chilsen Demonstration Forest

Legal Description: SWNW, Sec. 30 of T32N R8E

Town of Schley, Lincoln County

Species	Product	Volume
Mixed Hardwood	Tons	400
Ash	MBF	26
Sugar Maple	MBF	5
Basswood	MBF	7
Red Maple	MBF	3
Red Oak	MBF	1

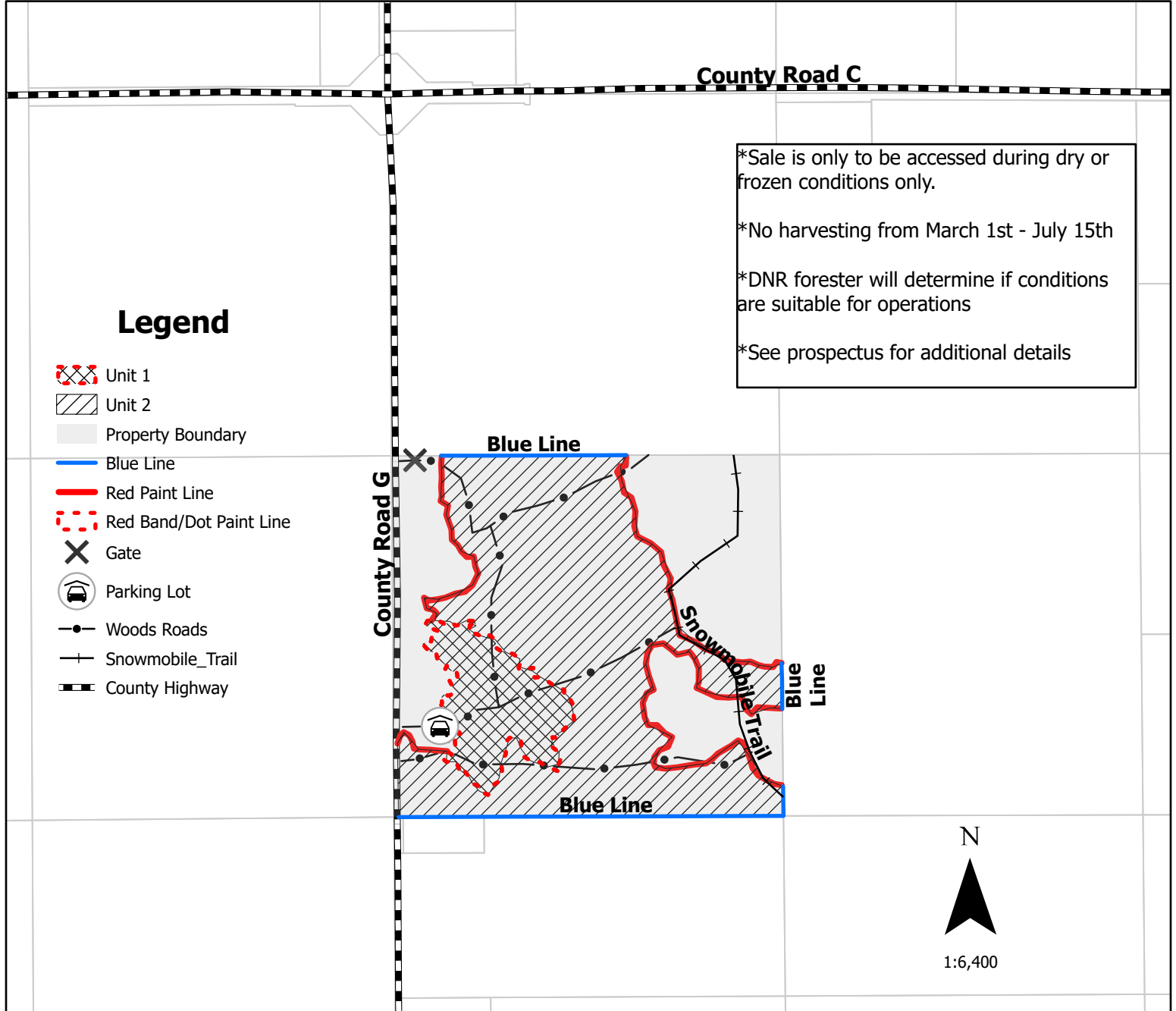

Unit 1: Salvage (4 acres) - Harvest all trees at 45 degree angle or 50% of the crown removed (discuss at pre-sale), ash & ironwood. All red oak shall not be cut.

Unit 2: Marked Salvage (23 acres) - Harvest all orange marked trees.

Contract End Date: June 30, 2027

Sale Method: Mill Scale

This map is for informational purposes only and may not have been prepared for or be suitable for legal, engineering or surveying purposes. The user is solely responsible for verifying the accuracy of information before using for any purpose. By using this product for any purpose user agrees to be bound by all disclaimers found here: <https://dnr.wisconsin.gov/legal>

Mapped: Zach Hylinski

Notice: Completion of this form is mandatory. The Department will not recognize your bid unless you complete and submit this form. Personal information collected will be used for program administration and may be provided to requesters as required by Wisconsin's Public Records law [ss. 19.31-19.39, Wis. Stats.].

Date

Bidder Name

Street Address	City	State	ZIP Code
----------------	------	-------	----------

Property Name (if any) Chilsen Demonstration Forest	Timber Sale Name Arbogast Anguish	Tract Number 3508-01-2024
--	--------------------------------------	------------------------------

Date and Hour of Bid Opening 8/7/24 1PM	Minimum Acceptable Bid (optional) \$6,471.00
--	---

Species-All bids including Lump Sum bids must be by species	Utilization Specifications (4 inch/Whole Tree/Logs)	Estimated Volume	Volume Units (tons/cords/mbf)	Price Bid Per Unit	Total Bid Value on Estimated Volume
Mixed Hardwood	4 inch top	400	tons		
Ash	Logs	26	MBF		
Sugar Maple	Logs	5	MBF		
Basswood	Logs	7	MBF		
Red Maple	Logs	3	MBF		
Red Oak	Logs	1	MBF		

The award shall be based on this TOTAL BID AMOUNT:

Performance Bond

Will be in the form of: (select one)

- | | |
|--|---|
| <input type="radio"/> Personal Check | <input type="radio"/> Assurance Bond |
| <input type="radio"/> Certified Check/Money Order | <input type="radio"/> Certificate of Deposit |
| <input type="radio"/> Irrevocable Letter of Credit | <input type="radio"/> Assignment of Savings Account |

I understand that any or all bids may be rejected and that consideration and awarding of a contract will be based upon my past performance and ability to complete contracts. **I also understand that if I am the winning bidder, I have 6 weeks from the date of the bid opening to submit an acceptable performance bond. I also understand that if I am awarded the contract and fail to execute it or work under it, I will be required to forfeit to the Department an amount equal to 10% of my total bid amount.** Failure to forfeit the 10% penalty will result in being considered ineligible to bid on any state timber sales for a two-year duration. In the event the highest bidder can not or will not sign the contract, the award may be made to the next highest qualified bid.

By checking this box, I certify that I hold a Wisconsin Master Logger Certification.

Notice: I understand:

Utilization specifications and estimated volumes are listed in the prospectus which is available upon request from the Department.

A copy of the standard timber sales contract which must be entered into is available upon request from the Department.

Signature of Bidder
Bidder's Name (Please Print or Type)
Phone Number (include area code)
Email Address

Prairie Axe
Tract # 3507-01-2023
State of Wisconsin
Prairie River Fishery Area

Forester Contact Information:
Zachary Hylinski / Timothy Allen
101 Eagle Dr. Merrill, WI 54452
Zachary.hylinski@wisconsin.gov - 715-921-5611
Timothyc.allen@wisconsin.gov – 715-965-8547

Legal Description: Part of SENE Section 31 and part of NWNW, NENW, and SWNW Section 32 of T33N R8E - Town of Russell, Lincoln County (see attached map for location and layout of harvest areas)

Species	Units	Volumes*
Tamarack ¹	Tons	450
Red maple ²	Tons	260
Spruce ³	Tons	240
Aspen	Tons	210
Balsam fir	Tons	150
Red Pine ⁴	Tons	95
White pine ⁵	Tons	50
Total		1,455

*All volumes use DNR standard weight conversions

¹ Includes approx. 20 MBF tamarack

² Red maple volume is approx. 65% red maple, 30% ash, 5% cherry and includes approx. 5 MBF red maple

³ Includes approx. 10 MBF spruce

⁴ Includes approx. 8 MBF red pine

⁵ Includes approx. 3 MBF white pine

Sale method: Mill scale

Contract length and end date: Three years or June 30, 2027

Minimum advertised value: \$ 2,327.00

Acres: 36

Cutting Specifications

- Unit 1 – Aspen coppice and conifer seedtree regeneration harvest area - 28 acres: Cut all stems greater than 1 inch (DBH) except for oak, white cedar, and green-marked trees. Operating in alder pockets is prohibited; cutting specifications do not apply to tag alder-dominated pockets. Town roads, agriculture field and red paint lines represent the cutting boundaries of this unit. Do not cut within yellow-lined reserve tree areas.
- Unit 2 – Pine thinning area – 8 acres: Cut all orange-marked trees, balsam fir, spruce, tamarack, aspen, and red maple stems greater than 4 inches (DBH). Town roads, parking area, young aspen, and red/blue paint lines represent the cutting boundaries of this unit. Only shortwood skidding allowed in Unit 2.
- All harvested pieces with at least a 4 inch top diameter must be utilized.
- Whole tree harvesting is NOT permitted on this sale.

Operational Considerations-

- Harvesting operations must occur only during sufficiently dry or frozen-ground conditions. Operations will be suspended during wet periods when soil is susceptible to rutting and excessive compaction.
- Contractor must adhere to Timber Sale Contract rutting standards and Wisconsin Best Management Practices for Water Quality.

- New roads and landings must be approved by a state forester prior to building. Roads and landings must be restored to pre-sale condition.
- Equipment operations outside of harvest boundaries are prohibited; trees felled over harvest boundary lines must be pulled back into the sale area before being limbed and topped. Trees felled into field areas or wildlife openings must also be pulled back into the sale area before being limbed and topped.
- Minimize damage to green-marked and other designated leave trees.
- Do not cut standing dead trees, unless leaving them represents a hazard to operator safety.
- Do not cut any trees marked with Green, Red, Blue, or Yellow paint.
- Contractor must properly disperse slash throughout the sale. Slash may not exceed 3 feet in height. Slash must be kept off landings, agriculture fields, wildlife opening, parking areas, town and woods roads, and private property. Stump heights must be no greater than the diameter of the stump or 12 inches, whichever is less.
- Harvesting equipment must be power washed and be free and clear of debris before entering sale. Inspection by DNR agent is needed prior to cutting can begin.
- Between May 1st and August 31st, all cut pine and spruce must be hauled within 2 weeks.
- **SPECIAL CONDITIONS:** All Pine and Spruce will require HRD (heterbasidion root disease) prevention treatment by the contractor if cut between April 1st and November 30th.
 1. The contractor shall purchase and apply an approved fungicide to all cut Pine and Spruce stumps and horizontal wound surfaces.
 2. Pesticide applicators must be certified/licensed by DATCP for this treatment.
 3. All stumps shall be treated by the end of each day.
 4. All stumps shall be left clear of logging slash to allow for the application and inspection of the approved fungicide.
 5. A marker dye shall be added to the solution to monitor application coverage.
- **Modifications to HRD treatment:**
 1. Prolonged, unusually warm weather during the winter period (December 1 - March 31), treatment may be recommended.
 2. Prolonged, unusually cold weather outside the winter period (outside of December 1 - March 31), treatment may not be necessary.
 3. Deep snow cover (at least 12 inches) outside of the winter period (outside of December 1 - March 31), treatment may not be necessary

Timber Sale Name: Prairie Axe
Tract #: 3507-01-2023
Property Owner: State of Wisconsin
Name of Property: Prairie River Fishery Area

Legal Descriptions: Part of SENE Section 31
and part of NWNW, NENW, and SWNW Section 32
of T33N R8E - Town of Russell, Lincoln County

Volumes*

Species	Tonnage
Tamarack	450 tons
Red maple	260 tons
Spruce	240 tons
Aspen	210 tons
Balsam fir	150 tons
Red pine	95 tons
White pine	50 tons
Totals	1455 tons

* See prospectus for additional details

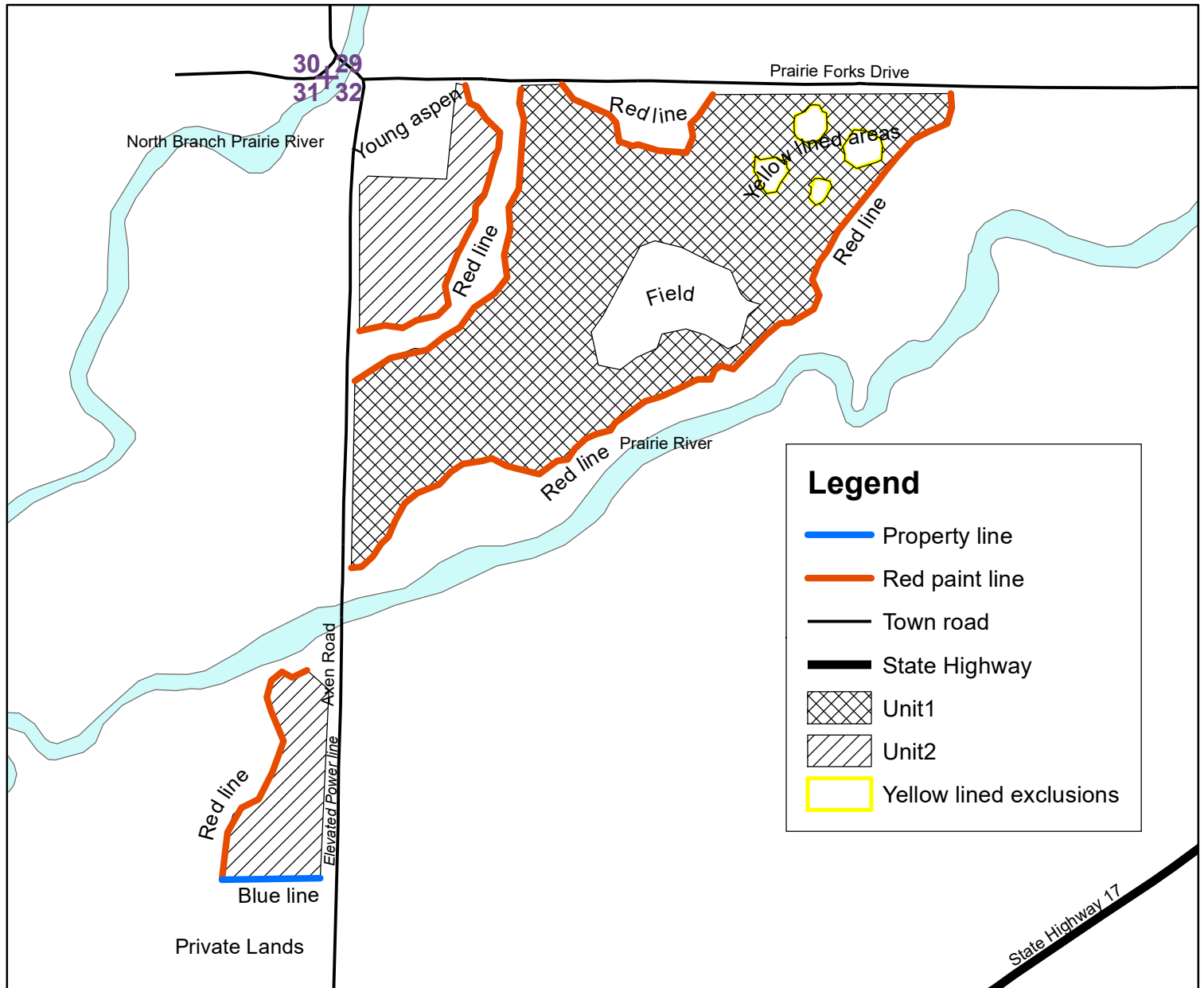

Unit 1 - Regeneration harvest - aspen coppice / conifer seedtree.

Harvest all stems greater than 1 inch (DBH) except oak, cedar, & green-marked trees.

28 acres (includes 1 acre of reserve trees)

Unit 2 - Red pine thinning. Harvest all orange-marked trees and non-pine stems greater than 4 inches (DBH). 8 acres.

Contract Ending Date: June 30, 2027

Sale Method: Mill scale

This map is for informational purposes only and may not have been prepared for or be suitable for legal, engineering or surveying purposes. The user is solely responsible for verifying the accuracy of information before using for any purpose.

Mapped by: Timothy Allen

0 150 300 600 Feet

Notice: Completion of this form is mandatory. The Department will not recognize your bid unless you complete and submit this form. Personal information collected will be used for program administration and may be provided to requesters as required by Wisconsin's Public Records law [ss. 19.31-19.39, Wis. Stats.].

Date

Bidder Name			
-------------	--	--	--

Street Address	City	State	ZIP Code
----------------	------	-------	----------

Property Name (if any) Prairie River Fishery Area	Timber Sale Name Prairie Axe	Tract Number 3507-01-2023
--	---------------------------------	------------------------------

Date and Hour of Bid Opening 8/7/24 1PM	Minimum Acceptable Bid (optional) \$2,327.00
--	---

Species-All bids including Lump Sum bids must be by species	Utilization Specifications (4 inch/Whole Tree/Logs)	Estimated Volume	Volume Units (tons/cords/mbf)	Price Bid Per Unit	Total Bid Value on Estimated Volume
Tamarack	4 inch top	450	tons		
Red maple	4 inch top	260	tons		
Spruce	4 inch top	240	tons		
Aspen	4 inch top	210	tons		
Balsam fir	4 inch top	150	tons		
Red pine	4 inch top	95	tons		
White pine	4 inch top	50	tons		

The award shall be based on this TOTAL BID AMOUNT:

Performance Bond Will be in the form of: (select one)

Personal Check
 Assurance Bond
 Certified Check/Money Order
 Certificate of Deposit
 Irrevocable Letter of Credit
 Assignment of Savings Account

I understand that any or all bids may be rejected and that consideration and awarding of a contract will be based upon my past performance and ability to complete contracts. **I also understand that if I am the winning bidder, I have 6 weeks from the date of the bid opening to submit an acceptable performance bond. I also understand that if I am awarded the contract and fail to execute it or work under it, I will be required to forfeit to the Department an amount equal to 10% of my total bid amount.** Failure to forfeit the 10% penalty will result in being considered ineligible to bid on any state timber sales for a two-year duration. In the event the highest bidder can not or will not sign the contract, the award may be made to the next highest qualified bid.

By checking this box, I certify that I hold a Wisconsin Master Logger Certification.

Notice: I understand:

Utilization specifications and estimated volumes are listed in the prospectus which is available upon request from the Department.

A copy of the standard timber sales contract which must be entered into is available upon request from the Department.

Signature of Bidder
Bidder's Name (Please Print or Type)
Phone Number (include area code)
Email Address

Lawless
Tract # 3507-01-2024
State of Wisconsin
Prairie River Fishery Area

Forester Contact Information:
Zach Hylinski
101 Eagle Drive. Merrill, WI 54452
715-921-5611
zachary.hylinski@wisconsin.gov

Legal Description: NWNE, SWNW, NESW, SESW, SWSW Sec. 2 of T33N R8E - Town of Russell, Lincoln County

(see attached map for location and layout of harvest areas)

Species	Units	Volume*	Whole Tree Volume*
Mixed Hardwood ¹	Tons	1,125	1,440
Aspen	Tons	250	300
Red Pine ²	Tons	380	480
Fir	Tons	50	60
Total		1,805	2,280

*All volumes use DNR standard weight conversions

¹ Approx. 48% ash (includes 9 MBF), 40% red maple (includes 8 MBF), 5% basswood (includes 1 MBF), 4% yellow birch, 3% sugar maple

² Approx. 96% red pine, 4% spruce

Sale method: Mill scale

Contract length and end date: Three years or June 30, 2027

Minimum advertised value: \$ 6,834.00

Acres: 40

Cutting Specifications

- Unit 1 – Regeneration Harvest – 20 acres: Harvest all stems greater than 1" except green, blue, or red marked trees
- Unit 2 - Red Pine Thinning - 20 acres: Harvest all orange marked trees
- All harvested pieces with at least a 4-inch diameter on the small end must be utilized.
- Whole tree harvesting is permitted on this sale only with short wood skidding. 1 in 10 tops must remain on site if whole tree is utilized.

Operational Considerations-

- Timber Harvesting is allowed from Nov. 16th – March 4th (No harvesting from March 5th - Nov. 15th). Any deviations would depend on species activity the year of harvest and shouldn't be anticipated.
- Site will be underplanted in some of unit 1 locations the spring prior to harvest. Contactor must contact the Seller July 1st prior to harvest (approximately 1 year prior) so site can be underplanted. Communication between Contractor and Seller will be imperative prior to harvesting begins.
- Access to the pine stand off R and H Road is possible from Hackbarths Drive. Access could be done through DNR easement (very wet requiring well frozen ground) or through adjacent landowner. Agreement to use access through private land is between the Contractor and the Landowner (Randy Hess – 507-261-3737).
- Harvesting operations must occur only during dry or frozen-ground conditions determined by the DNR forester. Operations will be suspended during wet periods when soil is susceptible to rutting and excessive compaction.

Contractor must adhere to Timber Sale Contract rutting standards and Wisconsin Best Management Practices for Water Quality. This sale has a 100' no cut buffer along the Prairie River. No harvesting or reaching into the 100' buffer will be allowed.

- New roads and landings must be approved by a state forester prior to building.
- All roads, trails and landings must be restored to pre-sale condition and seeded with a DNR approved seed mix
- Equipment operations outside of harvest boundaries are prohibited; trees felled over harvest boundary lines must be pulled back into the sale area before being limbed and topped.
- Do not cut standing dead trees, unless leaving them represents a hazard to operator safety.
- Do not cut any trees marked with green, red or blue paint.
- Contractor must properly disperse slash throughout the sale. Slash may not exceed 3 feet in height. Slash must be kept off landings, parking areas, town and woods roads, and private property. Stump heights must be no greater than the diameter of the stump or 12 inches, whichever is less.
- Harvesting equipment must be power washed and be free and clear of debris before entering sale. Inspection by DNR agent is needed prior to cutting can begin.
- **SPECIAL CONDITIONS:** All Pine and Spruce will require HRD (heterbasidion root disease) prevention treatment by the contractor if cut between April 1st and November 30th.
 1. The contractor shall purchase and apply an approved fungicide to all cut Pine and Spruce stumps and horizontal wound surfaces.
 2. Pesticide applicators must be certified/licensed by DATCP for this treatment.
 3. All stumps shall be treated by the end of each day.
 4. All stumps shall be left clear of logging slash to allow for the application and inspection of the approved fungicide.
 5. A marker dye shall be added to the solution to monitor application coverage.
- **Modifications to HRD treatment:**
 1. Prolonged, unusually warm weather during the winter period (December 1 - March 31), treatment may be recommended.
 2. Prolonged, unusually cold weather outside the winter period (outside of December 1 - March 31), treatment may not be necessary.
 3. Deep snow cover (at least 12 inches) outside of the winter period (outside of December 1 - March 31), treatment may not be necessary

Timber Sale Name: Lawless
Tract: 3507-01-24
Property Owner: State of Wisconsin
Name of Property: Prairie River Fishery Area

Species	Volume	Whole Tree
Mixed Hardwood	1,125 Tons	1,440 Tons
Aspen	250 Tons	300 Tons
Red Pine	380 Tons	480 Tons
Fir	50 Tons	60 Tons
Total	1,805 Tons	2,280 Tons

Legal Description: NWNE, SWNW, NESW, SESW, SWSW Sec. 2 of T33N R8E - Town of Russell, Lincoln County

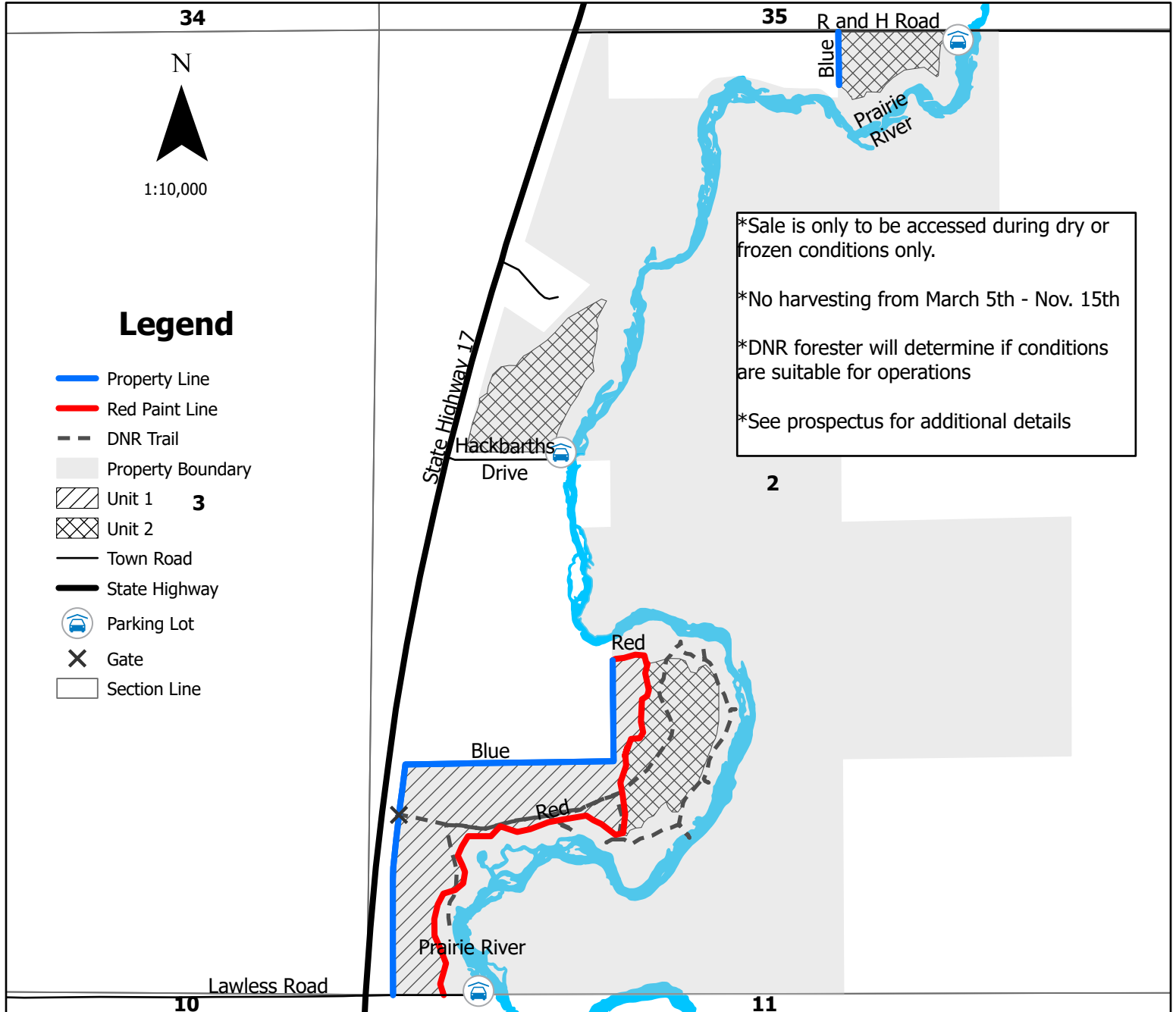

Unit 1: Regeneration Harvest (20 acres) - Harvest all stems greater than 1" except green, blue or red marked trees

Unit 2: Red Pine Thinning (20 acres) - Harvest all orange marked trees

Contract End Date: June 30, 2027

Sale Method: Mill Scale

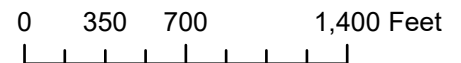

This map is for informational purposes only and may not have been prepared for or be suitable for legal, engineering or surveying purposes. The user is solely responsible for verifying the accuracy of information before using for any purpose.

Mapped: Zach Hylinski

Notice: Completion of this form is mandatory. The Department will not recognize your bid unless you complete and submit this form. Personal information collected will be used for program administration and may be provided to requesters as required by Wisconsin's Public Records law [ss. 19.31-19.39, Wis. Stats.].

Date

Bidder Name

Street Address	City	State	ZIP Code
----------------	------	-------	----------

Property Name (if any) Prairie River Fishery Area	Timber Sale Name Lawless	Tract Number 3507-01-2024
--	-----------------------------	------------------------------

Date and Hour of Bid Opening 8/7/24 1PM	Minimum Acceptable Bid (optional) \$6,834.00
--	---

Species-All bids including Lump Sum bids must be by species	Utilization Specifications (4 inch/Whole Tree/Logs)	Estimated Volume	Volume Units (tons/cords/mbf)	Price Bid Per Unit	Total Bid Value on Estimated Volume
Mixed Hardwood			tons		
Aspen			tons		
Red Pine			tons		
Fir			tons		

The award shall be based on this TOTAL BID AMOUNT:

Performance Bond

Will be in the form of: (select one)

- | | |
|--|---|
| <input type="radio"/> Personal Check | <input type="radio"/> Assurance Bond |
| <input type="radio"/> Certified Check/Money Order | <input type="radio"/> Certificate of Deposit |
| <input type="radio"/> Irrevocable Letter of Credit | <input type="radio"/> Assignment of Savings Account |

I understand that any or all bids may be rejected and that consideration and awarding of a contract will be based upon my past performance and ability to complete contracts. **I also understand that if I am the winning bidder, I have 6 weeks from the date of the bid opening to submit an acceptable performance bond. I also understand that if I am awarded the contract and fail to execute it or work under it, I will be required to forfeit to the Department an amount equal to 10% of my total bid amount.** Failure to forfeit the 10% penalty will result in being considered ineligible to bid on any state timber sales for a two-year duration. In the event the highest bidder can not or will not sign the contract, the award may be made to the next highest qualified bid.

By checking this box, I certify that I hold a Wisconsin Master Logger Certification.

Notice: I understand:

Utilization specifications and estimated volumes are listed in the prospectus which is available upon request from the Department.

A copy of the standard timber sales contract which must be entered into is available upon request from the Department.

Signature of Bidder
Bidder's Name (Please Print or Type)
Phone Number (include area code)
Email Address

County O Sale
3719-03-2024
Wisconsin DNR
Mead Wildlife Area

Forester Contact Information:
 Nicholas Hovda
 225051 Rib Mountain Drive
 Wausau, WI 54401
Nicholas.Hovda@wisconsin.gov
 715-297-0211

Legal Description: NWNW NENW NWNE SWNE NWSE SESE
 Section 2 T25N R6E Town of Eau Pleine, Portage County

see attached map for location and layout of harvest area(s)

Volume Estimates

Species	Pulp/Bolts/Logs	
Aspen	1750	Tons
Mixed HWD ¹	1000	Tons
Oak ¹	850	Tons
Totals	3600	Tons

Minimum Acceptable Value:	<u>\$18,925.00</u>
Scaling Method:	<u>Mill Scale</u>
Contract Ending Date:	<u>June 30, 2027</u>
Sale Area:	<u>56 Acres</u>

¹ **Mixed Hardwood and Oak consists of multiple products including pulp, bolts, and logs. Mixed hardwood pulp consists of 80% red maple, 8% of white birch, 7% of black ash, and 6% white ash, basswood, and black cherry Mixed Hardwood sawlogs consists of 40 MBF red maple, 2 MBF of basswood, 1 MBF black ash, and 1 MBF white ash. Oak products are comprised of 92% red oak, and 8% white oak. Oak sawlogs are comprised of 60 MBF of red oak, and 2 MBF of white oak. Mixed Hardwood wt. conv. 2.40 tons/cord. Aspen wt. conv. 2.25 tons/cord. Oak is 2.75 tons/cord.**

Access:

This timber sale has a few access points. To access the north part of this timber sale, an unimproved road borders the county line from the east of the County Road O parking lot located just south of the Little Eau Pleine River bridge. To access the south stand of the timber sale, use the parking lot at 44.674391, -89.765879. From that parking lot, follow the woods road east for roughly .75 miles to reach the stand. An unimproved access road may be used off County Road O heading east at 44.679360, -89.767011 as well to reach the center of the timber sale.

Cutting Specifications

- **Sale Area (56 acres):** Cut all trees greater than 2" in diameter within the red paint boundaries except for trees marked in green bands. Leave all conifer species.
- Cutting must be concurrent for all species to be harvested. Non-merchantable trees must be cut concurrent with merchantable trees. Whole tree harvesting will not be permitted in this sale.
- Sawlog top diameter minimum of 10 inches. Pulpwood top diameter minimum of 4 inches.

Operational Considerations:

- Roads and landings utilized during the timber sale must be returned to original condition.
- Harvesting during firm or frozen ground conditions. No harvesting during the 9 day gun-deer season. No harvesting during oak wilt season (April 15th to July 15th).
- New landings and roads must be approved by the DNR Forester.
- Do not cut any trees marked in green paint.
- Equipment must be clean and free of debris prior to entering the sale.
- Prompt and proper treatment of slash where required. It is the responsibility of the timber contractor to spread all slash evenly throughout the sale down to 2 ft. No slash on trails, landings, or private property.
- This is a 3-year contract ending on June 30, 2027.

County O Sale

Tract #: 3719-03-2024

Wisconsin DNR

Mead Wildlife Area

Legal Description:
 NWNW NENW NWNE SWNE NWSE SESE
 Section 2 T25N R6E Town of Eau Pleine, Portage County (56 acres)

Volume Estimates

Species	Pulp/Bolts/Logs	
Aspen	1750	Tons
Mixed HWD ¹	1000	Tons
Oak ¹	850	Tons
Totals	3600	Tons

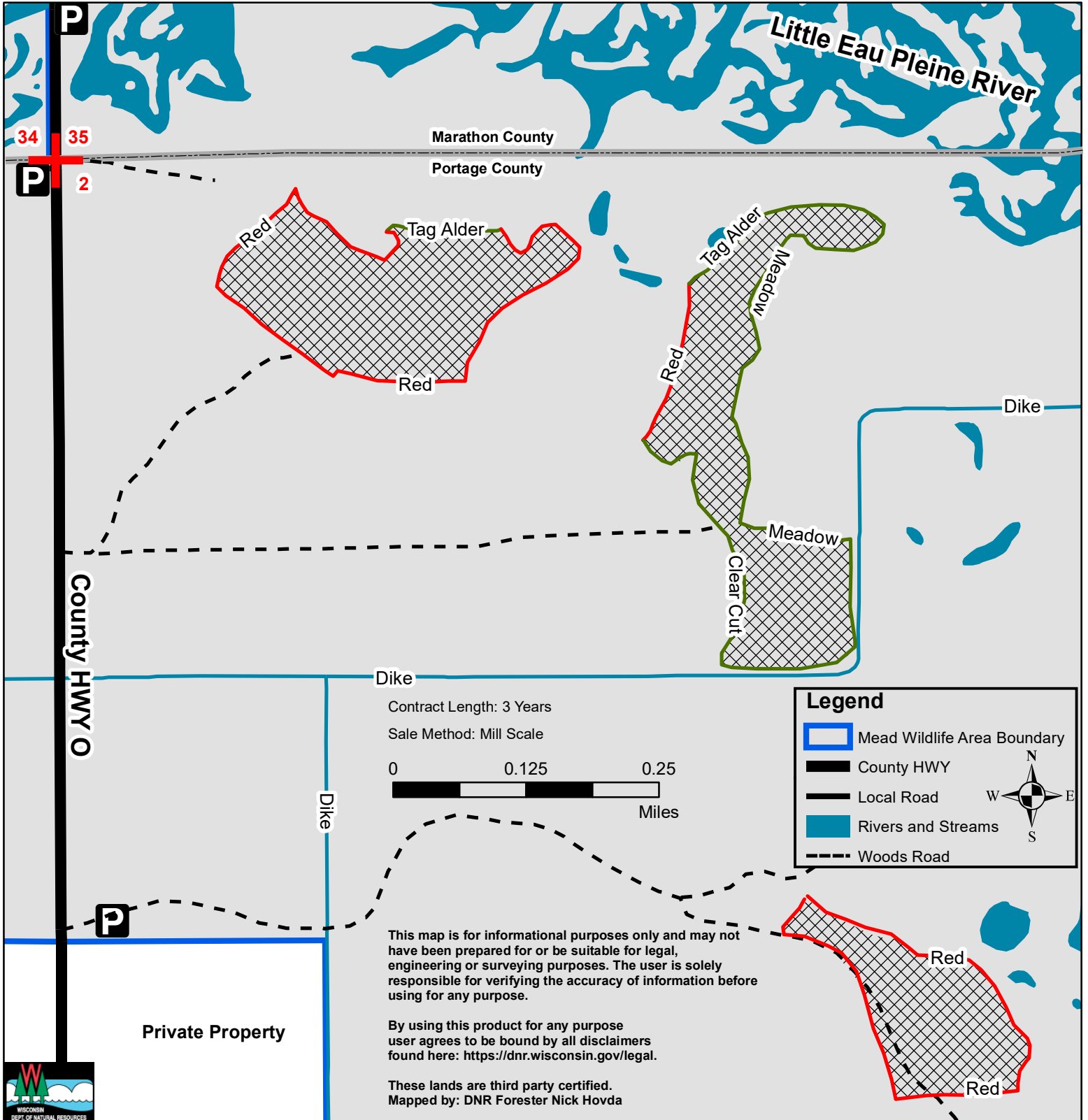

 - Sale Area (56 Acres): Cut all trees greater than 2" in diameter within the red paint boundaries except for trees marked in green bands. Leave all conifer species.

Note: In order to fill and save this form electronically, it must be opened using Adobe Reader or Acrobat software. Save a copy of the file, open Adobe Reader, select File > Open and browse for the file you saved.

State of Wisconsin
Department of Natural Resources
dnr.wi.gov

Timber Sale Bid
Form 2400-049 (R 07/22)

Notice: Completion of this form is mandatory. The Department will not recognize your bid unless you complete and submit this form. Personal information collected will be used for program administration and may be provided to requesters as required by Wisconsin's Public Records law [ss. 19.31-19.39, Wis. Stats.].

Date

Bidder Name

Street Address	City	State	ZIP Code
----------------	------	-------	----------

Property Name (if any) Mead Wildlife Area	Timber Sale Name County O	Tract Number 3719-03-2024
--	------------------------------	------------------------------

Date and Hour of Bid Opening August 7, 2024 at 1:00pm	Minimum Acceptable Bid (optional) \$18,925.00
--	--

Species-All bids including Lump Sum bids must be by species	Utilization Specifications (4 inch/Whole Tree/Logs)	Estimated Volume	Volume Units (tons/cords/mbf)	Price Bid Per Unit	Total Bid Value on Estimated Volume
Aspen	4 inch	1,750	Tons		
Mixed Hardwood	4 inch	1,000	Tons		
Oak	4 inch	850	Tons		

The award shall be based on this TOTAL BID AMOUNT:

Performance Bond

Will be in the form of: (select one)

- Personal Check
- Certified Check/Money Order
- Irrevocable Letter of Credit
- Assurance Bond
- Certificate of Deposit
- Assignment of Savings Account

I understand that any or all bids may be rejected and that consideration and awarding of a contract will be based upon my past performance and ability to complete contracts. **I also understand that if I am the winning bidder, I have 6 weeks from the date of the bid opening to submit an acceptable performance bond. I also understand that if I am awarded the contract and fail to execute it or work under it, I will be required to forfeit to the Department an amount equal to 10% of my total bid amount.** Failure to forfeit the 10% penalty will result in being considered ineligible to bid on any state timber sales for a two-year duration. In the event the highest bidder can not or will not sign the contract, the award may be made to the next highest qualified bid.

By checking this box, I certify that I hold a Wisconsin Master Logger Certification.

Notice: I understand:

Utilization specifications and estimated volumes are listed in the prospectus which is available upon request from the Department.

A copy of the standard timber sales contract which must be entered into is available upon request from the Department.

Signature of Bidder
Bidder's Name (Please Print or Type)
Phone Number (include area code)
Email Address

Dippin Dot Sale
3719-04-2024
Wisconsin DNR
Mead Wildlife Area

Forester Contact Information:
 Nicholas Hovda
 225051 Rib Mountain Drive
 Wausau, WI 54401
Nicholas.Hovda@wisconsin.gov
 715-297-0211

Legal Description: SWNW NWSW Section 16 T25N R6E Portage County
 NESE Section 17 T25N R6E Portage County

see attached map for location and layout of harvest area(s)

Volume Estimates

Species	Pulp/Bolts/Logs	
Aspen	50	Tons
Mixed HWD ¹	1000	Tons
Totals	1050	Tons

Minimum Acceptable Value: \$6,805.00
Scaling Method: Mill Scale
Contract Ending Date: June 30, 2027
Sale Area: 23 Acres

¹ **Mixed Hardwood consists of multiple products including pulp, bolts, and logs. Mixed hardwood pulp consists of 61% red maple, 19% of basswood, 9% of sugar maple, and 7% white ash, and 4% of red oak, white birch, yellow birch, and black ash. Mixed Hardwood sawlogs consists of 35 MBF red maple, 35 MBF of basswood, 9 MBF white ash, 8 MBF sugar maple, and 4 MBF red oak. Mixed Hardwood wt. conv. 2.40 tons/cord. Aspen wt. conv. 2.25 tons/cord.**

Access:

Access to this timber sale can be found via DNR parking lot at 44.6523, -89.8052 (.50 miles east of Mead Lane and County H). The sale area is just west of this parking lot. Private land borders the west side of the timber sale and can be used with landowner permission.

Cutting Specifications:

- **Area 1 (19 acres):** Cut all trees greater than 2" in diameter within the red and blue paint boundaries except for trees marked in green bands. Leave all conifer species.
- **Area 2 (4 acres):** Cut all trees marked with orange paint within the red and blue paint boundaries. Cut all aspen greater than 4 inches in diameter.
- Cutting must be concurrent for all species to be harvested. Non-merchantable trees must be cut concurrent with merchantable trees. Whole tree harvesting will not be permitted in this sale.
- Sawlog top diameter minimum of 10 inches. Pulpwood top diameter minimum of 4 inches.

Operational Considerations:

- Roads and landings utilized during the timber sale must be returned to original condition.
- Harvesting during firm or frozen ground conditions. No harvesting during the 9 day gun-deer season.
- New landings and roads must be approved by the DNR Forester.
- Do not cut any trees marked in green paint.
- Equipment must be clean and free of debris prior to entering the sale.
- Prompt and proper treatment of slash where required. It is the responsibility of the timber contractor to spread all slash evenly throughout the sale down to 2 ft. No slash on trails, landings, or private property.
- This is a 3-year contract ending on June 30, 2027.

Dippin Dot Sale

Tract #: 3719-04-2024

Wisconsin DNR



Mead Wildlife Area

Volume Estimates

Species	Pulp/Bolts/Logs	
Aspen	50	Tons
Mixed HWD ¹	1000	Tons
Totals	1050	Tons

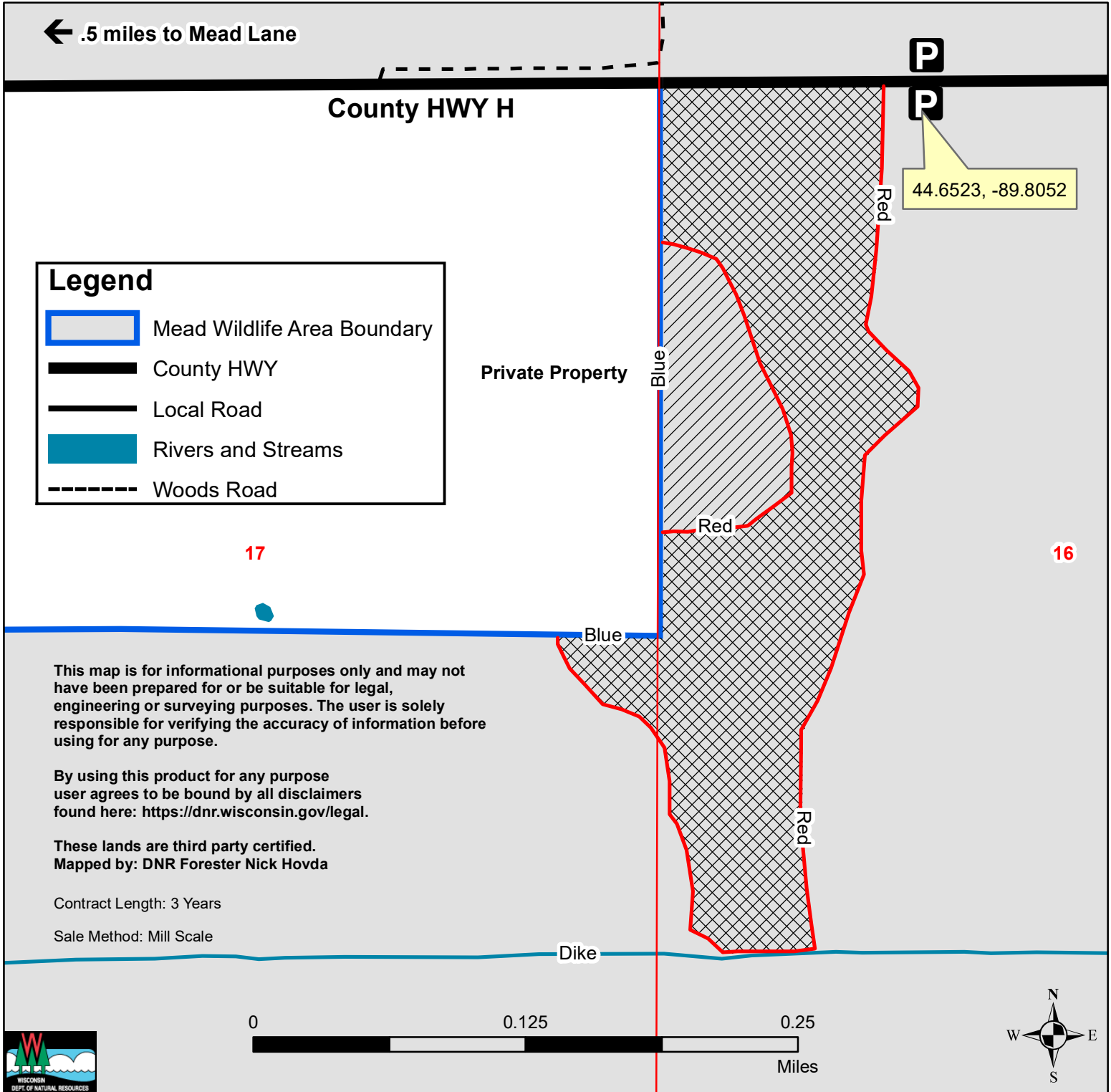
Legal Description:
 SWNW NWSW Section 16 T25N R6E Portage County
 NESE Section 17 T25N R6E Portage County (23 acres)



-  - Area 1 (19 Acres): Cut all trees greater than 2" in diameter within the red and blue paint boundaries except for trees marked in green bands. Leave all conifer species.
-  - Area 2 (4 Acres): Cut all trees marked with orange paint within the red and blue paint boundaries. Cut all aspen greater than 4 inches.

Notice: Completion of this form is mandatory. The Department will not recognize your bid unless you complete and submit this form. Personal information collected will be used for program administration and may be provided to requesters as required by Wisconsin's Public Records law [ss. 19.31-19.39, Wis. Stats.].

Date

Bidder Name

Street Address	City	State	ZIP Code
----------------	------	-------	----------

Property Name (if any) Mead Wildlife Area	Timber Sale Name Dippin Dot	Tract Number 3719-04-2024
--	--------------------------------	------------------------------

Date and Hour of Bid Opening August 7, 2024 at 1:00pm	Minimum Acceptable Bid (optional) \$6,805.00
--	---

Species-All bids including Lump Sum bids must be by species	Utilization Specifications (4 inch/Whole Tree/Logs)	Estimated Volume	Volume Units (tons/cords/mbf)	Price Bid Per Unit	Total Bid Value on Estimated Volume
Aspen	4 inch	50	Tons		
Mixed Hardwood	4 inch	1,000	Tons		

The award shall be based on this TOTAL BID AMOUNT:

Performance Bond

Will be in the form of: (select one)

- | | |
|--|---|
| <input type="radio"/> Personal Check | <input type="radio"/> Assurance Bond |
| <input type="radio"/> Certified Check/Money Order | <input type="radio"/> Certificate of Deposit |
| <input type="radio"/> Irrevocable Letter of Credit | <input type="radio"/> Assignment of Savings Account |

I understand that any or all bids may be rejected and that consideration and awarding of a contract will be based upon my past performance and ability to complete contracts. **I also understand that if I am the winning bidder, I have 6 weeks from the date of the bid opening to submit an acceptable performance bond. I also understand that if I am awarded the contract and fail to execute it or work under it, I will be required to forfeit to the Department an amount equal to 10% of my total bid amount.** Failure to forfeit the 10% penalty will result in being considered ineligible to bid on any state timber sales for a two-year duration. In the event the highest bidder can not or will not sign the contract, the award may be made to the next highest qualified bid.

By checking this box, I certify that I hold a Wisconsin Master Logger Certification.

Notice: I understand:

Utilization specifications and estimated volumes are listed in the prospectus which is available upon request from the Department.

A copy of the standard timber sales contract which must be entered into is available upon request from the Department.

Signature of Bidder
Bidder's Name (Please Print or Type)
Phone Number (include area code)
Email Address

Pine Road Sale (Optional Bid Sale)
3719-06-2024
Wisconsin DNR
Mead Wildlife Area

Forester Contact Information:
 Nicholas Hovda
 225051 Rib Mountain Drive
 Wausau, WI 54401
Nicholas.Hovda@wisconsin.gov
 715-297-0211

Legal Description: NENW SENW Section 28 T25N R6E
 Eau Pleine Township, Portage County



See attached map for location and layout of harvest area(s)

Volume Estimates

Species	Logs/Bolts (Cord) (8" DIB and up)	**Optional Pulp (Tons)
Mx HWD	210	400
Aspen	40	80
Totals:	250 Cords	**0-480 Tons

Minimum Acceptable Value: \$5,325.00

Scaling Method: Mill Scale

Contract Ending Date: June 30, 2027

Mixed hardwood pulp consists of 38% white ash, 31% of red maple, 19% of basswood, and 5% hickory, 5% of sugar maple, and 3% red oak and black ash. Mixed Hardwood sawlogs consists of 25 MBF of White Ash, 20 MBF basswood, 15 MBF of Red Maple, 2 MBF of hickory, 2 MBF sugar maple, 1 MBF red oak.

Pulpwood Specifications: (Aspen, Mixed Hardwood OPTIONAL pulpwood volume)

- If contactor bids on pulp volume, contractor is required to utilize (i.e., harvest, remove from the site, and pay for) the volume and value bid on. Logs and bolts must be bid on. Pulp volume is optional from 0 and 480 tons.
- If contactor who bid on a portion of the pulpwood chooses to utilize additional volume over the volume bid on, the additional volume will be charged at contract rates.
- If a contractor who did not bid on the pulpwood is awarded the sale and the contractor later wants to utilize the pulp, a contract amendment with volumes/values will be made.
- Pulpwood that is not bid on remains the property of the DNR and may not be utilized except as provided in a contract amendment, if any. Unutilized pulpwood must be treated as slash (further described below).
- Mixed hardwood pulp consists of 38% white ash, 31% of red maple, 19% of basswood, and 5% hickory, 5% of sugar maple, and 3% red oak and black ash. Pulpwood minimum is 4" DIB if bid on.

Access:

- The west side of the timber sale may be accessed off private lands with landowner permission. If no private access is available, a winter only skid trail may be used from the north on state owned property off the dead end DNR parking lot on Victory Road. A landing site may be used in the fields. The east side of the timber sale may be accessed off Pine Road.

Cutting Specifications:

- **Sale Area (23 acres):** Cut all trees marked with orange paint within the red and blue paint boundaries. Cut all aspen greater than 4 inches in diameter.
- Cutting must be concurrent for all species to be harvested. Non-merchantable trees must be cut concurrent with merchantable trees. Whole tree harvesting will not be permitted in this sale.
- Utilization standards will be varied for this timber sale.

Operational Considerations:

- Roads and landings utilized during the timber sale must be returned to original condition.
- Harvesting during frozen ground conditions. No harvesting during the 9 day gun-deer season.
- New landings and roads must be approved by the DNR Forester.
- Do not cut any trees marked in blue paint.
- Equipment must be clean and free of debris prior to entering the sale.
- Prompt and proper treatment of slash where required. It is the responsibility of the timber contractor to spread all slash evenly throughout the sale down to 2 ft. No slash on trails, landings, or private property.

Pine Road Sale Tract #: 3719-06-2024 Wisconsin DNR Mead Wildlife Area

Legal Description:
NENW SENW Section 28 T25N R6E
Twn. of Eau Pleine, Portage County (23 acres)

Volume Estimates

Species	Logs/Bolts (Cord) (8" DIB and up)	**Optional Pulp (Tons)
Mx HWD	210	400
Aspen	40	80
Totals:	250 Cords	**0-480 Tons

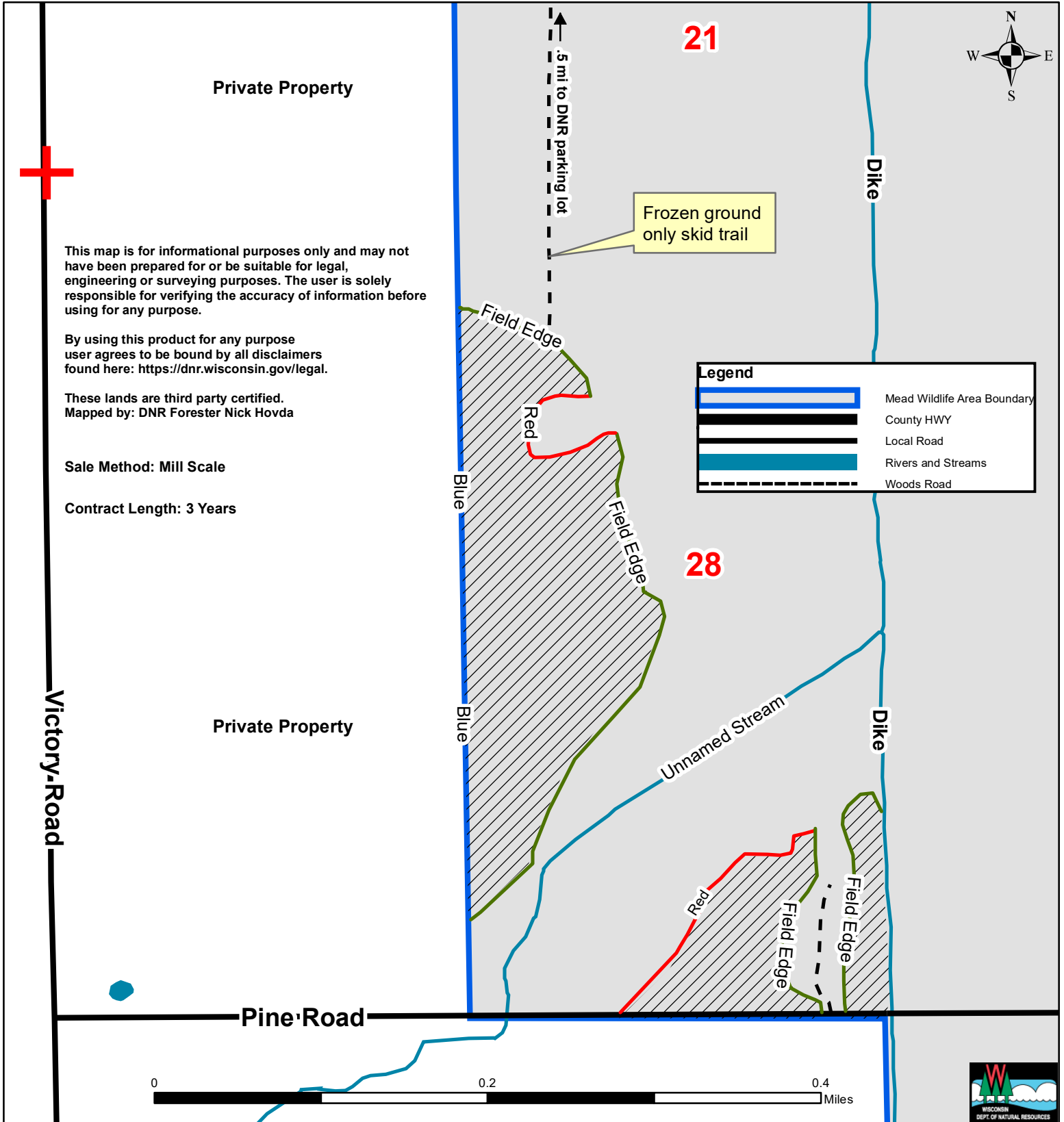

This map is for informational purposes only and may not have been prepared for or be suitable for legal, engineering or surveying purposes. The user is solely responsible for verifying the accuracy of information before using for any purpose.

By using this product for any purpose user agrees to be bound by all disclaimers found here: <https://dnr.wisconsin.gov/legal>.

These lands are third party certified.
Mapped by: DNR Forester Nick Hovda

Sale Method: Mill Scale

Contract Length: 3 Years

Legend	
	Mead Wildlife Area Boundary
	County HWY
	Local Road
	Rivers and Streams
	Woods Road

- Sale area (23 Acres): Cut all trees marked in orange paint including all aspen greater than 4 inches in diameter within the sale area.



Note: In order to fill and save this form electronically, it must be opened using Adobe Reader or Acrobat software. Save a copy of the file, open Adobe Reader, select File > Open and browse for the file you saved.

State of Wisconsin
Department of Natural Resources
dnr.wi.gov

Timber Sale Bid
Form 2400-049 (R 07/22)

Notice: Completion of this form is mandatory. The Department will not recognize your bid unless you complete and submit this form. Personal information collected will be used for program administration and may be provided to requesters as required by Wisconsin's Public Records law [ss. 19.31-19.39, Wis. Stats.].

Date

Bidder Name

Street Address City State ZIP Code

Property Name (if any) Timber Sale Name Tract Number
Mead Wildlife Area Pine Road 3719-06-2024

Date and Hour of Bid Opening Minimum Acceptable Bid (optional)
August 7, 2024 at 1:00pm \$5,325.00

Species-All bids including Lump Sum bids must be by species	Utilization Specifications (4 inch/Whole Tree/Logs)	Estimated Volume	Volume Units (tons/cords/mbf)	Price Bid Per Unit	Total Bid Value on Estimated Volume
Aspen	8 inch	40	Cords		
Mixed Hardwood	8 inch	210	Cords		
(Optional) Mixed Hardwood	4 inch		0-400 Tons		
(Optional) Aspen	4 inch		0-80 Tons		

The award shall be based on this TOTAL BID AMOUNT:

Performance Bond

Will be in the form of: (select one)

- Personal Check Assurance Bond
 Certified Check/Money Order Certificate of Deposit
 Irrevocable Letter of Credit Assignment of Savings Account

I understand that any or all bids may be rejected and that consideration and awarding of a contract will be based upon my past performance and ability to complete contracts. **I also understand that if I am the winning bidder, I have 6 weeks from the date of the bid opening to submit an acceptable performance bond. I also understand that if I am awarded the contract and fail to execute it or work under it, I will be required to forfeit to the Department an amount equal to 10% of my total bid amount.** Failure to forfeit the 10% penalty will result in being considered ineligible to bid on any state timber sales for a two-year duration. In the event the highest bidder can not or will not sign the contract, the award may be made to the next highest qualified bid.

By checking this box, I certify that I hold a Wisconsin Master Logger Certification.

Notice: I understand:

Utilization specifications and estimated volumes are listed in the prospectus which is available upon request from the Department.

A copy of the standard timber sales contract which must be entered into is available upon request from the Department.

Signature of Bidder

Bidder's Name (Please Print or Type)

Phone Number (include area code)

Email Address

Quail Lane Sale
3719-01-2024
Wisconsin DNR
Mead Wildlife Area

Forester Contact Information:
 Nicholas Hovda
 225051 Rib Mountain Drive
 Wausau, WI 54401
Nicholas.Hovda@wisconsin.gov
 715-297-0211

Legal Description: SWSW SESW Section 16
 NWNW NENW Section 21
 T26N R5E Town of Green Valley, Marathon County

see attached map for location and layout of harvest area(s)

Volume Estimates

Species	Pulp/Bolts/Logs	
Aspen	950	Tons
Mixed HWD ¹	350	Tons
Totals	1300	Tons

Minimum Acceptable Value: \$6,110.00
Scaling Method: Mill Scale
Contract Ending Date: June 30, 2027
Sale Area: 32 Acres

¹ Mixed Hardwood consists of multiple products including pulp, bolts, and logs. Mixed hardwood pulp consists of 58% red maple, 23% of white ash, 8% of basswood, 3% elm, 3% sugar maple, and 5% white birch, black cherry, red oak, and bitternut hickory. Mixed Hardwood Sawlogs consists of 10 MBF red maple, 8 MBF white ash, 1 MBF basswood, and 1 MBF sugar maple. Mixed Hardwood wt. conv. 2.40 tons/cord. Aspen wt. conv. 2.25 tons/cord.

Access:

Access to this timber sale is found off a DNR parking lot the east side of Smokey Hill Road just south of the Quail Lane intersection. The sale is located less than a quarter mile heading northeast from that parking lot. The sale can also be accessed from the ag field to the north with landowner permission. No current road access to sale area on state lands.

Cutting Specifications

- **Sale Area (32 acres):** Cut all trees greater than 2" in diameter within the red and blue paint boundaries except for trees marked in green bands. Leave all conifer species.
- Cutting must be concurrent for all species to be harvested. Non-merchantable trees must be cut concurrent with merchantable trees. Whole tree harvesting will not be permitted in this sale.
- Sawlog top diameter minimum of 10 inches. Pulpwood top diameter minimum of 4 inches.

Operational Considerations:

- Roads and landings utilized during the timber sale must be returned to original condition.
- Harvesting during firm or frozen ground conditions only. No harvesting during the 9 day gun-deer season.
- New landings and roads must be approved by the DNR Forester.
- Do not cut any trees marked in green, red, or blue paint.
- Equipment must be clean and free of debris prior to entering the sale.
- Prompt and proper treatment of slash where required. It is the responsibility of the timber contractor to spread all slash evenly throughout the sale down to 2 ft. No slash on trails, landings, or private property.
- This is a 3-year contract ending on June 30, 2027.

Quail Lane Sale

Tract #: 3719-01-2024

Wisconsin DNR

Mead Wildlife Area

Legal Description:
 SWSW SESW Section 16
 NWNW NENW Section 21
 T26N R5E Town of Green Valley, Marathon County (32 Acres)

Species	Volumes	
	Pulp/Bolts/Logs	
Aspen	950	Tons
Mixed HWD ¹	350	Tons
Totals	1300	Tons

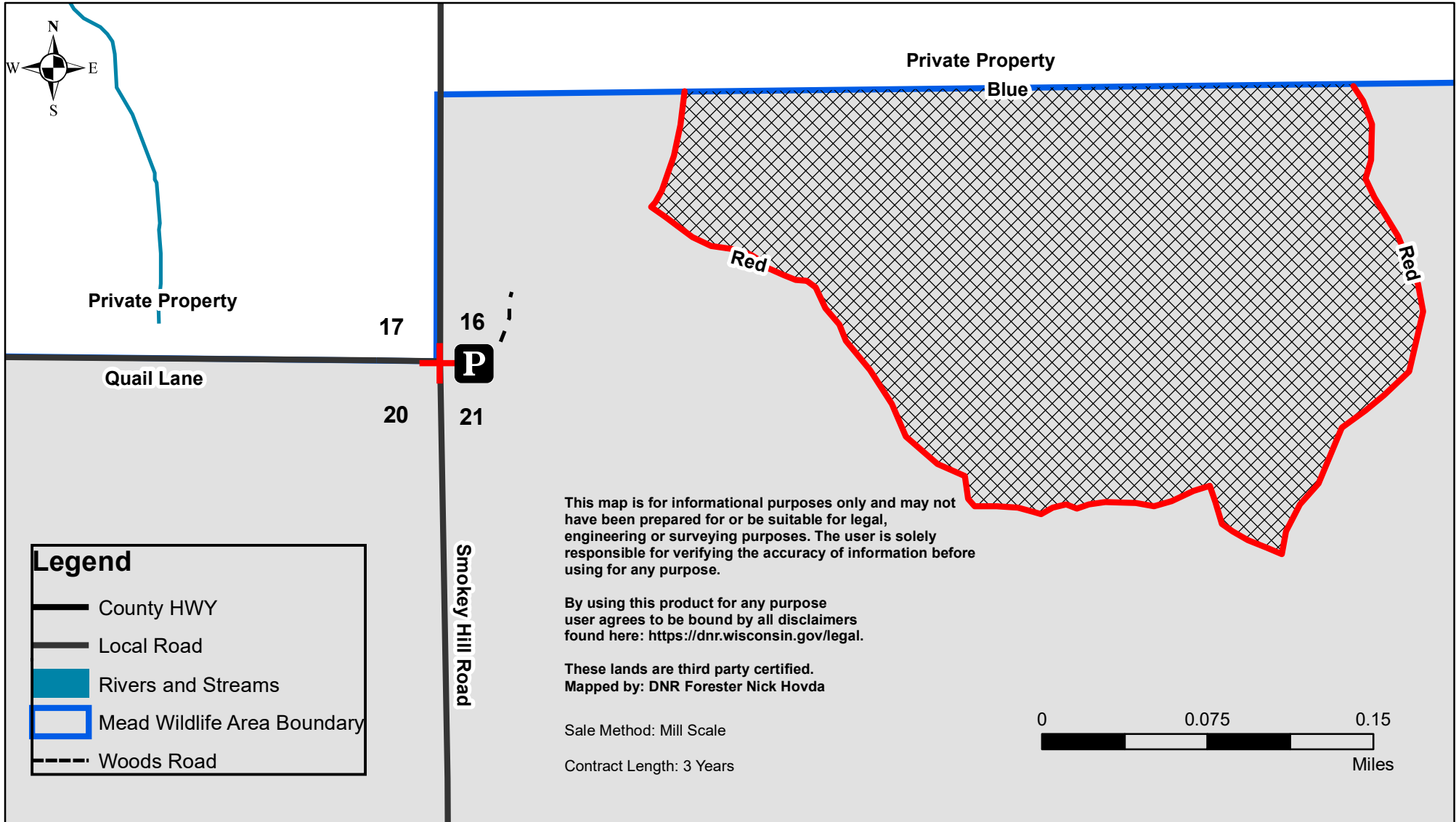

- Sale Area (32 Acres): Cut all trees greater than 2" in diameter within the red and blue paint boundaries except for trees marked in green bands. Leave all conifer species.



Notice: Completion of this form is mandatory. The Department will not recognize your bid unless you complete and submit this form. Personal information collected will be used for program administration and may be provided to requesters as required by Wisconsin's Public Records law [ss. 19.31-19.39, Wis. Stats.].

Date

Bidder Name

Street Address	City	State	ZIP Code
----------------	------	-------	----------

Property Name (if any) Mead Wildlife Area	Timber Sale Name Quail Lane	Tract Number 3719-01-2024
--	--------------------------------	------------------------------

Date and Hour of Bid Opening August 7, 2024 at 1:00pm	Minimum Acceptable Bid (optional) \$6,110.00
--	---

Species-All bids including Lump Sum bids must be by species	Utilization Specifications (4 inch/Whole Tree/Logs)	Estimated Volume	Volume Units (tons/cords/mbf)	Price Bid Per Unit	Total Bid Value on Estimated Volume
Aspen	4 inch	950	Tons		
Mixed Hardwoods	4 inch	350	Tons		

The award shall be based on this TOTAL BID AMOUNT:

Performance Bond Will be in the form of: (select one)

<input type="radio"/> Personal Check	<input type="radio"/> Assurance Bond
<input type="radio"/> Certified Check/Money Order	<input type="radio"/> Certificate of Deposit
<input type="radio"/> Irrevocable Letter of Credit	<input type="radio"/> Assignment of Savings Account

I understand that any or all bids may be rejected and that consideration and awarding of a contract will be based upon my past performance and ability to complete contracts. **I also understand that if I am the winning bidder, I have 6 weeks from the date of the bid opening to submit an acceptable performance bond. I also understand that if I am awarded the contract and fail to execute it or work under it, I will be required to forfeit to the Department an amount equal to 10% of my total bid amount.** Failure to forfeit the 10% penalty will result in being considered ineligible to bid on any state timber sales for a two-year duration. In the event the highest bidder can not or will not sign the contract, the award may be made to the next highest qualified bid.

By checking this box, I certify that I hold a Wisconsin Master Logger Certification.

Notice: I understand:

Utilization specifications and estimated volumes are listed in the prospectus which is available upon request from the Department.

A copy of the standard timber sales contract which must be entered into is available upon request from the Department.

Signature of Bidder
Bidder's Name (Please Print or Type)
Phone Number (include area code)
Email Address

Speedee Chickadee Sale
3719-05-2024
Wisconsin DNR
Mead Wildlife Area

Forester Contact Information:
 Nicholas Hovda
 225051 Rib Mountain Drive
 Wausau, WI 54401
Nicholas.Hovda@wisconsin.gov
 715-297-0211

Legal Description: SENE NESE Section 36 T26N R5E Marathon County
 SWNE Section 1 T25N R5E Wood County
 SWNW NWSW Section 6 T25N R6E Portage County

see attached map for location and layout of harvest area(s)

Volume Estimates

Species	Pulp/Bolts/Logs	
Aspen	110	Tons
Mixed HWD ¹	1450	Tons
Totals	1560	Tons

Minimum Acceptable Value: \$12,631.00
Scaling Method: Mill Scale
Contract Ending Date: June 30, 2027
Sale Area: 26 Acres

¹Mixed Hardwood consists of multiple products including pulp, bolts, and logs. Mixed hardwood pulp consists of 65% red maple, 13% of white and black ash, 6% basswood, 5% of red oak, and 3% sugar maple, and 8% of hickory, white and yellow birch, and elm. Mixed Hardwood sawlogs consists of 100 MBF red maple, 23 MBF of basswood, 15 MBF white ash, 6 MBF sugar maple, and 1 MBF red oak. Mixed Hardwood wt. conv. 2.40 tons/cord. Aspen wt. conv. 2.25 tons/cord.

Access:

Access to Area 1: Use the parking lot off Martin Lane. From the gate, head straight north for .4 miles across the agriculture field to reach the stand. Fields may be used for decking purposes.

Access to Area 2: Access will be off Deer Run Drive. An unimproved road runs north on state owned land for .5 miles to the stand. Private property borders the east side of the unimproved road as well as the south side of Area 2. Private property may be used for a landing area with permission.

Cutting Specifications:

- **Sale Area (26 acres):** Cut all trees greater than 2" in diameter within the red and blue paint boundaries except for trees marked in green bands. Leave all conifer species.
- Cutting must be concurrent for all species to be harvested. Non-merchantable trees must be cut concurrent with merchantable trees. Whole tree harvesting will not be permitted in this sale.
- Sawlog top diameter minimum of 10 inches. Pulpwood top diameter minimum of 4 inches.

Operational Considerations:

- Roads and landings utilized during the timber sale must be returned to original condition.
- Harvesting allowed from October 31st through May 1st.
- New landings and roads must be approved by the DNR Forester.
- Do not cut any trees marked in green or blue paint.
- Equipment must be clean and free of debris prior to entering the sale.
- Prompt and proper treatment of slash where required. It is the responsibility of the timber contractor to spread all slash evenly throughout the sale down to 2 ft. No slash on trails, landings, or private property.
- This is a 3-year contract ending on June 30, 2027.

Speedee Chickadee Sale

Tract #: 3719-05-2024

Wisconsin DNR

Mead Wildlife Area

Legal Description:

SENE NESE Section 36 T26N R5E Marathon County

SWNE Section 1 T25N R5E Wood County

SWNW NWSW Section 6 T25N R6E Portage County

Volume Estimates

Species	Pulp/Bolts/Logs	
Aspen	110	Tons
Mixed HWD ¹	1450	Tons
Totals	1560	Tons

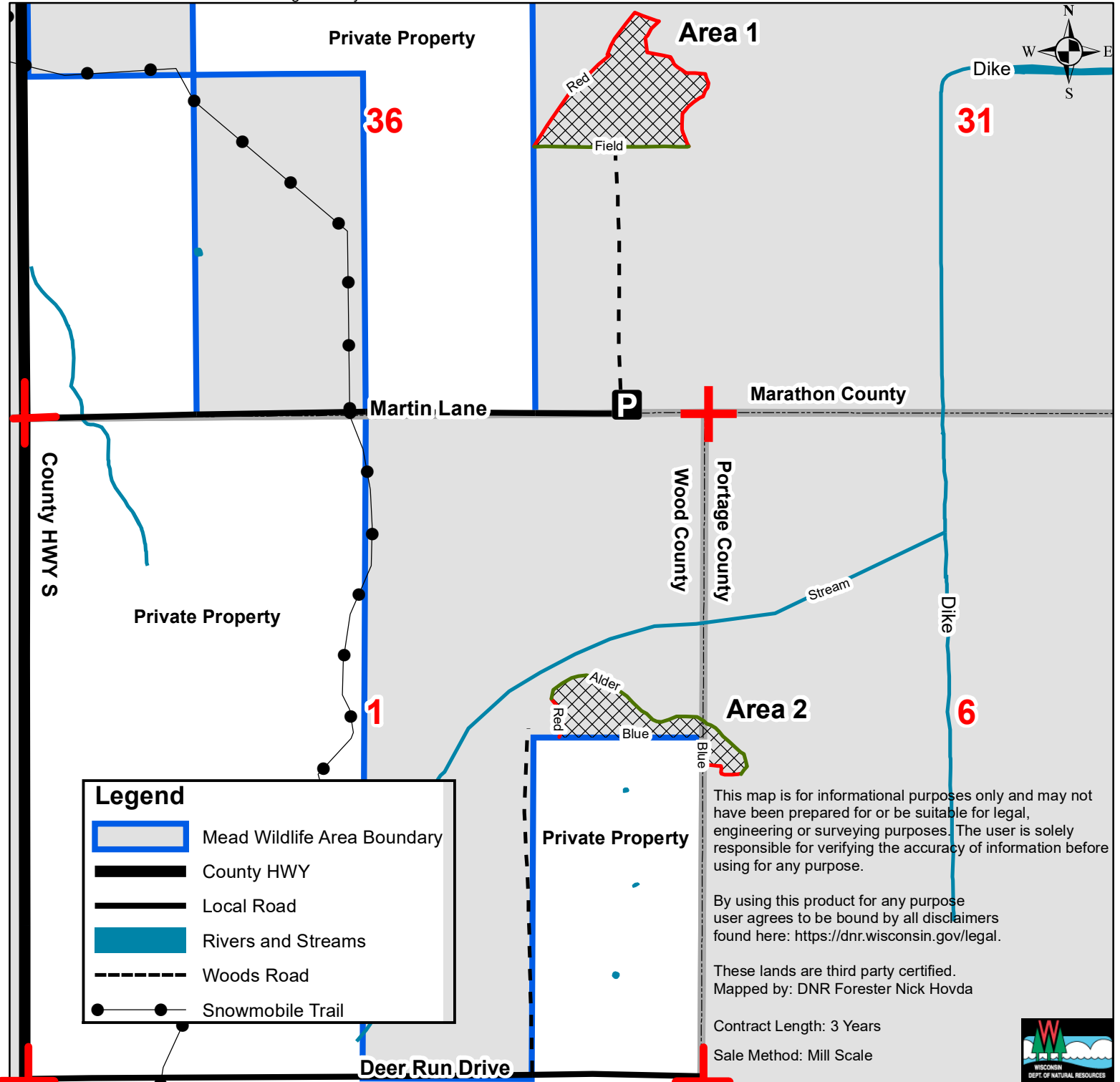

 - Sale Area (26 Acres): Cut all trees greater than 2" in diameter within the red and blue paint boundaries except for trees marked in green bands. Leave all conifer species.



Note: In order to fill and save this form electronically, it must be opened using Adobe Reader or Acrobat software. Save a copy of the file, open Adobe Reader, select File > Open and browse for the file you saved.

State of Wisconsin
Department of Natural Resources
dnr.wi.gov

Timber Sale Bid
Form 2400-049 (R 07/22)

Notice: Completion of this form is mandatory. The Department will not recognize your bid unless you complete and submit this form. Personal information collected will be used for program administration and may be provided to requesters as required by Wisconsin's Public Records law [ss. 19.31-19.39, Wis. Stats.].

Date

Bidder Name

Street Address

City

State

ZIP Code

Property Name (if any)

Mead Wildlife Area

Timber Sale Name

Speedee Chickadee

Tract Number

3719-05-2024

Date and Hour of Bid Opening

August 7, 2024 at 1:00pm

Minimum Acceptable Bid (optional)

\$12,631.00

Species-All bids including Lump Sum bids must be by species	Utilization Specifications (4 inch/Whole Tree/Logs)	Estimated Volume	Volume Units (tons/cords/mbf)	Price Bid Per Unit	Total Bid Value on Estimated Volume
Aspen	4 inch	110	Tons		
Mixed Hardwood	4 inch	1,450	Tons		

The award shall be based on this TOTAL BID AMOUNT:

Performance Bond

Will be in the form of: (select one)

Personal Check

Assurance Bond

Certified Check/Money Order

Certificate of Deposit

Irrevocable Letter of Credit

Assignment of Savings Account

I understand that any or all bids may be rejected and that consideration and awarding of a contract will be based upon my past performance and ability to complete contracts. **I also understand that if I am the winning bidder, I have 6 weeks from the date of the bid opening to submit an acceptable performance bond. I also understand that if I am awarded the contract and fail to execute it or work under it, I will be required to forfeit to the Department an amount equal to 10% of my total bid amount.** Failure to forfeit the 10% penalty will result in being considered ineligible to bid on any state timber sales for a two-year duration. In the event the highest bidder can not or will not sign the contract, the award may be made to the next highest qualified bid.

By checking this box, I certify that I hold a Wisconsin Master Logger Certification.

Notice: I understand:

Utilization specifications and estimated volumes are listed in the prospectus which is available upon request from the Department.

A copy of the standard timber sales contract which must be entered into is available upon request from the Department.

Signature of Bidder

Bidder's Name (Please Print or Type)

Phone Number (include area code)

Email Address

Ulman Lane Sale
3719-02-2024
Wisconsin DNR
Mead Wildlife Area

Forester Contact Information:
 Nicholas Hovda
 225051 Rib Mountain Drive
 Wausau, WI 54401
Nicholas.Hovda@wisconsin.gov
 715-297-0211

Legal Description: NENW SWNW Section 24 T26N R5E Town of Green Valley, Marathon Co.
 NWSW NESW SWSW SESW Section 24 T26N R5E Town of Green Valley, Marathon Co.

see attached map for location and layout of harvest area(s)

Volume Estimates

Species	Pulp/Bolts/Logs	
Aspen	450	Tons
Mixed HWD ¹	430	Tons
Oak ¹	410	Tons
Totals	1290	Tons

Minimum Acceptable Value: \$8,292.00
Scaling Method: Mill Scale
Contract Ending Date: June 30, 2027
Sale Area: 29 Acres

¹Mixed Hardwood and Oak consists of multiple products including pulp, bolts, and logs. Mixed hardwood pulp consists of 65% red maple, 22% of white ash, 6% of black ash, and 5% white birch, basswood, elm, and yellow birch. Mixed Hardwood sawlogs consists of 5 MBF red maple, 5 MBF white ash, 3 MBF black ash, and 1 MBF white birch. Oak products are comprised of 53% bur oak, and 46% red oak. Oak sawlogs are comprised of 4 MBF of bur oak, and 1 MBF of red oak. Mixed Hardwood wt. conv. 2.40 tons/cord. Aspen wt. conv. 2.25 tons/cord. Oak is 2.75 tons/cord.

Access:

The north stand of this timber sale can be accessed off the dead-end parking lot on Ulman Lane. A network of mowed field trails will connect to a snowmobile trail that connects to the harvest area. The south stand of the timber sale is located roughly 200 yards south of the Ulman Lane parking lot. A snowmobile trail borders the south end of the north stand. The local snowmobile club must be contacted prior to sale activity. No logging debris or equipment shall be left on the snowmobile trail. Plowing the trail must be done in a way to leave snow on the trail.

Cutting Specifications

- **Sale Area (29 acres):** Cut all trees greater than 2" in diameter within the red and blue paint boundaries except for trees marked in green bands. Leave all conifer species.
- Cutting must be concurrent for all species to be harvested. Non-merchantable trees must be cut concurrent with merchantable trees. Whole tree harvesting will not be permitted in this sale.
- Sawlog top diameter minimum of 10 inches. Pulpwood top diameter minimum of 4 inches.

Operational Considerations:

- Roads and landings utilized during the timber sale must be returned to original condition.
- Harvesting during firm or frozen ground conditions only from November 15th through March 5th. No harvesting during the 9 day gun-deer season.
- New landings and roads must be approved by the DNR Forester.
- Do not cut any trees marked in green or blue paint.
- Equipment must be clean and free of debris prior to entering the sale.
- Prompt and proper treatment of slash where required. It is the responsibility of the timber contractor to spread all slash evenly throughout the sale down to 2 ft. No slash on trails, landings, or private property.
- This is a 3-year contract ending on June 30, 2027.

Ulman Lane Sale

Tract #: 3719-02-2024

Wisconsin DNR

Mead Wildlife Area

Volume Estimates

Species	Pulp/Bolts/Logs	
Aspen	450	Tons
Mixed HWD ¹	430	Tons
Oak ¹	410	Tons
Totals	1290	Tons

Legal Description:

NENW SWNW Section 24 T26N R5E Town of Green Valley, Marathon Co.

NWSW NESW SWSW SESW Section 24 T26N R5E Town of Green Valley, Marathon Co. (29 Acres)

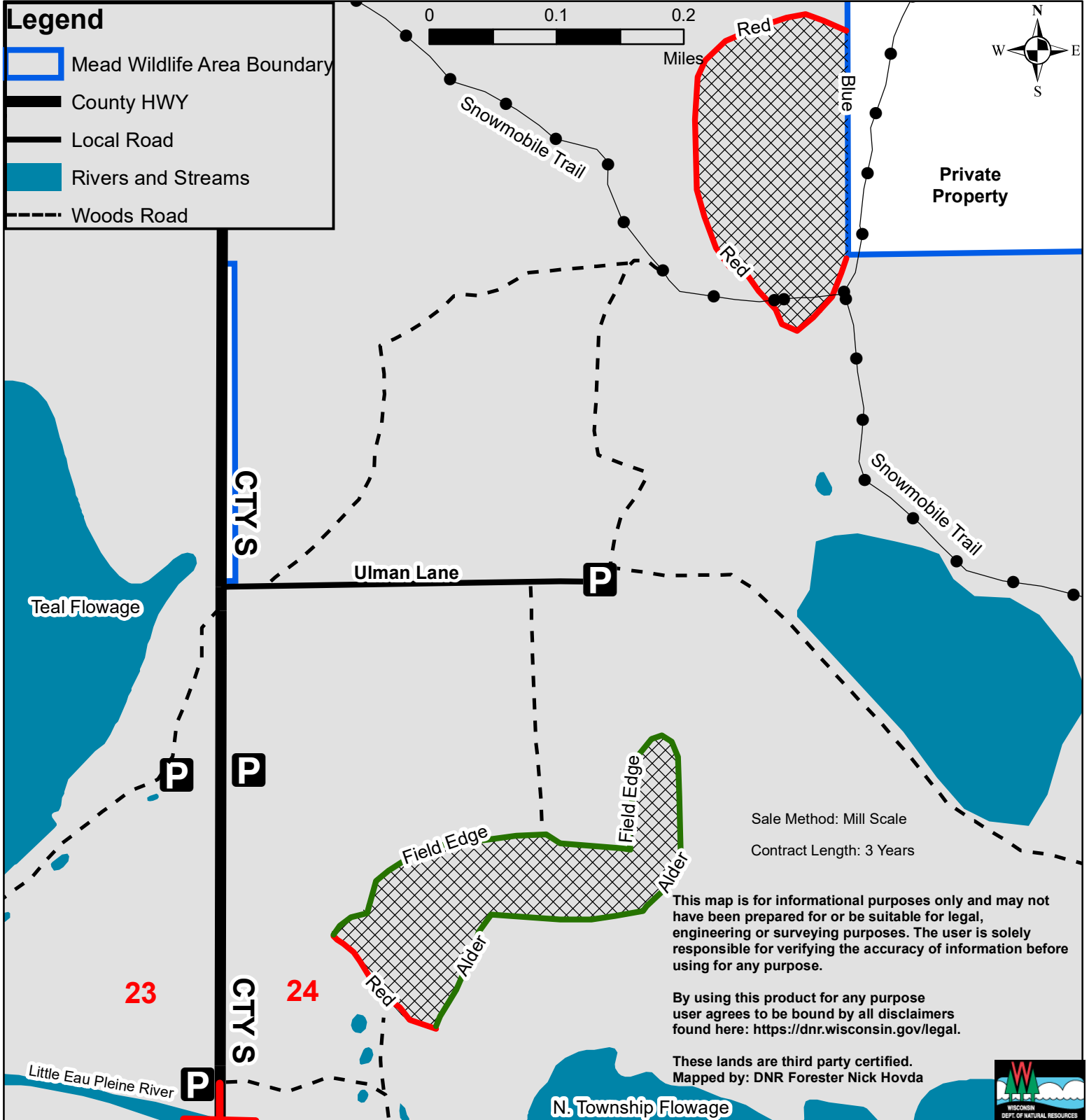

 - Sale Area (29 Acres): Cut all trees greater than 2" in diameter within the red and blue paint boundaries except for trees marked in green bands. Leave all conifer species.

Note: In order to fill and save this form electronically, it must be opened using Adobe Reader or Acrobat software. Save a copy of the file, open Adobe Reader, select File > Open and browse for the file you saved.

State of Wisconsin
Department of Natural Resources
dnr.wi.gov

Timber Sale Bid
Form 2400-049 (R 07/22)

Notice: Completion of this form is mandatory. The Department will not recognize your bid unless you complete and submit this form. Personal information collected will be used for program administration and may be provided to requesters as required by Wisconsin's Public Records law [ss. 19.31-19.39, Wis. Stats.].

Date

Bidder Name

Street Address

City

State

ZIP Code

Property Name (if any)

Mead Wildlife Area

Timber Sale Name

Ulman Lane

Tract Number

3719-02-2024

Date and Hour of Bid Opening

August 7, 2024 at 1:00pm

Minimum Acceptable Bid (optional)

\$8,292.00

Species-All bids including Lump Sum bids must be by species	Utilization Specifications (4 inch/Whole Tree/Logs)	Estimated Volume	Volume Units (tons/cords/mbf)	Price Bid Per Unit	Total Bid Value on Estimated Volume
Aspen	4 inch	450	Tons		
Mixed Hardwood	4 inch	430	Tons		
Oak	4 inch	410	Tons		

The award shall be based on this TOTAL BID AMOUNT:

Performance Bond

Will be in the form of: (select one)

Personal Check

Assurance Bond

Certified Check/Money Order

Certificate of Deposit

Irrevocable Letter of Credit

Assignment of Savings Account

I understand that any or all bids may be rejected and that consideration and awarding of a contract will be based upon my past performance and ability to complete contracts. **I also understand that if I am the winning bidder, I have 6 weeks from the date of the bid opening to submit an acceptable performance bond. I also understand that if I am awarded the contract and fail to execute it or work under it, I will be required to forfeit to the Department an amount equal to 10% of my total bid amount.** Failure to forfeit the 10% penalty will result in being considered ineligible to bid on any state timber sales for a two-year duration. In the event the highest bidder can not or will not sign the contract, the award may be made to the next highest qualified bid.

By checking this box, I certify that I hold a Wisconsin Master Logger Certification.

Notice: I understand:

Utilization specifications and estimated volumes are listed in the prospectus which is available upon request from the Department.

A copy of the standard timber sales contract which must be entered into is available upon request from the Department.

Signature of Bidder

Bidder's Name (Please Print or Type)

Phone Number (include area code)

Email Address

Frazzled Pheasant Sale
3718-01-2024
Wisconsin DNR
McMillan Wildlife Area

Forester Contact Information:
 Nicholas Hovda
 225051 Rib Mountain Drive
 Wausau, WI 54401
Nicholas.Hovda@wisconsin.gov
 715-297-0211

Legal Description: Section 7: SESW T26N, R3E Marathon County
 Section 13: NENE T26N R2E Marathon County
 Section 18: NENW, NWNE, SWNW, SENW,
 NWSW, NESW T26N R3E, Marathon County

see attached map for location and layout of harvest area(s)

Volume Estimates

Species	Pulp/Bolts/Logs	
Aspen	460	Tons
Mixed HWD ¹	2400	Tons
Totals	2860	Tons

Minimum Acceptable Value:	<u>\$18,130.00</u>
Scaling Method:	<u>Mill Scale</u>
Contract Ending Date:	<u>June 30, 2027</u>
Sale Area:	<u>66 Acres</u>

¹ **Mixed Hardwood consists of multiple products including pulp, bolts, and logs. Mixed hardwood pulp consists of 62% red maple, 21% of black ash, 10% white ash, 3% basswood, and 4% of white birch, red oak, bur oak, sugar maple, yellow birch, and elm. Mixed Hardwood sawlogs consists of 100 MBF red maple, 40 MBF black ash, 19 MBF white ash, 14 MBF basswood, and 8 MBF oak (red and bur). Mixed Hardwood wt. conv. 2.40 tons/cord. Aspen wt. conv. 2.25 tons/cord.**

Access:

There are multiple access points for this timber sale. To access the areas north of the Little Eau Pleine River, use the DNR Parking lots near the dead end of Abe Lincoln Drive. Various woods roads gives access to the cutting areas. To access the areas south of the Little Eau Pleine River, use the DNR parking lot off Frey Ave. From there, follow the snowmobile trail 1.4 miles east to the cutting area.

Cutting Specifications:

- **Area 1 (39 Acres):** Cut all trees marked in orange paint. Cut all trees greater than 2 inches in diameter within purple paint boundaries including purple marked trees. Leave all conifer species.
- **Area 2 (20 Acres):** Cut all trees greater than 2" in diameter within the stand boundaries except for oak species.
- **Area 3 (7 Acres):** Cut all trees greater than 2" in diameter within the stand boundaries except for trees marked in green bands. Leave all conifer species.
- Cutting must be concurrent for all species to be harvested. Non-merchantable trees must be cut concurrent with merchantable trees. Whole tree harvesting will not be permitted in this sale.
- Sawlog top diameter minimum of 10 inches. Pulpwood top diameter minimum of 4 inches.

Operational Considerations:

- Roads and landings utilized during the timber sale must be returned to original condition.
- Harvesting allowed from November 15th through March 5th.
- New landings and roads must be approved by the DNR Forester.
- Do not cut any trees marked in green or blue paint and oak species in Area 2.
- Equipment must be free of debris prior to entering the sale. Snow must be left on snowmobile trail.
- Prompt and proper treatment of slash where required. It is the responsibility of the timber contractor to spread all slash evenly throughout the sale down to 2 ft. No slash on trails, landings, or private property.

Frazzled Pheasant Sale

Tract #: 3718-01-2024

Wisconsin DNR



McMillan Wildlife Area

Legal Description:
 Section 7: SESW T26N, R3E Marathon County
 Section 13: NENE T26N R2E Marathon County
 Section 18: NENW, NWNE, SWNW, SENW,
 NWSW, NESW T26N R3E, Marathon County (66 acres)

Volume Estimates

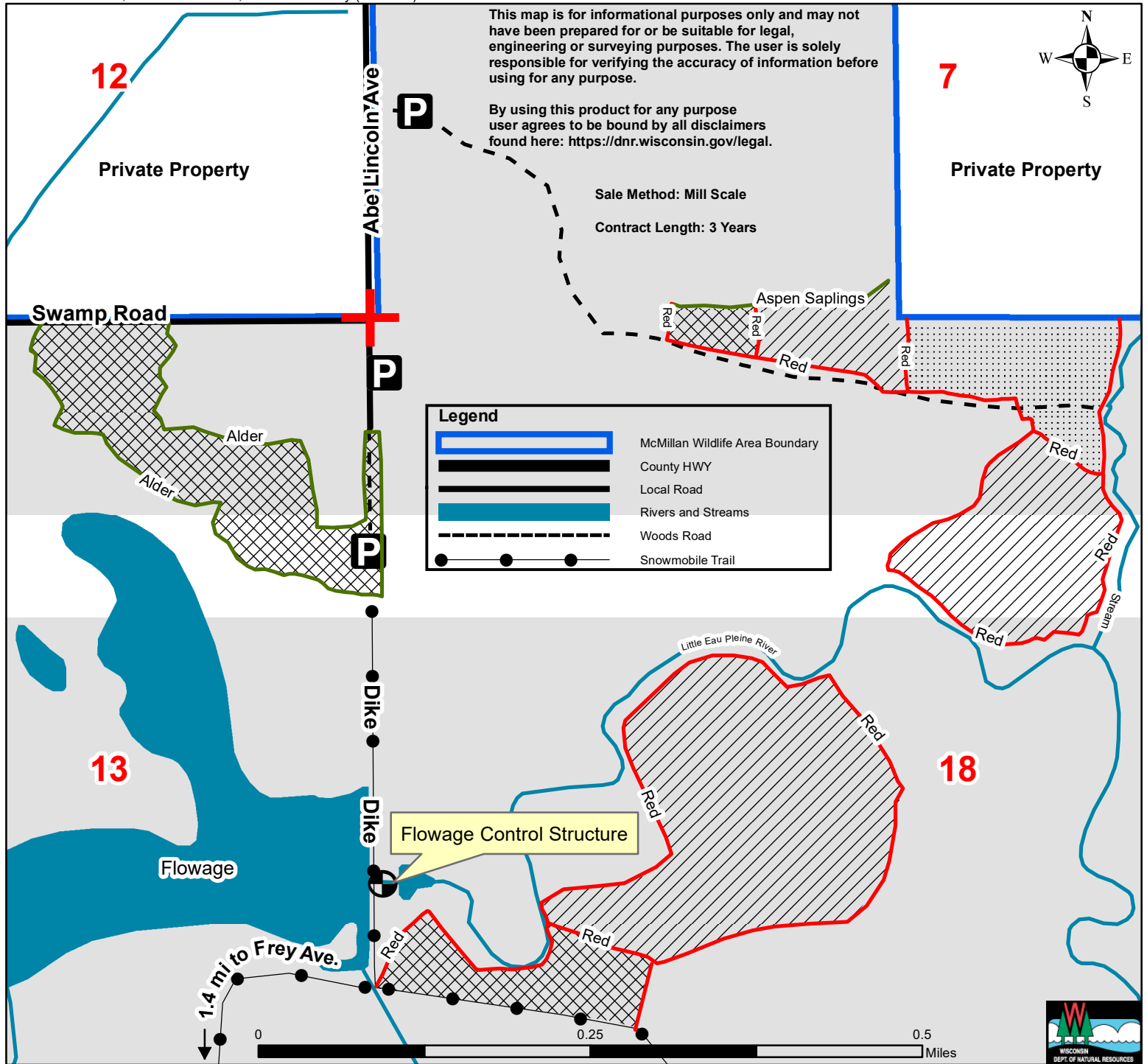
Species	Pulp/Bolts/Logs	
Aspen	460	Tons
Mixed HWD ¹	2400	Tons
Totals	2860	Tons



-  - Area 1 (39 Acres): Cut all trees marked in orange paint. Cut all trees greater than 2 inches in diameter within purple paint boundaries including purple marked trees. Leave all conifer species.
-  - Area 2 (20 Acres): Cut all trees greater than 2" in diameter within the stand boundaries except for oak species.
-  - Area 3 (7 Acres): Cut all trees greater than 2" in diameter within the stand boundaries except for trees marked in green bands. Leave all conifer species.



Note: In order to fill and save this form electronically, it must be opened using Adobe Reader or Acrobat software. Save a copy of the file, open Adobe Reader, select File > Open and browse for the file you saved.

State of Wisconsin
Department of Natural Resources
dnr.wi.gov

Timber Sale Bid
Form 2400-049 (R 07/22)

Notice: Completion of this form is mandatory. The Department will not recognize your bid unless you complete and submit this form. Personal information collected will be used for program administration and may be provided to requesters as required by Wisconsin's Public Records law [ss. 19.31-19.39, Wis. Stats.].

Date

Bidder Name

Street Address

City

State

ZIP Code

Property Name (if any)
McMillan Wildlife Area

Timber Sale Name
Frazzled Pheasant

Tract Number
3718-01-2024

Date and Hour of Bid Opening

August 7, 2024 at 1:00pm

Minimum Acceptable Bid (optional)

\$18,130.00

Species-All bids including Lump Sum bids must be by species	Utilization Specifications (4 inch/Whole Tree/Logs)	Estimated Volume	Volume Units (tons/cords/mbf)	Price Bid Per Unit	Total Bid Value on Estimated Volume
Aspen	4 inch	460	Tons		
Mixed Hardwood	4 inch	2,400	Tons		

The award shall be based on this TOTAL BID AMOUNT:

Performance Bond

Will be in the form of: (select one)

Personal Check

Assurance Bond

Certified Check/Money Order

Certificate of Deposit

Irrevocable Letter of Credit

Assignment of Savings Account

I understand that any or all bids may be rejected and that consideration and awarding of a contract will be based upon my past performance and ability to complete contracts. **I also understand that if I am the winning bidder, I have 6 weeks from the date of the bid opening to submit an acceptable performance bond. I also understand that if I am awarded the contract and fail to execute it or work under it, I will be required to forfeit to the Department an amount equal to 10% of my total bid amount.** Failure to forfeit the 10% penalty will result in being considered ineligible to bid on any state timber sales for a two-year duration. In the event the highest bidder can not or will not sign the contract, the award may be made to the next highest qualified bid.

By checking this box, I certify that I hold a Wisconsin Master Logger Certification.

Notice: I understand:

Utilization specifications and estimated volumes are listed in the prospectus which is available upon request from the Department.

A copy of the standard timber sales contract which must be entered into is available upon request from the Department.

Signature of Bidder

Bidder's Name (Please Print or Type)

Phone Number (include area code)

Email Address