

Hoofers Club - Tract 01-25 // Sale # _____

45N - R06W - S7 Township of Grand View - Bayfield Co. WI

Forester: Oikarinen (715) 209-0071	Estimated Volumes - Tons			Minimum Bid: \$61,170
Sale Area Information:	Species	Tons to 4" Top	Average Diameter	Additional Species & Sawlog Information:
Sale area is 125 acres on rolling to flat terrain, sandy loam soil in State Natural Area. All borders marked. Approach to stream crossing improved in 2024. Key for gated access to be loaned to buyer.	Aspen	3600	9 inches	*Mixed hardwood pulp is made up of approximately 64% hard maple, 13% red maple, 12% ash, and 5% white birch. This includes 8 MBF in log. Mixed hardwood also contains approximately 6% Basswood with 9 MBF in basswood logs. Sawlog volume estimate highly variable.
	Mixed Hardwood*	1500	9 inches	
	Total Volume	5100 total tons		

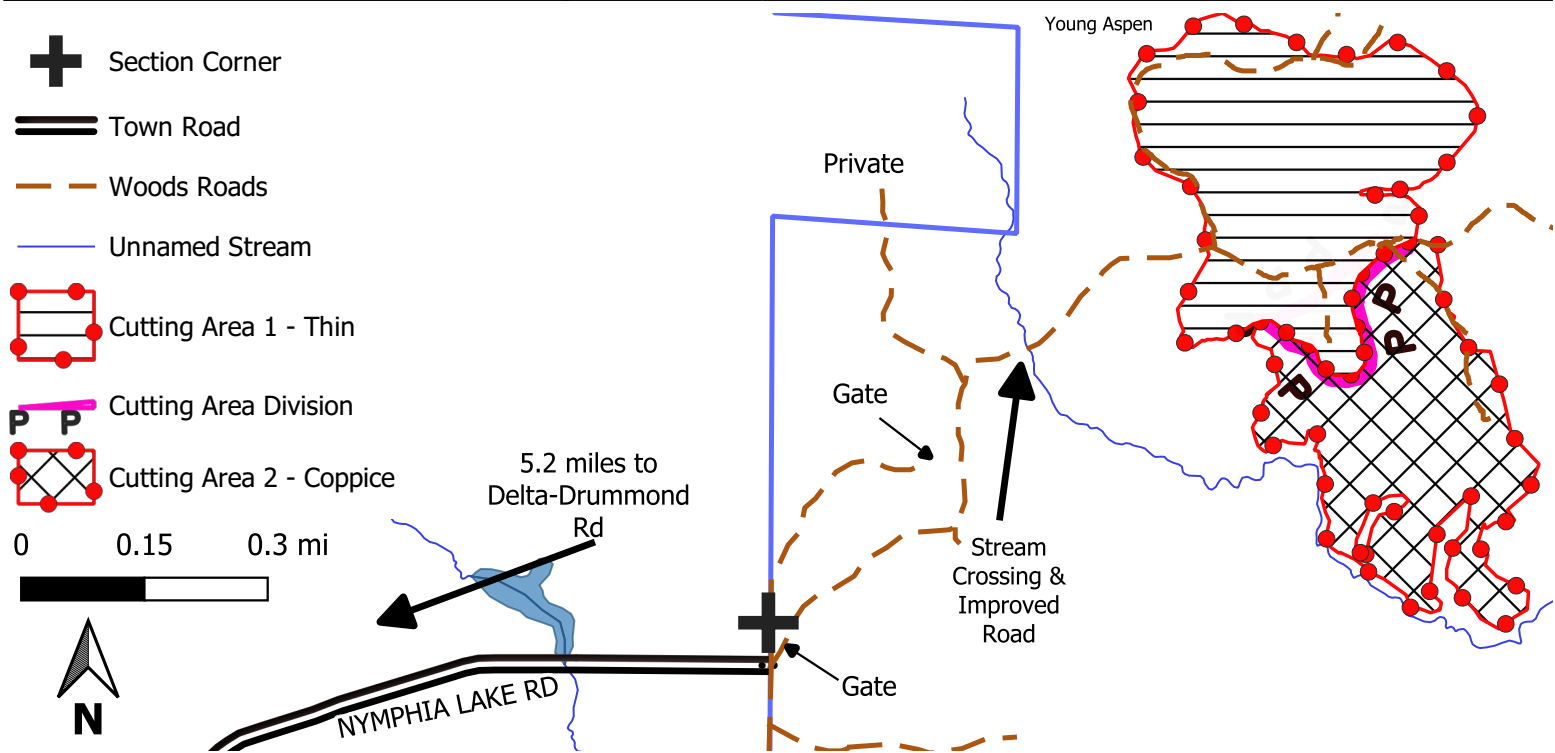

- Cutting Area 1: Marked Thin – Cut all trees marked with orange paint. Boundary marked with red paint line. Purple and red paint line shows boarder between Cutting Area 1 and Cutting Area 2.

- Cutting Area 2: Coppice with Reserves – Cut all trees 2" and greater with the exception of reserve species and trees marked with green paint. Reserve species are all maple, black cherry, red pine, white pine, hemlock, cedar, spruce, and balsam fir. Boundary Marked with red paint line.

- Utilization & Slash: Utilization on all harvested trees is a 100" stick to a 4" or 6" top; purchaser's discretion. No whole tree/ biomass harvesting. Scatter slash evenly over site.

- Sale Terms, Hauling, decking, & Access: This is a scaled and ticketed sale sold by the ton. No new hauling roads are to be created. Landing and decking areas to be confirmed at pre-sale meeting with Forester and Property Manager. Access from Nymphia Lake Road to gated DNR woods road. Gate must be closed and locked when not in use. Cautionary signage must be placed along Nymphia Lake Rd. during hauling operations.

- Intermittent Stream Crossing: Woods road surrounding intermittent stream improved in 2024 with geogrid and rock. Comply with Best Management Practices for Water Quality. A general permit, obtained by the DNR, will be adhered to by the contractor for the temporary unnamed tributary crossing on the main haul road. This may include, but is not limited to the following permit specifications: instructions on placement, type of structures permitted, timing restrictions for usage, maintenance of the crossing, removal of the structure, and the closure of the crossing.

- Forest Health & Damage: If forest health concerns, such as oak wilt arise, or excessive damage occurs, additional time or harvest restrictions may be imposed. Comply with Best Management Practices for Invasive Species: Prior to moving equipment onto or off the sale area, scrape or brush soil and debris from exterior surfaces to the extent practical.

- See bid package for more information.